

1. Copyright of this drawing is reserved by the Architect. The drawing, and all associated documents are instruments of service by the Architect. The drawing, and the information contained therein, may not be reproduced in whole or in part without prior written permission of the Architect.

2. These Contract Documents are the property of the Architect. The Architect bears no responsibility for the interpretation of these documents by the Contractor. Upon written application the Architect will provide written clarification or supplementary information regarding the intent of the Contract Documents. The Architect will review Shop Drawings submitted by the Contractor for design conformance only.

3. Drawings are not to be scaled for construction. The Contractor is to verify all existing conditions and dimensions required to perform the work and report and discrepancies with the Contract Documents to the Architect before commencing any work.

4. Positions of exposed finishes for mechanical or electrical devices, fitting and fixtures are indicated on architectural drawings. The location shown on the architectural drawing govern over the mechanical and electrical drawings. Those items not clearly located will be located as directed by the Architect.

5. These drawings are not to be used for construction unless noted below as "Issued for Construction".

6. All work is to be carried out in conformance with the Code and Bylaws of the Authorities having jurisdiction.

7. The Architect of these plans and specifications gives no warranty or representation to any party about the constructability of the building(s) represented by them. All contractors or subcontractors must satisfy themselves when bidding and at all times ensure that they can properly construct the work represented by these plans.

No. Issuance Date (YYYY-MM-DD)
 01 SITE PLAN APPLICATION 2012.07.27

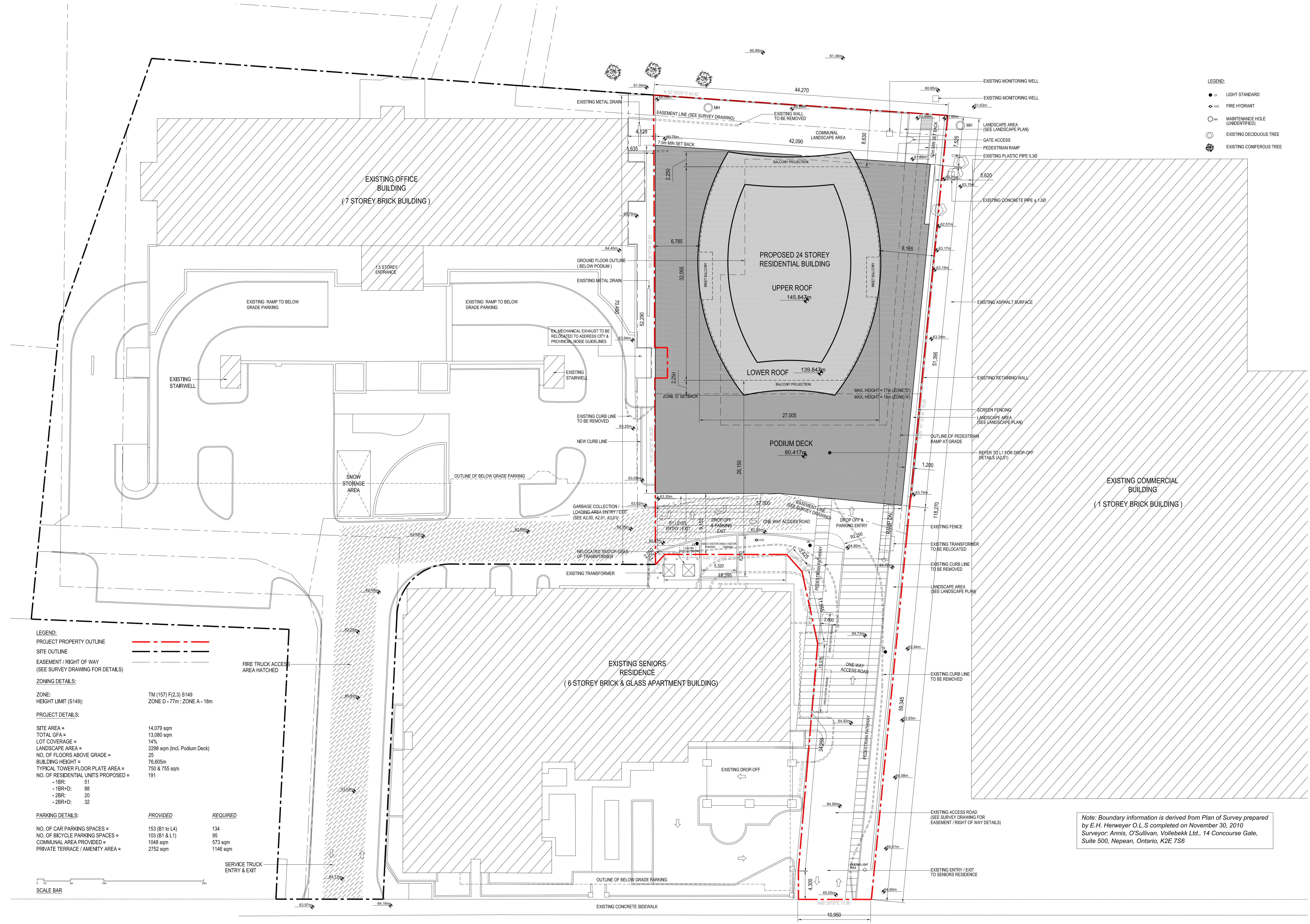

30 Duncan Street, Suite 202
 Toronto, Ontario M5V 2C3
 t 416 340 1870
 f 416 340 1871
 info@wallmanarchitects.com



485 RICHMOND ROAD
 OTTAWA, ONTARIO

MINTO COMMUNITIES INC.

200-180 KENT ST. OTTAWA, ON, K1P 0B6

SITE PLAN

project number	project north
XX-SS	project
2012.07.27	client
1:250 @ ARCH D	title
drawn by	sheet

A1.01

Note: Boundary information is derived from Plan of Survey prepared by E.H. Herweyer O.L.S. completed on November 30, 2010
 Surveyor: Annis, O'Sullivan, Vollebek Ltd., 14 Concourse Gate, Suite 500, Nepean, Ontario, K2E 7S6