

COPYRIGHT
This drawing has been prepared solely for the intended use. Any reproduction or distribution for any purpose other than authorized by IBI Group is forbidden. Written dimensions shall have precedence over scaled dimensions. Contractors shall verify and be responsible for all dimensions and conditions on the job, and IBI Group shall be informed of any variations from the dimensions and conditions shown on the drawing. Shop drawings shall be submitted to IBI Group for general concurrence before proceeding with fabrication.

IBI Group Professional Services (Canada) Inc.
is a member of the IBI Group of companies

ISSUES

No.	DESCRIPTION	DATE
1	ISSUED FOR CITY REVIEW	2021-03-05
2	REVISED PER CITY COMMENTS	2021-03-05
3	REVISED AS PER CITY COMMENTS	2021-07-28
4	REVISED PER NEW SITE PLAN	2021-08-30
5	ISSUED FOR BUILDING PERMIT	2021-09-13
6	REVISED WATERMAIN LABELS	2021-10-29

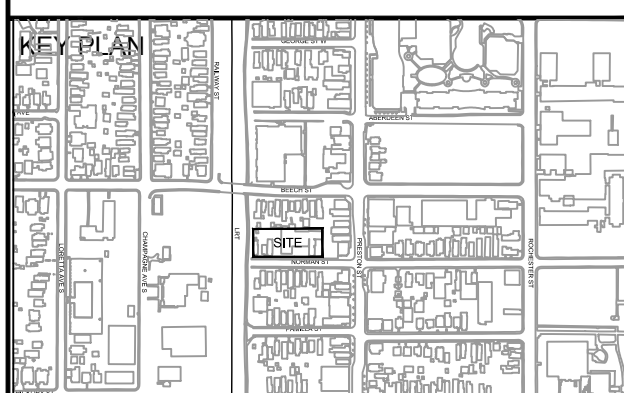

CONSULTANTS

Project Coordinator
Tamarack Homes

Architect:
RLA Architecture

Landscape:
Lashley + Associates

Surveyor:
Stantec Geomatics Ltd.

Geotech:
Paterson Group

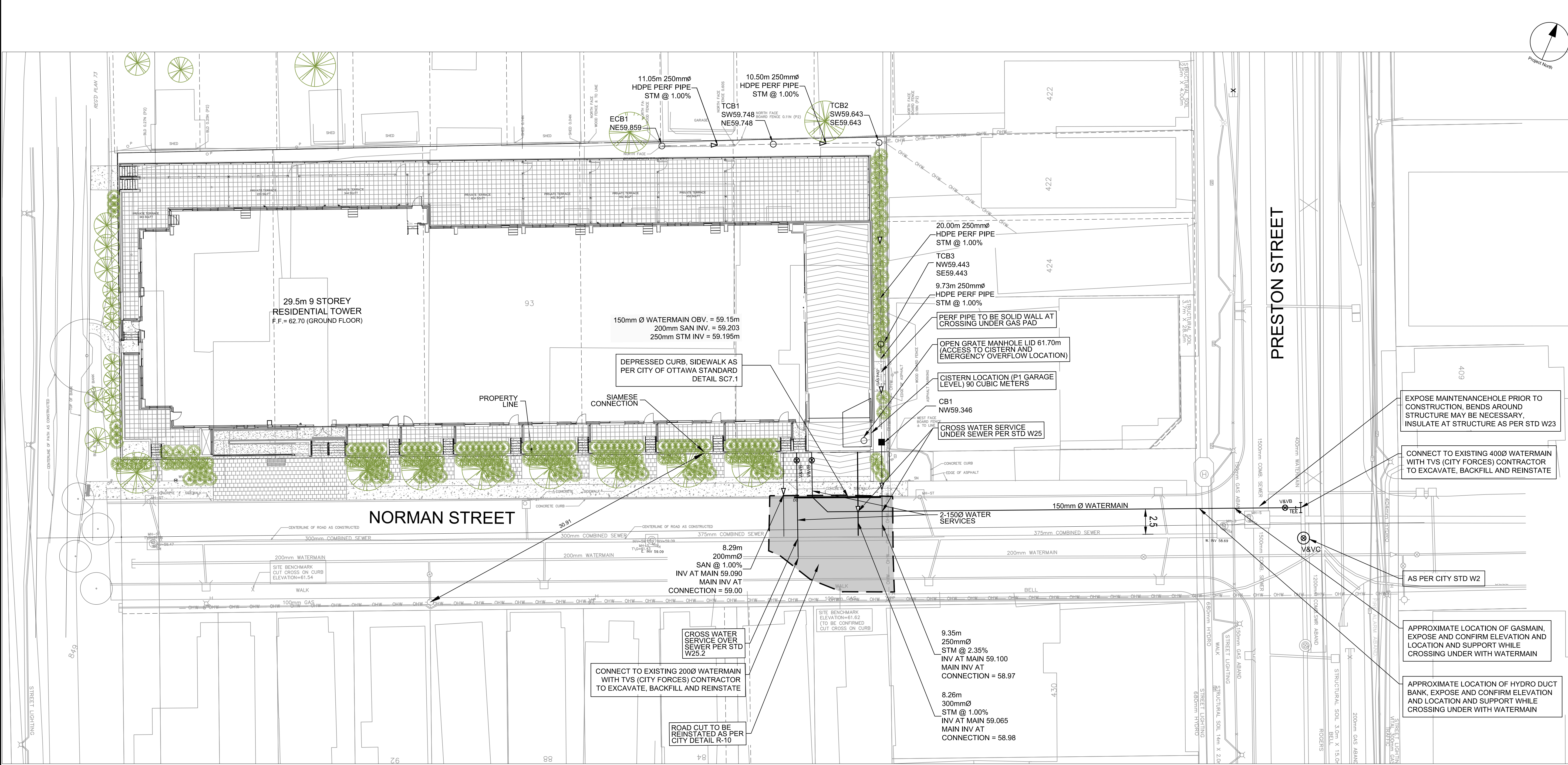
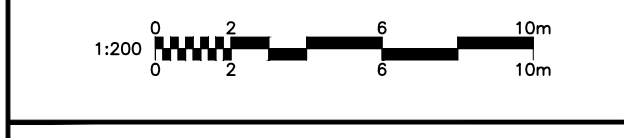

LEGEND

---	PROPERTY LINE	—	EXISTING TRAFFIC SIGN
---	FUTURE WIDENING	□ CB	EXISTING CATCH BASIN
F.F. = 80.50	FINISHED FLOOR ELEVATION	● AD1	PROPOSED AREA DRAIN
DC	PROPOSED DEPRESSED CURB	⊙ MH	EXISTING COMBINED MANHOLE
⊙	WATER METER (SEE MECH. DRWG. FOR EXACT LOCATION)	— 300P COMBINED	EXISTING COMBINED SEWER
⊙	REMOTE WATER METER (SEE MECH. DRWG. FOR EXACT LOCATION)	— 200P STORM	PROPOSED STORM SEWER
⊙	SIAMESE CONNECTIONS (SEE MECH. DRWG. FOR EXACT LOCATION)	— 400P WATERMAIN	EXISTING WATERMAIN
—	PROPOSED GAS SERVICE	— 200P SANITARY	PROPOSED SANITARY SEWER
—	EXISTING UNDERGROUND HYDRO	— 150P WATERMAIN	PROPOSED WATERMAIN
—	EXISTING OVERHEAD HYDRO	⊙ 150V&VB	PROPOSED VALVE AND VALVE BOX
⊙ HMH	EXISTING HYDRO MANHOLE	⊙ 400V&VC	PROPOSED VALVE AND VALVE CHAMBER
⊙ HP	EXISTING HYDRO AND LIGHT POLE	⊙ HYD	EXISTING FIRE HYDRANT
---	EXISTING GAS MAIN	— SN	EXISTING SIGN
---	EXISTING BELL	⊙	EXISTING WATER VALVE
⊙ BMH	EXISTING BELL MANHOLE	⊙ LS	EXISTING WATER SERVICE STANDPOST
⊙ TMH	EXISTING TRAFFIC MANHOLE	⊙ LS	EXISTING VALVE BOX
⊙ HP	EXISTING TRAFFIC LIGHT	---	PROPOSED LIMITS OF UNDERGROUND PARKING
---	PROPOSED RETAINING WALL		

NOTES:

- ALL WORKS TO BE COMPLETED AS PER CURRENT CITY OF OTTAWA STANDARDS AND ONTARIO PROVINCIAL STANDARDS AND SPECIFICATIONS.
- SEWER LATERALS TO BE PVC DR 35.
- WATER MAIN AND SERVICES TO BE PVC. DR 18 CL150. MINIMUM COVER OF 2.4m FOR WATER SERVICE IS REQUIRED, USE THERMAL INSULATION AS PER CITY STANDARDS WHEN COVER IS LESS THAN 2.4m. WATER MAIN AND SERVICES TO HAVE RESTRAINTS AND THRUST BLOCKS AS PER CITY STD W23, W25.5 AND W25.6. NEW WATER MAIN TO HAVE TRACING WIRE PER STD W36
- ALL SERVICE LATERAL AND SURFACE RESTORATION WORK IN ACCORDANCE WITH CURRENT CITY OF OTTAWA STANDARDS AND SPECIFICATIONS.
- FULL PORT BACKWATER VALVE IS REQUIRED ON BOTH THE SANITARY AND STORM SERVICE CONNECTIONS.
- WATER SERVICE CHLORINATION AND TESTING TO BE COMPLETED BY CITY FORCES.
- PROPOSED BUILDING INFORMATION TAKEN FROM RLA ARCHITECTS DRAWINGS.
- AN EROSION AND SEDIMENTATION CONTROL PLAN WILL BE IMPLEMENTED ON THIS SITE. AS A MINIMUM THAT PLAN WILL INCLUDE A LIGHT DUTY SILT FENCE BARRIER TO OPSD STANDARD 219.110 SURROUNDING THE SITE WHERE PRACTICAL AND SILT SACKS FITTED UNDER EXISTING STREET CATCH BASINS.
- ALL SHOWN UTILITIES ARE APPROXIMATE AND ARE TO BE FIELD VERIFIED BY CONTRACTOR, ANY DISCREPANCIES ARE TO BE REPORTED TO IBI GROUP PRIOR TO CONTRACTOR MOBILIZING TO SITE.
- CONTRACTOR RESPONSIBLE TO SUPPORT EXISTING UTILITIES THAT MAY BE AFFECTED DURING CONSTRUCTION

- EXISTING CURBS AND SIDEWALKS ARE TO BE REMOVED AND REPLACED AS NOTED ON THE DRAWINGS.
- THE CONTRACTOR SHALL IMPLEMENT BEST MANAGEMENT PRACTICES, TO PROVIDE FOR PROTECTION OF THE AREA DRAINAGE SYSTEM AND THE RECEIVING WATER COURSE, DURING CONSTRUCTION ACTIVITIES. THIS INCLUDES LIMITING THE AMOUNT OF EXPOSED SOIL, USING FILTER CLOTH UNDER THE GRATES OF CATCHBASINS AND MANHOLES AND INSTALLING SILT FENCES AND EFFECTIVE SEDIMENT TRAPS. THE CONTRACTOR ACKNOWLEDGES THAT FAILURE TO IMPLEMENT APPROPRIATE EROSION AND SEDIMENT CONTROL MEASURES MAY BE SUBJECT TO PENALTIES IMPOSED BY ANY APPLICABLE REGULATORY AGENCIES.
- FOR GEOTECHNICAL INFORMATION SEE REPORT PG2760-1 BY PATERSON GROUP
- CLAY SEAL TO BE INSTALLED IN SERVICE TRENCHES BETWEEN CONNECTION POINT AND CAP.

James Do

DOUGLAS JAMES, MCIP, RPP
MANAGER, DEVELOPMENT REVIEW - CENTRAL
PLANNING, INFRASTRUCTURE & ECONOMIC
DEVELOPMENT DEPARTMENT, CITY OF OTTAWA

APPROVED
By Jamesdo at 11:46 am, Nov 25, 2021



PROJECT
93 NORMAN STREET

PROJECT NO:
132469

DRAWN BY: D.D.	CHECKED BY: J.B.
PROJECT MGR: T.R.B.	APPROVED BY: T.R.B.

SHEET TITLE
GENERAL PLAN OF SERVICES

SHEET NUMBER C-001	ISSUE 5
------------------------------	-------------------