



- L-TP1 GENERAL NOTES**
- All general site information and conditions compiled from architect's and engineer's plans and surveys.
  - Do not scale this drawing.
  - Report any discrepancies prior to commencing work. No responsibility is born by the Landscape Architect for unknown subsurface conditions.
  - Reinstate all areas and items damaged as a result of construction activities to the satisfaction of the Landscape Architect.
  - Drawing may not be used for construction until signed by Landscape Architect as issued for construction.
  - The accuracy of the position of utilities is not guaranteed.
  - Individual utility co. must be contacted for confirmation of utility existence and location prior to digging.
  - This drawing is an instrument of service and requires the permission of the Landscape Architect for use. Copyright is reserved by the Landscape Architect, David M. Lashley.

- LEGEND:**
- PROPERTY LINE
  - o- EXISTING FENCE
  - - - TREE PROTECTION FENCE
  - EXISTING CONIFEROUS TREES TO BE REMAIN
  - EXISTING DECIDUOUS TREES TO BE REMAIN

NO.	DATE	DESCRIPTION
2	2021/05/21	ISSUED FOR SPA RESUBMISSION
1	2021/03/03	ISSUED FOR SPA

**NO. DATE DESCRIPTION**

**SEAL:** **NORTH:**

**LASHLEY ASSOCIATES**  
LANDSCAPE ARCHITECTURE AND SITE ENGINEERING

225-200 GILCHRIST AVENUE  
OTTAWA, ON K1Y 1S6  
T 613 232 8578  
F 613 232 8579  
E info@lashley.com  
E David.Lashley@lashley.com

**CONSULTANT:**

**TAMARACK**  
TAMARACKHOMES.COM

**PROJECT:**

**RESIDENTIAL APARTMENTS**  
93 NORMAN STREET  
OTTAWA, ONTARIO

**DRAWING TITLE:**

*EXISTING CONDITIONS AND REMOVALS PLAN*

**DATE:** 2021/05/21 **DRAWING NO.:**

**SCALE:** AS NOTED

**DRAWN BY:** RP/EL **L-TP1**

**LA PROJECT NO.** 21790-1

1 EXISTING VEGETATION  
L-TP1

**93 NORMAN STREET TREE INVENTORY**

NO.	TREE SPECIES	DBH (cm)	CONDITION	COMMENTS
1	Burr Oak/ <i>Quercus macrocarpa</i>	7	Good	
2	Burr Oak/ <i>Quercus macrocarpa</i>	6	Good	
3	Common Buckthorn/ <i>Rhamnus cathartica</i>	22	Good	
4	Eastern White Cedar/ <i>Taxus occidentalis</i>	11	Good	
5	Manitoba Maple/ <i>Acer negundo</i>	16	Fair	Heavy Lean To North

- NOTES:**
- THE FOLLOWING PROTECTION MEASURES MUST BE IMPLEMENTED FOR RETAINED TREES, BOTH WITHIN THE WORK AREA AND ON ADJACENT PARCELS.
- UNDER THE GUIDANCE OF AN ARBORIST, ERECT A MODULAR FENCE AT THE CRITICAL ROOT ZONE (CRZ) OF TREES WHERE THE CRZ IS ESTABLISHED AS BEING 10 CENTIMETERS FROM THE TRUNK FOR EVERY CENTIMETER OF TRUNK DIAMETER AT BREAST HEIGHT.
  - TREE PROTECTION SHALL BE ERECTED TO PROVIDE A CONTINUOUS BARRICADE BETWEEN DESIGNATED TREES AND THE WORK AREA PRIOR TO CONSTRUCTION.
  - TUNNEL OR BORE WHEN DIGGING WITHIN THE CRZ OF A TREE.
  - ENSURE ALL EQUIPMENT AND CONSTRUCTION RELATED MATERIAL ARE NOT PLACED OR TEMPORARILY STORED WITHIN THE CRZ.
  - ENSURE EXHAUST FUMES FROM ALL EQUIPMENT ARE NOT DIRECTED TOWARDS ANY TREES CANOPY.
  - FLOODING OR DEPOSITION OF SEDIMENT SHALL BE PREVENTED WHERE TREES ARE LOCATED.
  - ALL DISTURBED ROOT SYSTEMS SHALL BE EXPOSED AND BACKFILLED IN ONE CONTINUOUS OPERATION TO MINIMIZE DESICCATION.
  - EXPOSED ROOTS SHALL BE KEPT CONTINUOUSLY MOIST DURING EXCAVATION.
  - REMOVE BROKEN AND DAMAGED ROOTS WITH SHARP PRUNING SHEARS.
  - THE TREE PROTECTION MODULAR FENCE IS TEMPORARY, SHALL BE MAINTAINED AT ALL TIMES DURING CONSTRUCTION OPERATIONS, AND SHALL BE REMOVED UPON COMPLETION OF WORK.
  - WHEN AGREED TO BY THE CONTRACT ADMINISTRATOR AND LANDSCAPE ARCHITECT.

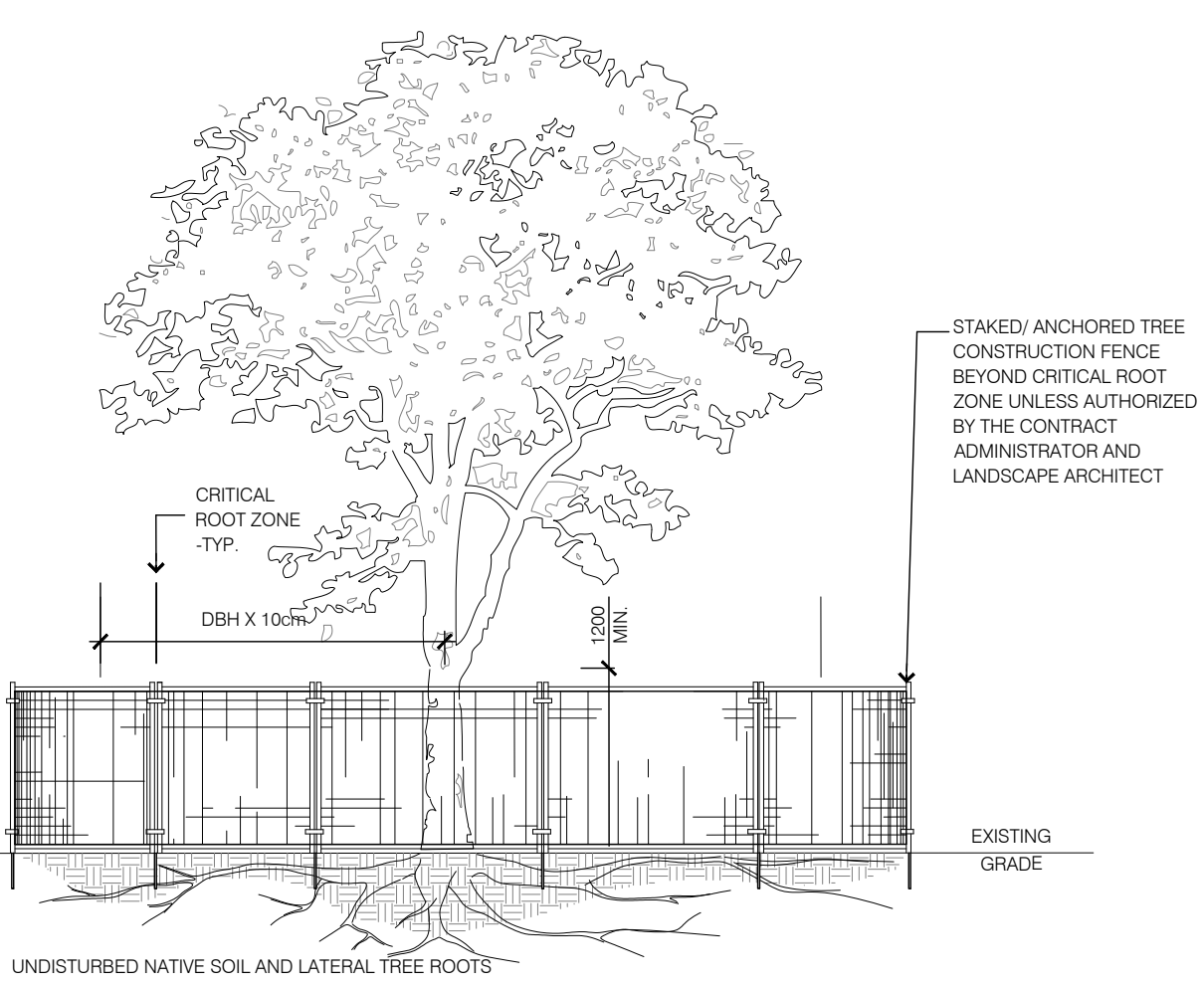

2 TREE PROTECTION FENCE  
L-TP1

1:125

1:50

D-07-12-19-0225



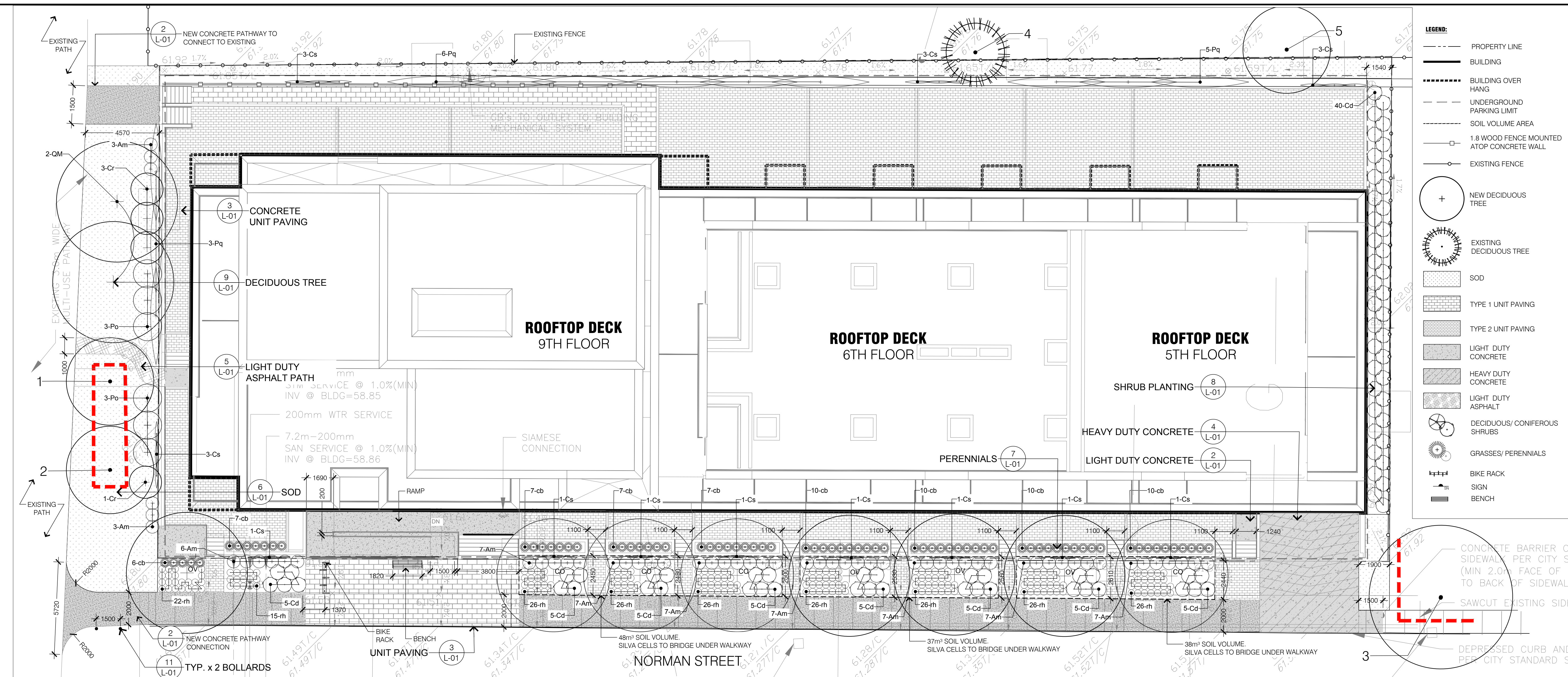

**LEGEND:**

- PROPERTY LINE
- BUILDING
- BUILDING OVER HANG
- UNDERGROUND PARKING LIMIT
- SOIL VOLUME AREA
- 1.8M WOOD FENCE MOUNTED ATOP CONCRETE WALL
- EXISTING FENCE
- NEW DECIDUOUS TREE
- EXISTING DECIDUOUS TREE
- SOD
- TYPE 1 UNIT PAVING
- TYPE 2 UNIT PAVING
- LIGHT DUTY CONCRETE
- HEAVY DUTY CONCRETE
- LIGHT DUTY ASPHALT
- DECIDUOUS/ CONIFEROUS SHRUBS
- GRASSES/ PERENNIALS
- BIKE RACK
- SIGN
- BENCH



- L1-01 GENERAL NOTES**
- All general site information and conditions compiled from architect's and engineer's plans and surveys.
  - Do not scale this drawing.
  - Report any discrepancies prior to commencing work. No responsibility is born by the Landscape Architect for unknown subsurface conditions.
  - Reinstate all areas and items damaged as a result of construction activities to the satisfaction of the Landscape Architect.
  - Drawing may not be used for construction until signed by Landscape Architect as issued for construction.
  - The accuracy of the position of utilities is not guaranteed.
  - Individual utility co. must be contacted for confirmation of utility existence and location prior to digging.
  - This drawing is an instrument of service and requires the permission of the Landscape Architect for use. Copyright is reserved by the Landscape Architect, David M. Lashley.

- L1-01 LANDSCAPE NOTES**
- Plant material shall be No. 1 Grade and shall comply with the Metric Guide Specifications for Nursery Stock (latest edition), published by Canadian Nursery Trades Association.
  - Plant substitutions shall not be permitted unless approved by the Landscape Architect.
  - Obtain approval of planting prior to digging.
  - Topsoil shall be garden soil mixture sandy loam with min. 5% organic matter and peat moss added at ratio of 1:10, topsoil to be approved by Landscape Architect.

**1 LANDSCAPE PLAN**

**GENERAL PLANT LIST**

KEY	QTY	BOTANICAL NAME	COMMON NAME	SIZE	COMMENTS
<b>DECIDUOUS TREES</b>					
CO	5	Celtis occidentalis	Hackberry	50mm CAL.	W.B.
OM	2	Quercus macrocarpa	Burr Oak	50mm CAL.	W.B.
OV	3	Ostrya virginiana	Ironwood	50mm CAL.	W.B.
<b>SHRUBS</b>					
Am	51	Aronia melanocarpa	Black Chokeberry	2 GAL.	POTTED
Cr	4	Cornus racemosa	Gray Dogwood	1 GAL.	POTTED
Cd	78	Cotoneaster dammeri	Bearberry Cotoneaster	1 GAL.	POTTED
Po	11	Physocarpus opulifolius 'Luteus'	Golden Ninebark	1 GAL.	POTTED
<b>VINES</b>					
Cs	20	Celastrus scandens 'Autumn Revolution'	American Bittersweet	1 GAL.	POTTED
Pq	12	Parthenocissus quinquefolia	Virginia Creeper	1 GAL.	POTTED
<b>GRASSES</b>					
cb	75	Calamagrostis brachytricha	Autumn Feather Reed Grass	1 GAL.	POTTED
<b>PERENNIALS</b>					
rh	203	Rudbeckia hirta	Black-Eyed Susan	1 GAL.	POTTED

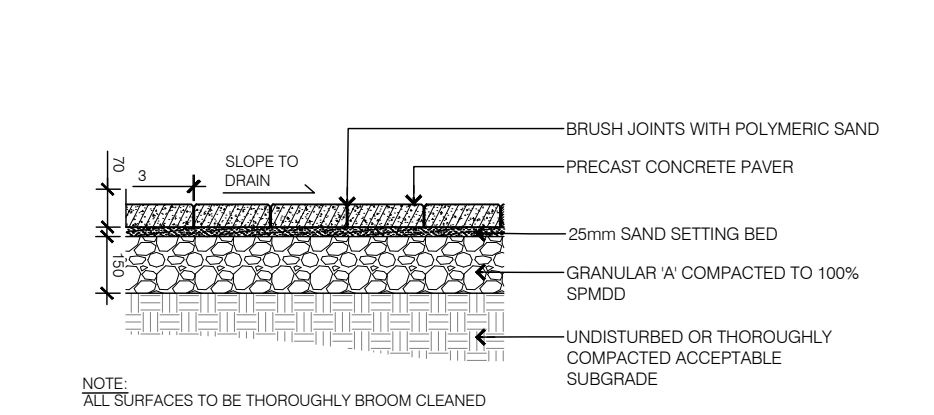

**3 UNIT PAVING** 1:20

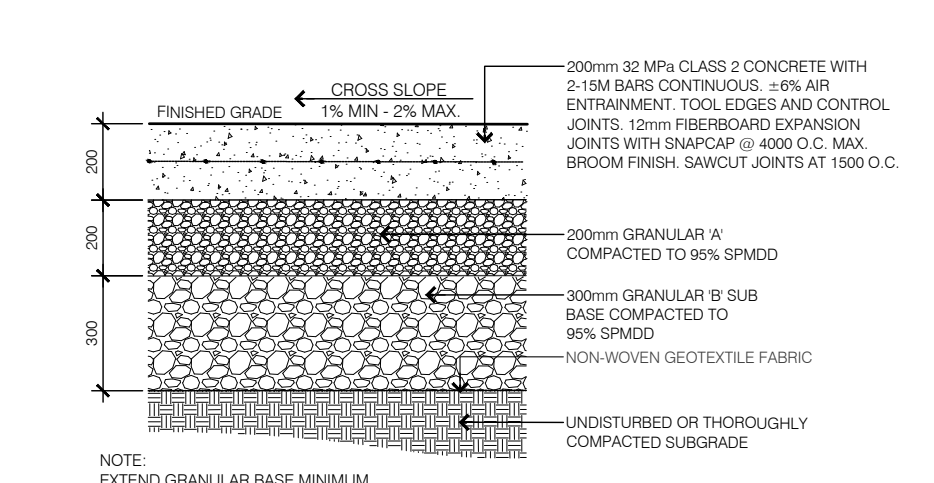

**4 HEAVY DUTY CONCRETE** 1:20

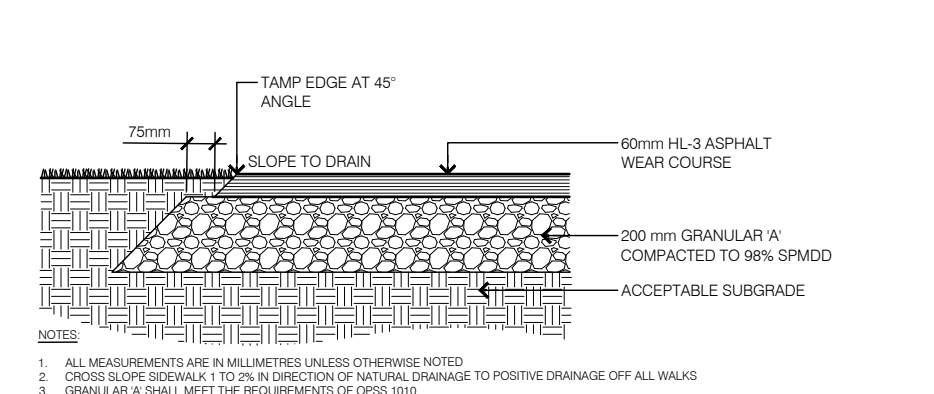

**5 LIGHT DUTY ASPHALT** 1:20

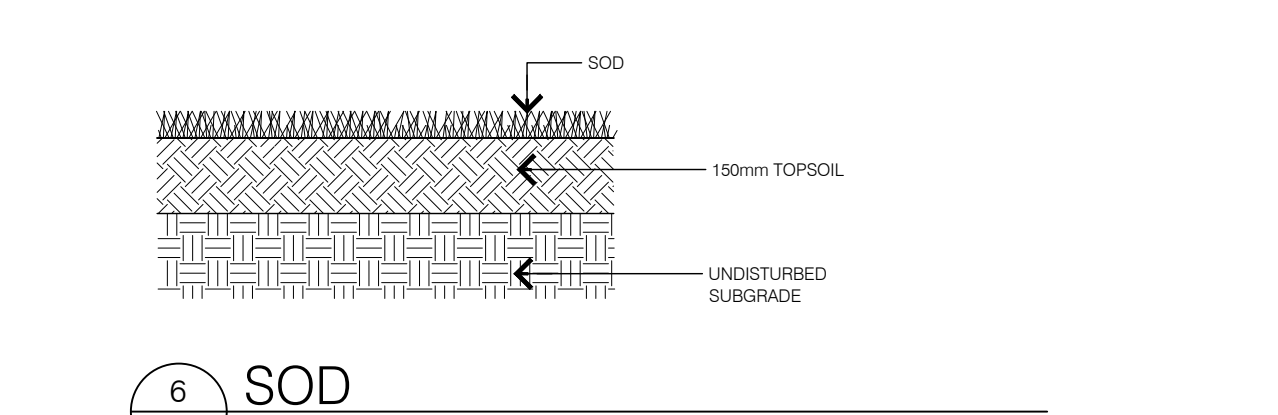

**6 SOD** 1:20

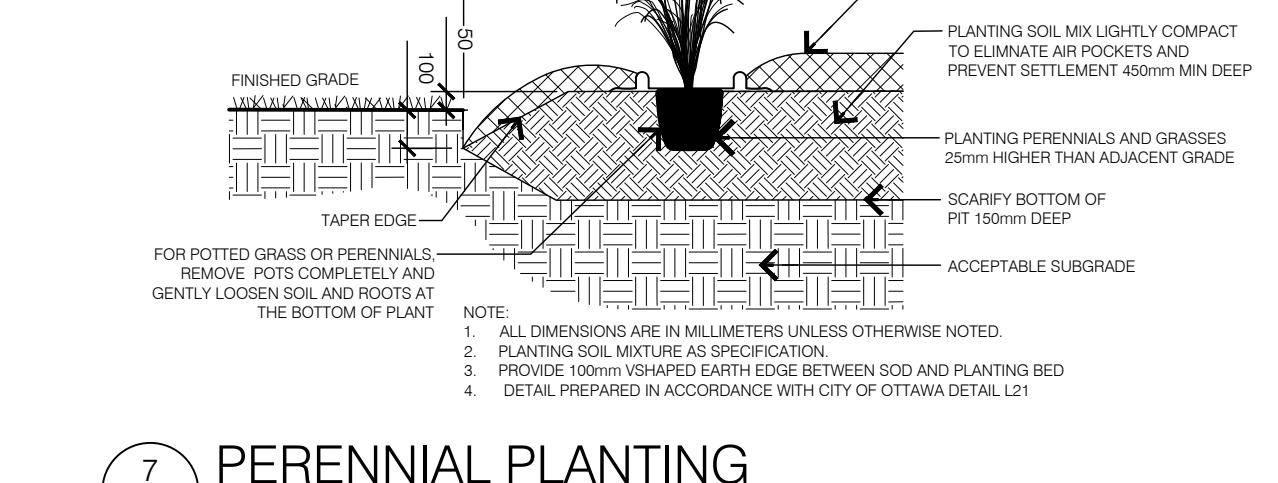

**7 PERENNIAL PLANTING** 1:20

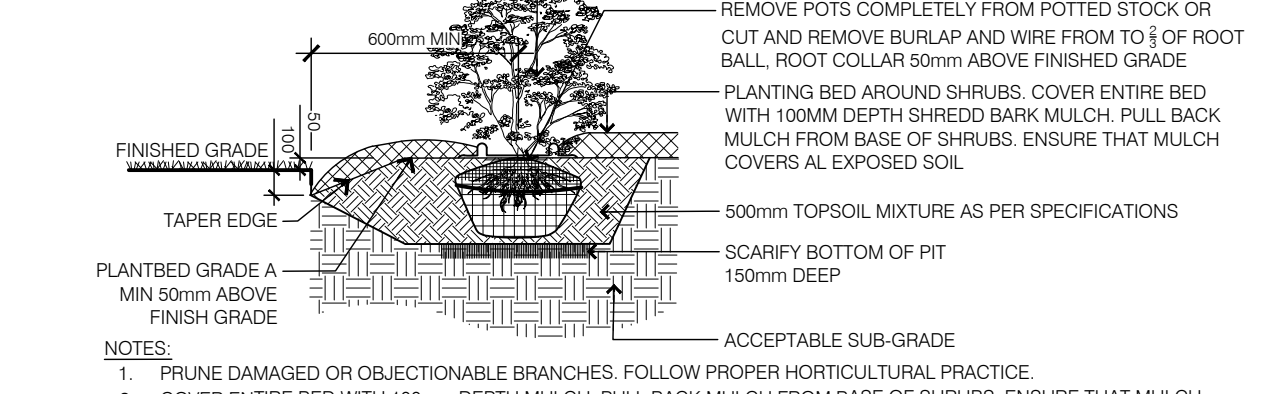

**8 SHRUB PLANTING** 1:30

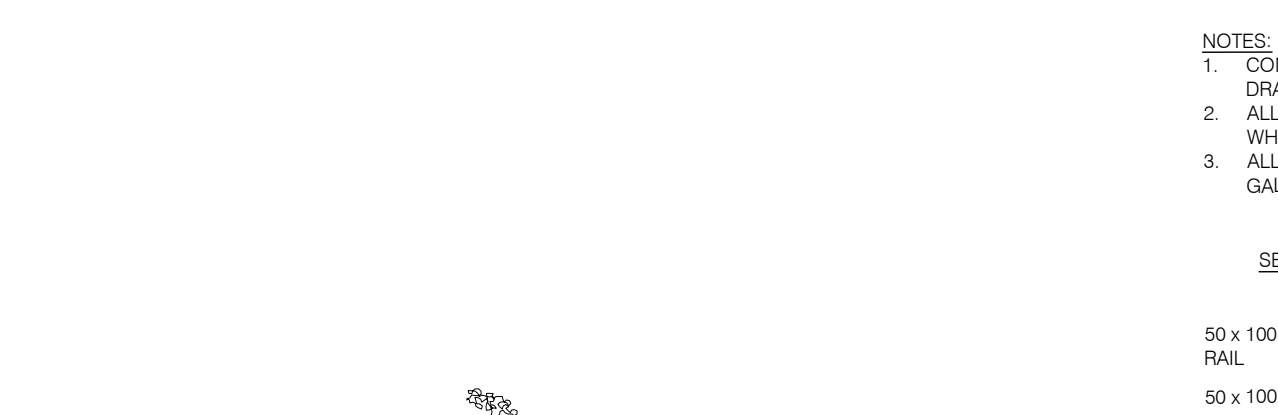

**9 DECIDUOUS TREE PLANTING** 1:40

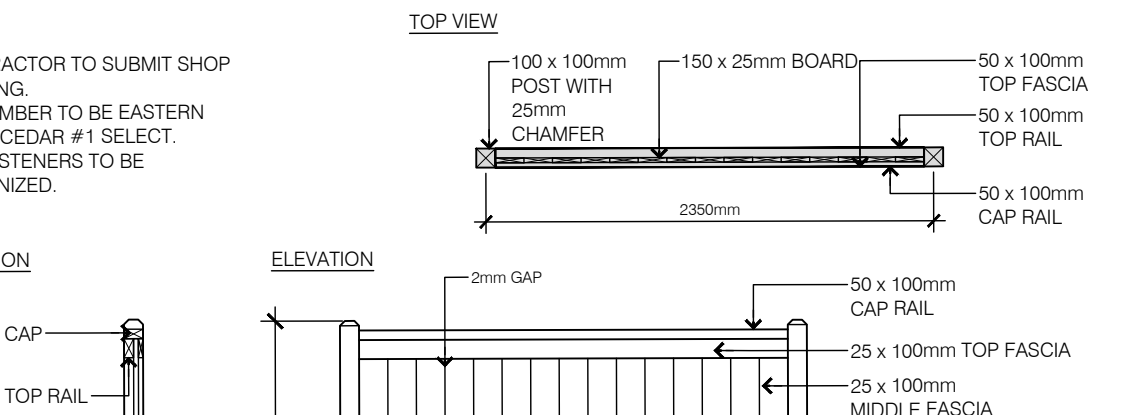

**10 1.8m HT WOOD FENCE MOUNTED ATOP CONCRETE WALL** 1:40



**2 LIGHT DUTY CONCRETE** 1:20

NO.	DATE	DESCRIPTION
3	2021/05/21	ISSUED FOR SPA RESUBMISSION
2	2021/03/03	ISSUED FOR SPA
1	2021/02/11	ISSUED FOR COORDINATION

**NO. DATE DESCRIPTION**

**SEAL:** [Professional Seal]

**NORTH:** [North Arrow]

**LASHLEY + ASSOCIATES**

LANDSCAPE ARCHITECTURE AND SITE ENGINEERING

202-891 GLADSTONE AVENUE OTTAWA, ON K1Y 3E8  
 T 613 233 8776  
 W LashleyA.com  
 E Mail@LashleyA.com

**CONSULTANT:**

**TAMARACK**  
 TAMARACKHOMES.COM

**PROJECT:**

**RESIDENTIAL APARTMENTS**  
 93 NORMAN STREET  
 OTTAWA, ONTARIO

**DRAWING TITLE:**

**LANDSCAPE PLAN**

**DATE:** 2021/05/21 **DRAWING NO.:**

**SCALE:** AS NOTED

**DRAWN BY:** RP/EL **L-01**

**LA PROJECT NO.:** 21790-1

D 07-12-19-0225