

**COPYRIGHT RESERVED**  
 THE CONTRACTOR SHALL VERIFY AND BE RESPONSIBLE OF ALL DIMENSIONS. DO NOT SCALE THE DRAWING - ANY ERRORS OR OMISSIONS SHALL BE REPORTED TO BLANCHARD LETENDRE ENGINEERING LTD. WITHOUT DELAY. THE COPYRIGHTS TO ALL DESIGNS AND DRAWINGS ARE THE PROPERTY OF BLANCHARD LETENDRE ENGINEERING LTD. REPRODUCTION OR USE FOR ANY PURPOSE OTHER THAN THAT AUTHORIZED BY BLANCHARD LETENDRE ENGINEERING LTD. IS STRICTLY PROHIBITED.

NOTE: ALL SANITARY PIPING TO BE BE 100MM DIAM. PVC @ 2.0% SLOPE  
 NOTE: EFFLUENT FILTER TO BE INSTALLED IN SEPTIC TANK AS PER SERVICING REPORT RECOMMENDATIONS.

PROPOSED AREA BED REFER TO SITE SERVICING REPORT AND SEPTIC PERMIT SCHEDULE 11  
 PROPOSED SEPTIC TANK BOUCHER PRECAST CONCRETE LTD OR EQUIV. 22,500L C/W POLYLOK PL122 OR EQUIV. EFFLUENT FILTER  
 1.2M Ø PRECAST CONCRETE PUMP CHAMBER. REFER TO SITE SERVICING REPORT.  
 100MM DIAM PVC SUMP PUMP LATERAL 5.5M @ MIN 2.0%  
 45° BEND

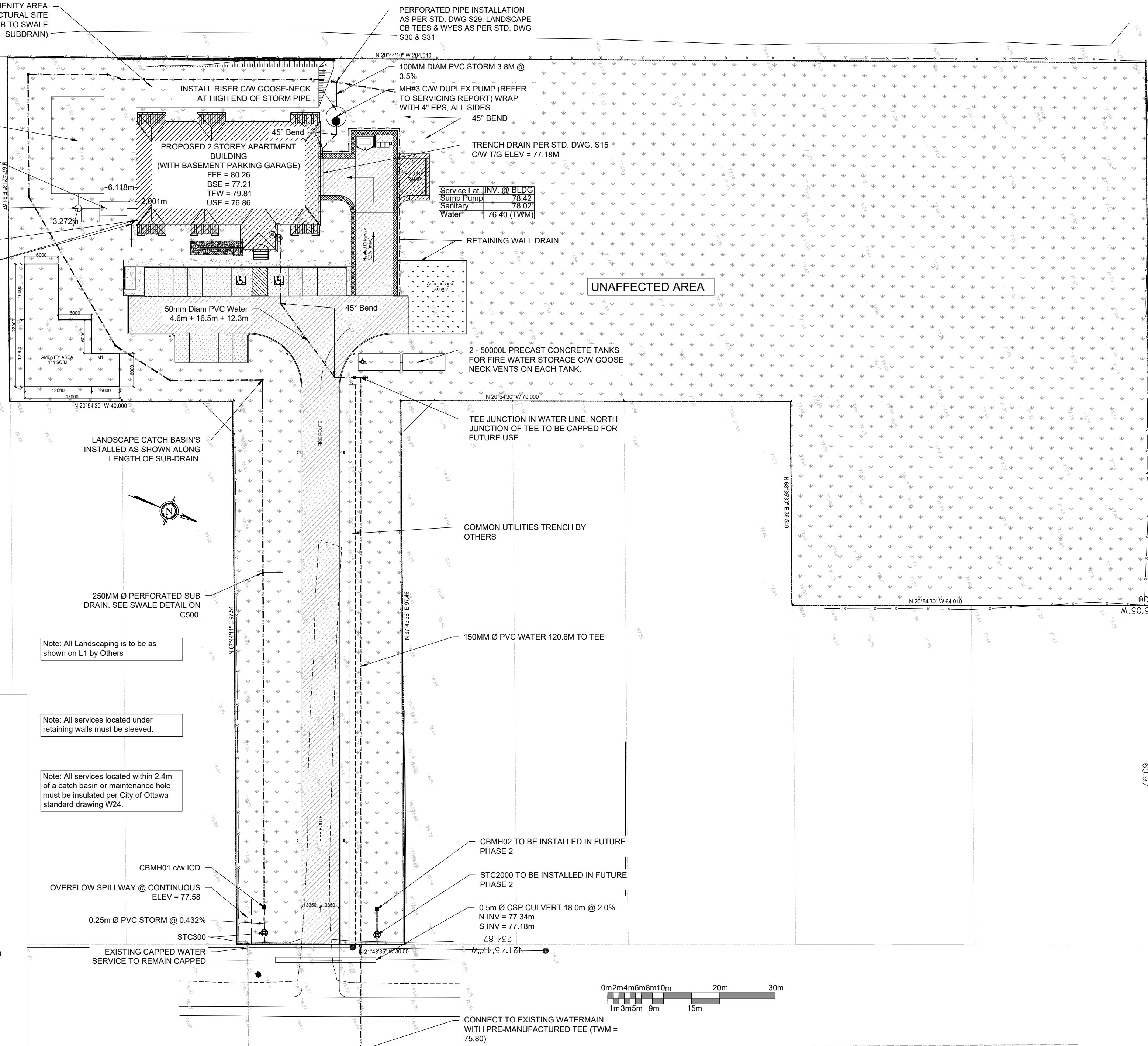

Service Lat. INV. @ BLDG	
Sump Pump	78.47
Sanitary	78.02
Water	76.40 (TWM)

**LEGEND:**

- EXISTING PROPERTY LINE TO REMAIN
- PROPOSED EASEMENT
- PROPOSED TERRACING (3:1 MIN.)
- PROPOSED DOOR ENTRANCE/EXIT
- PROPOSED ELEVATION
- PROPOSED HIGH POINT ELEVATION
- PROPOSED SWALE ELEVATION
- MATCH INTO EXISTING ELEVATION
- EXISTING ELEVATION
- PROPOSED OVERLAND MAJOR FLOW ROUTE
- PROPOSED SILT FENCE AS PER OPSD 219.110
- PROPOSED 100mm Ø PERFORATED SUBDRAIN
- PROPOSED STORM SEWER
- PROPOSED SANITARY SEWER
- PROPOSED WATERMAIN
- EXISTING SANITARY SEWER
- EXISTING WATERMAIN
- PROPOSED CATCHBASIN-MANHOLE/CATCHBASIN
- PROPOSED CURB STOP
- PROPOSED PIPE INSULATION
- PROPOSED 100 YEAR HIGH WATER LEVEL
- STORM WATERSHED EXTENT
- WATERSHED NAME
- RUNOFF COEFFICIENT
- AREA IN HECTARES
- PROPOSED GRASS AREA
- PROPOSED CONCRETE FEATURES/SLAB
- PROPOSED HEAVY DUTY ASPHALT
- PROPOSED LIGHT DUTY ASPHALT
- PROPOSED GRAVEL AREA
- PROPOSED RIP RAP AS PER OPSD 810.010
- PROPOSED WATER METER
- PROPOSED ACCESS GATE
- PROPOSED GROWING FIELD

Note: All Landscaping is to be as shown on L1 by Others

Note: All services located under retaining walls must be sleeved.

Note: All services located within 2.4m of a catch basin or maintenance hole must be insulated per City of Ottawa standard drawing W24.

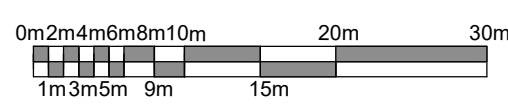

**ENGINEERING STAMP**

#5		
#4		
#3		
#2		
#1	ISSUED FOR CITY COMMENTS 6	26/03/2020
NO.	REVISION	DATE

**BLANCHARD LETENDRE ENGINEERING**  
 767, Notre Dame, Local 42, Embrun, Ontario,  
 (613) 693-0700 K0A 1W1 blengineering.co

**CLIENT:**  
**BERGERON CONSTRUCTION**  
 172 ST-THOMAS RD, VARS ON, K0A 3H0

**PROJECT:**  
**NEW 12-UNIT APARTMENT BUILDING**  
 5574 ROCKDALE RD, VARS ON, K0A 3H0

**DRAWING:**  
**SITE SERVICING PLAN**

PAPER FORMAT: 18x24  
 DRAWN BY: BF + GB  
 CHECKED BY: G.B.  
 DATE: 04-2020  
 SCALE: 1:750  
 PROJECT #: 19-276

**DRAWING #:**  
**C300**