

NOTES

- This drawing shall be read in conjunction with all relevant Architectural Engineering and related drawings and documents.
- Refer to Engineering Drawings for Grading. Provide drainage as indicated in grading plan. Round smoothly all tops and toes of slopes. Compact all areas to 95% Standard Proctor Density unless otherwise noted.
- Refer to Architectural Drawings for site layout.
- Refer to Engineering Drawings for site servicing. Contractor must contact utility companies for stake outs prior to excavation or planting.
- Plant material shall be No. 1 Grade and shall comply with Canadian Standards for Nursery Stock (latest edition) published by the Canadian Nursery Landscape Association. All trees and shrubs shall be container grown, potted, S/B or B/B. Bare root planting will only be acceptable for certain species and as approved by the Landscape Architect. Plant material substitutions shall not be permitted without the written approval from the consultant.
- Plant locations are schematic / approximate only. Contractor shall stake out locations on site for approval by the landscape architect prior to installation. Required plant material quantities shall be the number of plants indicated on the PLANTING PLAN. Any discrepancies between the number indicated on the PLANTING PLAN and the Quantity (QTY) indicated on the PLANT LIST shall be reported to the Landscape Architect.
- Shrubs shall be planted in a continuous prepared bed of 600mm depth approved planting soil mix covered with a Weed Control Fabric "Green Line" Landscape Fabric by Thrace-LINC and 75MM depth composted pine mulch to finish grade.
- Perennials, Ornamental Grasses, Vines and Groundcovers shall be planted in a continuous prepared bed of 600mm depth approved planting soil mix covered over with 75MM depth composted pine mulch to finish grade unless otherwise noted. DO NOT PLACE WEED CONTROL FABRIC IN PERENNIAL, ORNAMENTAL GRASS, VINE, OR GROUND COVER beds.
- Sod areas to receive 125MM depth topsoil mix as specified and shall be No. 1 Kentucky Bluegrass Sod grown from minimum mixture of 3 Kentucky Bluegrass cultivars. Quality and source shall comply with Canadian Standards for Nursery Stock, Section 17, (latest edition) published by the Canadian Nursery Landscape Nursery Landscape Association.
- Apply the following mineral fertilizer unless modified by results of soil tests. Sodded areas - (11-8-4) 11% Nitrogen, 8% Phosphorus, 4% Potash at a rate of 450kg/ha over 1,000 sq. ft. - Planting Beds - (7-7-7) - 7% Nitrogen, 7% Phosphorus, 7% Potash at a rate of 0.9kg/m² of planting soil.
- Reinstate all areas damaged or disturbed beyond the limit of Work.
- The contractor shall maintain the plant material according to accepted horticultural practice and shall warrant that as itemized on the plant list will remain free of defects for a minimum period of one (1) full year from completion acceptance and commencement of the warranty period. Throughout the warranty period, the Contractor, at his own expense, shall replace plant material of the same size and species as specified, if found dead, unhealthy, in an unsatisfactory growing condition or does not meet the requirements of the specifications as determined by the Landscape Architect. The Landscape Architect reserves the right to extend the Contractor's warranty for an additional one (1) year if, at the end of the warranty period, leaf development and growth is not sufficient to ensure future survival.
- Existing trees to be retained shall be protected according to the detail on this plan.
- Topsoil shall be high quality, Grade A, containing a maximum of 70% sandy loam and 10-15% organic matter and comply with the Canadian System of Soil Classification. p.H value should be 5.5 to 7.5, and it should not contain toxic or growth prohibiting elements. Soil shall be free of stones greater than 25mm dia., and coarse vegetative material shall not exceed more than 2% of the volume. Topsoil will be stockpiled and inspected on site by the landscape architect prior to installation. The landscape architect may require testing by a certified company that can recommend measures to improve soil quality.

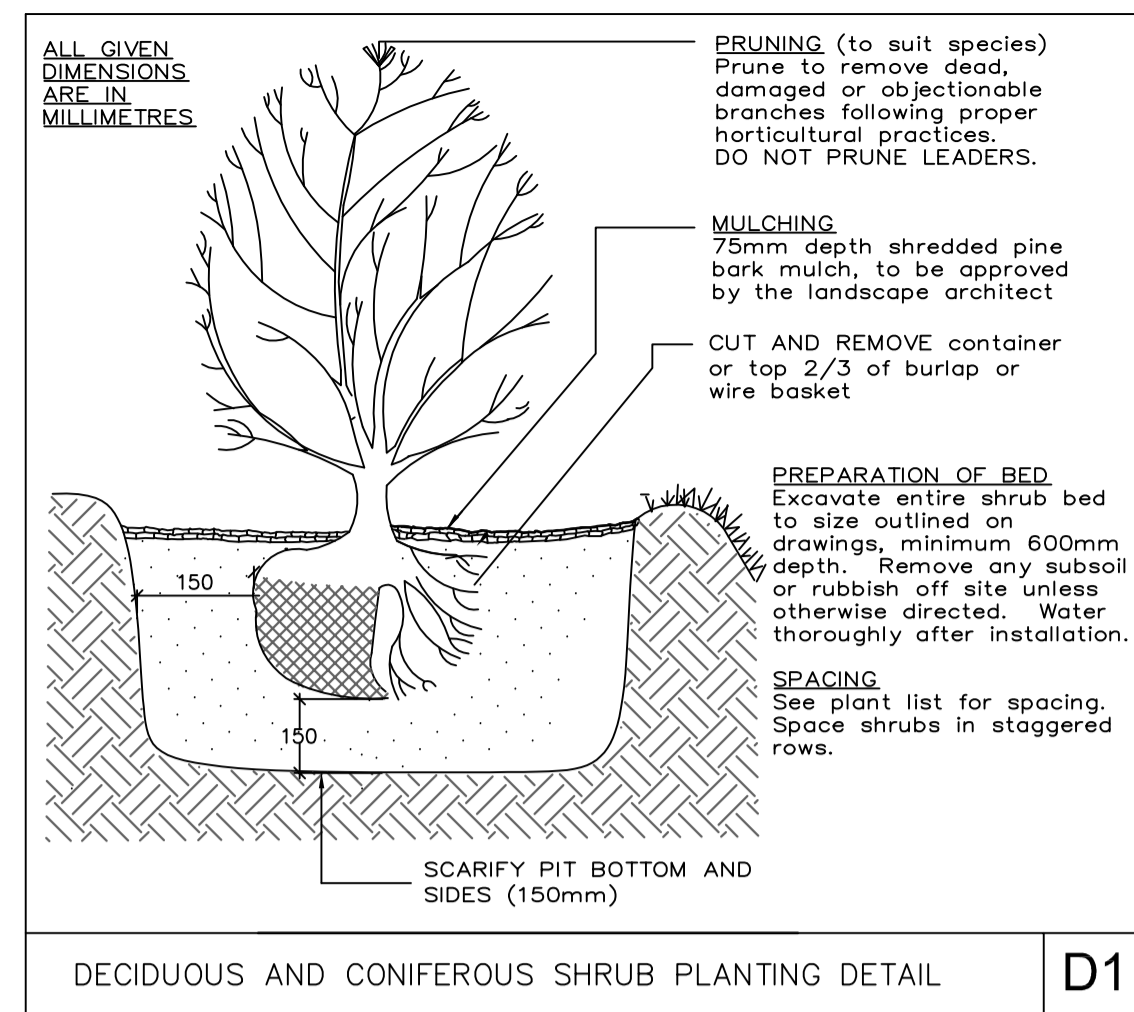

PLANT LIST - Apex Gardens, Hawthorne Industrial Park

KEY	No.	BOTANICAL NAME	COMMON NAME	SIZE	SPACING
CONIFEROUS SHRUBS					
jsb	19	JUNIPERUS SABINA 'BUFFALO'	BUFFALO JUNIPER	2g	100 cm O.C.
pmp	27	PINUS MUGO VAR. 'PUMILIO'	MUGHO PINE	3g	100 cm O.C.
DECIDUOUS SHRUBS					
auv	7	ARCTOSTAPHALOS UVA-URSI	BEARBERRY	3g	90 cm O.C.
pfa	12	POTENTILLA FRUTICOSA 'ABBOTSWOOD'	ABBOTSWOOD POTENTILLA (WHITE)	2g	60 cm O.C.
PERENNIALS					
Hgs	60	HEMEROCALLIS 'GENTLE SHEPHERD'	GENTLE SHEPHERD DAYLILY	1g	30 cm O.C.
Hso	73	HEMEROCALLIS 'STELLA D'ORO'	STELLA D'ORO DAYLILY	1g	30 cm O.C.
Ht	35	HEMEROCALLIS 'TIGGER'	TIGGER DAYLILY	1g	30 cm O.C.

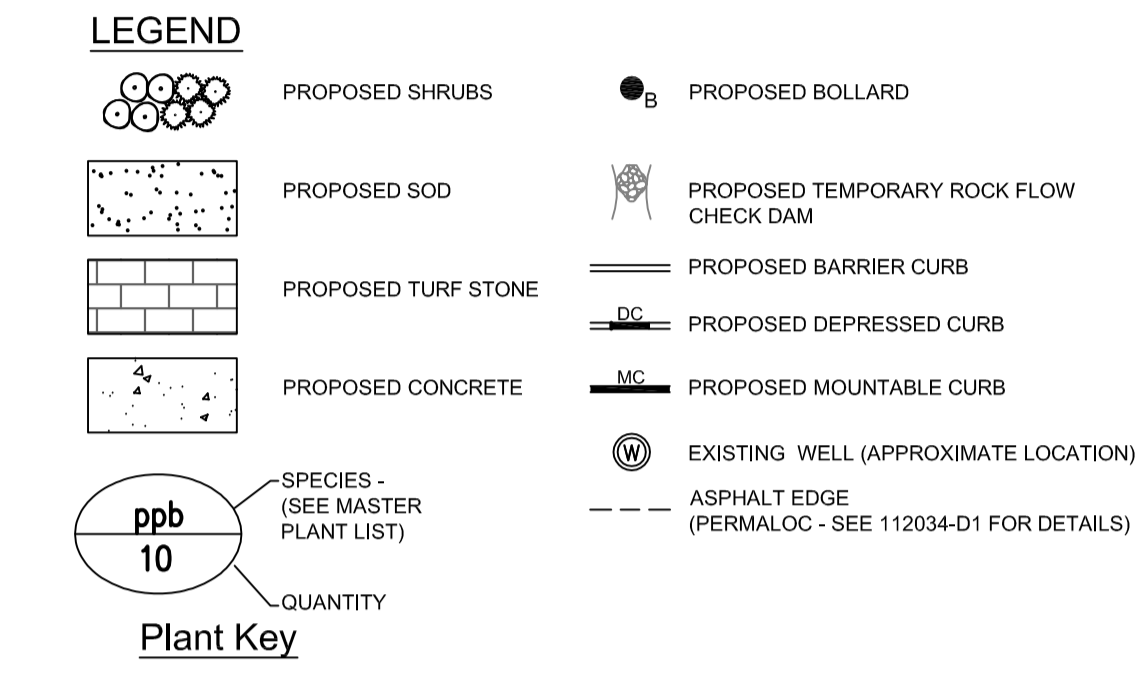
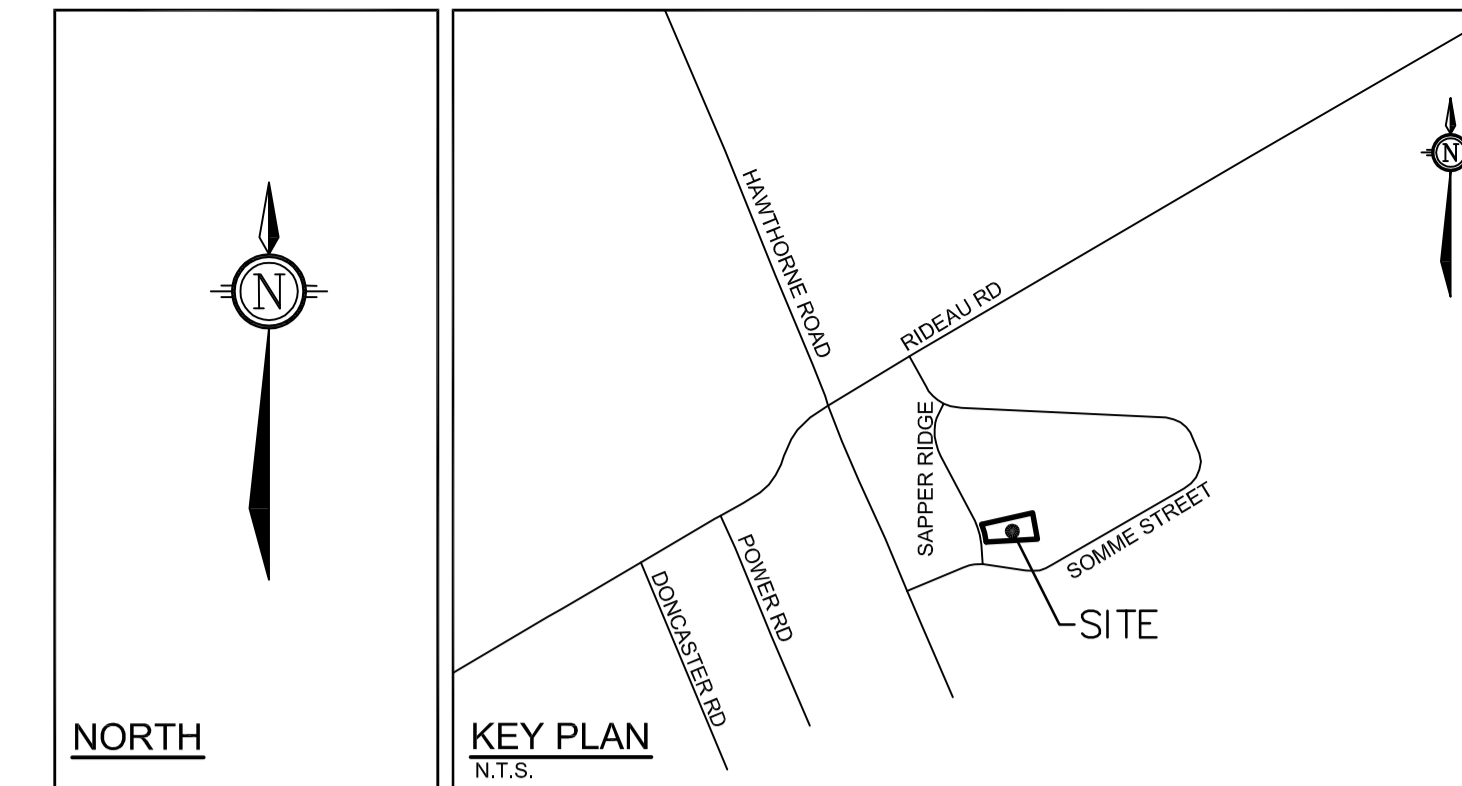

NOTE:
THE POSITION OF ALL POLE LINES, CONDUITS, WATERMANS, SEWERS AND OTHER UNDERGROUND AND OVERGROUND UTILITIES AND STRUCTURES IS NOT NECESSARILY SHOWN ON THE CONTRACT DRAWINGS, AND WHERE SHOWN, THE ACCURACY OF THE POSITION OF SUCH UTILITIES AND STRUCTURES IS NOT GUARANTEED. BEFORE STARTING WORK, DETERMINE THE EXACT LOCATION OF ALL SUCH UTILITIES AND STRUCTURES AND ASSUME ALL LIABILITY FOR DAMAGE TO THEM.

REFER TO DETAIL PLAN 112034-D1 FOR STANDARD DETAILS

No.	REVISION	DATE	BY
1.	ISSUED FOR SITE PLAN APPROVAL	FEB 10/14	JF

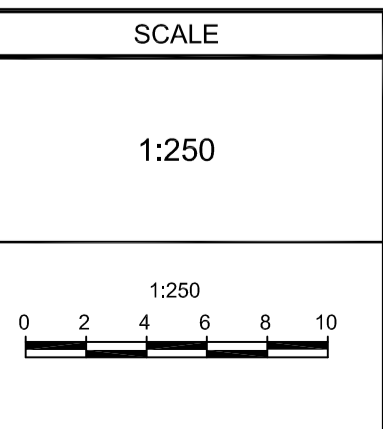

DESIGN: JF

CHECKED: SMG

DRAWN: DJC

CHECKED: LAB

APPROVED: JF

FOR REVIEW ONLY

ASSOCIATION OF LANDSCAPE ARCHITECTS OF ONTARIO

MEMBER

NOVATECH

ENGINEERING CONSULTANTS LTD.

ENGINEERS & PLANNERS

Suite 200, 240 Michael Cowpland Drive
Ottawa, Ontario, Canada
K2M 1P6

Telephone: (613) 254-9643
Facsimile: (613) 254-5967
Email: novainfo@novatech-eng.com

CITY OF OTTAWA
35 SAPPERS RIDGE
APEX SOUTH BUSINESS CENTRE

LANDSCAPE PLAN

PROJECT NO.: 112034B-1

REV: REV #1

DRAWING NO.: 112034-L

M:\2011\112034\CAD\landscape\SP\112034-L.dwg, L. Feb 10, 2014, 3:14pm, mmshouph