

LEGEND

	PROPOSED TEMPORARY ROCK FLOW CHECK DAM
	PROPOSED STRAW BALE BARRIER
	SILT FENCE
	MUD MAT LOCATION
	□ DITCH AND DIRECTION OF FLOW
	ASPHALT EDGE (PERMALOC - SEE 112034-D1 FOR DETAILS)
	EXISTING WELL (APPROXIMATE LOCATION)

- EROSION AND SEDIMENT CONTROL NOTES:**
- THE OWNER AGREES TO PREPARE AND IMPLEMENT AN EROSION AND SEDIMENT CONTROL PLAN TO THE SATISFACTION OF THE CITY OF OTTAWA, APPROPRIATE TO THE SITE CONDITIONS, PRIOR TO UNDERTAKING ANY SITE ALTERATIONS (FILLING, GRADING, REMOVAL OF VEGETATION, ETC.) AND DURING ALL PHASES OF SITE PREPARATION AND CONSTRUCTION IN ACCORDANCE WITH THE CURRENT BEST MANAGEMENT PRACTICES FOR EROSION AND SEDIMENT CONTROL, SUCH AS BUT NOT LIMITED TO MAINTAIN A LIGHT DUTY SILT FENCE BARRIER AS REQUIRED.
 - SILT FENCING FOR ENTIRE PERIMETER OF SITE, SHALL BE UTILIZED TO CONTROL EROSION FROM THE SITE DURING CONSTRUCTION.
 - SPECIFICATIONS:
ITEM: STRAW BALES, LIGHT-DUTY SILT FENCE, ROCK FLOW CHECK DAM
SPEC. No.: 219.100, 219.110, 219.211
REFERENCE: OPSD, OPSD, OPSD
 - MUD MATS ARE TO BE INSTALLED AND MAINTAINED AT CONSTRUCTION ACCESS POINTS TO MINIMIZE SEDIMENT TRANSFER TO EXISTING ROADWAYS.
 - ALL STREETS TO BE SWEEPED REGULARLY UNTIL THE SITE IS PAVED AND IS TO CONTINUE FOR THE DURATION OF CONSTRUCTION AS REQUIRED OR AS DIRECTED BY THE ENGINEER OR CITY OF OTTAWA.
 - NO CONTROL MEASURE SHALL BE PERMANENTLY REMOVED WITHOUT PRIOR AUTHORIZATION FROM THE ENGINEER.
 - THE CONTRACTOR ACKNOWLEDGES THAT FAILURE TO IMPLEMENT EROSION AND SEDIMENT CONTROL MEASURES MAY BE SUBJECT TO PENALTIES IMPOSED BY ANY APPLICABLE REGULATORY AGENCY.

Erosion and Sediment Control Responsibilities:

ESC Measure	Symbol	OPSD No.	During Construction		After Construction Prior to Final Acceptance		After Final Acceptance
			Installation Responsibility	Inspection Responsibility	Inspection/Maintenance Responsibility	Removal Responsibility	Inspection/Maintenance Responsibility
Rock Flow Check Dam		219.211	Developer's Contractor	Developer's Contractor	Developer	Developer's Contractor	N/A
Light-Duty Silt Fence Barrier		219.110	Developer's Contractor	Developer's Contractor	N/A	Developer's Contractor	N/A
Light-Duty Straw Bale Barrier		219.100	Developer's Contractor	Developer's Contractor	N/A	Developer's Contractor	N/A
Mud Mat		see detail	Developer's Contractor	Developer's Contractor	N/A	Developer's Contractor	N/A
Roof Leaders Directed to Grassed Areas	N/A	N/A	Builder	Builder	Condo Association	N/A	Condo Association
Ditches (Grading and Vegetation)	N/A	N/A	Developer's Contractor	Developer's Contractor	Municipality/Developer - Inspection Developer - Repairs Condo Association - Grass Cutting	N/A	Condo Association

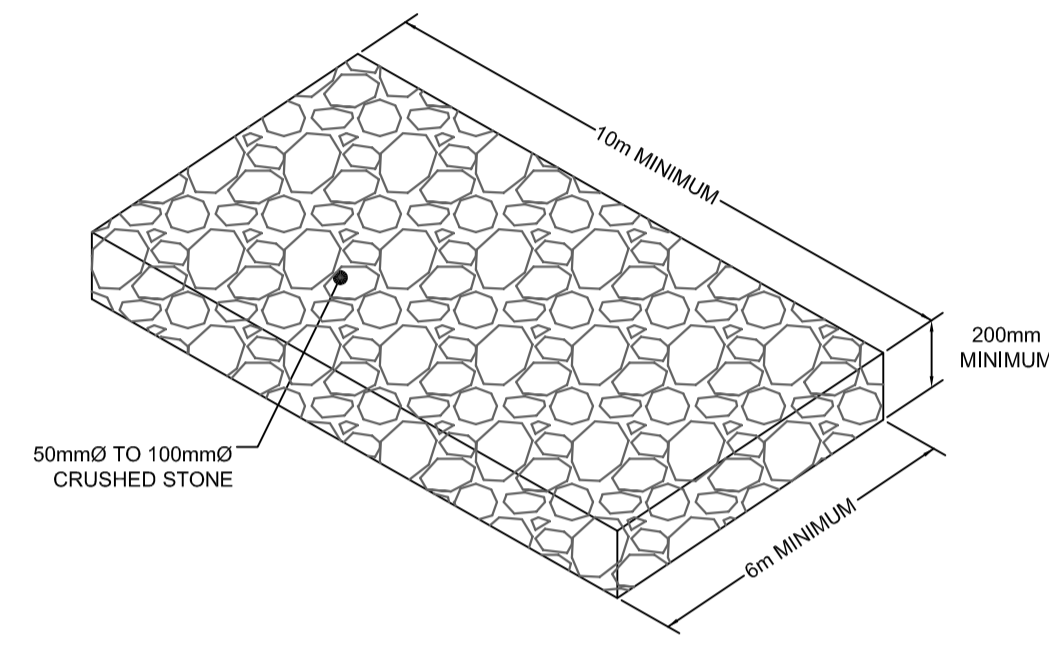
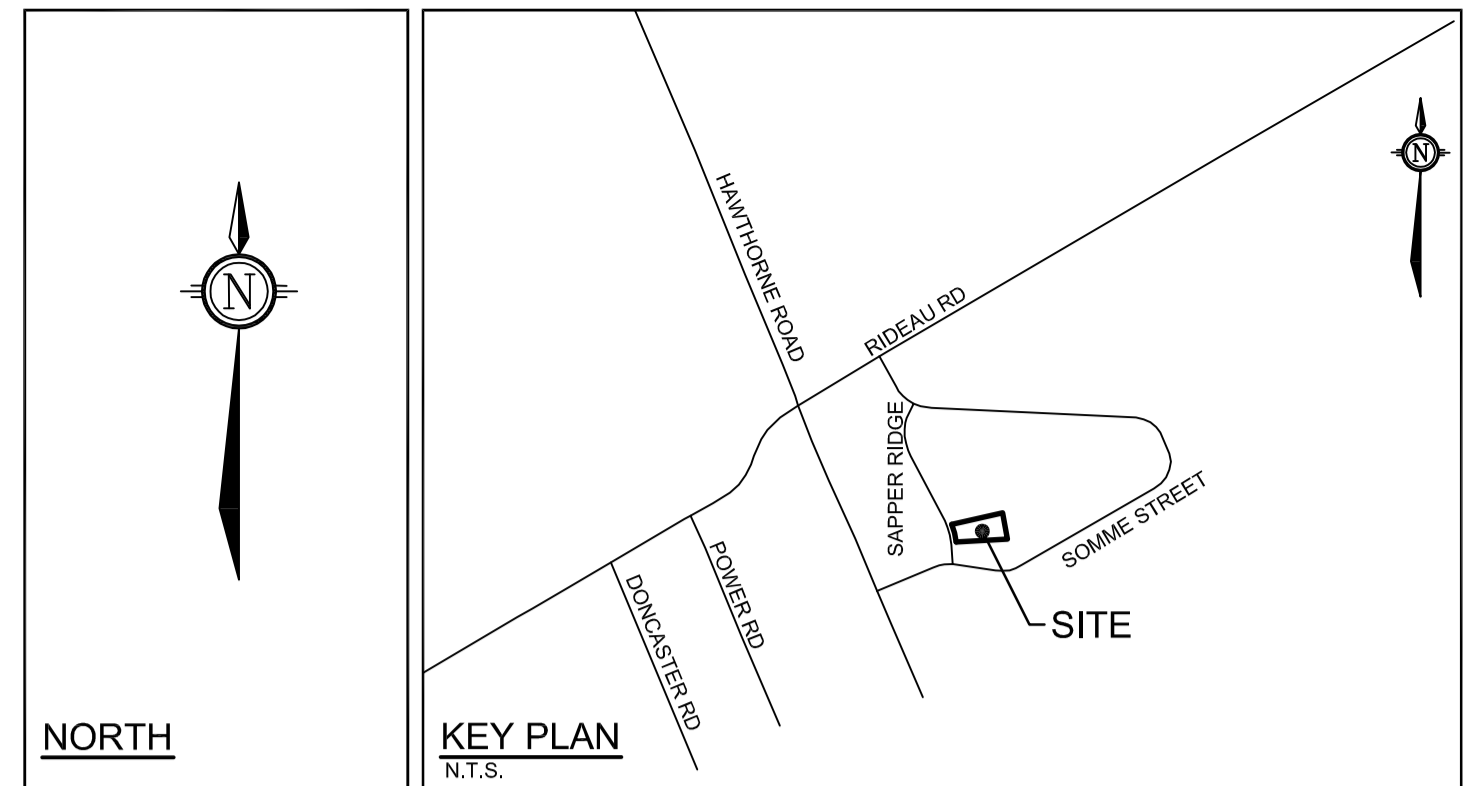

MUD MAT DETAIL
NOT TO SCALE

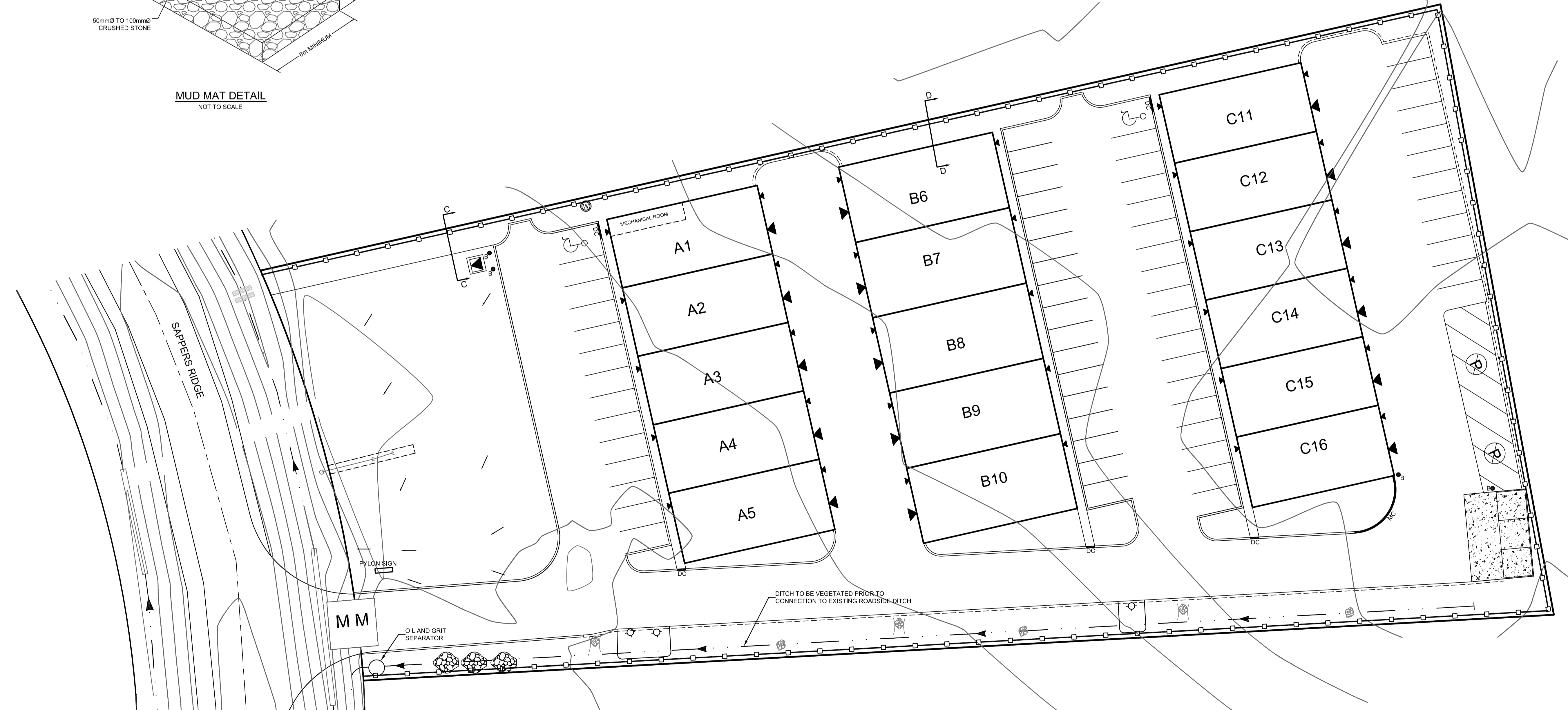

NOTE:
THE POSITION OF ALL POLE LINES, CONDUITS, WATERMANS, SEWERS AND OTHER UNDERGROUND AND OVERGROUND UTILITIES AND STRUCTURES IS NOT NECESSARILY SHOWN ON THE CONTRACT DRAWINGS, AND WHERE SHOWN, THE ACCURACY OF THE POSITION OF SUCH UTILITIES AND STRUCTURES IS NOT GUARANTEED. BEFORE STARTING WORK, DETERMINE THE EXACT LOCATION OF ALL SUCH UTILITIES AND STRUCTURES AND ASSUME ALL LIABILITY FOR DAMAGE TO THEM.

No.	REVISION	DATE	BY
1.	ISSUED FOR SITE PLAN APPROVAL	FEB 10/14	LAB

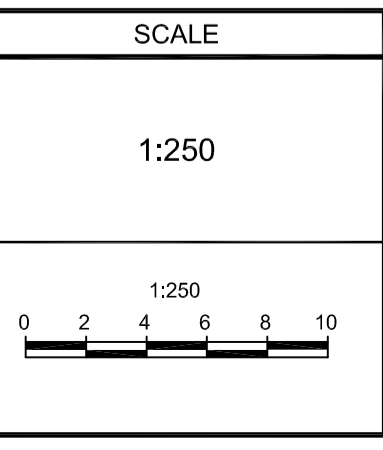

DESIGN	LAB
CHECKED	SMG
DRAWN	MTM
CHECKED	LAB
APPROVED	SMG

FOR REVIEW ONLY

NOVATECH
ENGINEERING CONSULTANTS LTD.
ENGINEERS & PLANNERS
Suite 200, 240 Michael Cowpland Drive
Ottawa, Ontario, Canada
K2M 1P6
Telephone: (613) 254-9643
Facsimile: (613) 254-5867
Email: novatech@novatech-eng.com

CITY OF OTTAWA
35 SAPPERS RIDGE - APEX SOUTH BUSINESS CENTRE

EROSION AND SEDIMENT CONTROL PLAN

PROJECT NO.: 112034B-1
REV: REV #1
DRAWING NO.: 112034-ESC

M:\2011\12034\CAD\Design\112034-ESC.dwg, ESC, Feb. 10, 2014 - 12:54pm, mmckeeough