

Landscape Enlargement Plan

Scale - 1:400

MITCH OWENS ROAD

NOTE: ACCESS TO SITE TO BE DETERMINED IN CONJUNCTION WITH FUTURE ROAD WORK DESIGN BY OTHERS

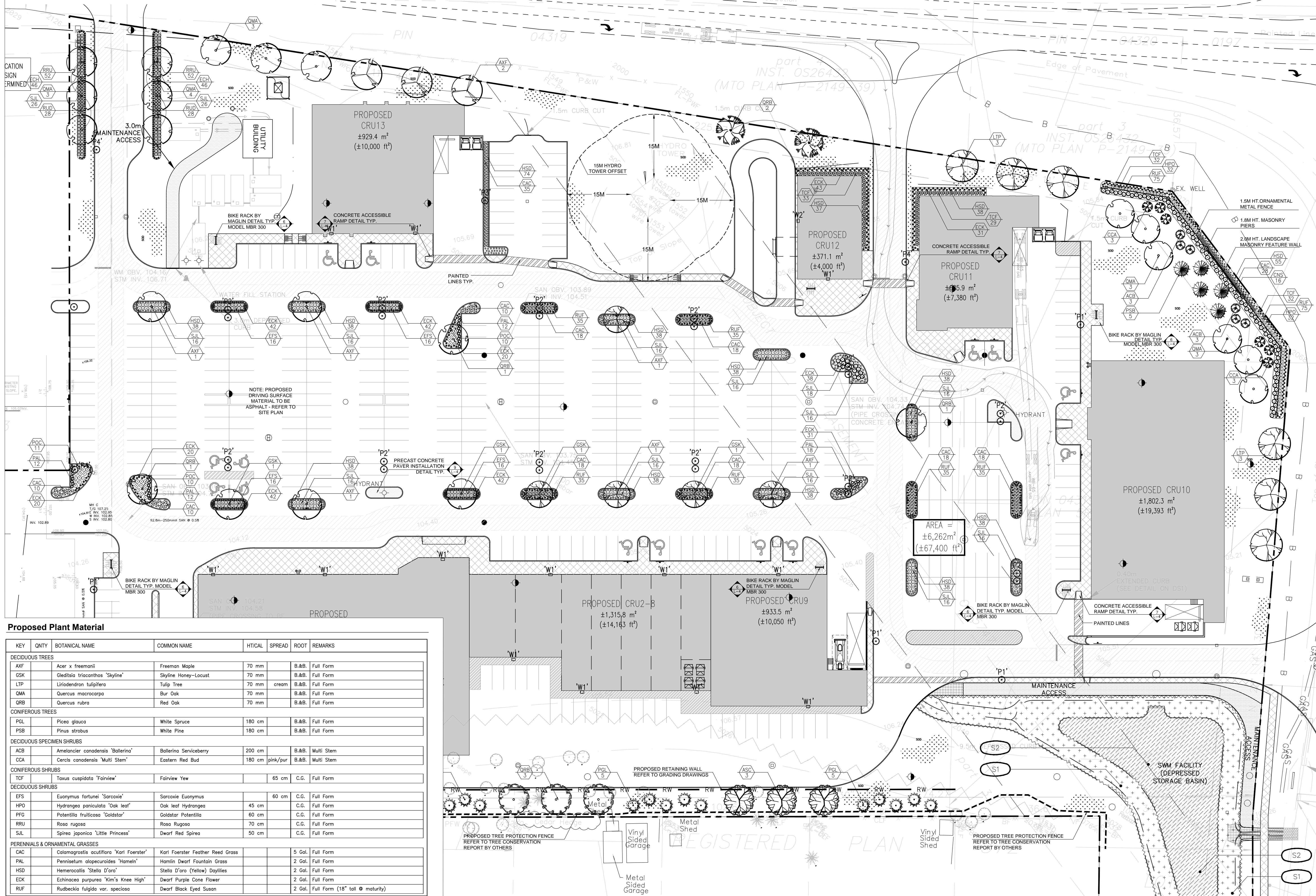

Legend

- Proposed Deciduous Tree
- Proposed Coniferous Tree
- Proposed Shrub/Perennial
- Existing Deciduous Tree
- Existing Coniferous Tree
- Proposed Sodded Area
- Proposed Precast Concrete Unit Pavers
- Proposed Light Standard
- Proposed Bike Rack
- Property Line
- 1.8M Ht. Ornamental Metal Fence
- 1.8M Ht. Masonry Piers
- Proposed Plant Material
- Detail Reference Key

No.	Revision	Date
9	Issued for Resubmission	10/20/15
8	Revised per Comments	07/08/14
7	Revised per Grading Plan	05/28/14
6	Revised per Comments	04/30/14
5	Revised per Grading Plan	01/30/14
4	Revised per Site Plan	01/06/14
3	Issued for Coordination	09/30/13
2	Issued for Coordination	12/12/11
1	Issued for Coordination	10/12/11

North:

Stamp:

Project: **Proposed Commercial Development**
Bank Street & Mitch Owens Road
Greely, Ontario

Scale: 1:400 Date: Dec. 2011

Drawn By: J.C. Checked By: L.M.

Drawing Title: **Landscape Enlargement Plan**

Project No. 11212 Sheet No. L2 of 4

Proposed Plant Material

KEY	QNTY	BOTANICAL NAME	COMMON NAME	HT/CAL	SPREAD	ROOT	REMARKS
DECIDUOUS TREES							
AXF		Acer x freemanii	Freeman Maple	70 mm		B.&B.	Full Form
GSK		Gleditsia triacanthos 'Skyline'	Skyline Honey-Locust	70 mm		B.&B.	Full Form
LTP		Liriodendron tulipifera	Tulip Tree	70 mm	cream	B.&B.	Full Form
QMA		Quercus macrocarpa	Bur Oak	70 mm		B.&B.	Full Form
QRB		Quercus rubra	Red Oak	70 mm		B.&B.	Full Form
CONIFEROUS TREES							
PGL		Picea glauca	White Spruce	180 cm		B.&B.	Full Form
PSB		Pinus strobus	White Pine	180 cm		B.&B.	Full Form
DECIDUOUS SPECIMEN SHRUBS							
ACB		Amelanchier canadensis 'Ballerina'	Ballerina Serviceberry	200 cm		B.&B.	Multi Stem
CCA		Cercis canadensis 'Multi Stem'	Eastern Red Bud	180 cm	pink/pur	B.&B.	Multi Stem
CONIFEROUS SHRUBS							
TCF		Taxus cuspidata 'Fairview'	Fairview Yew	65 cm		C.G.	Full Form
DECIDUOUS SHRUBS							
EFS		Euonymus fortunei 'Sarcocoe'	Sarcocoe Euonymus	60 cm		C.G.	Full Form
HPO		Hydrangea paniculata 'Oak leaf'	Oak leaf Hydrangea	45 cm		C.G.	Full Form
PFG		Potentilla fruticosa 'Goldstar'	Goldstar Potentilla	60 cm		C.G.	Full Form
RRU		Rosa rugosa	Rosa Rugosa	70 cm		C.G.	Full Form
SJL		Spiraea japonica 'Little Princess'	Dwarf Red Spirea	50 cm		C.G.	Full Form
PERENNIALS & ORNAMENTAL GRASSES							
CAC		Calamagrostis acutiflora 'Karl Foerster'	Karl Foerster Feather Reed Grass		5 Gal.	Full Form	
PAL		Pennisetum alopecuroides 'Hameln'	Hameln Dwarf Fountain Grass		2 Gal.	Full Form	
HSD		Hemerocallis 'Stella D'oro'	Stella D'oro (Yellow) Daylilies		2 Gal.	Full Form	
ECK		Echinacea purpurea 'Kim's Knee High'	Dwarf Purple Cone Flower		2 Gal.	Full Form	
RUF		Rudbeckia fulgida var. speciosa	Dwarf Black Eyed Susan		2 Gal.	Full Form (18" tall @ maturity)	

All information contained in these plans shall be checked by the contractor. All discrepancies shall be reported to the Landscape Architect (L.A.) before commencing with construction. All drawings have copyright and shall remain the property of the Landscape Architect. Copying or any reproduction in part or whole shall only be permitted with written consent of L.A. Drawings shall not be used for construction unless sealed & SIGNED. All drawings shall be checked by the contractor. All discrepancies shall be reported to the Landscape Architect (L.A.) before commencing with construction. All drawings have copyright and shall remain the property of the Landscape Architect. Copying or any reproduction in part or whole shall only be permitted with written consent of L.A. Drawings shall not be used for construction unless sealed & SIGNED.