

**GENERAL NOTES**

1. ALL MEASUREMENTS ARE IN METRES EXCEPT PIPE SIZES ARE IN MILLIMETRES, UNLESS OTHERWISE NOTED.
2. THE DESIGN BY URBAN ECOSYSTEMS LIMITED IS RESTRICTED TO SITE GRADING, STORM SEWERS, SANITARY SEWERS AND WATER DISTRIBUTION SYSTEMS, INCLUDING APPURTENANCES, PLUMBING, DRAINS AND WATER SYSTEMS WITHIN THE BUILDING STRUCTURES ARE SPECIFICALLY EXCLUDED FROM THE DESIGN BY URBAN ECOSYSTEMS LIMITED. FOR THOSE WORKS, THE CONTRACTOR SHALL REFER TO ARCHITECTURAL AND MECHANICAL DESIGN DRAWINGS.
3. THE LOCATION AND DIMENSIONS OF PROPOSED BUILDINGS, PARKING LOTS AND LANDSCAPE AREAS HAVE BEEN OBTAINED FROM THE SITE PLANS PREPARED BY PETROFF PARTNERSHIP ARCHITECTS. FOR DIMENSIONS AND OTHER DETAILS, THE CONTRACTOR SHALL REFER TO THE ARCHITECT'S SITE PLANS).
4. ALL EXISTING TOPOGRAPHICAL INFORMATION HAS BEEN OBTAINED FROM A SURVEY BY ANNIS, O'SULLIVAN, VOLLEBEK LTD., O.L.S.
5. ALL CONSTRUCTION WORK, INCLUDING TRENCHING, SHALL BE DONE IN STRICT ACCORDANCE WITH THE ONTARIO OCCUPATIONAL HEALTH AND SAFETY ACT.
6. FOR DETAILS AND DIMENSIONS, THE CONTRACTOR SHALL REFER TO STANDARD DRAWINGS APPROVED BY THE CITY OF OTTAWA. FOR WORK NOT SPECIFICALLY COVERED BY APPROVED CITY SPECIFICATIONS, CPSP STANDARDS SHALL APPLY.
7. THE CONTRACTOR SHALL THOROUGHLY EXAMINE THE SITE AND SATISFY HIMSELF OF THE ACTUAL CONDITIONS TO BE ENCOUNTERED AND THE REQUIREMENTS OF THE WORK.
8. THE CONTRACTOR SHALL VERIFY ALL DIMENSIONS AND NOTIFY THE ENGINEER OF ANY DISCREPANCIES OR OMISSIONS ON THE DRAWINGS.
9. ALL TRAFFIC CONTROL AND SIGNAGE SHALL BE IN ACCORDANCE WITH THE MTO TRAFFIC CONTROL MANUAL.
10. THE CONTRACTOR SHALL PROVIDE THE ENGINEER WITH A DETAILED CONSTRUCTION SCHEDULE 48 HOURS PRIOR TO COMMENCING ANY WORK.
11. THE CONTRACTOR SHALL NOTIFY THE ENGINEER AND THE CITY OF OTTAWA 48 HOURS PRIOR TO COMMENCING ANY WORK WITHIN A MUNICIPAL ROAD ALLOWANCE.
12. THE CONTRACTOR SHALL BE RESPONSIBLE TO LOCATE, PROTECT AND SUPPORT, AS NECESSARY, ALL EXISTING UTILITIES AND MUNICIPAL SERVICES.
13. ANY TRENCH OR EXCAVATION WITHIN THE TRAVELED PORTION OF A ROAD ALLOWANCE SHALL BE BACKFILLED WITH UNSHINKABLE FILL, UNLESS OTHERWISE NOTED.
14. ALL AREAS WITHIN AN EXISTING ROAD ALLOWANCE, DISTURBED BY CONSTRUCTION, SHALL BE RESTORED TO THEIR ORIGINAL CONDITION TO THE SATISFACTION OF THE ENGINEER AND THE CITY OF OTTAWA.
15. ALL EXISTING MANHOLES, CATCHBASINS, VALVE CHAMBERS, HYDRANTS, VALVES, ETC. ARE TO BE ADJUSTED TO FINAL GRADES TO THE SATISFACTION OF THE ENGINEER.
16. WHEREVER PIPES, MANHOLES, CATCHBASINS, VALVE CHAMBERS OR APPURTENANCES ARE CONSTRUCTED IN FILL AREAS OR IN DISTURBED GROUND, THE TRENCH SHALL BE EXCAVATED TO UNDISTURBED GROUND AND BACKFILLED WITH GRANULAR "A" OR OTHER SUITABLE MATERIAL, APPROVED BY THE GEOTECHNICAL ENGINEER, AND COMPACTED TO 100 STANDARD PROCTOR DENSITY.
17. PRIOR TO COMMENCING ANY WORK, ALL EROSION AND SEDIMENT CONTROL FEATURES SHALL BE IN PLACE.
18. ALL WORK SHALL COMPLY WITH STANDARD DRAWINGS AND SPECIFICATIONS OF THE CITY OF OTTAWA AND THE ONTARIO PROVINCIAL STANDARDS AND SPECIFICATIONS.
19. ROAD OCCUPANCY OR ACCESS PERMITS MUST BE OBTAINED 48 HOURS PRIOR TO COMMENCING ANY WORKS WITHIN A MUNICIPAL ROAD ALLOWANCE.
20. DUE TO STORM WATER MANAGEMENT CONTROL, FOUNDATION DRAINS SHALL NOT BE CONNECTED TO THE STORM SEWERS ON THIS SITE.
21. UNLESS OTHERWISE NOTED, ALL BUILDINGS SHALL BE EQUIPPED WITH ROOF CONTROL DRAINS. REFER TO DRAWING 2 OF 8 FOR NUMBER AND MODEL OF CONTROL DRAINS REQUIRED FOR EACH BUILDING.
22. SERVICE CONNECTIONS TO BUILDINGS SHALL TERMINATE 1.0 METRES FROM THE OUTSIDE BUILDING FACE, UNLESS OTHERWISE NOTED.
23. ALL BUILDING SERVICE CONNECTIONS SHALL BE CAPPED AND MARKED WITH A "4X4" PAINTED GREEN (SANITARY), YELLOW (STORM) AND BLUE (WATER). THE "4X4" SHALL EXTEND 0.6 METRES ABOVE GRADE.

**SANITARY SEWERS AND APPURTENANCES**

1. ALL SANITARY SEWER WORKS SHALL BE CONSTRUCTED IN ACCORDANCE WITH APPROVED CITY OF OTTAWA AND ONTARIO PROVINCIAL STANDARD DRAWINGS AND SPECIFICATIONS.
2. ALL SANITARY SEWERS, MANHOLES AND APPURTENANCES SHALL CONFORM TO THE CITY OF OTTAWA "SEWER MATERIAL SPECIFICATIONS".
3. ALL SANITARY SEWERS SHALL BE PVC SDR 35, MEETING CSA 182.2-02. FITTINGS FOR PVC SANITARY SEWER PIPE SHALL BE MANUFACTURED IN ACCORDANCE WITH A.S.T.M. SPECIFICATION D 03034. JOINTS SHALL BE BELL AND SPIGOT WITH RUBBER GASKETS.
4. BEDDING FOR SANITARY SEWERS SHALL BE CLASS "B" OR AS SPECIFIED BY THE GEOTECHNICAL ENGINEER.
5. WHERE SANITARY SEWERS CROSS OTHER UTILITIES, THE MINIMUM CLEARANCE BETWEEN OUTSIDE OF PIPE WALLS SHALL BE 0.3 METRES, UNLESS OTHERWISE NOTED.
6. "MODULOC", OR OTHER APPROVED PRE-CAST MANHOLE ADJUSTING UNITS, SHALL BE USED, PARGED ON THE OUTSIDE ONLY.
7. THE CONTRACTOR SHALL CCTV CAMERA INSPECT ALL SANITARY SEWERS PRIOR TO ASPHALT PLACEMENT AND AGAIN PRIOR TO EXPIRATION OF THE MAINTENANCE PERIOD. ALL SEWERS SHALL BE FLUSHED PRIOR TO CAMERA INSPECTION.
8. ALL SANITARY MANHOLES SHALL BE BENCH TO THE CROWN OF ALL PIPES ON A VERTICAL PROJECTION FROM SPRINGLINE, UNLESS OTHERWISE NOTED.

**STORM SEWERS AND APPURTENANCES**

1. ALL STORM SEWER WORKS SHALL BE CONSTRUCTED IN ACCORDANCE WITH APPROVED CITY OF OTTAWA AND ONTARIO PROVINCIAL STANDARD DRAWINGS AND SPECIFICATIONS.
2. ALL STORM SEWERS, MANHOLES, CATCHBASINS, CATCHBASIN MANHOLES AND APPURTENANCES SHALL CONFORM TO THE CITY OF OTTAWA "SEWER MATERIAL SPECIFICATIONS".
3. ALL STORM SEWERS, 450 mm DIAMETER AND SMALLER, SHALL BE PVC SDR 35, MEETING CSA 182.2-02. FITTINGS FOR PVC STORM SEWER PIPE SHALL BE MANUFACTURED IN ACCORDANCE WITH A.S.T.M. SPECIFICATION D 03034. JOINTS SHALL BE BELL AND SPIGOT WITH RUBBER GASKETS.
4. BEDDING FOR STORM SEWERS SHALL BE CLASS "B" OR AS SPECIFIED BY THE GEOTECHNICAL ENGINEER.
5. ALL CATCHBASIN LEADS SHALL BE 250 mm DIAMETER, UNLESS OTHERWISE NOTED.
6. WHERE STORM SEWERS CROSS OTHER UTILITIES, THE MINIMUM CLEARANCE BETWEEN OUTSIDE OF PIPE WALLS SHALL BE 0.3 METRES.
7. "MODULOC", OR OTHER APPROVED PRE-CAST MANHOLE AND CATCHBASIN ADJUSTING UNITS, SHALL BE USED, PARGED ON THE OUTSIDE ONLY.
8. THE CONTRACTOR SHALL CCTV CAMERA INSPECT ALL STORM SEWERS PRIOR TO ASPHALT PLACEMENT AND AGAIN PRIOR TO EXPIRATION OF THE MAINTENANCE PERIOD. ALL SEWERS SHALL BE FLUSHED PRIOR TO CAMERA INSPECTION.
9. ALL STORM MANHOLES SHALL BE BENCH TO THE CROWN OF ALL PIPES ON A VERTICAL PROJECTION FROM SPRINGLINE, UNLESS OTHERWISE NOTED.
10. ALL CATCHBASINS AND CATCHBASIN MANHOLES SHALL BE ENCRICLED WITH A 100mm DIAMETER PERFORATED SUBDRAIN COMPLETE WITH FILTER SOCK AND STONE SURROUND AS SHOWN ON DRAWING 5 OF 5.

**SURFACE WORKS**

1. ALL CONCRETE CURBS SHALL CONFORM TO THE CITY OF OTTAWA STANDARD DRAWINGS SC 1.1 AND SC 1.4 AS APPLICABLE.
2. ALL SIDEWALKS SHALL CONFORM TO THE CITY OF OTTAWA STANDARD DRAWINGS SC 4 AND SC 5. ALL SITE ENTRANCES SHALL CONFORM TO CITY OF OTTAWA STANDARD DRAWINGS SC 7.1.
3. ALL ASPHALT PAVEMENTS SHALL BE CONSTRUCTED AS SHOWN ON THE ARCHITECT'S SITE PLANS) AND AS SPECIFIED BY THE GEOTECHNICAL ENGINEER.

MATERIAL	LIGHT DUTY	LIGHT DUTY
HL3	50 mm	40 mm
HL8	—	50 mm
GRAN A.	150 mm	150 mm
GRAN B.	400 mm	450 mm

4. ALL LANDSCAPED AREA SHALL BE GRADED AND CONSTRUCTED AS SPECIFIED ON THE LANDSCAPE ARCHITECTS DRAWINGS AND SPECIFICATIONS.

**WATERMANS AND APPURTENANCES**

1. ALL WATERMAIN MATERIAL, INCLUDING APPURTENANCES SHALL CONFORM TO THE CITY OF OTTAWA "WATERMAIN MATERIAL SPECIFICATIONS".
2. ALL WATERMANS FROM 100 mm TO 300 mm DIAMETER SHALL BE PVC CL 150 DR18 CONFORMING TO CSA B137.3 AND ANWAC900 AND INSTALLED WITH 14 GAGE TRACER WIRE. THE PIPE JOINTS SHALL BE APPROVED PUSH ON, MECHANICAL OR FLANGED AS REQUIRED FOR 1,000 KPA RATED PRESSURE. ALL WATERMANS 50 mm DIAMETER AND SMALLER SHALL BE TYPE K COPPER.
3. ALL WATERMANS SHALL HAVE A MINIMUM COVER OF 2.4 METRES TO THE TOP OF PIPE.
4. THRUST BLOCKING SHALL CONFORM TO THE CITY OF OTTAWA SPECIFICATIONS.
5. PIPE BEDDING SHALL CONFORM TO THE CITY OF OTTAWA SPECIFICATIONS.
6. ALL CONSTRUCTION METHODS SHALL CONFORM TO CURRENT CITY OF OTTAWA STANDARDS AND SPECIFICATIONS.
7. 50 mm DIAMETER BLOW OFF'S SHALL BE INSTALLED AT ALL DEAD ENDED WATERMANS FOR BLEEDING OFF, CHARGING AND FLUSHING THE WATER SYSTEM.
8. UPON COMPLETION OF CONSTRUCTION OF THE WATERMANS, THE CONTRACTOR SHALL FLUSH, PRESSURE TEST AND DISINFECT THE ENTIRE WATER DISTRIBUTION SYSTEM AS DIRECTED BY THE ENGINEER AND THE CITY OF OTTAWA.
9. WATERMANS SHALL BE INSTALLED TO LINES AND GRADES AS SHOWN ON THE APPROVED SITE SERVING PLANS. A COPY OF ALL GRADE SHEETS SHALL BE SUPPLIED TO THE ENGINEER PRIOR TO COMMENCEMENT OF WORK.
10. WATERMANS SHALL HAVE A MINIMUM VERTICAL CLEARANCE OF 0.30 METRES OVER AND 0.50 METRES UNDER CROSSING SEWERS AND OTHER UTILITIES.
11. ALL WATERMANS SHALL HAVE A MINIMUM OF 1.2 METRE HORIZONTAL CLEARANCE FROM MANHOLES, CATCHBASINS AND ALL UTILITIES.
12. PROVISIONS FOR FLUSHING THE WATERMANS PRIOR TO TESTING SHALL BE PROVIDED WITH AT LEAST A 50 mm DIAMETER OUTLET ON 100 mm DIAMETER AND LARGER MANS. COPPER LINES ARE TO HAVE FLUSHING POINTS AT THE END, THE SAME SIZE AS THE LINE. THE FLUSHING POINTS MUST ALSO BE HOSED OR PIPED TO ALLOW THE WATER TO BE DISCHARGED TO A DRAIN. ON FIRE LINES, THE FLUSHING OUTLET IS TO BE 100 mm DIAMETER MINIMUM ON A HYDRANT.
13. THE PROPOSED WATER DISTRIBUTION SYSTEM MUST BE ISOLATED FROM EXISTING WATERMANS TO ALLOW INDEPENDENT TESTING AND CHLORINATING FROM THE EXISTING SYSTEMS.
14. ALL LINE TAPPING AND OPERATION OF THE CITY OF OTTAWA WATER VALVES SHALL BE ARRANGED THROUGH THE CITY.
15. CATHODIC PROTECTION OF THE WATER DISTRIBUTION SYSTEM SHALL BE PROVIDED IN CONFORMITY WITH THE CITY OF OTTAWA SPECIFICATIONS.
16. ALL BUILDING SERVICE CONNECTIONS SHALL TERMINATE WITH A CAPPED VALVE, SET 1.0 METRES FROM THE FACE OF THE BUILDING, UNLESS OTHERWISE NOTED, AND MUST BE MECHANICALLY RESTRAINED FOR A MINIMUM DISTANCE OF 12 METRES BACK FROM THE VALVE.
17. FIRE HYDRANTS SHALL BE FLOW TESTED AND COLOUR CODED IN CONFORMANCE WITH THE CITY OF OTTAWA AND THE FIRE DEPARTMENT REQUIREMENTS.

**EROSION AND SILT CONTROL NOTES**

1. ALL SEDIMENT CONTROL WORKS SHALL BE INSTALLED PRIOR TO COMMENCING ANY CONSTRUCTION.
2. ALL SILT CONTROL FENCING, MUD MATS, ROCK CHECK DAMS AND OTHER SEDIMENTATION CONTROL MEASURES SHALL BE INSPECTED DAILY AS WELL AS IMMEDIATELY FOLLOWING A SIGNIFICANT RAINFALL EVENT AND MAINTAINED OR CLEANED AS REQUIRED.
3. IF IT IS DETERMINED THAT THE EROSION AND SEDIMENT CONTROL MEASURES ARE NOT ADEQUATELY PREVENTING THE RELEASE OF SEDIMENT TO THE EXISTING STORM SEWERS OR SWALES, ADDITIONAL MEASURES SHALL IMMEDIATELY BE PUT IN PLACE, AS DIRECTED BY THE ENGINEER.
4. ALL CONSTRUCTION VEHICLES SHALL ENTER AND EXIT THE SITE AT A DESIGNATED POINT, PROVIDED WITH MUD MATS AS SPECIFIED ON THE DRAWINGS, TO ENSURE THAT MATERIAL IS NOT TRACKED OFF THE SITE ONTO ADJACENT ROADS.
5. THE CONTRACTOR SHALL, AT HIS EXPENSE, CLEAN THE ADJACENT ROADS AS REQUIRED.
6. THE CONTRACTOR SHALL INSTALL ROCK CHECK DAMS AS MAY BE REQUIRED, OR AS DIRECTED BY THE ENGINEER.
7. THE CONTRACTOR SHALL IMMEDIATELY NOTIFY THE ENGINEER OF ANY DISCREPANCIES ON THE DRAWINGS OR ANY UNUSUAL CONDITIONS ENCOUNTERED DURING THE WORK.
8. ADDITIONAL SILT CONTROL FENCING SHALL BE INSTALLED AS REQUIRED AROUND ALL STOCKPILES OF EXCAVATED MATERIAL.
9. ANY EXTERNAL AREAS DISTURBED DUE TO CONSTRUCTION SHALL BE RESTORED TO THEIR ORIGINAL CONDITION TO THE SATISFACTION OF THE ENGINEER.
10. THE CONTRACTOR IS RESPONSIBLE FOR MAINTAINING SEDIMENT AND EROSION CONTROL WORKS FOR THE DURATION OF THE CONSTRUCTION PERIOD, TO THE SATISFACTION OF THE ENGINEER.
11. LOCATION OF ADDITIONAL SILT CONTROL FENCE OR OTHER MEASURES MAY BE REQUIRED AND WILL BE REVIEWED AND APPROVED BY THE ENGINEER AS THE WORK PROGRESSES.
12. THE CONTRACTOR SHALL USE APPROPRIATE CONSTRUCTION METHODS TO ELIMINATE ANY TRENCH WATER, MUD, DEBRIS, SILT ETC. FROM ENTERING EXISTING STORM SEWER SYSTEMS, CULVERTS OR DRAINAGE CHANNEL.
13. HALF BULK HEADS SHALL BE INSTALLED IN ALL NEW STORM MANHOLES AND MAINTAINED UNTIL THEIR REMOVAL IS APPROVED BY THE ENGINEER. THE BULK HEADS SHALL BE INSPECTED ON A REGULAR BASIS AND ANY SILT BUILD-UP SHALL BE REMOVED AS REQUIRED.
14. ALL DISTURBED AREAS SHALL BE REINSTATED AS SOON AS PRACTICAL, FOLLOWING COMPLETION OF THE WORK.
15. ONCE THE CATCHBASINS HAVE BEEN INSTALLED AND CONNECTED TO THE STORM SEWER SYSTEM, SEDIMENT BARRIERS SHALL BE INSTALLED.
16. ALL CATCHBASIN SLUMPS SHALL BE INSPECTED FREQUENTLY, AND CLEANED AS REQUIRED.
17. ALL DISTURBED AREAS WITHIN THE SITE THAT ARE NOT OCCUPIED BY BUILDINGS, ROADWAY OR DRIVEWAYS SHALL BE TOPSOILED AND SOODED OR SEEDED IMMEDIATELY FOLLOWING COMPLETION OF FINAL GRADING OPERATIONS.
18. ADDITIONAL EROSION AND SEDIMENT CONTROL MATERIALS INCLUDING SILT FENCE, STRAW BALES, CLEAR STONES ETC. ARE TO BE KEPT ON SITE FOR EMERGENCIES AND REPAIRS.
19. AN AFTER HOURS CONTACT PHONE NUMBER IS TO BE VISIBLY POSTED ON THE SITE FOR EMERGENCIES.
20. ANY SPILL FROM THE SITE SHALL BE REPORTED TO MINISTRY OF THE ENVIRONMENT, SPILL ACTION CENTRE, AT 1-800-268-6060 AND TO THE ENGINEER.
21. THE EROSION AND SEDIMENT CONTROL METHODS SHALL HAVE REGARD TO APPLICATION OF EROSION & SEDIMENT CONTROLS ON RMOC CONSTRUCTION PROJECT (1998) AND EROSION & SEDIMENT CONTROL GUIDELINES FOR URBAN CONSTRUCTION (2009).

APPROVED  
By Lily Xu at 11:13 am, Oct 13, 2022

LILY XU, MCIP, RPP  
MANAGER, DEVELOPMENT REVIEW SOUTH  
PLANNING, INFRASTRUCTURE & ECONOMIC  
DEVELOPMENT DEPARTMENT, CITY OF OTTAWA

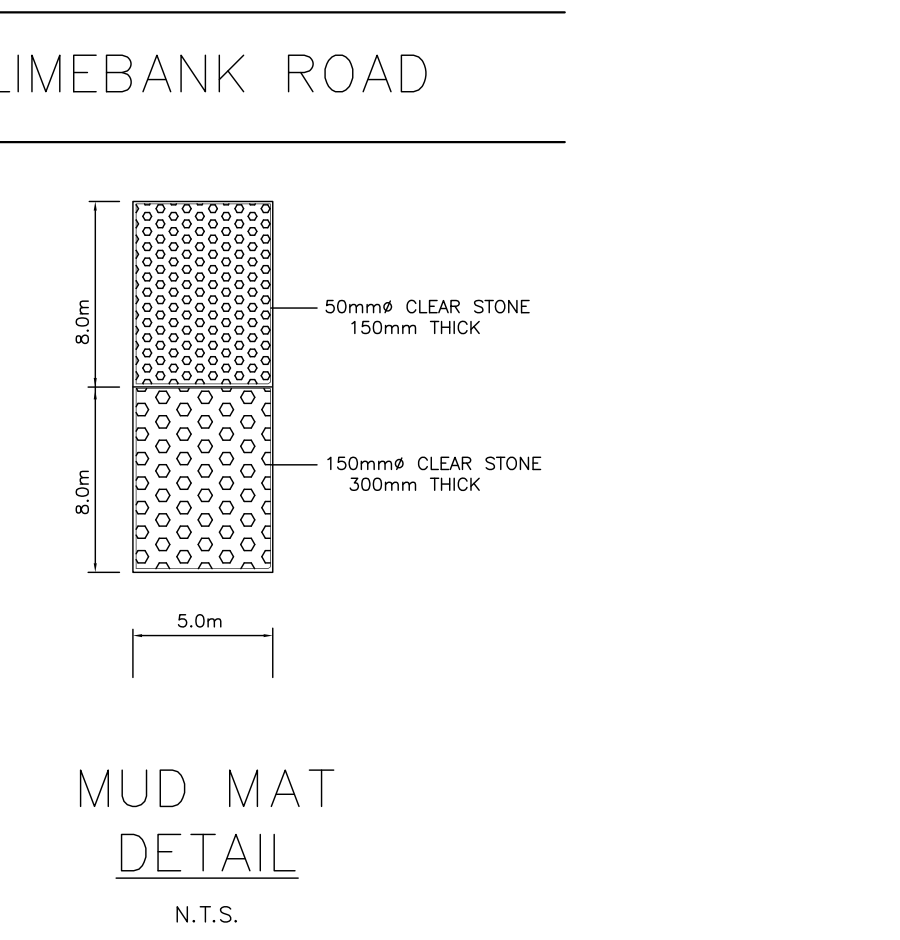
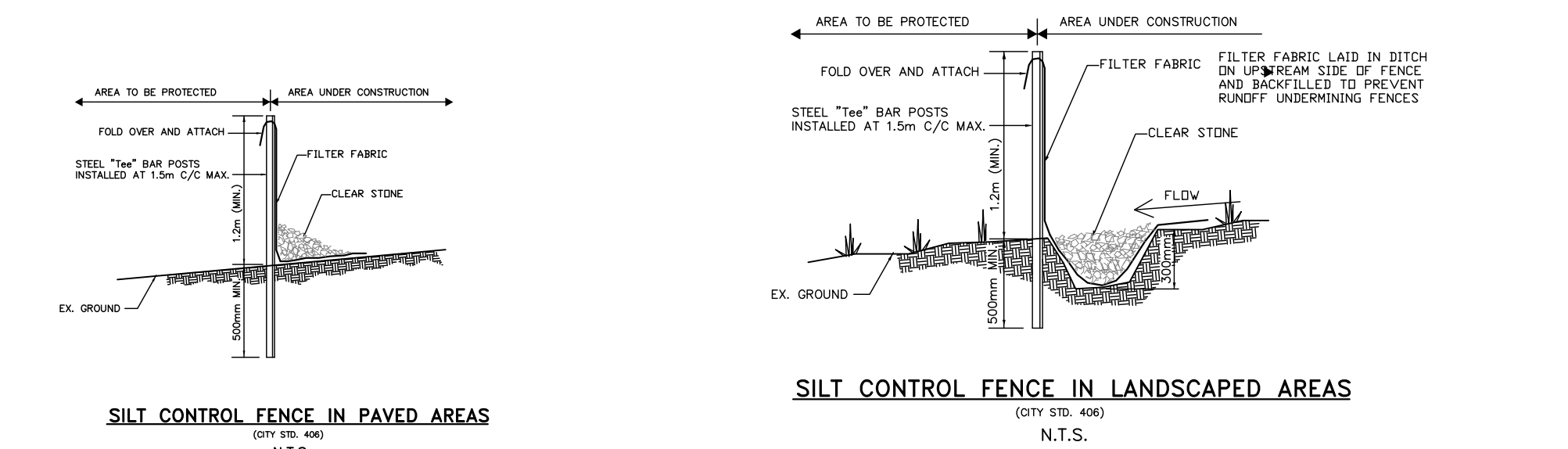
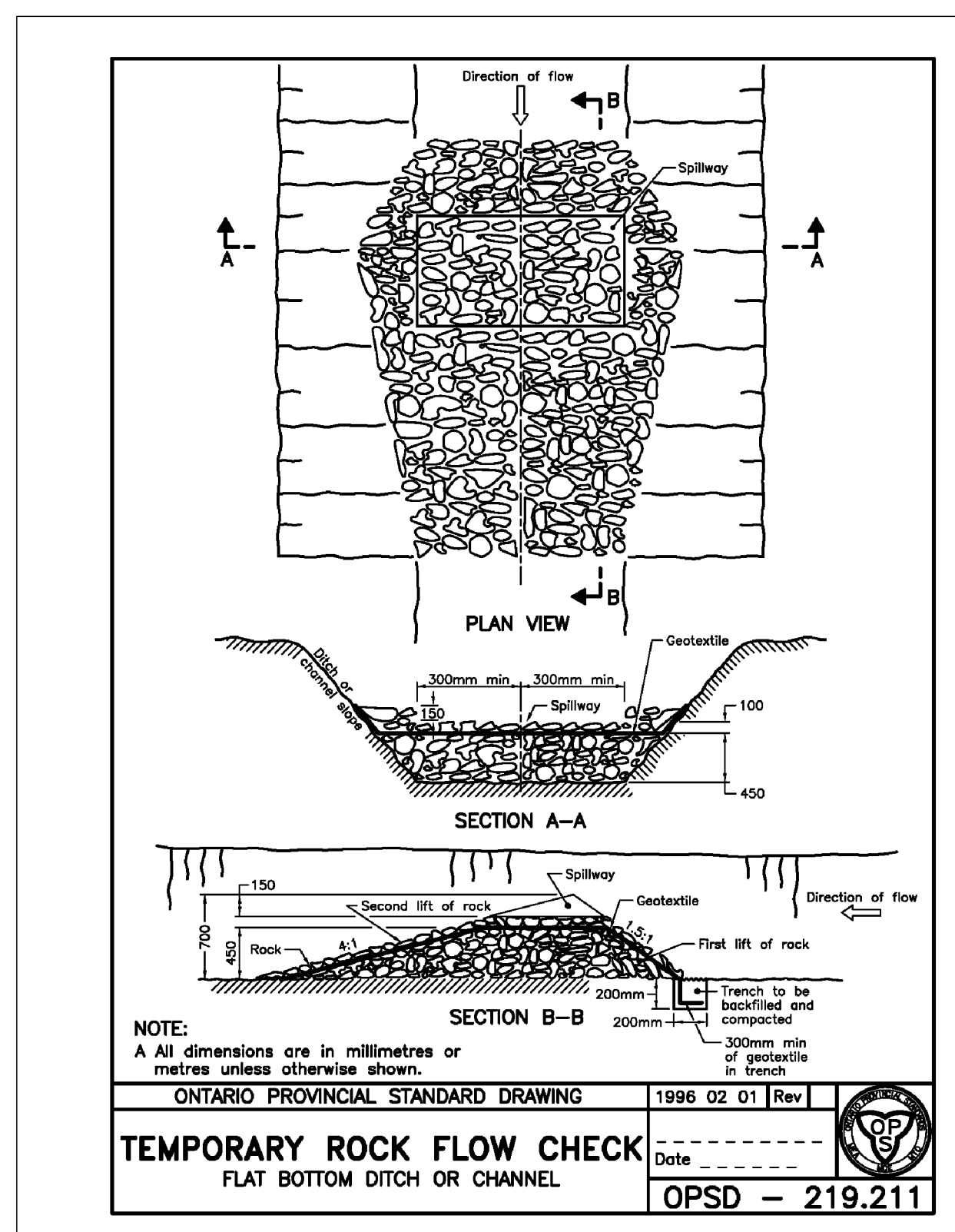
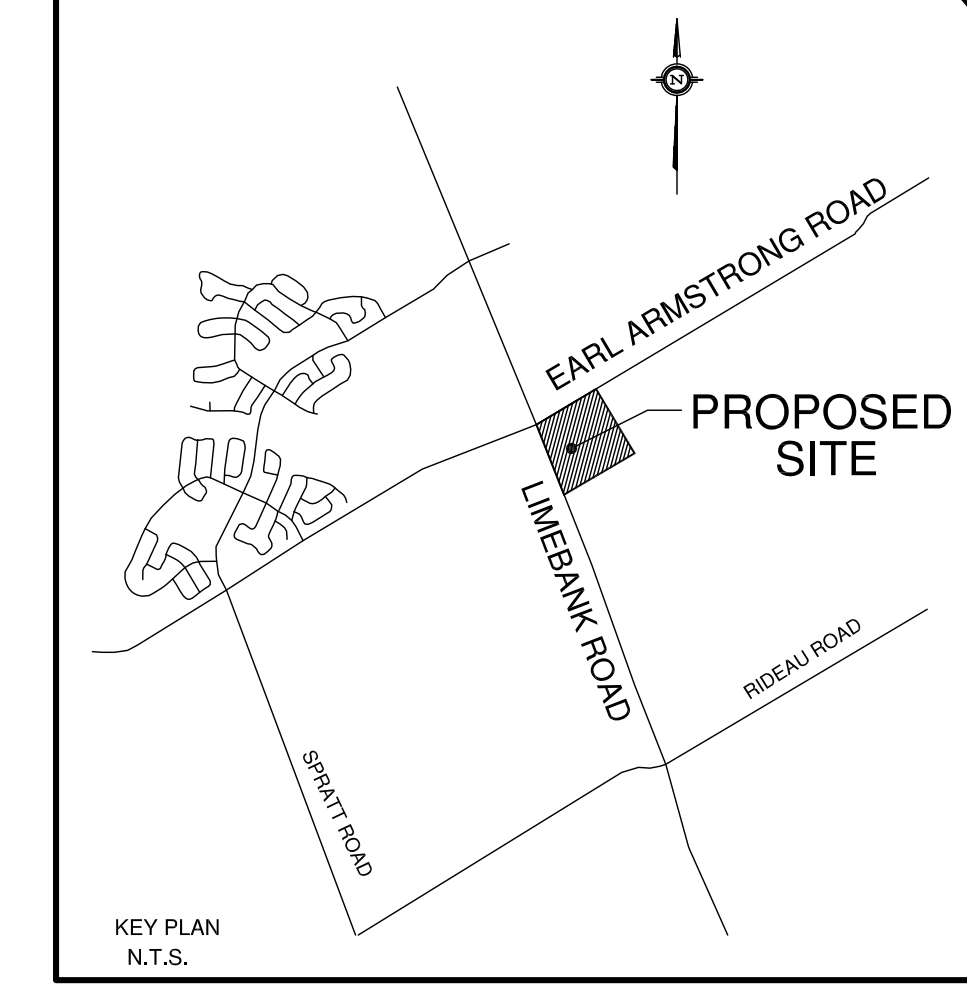
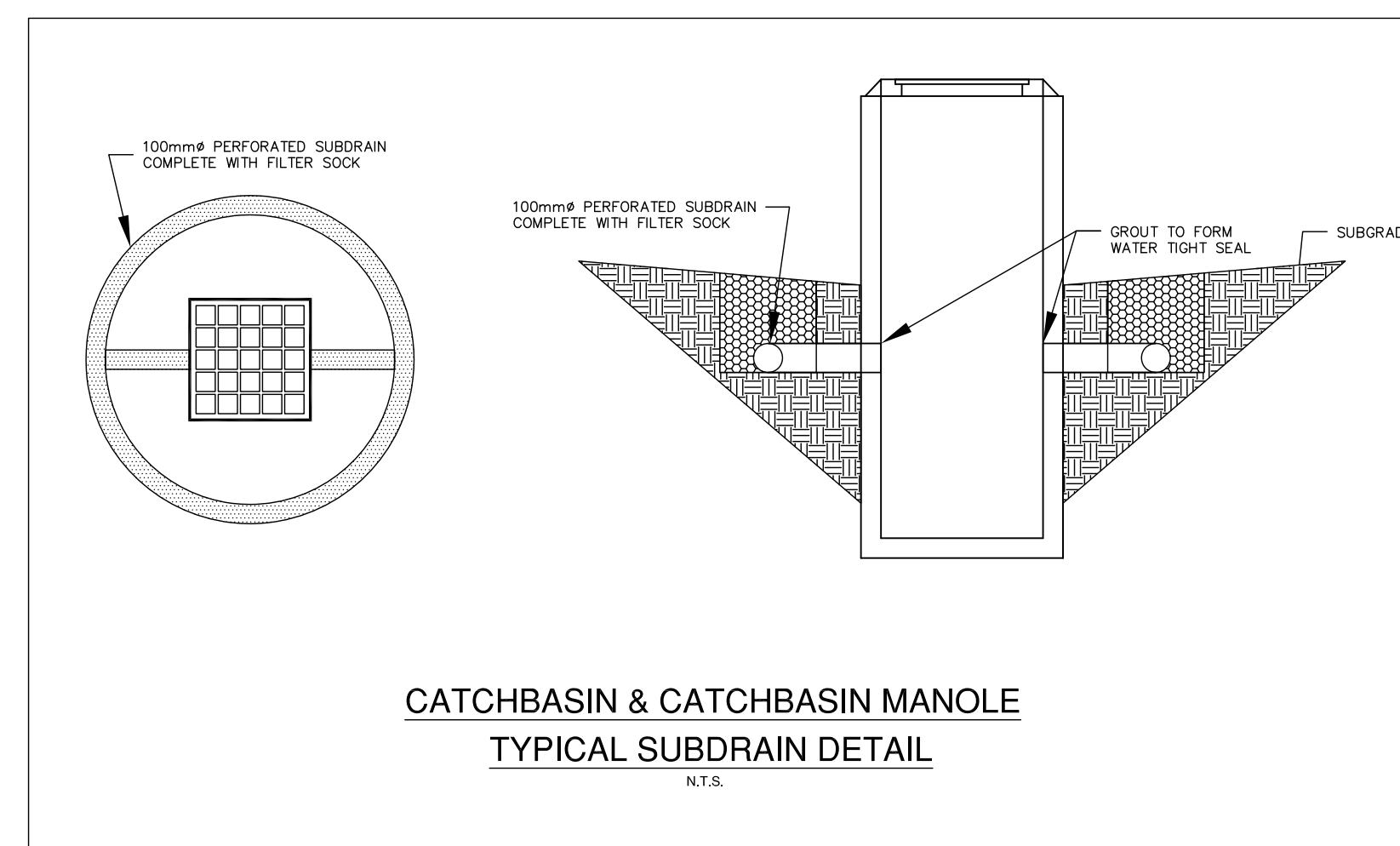

**EROSION CONTROL MEASURES**

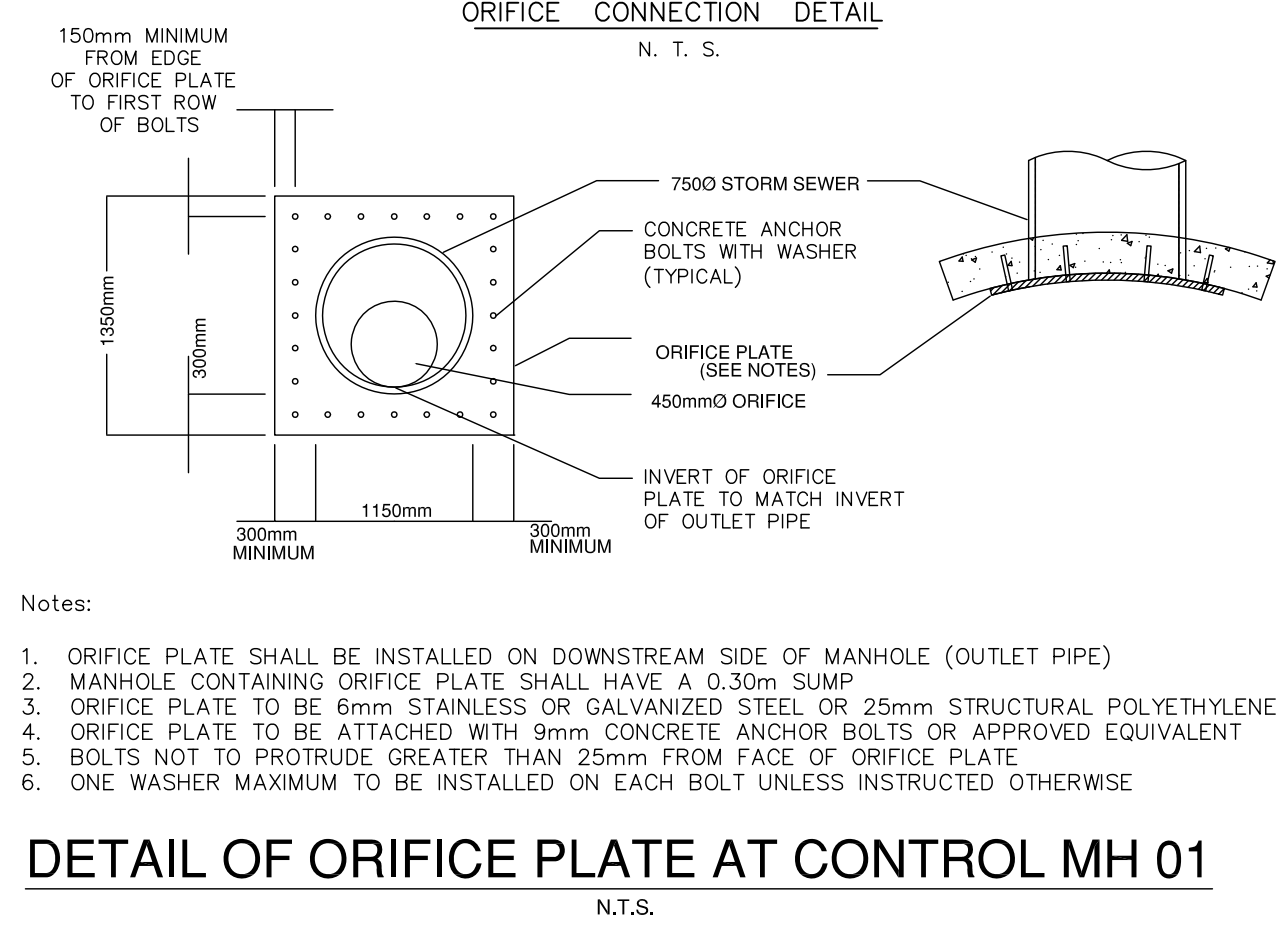
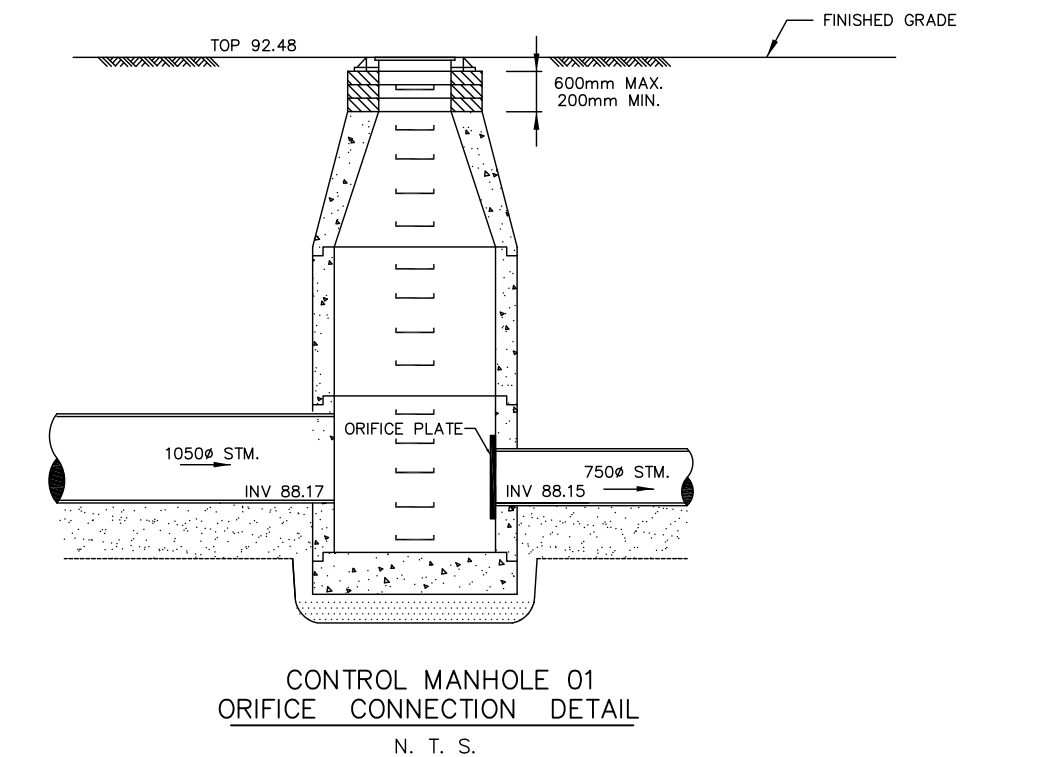
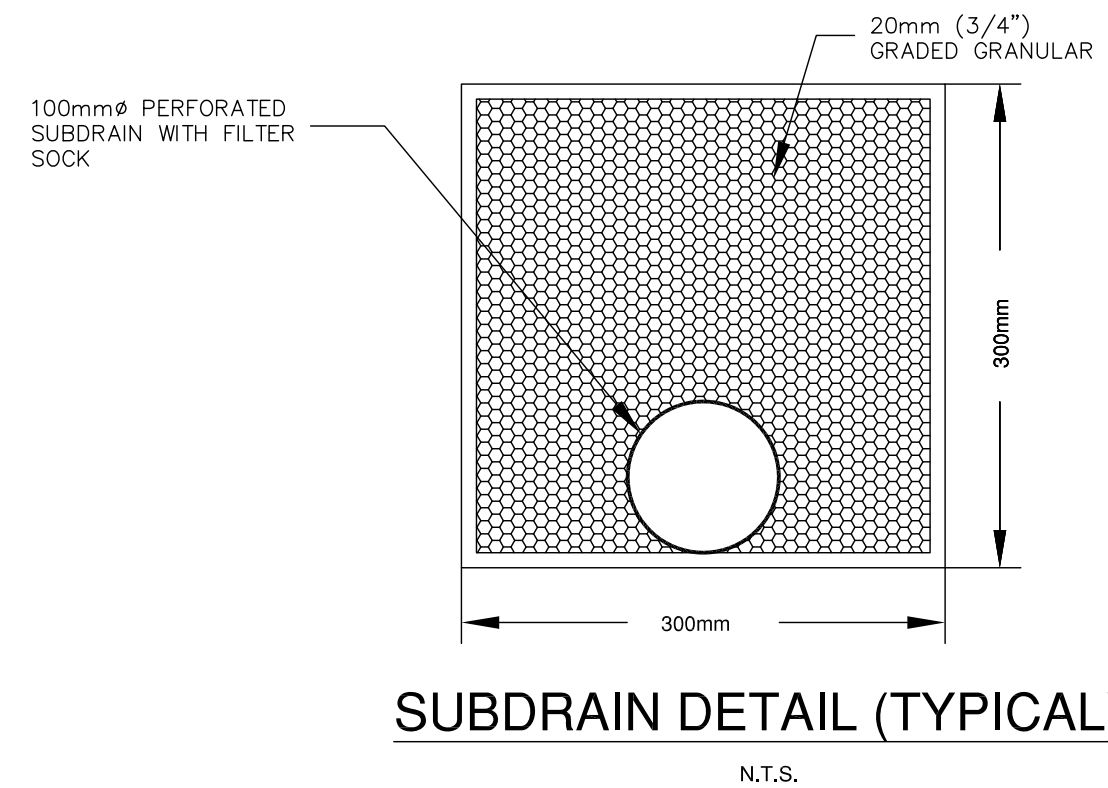
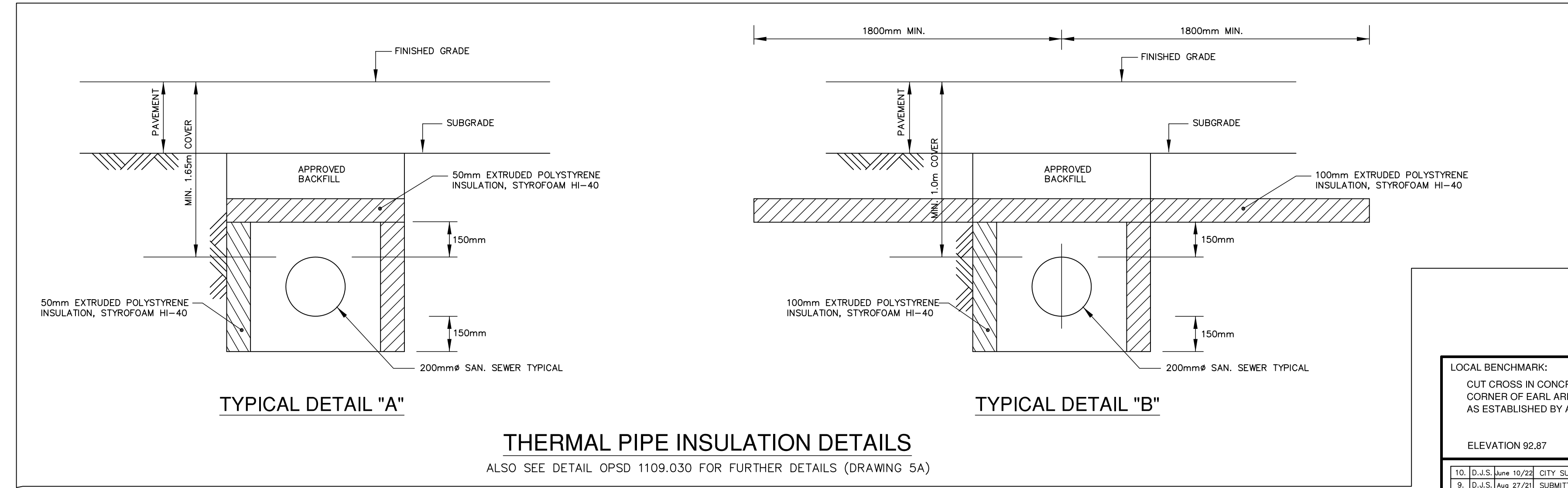

- SPECIAL NOTES**
1. CLAY SEALS SHALL BE INSTALLED IN THE SERVICE TRENCHES. THE SEALS SHALL BE 1.5m LONG (IN THE TRENCH DIRECTION) AND SHALL EXTEND FROM TRENCH WALL TO TRENCH WALL. THE SEALS SHALL EXTEND FROM THE FROST LINE AND FULLY PENETRATE THE BEDDING. SUBSIDING AND COVER MATERIAL. THE SEALS SHALL CONSIST OF RELATIVELY DRY AND COMPACTABLE BROWN SILTY CLAY, COMPACTED TO A MINIMUM OF 95% OF THE SPMD. THE CLAY SEALS SHALL BE PLACED AT THE SITE BOUNDARIES AND AT STRATEGIC LOCATIONS AT NO MORE THAN 50m INTERVALS ALONG THE SERVICE TRENCHES, AS DIRECTED BY THE GEOTECHNICAL ENGINEER.
  2. A PERIMETER DRAINAGE SYSTEM IS TO BE USED AROUND ALL BUILDINGS. THE SYSTEM SHALL CONSIST OF A 100mm DIAMETER PERFORATED CORRUGATED PLASTIC PIPE, SURROUNDED ON ALL SIDES BY 150mm OF 10mm CLEAR CRUSHED STONE. SUBSIDING AND COVER MATERIAL. THE SEALS SHALL CONSIST OF RELATIVELY DRY AND COMPACTABLE BROWN SILTY CLAY, COMPACTED TO A MINIMUM OF 95% OF THE SPMD. BACKFILL AGAINST THE EXTERIOR SIDES OF THE FOUNDATION WALLS SHALL CONSIST OF FREE-DRAINING NON FROST SUSCEPTIBLE GRANULAR MATERIALS, SUCH AS CLEAN SAND OR OPSS GRANULAR B TYPE I GRANULAR MATERIAL.

**LOCAL BENCHMARK:**  
CUT CROSS IN CONCRETE TRAFFIC ISLAND AT THE NORTH-EAST CORNER OF EARL ARMSTRONG ROAD AND LIMEBANK ROAD AS ESTABLISHED BY ANNIS, O'SULLIVAN, VOLLEBEK LTD, O.L.S.

ELEVATION 92.87

No.	Date	Revision	Checked	
10.	0.15 Jun 10/22	CITY SUBMISSION	R.S.	
9.	0.15 Jun 27/21	SUBMITTED FOR SITE PLAN APPROVAL	O.B.C.	
8.	0.5 Mar 8/21	SITE PLAN REVISIONS - MINOR BUILDING ADJUSTMENTS	O.B.C.	
7.	0.5 Aug 27/20	SITE PLAN REVISIONS TO LOCATION OF BUILDINGS	O.B.C.	
6.	0.5 Aug 28/20	REVISED AS PER CITY COMMENTS	O.B.C.	
5.	0.5 Aug 14/20	SITE PLAN REVISIONS	O.B.C.	
4.	0.5 Jun 28/20	REVISED AS PER CITY COMMENTS	O.B.C.	
3.	0.5 Jun 18/20	ISSUED FOR SECOND SUBMISSION	O.B.C.	
No.	By	Date	Revision	Checked

APPROVED AS TO FORM IN RELIANCE UPON THE PROFESSIONAL SKILL AND ABILITY OF URBAN ECOSYSTEMS LIMITED AS TO DESIGN AND SPECIFICATION.

*[Signature]*  
Director of Engineering Date

*[Signature]*  
June 15, 2022  
PROVINCE OF ONTARIO

URBAN ECOSYSTEMS LIMITED  
7050 WESTON ROAD, SUITE 705  
WOODBRIDGE, ONTARIO L4L 8G7  
uel@urbanecosystems.com  
t. (905)856-0629  
f. (905)856-0698

**TOWN SQUARE CENTRE  
RIVERSIDE SOUTH  
1424 EARL ARMSTRONG ROAD  
CITY OF OTTAWA**

**MORGUARD INVESTMENTS LTD.  
55 CITY CENTER DRIVE  
MISSISSAUGA, ONTARIO**

FILE No D07-12-14-0067

**NOTES & DETAILS**

Designed By	J.M.C.	Date	APR 2014	Checked By	R.S.
Drawn By	J.M.	Approved By			
Scale:	1:500	Project No.	12007	Drawing No.	5 of 8
Plan Number: 18433					

D07-12-14-0067