

- LEGEND**
- EXISTING CURB
  - - - EXISTING CURB TO BE REMOVED
  - PROPOSED CURB
  - PROPOSED SIDEWALK
  - OVERLAND FLOW ROUTE
  - 1.5% → DIRECTION AND SLOPE OF XXXX DRAINAGE
  - █ PROPOSED PAVEMENT
  - 95.45 EXISTING ELEVATION
- NOTE:**  
THIS DRAWING SHALL BE READ IN CONJUNCTION WITH DRAWING 5 OF 8, NOTES & DETAILS PROJECT 12007

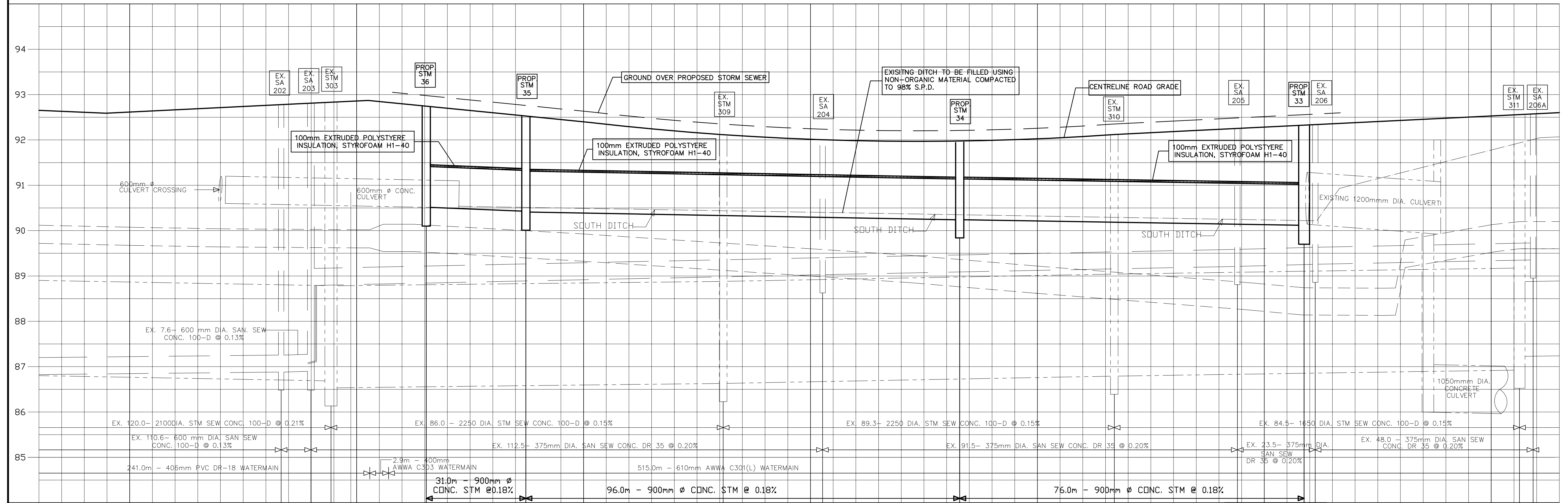

ELEVATION 92.87

| No. | By   | Date     | Revision            | Checked |
|-----|------|----------|---------------------|---------|
| 1.  | J.H. | Nov 8/16 | ISSUED FOR APPROVAL |         |

APPROVED AS TO FORM IN RELIANCE UPON THE PROFESSIONAL SKILL AND ABILITY OF URBAN ECOSYSTEMS LIMITED AS TO DESIGN AND SPECIFICATION.

Director of Engineering \_\_\_\_\_ Date \_\_\_\_\_

**PROFESSIONAL ENGINEER**  
ROSARIO SACCO  
NOV 21, 2016  
PROVINCE OF ONTARIO

URBAN ECOSYSTEMS LIMITED  
7050 WESTON ROAD, SUITE 705  
WOODBRIDGE, ONTARIO L4L 6G7  
ucl@urbanecosystems.com  
t: (905)856-0629  
f: (905)856-0698

**UCL**

**TOWN SQUARE CENTRE**  
RIVERSIDE SOUTH  
CITY OF OTTAWA

**MORGUARD INVESTMENTS LTD.**  
55 CITY CENTER DRIVE  
MISSISSAUGA, ONTARIO

FILE No D07-12-14-0067  
**PROPOSE STORM SEWER TO REPLACE EXISTING DITCH**

|             |       |             |          |             |      |
|-------------|-------|-------------|----------|-------------|------|
| Designed By | OBC   | Date        | APR 2014 | Checked By  | R.S. |
| Drawn By    | JH    |             |          | Approved By |      |
| Scale:      | 1:500 | Project No. | 12007    | Drawing No. | PP-1 |

| STATION  | STORM SEWER    | SANITARY SEWER                   |
|----------|----------------|----------------------------------|
| 54 + 950 |                | 86.88<br>86.88<br>86.90<br>86.79 |
| 55 + 000 | 90.55<br>90.49 | 86.685<br>86.533                 |
| 55 + 050 | 90.43<br>90.41 |                                  |
| 55 + 100 |                | 86.63<br>86.63                   |
| 55 + 150 | 90.24<br>90.24 | 89.028<br>89.028                 |
| 55 + 200 |                | 89.211<br>89.211                 |
| 55 + 250 |                | 86.925<br>87.225                 |