

66.98 ——— DRAINAGE AREA (Ha)
 1.73 SCS24 ——— STORM
 1.73 ——— TIME TO PEAK (Ha)

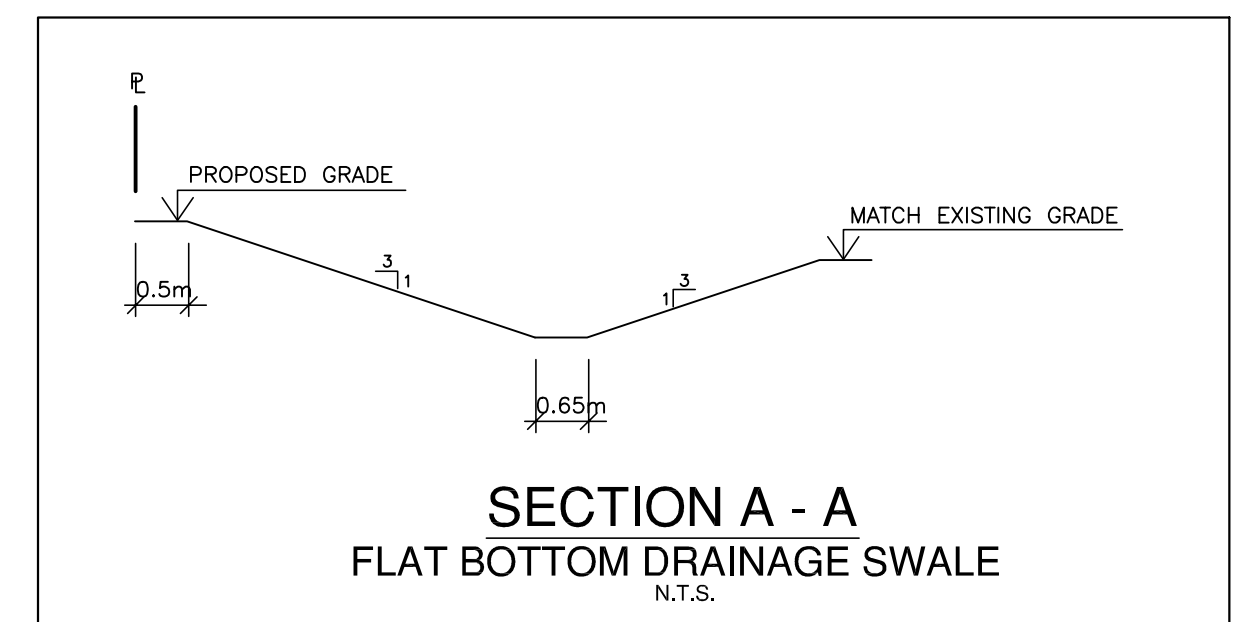

NOTE:
 THIS DRAWING SHALL BE READ
 IN CONJUNCTION WITH DRAWING
 4 OF 8, EROSION & SEDIMENT
 CONTROL PLAN, AND DRAWING
 5 OF 8, NOTES & DETAILS
 PROJECT 12007

LOCAL BENCHMARK:
 CUT CROSS IN CONCRETE TRAFFIC ISLAND AT THE NORTH-EAST
 CORNER OF EARL ARMSTRONG ROAD AND LIMEBANK ROAD
 AS ESTABLISHED BY ANNIS, O'SULLIVAN, VOLLEBEK LTD, O.L.S.
 ELEVATION 92.87

No.	By	Date	Revision	Checked
7.	D.S.	Nov. 27/14	SITE PLAN REVISIONS/CITY COMMENTS	O.B.C.
6.	D.S.	Aug. 28/15	REVISED AS PER CITY COMMENTS	O.B.C.
5.	D.S.	Aug. 14/15	SITE PLAN REVISIONS	O.B.C.
4.	C.R.M.	Jan. 28/15	REVISED AS PER CITY COMMENTS	O.B.C.
3.	J.H.	July 18/14	ISSUED FOR SECOND SUBMISSION	O.B.C.
2.	J.H.	May 25/14	REVISED AS PER CITY COMMENTS	O.B.C.
1.	C.R.M.	Apr. 17/14	ISSUED FOR SITE PLAN APPROVAL	O.B.C.

APPROVED AS TO FORM IN RELIANCE UPON
 THE PROFESSIONAL SKILL AND ABILITY OF
 URBAN ECOSYSTEMS LIMITED AS TO DESIGN
 AND SPECIFICATION.

Director of Engineering _____ Date _____

REG. SITE PLAN ENGINEER
 ROSARIO SACCO
 (NOV 21, 2016)
 PROVINCE OF ONTARIO

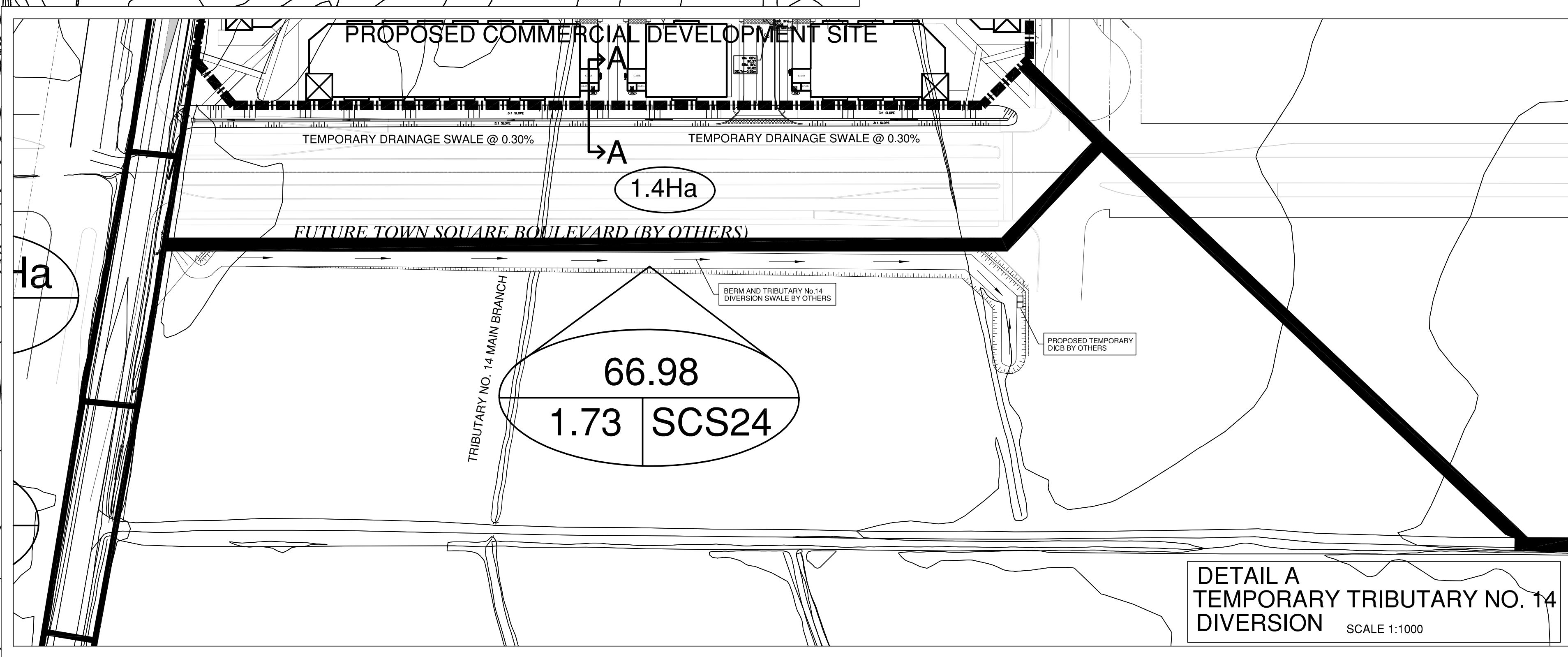

URBAN ECOSYSTEMS LIMITED
 7050 WESTON ROAD, SUITE 705
 WOODBRIDGE, ONTARIO L4L 8C7
 uel@urbanecosystems.com
 t. (905)856-0629
 f. (905)856-0698

U.E.L.

TOWN SQUARE CENTRE
 RIVERSIDE SOUTH
 CITY OF OTTAWA

MORGUARD INVESTMENTS LTD.
 55 CITY CENTER DRIVE
 MISSISSAUGA, ONTARIO

FILE No D07-12-14-0067
**EXTERNAL STORM DRAINAGE AREA
 AND OFF SITE DITCHING PLAN**

Designed By	XXX	Date	APR 2014	Checked By	R.S.
Drawn By	XXX	Approved By			
Scale:	1:3000	Project No.	12007	Drawing No.	8 of 8