

	CONTROLLED LANDSCAPE	3,024 sq.m.
	UNCONTROLLED LANDSCAPE	4,126 sq.m.
	CONTROLLED PAVEMENT	45,306 sq.m (Incl. BLDG "A" OF 4,821.6 sq.m.)
	UNCONTROLLED PAVEMENT	1,186 sq.m.
	PROPOSED BUILDING	10,035 sq.m. (Exclude BLDG "A" OF 4,821.6 sq.m.)
	PONDING AREA	7,772 sq.m.

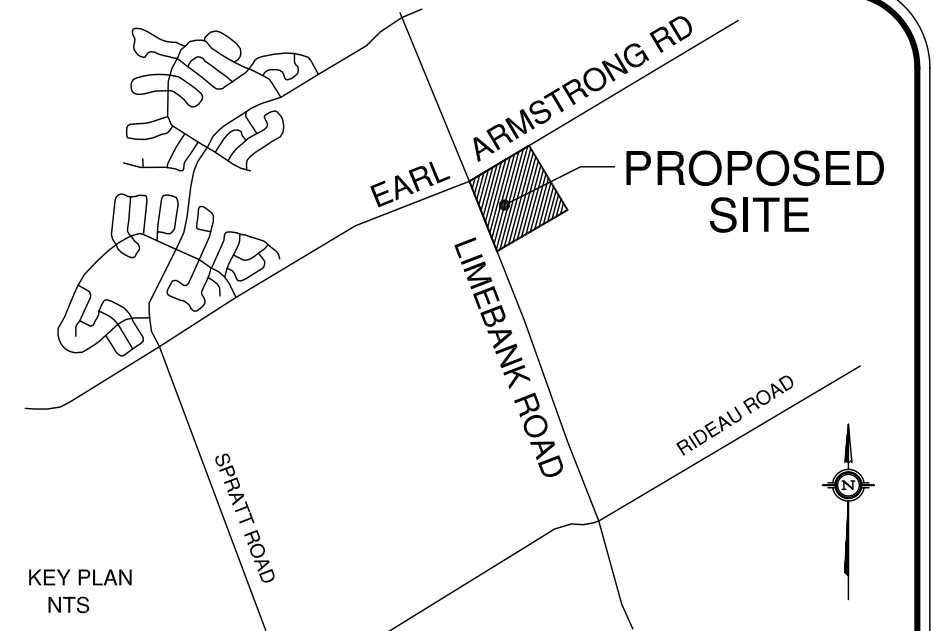

# EARL ARMSTRONG ROAD

# LIMEBANK ROAD

# CEREMONIAL DRIVE

# CONNECTOR ROAD

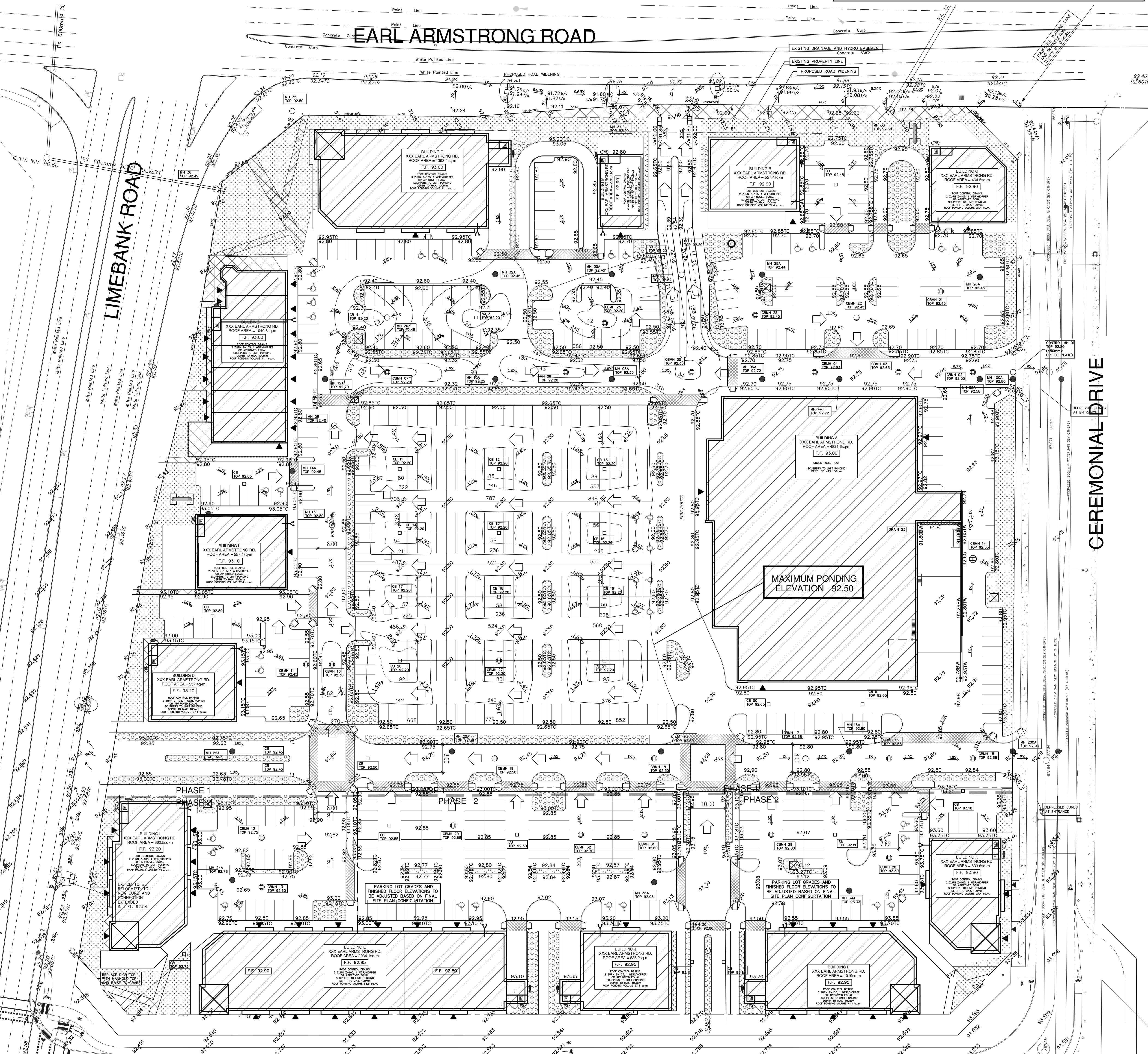

<b>MAXIMUM PONDING ELEVATION</b>	92.5	<b>LANDSCAPE</b>	uncontrolled LANDSCAPE = 4,126 Sq. m. controlled LANDSCAPE = 3,024 Sq. m.
<b>MAXIMUM PONDING VOLUME</b>	2,091 m <sup>3</sup>	<b>HARD SURFACE</b>	uncontrolled HARD SURFACE = 1186 Sq. m. controlled HARD SURFACE = 35,306 Sq. m. INCL BLDG A
<b>DRAINAGE AREAS</b>		<b>TOTAL</b>	<b>63,677 Sq. m.</b>

AREA	Roof Area sq.m.	No. OF DRAINS	Max. Ponding Vol. cu.m.
A	1821.6	UNCONTROLLED	N.A.
B	557.4	2	37.8
C	1393.5	3	94.4
D	557.4	2	37.8
E	2034.1	5	137.8
F	1019.3	3	69.0
G	464.5	2	31.5
H	1040.8	3	70.5
I	862.5	2	58.4
J	635.2	2	43.0
K	633.6	2	42.9
L	557.4	2	37.8
M	278.7	2	18.9
<b>TOTAL</b>		<b>30</b>	<b>679.7</b>

AREA	DEPTH (mm)	INCREMENTAL PONDING VOLUME (m <sup>3</sup> )	TOTAL
1	300	1.1	4.6
2	300	1.1	4.6
3	300	1.4	11.2
4	300	2.1	11.4
5	300	1.4	6.9
6	300	2.1	14.3
7	300	1.4	13.7
8	300	1.4	11.6
9	300	4.2	21.5
10	300	4.2	22.3
11	300	2.7	13.2
12	300	2.5	14.7
13	300	2.8	14.0
14	300	2.9	14.1
15	300	2.9	14.7
16	300	4.6	21.7
17	300	4.6	21.7
18	300	4.6	21.7
19	300	4.6	21.7
20	300	4.6	21.7
21	300	4.6	21.7
22	300	4.6	21.7
23	300	4.6	21.7
24	300	4.6	21.7
25	300	4.6	21.7
26	300	4.6	21.7
27	300	4.6	21.7
28	300	4.6	21.7
29	300	4.6	21.7
30	300	4.6	21.7
<b>TOTAL</b>		<b>3.8</b>	<b>14.7</b>

SITE AREA SUMMARY		sq.m.
CONTROLLED PAVED		45,306
CONTROLLED LANDSCAPED		3,024
CONTROLLED ROOF		10,035
UNCONTROLLED PAVED		1,186
UNCONTROLLED LANDSCAPED		4,126
<b>TOTAL SITE AREA</b>		<b>63,677</b>

ROOF DRAINAGE SYSTEM		
TOTAL CONTROLLED ROOF AREA		10,035 sq.m.
PEAK OUTFLOW RATE		45.7 l/s
TOTAL NO. OF WELLS		30
REQUIRED ROOF STORAGE		411.2 cu.m.
AVAILABLE ROOF STORAGE		679.7 cu.m.

SITE DRAINAGE SYSTEM - 100 YEAR		
ORIFICE DIAMETER		450 mm
MAXIMUM PONDING ELEV.		92.50 m
MAXIMUM PARKING LOT PONDING DEPTH		0.30 m
ORIFICE INVERT		88.15
MAXIMUM LOADING DOCK PONDING DEPTH		0.70 m
ORIFICE RELEASE RATE		8871 l/sec
UNCONTROLLED RELEASE RATE		1834 l/sec
TOTAL RELEASE RATE		10705 l/sec
ALLOWABLE RELEASE RATE		12926 l/sec
REQUIRED SITE STORAGE		848 cu.m.
AVAILABLE SITE STORAGE		2091 cu.m.

LOCAL BENCHMARK:  
CUT CROSS IN CONCRETE TRAFFIC ISLAND AT THE NORTH-EAST CORNER OF EARL ARMSTRONG ROAD AND LIMEBANK ROAD AS ESTABLISHED BY ANNIS, O'SULLIVAN, VOLLEBECK LTD., O.L.S.

ELEVATION 92.87

14	0.5	June 10/22	CITY SUBMISSION	O.B.C.
13	0.5	May 27/20	SUBMITTED FOR SITE PLAN APPROVAL	O.B.C.
12	0.5	May 27/20	SITE PLAN REVISIONS - MINOR BUILDING ADJUSTMENTS	O.B.C.
11	0.5	Aug 27/20	SITE PLAN REVISIONS TO LOCATION OF BUILDINGS	O.B.C.
10	0.5	May 27/20	SITE PLAN REVISIONS/CITY COMMENTS	O.B.C.
9	0.5	Aug 24/20	REVISED AS PER CITY COMMENTS	O.B.C.
8	0.5	Aug 14/20	SITE PLAN REVISIONS	O.B.C.
7	0.5	Aug 14/20	REVISED AS PER CITY COMMENTS	O.B.C.
6	0.5	Aug 14/20	REVISED AS PER CITY COMMENTS	O.B.C.
5	0.5	Aug 14/20	SITE PLAN REVISION	O.B.C.
4	0.5	July 15/14	ISSUED FOR SECOND SUBMISSION	O.B.C.
No. 03			Revision	Checked

**APPROVED**  
By Lily Xu at 11:14 am, Oct 13, 2022

*Lily Xu*

LILY XU, MCIP, RPP  
MANAGER, DEVELOPMENT REVIEW SOUTH  
PLANNING, INFRASTRUCTURE & ECONOMIC  
DEVELOPMENT DEPARTMENT, CITY OF OTTAWA

APPROVED AS TO FORM IN RELIANCE UPON THE PROFESSIONAL SKILL AND ABILITY OF URBAN ECOSYSTEMS LIMITED AS TO DESIGN AND SPECIFICATION.

Director of Engineering: \_\_\_\_\_ Date: \_\_\_\_\_

URBAN ECOSYSTEMS LIMITED  
7050 WESTON ROAD, SUITE 705  
WOODBRIDGE, ONTARIO L4L 6P7  
ue@urbanecosystems.com  
t. (905) 856-0629  
f. (905) 856-0698

**JEL**

TOWN SQUARE CENTRE  
RIVERSIDE SOUTH  
1424 EARL ARMSTRONG ROAD  
CITY OF OTTAWA

MORGUARD INVESTMENTS LTD.  
55 CITY CENTER DRIVE  
MISSISSAUGA, ONTARIO

FILE No D07-12-14-0067

**SWM DRAINAGE PLAN**

Designed By	O.B.C.	Date	APR 2014	Checked By	R.S.
Drawn By	J.M.	Project No.	12007	Approved By	
Scale:	1:500	Drawing No.	3 of 8	Plan Number:	18433

D07-12-14-0067