

Copyright Reserved

The Contractor shall verify and be responsible for all dimensions. DO NOT scale the drawing - any errors or omissions shall be reported to Stantec without delay. The Copyright to all designs and drawings are the property of Stantec. Reproduction or use for any purpose other than that authorized by Stantec is forbidden.

Legend

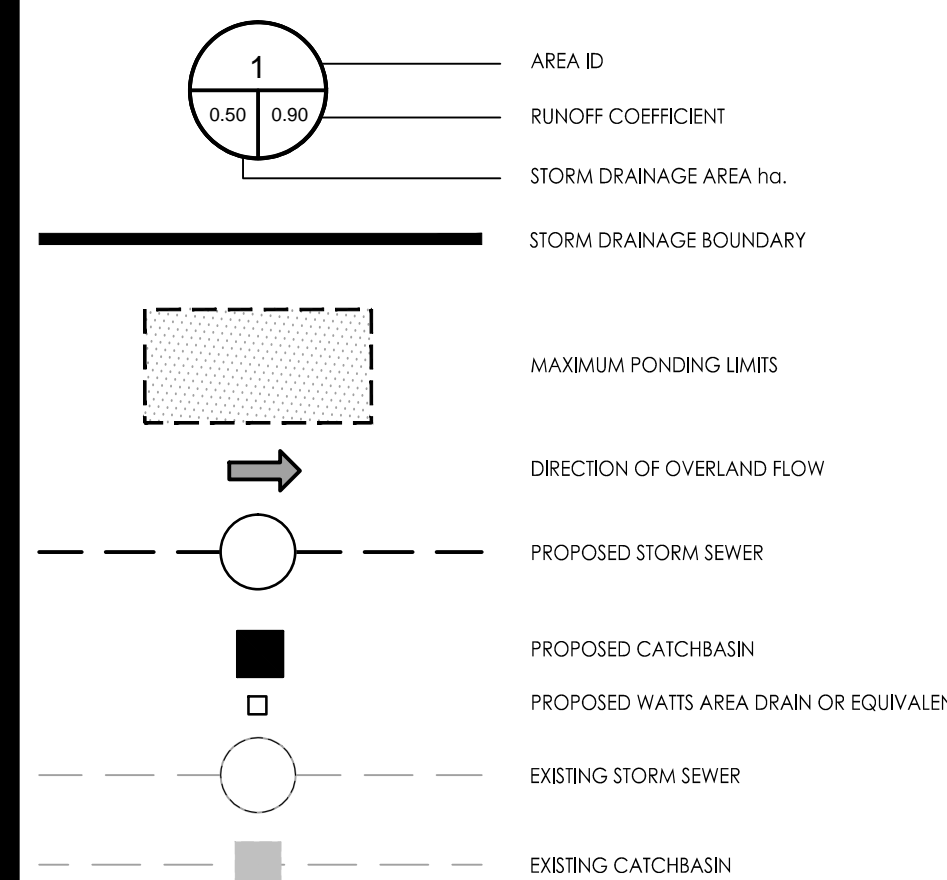

ROOF STORAGE CHARACTERISTICS				
AREA ID	AREA(ha)	HEAD (m)	Release (L/s)	Stored (m ³)
BLDG 1	0.054	0.14	4.2	17.2
BLDG 2	0.015	0.13	2.0	3.7
BLDG 3	0.002	0.06	0.9	0.1
BLDG 4	0.009	0.11	1.8	1.6
BLDG 5	0.004	0.09	1.4	0.4

NOTE: STANDARD ZURN MODEL Z-105-5 CONTROL-FLO SINGLE NOTCH OF DRAINS OR APPROVED EQUIVALENT.

Notes

- PROPOSED BUILDING TO BE EQUIPPED WITH SUMP PUMP AND BACKWATER VALVE AT STORM CONNECTION TO CLARENCE STREET.
- MAXIMUM STORM RELEASE RATE AND UNDERGROUND CISTERN STORAGE REQUIREMENTS TO BE COORDINATED WITH MECHANICAL ENGINEER.
- AS RECOMMENDED IN THE GEOTECHNICAL INVESTIGATION, A TRENCH DRAIN SYSTEM IS TO BE INSTALLED AS A PRECAUTIONARY MEASURE, AROUND THE EXTERIOR PERIMETER WALLS AND BENEATH THE DEEPEST BASEMENT FLOOR SLAB. THE DRAIN SYSTEM SHOULD BE PROVIDED WITH SUFFICIENT CLEAN-OUTS TO PERMIT MAINTENANCE WHEN REQUIRED AND SHOULD ALSO BE CONNECTED TO A SUITABLE SUMP PIT(S) FOR MECHANICAL EVACUATION.
- ROOF DRAINAGE TO BE CONNECTED TO INTERNAL PLUMBING DRAINING TO CISTERN.

Revision	By	Appd.	YY.MM.DD
1	MJS	KJK	16.04.04
0	MJS	KJK	15.08.26

Permit-Seal

Client/Project
CLAUDE LAUZON GROUP LTD.

275 KING EDWARD AVENUE

Ottawa, ON

Title

STORM DRAINAGE PLAN

Project No. 160401149	Scale 1:150	Sheet 4.5	Revision 7.5m
--------------------------	----------------	--------------	------------------

SD-1 6 of 7 1

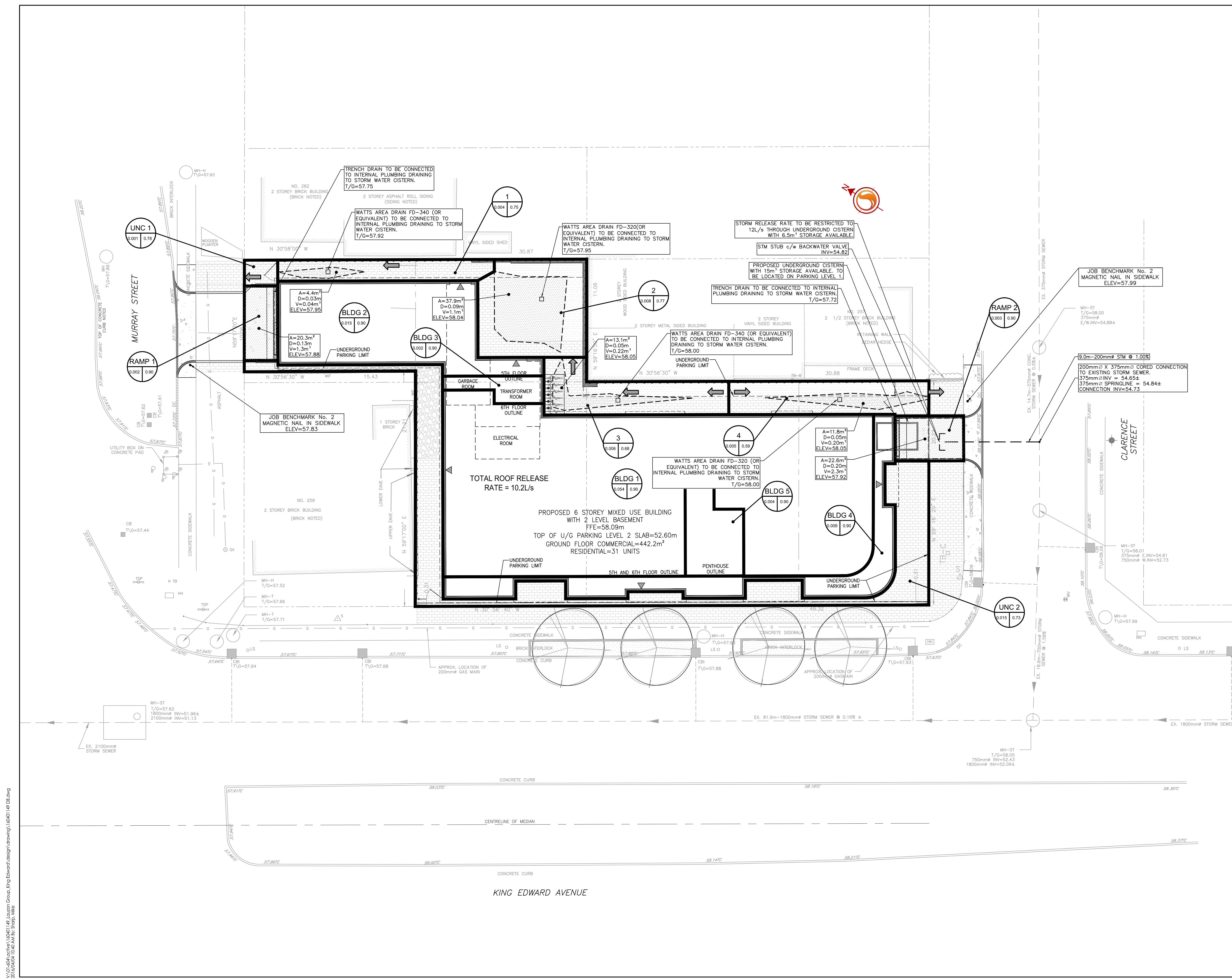

V:\01-00\active\160401149\Lauson Group\King Edward design\drawing\160401149.DWG
2016/04/16 04:16:40 AM By: Jhao, Mike