

GENERAL NOTES

- 1. ALL WORKS AND MATERIALS SHALL CONFORM TO THE LATEST REVISIONS OF THE STANDARDS AND SPECIFICATIONS FOR THE CITY OF OTTAWA, ONTARIO PROVINCIAL STANDARD DRAWINGS (OPSD), SPECIFICATIONS (SPS), AND COSTCO WHOLESALE DEVELOPMENT REQUIREMENTS DATED JUNE 2014 (CWR 2014) WHERE APPLICABLE. LOCAL UTILITY STANDARDS AND MINISTRY OF TRANSPORTATION STANDARDS WILL APPLY WHERE REQUIRED.
- 2. THE CONTRACTOR SHALL CONFIRM THE LOCATION OF ALL EXISTING UTILITIES WITHIN THE SITE AND ADJACENT WORK AREAS. THE CONTRACTOR SHALL BE RESPONSIBLE FOR PROTECTING ALL EXISTING UTILITIES TO THE SATISFACTION OF THE AUTHORITY HAVING JURISDICTION. THE CONTRACTOR SHALL BE RESPONSIBLE FOR THE REPAIR OR REPLACEMENT OF ANY SERVICES OR UTILITIES DISTURBED DURING CONSTRUCTION, TO THE SATISFACTION OF THE AUTHORITY HAVING JURISDICTION.

LEGEND

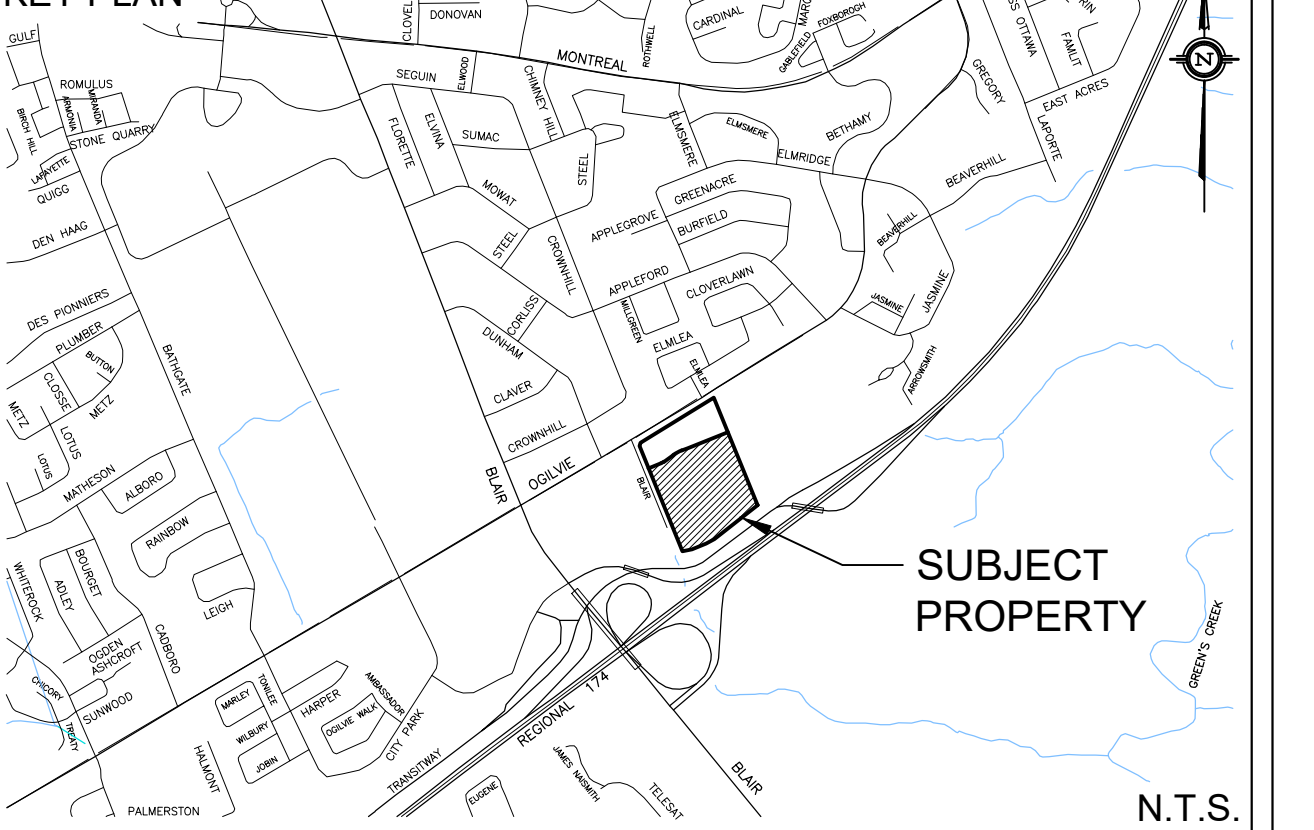

WATERMAIN NOTES

- 1. ALL WATERMAIN INSTALLATION SHALL CONFORM TO THE LATEST REVISIONS OF THE CITY OF OTTAWA AND THE ONTARIO PROVINCIAL STANDARD DRAWINGS (OPSD), SPECIFICATIONS (SPS), AND COSTCO WHOLESALE DEVELOPMENT REQUIREMENTS, DATED JUNE 2014 (CWR 2014).
- 2. ALL PVC WATERMANS SHALL BE AWWA C-900 CLASS 150, SDR 18 OR APPROVED EQUIVALENT.
- 3. WATERMAIN TRENCH AND BEDDING SHALL BE IN ACCORDANCE WITH CITY OF OTTAWA STANDARD W17, UNLESS SPECIFIED OTHERWISE. BEDDING AND COVER MATERIAL SHALL BE SPECIFIED BY THE PROJECT GEOTECHNICAL ENGINEER.

NOTE  
ALL SITE WORKS TO BE IN ACCORDANCE WITH COSTCO WHOLESALE DEVELOPMENT REQUIREMENTS DATED JUNE 2014 (CWR 2014)

PROPOSED 286.9 SQ. M. PARKLAND DEDICATION PARCEL FROM 2012 OGILVIE ROAD

CONTINUED ON SSP-1

N.T.S.

- 1. LASER ALIGNMENT CONTROL TO BE UTILIZED ON ALL SEWER INSTALLATIONS.
- 2. CLAY SEALS TO BE INSTALLED AS PER CITY STANDARD DRAWING S8. THE SEALS SHOULD BE AT LEAST 1.5m LONG (IN THE TRENCH DIRECTION) AND SHOULD EXTEND FROM TRENCH WALL TO TRENCH WALL. THE SEALS SHOULD EXTEND FROM THE PROJECT LINE AND FULLY PENETRATE THE TRENCH WALLS. THE SEAL MATERIALS SHOULD CONSIST OF RELATIVELY DRY AND COMPATIBLE BROWN SLTY CLAY PLACED IN MAXIMUM 250mm SPITS AND COMPACTED TO A MINIMUM OF 95% PROCTOR. THE CLAY SEALS SHOULD BE PLACED AT THE SITE BOUNDARIES AND AT 60m INTERVALS IN THE SERVICE TRENCHES.
- 3. SERVICES TO BUILDINGS TO BE TERNATED WITHIN 1.5m FROM THE EXTERIOR FACE OF BUILDING UNLESS OTHERWISE NOTED.
- 4. ALL MAINTENANCE STRUCTURE AND CATCH BASIN EXCAVATIONS TO BE BACKFILLED WITH GRANULAR MATERIAL COMPACTED TO 98% STANDARD PROCTOR SPECIFICATION, A MINIMUM OF 300mm AROUND STRUCTURES.

SANITARY AND STORM SEWER NOTES

- 1. SANITARY SEWER INSTALLATION SHALL CONFORM TO THE LATEST REVISIONS OF THE CITY OF OTTAWA AND THE ONTARIO PROVINCIAL STANDARD DRAWINGS (OPSD), SPECIFICATIONS (SPS), AND COSTCO WHOLESALE DEVELOPMENT REQUIREMENTS, DATED JUNE 2014 (CWR, 2014).
- 11. ALL SANITARY GRAVITY SEWER SHALL BE PVC SDR 35, IPEX TRING-TITE (OR APPROVED EQUIVALENT) PER CSA STANDARD B182.2 OR LATEST AMENDMENT, UNLESS SPECIFIED OTHERWISE.
- 12. EXISTING MAINTENANCE STRUCTURES TO BE RE-BECHED WHERE A NEW CONNECTION IS MADE.
- 13. SANITARY GRAVITY SEWER TRENCH AND BEDDING SHALL BE PER CITY OF OTTAWA STD. S6 AND S7, CLASS 'B' BEDDING, UNLESS SPECIFIED OTHERWISE.
- 14. SANITARY MAINTENANCE STRUCTURES SHALL BE COVERED PER OPSD 701.021.

INLET CONTROL DEVICE (ICD) DETAIL PLASTIC "PLUG" STYLE

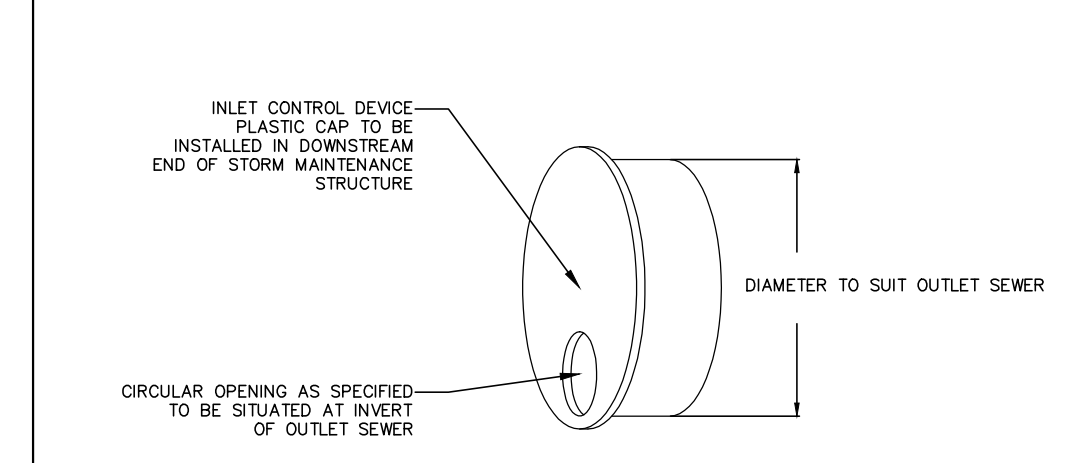

NOT TO SCALE

DIAMETER TO SUIT OUTLET SEWER

UNLESS OTHERWISE INDICATED BUILDING SERVICES TO BE WATER TO BE MIN. 25mm DIA. STORM 200mm DIA. AND SANITARY 150mm DIA. STORM AND SANITARY SERVICES TO BE @ 1.0% MIN

PROPOSED SANITARY, STORM AND WATER SERVICE SIZE TO BE SPECIFIED BY MECHANICAL ENGINEER. ROOF TOP STORM CONTROLS TO BE REVIEWED AND CONFIRMED BY MECHANICAL ENGINEER.

CONTRACTOR TO CONFIRM ELEVATIONS AND LOCATIONS OF EXISTING UNDERGROUND SERVICES AND UTILITIES WITHIN OGILVIE ROAD AND BLAIR PLACE RIGHT OF WAY PRIOR TO INSTALLATION OF SITE SERVICING INFRASTRUCTURE.

THE CONTRACTOR SHALL IMPLEMENT BEST MANAGEMENT PRACTICES, TO PROVIDE PROTECTION OF THE AREA DRAINAGE SYSTEM AND THE RECEIVING WATERBODIES DURING CONSTRUCTION ACTIVITIES. THE CONTRACTOR KNOWLEDGES THAT FAILURE TO IMPLEMENT APPROPRIATE EROSION AND SEDIMENT CONTROL MEASURES MAY BE SUBJECT TO PENALTIES IMPOSED BY ANY APPLICABLE REGULATORY AGENCY.

NOT FOR CONSTRUCTION

TOPOGRAPHIC INFORMATION  
TOPOGRAPHIC INFORMATION PROVIDED BY STANTEC GEOMATICS LTD.  
PROJ. NO. 161613044-111  
DATED MARCH 5, 2014

SITE PLAN INFORMATION  
SITE PLAN PROVIDED BY PETROFF PARTNERSHIP ARCHITECTS  
PROJ. NO. 13151  
DATED JULY 22, 2016

GEOTECHNICAL STUDY  
GEOTECHNICAL RECOMMENDATIONS PROVIDED BY INSP-EC ENGINEERING SOLUTIONS  
PROJ. NO. 1021399-11  
DATED JUNE 30, 2015

SITE SERVICING AND STORMWATER MANAGEMENT STUDY  
SERVICING AND STORMWATER MANAGEMENT RECOMMENDATIONS PROVIDED BY DSEL  
PROJ. NO. 13-694  
DATED JULY 2016

BENCH MARK  
TOP OF SPINDLE OF FIRE HYDRANT LOCATED AT INTERSECTION OF OGILVIE ROAD AND BLAIR PLACE  
ELEV=78.03

Table with columns: STATION, FINISHED GROUND, TOP WATERMAIN, DESCRIPTION. Lists data for PROPOSED WATERMAIN 'A'.

Table with columns: STATION, FINISHED GROUND, TOP WATERMAIN, DESCRIPTION. Lists data for PROPOSED WATERMAIN 'C'.

Table with columns: STATION, FINISHED GROUND, TOP WATERMAIN, DESCRIPTION. Lists data for PROPOSED 150mm DIAMETER HYDRANT LEAD.

Table with columns: STATION, FINISHED GROUND, TOP WATERMAIN, DESCRIPTION. Lists data for PROPOSED 200mm DIAMETER HYDRANT LEAD.

Table with columns: STATION, FINISHED GROUND, TOP WATERMAIN, DESCRIPTION. Lists data for PROPOSED 150mm DIAMETER HYDRANT LEAD.

Table with columns: STATION, FINISHED GROUND, PROPOSED 250mm DIAMETER WATERMAIN 'B', DESCRIPTION. Lists data for PROPOSED 250mm DIAMETER WATERMAIN 'B'.

Table with columns: STATION, FINISHED GROUND, TOP WATERMAIN, DESCRIPTION. Lists data for PROPOSED 250mm DIAMETER HYDRANT LEAD.

Table with columns: STATION, FINISHED GROUND, TOP WATERMAIN, DESCRIPTION. Lists data for PROPOSED 150mm DIAMETER HYDRANT LEAD.

Table with columns: PIPE CROSSING #, PIPE INVERT, PIPE EVERT, SEPARATION (m). Lists data for CONFLICT TABLE.

Table with columns: STATION, FINISHED GROUND, TOP WATERMAIN, DESCRIPTION. Lists data for PROPOSED 150mm DIAMETER HYDRANT LEAD.

PROJECT No. 13-694

SITE SERVICING PLAN  
2012 OGILVIE ROAD - PHASE 2 © DSEL

Logos for Trinity and DSEL. Address: 359 Kent Street, Suite 400 Ottawa, Ontario, K2P 0R6 Tel. (613) 565-5864. 120 Iher Road Unit 203 Stittsville, Ontario, K2S 1E9 Tel. (613) 836-0856 Fax. (613) 836-7183 www.DSEL.ca

Table with columns: DRAWN BY, DESIGNED BY, SCALE, CHECKED BY, CHECKED BY, DATE, DRAWING NO., SHEET NO. Values: B.N.C., S.L.M., 1:500, A.D.F., July 2016, SSP-2, 4 of 6