

SCHEDULE OF EXISTING TREES
(Inventory conducted Sept. 17, 2013)

CODE	SPECIES	SIZE (dia tr cm)	CONDITION / TREATMENT / REMARKS
1	Linden	25	good / remove / development conflict
2	Linden	25	good / remove / development conflict
3	Linden	25	good / remove / development conflict
4	Linden	25	good / remove / development conflict
5	Linden	25	good / remove / development conflict
6	Linden	25	good / remove / development conflict
7	Linden	25	good / remove / development conflict
8	Linden	25	good / remove / development conflict
9	Linden	25	good / retain / protect
10	Linden	25	good / retain / protect
11	Linden	25	good / retain / protect
12	Linden	25	good / retain / protect
13	Linden	25	good / retain / protect
14	Linden	25	good / retain / protect
15	Linden	25	good / retain / protect
16	Linden	25	good / retain / protect
17	Linden	25	good / retain / protect
18	Linden	25	good / retain / protect
19	Linden	25	good / retain / protect
20	Maple	50	good / retain / protect
21	Maple	35	good / retain / protect
22	Elm	50	fair - poor / remove / hazardous / conflict
23	Elm	10	fair - poor / remove / hazardous / conflict
24	Elm	10	fair - poor / remove / hazardous / conflict
25	Elm	10	fair - poor / remove / hazardous / conflict
26	Elm	10	fair - poor / remove / hazardous / conflict
27	Elm	10	fair - poor / remove / hazardous / conflict
28	Elm	30	fair - poor / remove / hazardous / conflict
29	Elm	30	fair - poor / remove / hazardous / conflict
30	Elm	10	fair - poor / remove / hazardous / conflict
31	Elm	30	fair - poor / remove / hazardous / conflict
32	Elm	19	fair - poor / remove / hazardous / conflict
33	Elm	19	fair - poor / remove / hazardous / conflict
34	Poplar	40	good / remove / development conflict
35	Elm	50	fair - poor / remove / hazardous
36	Poplar	50	fair - poor / remove / development conflict
37	Manitoba Maple	25	good / coppice growth / retain / protect
38	Manitoba Maple	20	good / coppice growth / retain / protect
39	Manitoba Maple	60	good / coppice growth / retain / protect
40	Elm	50	good / retain / protect
41	Poplar	40	dead / remove
42	Ash	20	dead / remove
43	SHADED AREA NOT PART OF THIS APPLICATION		
44	Linden	40	good / retain / protect
45	Linden	25	good / remove / development conflict

PLANT MATERIAL SCHEDULE

CODE	BOTANICAL NAME	COMMON NAME	QTY.	SIZE	REMARKS
DECIDUOUS TREES					
AC	AMELANCHIER CANADENSIS	SHADBLOW SERVICEBERRY	3	50mm cal	B&B, single stem
AS	ACER SACCHARINUM	SUGAR MAPLE	3	60mm cal	B&B, single stem
CO	CORNUS OCCIDENTALIS	COMMON HOCKBERRY	19	60mm cal	B&B, single stem
GBA	GINKGO BILOBA	AUTUMN GOLD MADEHUNKAH TREE	12	60mm cal	B&B, single stem
GT	QUERCUS TRILICATA	SKYLINE HONEYLOCUST	13	60mm cal	B&B, single stem
SKYLINE					
MAG	MALUS AUTUMN GOLD	AUTUMN GOLD CRABAPPLE	3	50mm cal	B&B, single stem
MBS	MALUS BACCATA	SIBERIAN CRABAPPLE	4	50mm cal	B&B, single stem
QMI	QUERCUS MACROCARPA	PINK SPIRES CRABAPPLE	9	50mm cal	B&B, single stem
OR	QUERCUS RUBRA	BUR OAK	1	60mm cal	B&B, single stem
SR	SYRINGA RETICULATA	IVORY SILK JAPANESE TREE LILAC	3	60mm cal	B&B, single stem
SILK					
TC	TILIA CORDATA	CHANCELLOR LINDEN	12	50mm cal	B&B, single stem
CONIFEROUS TREES					
AB	ABIES BALSAMICA	BALSAM FIR	4	180 cm ht	B&B
PB	PINUS BANKSIANA	JACK PINE	19	180 cm ht	B&B
PG	PICUS GLAUCA	WHITE SPRUCE	13	180 cm ht	B&B
PR	PINUS RESINOSA	RED PINE	11	180 cm ht	B&B
PS	PINUS STROBUS	WHITE PINE	10	180 cm ht	B&B
SHRUBS					
DL	DIERILLA LONGIFLORA	BUSH HONEYSUCKLE	424	50cm ht	potted, 100cm o/c
PAFW	PARROTULIA FRUTICOSA	PARROT WHISPER CINQUEFOIL	146	50cm ht	pottd, 80cm o/c
PRY	POTENTILLA FRUTICOSA	YELLOW GEM CINQUEFOIL	429	50cm ht	pottd, 80cm o/c
GEM					
PO	PHYSCARRUPUS OPULEFOLIS	COMMON NINEBARK	130	50cm ht	pottd, 100cm o/c
RB	ROSA BLANDA	SHRUB ROSE	148	50cm ht	pottd, 100cm o/c
RCA	ROSA CHARLES ALBANEL	CHARLES ALBANEL EXPLORER	142	50cm ht	pottd, 80cm o/c
RIA	RHUS AROMATICA	ROSE (magenta)	216	50cm ht	pottd, 100cm o/c
SFR	SPIRAEA BIMALUDA FROEBELI	FRAGRANT SUMAC	148	50cm ht	pottd, 100cm o/c
PERENNIALS / GRASSES					
Cal	CALAMAGROSTIS acutiflora 'Karl Foerster'	FEATHER REED GRASS	155	1 gal.	plant 75cm o/c
Hem	HEMEROCALLIS cultivars	Stella Doré DAYLILY	389	20 cm pot	plant 50cm o/c

GENERAL NOTES

- This drawing shall be read in conjunction with all relevant Architectural, Engineering and related Drawings and Documents.
- Refer to Engineering Drawings for Grading and Sizing.
- Refer to Architectural Drawings for Site Layout.
- Contractor shall provide the location(s) of all services/utilities by consulting Municipal Authorities and Utility companies and shall be responsible for adequate protection during construction.
- Plant material shall be No. 1 Grade and shall comply with the Native Guide Specifications for Nurseries (latest edition), published by the Canadian Nursery Trades Association.
- Plant Material locations are Schematic / Approximate only. Contractor shall stake out locations on site prior to work.
- Shrubs shall be planted in a continuous prepared bed of 450mm depth planting soil mix covered over with a woven polypropylene weed control fabric (LANDSCAPE FABRIC-Green-Line by Threco-LINQ) and 75mm depth composted pine mulch to finish grade, as specified.
- Perennials and Ornamental Grasses shall be planted in a continuous prepared bed of 450mm depth planting soil mix covered over with 75mm depth composted pine mulch to finish grade. **NO WEED CONTROL FABRIC**, as specified.
- Sod areas to receive 125mm topsoil. Sod shall be No. 1 quality conforming to the Canadian Nursery Sod Growers Specification.
- Reinstate all areas damaged or disturbed beyond the limit of Work.
- Contractor shall guarantee all plant material for a period of one (1) full year from the date of final acceptance.
- Plant Material substitutions shall not be permitted without written approval from the Consultant.
- THIS PLAN HAS BEEN PREPARED FOR MUNICIPAL SITE PLAN APPROVAL AND MAY NOT BE USED FOR ANY OTHER PURPOSE.**

DRAWING NOTES

- BICYCLE RACK: 4-Ring (7 Capacity) Ring Rack by Bike-Up Bicycle Parking Systems Inc. (Ontario 613-226-9432) Finish: Galvanized
- AGGREGATE: 200mm depth of the following, over geotextile fabric: 100% 3/8" - 5/8" Natural Washed (granite) stone from Nesbitt Aggregate Ltd., Renfrew ON (or approved equal)

LEGEND / SYMBOL

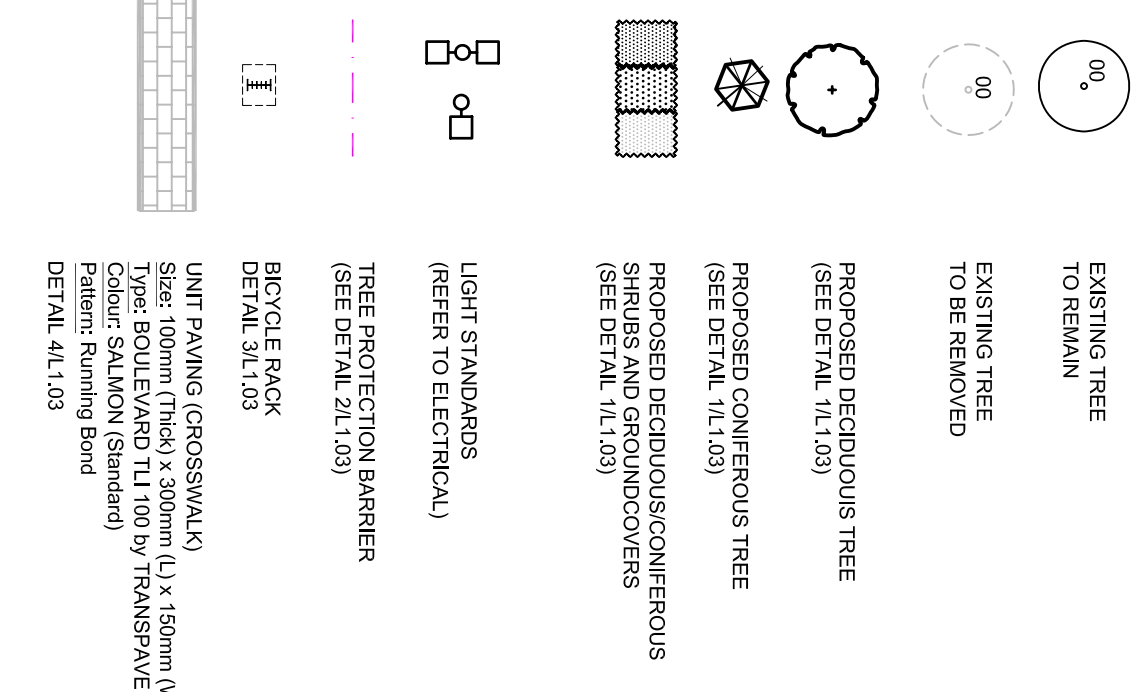

FORESTRY SERVICES BRANCH IS TO CONTACT TO ARRANGE FOR THE REMOVAL OF ANY TREE REMOVAL AND/OR ON-SITE ALONG BLAIR PLACE ONCE THEY ARE FULLY INSTALLED. ALL THE COMMENCEMENT OF ANY TREE REMOVAL AND/OR ON-SITE WORKS AND MAINTENANCE FOR THE DURATION OF CONSTRUCTION.

NOT FOR CONSTRUCTION

NO.	DATE	REVISION	BY	DATE
1	JULY 29/16	PER CITY COMMENTS (1)		
2	MAY 17/16	ISSUE FOR SPA		

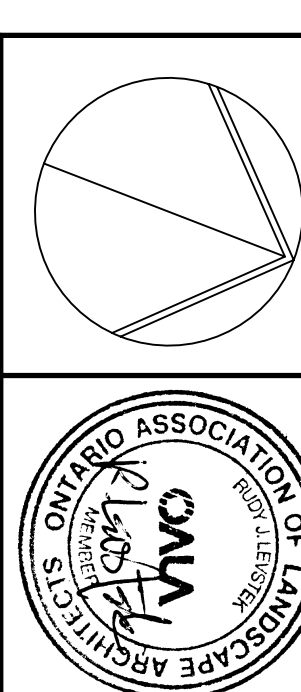

Contractor shall check and verify all dimensions to the Consultant. Work to be done in accordance with all applicable codes and by-laws. Do not scale Drawing.

Copyright reserved. This Drawing is the exclusive property of Levestek Consultants. All rights reserved and shall not be used without consent.

LEVSTEK CONSULTANTS
LANDSCAPE ARCHITECTS
5871 HURON CAVENDISH, OTTAWA, ONTARIO • K2A 3W6
613-828-9518

TRINITY

Project: **SHOPPER'S CITY EAST**
2012 OGILVIE ROAD, OTTAWA

BLOCK B

Drawing Title: **LANDSCAPE PLAN**

Scale: 1:400

Date: **AUG 2015**

Project No.: 1076.05

Drawing No.: **L1.01**

OF 3

