

ASPHALT CROSS-SECTIONS TO CONFORM TO TABLE 3 AND 4 WITHIN THE SECTION 5.6 OF THE GEOTECHNICAL REPORT COMPLETED BY PATERSON GROUP (REF NO. PG3905-1) DATED DECEMBER 16, 2016.

- GENERAL NOTES**
1. THE ORIGINAL TOPOGRAPHY, GROUND ELEVATION AND SURVEY DATA SHOWN ARE SUPPLIED FOR INFORMATION PURPOSES ONLY, AND IMPLY NO GUARANTEE OF ACCURACY. IT SHALL BE THE RESPONSIBILITY OF THE CONTRACTOR TO VERIFY ALL INFORMATION SHOWN.
 2. THIS PLAN IS NOT A CADASTRAL SURVEY SHOWING LEGAL PROPERTY BOUNDARIES AND EASEMENTS. THE PROPERTY BOUNDARIES SHOWN HEREON HAVE BEEN DERIVED FROM INFORMATION SUPPLIED BY (OR SHOWN ON) MCINTOSH PERRY SURVEYING INC. DATED NOVEMBER 02, 2016 AND CANNOT BE RELIED UPON TO BE ACCURATE OR COMPLETE. THE PRECISE LOCATION OF THE CURRENT PROPERTY BOUNDARIES AND EASEMENTS CAN ONLY BE DETERMINED BY AN UP-TO-DATE LAND TITLES SEARCH AND A SUBSEQUENT CADASTRAL SURVEY PERFORMED AND CERTIFIED BY AN ONTARIO LAND SURVEYOR.
 3. SURVEY ELEVATIONS FROM MP51, SURVEY PLAN # 15-4344, ELEVATIONS DERIVED FROM THE FOLLOWING COSINE GEODETIC BENCHMARK ARE 0.76m LOWER THAN ELEVATIONS SHOWN ON THE PLAN:
 3.1 STATION: 001368/112-1
 3.2 VERTICAL DATUM: CGVD-1928-1978
 3.3 ORTHOMETRIC ELEVATION: 126.180
 3.4 LOCATION: OTTAWA - CONCRETE CULVERT, UNDER HIGHWAYS NO. 7 AND 15, 1.6km SOUTHWEST OF INTERSECTION WITH STITTSVILLE-CARP ROAD, TABLE IN TOP OF CULVERT, 34cm FROM SOUTH END, 27cm FROM WEST EDGE, 11.3m FROM CENTER LINE OF ROAD, 1m BELOW ROAD LEVEL.
 4. THE CONTRACTOR IS TO OBTAIN AND PAY FOR ALL NECESSARY PERMITS AND APPROVALS FROM THE CITY OR TOWNSHIP BEFORE COMMENCING CONSTRUCTION.
 5. THE CONTRACTOR IS RESPONSIBLE FOR ALL LAZYT.
 6. THE CONTRACTOR IS TO DETERMINE THE EXACT LOCATION, SIZE, MATERIAL AND ELEVATION OF ALL EXISTING UTILITIES PRIOR TO COMMENCING CONSTRUCTION. PROTECT AND ASSUME ALL RESPONSIBILITY FOR EXISTING UTILITIES WHETHER OR NOT SHOWN ON THESE DRAWINGS. IF THERE IS ANY DISCREPANCY THE CONTRACTOR IS TO NOTIFY THE ENGINEER PROMPTLY.
 7. ALL 'GREEN AREAS' TO BE TREATED WITH 150mm TOPSOIL AND SOD AS SOON AS FEASIBLE.
 8. RESTORE ALL TRENCHES AND SURFACES OF PUBLIC ROAD ALLOWANCES TO CONDITION EQUAL OR BETTER THAN ORIGINAL CONDITION AND TO THE SATISFACTION OF THE CITY OR TOWNSHIP AUTHORITIES.
 9. EXCAVATE AND DISPOSE OF ALL EXCESS EXCAVATED MATERIAL, SUCH AS ASPHALT, CURBING AND DEBRIS, OFF SITE AS DIRECTED BY THE ENGINEER AND THE CITY OR TOWNSHIP.
 10. TOPSOIL TO BE STRIPPED AND STOCKPILED FOR REHABILITATION. CLEAN FILL TO BE PLACED IN FILL AREAS AND COMPACTED TO 95% STANDARD PROCTOR DENSITY.
 11. ALL DISTURBED AREAS TO BE RESTORED TO ORIGINAL CONDITION OR BETTER UNLESS OTHERWISE SPECIFIED.
 12. THE CONTRACTOR SHALL BE RESPONSIBLE FOR ALL TRAFFIC CONTROL AND SAFETY MEASURES DURING THE CONSTRUCTION PERIOD, INCLUDING THE SUPPLY, INSTALLATION, AND REMOVAL OF ALL NECESSARY SIGNAGE, DELINEATORS, MARKERS AND BARRIERS.
 13. DO NOT ALTER GRADING OF THE SITE WITHOUT PRIOR APPROVAL OF THE CITY OR TOWNSHIP.
 14. ALL ROADWAY, PARKING LOT, AND GRADING WORKS TO BE UNDERTAKEN IN ACCORDANCE WITH CITY OR TOWNSHIP STANDARDS AND SPECIFICATIONS. THE CONTRACTOR IS TO PROVIDE POSITIVE DRAINAGE AWAY FROM THE BUILDING.
 15. CONTACT THE CITY OR TOWNSHIP FOR INSPECTION OF ROUGH GRADING OF PARKING LOTS, ROADWAYS AND LANDSCAPED AREAS PRIOR TO PLACEMENT OF ASPHALT AND TOPSOIL. ALL DEFICIENCIES NOTED SHALL BE RECTIFIED TO THE TOWNSHIP'S SATISFACTION PRIOR TO PLACEMENT OF ANY ASPHALT, TOPSOIL, SEED & MULCH AND/OR SOD.
 16. ALL DIMENSIONS AND INVERTS MUST BE VERIFIED PRIOR TO CONSTRUCTION, IF THERE IS ANY DISCREPANCY THE CONTRACTOR IS TO NOTIFY THE ENGINEER PROMPTLY.
 17. HYDRO, GAS, TELEPHONE AND TELEVISION SERVICE LOCATIONS SUBJECT TO THE APPROVAL AGENCY:
 • GAS SERVICE - ENBRIDGE
 • TELEPHONE SERVICE - BELL CANADA
 • TELEVISION SERVICE - ROGERS
 18. INSTALLATION TO BE IN ACCORDANCE WITH CURRENT CODES AND STANDARDS OF APPROVAL AGENCIES BELL, HYDRO AND THE CITY OR TOWNSHIP.
 19. ALL PROPOSED CURB SHALL BE CONCRETE BARRIER CURB UNLESS SPECIFIED.
 20. ALL EXISTING REDUNDANT PRIVATE APPROACHES FRONTING THIS DEVELOPMENT MUST BE REMOVED TO THE SATISFACTION OF THE CITY OR TOWNSHIP.
 21. THIS PLAN MUST BE READ IN CONJUNCTION WITH GEOTECHNICAL REPORT BY PATERSON GROUP INC. REPORT # PG3905-1 DATED JANUARY 3, 2016, AND SITE SERVING REPORT BY MCINTOSH PERRY REPORT # CP-15-0429 DATED, FEBRUARY 1, 2018.

- EROSION AND SEDIMENT CONTROL**
1. THE CONTRACTOR SHALL IMPLEMENT BEST MANAGEMENT PRACTICES, TO PROVIDE FOR PROTECTION OF THE AREA DRAINAGE SYSTEM AND THE RECEIVING WATERCOURSE, DURING CONSTRUCTION ACTIVITIES. THIS INCLUDES LIMITING THE AMOUNT OF EXPOSED SOIL, TEMPORARY SEDIMENT CONTROL (GEO SOCKS/INSETS WITH AN OVERFLOW UNDER GRATE OR COVER) TO BE IMPLEMENTED DURING CONSTRUCTION ON ALL PROPOSED ROAD CATCHBASINS, REAR YARD CATCHBASINS AND CATCHBASIN MANHOLES AND OTHER SEDIMENT TRAPS. NO RECYCLED GEO SOCK MATERIAL SHALL BE PERMITTED FOR USE ON SITE.
 2. AT THE DISCRETION OF THE PROJECT MANAGER OR MUNICIPAL STAFF, ADDITIONAL SILT CONTROL DEVICES SHALL BE INSTALLED AT DESIGNATED LOCATIONS.
 3. FOR SILT FENCE BARRIER, USE OPSD 219.110. GEOTEXTILE FOR SILT FENCE AS PER OPSD 1860, TABLE 3.
 4. EXCEPT AS PROVIDED IN PARAGRAPHS 4.1, and 4.2. BELOW, STABILIZATION MEASURES SHALL BE INITIATED AS SOON AS FEASIBLE IN PORTIONS OF THE SITE WHERE CONSTRUCTION ACTIVITIES HAVE TEMPORARILY OR PERMANENTLY CEASED, BUT IN NO CASE MORE THAN 14 DAYS AFTER THE CONSTRUCTION ACTIVITY HAS TEMPORARILY OR PERMANENTLY CEASED.
 4.1. WHERE THE INITIATION OF STABILIZATION MEASURES BY THE 14TH DAY AFTER CONSTRUCTION ACTIVITY TEMPORARILY OR PERMANENTLY CEASES IS PRECLUDED BY SNOW COVER, STABILIZATION MEASURES SHALL BE INITIATED AS SOON AS FEASIBLE.
 4.2. WHERE CONSTRUCTION ACTIVITY WILL RESUME ON A PORTION OF THE SITE WITHIN 21 DAYS FROM WHEN ACTIVITIES CEASED, (E.G. THE TOTAL TIME PERIOD THAT CONSTRUCTION ACTIVITY IS TEMPORARILY CEASED IS LESS THAN 21 DAYS) THEN STABILIZATION MEASURES DO NOT HAVE TO BE INITIATED ON THAT PORTION OF SITE BY THE 14TH DAY AFTER CONSTRUCTION ACTIVITY TEMPORARILY CEASED.
 5. SEDIMENT THAT IS ACCUMULATED BY THE TEMPORARY EROSION AND SEDIMENT CONTROL MEASURES SHALL BE REMOVED IN A MANNER THAT AVOIDS ESCAPE OF THE SEDIMENT TO THE DOWNSTREAM SIDE OF THE CONTROL MEASURE AND AVOIDS DAMAGE TO THE CONTROL MEASURE. SEDIMENT SHALL BE REMOVED TO THE LEVEL OF THE GRADE EXISTING AT THE TIME THE CONTROL MEASURE WAS CONSTRUCTED AND BE ACCORDING TO THE FOLLOWING:
 5.1. FOR LIGHT-DUTY SEDIMENT BARRIERS, ACCUMULATED SEDIMENT SHALL BE REMOVED ONCE IT REACHES THE LESSER OF THE FOLLOWING:
 5.1.1. A DEPTH OF ONE-HALF THE EFFECTIVE HEIGHT OF THE CONTROL MEASURE.
 5.1.2. A DEPTH OF 300 MM IMMEDIATELY UPSTREAM OF THE CONTROL MEASURE.
 5.2. FOR ALL CONTROL MEASURES, ACCUMULATED SEDIMENT SHALL BE REMOVED AS NECESSARY TO PERFORM MAINTENANCE REPAIRS.
 5.3. ACCUMULATED SEDIMENT SHALL BE REMOVED PRIOR TO THE REMOVAL OF THE CONTROL MEASURE.
 5.4. ACCUMULATED SEDIMENT IS TO BE REMOVED AND DISPOSED OF AS PER OPSD 180.
 6. ALL TEMPORARY EROSION AND SEDIMENT CONTROL MEASURES SHALL BE MONITORED TO ENSURE THEY ARE IN EFFECTIVE WORKING ORDER. THE CONDITION OF THE CONTROL MEASURES SHALL BE MONITORED PRIOR TO ANY FORECAST STORM EVENT AND FOLLOWING A STORM EVENT.
 7. DUST CONTROL MEASURES SHOULD BE CONSIDERED PRIOR TO CLEARING AND GRADING. THE USE OF WATER, CALCIUM CHLORIDE FLAKES/SOLUTION OR MAGNESIUM CHLORIDE FLAKES/SOLUTION SHALL BE USED AS DUST SUPPRESSANTS AS PER OPSD 506. THIS IS TO LIMIT WIND EROSION OF SOILS WHICH MAY TRANSPORT SEDIMENTS OFFSITE, WHERE THEY MAY BE WASHED INTO THE RECEIVING WATER BY THE NEXT RAINSTORM.
 8. ALL 'GREEN AREAS' TO BE TREATED WITH 150mm TOPSOIL AND SOD AS SOON AS FEASIBLE, AS PER OPSD 570.
 9. TOPSOIL TO BE STRIPPED AND STOCKPILED FOR REHABILITATION. CLEAN FILL TO BE PLACED IN FILL AREAS AND COMPACTED TO 95% STANDARD PROCTOR DENSITY.
 10. ALL DISTURBED AREAS TO BE RESTORED TO ORIGINAL CONDITION OR BETTER UNLESS OTHERWISE SPECIFIED.
 11. STOCKPILED MATERIAL IS TO BE STORED AWAY FROM POTENTIAL RECEIVERS (E.G. STORM CATCHBASINS, MANHOLES), AND BE SURROUNDED BY EROSION CONTROL MEASURES WHERE MATERIAL IS LEFT IN PLACE IN EXCESS OF 14 DAYS.
 12. IF REQUIRED, DEWATERING/SETTLING BASINS SHALL BE CONSTRUCTED AS PER OPSD 219.240 AND LOCATED ON FLAT GRADE UPSTREAM OF OTHER EXISTING MITIGATION MEASURES. WATERCOURSES SHALL NOT BE DIVERTED, OR BLOCKED, AND TEMPORARY WATERCOURSES CROSSINGS SHALL NOT BE CONSTRUCTED OR UTILIZED, UNLESS OTHERWISE SPECIFIED IN THE CONTRACT. IF CLOSURE OF ANY PERMANENT WATER PASSAGE IS NECESSARY, THE CONTRACTOR SHALL RELEASE ANY STRANDED FISH TO THE OPEN PORTION OF THE WATERCOURSE WITHOUT HARM.
 13. ALL EROSION AND SEDIMENT CONTROL MEASURES SHALL CONFORM TO OPSD 577
 14. WHERE DEWATERING IS REQUIRED, THE DISCHARGED WATER SHALL BE CONTROLLED IN ACCORDANCE WITH OPSD 518.
 15. ALL SETTLING/FILTRATION BASINS SHALL BE EQUIPPED WITH TERRAFIX 270R GEOTEXTILE (OR APPROVED EQUIVALENT) AND SHALL BE CLEANED AND REPLACED AS REQUIRED.
 16. MUD MATS ARE TO BE INSTALLED AND MAINTAINED BY THE CONTRACTOR AT ALL ENTRANCES TO THE SITE.

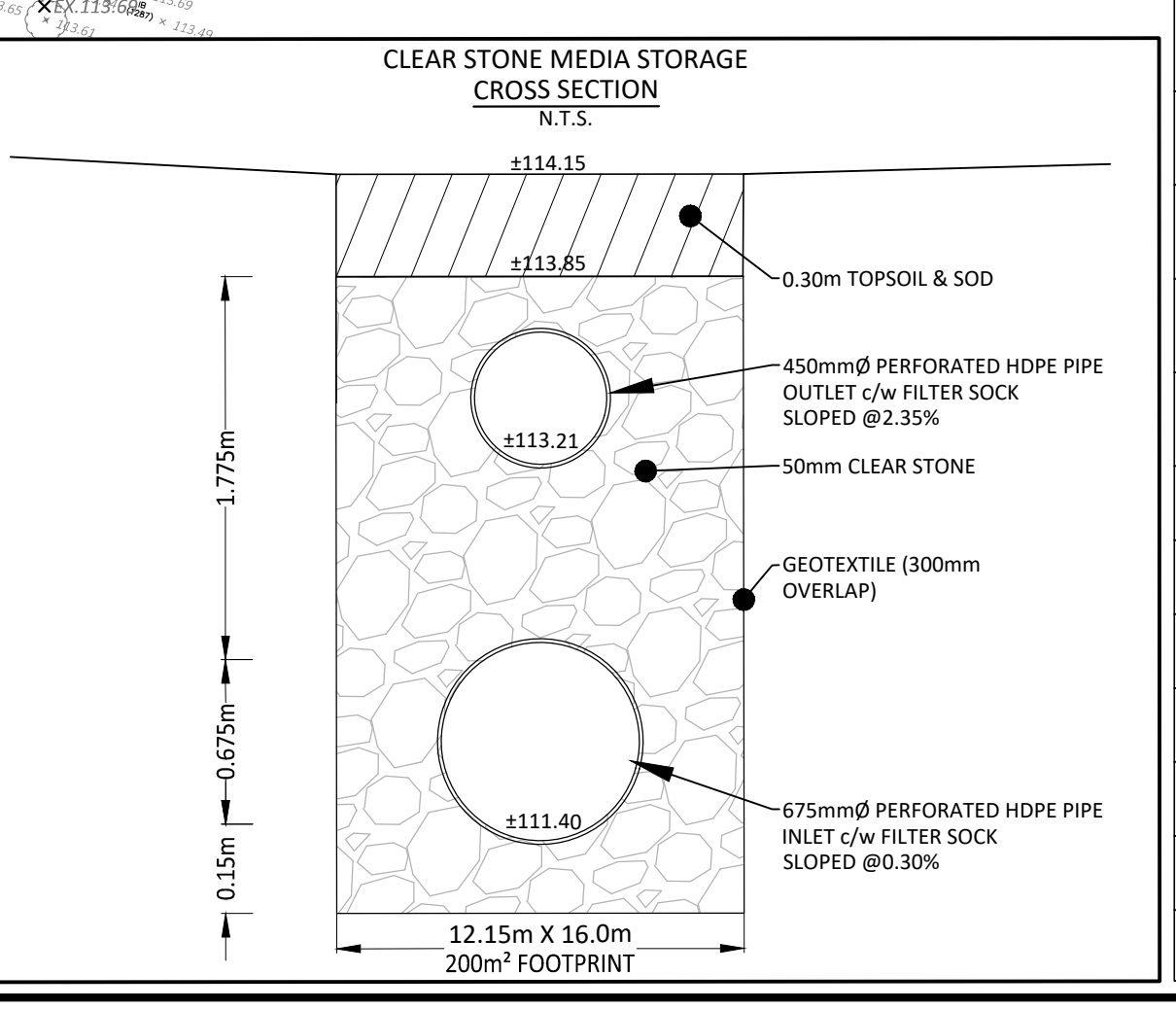
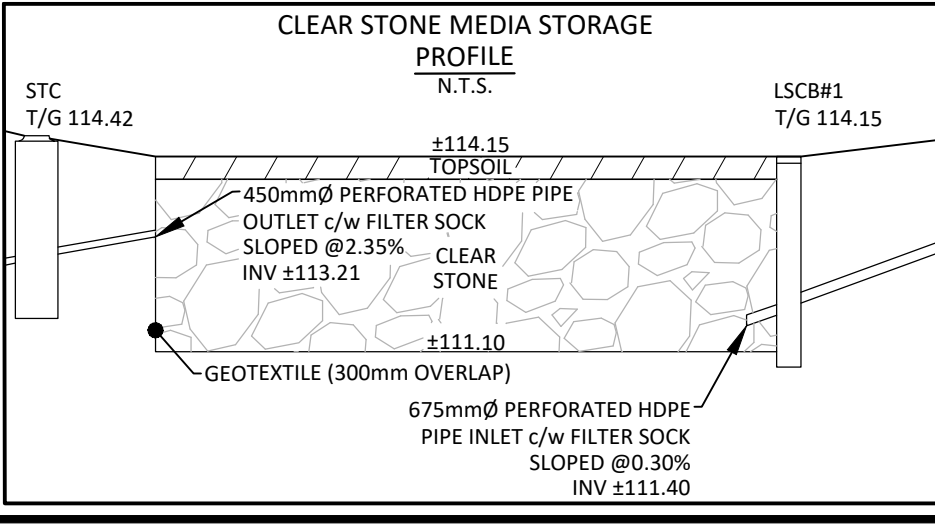
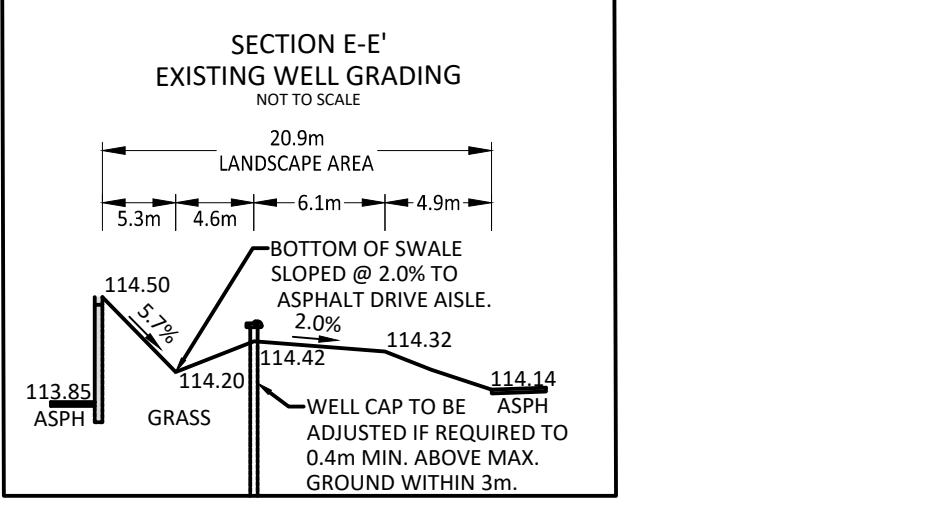

APPROVED REFUSED
 DATE _____
 Adam Brown, Manager, Development Review,
 Rural Services

STM NETWORK STRUCTURE TABLE

NAME	RIM ELEV.	INVERT IN	INVERT OUT	DESCRIPTION
CB#9	114.30	E113.121		OPSD 705.010 FRAME 704.010 COVER S19.1
CBMH#2	113.45	SE111.584	NW111.509	OPSD 701.010 FRAME S25 COVER S19
CBMH#3	113.60	NE111.957	NW111.882	OPSD 701.010 FRAME S25 COVER S19
CBMH#7	114.46	W112.776 E112.651	S112.576	OPSD 701.010 FRAME S25 COVER S19
CBMH#8	114.30	W112.949	E112.899	OPSD 701.010 FRAME S25 COVER S19
CBMH#10	114.12	E112.751	W112.721	OPSD 701.010 FRAME 704.010 COVER S19.1
LSCB#1	114.15	SE111.400	NW111.400	SMOOTH EXTERIOR CB SOLENO (33P183P)
LSCB#4	114.07	N112.131	SW112.056	SMOOTH EXTERIOR CB SOLENO (33P243P)
LSCB#5	114.40	NW112.341	S112.311	SMOOTH EXTERIOR CB SOLENO (33P243P)
LSCB#6	115.05	N112.465	SE112.435	SMOOTH EXTERIOR CB SOLENO (33P243P)
LSCB#11	114.80	W113.266	SW113.266	SMOOTH EXTERIOR CB SOLENO (33P243P)
LSCB#12	113.71	S113.186		SMOOTH EXTERIOR CB SOLENO (33P183P)
STC	114.42	E113.000	W112.993	STORMCEPT STC 4000 OR APPROVED EQUIVALENT

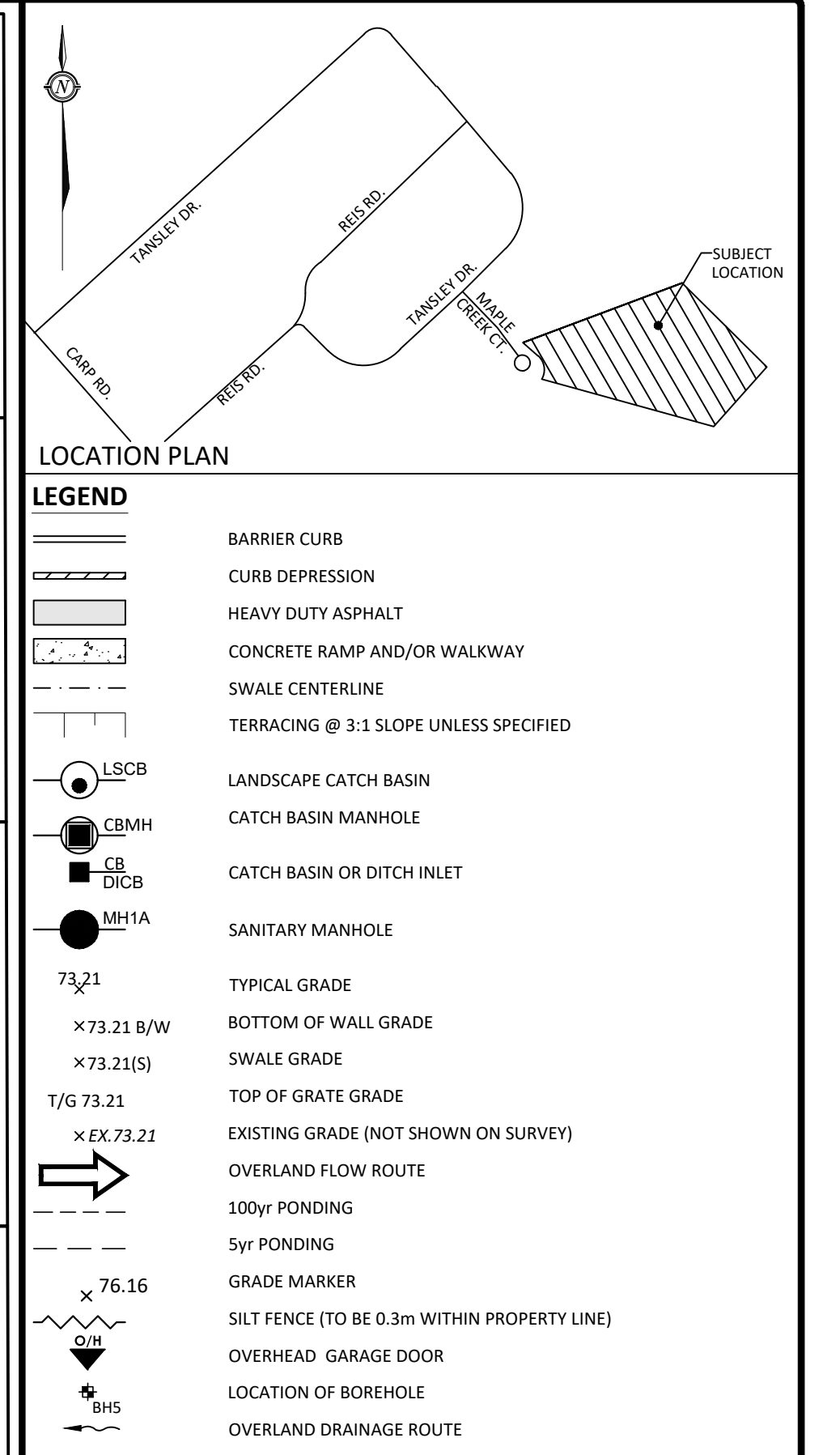

No.	Revision/Issue	Date
04	REVISED PER CITY COMMENTS	DEC 17, 2019
03	ISSUED FOR CITY REVIEW	FEB 5, 2018
02	REVISED PER CITY COMMENTS	JAN 26, 2018
01	ISSUED FOR SITE PLAN CONTROL	JAN 20, 2017

Check and verify all dimensions before proceeding with the work. Do not scale drawings.
 SCALE 1:500
 0 10 20 30 40 50 Metres

McINTOSH PERRY
 115 Walgreen Road, RR3, Carp, ON K0A 1L0
 Tel: 613-836-2184 Fax: 613-836-3742
 www.mcintoshperry.com

Client:
BBS CONSTRUCTION (ONTARIO) LTD.
 1805 WOODWARD DRIVE OTTAWA, ON, K2C 0P9
 P: 613-226-8830 F: 613-226-7709

Project:
 210/220 MAPLE CREEK COURT
WALL SOUND PROPOSED WAREHOUSE DEVELOPMENT
 OTTAWA ONTARIO

Drawing Title:
LOT GRADING, DRAINAGE, SEDIMENT AND EROSION CONTROL PLAN

Scale: 1:500 Project Number:
 Drawn by: SVL/PKG
 Checked by: RPK/CJM
 Designed by: SVL/PKG
 Date: NOV 25, 2016 SHEET 1 of 3

CP-15-0429
C101

FILENAME: I:\2016 Projects - Professional\2016\CP15-0429\CP15-0429_BBS_Site Plan_210 Maple Creek Court\CP15-0429_PRESENTATION.dwg
 LAST SAVED: Thursday, December 17, 2015 1:00:00 PM
 LAST PLOTTED: Thursday, December 10, 2015 9:03:00 AM

D07-12-17-0112