

EXISTING TREE INVENTORY - TREE GROUPING

Group	Botanical Name	Common Name	% Composition	DBH Min-Max	Remarks	Remarks
A	Acer negundo	Manitoba Maple	80	10-30cm	Good	Conflict trees to be removed
	Ulmus spp.	Elm	20	10-40cm	Poor/Mostly dead	Conflict trees to be removed
	Ulmus spp.	Elm	20	10-40cm	Poor/Mostly dead	Conflict trees to be removed
Understory	Acer negundo	Manitoba Maple	50	5-10cm	Good	Conflict trees to be removed
	Rhamnus cathartica	Glossy Buckthorn	30	5cm	Good	Conflict trees to be removed
	Rhus typhina	Staghorn Sumac	20	5cm	Good	Conflict trees to be removed

EXISTING TREE INVENTORY - SINGLE TREE

No.	Botanical Name	Common Name	DBH (m)	CRZ (m)	Condition	Remarks	Recomm.
1	Acer x freemanii	Freeman Maple	1.40	14.00	F	Old wound 0.2m above base rotted out. Otherwise healthy. Multi-stem from 1.75m	Remove
2	Sorbus spp	Mountain Ash	0.11	1.10	F	Multi-stem / Dieback / Thin canopy	Remove
3	Acer negundo	Manitoba Maple	0.28	2.80	P	Multi-stem / Multiple large wounds / Poor form	Remove
4	Acer negundo	Manitoba Maple	0.31	3.10	P	Multi-stem / One large stem alive but prostrate to ground / Poor form	Remove
5	Acer negundo	Manitoba Maple	0.23	2.30	F		Remove
6	Acer negundo	Manitoba Maple	0.57	5.70	F	Sweep / Moderate dieback	Remove
7	Acer saccharum	Sugar Maple	0.58	5.80	G		Remove
8	Acer saccharum	Sugar Maple	0.64	6.40	F	Wound at base / Internal rot	Remove
9	Acer saccharum	Sugar Maple	0.86	8.60	VP	Severe internal rot / Barreling of stem	Remove

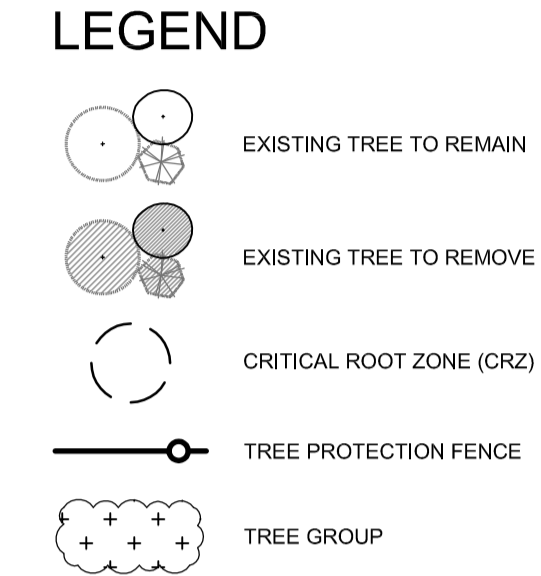
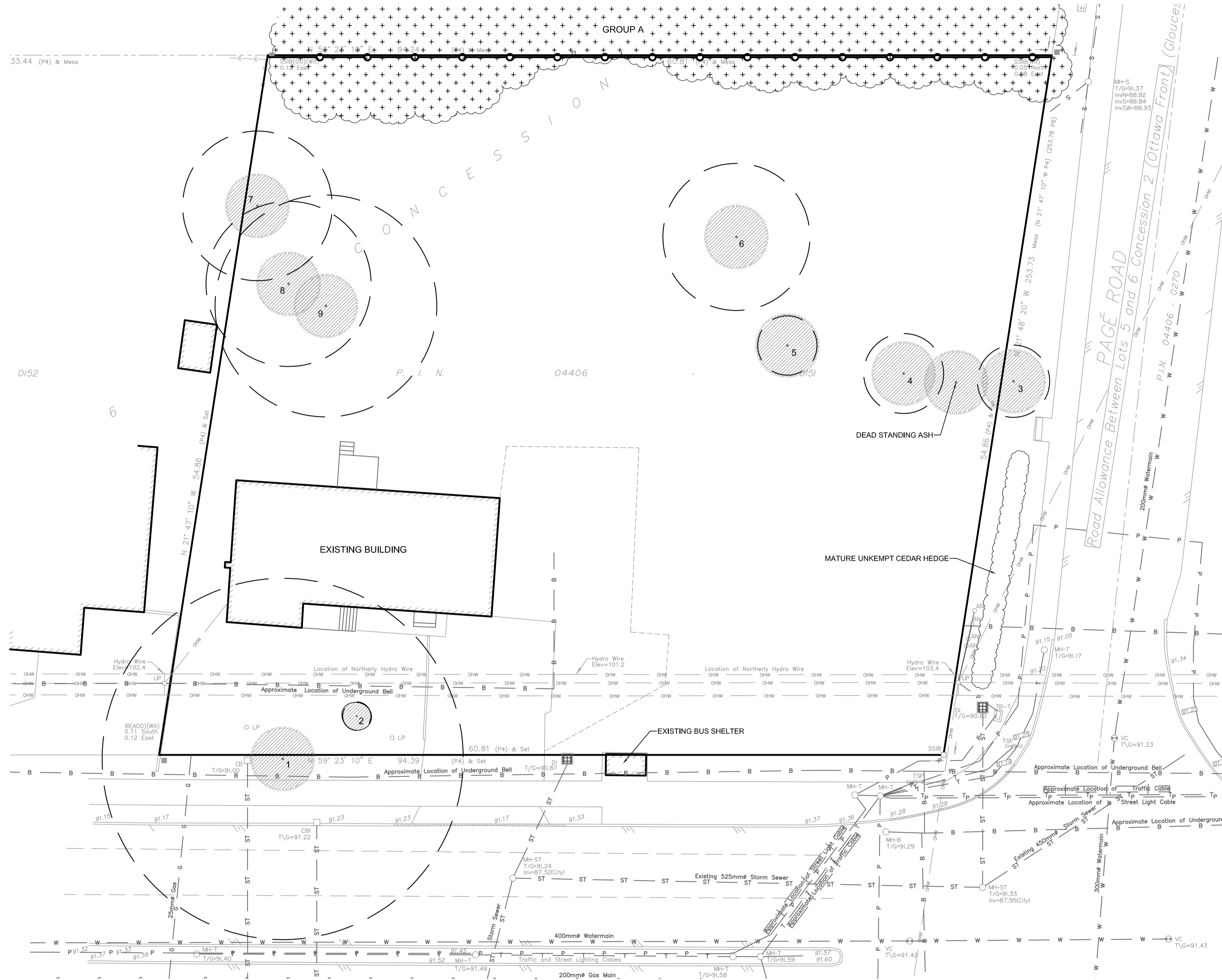

TREE PROTECTION NOTES

- The following protection measures must be implemented for retained trees, both on site and on adjacent sites, prior to any tree removal or site works and maintained for the duration of construction on site:
- Under the guidance of a Landscape Architect or Certified Arborist, erect a fence at the critical root zone (CRZ) of trees where the CRZ is established as being 10 centimetres from the trunk of a tree for every centimetre of trunk diameter at breast height. The CRZ is calculated as DBH x 10cm. Refer to the Tree Protection Fence detail. See plan for fence location.
 - When trees to be removed overlap with the CRZ of trees to be preserved: cut roots at the edge of the CRZ and grind down stumps after tree removals, do not pull out stumps. Ensure there is not root pulling or disturbance of the ground within the CRZ.
 - If roots must be cut, roots 20mm or larger should be cut at right angles with clean, sharp horticultural tools without tearing, crushing, or pulling. Refer to City of Ottawa Specification S.P. F-8011 Tree Protection, Excavation of Root Zone.
 - Hand work only where required within the CRZ; absolutely no machinery permitted.
 - Do not place any material or equipment within the CRZ of any tree.
 - Do not attach any signs, notices or posters to any tree.
 - Do not disturb, raise or lower the existing grade within the CRZ without approval.
 - Only tunnel or bore when digging within the CRZ of a tree.
 - Do not damage the root system, trunk, or branches of any tree.
 - Ensure that exhaust fumes from all equipment are directed away from any tree canopy.

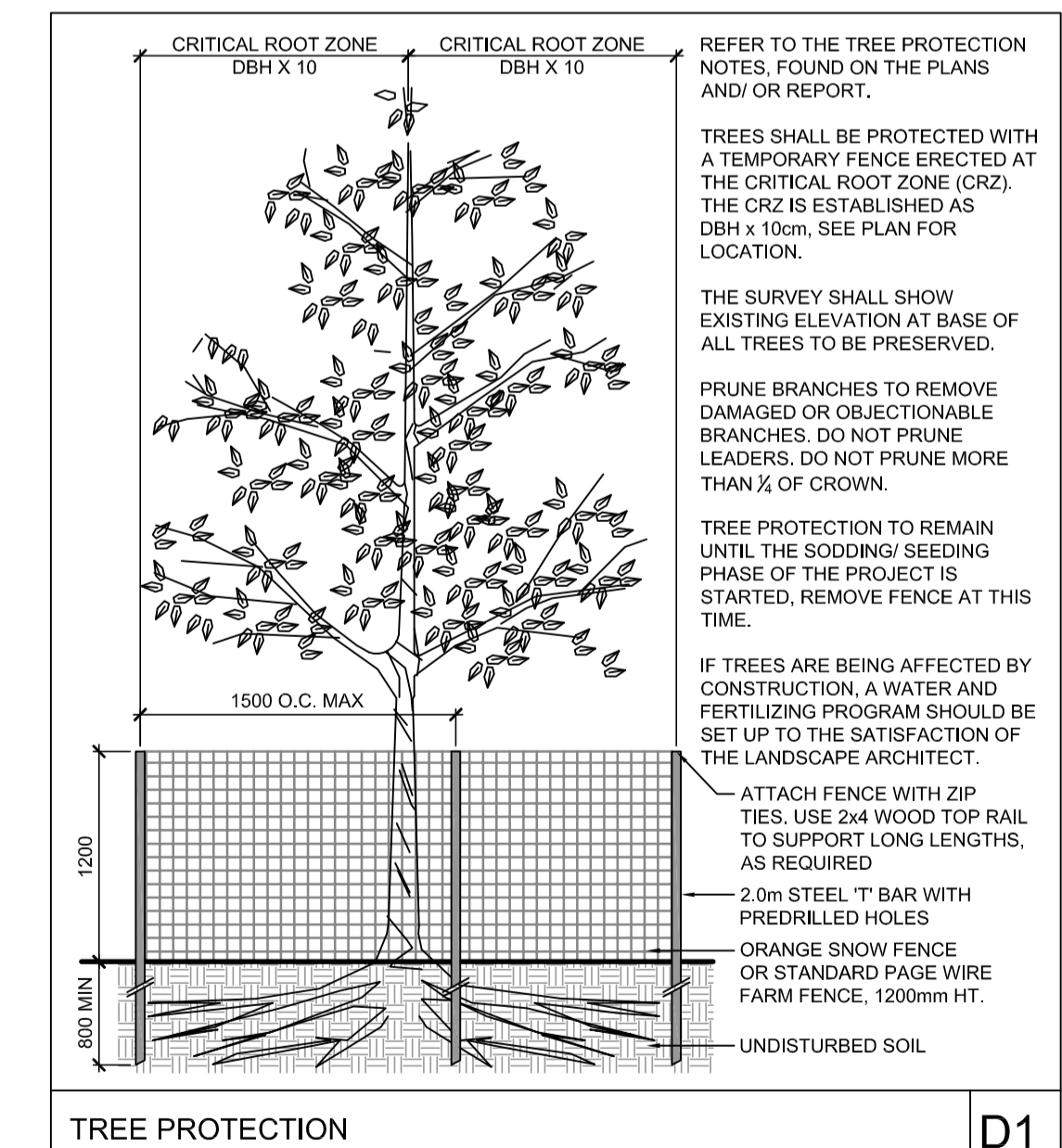

NOTE:
THE POSITION OF ALL POLE LINES, CONDUITS, WATERMANS, SEWERS AND OTHER UNDERGROUND AND OVERGROUND UTILITIES AND STRUCTURES IS NOT NECESSARILY SHOWN ON THE CONTRACT DRAWINGS, AND WHERE SHOWN, THE ACCURACY OF THE POSITION OF SUCH UTILITIES AND STRUCTURES IS NOT GUARANTEED. BEFORE STARTING WORK, DETERMINE THE EXACT LOCATION OF ALL SUCH UTILITIES AND STRUCTURES AND ASSUME ALL LIABILITY FOR DAMAGE TO THEM.

NOT FOR CONSTRUCTION

No.	REVISION	DATE	BY
2.	ISSUED FOR SITE PLAN APPLICATION	DEC 15/17	RJ
1.	ISSUED FOR COORDINATION	DEC 1/17	RJ

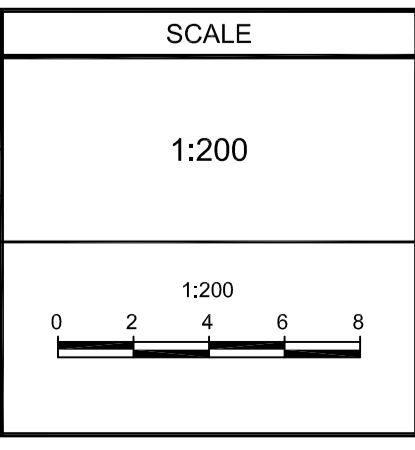

DESIGN	RJ
CHECKED	RJ
DRAWN	MT
CHECKED	RJ
APPROVED	RJ

FOR REVIEW ONLY



NOVATECH
Engineers, Planners & Landscape Architects
Suite 200, 240 Michael Cowpland Drive
Ottawa, Ontario, Canada K2M 1P6
Telephone (613) 254-9643
Facsimile (613) 254-5867
Website www.novatech-eng.com

LOCATION		PROJECT No.
CITY OF OTTAWA 3443 INNES ROAD		117077-00
DRAWING NAME		REV
TREE CONSERVATION PLAN		REV # 2
		DRAWING No.
		117077-TCR

M:\2017\117077\CAD\Landscape\Plan\117077_TCR.dwg, TCR, Dec 01, 2017 - 3:03pm, kvatson