

PART OF LOT A CONCESSION 9 (NEW SURVEY) AND PART OF ROAD ALLOWANCE BETWEEN CONCESSIONS 8 AND 9 Geographic Township of Cumberland CITY OF OTTAWA

Surveyed by Annis, O'Sullivan, Vollebakk Ltd.

Scale 1 : 250



Metric DISTANCES AND COORDINATES SHOWN ON THIS PLAN ARE IN METRES AND CAN BE CONVERTED TO FEET BY DIVIDING BY 0.3048.

Surveyor's Certificate

I CERTIFY THAT: 1. This survey and plan are correct and in accordance with the Surveys Act, the Surveyors Act and the Land Titles Act and the regulations made under them. 2. The survey was completed on the 15th day of February, 2018.

Feb 27/18 Date

V. Andrew Shep Ontario Land Surveyor

Notes & Legend

Table with 2 columns: Denotes and Description. Includes symbols for Survey Monument Planted, Standard Iron Bar, Short Standard Iron Bar, Iron Bar, Witness, Measured, Annis, O'Sullivan, Vollebakk Ltd., Plan 4R-18344, Plan 4R-20023, Plan by (AOG) dated January 22, 2015, Registered Plan 4M-1522, Plan 50R-4052, Plan 4R-25923, Plan by (1236) dated December 23, 2004, Top of Grate, Top Spindle, Maintenance Hole (Storm Sewer), Maintenance Hole (Sanitary), Sign, Fire Hydrant, Catch Basin Inlet, Cable Terminal Box, Unidentified Terminal Box, Chain Link Fence, Board Fence, Post and Wire, Bottom of Slope, Top of Slope, Flag Pole, Diameter, Location of Elevations, Top of Concrete Curb Elevation, Centreline, Deciduous Tree.

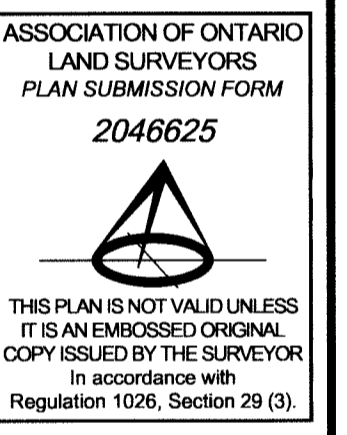

Bearings are grid, derived from Can-Net 2016 Real Time Network GPS observations on reference points A and B, shown hereon, having a bearing of N70°00'40"W and are referenced to Specified Control Points 01919680184 and 019198434761, MTM Zone 9 (76°30' West Longitude) NAD-83 (original).

Distances shown on this plan are ground distances and can be converted to grid distances by multiplying by the combined scale factor of 0.999874.

Coordinate values are to urban accuracy in accordance with O. Reg. 216/10. .01919680184 Northing 5040610.16 Easting 384736.56 .019198434761 Northing 5036178.12 Easting 372436.11 .Point A Northing 5037820.06 Easting 386246.53 .Point B Northing 5037852.73 Easting 386336.33

Caution: Coordinates cannot, in themselves, be used to re-establish corners or boundaries shown on this plan.

ELEVATION NOTES

1. Elevations shown are geodetic and are referred to the CGVD28 geodetic datum. 2. It is the responsibility of the user of this information to verify that the job benchmark has not been altered or disturbed and that its relative elevation and description agrees with the information shown on this drawing.

UTILITY NOTES

1. This drawing cannot be accepted as acknowledging all of the utilities and it will be the responsibility of the user to contact the respective utility authorities for confirmation. 2. Only visible surface utilities were located. 3. A field location of underground plant by the pertinent utility authority is mandatory before any work involving breaking ground, probing, excavating etc.

Topographic data was collected under Winter Conditions. Snow cover and ice preclude determining location and elevation of some topographical data that is otherwise visible.

Professional information for Annis, O'Sullivan, Vollebakk Ltd., including address (14 Concourse Gate, Suite 500, Nepean, Ont. K2E 7S6), phone, fax, email, and job number (18-022-18).

