

Path: g:\golder\gpc\chicago\active\spatial\miller_paving\ltd\CRRC\ACAD\1787048\007_Servicing_Plan1 | File Name: 1787048-007_CIV-004.dwg | Last Edited By: mfoget | Date: 2018-06-14 Time: 4:09:13 PM | Printed By: mfoget | Date: 2018-06-14 Time: 4:52:42 PM

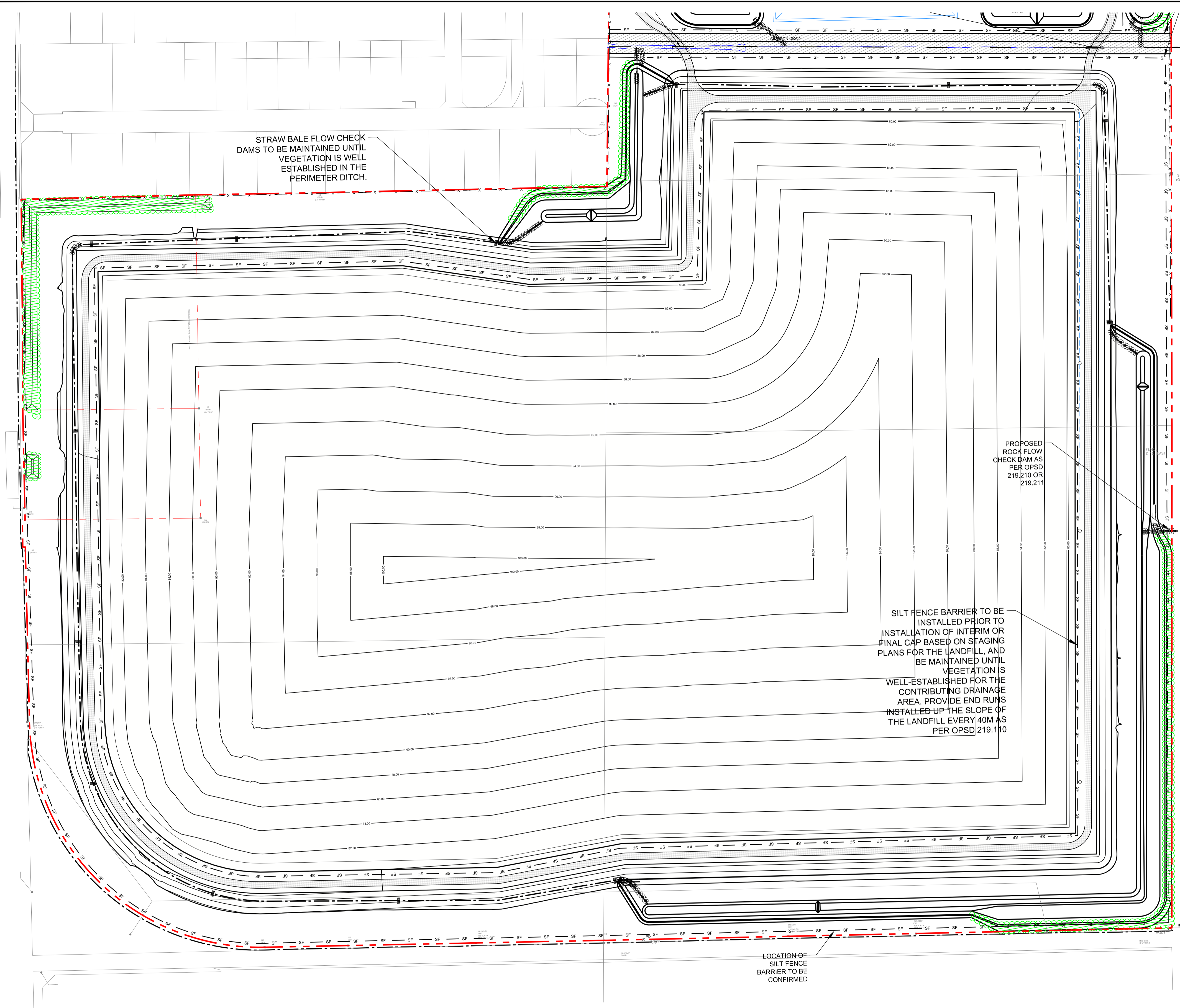

STRAW BALE FLOW CHECK DAMS TO BE MAINTAINED UNTIL VEGETATION IS WELL ESTABLISHED IN THE PERIMETER DITCH.

PROPOSED ROCK FLOW CHECK DAM AS PER OPSD 219.210 OR 219.211

SILT FENCE BARRIER TO BE INSTALLED PRIOR TO INSTALLATION OF INTERIM OR FINAL CAP BASED ON STAGING PLANS FOR THE LANDFILL, AND BE MAINTAINED UNTIL VEGETATION IS WELL-ESTABLISHED FOR THE CONTRIBUTING DRAINAGE AREA. PROVIDE END RUNS INSTALLED UP THE SLOPE OF THE LANDFILL EVERY 40M AS PER OPSD 219.110

LOCATION OF SILT FENCE BARRIER TO BE CONFIRMED

- LEGEND**
- PROPERTY BOUNDARY
 - EXISTING CONTOUR (0.25 m INTERVAL)
 - TERRACING (SLOPE AS INDICATED)
 - RIP-RAP 200 mmØ, 300 M THICK (NOMINAL) AS PER OPSD 810.010 TYPE 'B'
 - DITCH
 - 600 mmØ CULVERT OR AS NOTED
 - EXISTING CULVERT AS NOTED
 - PROPOSED SILT FENCE BARRIER AS PER OPSD 219.110
 - STORM SEWER LOCATION
 - CATCH BASIN (OPSD 705.010 C/W 600 mm SUMP)
 - MAINTENANCE HOLE (OPSD 707.020)
 - PROPOSED STRAW BALE FLOW CHECK DAM AS PER OPSD 219.180

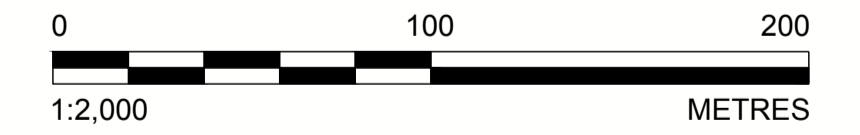

REV.	YYYY-MM-DD	DESCRIPTION	DESIGNED	PREPARED	REVIEWED	APPROVED
1	2018-06-15	ISSUED FOR SITE PLAN APPROVAL	SWT	MLF	DVK	DVK

SEAL



CLIENT
TAGGART MILLER ENVIRONMENTAL SERVICES

CONSULTANT
GOLDER
GOLDER ASSOCIATES LTD.
1931 ROBERSON ROAD
OTTAWA, ONTARIO
CANADA
[+1] (613) 592 9600
www.golder.com

PROJECT
CAPITAL REGION RESOURCE RECOVERY CENTRE

TITLE
EROSION AND SEDIMENT CONTROL PLAN

PROJECT NO.	CONTROL	REV.	of	DRAWING
1787048	0007	1		EC2

IF THIS MEASUREMENT DOES NOT MATCH WHAT IS SHOWN, THE SHEET SIZE HAS BEEN MODIFIED FROM: ANSI D