

Path: \\golder\gpc\gpc\otawa\active\spatial\mml\miller_paving\luc\crrrc\cadd\1787048\05\crrrc\boundary_road_access\1 File Name: 1787048-0005-CV-0003.dwg | Last Edited By: mfergat Date: 2018-12-11 Time: 11:33:06 AM

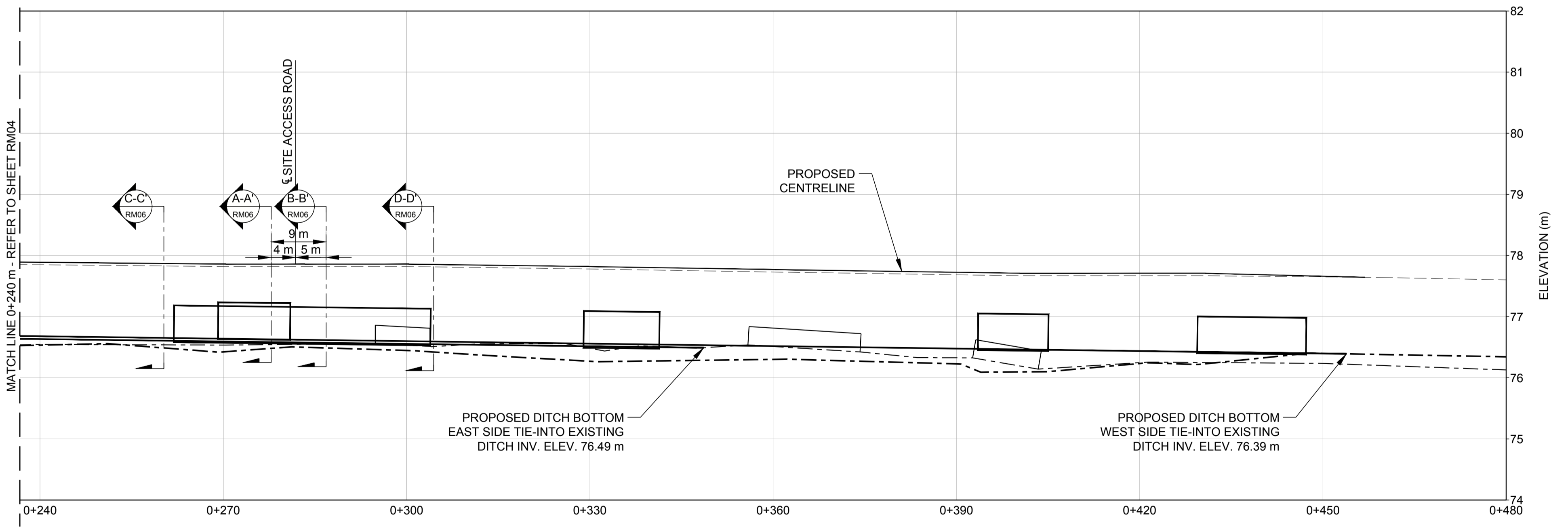

- LEGEND**
- APPROXIMATE BOREHOLE LOCATION
 - APPROXIMATE MANUAL AUGERHOLE LOCATION
 - APPROXIMATE AUGERHOLE LOCATION

- REFERENCE(S)**
1. TOPOGRAPHIC SURVEY PROVIDED IN A DIGITAL FORMAT BY ANNIS, O'SULLIVAN, VOLLEBEKK LTD., JOB No. XRF-AOV-2017_Survey_BoundaryRD, FIELD WORK COMPLETED ON November 22, 2017.
 2. PROPOSED BOUNDARY ROAD SITE ACCESS GEOMETRY PROVIDED BY TAGGART GROUP OF COMPANIES, TECHNICAL SUPPORT DOCUMENT #9, TRAFFIC IMPACT STUDY.
 3. COORDINATE SYSTEM, HORIZONTAL DATUM MTM ZN9, VERTICAL DATUM: CGVD28.
 4. GEOTECHNICAL/PAVEMENT INVESTIGATION, PROPOSED BOUNDARY ROAD IMPROVEMENTS, CAPITAL REGION RESOURCE CENTRE (CRRRC), GOLDR ASSOCIATES LTD., DATED APRIL 10, 2018.

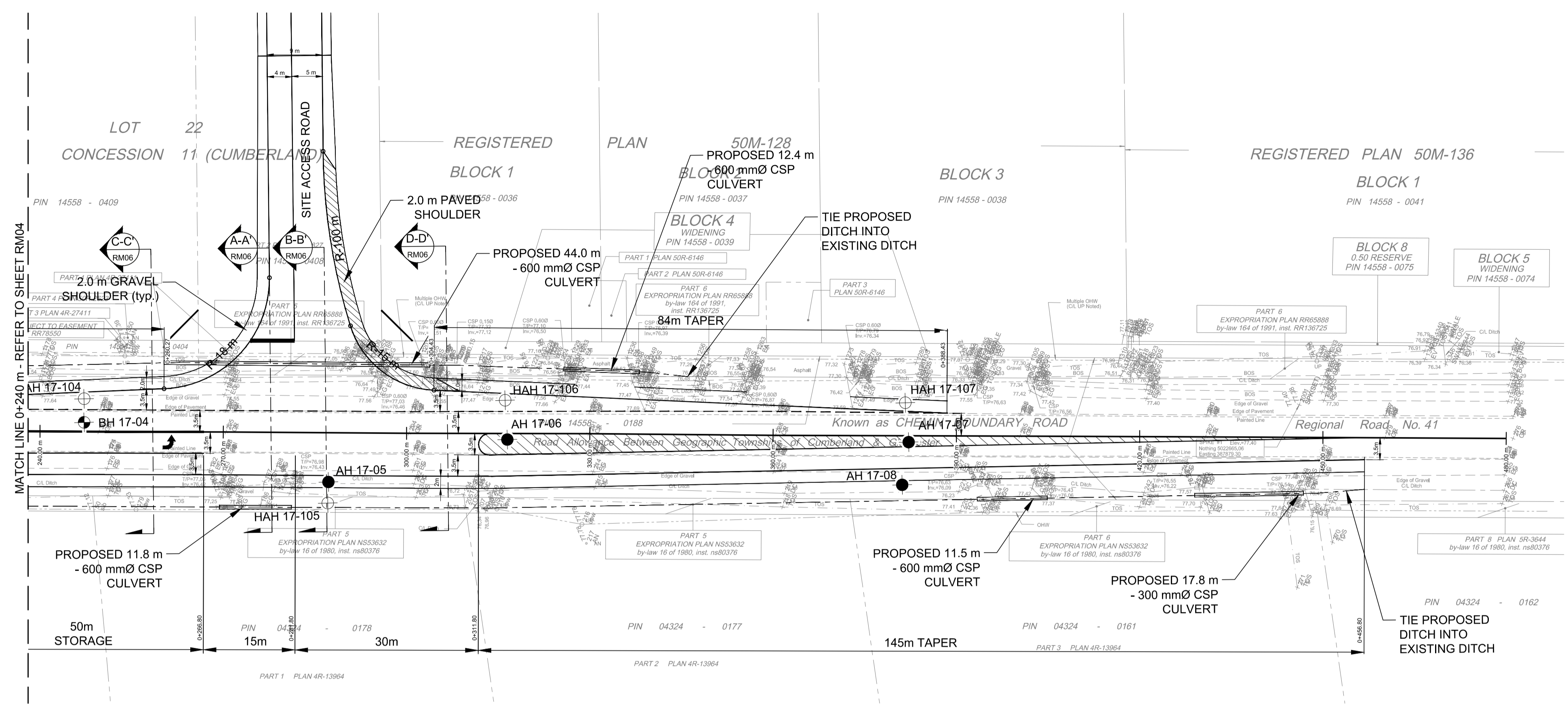
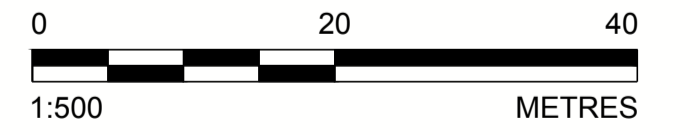

SEAL

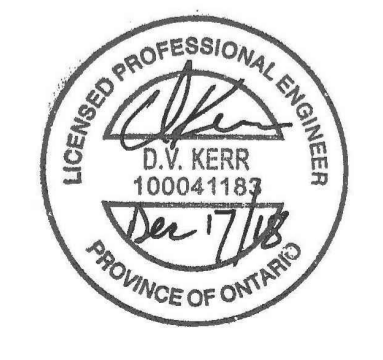

CLIENT
TAGGART MILLER ENVIRONMENTAL SERVICES

CONSULTANT

PROJECT
CAPITAL REGION RESOURCE RECOVERY CENTRE
BOUNDARY ROAD MODIFICATIONS
5471 BOUNDARY ROAD, OTTAWA

TITLE
PLAN AND PROFILE - 2

REV.	YYYY-MM-DD	DESCRIPTION	DESIGNED	PREPARED	REVIEWED	APPROVED
4	2018-11-30	ISSUED FOR APPROVAL	DVK	MLF	DVK	DVK
3	2018-10-04	ISSUED FOR CIRCULATION	DVK	MLF	DVK	DVK
2	2018-09-07	RE-ISSUED FOR APPROVAL	DVK	MLF	DVK	DVK
1	2018-06-15	ISSUED FOR SITE PLAN APPROVAL	MHK	MLF	DVK	DVK



GOLDER ASSOCIATES LTD.
1931 ROBERSON ROAD
OTTAWA, ONTARIO
CANADA
[+1] (613) 592 9600
www.golder.com

PROJECT NO.	CONTROL	REV.	5 of 6	DRAWING
1787048	0005	4		RM05