

Path: I:\golder\gpc\chicago\active\spatial\mmiller_paving\ltd\crrrc\cadd\1787048\006\PROCD006_Schem_Ceading_Plan | File Name: 1787048-006-CH-002.dwg | Last Edited By: zsavare Date: 2018-12-17 Time: 1:38:47 PM | Printed By: zsavare Date: 2018-12-17 Time: 3:00:13 PM

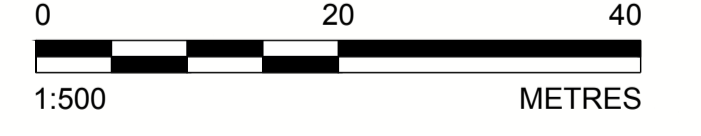
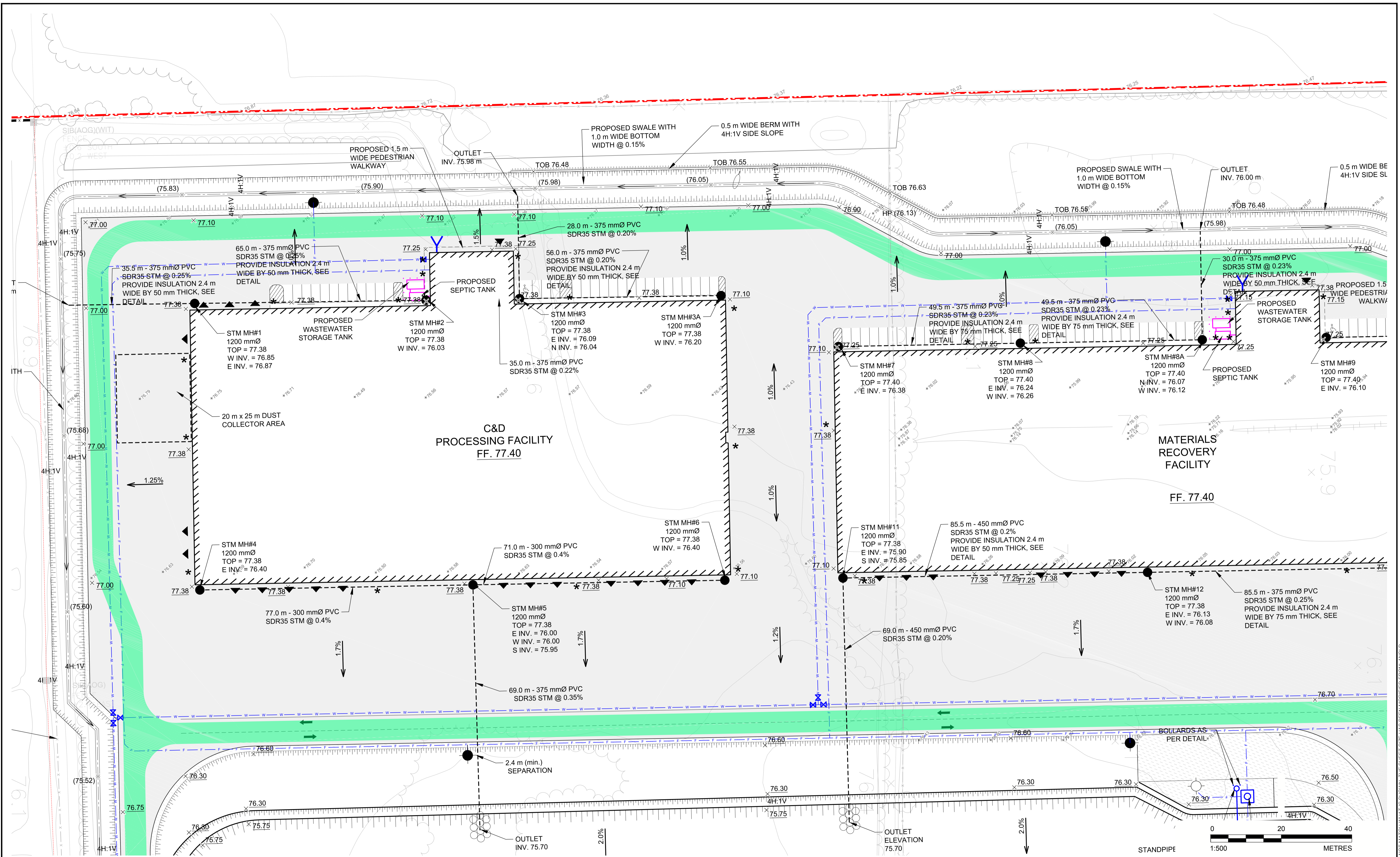

REV.	YYYY-MM-DD	DESCRIPTION	DESIGNED	PREPARED	REVIEWED	APPROVED
2	2018-12-14	REVISED FOR SITE PLAN APPROVAL	MHK	MLF	DVK	DVK
1	2018-06-15	ISSUED FOR SITE PLAN APPROVAL	MHK	MLF	DVK	DVK

SEAL

CLIENT
TAGGART MILLER ENVIRONMENTAL SERVICES

PROJECT
CAPITAL REGION RESOURCE RECOVERY CENTRE

CONSULTANT

GOLDER ASSOCIATES LTD.
1931 ROBERSON ROAD
OTTAWA, ONTARIO
CANADA
[+1] (613) 592 9600
www.golder.com

TITLE
GRADING AND DRAINAGE PLAN

PROJECT NO. 1787048 CONTROL 0006 REV. 2 of DRAWING C03



IF THIS MEASUREMENT DOES NOT MATCH WHAT IS SHOWN, THE SHEET SIZE HAS BEEN MODIFIED FROM: ANSI D 25 mm