

Responsibility / Copyright Reserved

The location of under/overground utilities and structures are not necessarily shown on the contract drawings, and/or where shown. The accuracy of the position of such utilities and structures is not guaranteed. The Contractor shall verify and be responsible to determine the exact location of all such utilities and structures and assume all liability for any damage to them.

The Copyrights to all designs and drawings are the property of ARK Engineering and Development. Reproduction or use for any purpose other than that authorized by ARK Engineering and Development is forbidden.

Legend

- PARKING AREA LIGHT STANDARD
- HC DISABLED PARKING PERMIT SIGN
- DC DEPRESSED CONCRETE CURB
- MAIN ENTRANCE TO UNIT

Notes

- 1) THIS DRAWING TO BE READ IN CONJUNCTION WITH THE ARCHITECTURAL SITE PLAN AND THE CIVIL ENGINEER GRADING PLAN AND UNDERGROUND SERVICES.
- 2) THE LANDSCAPING CONTRACTOR SHALL BE RESPONSIBLE TO LOCATE ALL UNDERGROUND SERVICES PRIOR TO MOVING EARTH AND PLANTING. ADEQUATE PROTECTION SHALL BE PROVIDED TO EXISTING SERVICES AND FINISHED SURFACES IN THE GENERAL AREAS OF CONSTRUCTION. THE CONTRACTOR SHALL REINSTATE AT HIS EXPENSE ALL AREAS DAMAGED OR DISTURBED BEYOND THE LIMIT OF WORK.
- 3) ALL PLANT MATERIAL SHALL BE NO.1 GRADE. EXACT LOCATION OF PLANTING TO BE A SITE CONDITION AS REVIEWED BY THE CONSULTANT.
- 4) SHRUBS AND PERENNIALS SHALL BE PLANTED IN A CONTINUOUS BED OF 450mm DEEP PLANTING SOIL MIX COVERED WITH GEOTEXTILE FABRIC AND TOPPED WITH MINIMUM 75mm COMPOSTED PINE MULCH OR RIVER STONE BED (WHERE NOTED) FLUSH WITH FINISHED GRADE.
- 5) DEODOROUS AND CONIFEROUS TREES SHALL BE PLANTED IN ACCORDANCE WITH THE SKETCHES PROVIDED AND/OR INDUSTRY STANDARDS.
- 6) SUBSTITUTE PLANTS WILL NOT BE ACCEPTED UNLESS THE SPECIFIED PLANT OR TREE IS NO LONGER AVAILABLE FROM THE LOCAL NURSERIES.
- 7) APPLY MINIMUM 125mm NO.1 QUALITY TOPSOIL IN SODDED AREAS CONFORMING TO THE CANADIAN NURSERY SOD GROWERS OF ONTARIO SPECIFICATIONS.
- 8) THE LANDSCAPE CONTRACTOR SHALL GUARANTEE ALL PLANT MATERIAL FOR A PERIOD OF (1) FULL YEAR FROM THE DATE OF FINAL ACCEPTANCE OF THE WORK PERFORMED.
- 9) AS PART OF HIS OR HER CONTRACTUAL OBLIGATIONS, THE LANDSCAPE CONTRACTOR SHALL PROVIDE THE OWNER WITH A GENERAL MAINTENANCE LIST FOR ALL PLANTS AND TREES INSTALLED INCLUDING PRUNING METHOD AND WINTERIZING PROCEDURE.

Revision

0. SUBMITTED FOR APPROVAL	AUG 1/13
1. REVISED AS PER CITY COMMENTS	OCT 24/13
2. REVISED AS PER SNCA/CITY COMMENTS	NOV 21/13
3. REVISED AS PER MEETING WITH CITY	JAN 22/14
4. REVISED BLOCK 63	NOV 12/18

Location Map

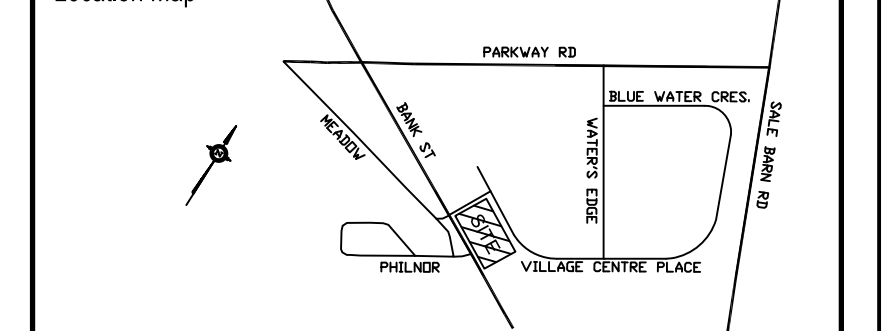

Seal

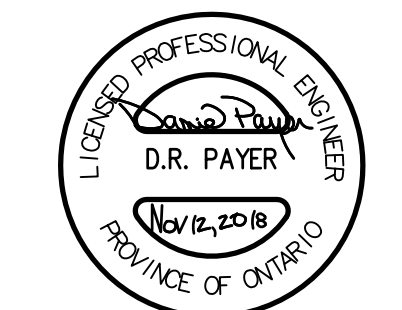

Client / Project

GREELY FAMILY FARM INC.
 7586 VILLAGE CENTRE PLACE
 GREELY VILLAGE PROFESSIONAL CENTRE

Drawing Name

LANDSCAPE PLAN

Scale

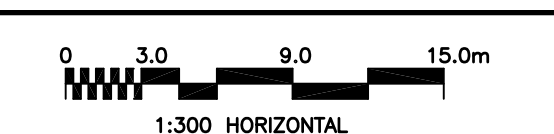

Revision

REV-4 Sheet Drawing No.
 4 of 4 LP-1

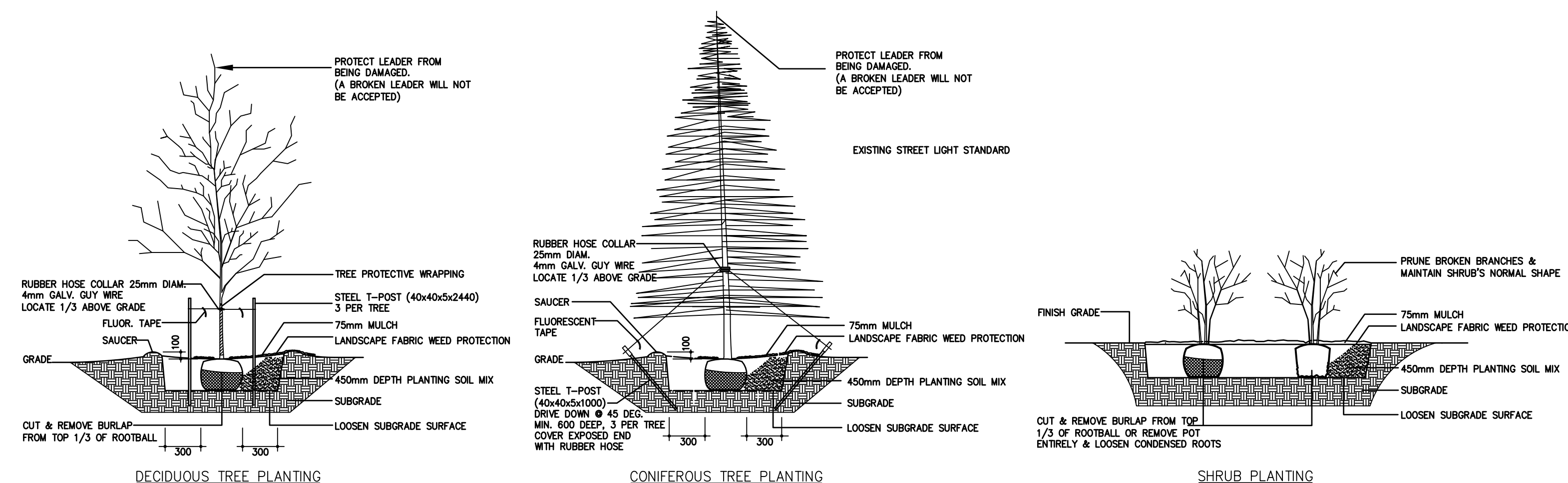
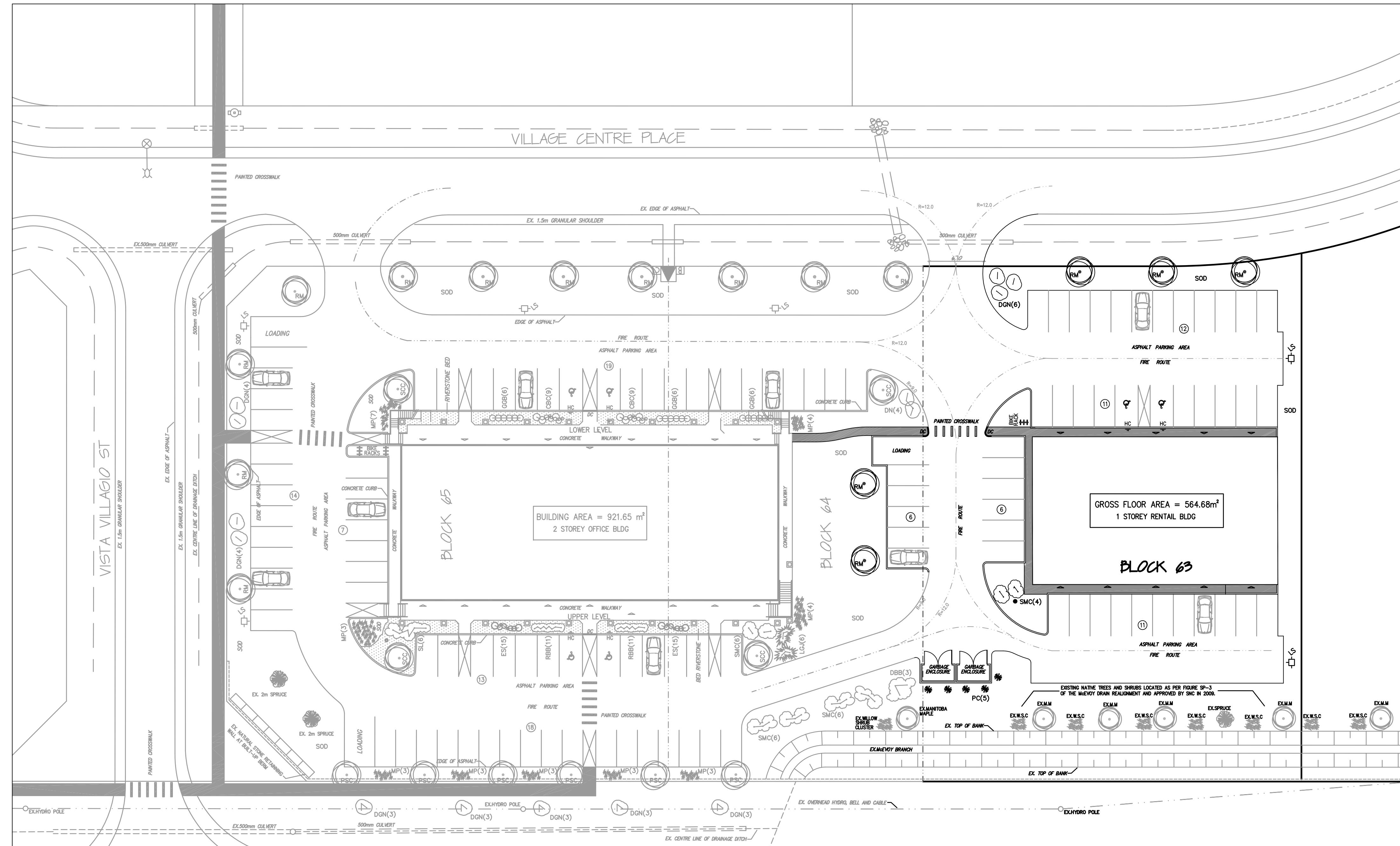

Planting Legend

COMMON NAME	LATIN NAME	QTY	SIZE	REMARKS
MP Slowmound Pine	Pinus mugo 'slowmound'	35	30cm ht	Potted, 90cm o.c.
SMC Spirea Magic Carpet	Spirea japonica 'walburna'	4	50cm ht	Potted, 90cm o.c.
DGN Darts Gold Ninebark (shrub)	Physocarpus opulifolius 'darts gold'	6	60cm ht	Potted, 80cm o.c.
RM Red Maple 'Red Sunset'	Acer rubrum 'Red Sunset'	5	75mm col	B&B