

TEMPORARY SITE BENCH MARK:
TOP OF HYDRO PAD ELEV.=90.00
TAKEN FROM MUNICIPAL
BM 0011970045 ELEV.=92.08

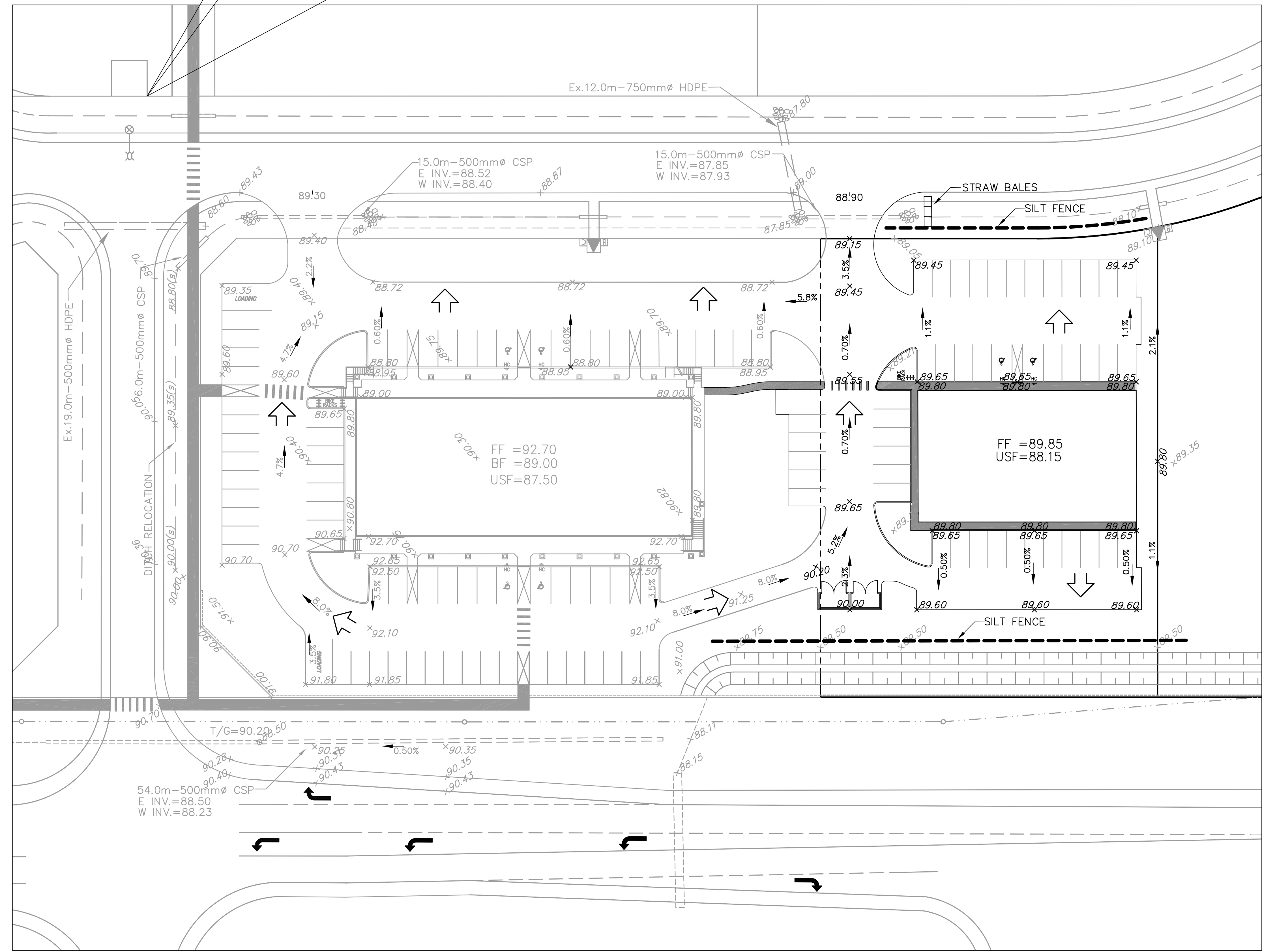

Notes

- ADDITIONAL TO THIS PLAN, THE CONTRACTOR SHALL IMPLEMENT THE "BEST MANAGEMENT PRACTICE" ALL ALONG CONSTRUCTION.
- STRAW BALES SHALL BE INSTALLED ALONG THE VARIOUS SWALES (MAN MADE OR EXISTING) WHERE JUDGED NECESSARY BY THE ENGINEER AND/OR THE CITY OF OTTAWA'S INSPECTOR.
- STRAW BALES SHOULD BE INSTALLED AS PER OPSD 219.100 AND OPSD 219.110 AS APPROPRIATE.
- STRAW BALES SHALL BE INSTALLED AT EVERY MAJOR POINT OF WATER ENTRY INCLUDING DITCHES AND CULVERTS.
- ALL SEDIMENT CONTROL LOCATIONS MUST BE INSPECTED ON A REGULAR BASIS ESPECIALLY FOLLOWING A RAINFALL EVENT. SEDIMENTS SHALL BE REMOVED AND CONTROLS REINSTALLED AS NECESSARY.
- ANY MATERIAL STOCKPILES SHOULD BE LOCATED ON FLAT AREAS WELL AWAY FROM ANY DRAINAGE INLETS.
- NO SEDIMENT CONTROL STRUCTURES SHALL BE REMOVED UNLESS FOUND UNNECESSARY OR ANOTHER SEDIMENT CONTROL POINT IS INSTALLED ELSEWHERE TO REPLACE THE LATTER.
- THE SEDIMENT AND EROSION CONTROL MEASURES MAY BE MODIFIED IN THE FIELD AT THE DISCRETION OF THE CITY OF OTTAWA SITE INSPECTOR.
- THIS PLAN IS A "LIVING DOCUMENT" AND THAT ANY MODIFICATION TO THE PLAN SHALL BE SUBMITTED TO THE SATISFACTION OF SNC AND MAY BE MODIFIED BY SNC STAFF.

ARK Engineering and Development

2691 Old Highway 17
Rockland ON Canada
K4K 1K7
Tel: (613) 858-6443

Responsibility / Copyright Reserved

The location of under/overground utilities and structures are not necessarily shown on the contract drawings, and/or where shown. The accuracy of the position of such utilities and structures is not guaranteed. The Contractor shall verify and be responsible to determine the exact location of all such utilities and structures and assumes all liability for any damage to them.

The Copyrights to all designs and drawings are the property of ARK Engineering and Development. Reproduction or use for any purpose other than that authorized by ARK Engineering and Development is forbidden.

Legend

- EXISTING CENTRE LINE ELEVATION
- EXISTING DITCH ELEVATION
- PROPOSED ELEVATION
- EXISTING GRADE
- PROPOSED ELEVATION
- % SLOPE
- PROPOSED DIRECTION OF FLOW
- PROPOSED DIRECTION OF FLOW
- PROPOSED FIRST FLOOR ELEVATION
- PROPOSED BASEMENT FLOOR ELEVATION
- PROPOSED UNDERSIDE OF FOOTING
- TERRACING 3:1 (MAXIMUM SLOPE)
- MAJOR DRAINAGE SYSTEM
- SILTATION CURTAIN
- PROPOSED STRAW BALES
- DRAINAGE AREA
- SITE AREA RUNOFF COEFFICIENT
- EX. PADMOUNT HYDRO TRANSFORMER
- EX. BELL PEDESTAL
- EX. CABLE PEDESTAL
- EX. 500mm CSP CULVERT
- DEPRESSED CONCRETE CURB
- MAIN ENTRANCE TO UNIT

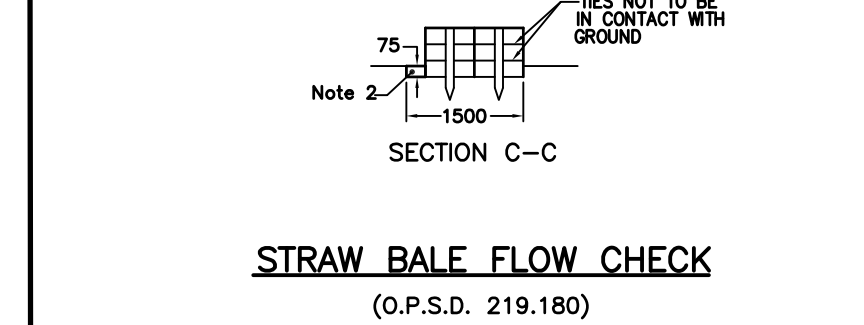
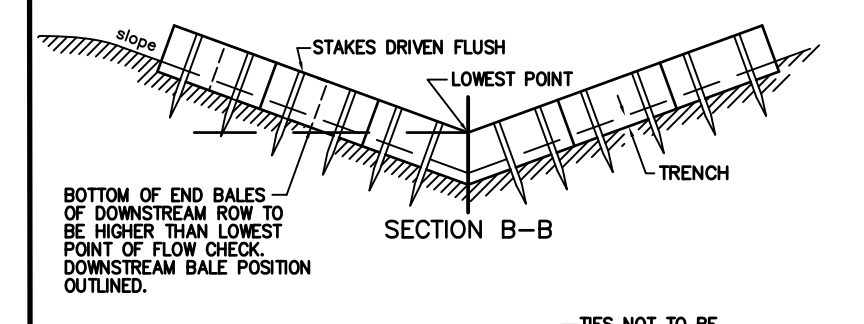
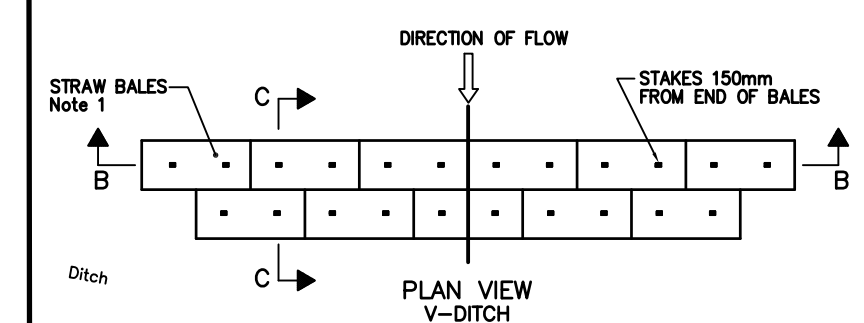
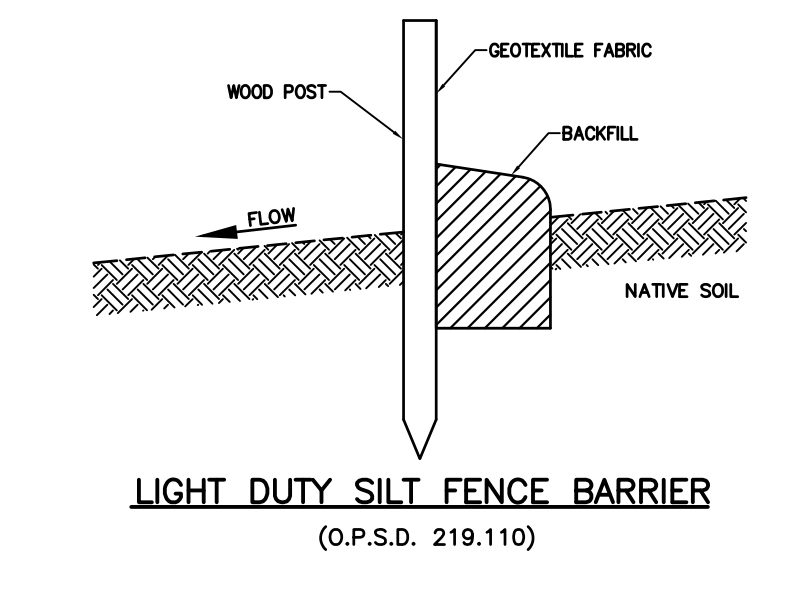

Revision

0. SUBMITTED FOR APPROVAL	AUG 1/13
1. REVISED AS PER CITY COMMENTS	OCT 24/13
2. REVISED AS PER SNCA/CITY COMMENTS	NOV 21/13
3. REVISED AS PER MEETING WITH CITY	JAN 22/14
4. REVISED BLOCK 63	NOV 12/18
5. REVISED AS PER CITY COMMENTS	FEB 5/20

Location Map

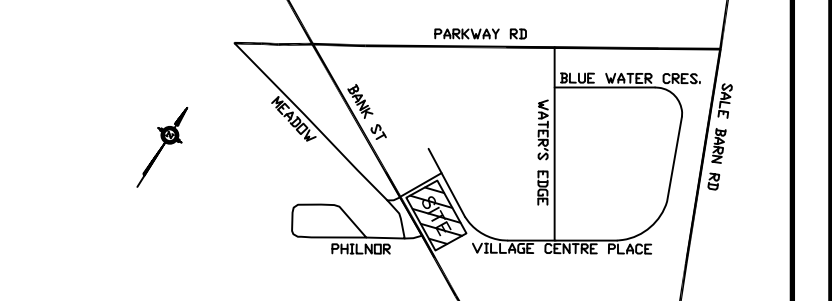

Seal



Client / Project

GREELY FAMILY FARM INC.
7586, 7574 and 7564 VILLAGE CENTRE PLACE
GREELY VILLAGE PROFESSIONAL CENTRE

Drawing Name

GRADING AND EROSION CONTROL PLAN

Scale

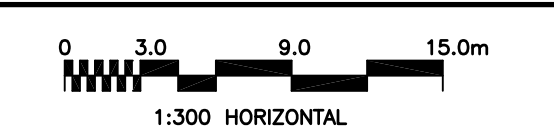

Revision
REV-5

Sheet
3 of 3

Drawing No.
GP-1