

KINAXIS

8700 CAMPEAU DRIVE

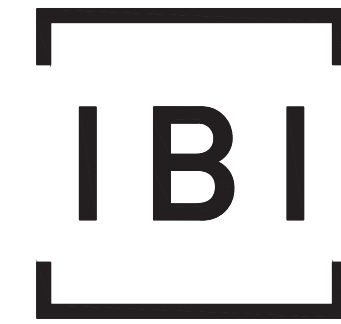

IBI GROUP
 400 – 333 Preston Street
 Ottawa ON K1S 5N4 Canada
 tel 613 225 1311 fax 613 225 9868
 ibigroup.com

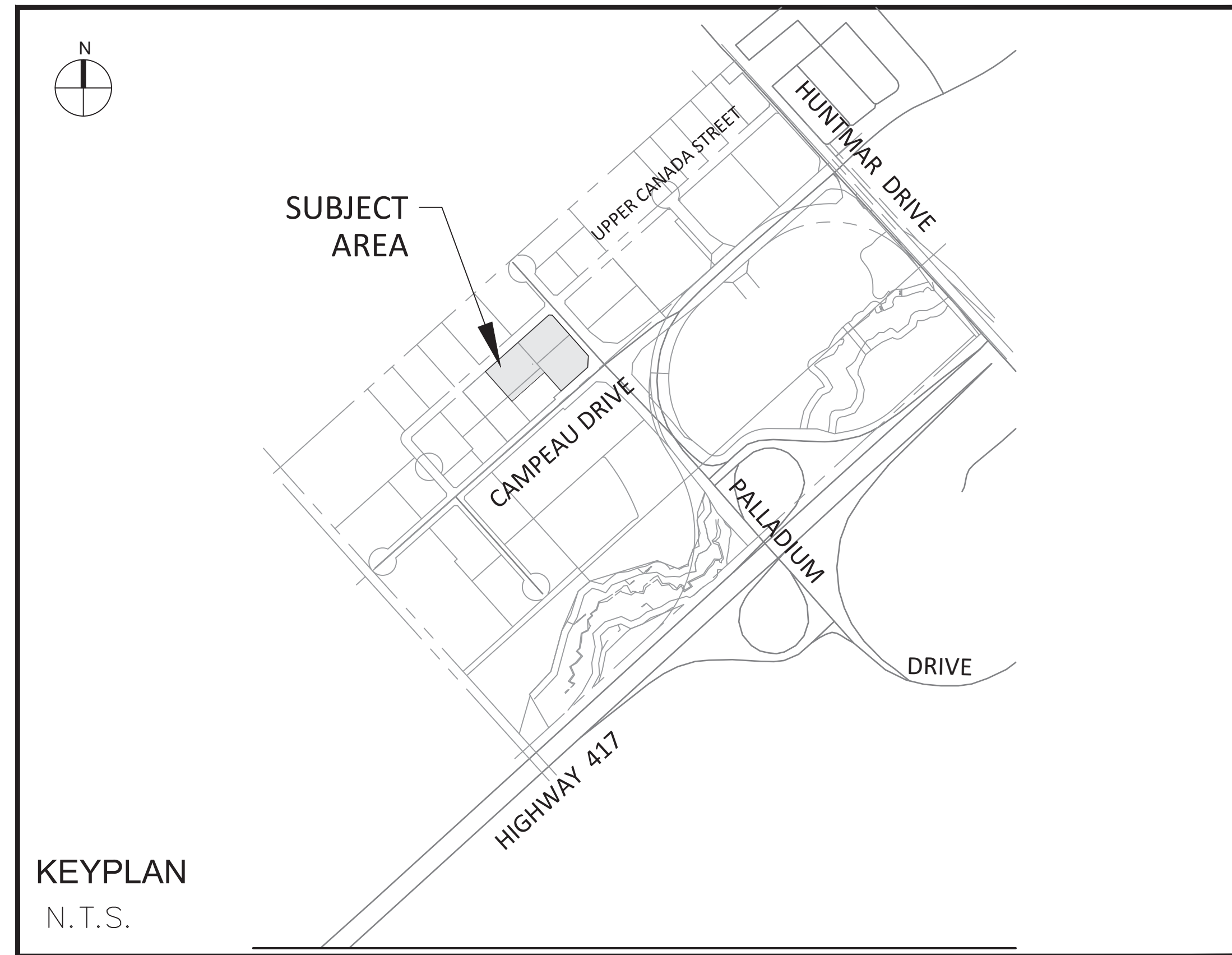

| Sheet List Table | |
|------------------|--|
| Sheet Number | Sheet Title |
| 000 | COVER |
| C-001 | SERVICING PLAN |
| C-010 | NOTES LEGEND AND CB |
| C-200 | GRADING PLAN |
| C-201 | BLOCK 24, 25, AND 28 SITE GRADING & EXISTING DRAINAGE AREA |
| C-400 | SANITARY DRAINAGE AREA PLAN |
| C-500 | STORM DRAINAGE AREA PLAN |
| C-600 | PONDING PLAN |
| C-900 | EROSION AND SEDIMENT PLAN |

PC KANATA DEVELOPMENTS INC.

CONTRACT NO. 121693

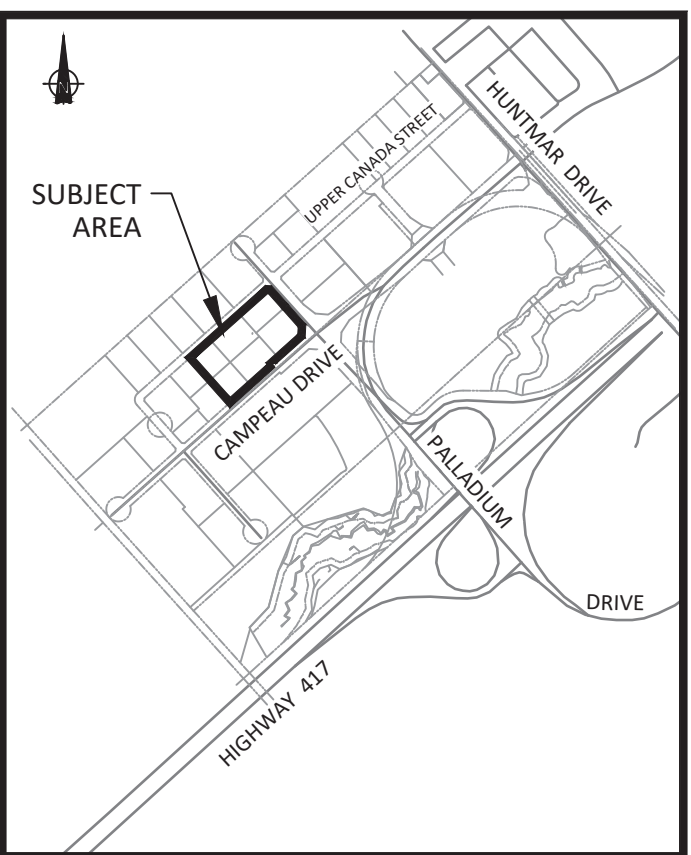
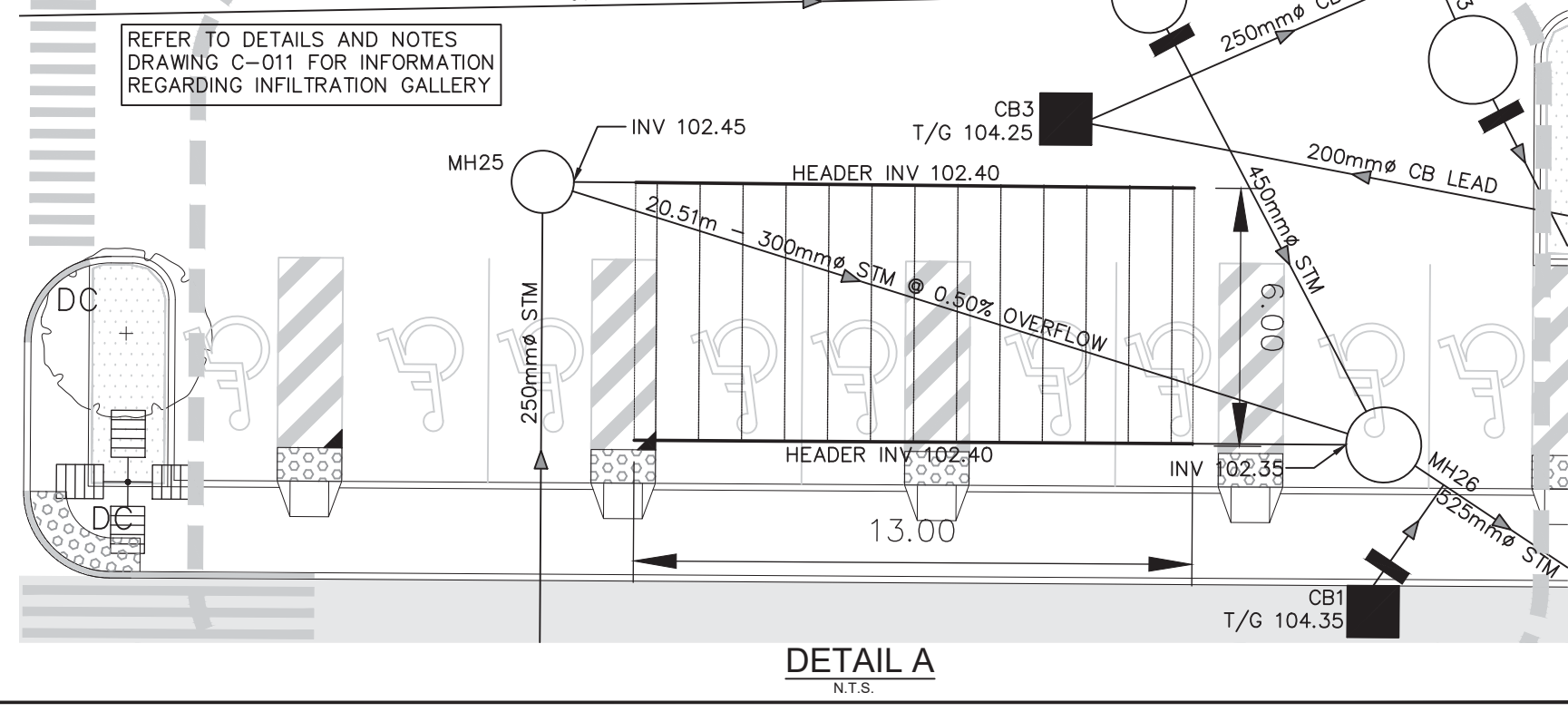
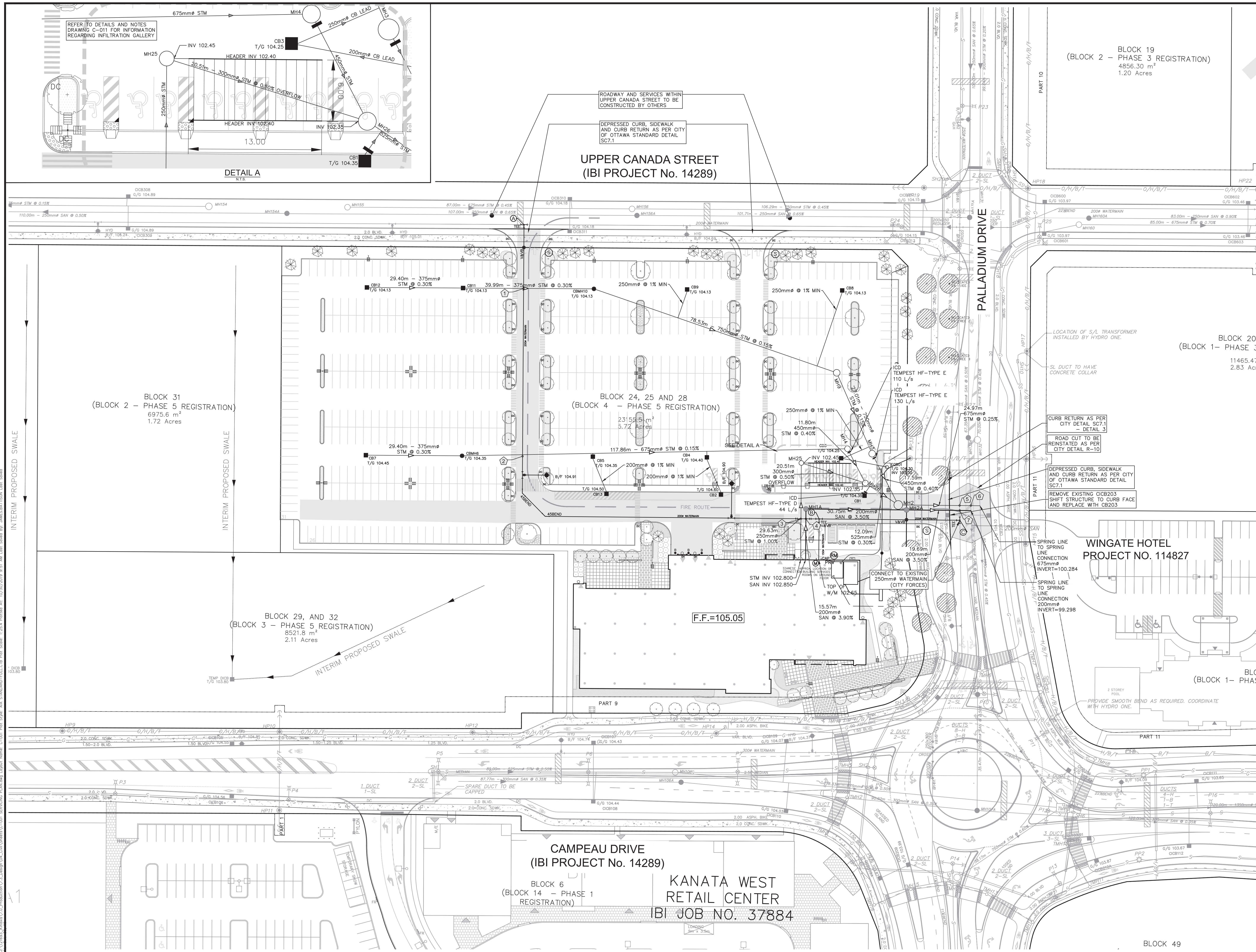

KEY PLAN (INTS)

NOTES:
 1. SEE DETAIL DRAWING C-010 FOR ADDITIONAL DETAILS AND NOTES.
 2. SITE BENCHMARK TO BE OBTAINED FROM LEGAL SURVEYOR STANTEC GEOMATICS.

| No. | REVISIONS | By | Date |
|-----|---|--------|------------|
| 14 | | | |
| 13 | | | |
| 12 | | | |
| 11 | | | |
| 10 | | | |
| 9 | | | |
| 8 | | | |
| 7 | | | |
| 6 | | | |
| 5 | | | |
| 4 | REVISE AS PER CITY COMMENTS | T.R.B. | 2019-10-29 |
| 3 | REVISE AS PER CITY COMMENTS AND NEW SITE PLAN | T.R.B. | 2019-09-30 |
| 2 | INTERIM SUBMISSION - KINAXIS INTERIORS | T.R.B. | 2019-08-12 |
| 1 | ISSUED FOR SPA | T.R.B. | 2019-07-09 |

PC KANATA DEVELOPMENTS INC.

IBI GROUP
 400 - 333 Preston Street
 Ottawa ON K1S 5N4 Canada
 tel 613 225 1311 fax 613 225 9868
 ibigroup.com

Project Title
kinaxis
8700 CAMPEAU DRIVE

Professional Engineer
T. R. BRULE
 2019/10/29
 PROVINCE OF ONTARIO

Drawing Title
SERVICING PLAN

Scale
 1:500

| | | | |
|-------------|-----------|-------------|-----------|
| Design | JB | Date | JULY 2019 |
| Drawn | DPS/DD/EH | Checked | TRB |
| Project No. | 121693 | Drawing No. | C-001 |

J:\121693_kinaxis\7.0_Production\7.3_Design\04_Civil\Sheets\C-001_SERVICING PLAN.dwg Layout Name: C-001 Plot Style: AA STANDARD-FULL.CTB Plot Scale: 1:25.4 Printed At: 10/29/2019 8:51 AM Last Saved By: JAMES.BATTS@IBI.COM

D07-12-19-0122

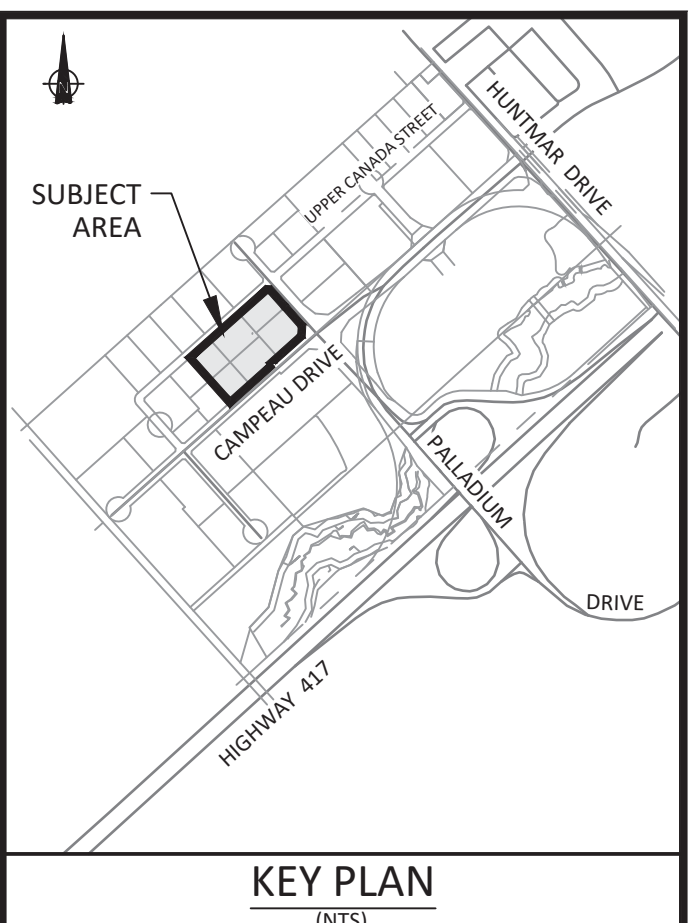
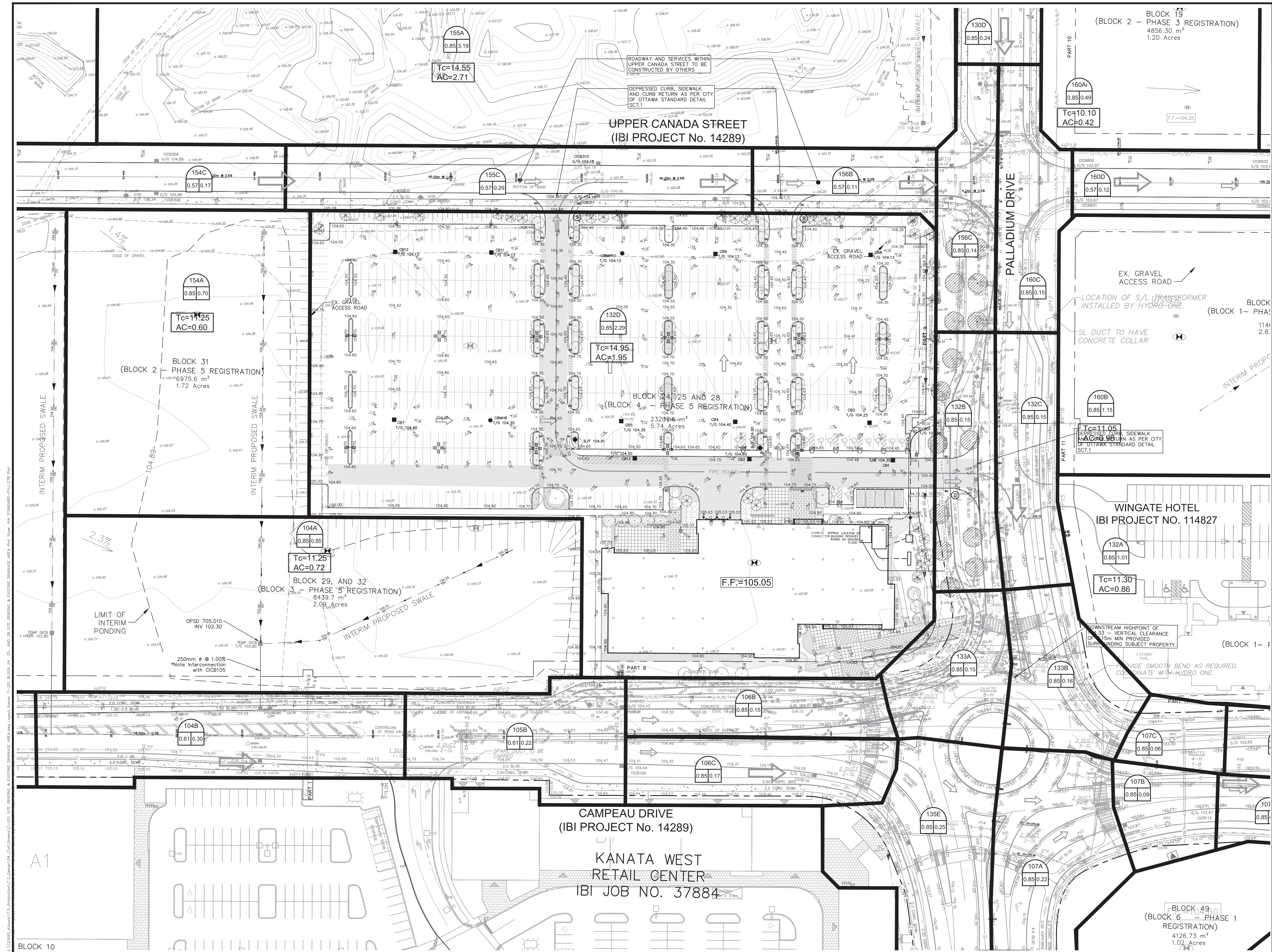

NOTES:
1. SEE DETAIL DRAWING C-100 FOR ADDITIONAL DETAILS AND NOTES.
2. SITE BENCHMARK TO BE OBTAINED FROM LEGAL SURVEYOR STANTEC GEOMATICS.

Revision table with columns: No., REVISIONS, By, Date.

| | | | |
|----|--|--------|------------|
| 14 | | | |
| 13 | | | |
| 12 | | | |
| 11 | | | |
| 10 | | | |
| 9 | | | |
| 8 | | | |
| 7 | | | |
| 6 | | | |
| 5 | | | |
| 4 | | | |
| 3 | REVISED AS PER CITY COMMENTS | T.R.B. | 2019.10.29 |
| 2 | REVISED AS PER NEW SITE PLAN AND CITY COMMENTS | T.R.B. | 2019.09.30 |
| 1 | ISSUED FOR SPA | T.R.B. | 2019.07.09 |

PC KANATA DEVELOPMENTS INC.

IBI GROUP
400 - 333 Preston Street
Ottawa ON K1S 5N4 Canada
tel 613 225 1311 fax 613 225 9888
ibigroup.com

Project Title
kinaxis
8700 CAMPEAU DRIVE

LICENSÉ PROFESSIONNEL ENGINEER
T. R. BRULE
2019/10/29
PROVINCE OF ONTARIO

Drawing Title
BLOCK 31, 32 AND 29 SITE GRADING & EXISTING DRAINAGE AREA

Scale 1:500

| | | | |
|-------------|-----------|-------------|-----------|
| Design | JB | Date | JULY 2019 |
| Drawn | DPS/DD/EH | Checked | TRB |
| Project No. | 121693 | Drawing No. | C-201 |

J:\121693_kinaxis\03_Production\03_121693_Kinaxis_V3_3_Bespoke\04_Civil\Drawings\C-201 BLOCK 24 AND 28 SITE GRADING & EXISTING DRAINAGE AREA.Plot_Sys: AIA STANDING-FULL.CTB Plot

A1

D07-12-19-0122

1.30 Acres

3.19 IND

BLOCK 19
(BLOCK 2 - PHASE 3 REGISTRATION)
4856.30 m²
1.20 Acres

UPPER CANADA STREET
(IBI PROJECT No. 14289)
UPPER CANADA STREET

PALLADIUM DRIVE

KEY PLAN
(INTS)

NOTES:
1. SEE DETAIL DRAWING C-100 FOR ADDITIONAL DETAILS AND NOTES.
2. SITE BENCHMARK TO BE OBTAINED FROM LEGAL SURVEYOR STANTEC GEOMATICS.

LEGEND:

- WH AREA NUMBER
- 1.01 / 0.0 RUNOFF COEFFICIENT
- 5.14 PBP AREA IN HECTARES
- PBP LAND USE TYPE
- IND PRESTIGE BUSINESS
- COM PARK - 35 000 l/s/ha
- ROW LIGHT INDUSTRIAL - 35 000 l/s/ha
- RIGHT OF WAY COMMERCIAL - 50 000 l/s/ha
- (INFILTRATION FLOW ONLY)
- DRAINAGE AREA LIMITS
- EXISTING DRAINAGE AREA LIMITS

| 12 | | |
|-----|--|-------------------|
| 11 | | |
| 10 | | |
| 9 | | |
| 8 | | |
| 7 | | |
| 6 | | |
| 5 | | |
| 4 | | |
| 3 | REVISED AS PER CITY COMMENTS | T.R.B. 2019.10.29 |
| 2 | REVISED AS PER NEW SITE PLAN AND CITY COMMENTS | T.R.B. 2019.09.30 |
| 1 | ISSUED FOR SPA | T.R.B. 2019.07.09 |
| No. | REVISIONS | By Date |

BLOCK 31
(BLOCK 2 - PHASE 5 REGISTRATION)
6975.6 m²
1.72 Acres

BLOCK 24, 25 AND 28
(BLOCK 4 - PHASE 5 REGISTRATION)
23155.5 m²
5.72 Acres

BLOCK 2
(BLOCK 1 - PHASE 5 REGISTRATION)
11465.283 m²

BLOCK 29, AND 32
(BLOCK 3 - PHASE 5 REGISTRATION)
8521.8 m²
2.11 Acres

WINGATE HOTEL
PROJECT NO. 114827

F.F.=105.05

PC KANATA
DEVELOPMENTS
INC.

IBI GROUP
400 - 333 Preston Street
Ottawa ON K1S 5N4 Canada
tel 613 225 1311 fax 613 225 9888
ibigroup.com

Project Title
kinaxis
8700 CAMPEAU DRIVE

PROFESSIONAL ENGINEER
T. R. BRULE
2019/10/29
PROVINCE OF ONTARIO

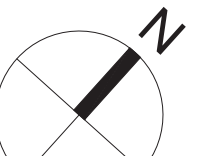

Drawing Title
**SANITARY DRAINAGE
AREA PLAN**

Scale
1 : 500

| | | | |
|-------------|-----------|-------------|-----------|
| Design | JB | Date | JULY 2019 |
| Drawn | DPS/DD/EH | Checked | TRB |
| Project No. | 121693 | Drawing No. | C-400 |

J:\121693_kinaxis\0_Production\03_Design\04_Civil\Sheets\C-400_SANITARY_DRAINAGE_AREA_PLAN.dwg
Name: C-400_Plot_Sheet_AIA_STANDARD-HAIF_CTB_Plot_Scale: 1:25.4
Printed At: 10/25/2019 9:54 AM
User: Savel By: CSUBINA

D07-12-19-0122

#17988

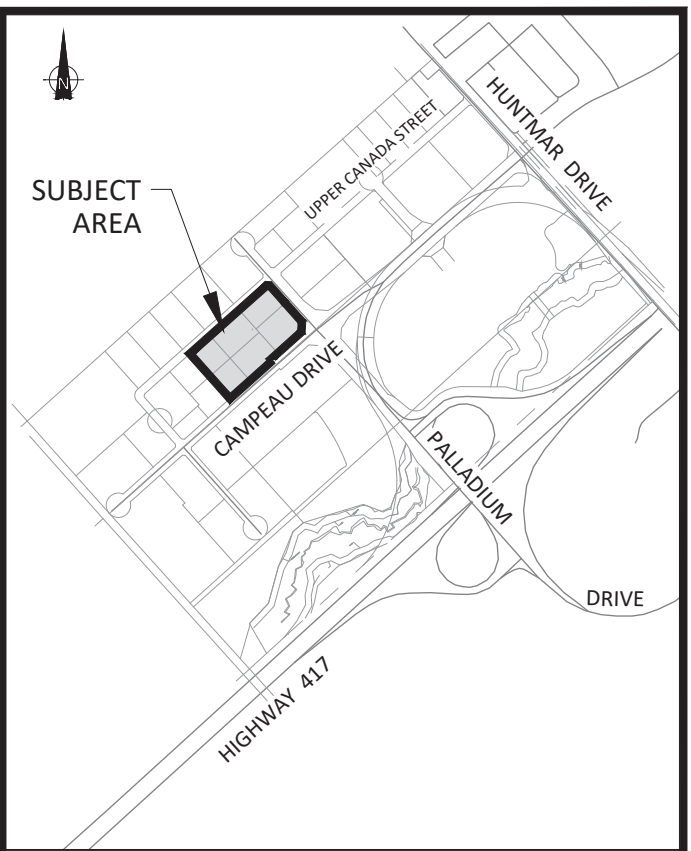
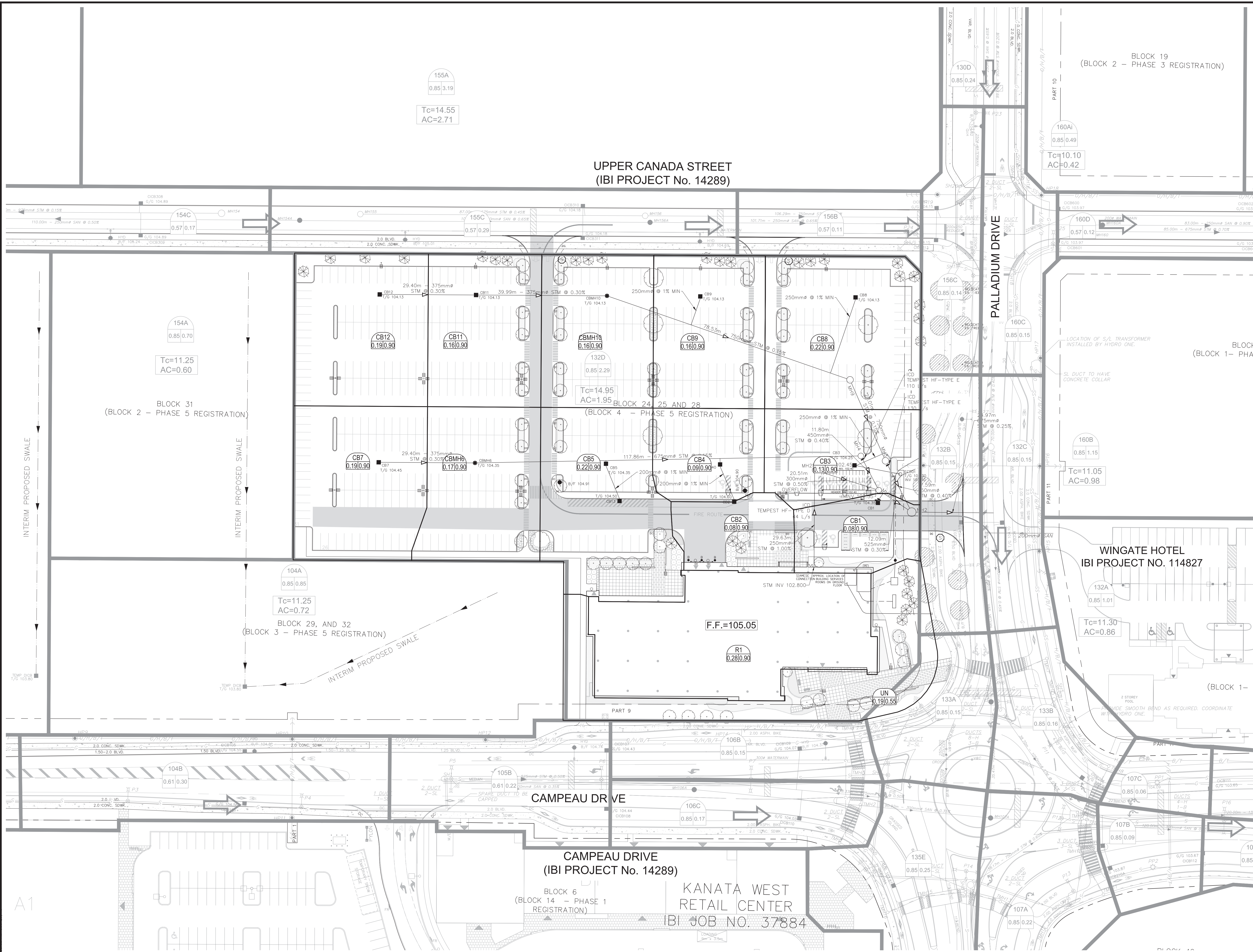

NOTES:
 1. SEE DETAIL DRAWING C-010 FOR ADDITIONAL DETAILS AND NOTES.
 2. SITE BENCHMARK TO BE OBTAINED FROM LEGAL SURVEYOR STANTEC GEOMATICS.

- LEGEND:**
- AREA NUMBER
 - RUNOFF COEFFICIENT
 - AREA IN HECTARES
 - EXISTING AREA NUMBER
 - EXISTING AREA IN HECTARES
 - EXISTING RUNOFF COEFFICIENT
 - ESTIMATED TIME OF CONCENTRATION IN MINUTES PRODUCT OF AREA AND RUNOFF COEFFICIENT
 - DRAINAGE AREA LIMITS
 - EXISTING DRAINAGE AREA LIMITS
 - EXISTING EMERGENCY OVERLAND FLOW

| 10 | | | |
|-----|--|--------|------------|
| 9 | | | |
| 8 | | | |
| 7 | | | |
| 6 | | | |
| 5 | | | |
| 4 | | | |
| 3 | REVISED AS PER CITY COMMENTS | T.R.B. | 2019-10-29 |
| 2 | REVISED AS PER NEW SITE PLAN AND CITY COMMENTS | T.R.B. | 2019-09-30 |
| 1 | ISSUED FOR SPA | T.R.B. | 2019-07-09 |
| No. | REVISIONS | By | Date |

PC KANATA DEVELOPMENTS INC.

IBI GROUP
 400 - 333 Preston Street
 Ottawa ON K1S 5N4 Canada
 tel 613 225 1311 fax 613 225 9868
 ibigroup.com

Project Title

8700 CAMPEAU DRIVE

PROFESSIONAL ENGINEER

T. R. BRULE
 2019/10/29
 PROVINCE OF ONTARIO

Drawing Title
STORM DRAINAGE AREA PLAN

Scale
 1 : 500

| | | | |
|-------------|-----------|-------------|-----------|
| Design | JB | Date | JULY 2019 |
| Drawn | DPS/DD/EH | Checked | TRB |
| Project No. | 121693 | Drawing No. | C-500 |

J:\121693_Kinaxis\0_Production\03_Production\03_000 STORM DRAINAGE AREA PLAN.dwg Layout Name: C-500 Plot Style: AIA STANDARD-HALF CTB Plot Scale: 1:25 x Plotted At: 10/29/2019 9:55 AM Last Saved By: DSI/RAA Last

D07-12-19-0122

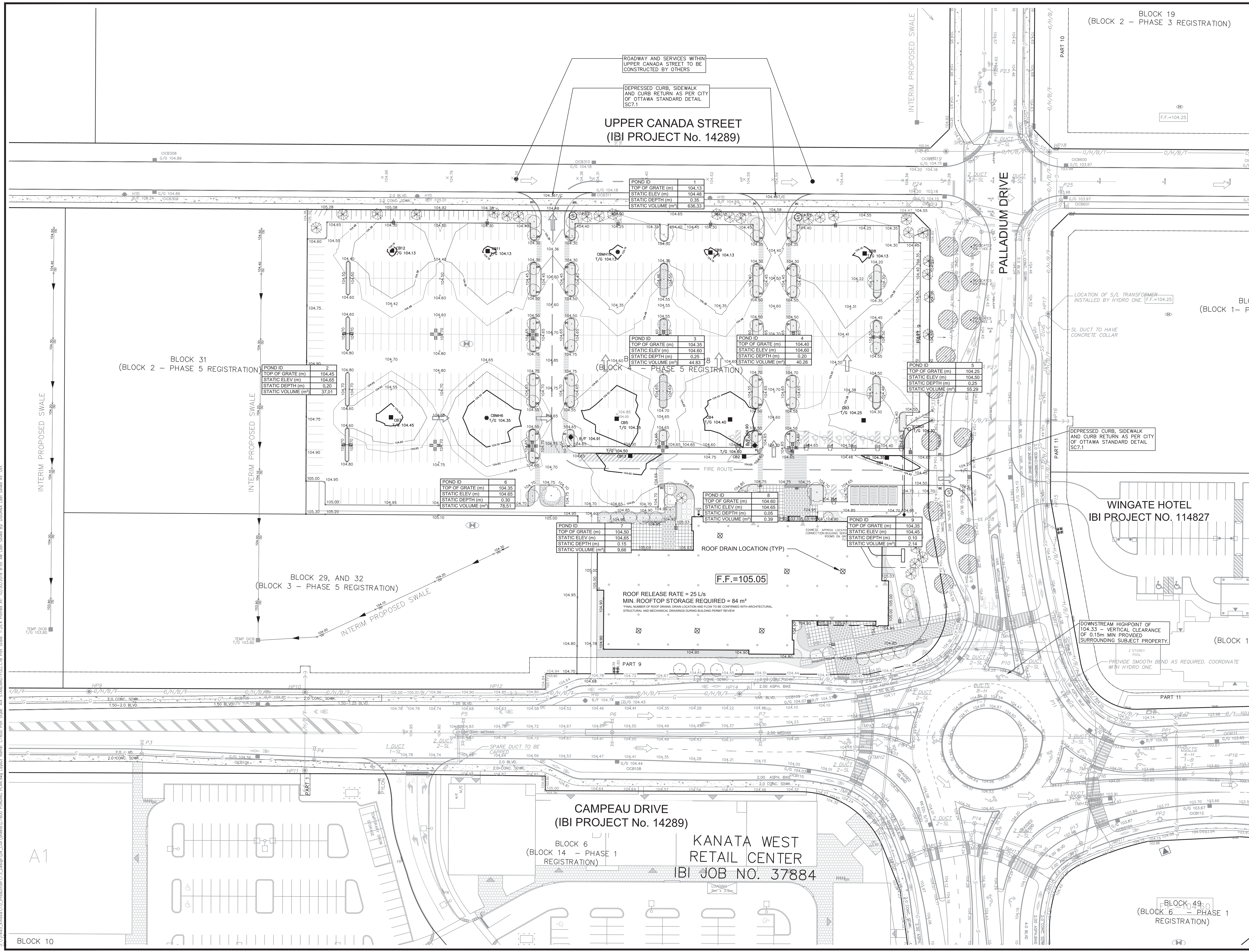

ROADWAY AND SERVICES WITHIN UPPER CANADA STREET TO BE CONSTRUCTED BY OTHERS

DEPRESSED CURB, SIDEWALK AND CURB RETURN AS PER CITY OF OTTAWA STANDARD DETAIL SCT.1

UPPER CANADA STREET (IBI PROJECT No. 14289)

BLOCK 19
(BLOCK 2 - PHASE 3 REGISTRATION)

BLOCK 31
(BLOCK 2 - PHASE 5 REGISTRATION)

BLOCK 4 - PHASE 5 REGISTRATION

BLOCK 29, AND 32
(BLOCK 3 - PHASE 5 REGISTRATION)

WINGATE HOTEL
IBI PROJECT NO. 114827

CAMPEAU DRIVE
(IBI PROJECT No. 14289)

KANATA WEST RETAIL CENTER
IBI JOB NO. 37884

BLOCK 49
(BLOCK 6 - PHASE 1 REGISTRATION)

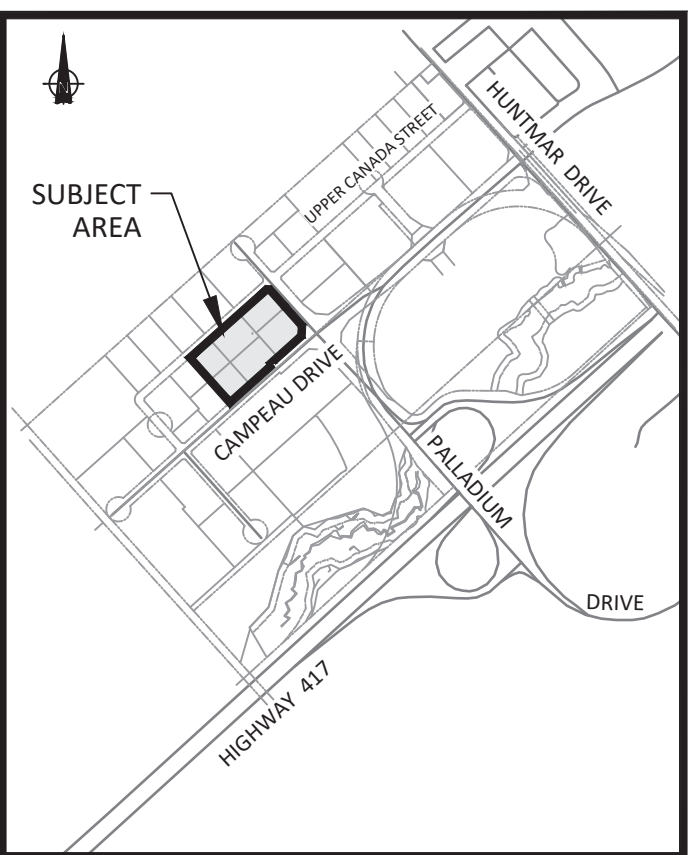

KEY PLAN
(N.T.S)

- NOTES:**
- SEE DETAIL DRAWING C-010 FOR ADDITIONAL DETAILS AND NOTES.
 - SITE BENCHMARK TO BE OBTAINED FROM LEGAL SURVEYOR STANTEC GEOMATICS.

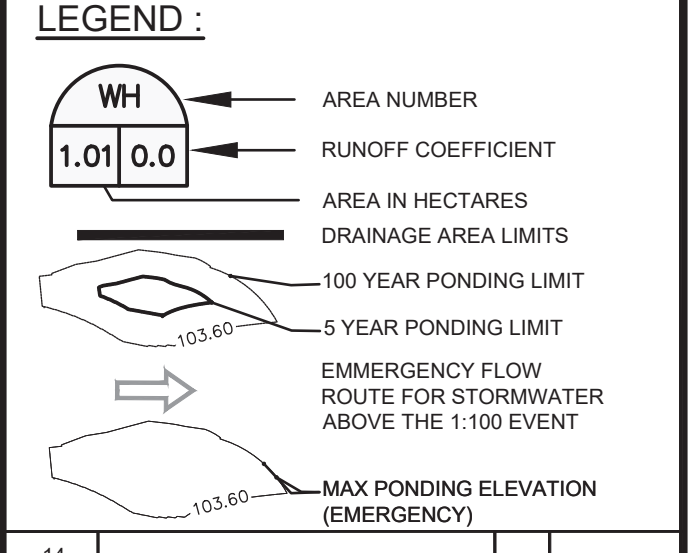

| No. | REVISIONS | By | Date |
|-----|--|--------|------------|
| 14 | | | |
| 13 | | | |
| 12 | | | |
| 11 | | | |
| 10 | | | |
| 9 | | | |
| 8 | | | |
| 7 | | | |
| 6 | | | |
| 5 | | | |
| 4 | | | |
| 3 | REVISED AS PER CITY COMMENTS | T.R.B. | 2019/10/29 |
| 2 | REVISED AS PER NEW SITE PLAN AND CITY COMMENTS | T.R.B. | 2019/09/30 |
| 1 | ISSUED FOR SPA | T.R.B. | 2019/07/09 |

PC KANATA DEVELOPMENTS INC.

IBI GROUP
400 - 333 Preston Street
Ottawa ON K1S 5N4 Canada
tel 613 225 1311 fax 613 225 9888
ibigroup.com

Project Title
kinaxis
8700 CAMPEAU DRIVE

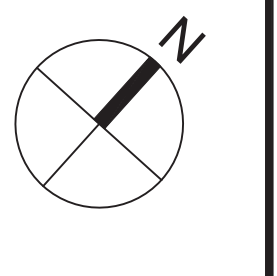

PONDING PLAN

Scale 1 : 500

| Design | Date |
|-------------|-------------|
| JB | JULY 2019 |
| Drawn | Checked |
| DPS/DD/EH | TRB |
| Project No. | Drawing No. |
| 121693 | C-600 |

J:\121693_kinaxis\121693_Production\121693_Ponding-Full\121693_Ponding-Full.dwg Plot Scale: 1:25.4 Printed At: 10/29/2019 8:55 AM Last Saved By: DSURINA, Last Saved At: Oct. 29, 2019 10:44:44 AM

D07-12-19-0122

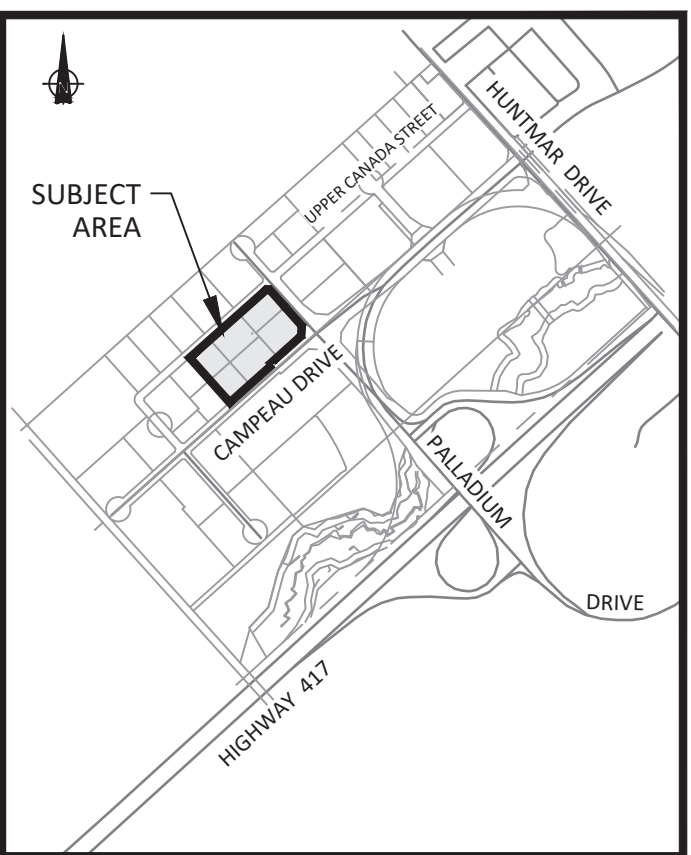
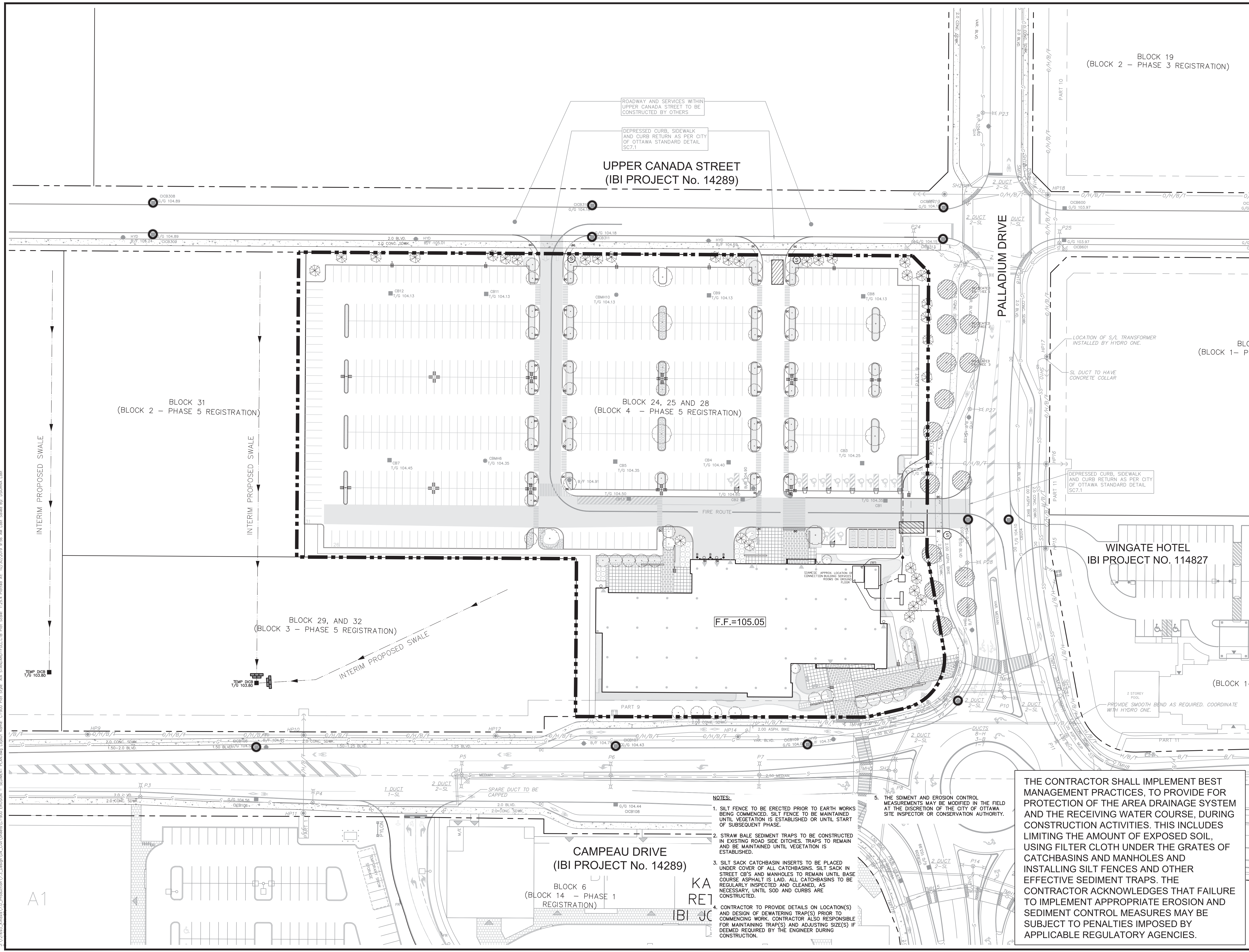

KEY PLAN
(NTS)

NOTES:
 1. SEE DETAIL DRAWING C-010 FOR ADDITIONAL DETAILS AND NOTES.
 2. SITE BENCHMARK TO BE OBTAINED FROM LEGAL SURVEYOR STANTEC GEOMATICS.

- LEGEND :**
- LIGHT DUTY SILT FENCE AS PER OFSD-219.110
 - STRAW BALE CHECK DAM AS PER OFSD-219.160
 - SILT SACK CATCHBASIN INSERT PLACED UNDER CB OR MH COVER
 - TEMPORARY MUD MAT 0.15m THICK, 50mm CLEAR STONE ON NON WOVEN FILTER CLOTH

| No. | REVISIONS | By | Date |
|-----|--|--------|------------|
| 14 | | | |
| 13 | | | |
| 12 | | | |
| 11 | | | |
| 10 | | | |
| 9 | | | |
| 8 | | | |
| 7 | | | |
| 6 | | | |
| 5 | | | |
| 4 | | | |
| 3 | REVISED AS PER CITY COMMENTS | T.R.B. | 2019-10-29 |
| 2 | REVISED AS PER NEW SITE PLAN AND CITY COMMENTS | T.R.B. | 2019-09-30 |
| 1 | ISSUED FOR SPA | T.R.B. | 2019-07-09 |

PC KANATA DEVELOPMENTS INC.

IBI GROUP
 400 - 333 Preston Street
 Ottawa ON K1S 5N4 Canada
 tel 613 225 1311 fax 613 225 9868
 ibigroup.com

Project Title
kinaxis
8700 CAMPEAU DRIVE

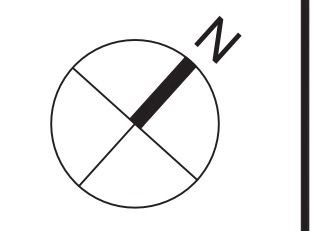
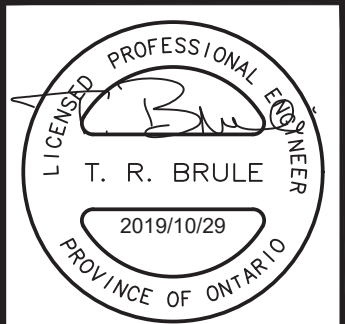

EROSION AND SEDIMENT PLAN

Scale 1 : 500

| | | | |
|-------------|-----------|-------------|-----------|
| Design | JB | Date | JULY 2019 |
| Drawn | DPS/DD/EH | Checked | TRB |
| Project No. | 121693 | Drawing No. | C-900 |

THE CONTRACTOR SHALL IMPLEMENT BEST MANAGEMENT PRACTICES, TO PROVIDE FOR PROTECTION OF THE AREA DRAINAGE SYSTEM AND THE RECEIVING WATER COURSE, DURING CONSTRUCTION ACTIVITIES. THIS INCLUDES LIMITING THE AMOUNT OF EXPOSED SOIL, USING FILTER CLOTH UNDER THE GRATES OF CATCHBASINS AND MANHOLES AND INSTALLING SILT FENCES AND OTHER EFFECTIVE SEDIMENT TRAPS. THE CONTRACTOR ACKNOWLEDGES THAT FAILURE TO IMPLEMENT APPROPRIATE EROSION AND SEDIMENT CONTROL MEASURES MAY BE SUBJECT TO PENALTIES IMPOSED BY APPLICABLE REGULATORY AGENCIES.

- NOTES:**
- SILT FENCE TO BE ERRECTED PRIOR TO EARTH WORKS BEING COMMENCED. SILT FENCE TO BE MAINTAINED UNTIL VEGETATION IS ESTABLISHED OR UNTIL START OF SUBSEQUENT PHASE.
 - STRAW BALE SEDIMENT TRAPS TO BE CONSTRUCTED IN EXISTING ROAD SIDE DITCHES. TRAPS TO REMAIN AND BE MAINTAINED UNTIL VEGETATION IS ESTABLISHED.
 - SILT SACK CATCHBASIN INSERTS TO BE PLACED UNDER COVER OF ALL CATCHBASINS. SILT SACK IN STREET C/S AND MANHOLES TO REMAIN UNTIL BASE COURSE ASPHALT IS LAID. ALL CATCHBASINS TO BE REGULARLY INSPECTED AND CLEANED, AS NECESSARY, UNTIL SOD AND CURBS ARE CONSTRUCTED.
 - CONTRACTOR TO PROVIDE DETAILS ON LOCATION(S) AND DESIGN OF DEWATERING TRAP(S) PRIOR TO COMMENCING WORK. CONTRACTOR ALSO RESPONSIBLE FOR MAINTAINING TRAP(S) AND ADJUSTING SIZE(S) IF DEEMED REQUIRED BY THE ENGINEER DURING CONSTRUCTION.
 - THE SEMENT AND EROSION CONTROL MEASUREMENTS MAY BE MODIFIED IN THE FIELD AT THE DISCRETION OF THE CITY OF OTTAWA SITE INSPECTOR OR CONSERVATION AUTHORITY.

J:\121693_kinaxis\7.0_Production\03_Sheets\03_C-900_EROSION - SEDIMENT PLAN.dwg
 Name: C-900 Plot Style: AN STANDARD-FULL.CTB Plot Scale: 1:254.4 Printed At: 10/22/2019 8:56 AM Last Saved By: DSURINA, L...

D07-12-19-0122