

2 TYPICAL PAVERS ON CONCRETE DECK & COMPACTED GRADE
SCALE 1 : 20

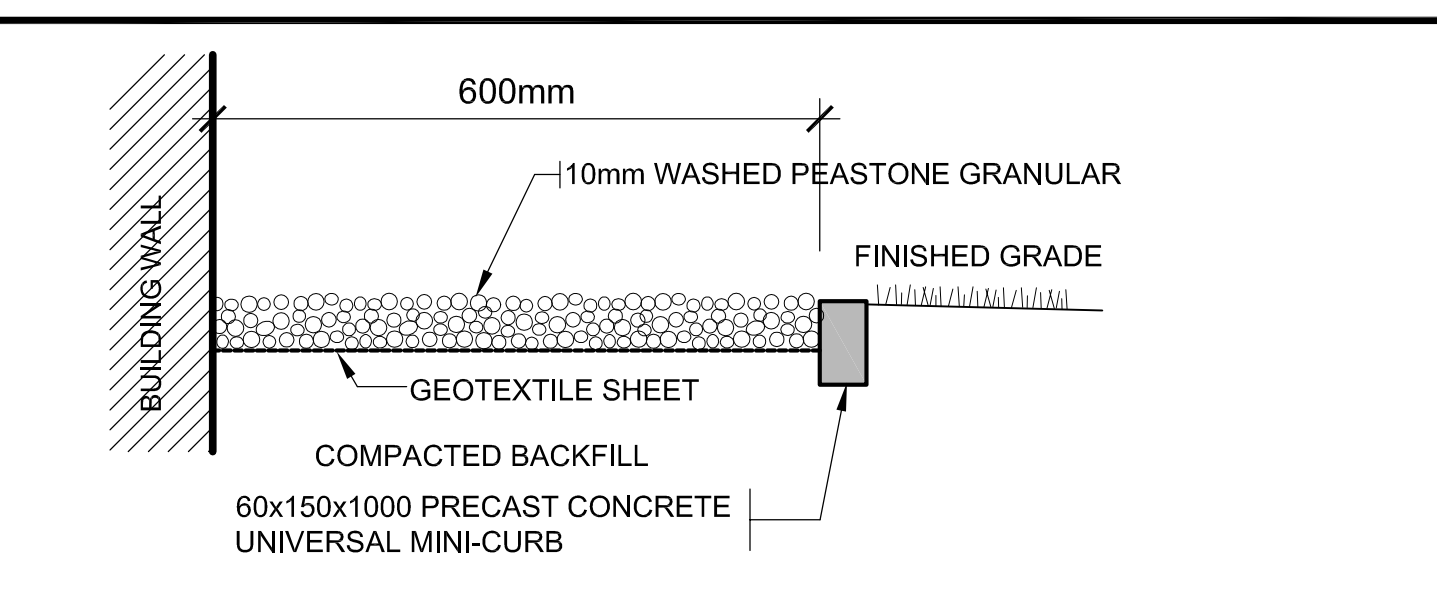

3 PEASTONE MAINTENANCE EDGE DETAIL
SCALE 1 : 25

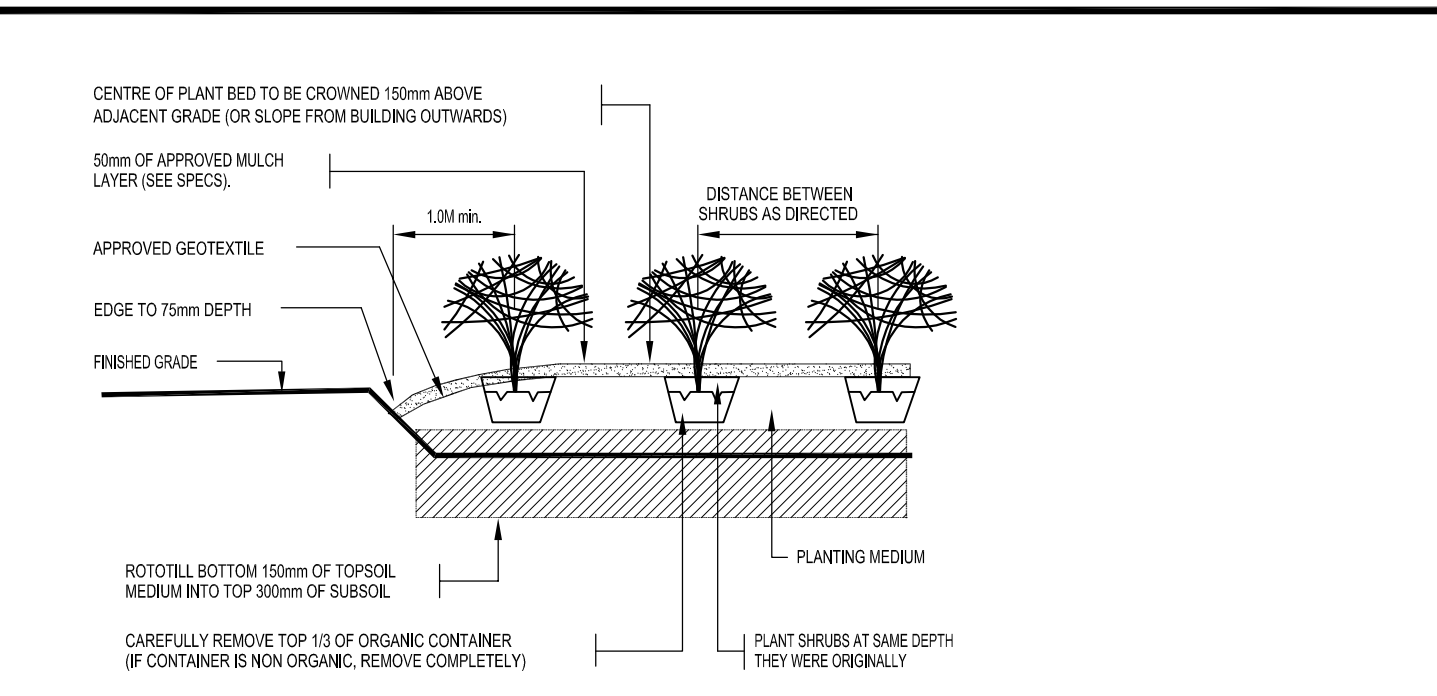

4 TYPICAL SHRUB PLANTING DETAIL
SCALE 1 : 25

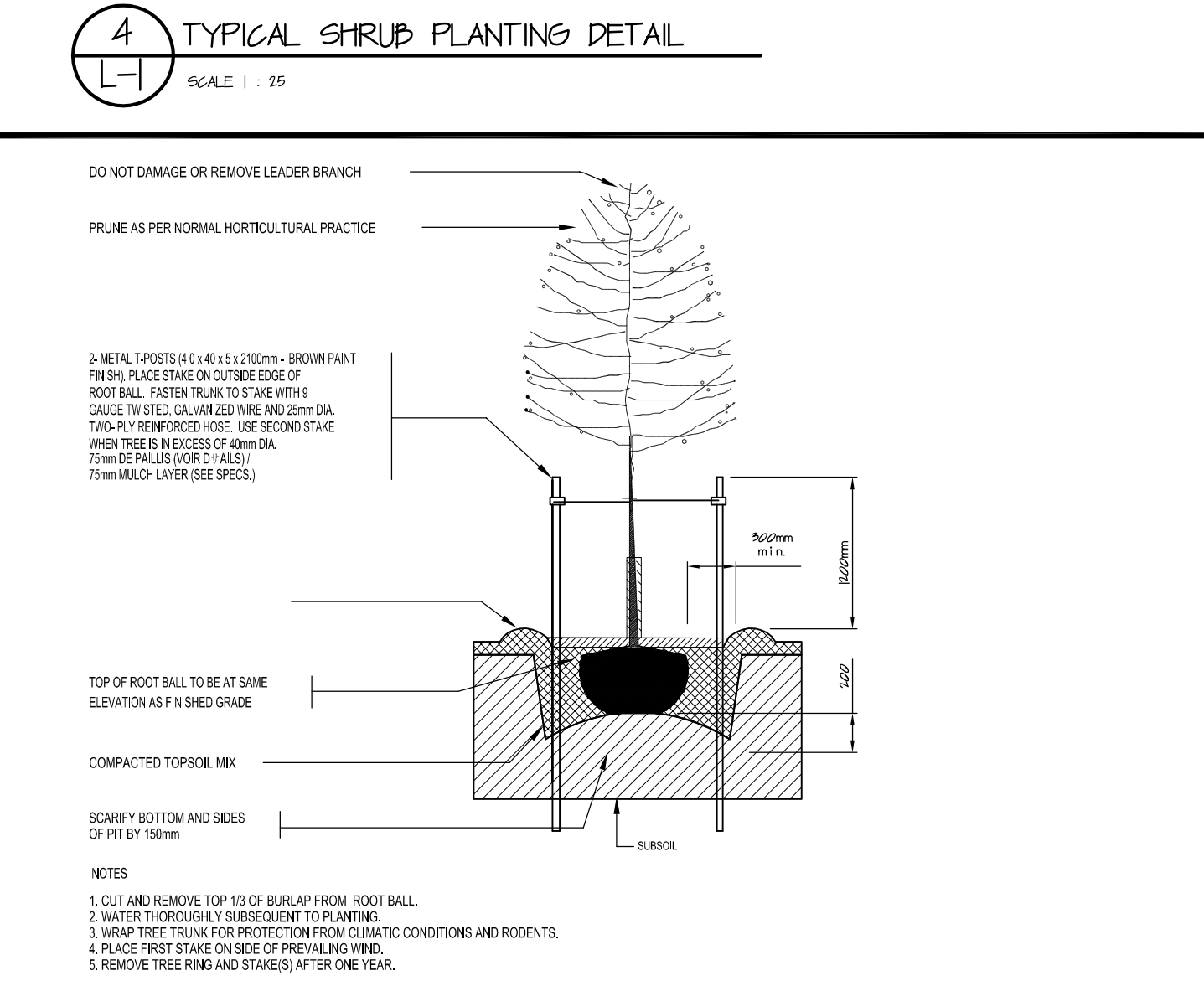

5 TYPICAL DECIDUOUS TREE PLANTING DETAIL
SCALE 1 : 25

PLANT LIST

ID.	Qty.	BOTANICAL NAME	COMMON NAME	SPACING	SCHED. SIZE	REMARKS
DECIDUOUS TREES						
AR	-	Acer Rubrum Armstrong	Armstrong Red Maple	See Plan	70mm cal.	WB, straight trunk, uniformly well branched
AC	-	Amelanchier Laevis	Allegheny Serviceberry Tree	See Plan	50mm cal.	WB, straight trunk, uniformly well branched
PO	-	Picea Pmaritica	Serbian Spruce	See Plan	240cm ht.	WB, straight trunk, uniformly well branched
SHRUBS						
CA	-	Cotonaster Acutifolius	Peking Cotoaneaster	1.0m o/c	40cm ht.	3 Gal Pots, full body, uniformly well branched
CR	-	Cornus Racemosa STO	Grey Dogwood	1.0m o/c	60cm ht.	3 Gal Pots, full body, uniformly well branched
HA	-	Hydrangea Arborescens	Annabelle Hydrangea	1.0m o/c	60cm ht.	3 Gal Pots, full body, uniformly well branched
PT	-	Parthenocissus Tricuplata	Boston Ivy	1.0m o/c	60cm ht.	3 Gal Pots, full body, uniformly well branched
EAC	-	Euonymus Aladus Compacta	Dwarf Burning Bush	1.0m o/c	60cm ht.	3 Gal Pots, full body, uniformly well branched
Ra	-	Rhus Aromatica	Fragrant Sumac	1.0m o/c	60cm ht.	3 Gal Pots, full body, uniformly well branched
CakF	-	Calamagrostis Acutiflora	Karl Foerster Feather Reed Grass	1.0m o/c	60cm ht.	3 Gal Pots, full body, uniformly well branched
Pvs	-	Panicum Virgatum	Shenandoah Switch Grass	1.0m o/c	60cm ht.	3 Gal Pots, full body, uniformly well branched
Aa	-	Astilbe	Bridal Veil	0.6m o/c	60cm ht.	1 Gal Pots
Pa	-	Perovskia Atriplicifolia	Russian Sage	1.0m o/c	60cm ht.	1 Gal Pots
VM	-	Vinca Minor	Periwinkle	0.6m o/c	60cm ht.	1 Gal Pots, 2 year old
TcM	-	Taxus Cuspidata	Monloo Japanese Yew	1.0m o/c	60cm ht.	3 Gal Pots

IRRIGATION: PROVIDE FULL COVERAGE DRIP IRRIGATION TO ALL PLANT BEDS, TREE PITS AND PLANTERS

GENERAL NOTES

1. ALL GENERAL SITE INFORMATION AND CONDITIONS COMPILED FROM EXISTING PLANS AND CONSULTANTS' FIELD NOTES. REPORT ALL DISCREPANCIES PRIOR TO ANY WORK. NO RESPONSIBILITY IS BORNE BY THE CONSULTANT FOR UNDERLYING SUBSURFACE CONDITIONS.

2. THE CONTRACTOR IS TO NOTIFY ALL UTILITY COMPANIES PRIOR TO EXCAVATION TO ASCERTAIN LOCATION OF UNDERLYING SERVICES. VERIFY ALL ELEVATIONS WITH INFORMATION SHOWN ON PLANS.

3. ALL DIMENSIONS AND GRADES ARE TO BE VERIFIED ON SITE PRIOR TO ANY CONSTRUCTION BY THE LANDSCAPE ARCHITECT.

4. CONTRACTOR IS TO MAINTAIN POSITIVE SURFACE RUNOFF THROUGHOUT THE ENTIRE CONSTRUCTION PERIOD.

5. REINSTATE ALL DAMAGE CAUSED CONTRACTOR TO STRUCTURES, CURBS, PAVEMENT, PLANTING, ROAD SHOULDERS AND OTHER SITE AMENITIES.

6. CONTRACTOR TO STAKE PLANTING LOCATION AND OTHER SITE AMENITIES, UNDER SUPERVISION OF LANDSCAPE ARCHITECT, PRIOR TO ANY WORK.

7. NO MODIFICATIONS TO PLANS AND DETAILS, AND NO MATERIALS SUBSTITUTIONS IS PERMITTED WITHOUT THE WRITTEN AUTHORIZATION OF THE LANDSCAPE ARCHITECT.

8. USE OF THIS PLAN WITHOUT THE LANDSCAPE ARCHITECT'S SEAL AND SIGNATURE IS NOT ALLOWED AND RELEASES THE LANDSCAPE ARCHITECT OF ANY RESPONSIBILITY.

NO.	DATE	REVISION
2	Jan 20, 20	ISSUED FOR 1st ROUND COMMENTS
1	June 30, 19	ISSUED FOR SPC AND ZONING AMENDMENT

JBHOLDINGS

107 Pretoria Ave. Ottawa, Ontario



PROJECT

24-30 PRETORIA AVENUE

OTTAWA ONTARIO

TITLE

LANDSCAPE PLAN

NORTH

DRAWN BY: J.W. / R.V.

DATE: March 2019

SCALE: 1 : 75

VERIFIED BY: J. Wheeler

PROJECT NO: KD-2019-2

PLAN NO: L-1

REV #0

