

NOTE: The location of utilities is approximate only, the exact location should be determined by consulting the municipal authorities and utility companies concerned. The contractor shall prove the location of utilities and shall be responsible for adequate protection from damage.

No.	Description	By	Date (dd/mm/yy)

APPROVED REFUSED

THIS 28 DAY OF August, 2020

ERIN O'CONNELL, MCIP, RPP, MANAGER (A)
DEVELOPMENT REVIEW, WEST
PLANNING, INFRASTRUCTURE AND ECONOMIC
DEVELOPMENT DEPARTMENT, CITY OF OTTAWA

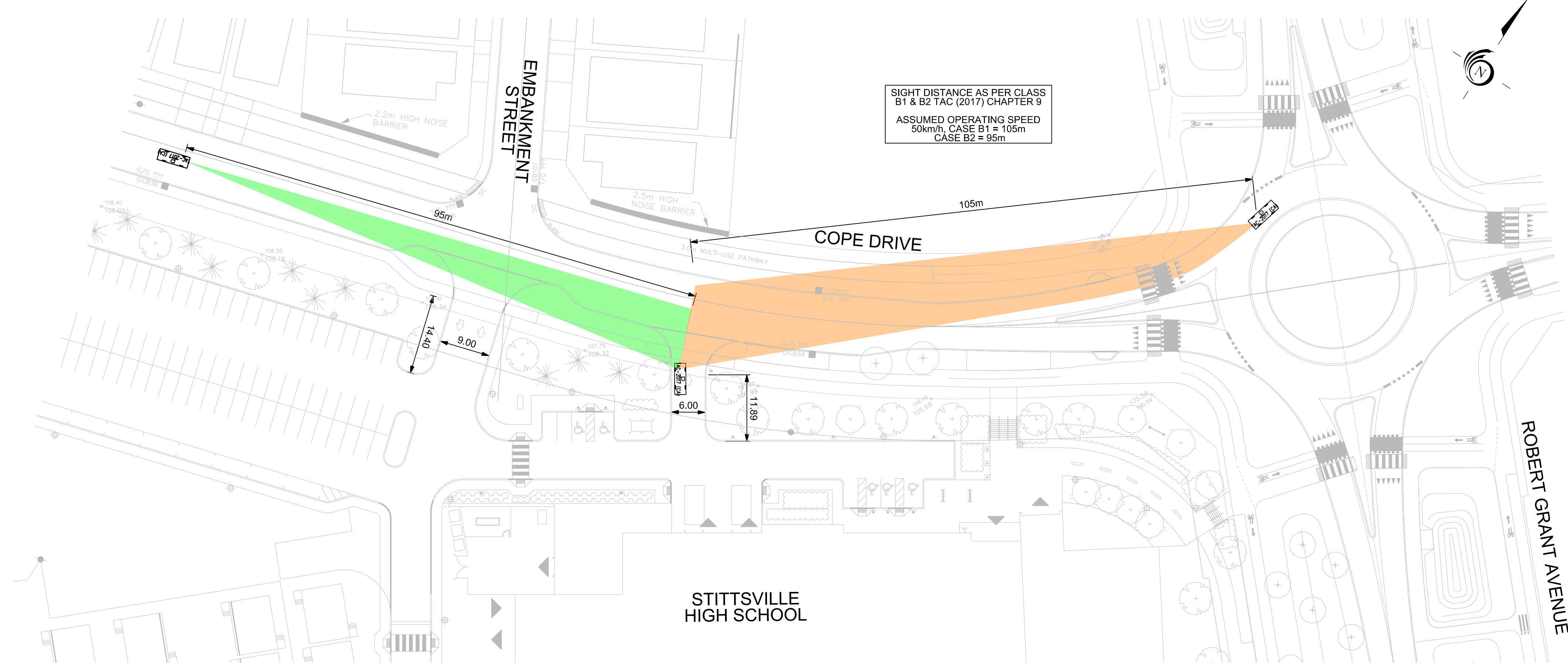
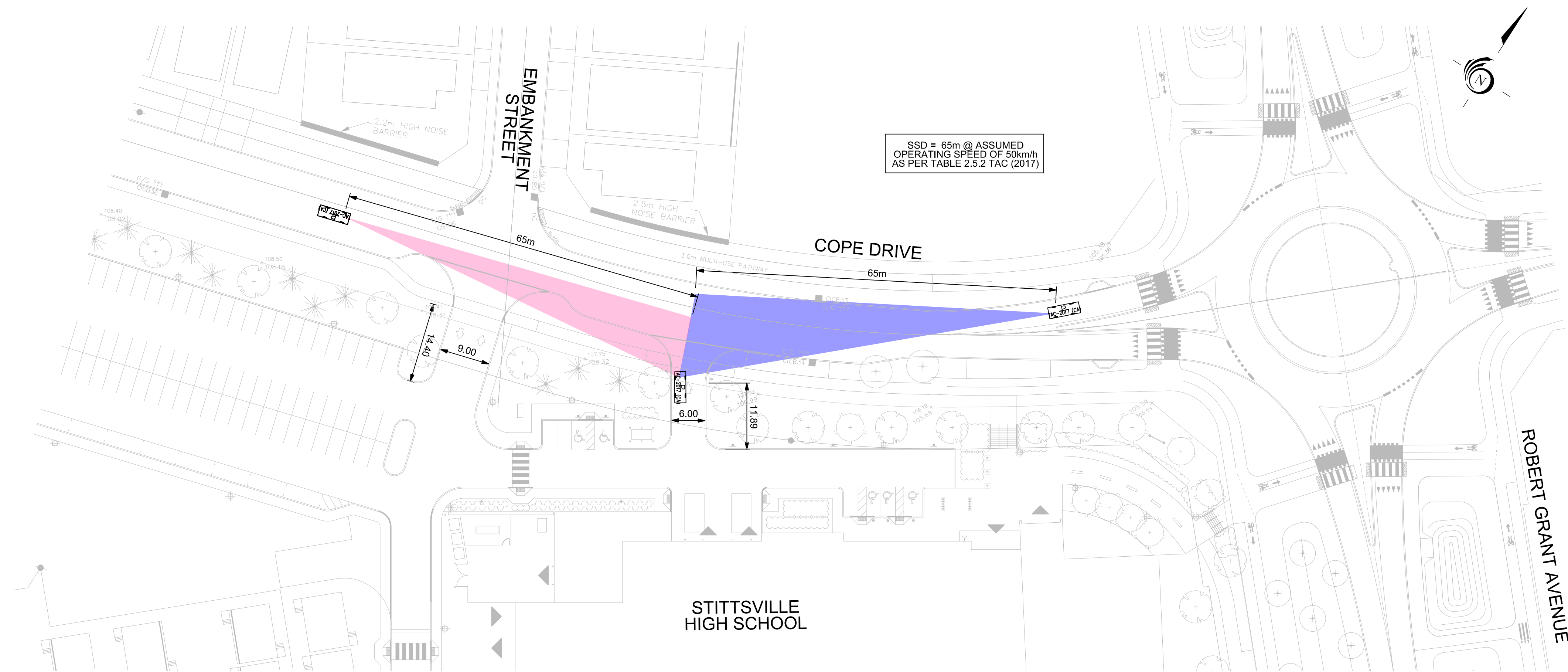

NOTE: The location of utilities is approximate only, the exact location should be determined by consulting the municipal authorities and utility companies concerned. The contractor shall prove the location of utilities and shall be responsible for adequate protection from damage.

No.	Description	By	Date (dd/mm/yy)

APPROVED REFUSED

THIS 28 DAY OF August, 2020

ERIN O'CONNELL, MCIP, RPP, MANAGER (A)
DEVELOPMENT REVIEW, WEST
PLANNING, INFRASTRUCTURE AND ECONOMIC
DEVELOPMENT DEPARTMENT, CITY OF OTTAWA

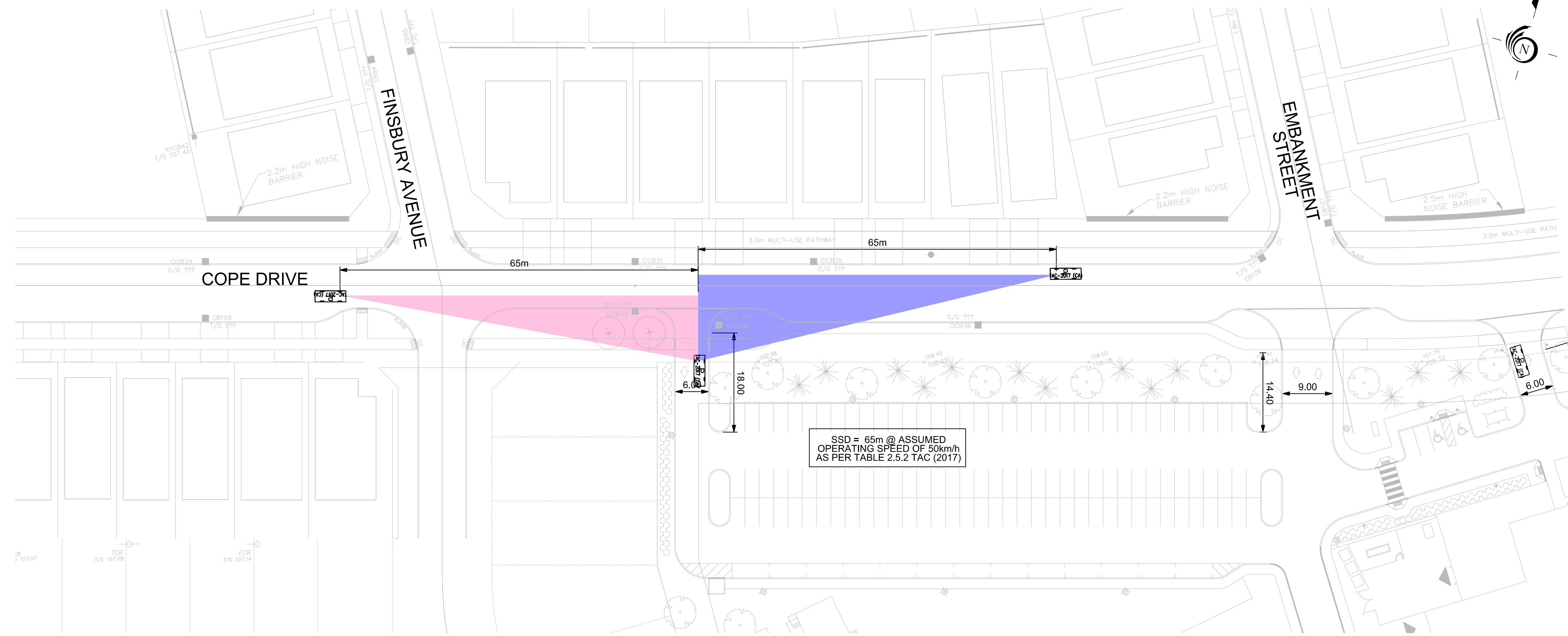

SSD = 65m @ ASSUMED
OPERATING SPEED OF 50km/h
AS PER TABLE 2.5.2 TAC (2017)

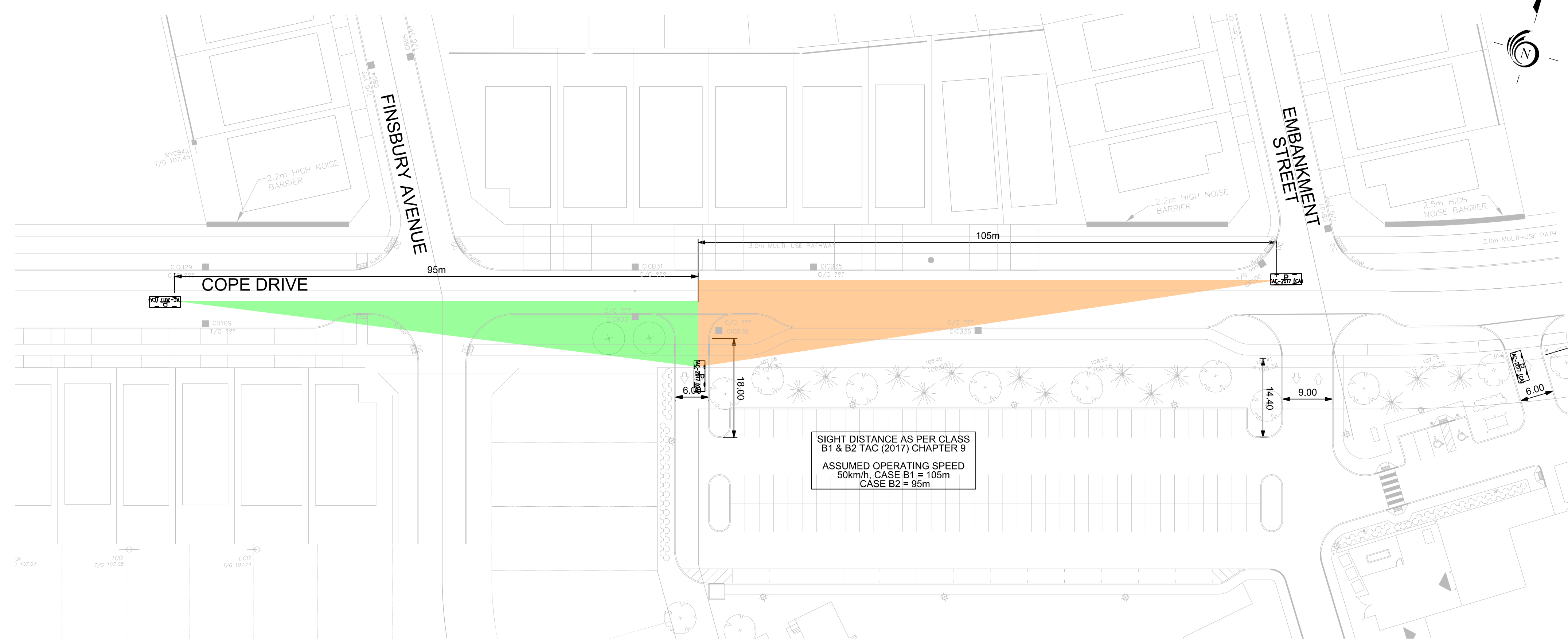

SIGHT DISTANCE AS PER CLASS
B1 & B2 TAC (2017) CHAPTER 9
ASSUMED OPERATING SPEED
50km/h, CASE B1 = 105m
CASE B2 = 95m

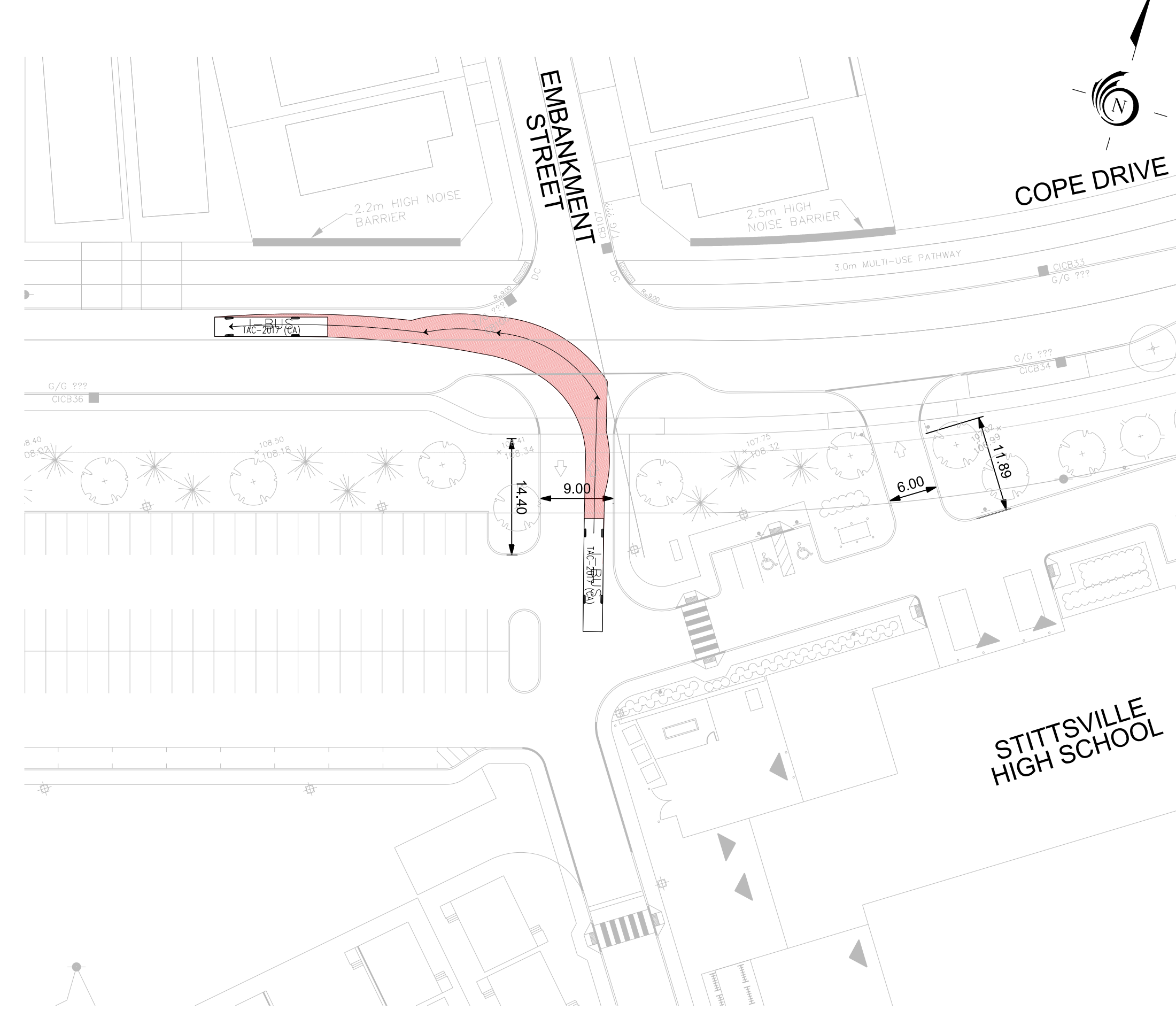
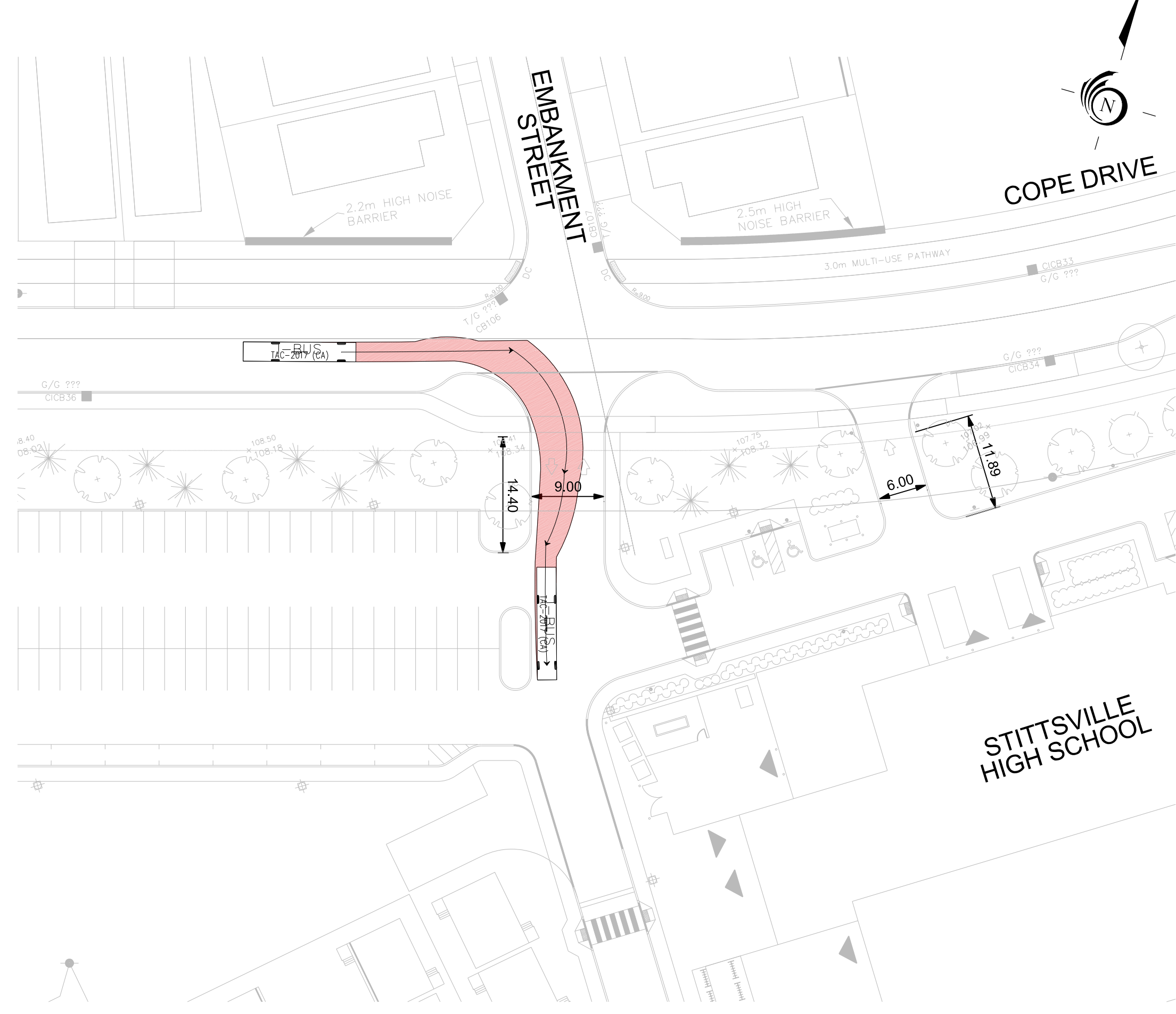
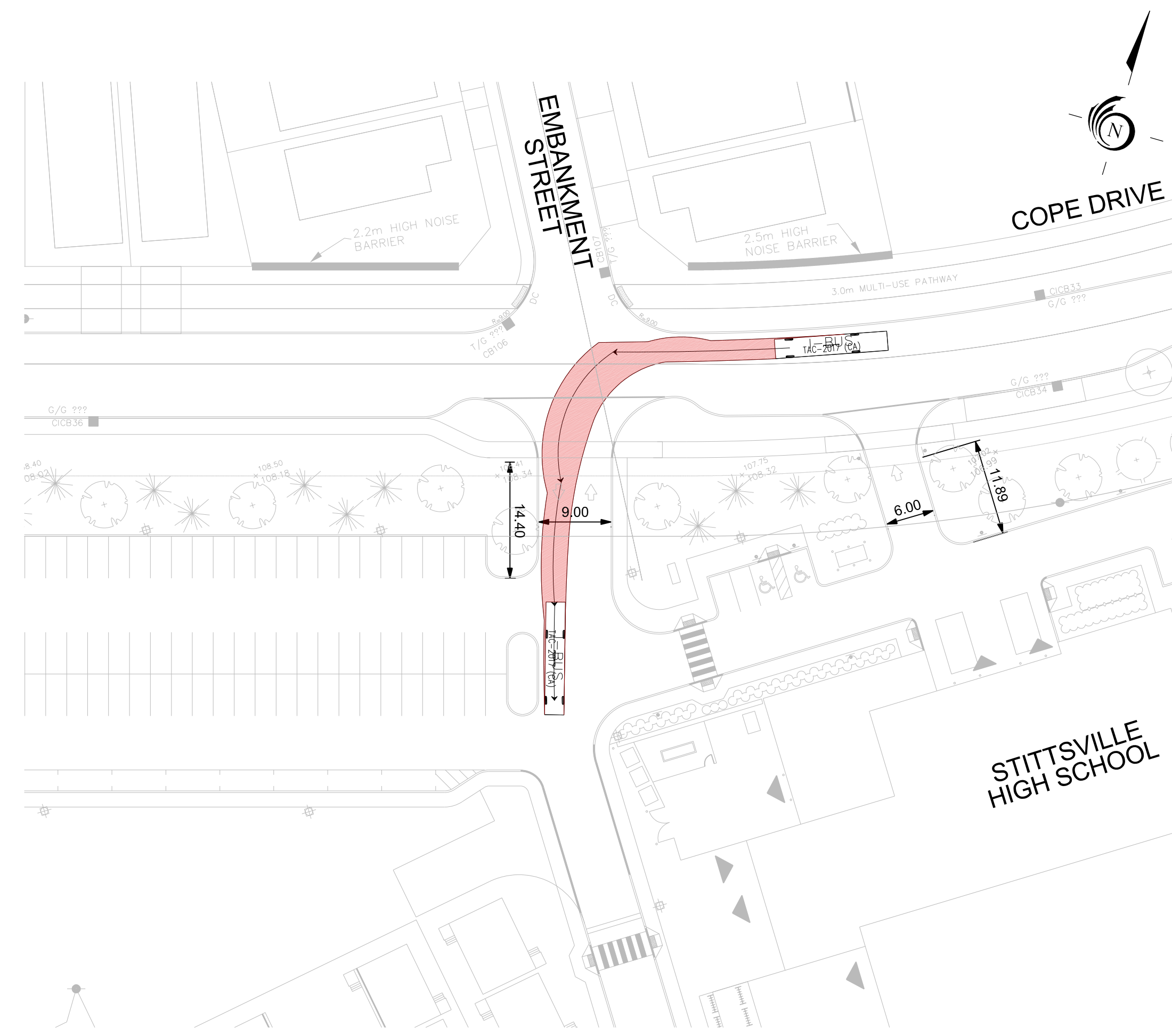
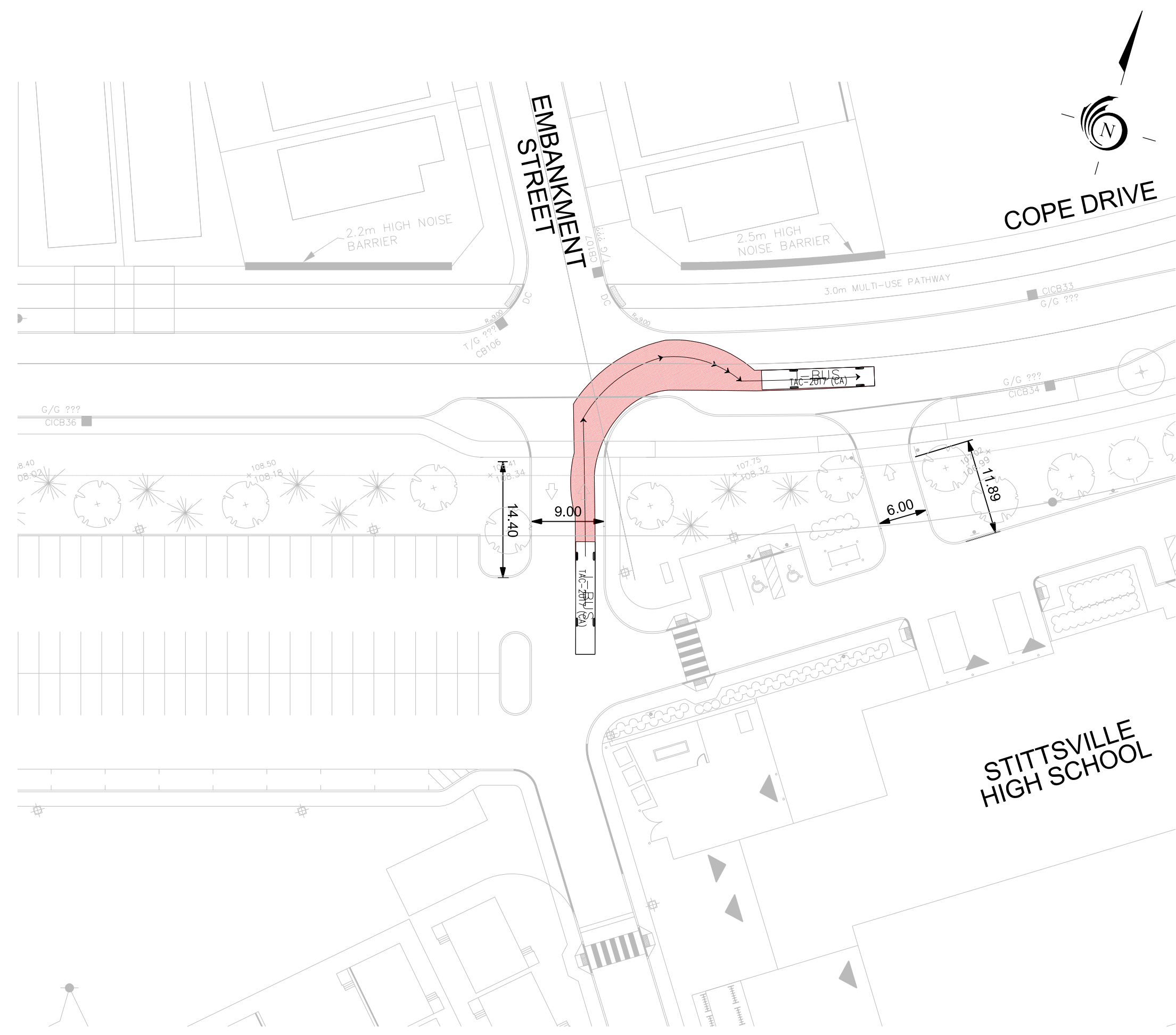

STITTSVILLE HIGH SCHOOL
700 COPE DRIVE



Contract No. 477180 Dwg. No. 003

TURNING MOVEMENTS I

Sheet 3 of 4

Asset No. _____

Asset Group _____



Des. _____ Chk'd. _____

Dwn. _____ Chk'd. _____

Utility Circ. No. _____ Index No. _____

Const. Inspector _____

Scale: HORIZONTAL

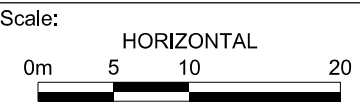

NOTE: The location of utilities is approximate only, the exact location should be determined by consulting the municipal authorities and utility companies concerned. The contractor shall prove the location of utilities and shall be responsible for adequate protection from damage.

No.	Description	By	Date (dd/mm/yy)

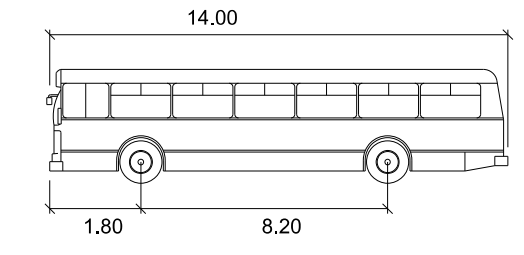

I-BUS
meters
Width : 2.40
Track : 2.40
Lock to Lock Time : 6.0
Steering Angle : 39.3

APPROVED REFUSED

THIS 28 DAY OF August, 2020

ERIN O'CONNELL, MCIP, RPP, MANAGER (A)
DEVELOPMENT REVIEW, WEST
PLANNING, INFRASTRUCTURE AND ECONOMIC
DEVELOPMENT DEPARTMENT, CITY OF OTTAWA

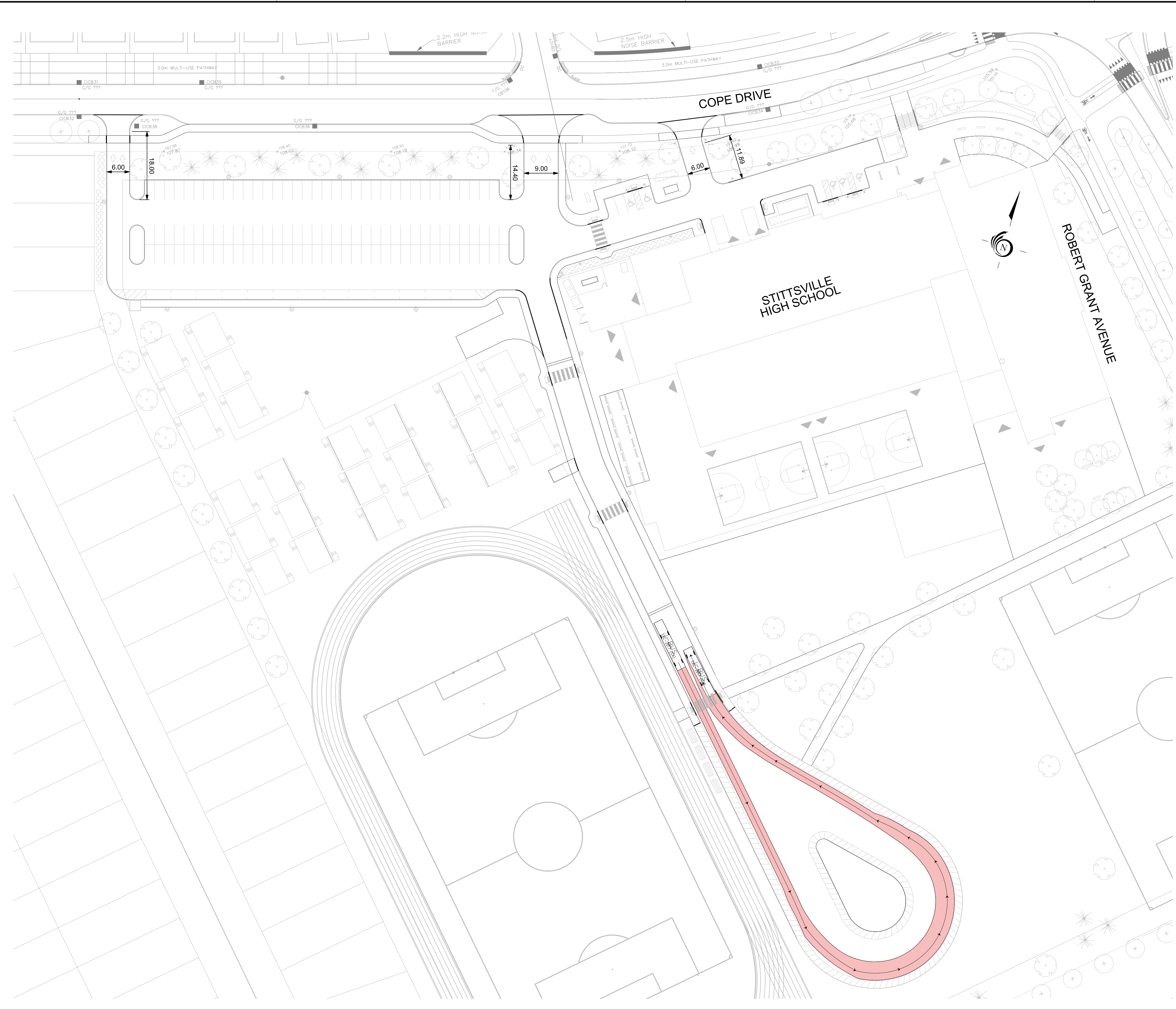

STITTSVILLE HIGH SCHOOL
700 COPE DRIVE



Contract No. 477180 Dwg. No. 004

TURNING MOVEMENTS II

Sheet 4 of 4

Asset No. _____
Director _____ Project Manager _____



Asset Group _____

Des. _____ Chk'd. _____

Dwn. _____ Chk'd. _____

Utility Circ. No. _____ Index No. _____

Const. Inspector _____

Scale: HORIZONTAL

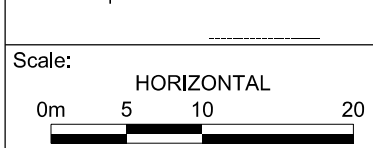

NOTE: The location of utilities is approximate only, the exact location should be determined by consulting the municipal authorities and utility companies concerned. The contractor shall prove the location of utilities and shall be responsible for adequate protection from damage.

No.	Description	By	Date (dd/mm/yy)

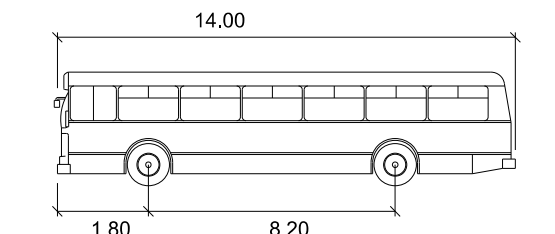

I-BUS
meters
Width : 2.40
Track : 2.40
Lock to Lock Time : 6.0
Steering Angle : 39.3

APPROVED REFUSED

THIS 28 DAY OF August, 2020

ERIN O'CONNELL, MCIP, RPP, MANAGER (A)
DEVELOPMENT REVIEW, WEST
PLANNING, INFRASTRUCTURE AND ECONOMIC
DEVELOPMENT DEPARTMENT, CITY OF OTTAWA