

plot scale 1:1

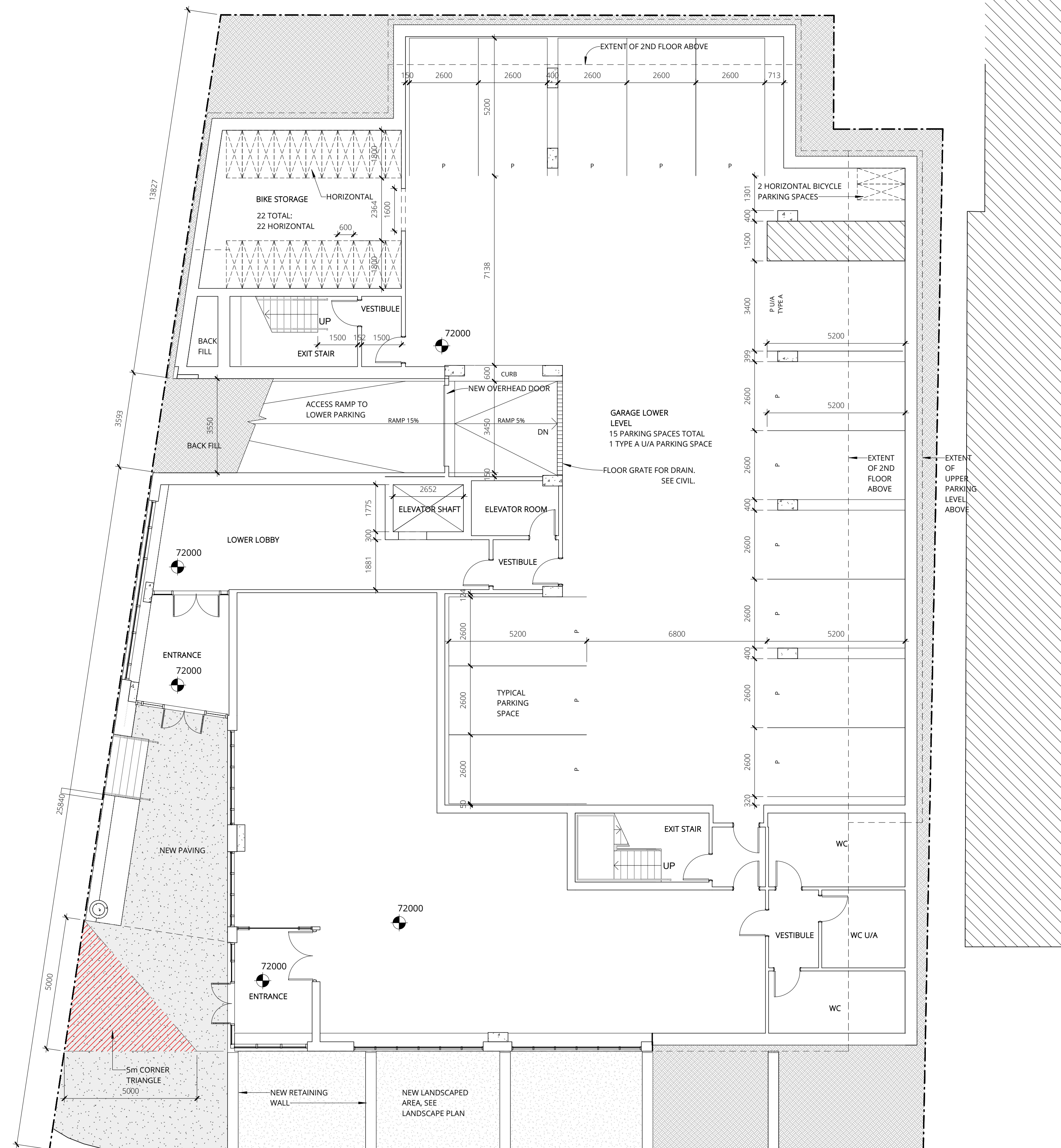

1 LO LOWER PARKING/ BASEMENT MAIN ENTRANCES AND OFFICE
A101 SCALE 1 : 100

NOTES:

Contractor shall check and verify all dimensions on site and report any discrepancies to the Architect before proceeding.

no.	revision	date
1	ISSUED FOR SITE PLAN APPROVAL R1	31 OCT 2019
0	ISSUED FOR SITE PLAN APPROVAL	16 AUG 2019

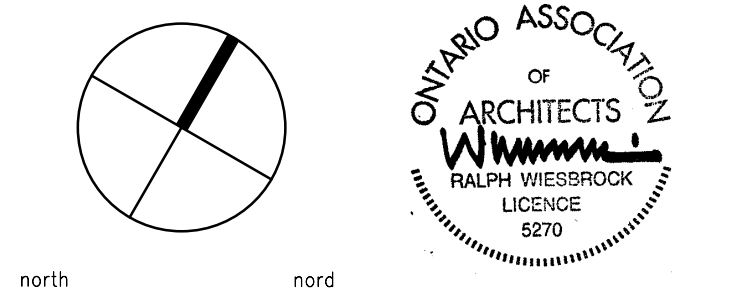

KWC ARCHITECTS INC.
383 Parkdale Avenue, Suite 201
Ottawa Ontario Canada K1Y 4R4
PHONE (613) 238-2117
FAX (613) 238-6595
E MAIL kwc@kwc-arch.com

detail no.	1	detail no.
sheet no.	A1	feuille no.

project
projet
JHS - 289 CARLING AVENUE

**JOHN HOWARD SOCIETY
289 CARLING AVE, OTTAWA**

designed by conçu par	KWC	approved by approuvé par	RZ
drawn by dessiné par	EI	project no. no. du projet	1850
date	2019-MAY-09	scale	as noted

drawing / dessin

**LEVEL 0 LOWER PARKING
PLAN**

FILE No. D07-12-19-0147
PLAN No. #18008

revision
révision

sheet no.
no. de la feuille

A101