

CONSULTANT:

SEAL:



CLIENT:

CLIENT REF. #:

PROJECT:

1164 / 1166 HIGHCROFT
 MANOTICK, ON.

KEY PLAN:

DISCLAIMER: THIS DRAWING AND DESIGN IS COPYRIGHT PROTECTED WHICH SHALL NOT BE REPRODUCED OR REVISED WITHOUT WRITTEN PERMISSION BY WSP CANADA INC. THE CONTRACTOR SHALL CHECK AND VERIFY ALL DIMENSIONS AND UTILITY LOCATIONS AND REPORT ALL ERRORS AND OMISSIONS PRIOR TO COMMENCING WORK. THIS DRAWING IS NOT TO BE SCALED.

ISSUED FOR - REVISION:

IS	RE	DATE	DESCRIPTION
	1	2021/05/03	RE-ISSUED FOR SITE PLAN APPROVAL
A		2020/07/09	ISSUED FOR SITE PLAN APPROVAL

PROJECT NO:	201-04582-00	DATE:	2020/07/07
ORIGINAL SCALE:		IF THIS BAR IS NOT 25mm LONG, ADJUST YOUR PLOTTING SCALE.	
DESIGNED BY:	D.G.	CHECKED BY:	G.G.
DISCIPLINE:	ELECTRICAL		

TITLE:	SITE LIGHTING LAYOUT		
SHEET NUMBER:	E-01	1 OF 1	REV #
ISSUE:	RE-ISSUED FOR SITE PLAN APPROVAL		
DATE OF:	2021/05/03		0

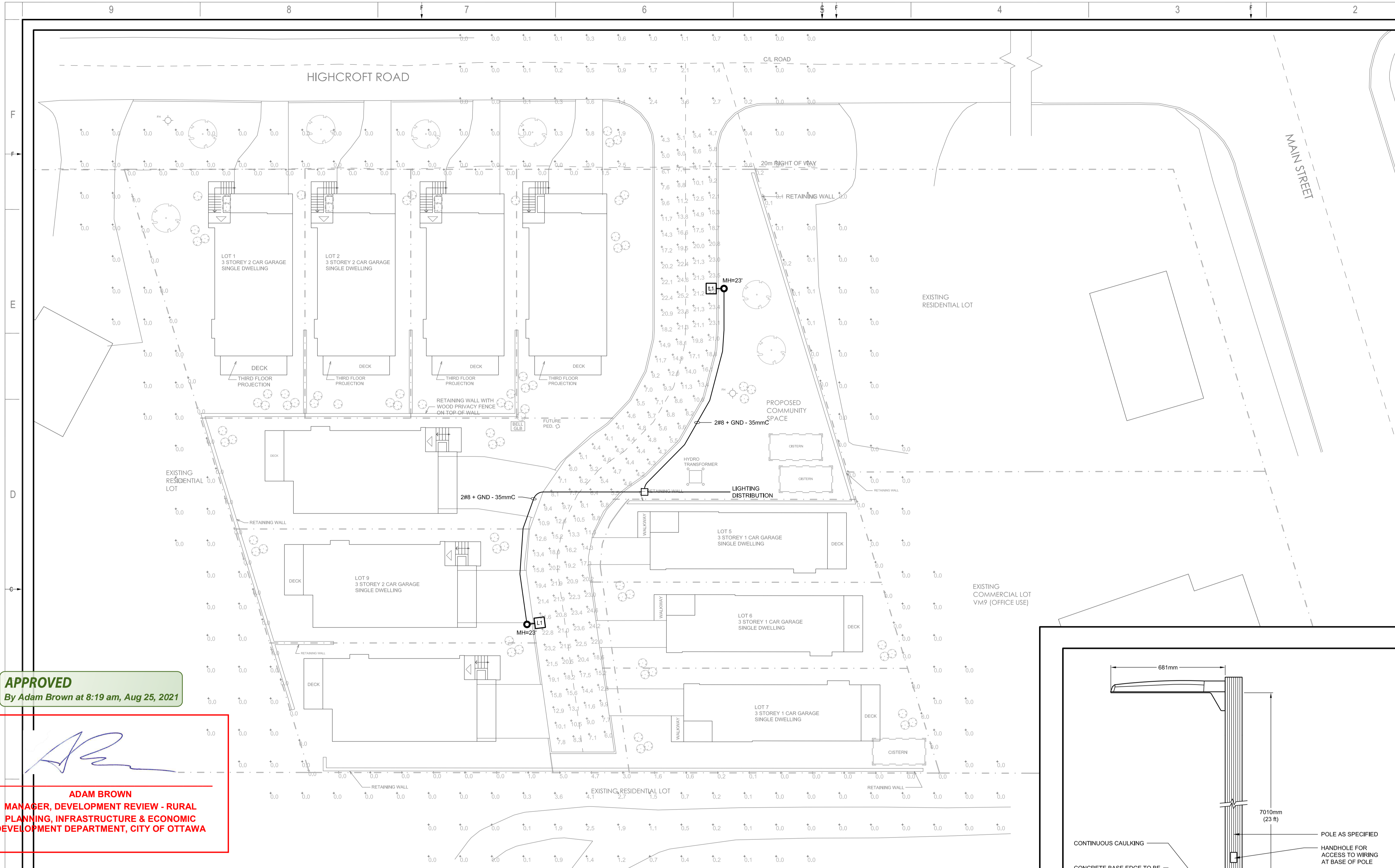

APPROVED
 By Adam Brown at 8:19 am, Aug 25, 2021

Adam Brown
ADAM BROWN
 MANAGER, DEVELOPMENT REVIEW - RURAL
 PLANNING, INFRASTRUCTURE & ECONOMIC
 DEVELOPMENT DEPARTMENT, CITY OF OTTAWA

1 SITE PLAN - LIGHTING LAYOUT
 E-01 1:200

LIGHTING FIXTURE SCHEDULE	
TYPE	L1
DISCRIPTION	STREETWORKS USSL DISCRETE LED AREA / SITE LUMINAIRE, 24 LED CONFIGURATION, TYPE II DISTRIBUTION
CATALOGUE NUMBER	USSL-PA1A-730-U-T2R-HSS
LAMPS PER FIXTURE	24
TYPE	LED
WATTS	2.25
COLOUR	3000K
TOTAL LUMENS	6926
VOLTAGE	120/208V
TOTAL WATTS	54
MOUNTING	POLE @ 7010mm (23 ft.)

ABBREVIATIONS: "LED" = LIGHT EMITTING DIODE

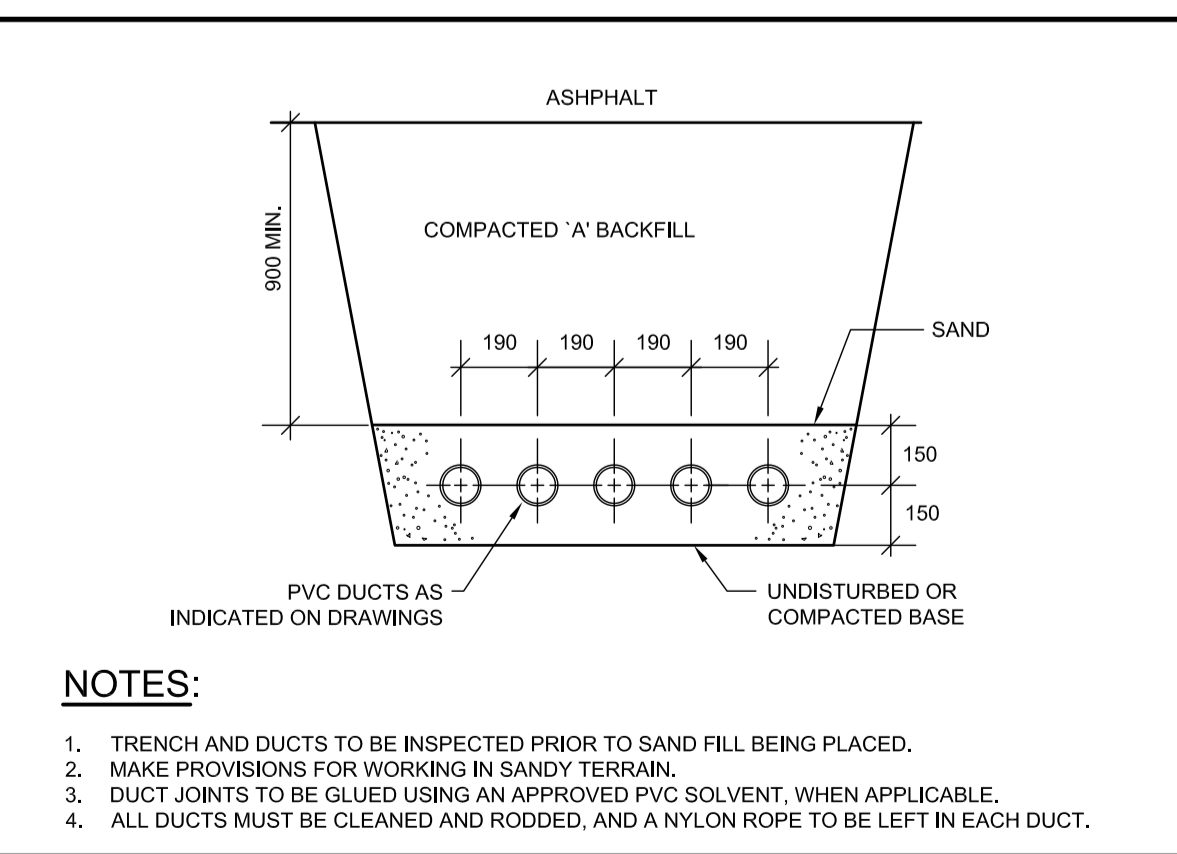

2 TYPICAL - DIRECT BURIED DUCT DETAIL
 E-01 N.T.S.

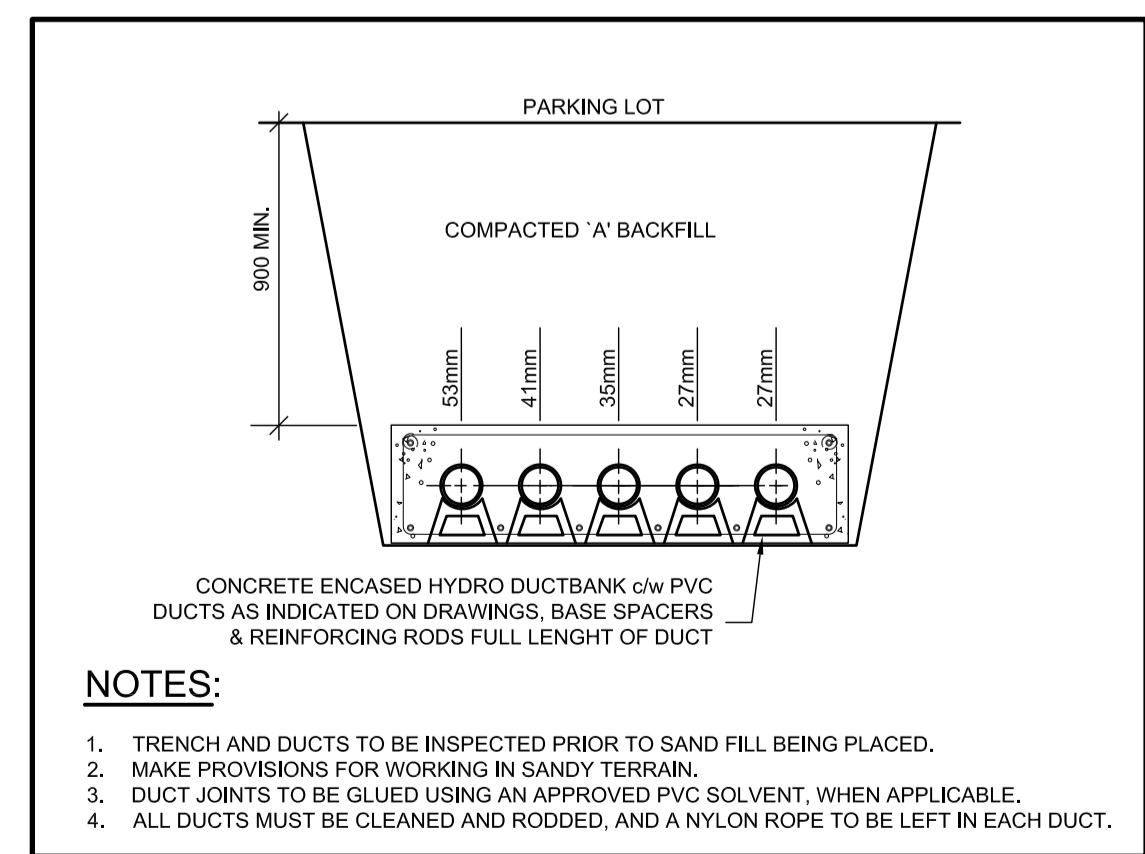

3 TYPICAL - DUCT DETAIL AT ROAD CROSSING
 E-01 N.T.S.

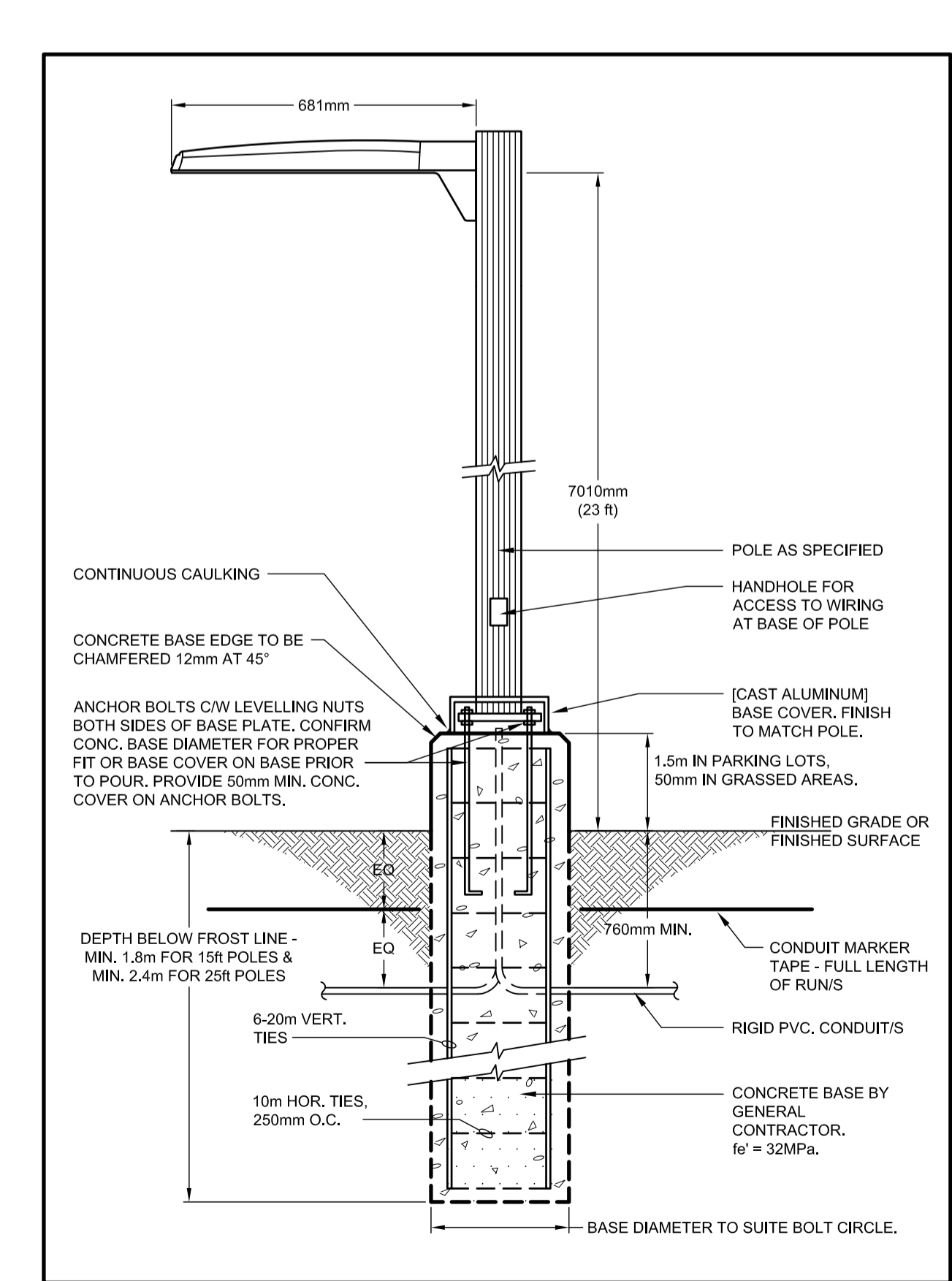

4 BASE DETAIL FOR POLE MOUNTED LUMINAIRES
 E-01 N.T.S.