

OWNER:
 NIVO DEVELOPMENTS INC.
 255 MICHAEL COWPLAND DRIVE
 OTTAWA, ONTARIO, K2M 0M5
 613-224-6200

THE EXISTING JOB BENCHMARK IS ON A UTILITY POLE THAT WILL BE RELOCATED. THE SURVEYOR SHALL ESTABLISH AN ALTERNATIVE JOB BENCHMARK PRIOR TO THE COMMENCEMENT OF CONSTRUCTION.

AN EXISTING TRANSFORMER AND STREET LIGHT ARE CONNECTED TO POLE TO BE REMOVED AND SHALL BE CONNECTED TO NEW POLE.

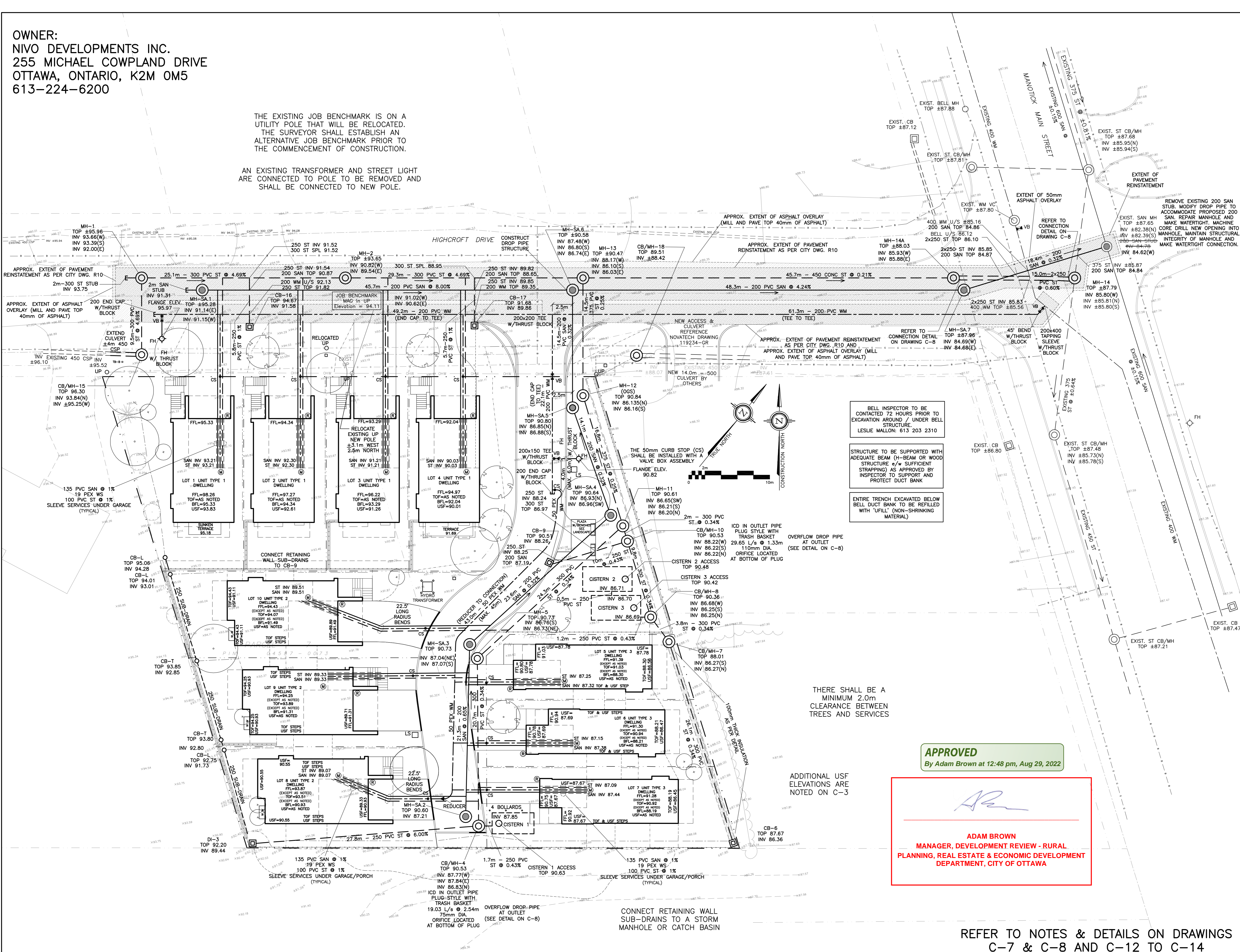

DRAWING LEGEND	
CB	CATCH BASIN
MH	MANHOLE
CB/MH	CATCH BASIN/MANHOLE
MH	SANITARY MANHOLE
SPL	SPRINGLINE OF PIPE
INV	INVERT OF PIPE
SAN	SANITARY SEWER
ST	STORM SEWER
WS/WM	WATER SERVICE/WATERMAIN
CS	CURB STOP & STANDPOST
VB	VALVE & VALVE BOX
FH	FIRE HYDRANT
M	WATER METER
R	REMOTE WATER METER READOUT
—	EXISTING GRADE ELEVATION
---	PROPERTY LINE
FFL	FIRST FLOOR ELEVATION
TOF	TOP OF FOUNDATION
BFL	BASEMENT FLOOR ELEVATION
USF	UNDERSIDE OF FOOTING

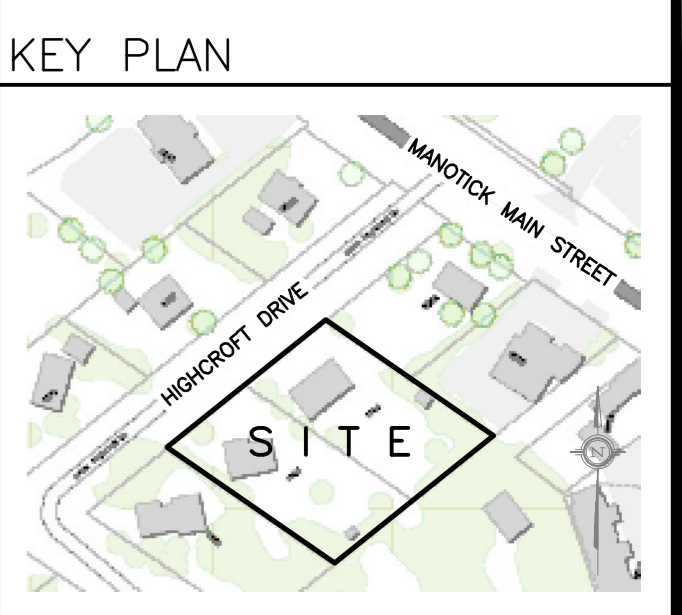

No.	DATE	REVISION
12	AUG 17-22	REVISED STORM SEWER MH-14 TO MH-14A - RE-ISSUED FOR APPROVAL
11	AUG 11-22	REVISED STORM SEWER MH-14 TO MH-14A - RE-ISSUED FOR APPROVAL
10	AUG 8-22	REVISED STORM SEWER MH-14 TO MH-14A - RE-ISSUED FOR APPROVAL
9	MAY 31-21	RE-ISSUED FOR APPROVAL
8	MAY 20-21	RE-ISSUED FOR APPROVAL
7	MAR 15-21	RE-ISSUED FOR APPROVAL
6	NOV 16-20	RE-ISSUED FOR APPROVAL
5	JUN 18-20	RE-ISSUED FOR APPROVAL
4	MAY 5-20	ISSUED FOR COORDINATION
3	SEP 27-19	RE-ISSUED FOR APPROVAL
2	AUG 9-19	ISSUED FOR APPROVAL

D. B. GRAY ENGINEERING INC.
 Stormwater Management - Grading & Drainage - Storm & Sanitary Sewers - Watermain
 700 Long Point Circle
 Ottawa, Ontario
 613-425-8044
 d.gray@dbgrayengineering.com

Project
PROPOSED RESIDENTIAL DEVELOPMENT
 1164-1166 HIGHCROFT DR.
 MANOTICK, ONTARIO

Drawing Title
SITE SERVICING PLAN

Engineer's Seal

 Drawn D.B.G.
 Hor. Scale 1:200
 Vert. Scale 1:200
 Date JUN 14-19
 Job No. 18035
 Drawing No. **C-1**
 of 14

BELL INSPECTOR TO BE CONTACTED 72 HOURS PRIOR TO EXCAVATION AROUND / UNDER BELL STRUCTURE.
 LESLIE MALLON: 613 203 2310

STRUCTURE TO BE SUPPORTED WITH ADEQUATE BEAM (H-BEAM OR WOOD STRUCTURE) w/ SUFFICIENT STRAPPING AS APPROVED BY INSPECTOR TO SUPPORT AND PROTECT DUCT BANK

ENTIRE TRENCH EXCAVATED BELOW BELL DUCT BANK TO BE REFILLED WITH "UFFILL" (NON-SHRINKING MATERIAL)

THERE SHALL BE A MINIMUM 2.0m CLEARANCE BETWEEN TREES AND SERVICES

ADDITIONAL USF ELEVATIONS ARE NOTED ON C-3

APPROVED
 By Adam Brown at 12:48 pm, Aug 29, 2022

ADAM BROWN
 MANAGER, DEVELOPMENT REVIEW - RURAL
 PLANNING, REAL ESTATE & ECONOMIC DEVELOPMENT
 DEPARTMENT, CITY OF OTTAWA

REFER TO NOTES & DETAILS ON DRAWINGS C-7 & C-8 AND C-12 TO C-14