

- GENERAL NOTES**
- All general site information and conditions compiled from architect's and engineer's plans and surveys.
 - Do not scale this drawing.
 - Report any discrepancies prior to commencing work. No responsibility is born by the Landscape Architect for unknown subsurface conditions.
 - Contractor to check and verify all dimensions on site and report any errors and/or omissions to the Landscape Architect.
 - Restate all areas and items damaged as a result of construction activities to the satisfaction of the Landscape Architect.
 - Contractor to layout planting beds, pathways etc. to approval of Landscape Architect prior to any excavation.
 - Drawing may not be used for construction until signed by Landscape Architect as issued for construction.
 - The accuracy of the position of utilities is not guaranteed.
 - Individual utility co. must be contacted for confirmation of utility existence and location prior to digging.
 - This drawing is an instrument of service and requires the permission of the Landscape Architect for use. Copyright is reserved by the Landscape Architect, David M. Lashley.

Contractor to verify all dimensions & conditions on site and immediately notify the departmental representative of all discrepancies.

1	ISSUED FOR CITY OF OTTAWA SITE COORDINATION	2018/03/05
---	---------------------------------------------	------------

revisions	description	date
A	A detail no. du détail	A
B	B location drawing no. sur dessin no.	B
C	C drawing no. dessin no.	C

project
WEST MEMORIAL BUILDING - REHABILITATION PROJECT
344 Wellington Street, Ottawa, ON

TREE CONSERVATION PLAN

Designed By: RC Conçu par
Date: 11/30/18 (yyyy/mm/dd)
Drawn By: JC Dessiné par
Date: 11/30/18 (yyyy/mm/dd)
Reviewed By: RC Examiné par
Date: 11/30/18 (yyyy/mm/dd)
Approved By: RC Approuvé par
Date: 11/30/18 (yyyy/mm/dd)
Tender: Soumission
Project Manager: Administrateur de projets
Project no.: No. du projet
R.086471.405
Drawing no.: No. du dessin
L1-01

WELLINGTON STREET

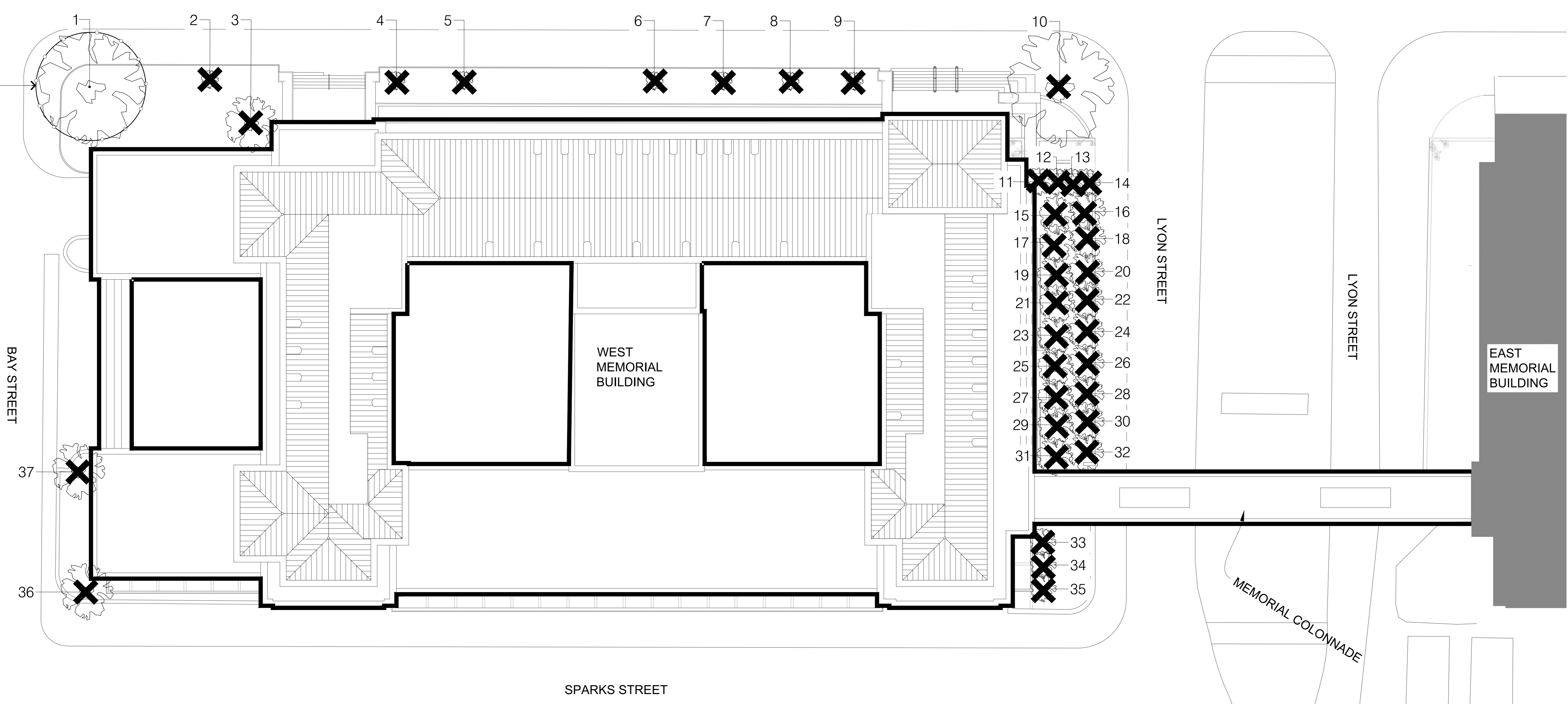

EXISTING TREES TO BE REMOVED

NO.	TREE SPECIES	DBH	CONDITION	COMMENTS
2	Castanopsis Maple / Acon x Fernand's Oakleaf	6 cm	Good	
3	Columbine English Oak / Quercus robur f. Rubra	30 cm	Good Fair	
4	Castanopsis Maple / Acon x Fernand's Oakleaf	6 cm	Good	
5	Castanopsis Maple / Acon x Fernand's Oakleaf	6 cm	Good	
6	Castanopsis Maple / Acon x Fernand's Oakleaf	6 cm	Good	
7	Castanopsis Maple / Acon x Fernand's Oakleaf	6 cm	Good	
8	Castanopsis Maple / Acon x Fernand's Oakleaf	6 cm	Good	
9	Castanopsis Maple / Acon x Fernand's Oakleaf	6 cm	Good	
10	American elm / Ulmus americana	45 cm	Poor - Good	No Leaves
11	Senecioideae / Artemisia arbuscula	7.5 cm	Good Fair	Multi-stemmed
12	Senecioideae / Artemisia arbuscula	7.5 cm	Good Fair	Multi-stemmed
13	Senecioideae / Artemisia arbuscula	7.5 cm	Good Fair	Multi-stemmed
14	Senecioideae / Artemisia arbuscula	7.5 cm	Good Fair	Multi-stemmed
15	Japanese Liboc / Springe reticulata	8-12 cm	Good Fair	Multi-stemmed
16	Japanese Liboc / Springe reticulata	8-12 cm	Good Fair	Multi-stemmed
17	Japanese Liboc / Springe reticulata	8-12 cm	Good Fair	Multi-stemmed
18	Japanese Liboc / Springe reticulata	8-12 cm	Good Fair	Multi-stemmed
19	Japanese Liboc / Springe reticulata	8-12 cm	Good Fair	Multi-stemmed
20	Japanese Liboc / Springe reticulata	8-12 cm	Good Fair	Multi-stemmed
21	Japanese Liboc / Springe reticulata	8-12 cm	Good Fair	Multi-stemmed
22	Japanese Liboc / Springe reticulata	8-12 cm	Good Fair	Multi-stemmed
23	Japanese Liboc / Springe reticulata	8-12 cm	Good Fair	Multi-stemmed
24	Japanese Liboc / Springe reticulata	8-12 cm	Good Fair	Multi-stemmed
25	Japanese Liboc / Springe reticulata	8-12 cm	Good Fair	Multi-stemmed
26	Japanese Liboc / Springe reticulata	8-12 cm	Good Fair	Multi-stemmed
27	Japanese Liboc / Springe reticulata	8-12 cm	Good Fair	Multi-stemmed
28	Japanese Liboc / Springe reticulata	8-12 cm	Good Fair	Multi-stemmed
29	Japanese Liboc / Springe reticulata	8-12 cm	Good Fair	Multi-stemmed
30	Japanese Liboc / Springe reticulata	8-12 cm	Good Fair	Multi-stemmed
31	Japanese Liboc / Springe reticulata	8-12 cm	Good Fair	Multi-stemmed
32	Japanese Liboc / Springe reticulata	8-12 cm	Good Fair	Multi-stemmed
33	Japanese Liboc / Springe reticulata	8-12 cm	Good	Multi-stemmed
34	Japanese Liboc / Springe reticulata	8-12 cm	Good	Multi-stemmed
35	Japanese Liboc / Springe reticulata	8-12 cm	Good	Multi-stemmed
36	Japanese Liboc / Springe reticulata	8-12 cm	Good	Multi-stemmed
37	Japanese Liboc / Springe reticulata	8-12 cm	Good	Multi-stemmed

EXISTING TREES TO REMAIN

NO.	TREE SPECIES	DBH	CONDITION	COMMENTS
1	American elm / Ulmus americana	45 cm	Good Fair	

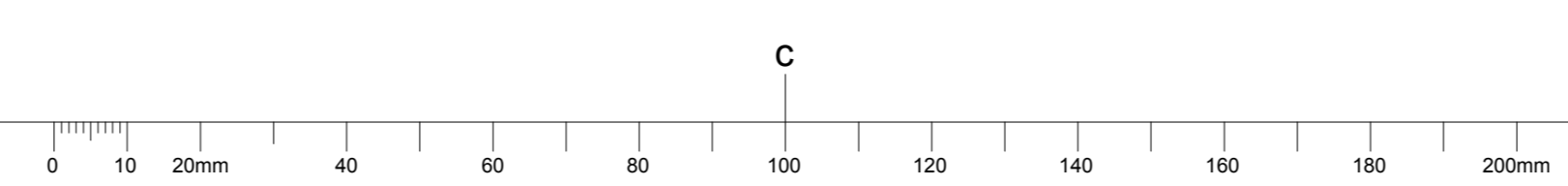
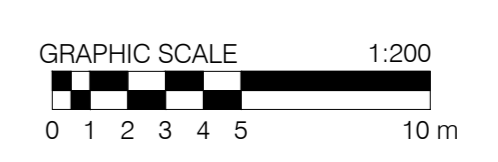
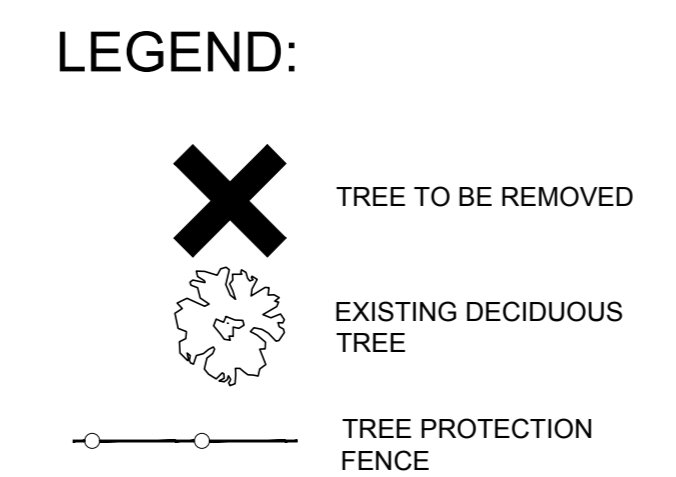

- GENERAL NOTES**
- All general site information and conditions compiled from architect's and engineer's plans and surveys.
 - Do not scale this drawing.
 - Report any discrepancies prior to commencing work. No responsibility is born by the Landscape Architect for unknown subsurface conditions.
 - Contractor to check and verify all dimensions on site and report any errors and/or omissions to the Landscape Architect prior to the satisfaction of the Landscape Architect.
 - Reinstate all areas and items damaged as a result of construction activities to the satisfaction of the Landscape Architect.
 - Contractor to layout planting beds, pathways etc. to approval of Landscape Architect prior to any excavation.
 - Drawing may not be used for construction until signed by Landscape Architect as issued for construction.
 - The accuracy of the position of utilities is not guaranteed.
 - Individual utility co. must be contacted for confirmation of utility existence and location prior to digging.
 - This drawing is an instrument of service and requires the permission of the Landscape Architect for use. Copyright is reserved by the Landscape Architect, David M. Lashley.

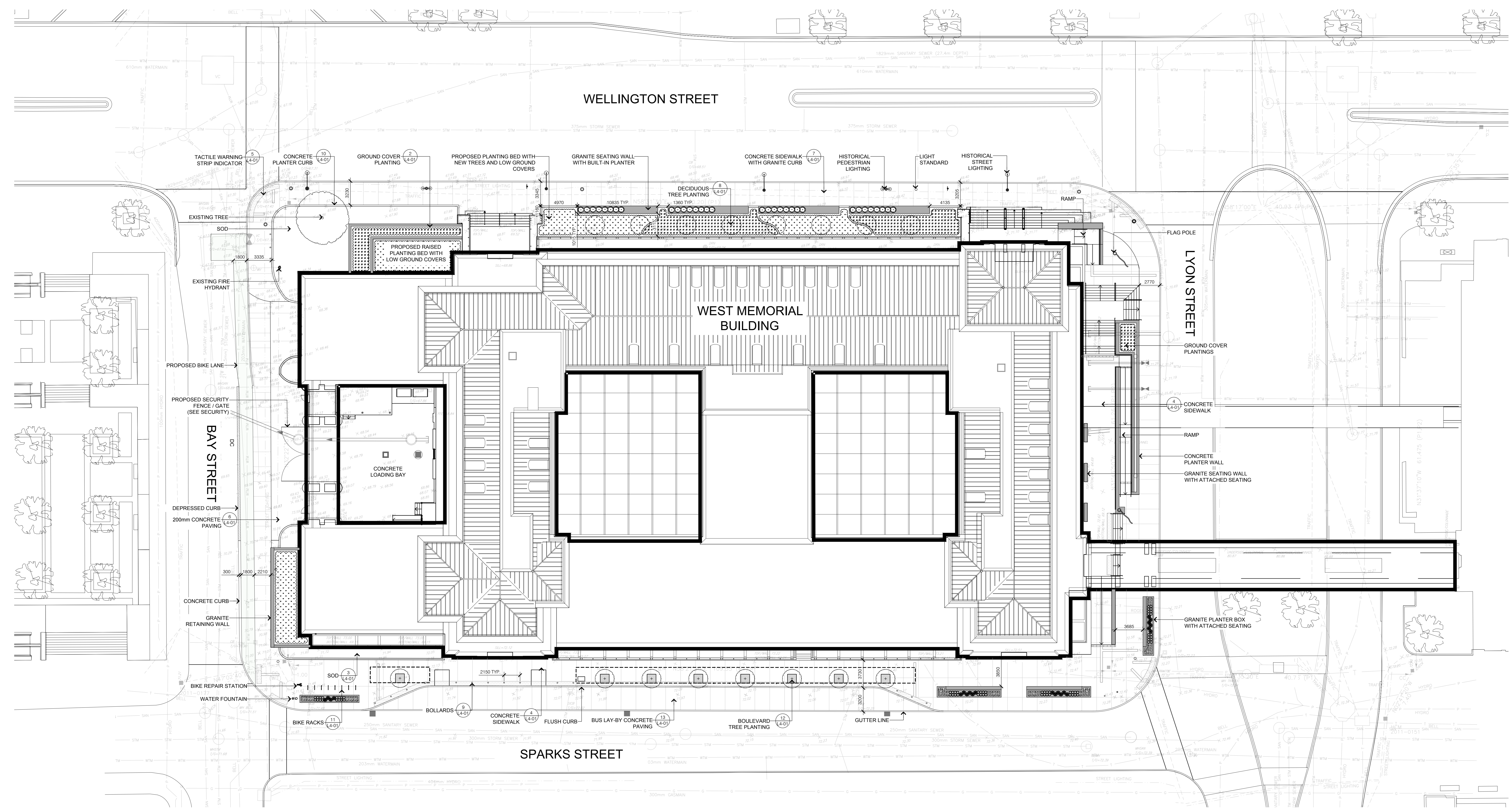

LEGEND:

- |||| BIKE RACK
- ⊕ PROPOSED DECIDUOUS TREE
- ⊕ PROPOSED GROUND COVER / SHRUB PLANTINGS
- ▭ CONCRETE SEAT WALL WITH PLANTER
- ⚡ HISTORICAL STREET LIGHT
- ⚡ HISTORICAL PEDESTRIAN LIGHT
- LIGHT STANDARD
- ▨ TACTILE PAVING
- ▭ CONCRETE PAVING
- TREE CELL EXTENTS

Contractor to verify all dimensions & conditions on site and immediately notify the departmental representative of all discrepancies.

revisions	description	date
1	ISSUED FOR CITY OF OTTAWA SITE COORDINATION	20190905

WEST MEMORIAL BUILDING - REHABILITATION PROJECT
344 Wellington Street, Ottawa, ON

LANDSCAPE LAYOUT PLAN

Designed By	RC	Conçu par	RC
Date	11/30/18	Date	(yyyy/mm/dd)
Drawn By	JC	Dessiné par	JC
Date	11/30/18	Date	(yyyy/mm/dd)
Reviewed By	RC	Examiné par	RC
Date	11/30/18	Date	(yyyy/mm/dd)
Approved By	RC	Approuvé par	RC
Date	11/30/18	Date	(yyyy/mm/dd)
Tender		Soumission	
Project Manager		Administrateur de projets	
Project no.		No. du projet	
	R.086471.405		
Drawing no.		No. du dessin	
	L2-01		

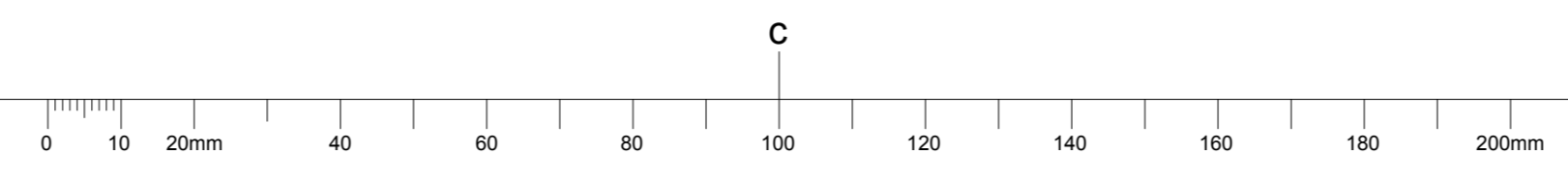

- GENERAL NOTES**
- All general site information and conditions compiled from architect's and engineer's plans and surveys.
 - Do not scale this drawing.
 - Report any discrepancies prior to commencing work. No responsibility is born by the Landscape Architect for unknown subsurface conditions.
 - Contractor to check and verify all dimensions on site and report any errors and/or omissions to the Landscape Architect.
 - Reinstate all areas and items damaged as a result of construction activities to the satisfaction of the Landscape Architect.
 - Contractor to layout planting beds, pathways etc. to approval of Landscape Architect prior to any excavation.
 - Drawing may not be used for construction until signed by Landscape Architect as issued for construction.
 - The accuracy of the position of utilities is not guaranteed.
 - Individual utility co. must be contacted for confirmation of utility existence and location prior to digging.
 - This drawing is an instrument of service and requires the permission of the Landscape Architect for use. Copyright is reserved by the Landscape Architect, David M. Lashley.

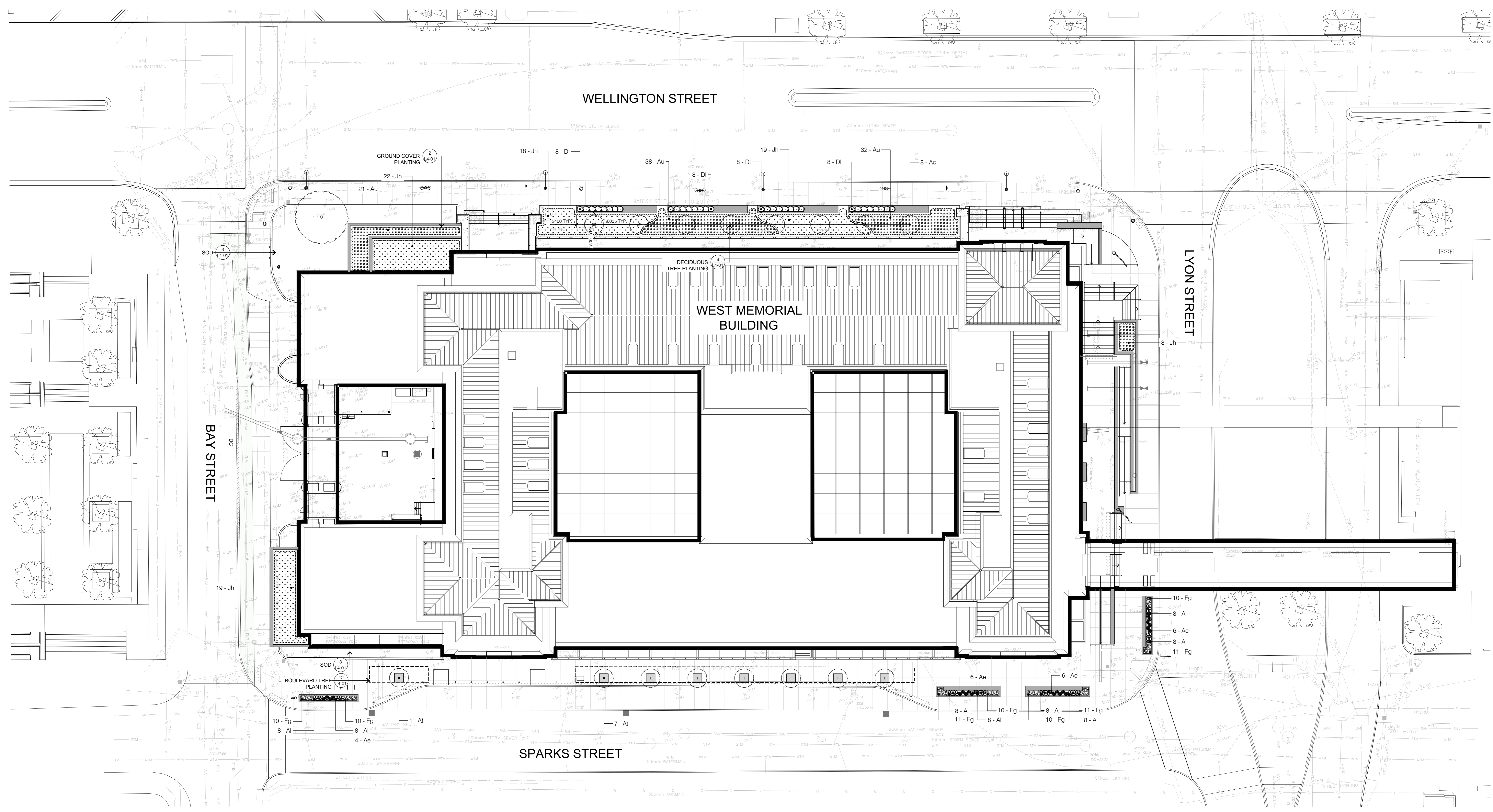

L-04 PLANT LIST

SYD	QTY	BOTANICAL NAME	COMMON NAME	SIZE	COMMENTS
Ac	8	Acer x nemoros 'Colony'	Celebration Maple	60mm Cal.	Wire Basket
Al	8	Acer balsamum	Tatarian Maple	60mm Cal.	Wire Basket
SHRUBS					
Au	91	Acrostaphylos oenanthifolia	Banberry	15cm PT	Planted
Di	32	Diervilla lonicera	Bush HoneySuckle	2 GAL	Planted
Jh	86	Juncus horizontalis	Creeper Jumper	45cm, 3 GAL	Planted
GRASSES AND PERENNIALS					
Ae	22	Aster ericoides	Heath Aster	1 GAL	Planted
Al	64	Allium ostenum	Nodding Onion	1 GAL	Planted
Fg	67	Festuca glauca	Blue Fescue	1 GAL	Planted

- LEGEND:**
- BIKE RACK
 - PROPOSED DECIDUOUS TREE
 - PROPOSED GROUND COVER / SHRUB PLANTINGS
 - CONCRETE SEAT WALL WITH PLANTER
 - HISTORICAL STREET LIGHT
 - HISTORICAL PEDESTRIAN LIGHT
 - LIGHT STANDARD
 - TACTILE PAVING
 - CONCRETE PAVING
 - TREE CELL EXTENTS

Contractor to verify all dimensions & conditions on site and immediately notify the departmental representative of all discrepancies.

1 ISSUED FOR CITY OF OTTAWA SITE COORDINATION 20190905

revisions	description	date
A	A detail no.	
B	B location drawing no.	
C	C drawing no.	

WEST MEMORIAL BUILDING - REHABILITATION PROJECT
344 Wellington Street, Ottawa, ON

PLANTING PLAN

Designed By	RC	Conçu par	
Date	11/30/18	(yyyy/mm/dd)	
Drawn By	JC	Dessiné par	
Date	11/30/18	(yyyy/mm/dd)	
Reviewed By	RC	Examiné par	
Date	11/30/18	(yyyy/mm/dd)	
Approved By	RC	Approuvé par	
Date	11/30/18	(yyyy/mm/dd)	
Tender		Soumission	
Project Manager	Administrateur de projets		
Project no.	No. du projet		
	R.086471.405		
Drawing no.	No. du dessin		
	L3-01		

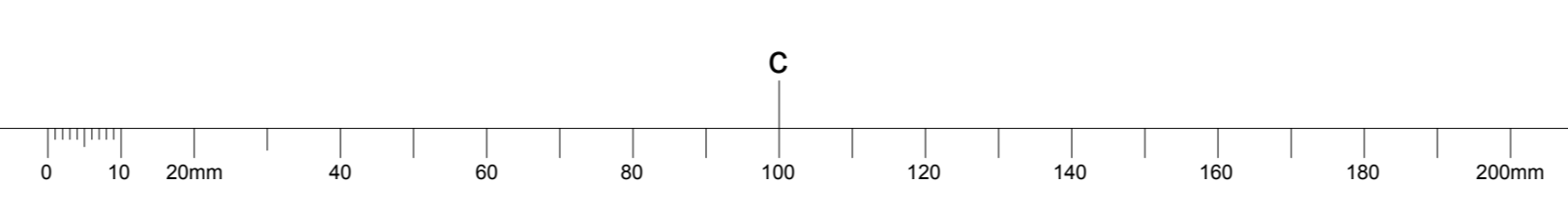

NOTES:
THE FOLLOWING PROTECTION MEASURES MUST BE IMPLEMENTED FOR RETAINED TREES, BOTH WITHIN THE WORK AREA AND ON ADJACENT PARCELS.

1. UNDER THE GUIDANCE OF AN ARBORIST, ERECT A MODULAR FENCE AT THE CRITICAL ROOT ZONE (CRZ) OF TREES WHERE THE CRZ IS ESTABLISHED AS BEING 10 CENTIMETERS FROM THE TRUNK FOR EVERY CENTIMETER OF TRUNK DIAMETER AT BREAST HEIGHT.
2. TREE PROTECTION SHALL BE ERECTED TO PROVIDE A CONTINUOUS BARRICADE BETWEEN DESIGNATED TREES AND THE WORK AREA PRIOR TO CONSTRUCTION.
3. TUNNEL OR BORE WHEN DIGGING WITHIN THE CRZ OF A TREE.
4. ENSURE ALL EQUIPMENT AND CONSTRUCTION RELATED MATERIAL ARE NOT PLACED OR TEMPORARILY STORED WITHIN THE CRZ.
5. ENSURE EXHAUST FUMES FROM ALL EQUIPMENT ARE NOT DIRECTED TOWARDS ANY TREE'S CANOPY.
6. FLOODING OR DEPOSITION OF SEDIMENT SHALL BE PREVENTED WHERE TREES ARE LOCATED.
7. ALL DISTURBED ROOT SYSTEMS SHALL BE EXPOSED AND BACKFILLED IN ONE CONTINUOUS OPERATION TO MINIMIZE DESICCATION.
8. EXPOSED ROOTS SHALL BE KEPT CONTINUOUSLY MOIST DURING EXCAVATION.
9. REMOVE BROKEN AND DAMAGED ROOTS WITH SHARP PRUNING SHEARS.
10. THE TREE PROTECTION MODULAR FENCE IS TEMPORARY, SHALL BE MAINTAINED AT ALL TIMES DURING CONSTRUCTION OPERATIONS, AND SHALL BE REMOVED UPON COMPLETION OF WORK WHEN AGREED TO BY THE CONTRACT ADMINISTRATOR AND LANDSCAPE ARCHITECT.

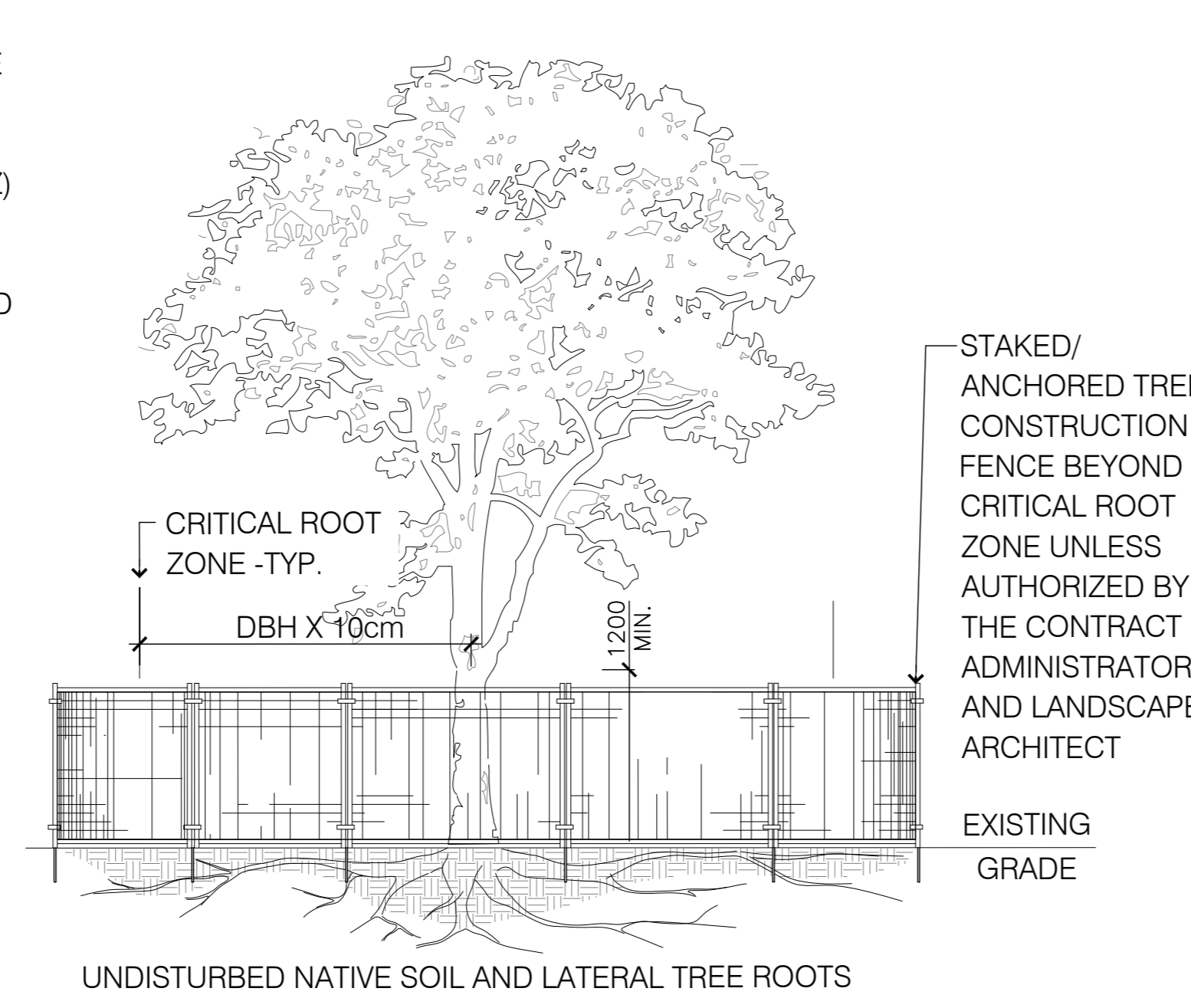

1 TREE PROTECTION FENCING
L4-01 1:40

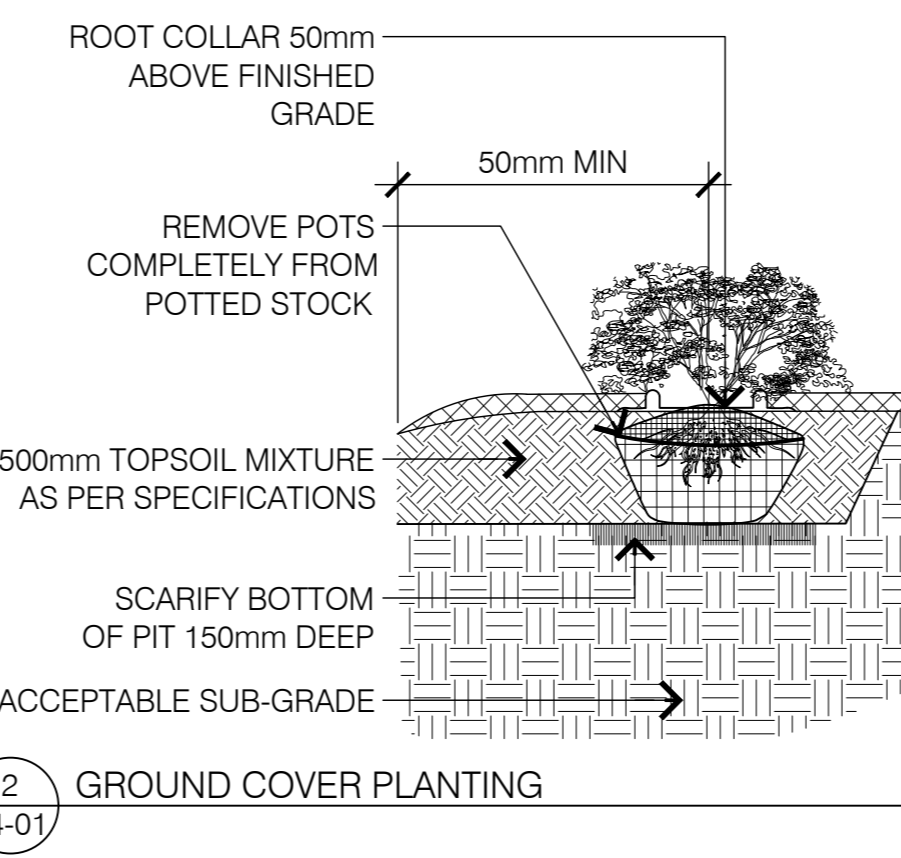

2 GROUND COVER PLANTING
L4-01 1:20

NOTES:
PRUNE DAMAGED OR OBJECTIONABLE BRANCHES. FOLLOW PROPER HORTICULTURAL PRACTICE.
COVER ENTIRE BED WITH 100mm DEPTH MULCH. PULL BACK MULCH FROM BASE OF SHRUBS. ENSURE THAT MULCH COVERS ALL EXPOSED SOIL.

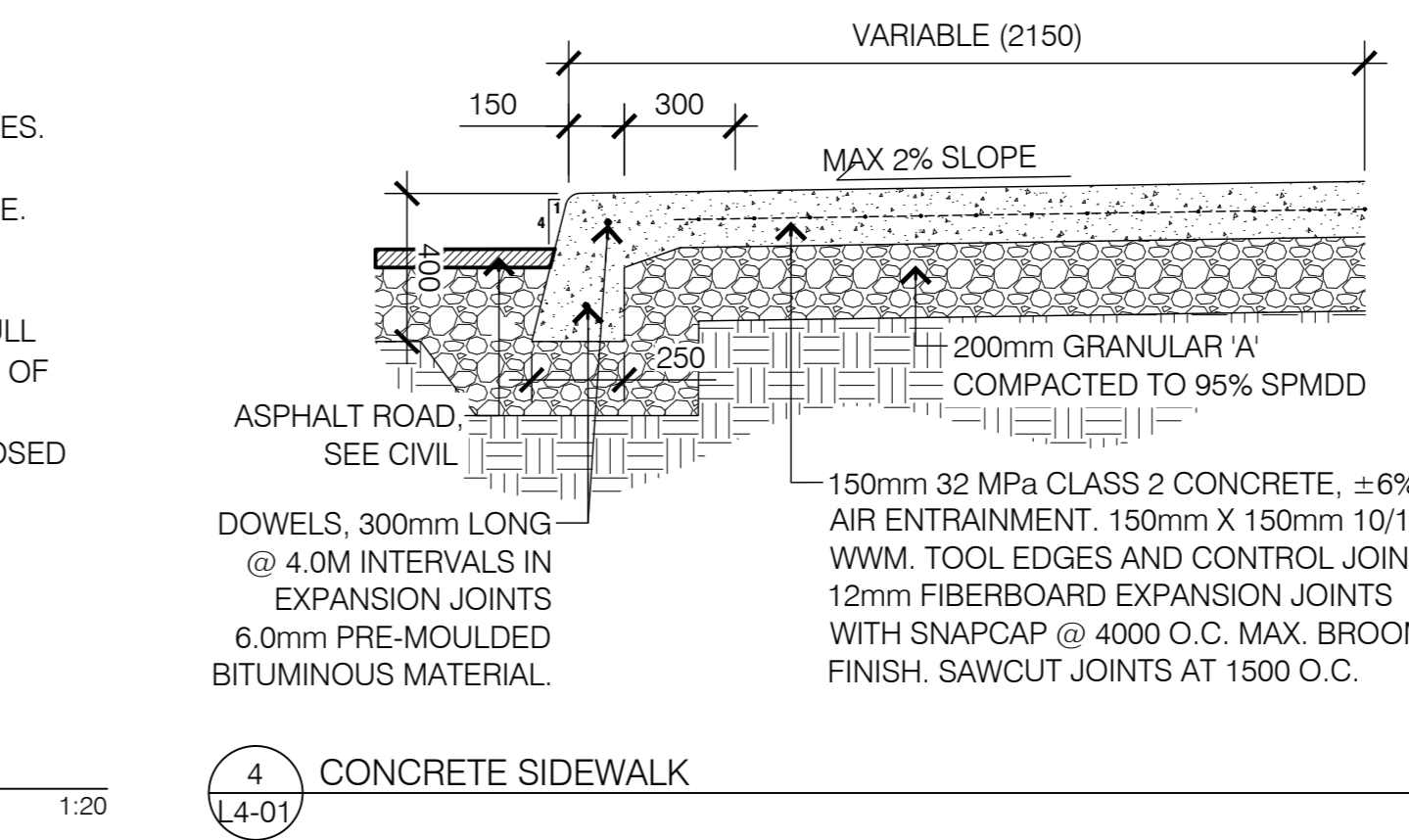

4 CONCRETE SIDEWALK
L4-01 1:20

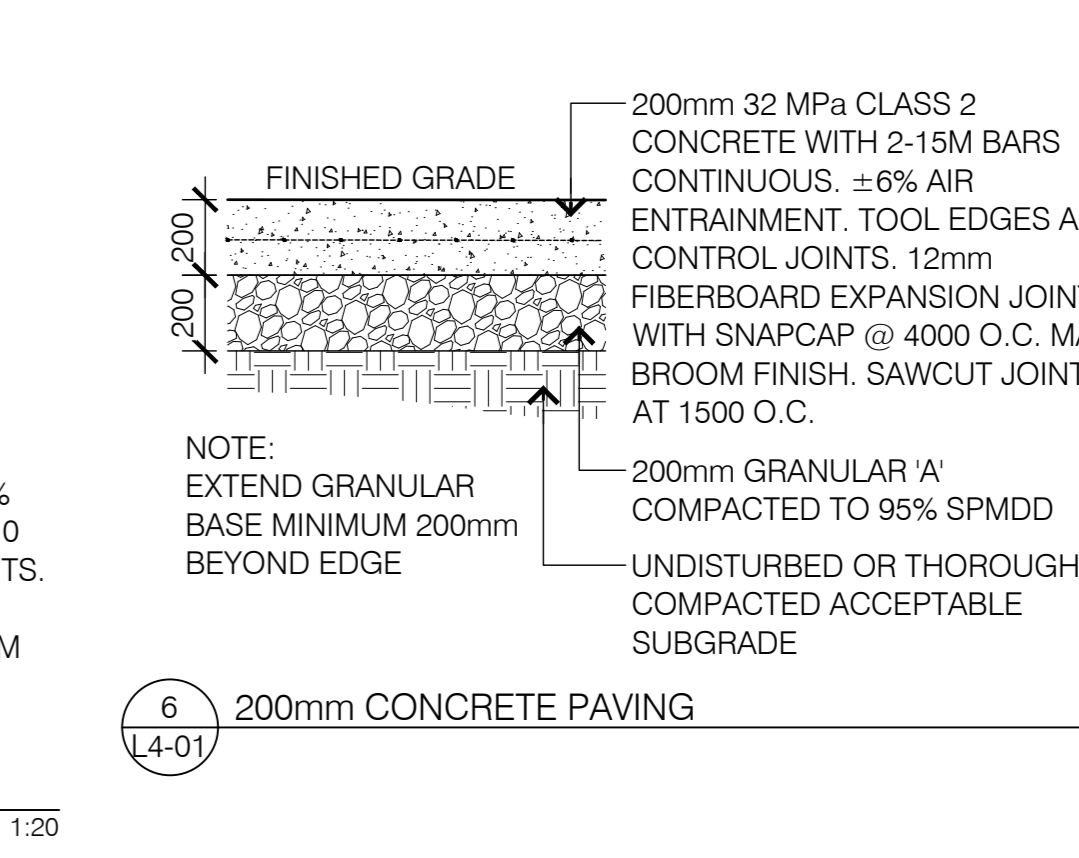

6 200mm CONCRETE PAVING
L4-01 1:20

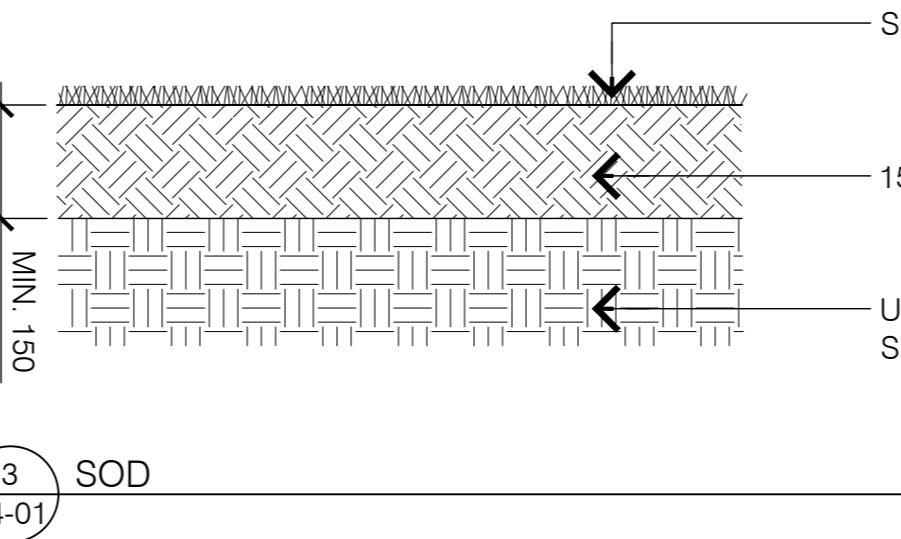

3 SOD
L4-01 1:10

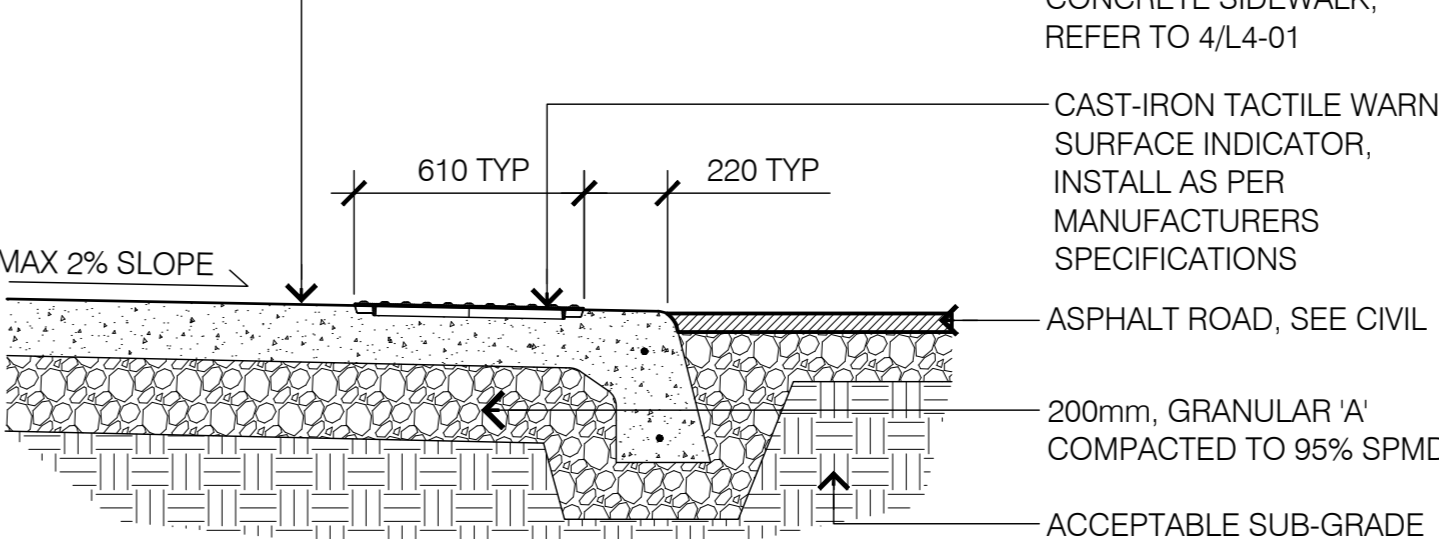

5 TACTILE WARNING STRIP INDICATOR
L4-01 1:20

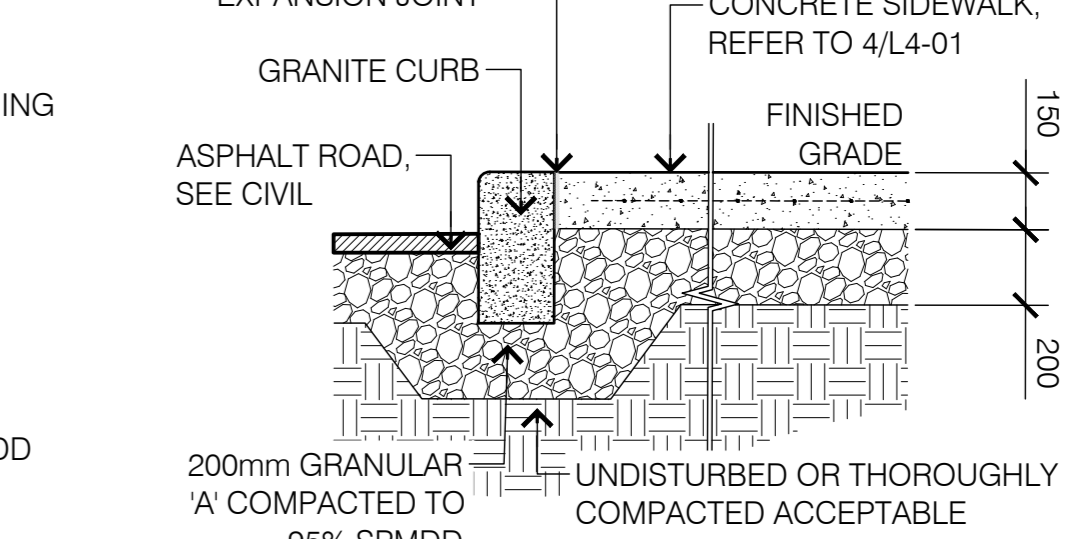

7 CONCRETE SIDEWALK WITH GRANITE CURB
L4-01 1:20

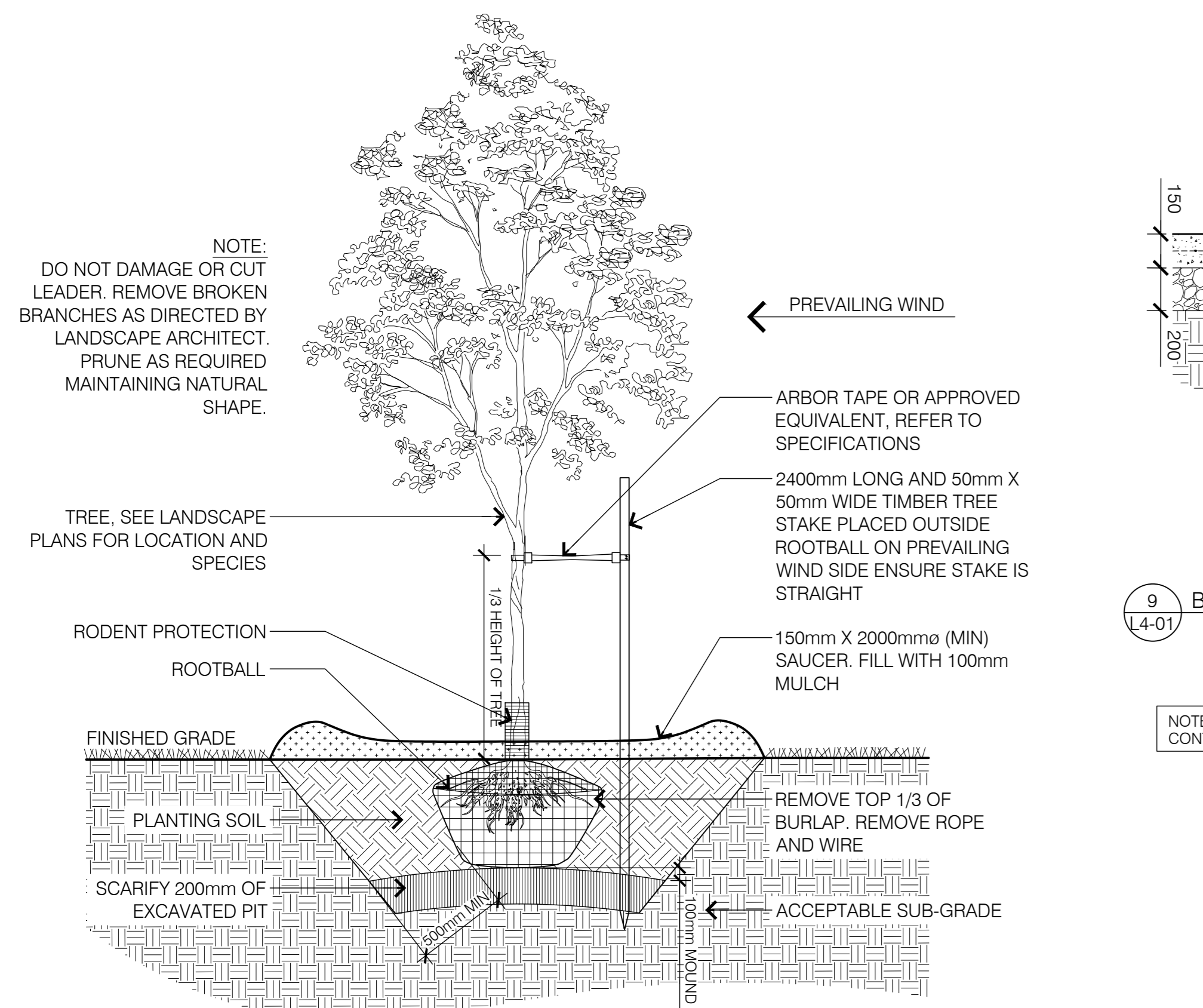

8 DECIDUOUS TREE PLANTING
L4-01 1:25

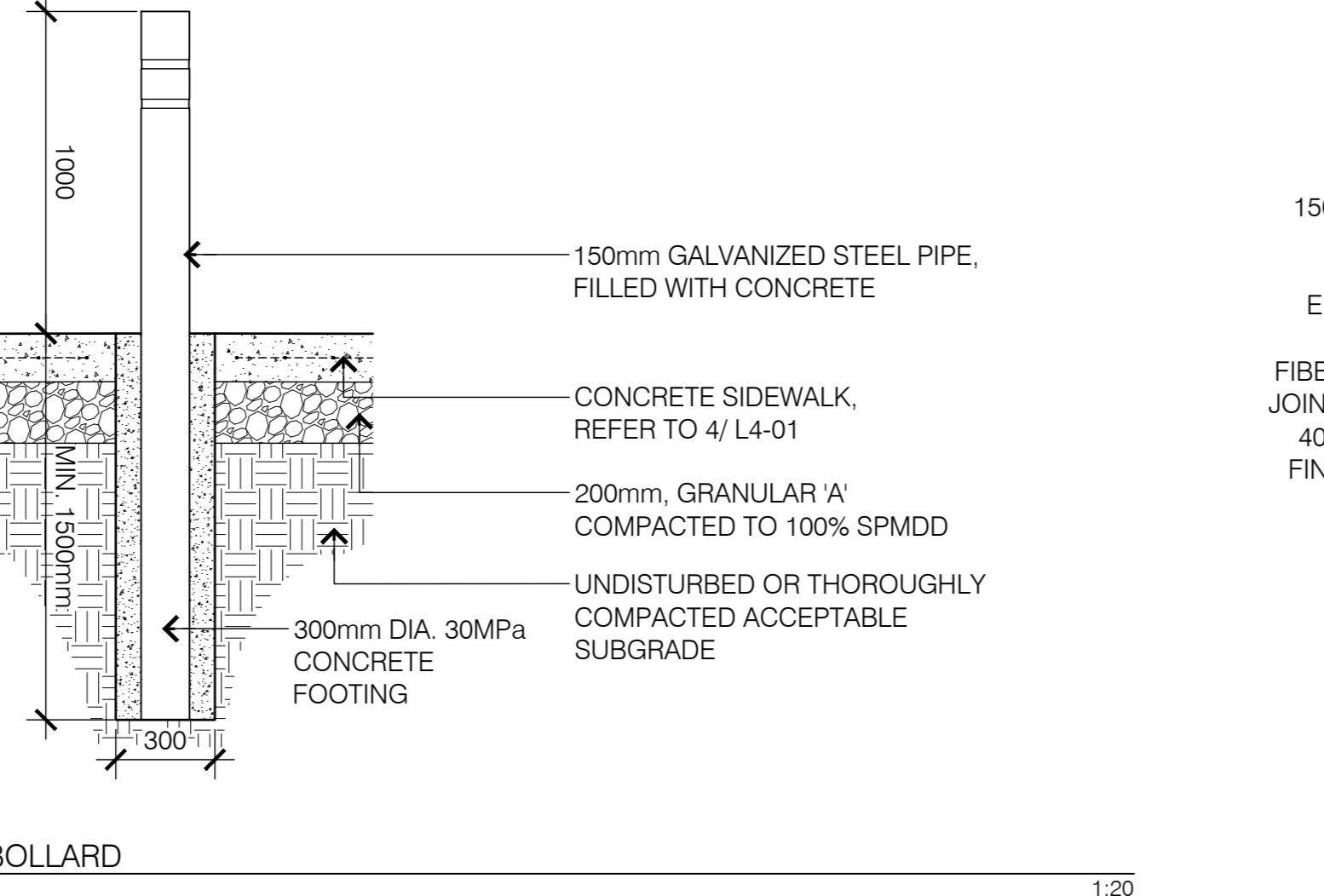

9 BOLLARD
L4-01 1:20

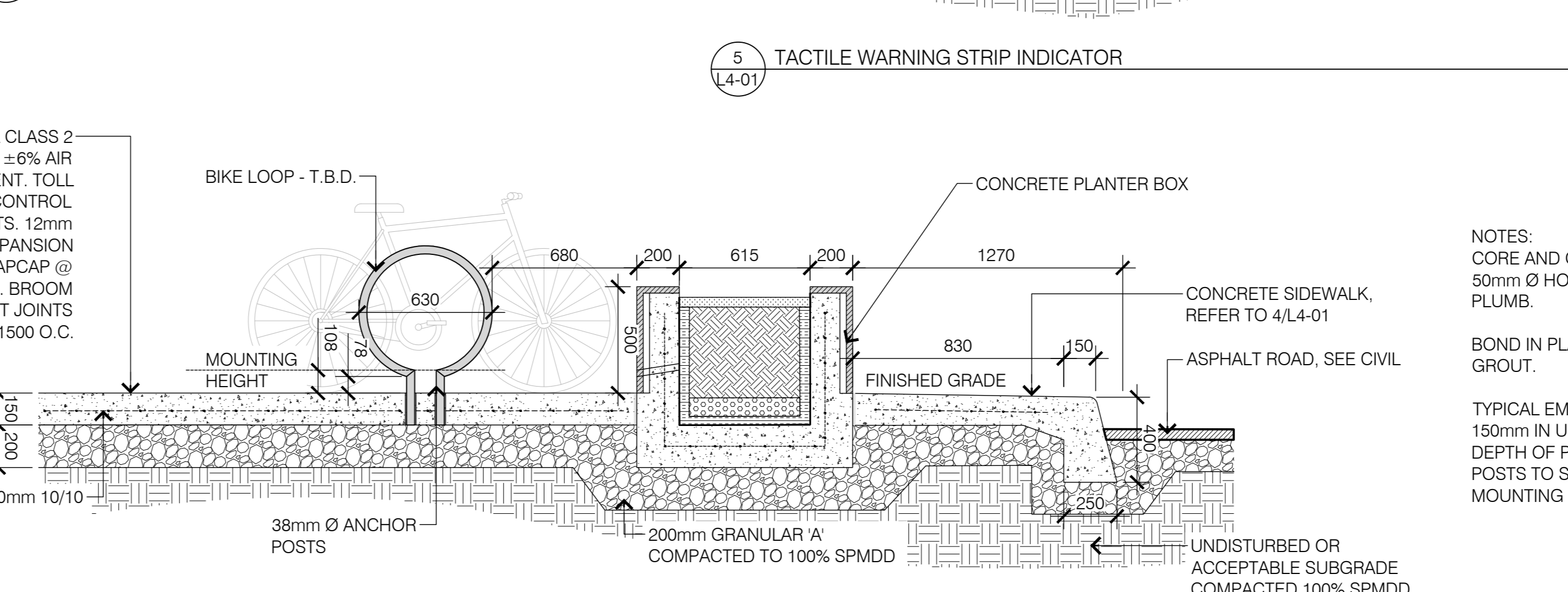

11 BIKE RACK
L4-01 1:20

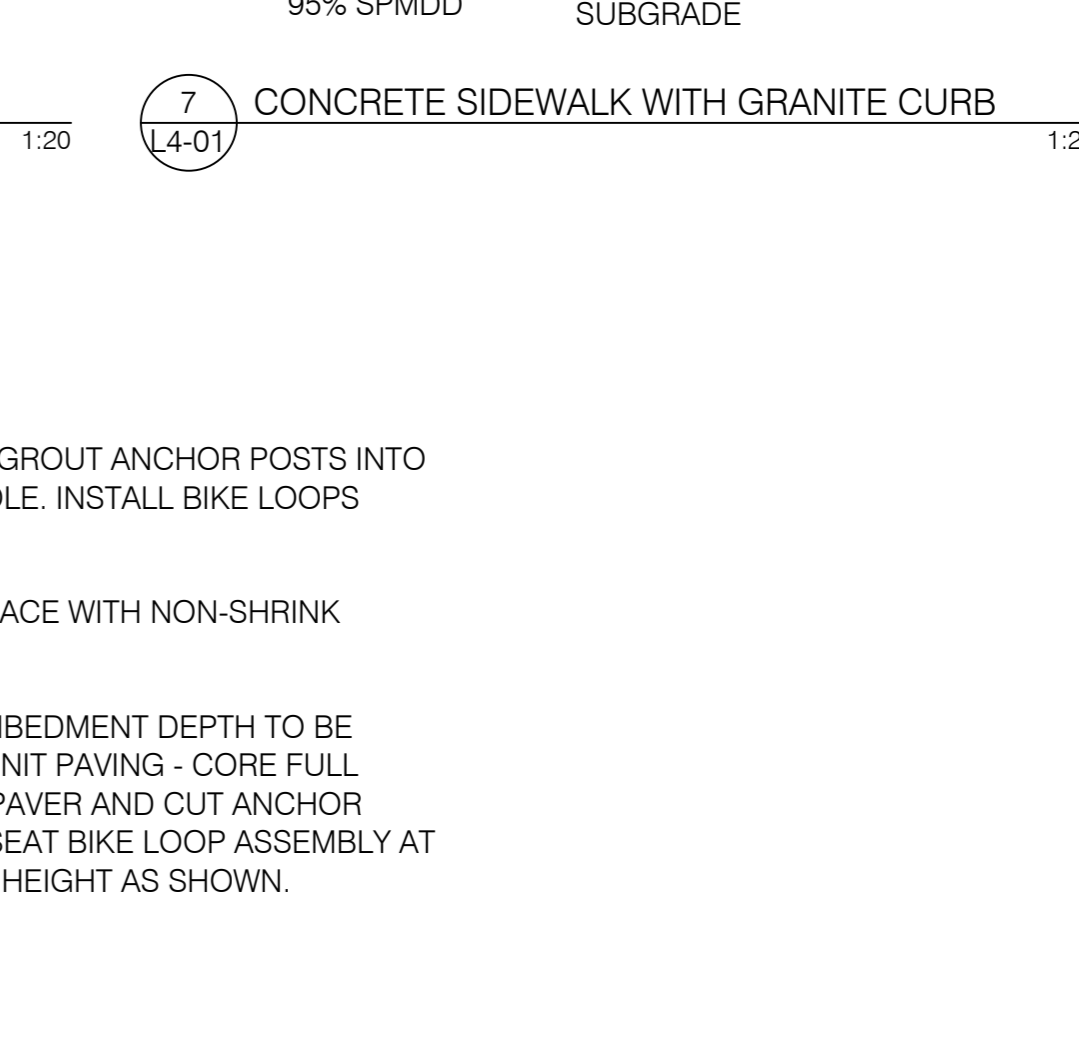

10 CONCRETE PLANTER CURB
L4-01 1:20

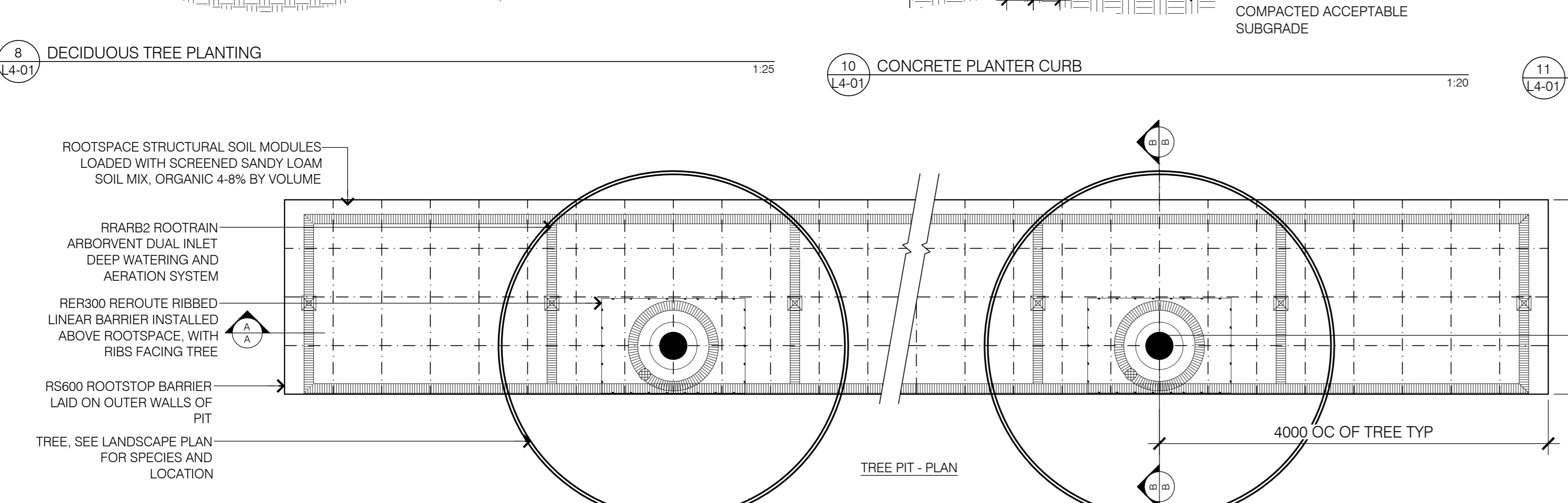

12 BOULEVARD TREE PLANTING
L4-01 1:35

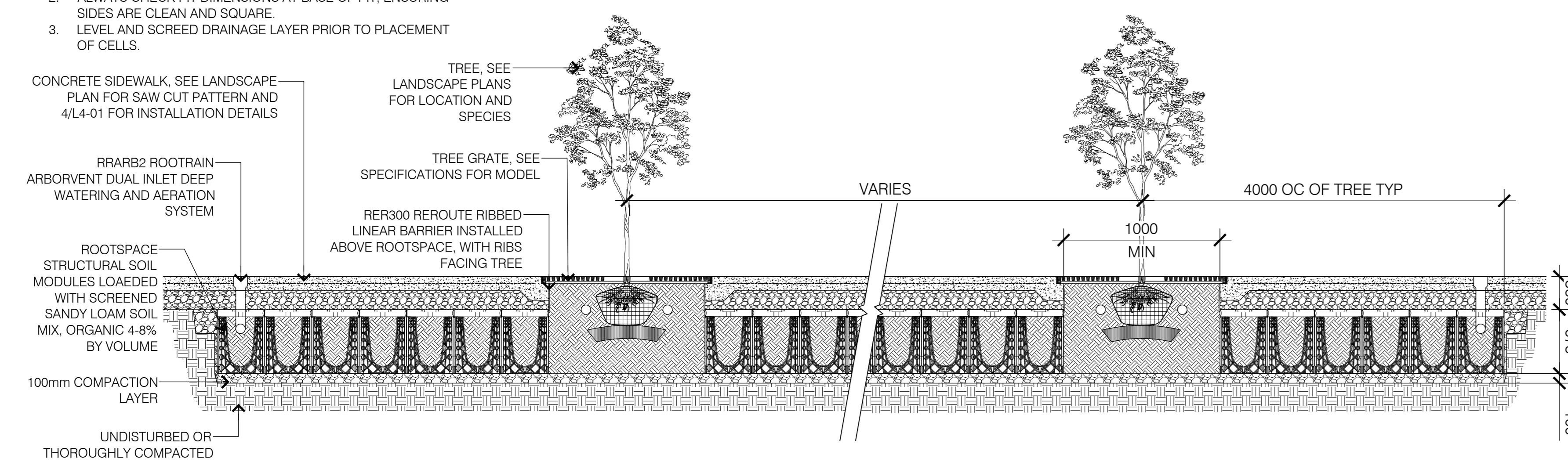

12 BOULEVARD TREE PLANTING
L4-01 1:35

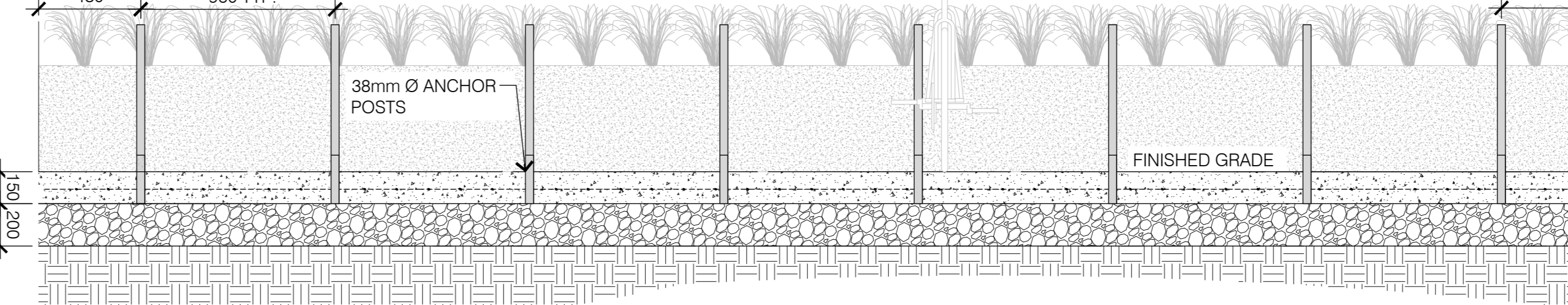

13 BUS LAY-BY CONCRETE PAVING
L4-01 1:20

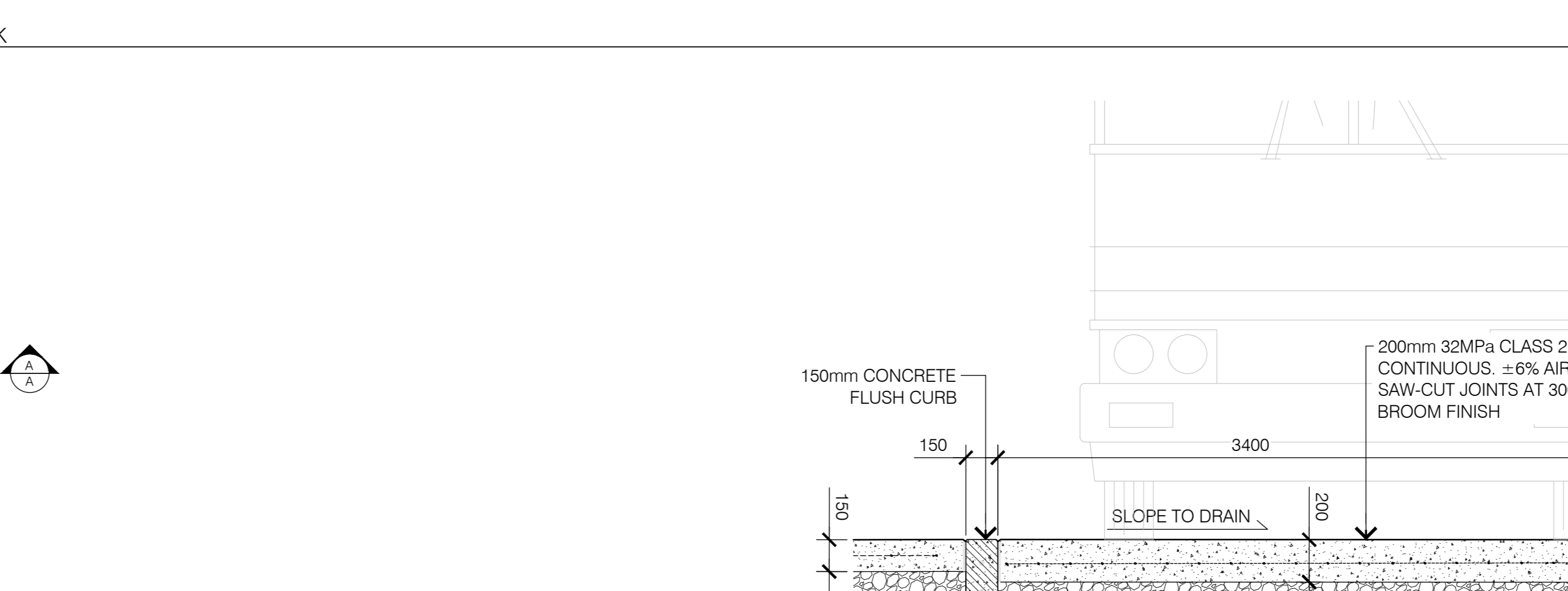

11 BIKE RACK
L4-01 1:20

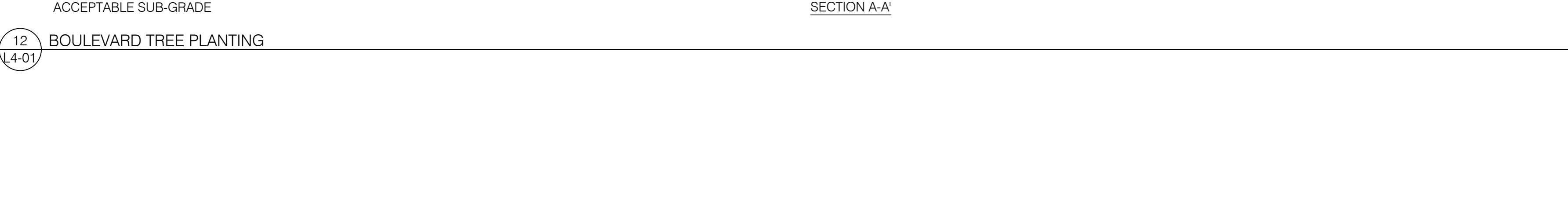

12 BOULEVARD TREE PLANTING
L4-01 1:35

GENERAL NOTES

1. All general site information and conditions compiled from architect's and engineer's plans and surveys.
2. Do not scale this drawing.
3. Report any discrepancies prior to commencing work. No responsibility is born by the Landscape Architect for unknown subsurface conditions.
4. Contractor to check and verify all dimensions on site and report any errors and/or omissions to the Landscape Architect.
5. Reinstated all areas and items damaged as a result of construction activities to the satisfaction of the Landscape Architect.
6. Contractor to layout planting beds, pathways etc. to approval of Landscape Architect prior to any excavation.
7. Shoring may not be used for construction until signed by Landscape Architect as issued for construction.
8. The accuracy of the position of utilities is not guaranteed.
9. Individual utility co. must be contacted for confirmation of utility existence and location prior to digging.
10. This drawing is an instrument of service and requires the permission of the Landscape Architect for use. Copyright is reserved by the Landscape Architect, David M. Lashley.

Contractor to verify all dimensions & conditions on site and immediately notify the departmental representative of all discrepancies.

revisions	description	date
1	ISSUED FOR CITY OF OTTAWA SITE COORDINATION	20180805

project
WEST MEMORIAL BUILDING - REHABILITATION PROJECT
344 Wellington Street, Ottawa, ON

drawing
LANDSCAPE DETAILS

Designed By	RC	Conçu par	
Date	11/30/18	(yyyy/mm/dd)	
Drawn By	JC	Dessiné par	
Date	11/30/18	(yyyy/mm/dd)	
Reviewed By	RC	Examiné par	
Date	11/30/18	(yyyy/mm/dd)	
Approved By	RC	Approuvé par	
Date	11/30/18	(yyyy/mm/dd)	
Tender		Soumission	
Project Manager	Administrateur de projets	No. du projet	
Project no.		No. du projet	
			R.086471.405
Drawing no.		No. du dessin	
			L4-01