

Copyright Reserved

The Contractor shall verify and be responsible for all dimensions. DO NOT scale the drawing - any errors or omissions shall be reported to Stantec without delay.
The Copyrights to all designs and drawings are the property of Stantec. Reproduction or use for any purpose other than that authorized by Stantec is forbidden.

Legend

- ORIGINAL GROUND ELEVATION
- PROPOSED ELEVATION
- PROPOSED LOT CORNER ELEVATION
- EXISTING ELEVATION AT LOT CORNER
- FLOW DIRECTION AND GRADE
- FINISHED FIRST FLOOR ELEVATION
- ENGINEERING FILL REQUIRED
- TERRACING 3:1 SLOPE MAXIMUM (UNLESS OTHERWISE SHOWN)
- PROPOSED SWALE
- DIRECTION OF OVERLAND FLOW
- PROPOSED VALVE BOX
- PROPOSED SANITARY SEWER MANHOLE
- PROPOSED STORM SEWER MANHOLE
- PROPOSED CATCHBASIN
- EXISTING SANITARY SEWER MANHOLE
- EXISTING STORM SEWER MANHOLE
- EXISTING CATCHBASIN
- PROPOSED DEPRESSED CURB LOCATION
- PROPOSED TRANSFORMER LOCATIONS
- PROPOSED LIGHT STANDARD

Notes

Revision	By	Appd.	YY.MM.DD	
4	REVISED AS PER CITY COMMENTS	DC	DT	20.10.16
3	REVISED AS PER CITY COMMENTS	DC	DT	20.09.14
2	REVISED AS PER CITY COMMENTS	AJ	DT	20.06.30
1	ISSUED FOR SPA	AJ	DT	19.09.12

File Name:	MJS	SG	AJ	19.07.25
160401500 BLK 15 DE.DWG	Dwn.	Chkd.	Dgn.	YY.MM.DD

Permit-Seal

Client/Project
LONGFIELDS BLOCK 14
CAMPANALE GROUP
200-1187 BANK STREET
K1S 3X7
OTTAWA, ON, CANADA

Title
GRADING PLAN

Project No.	Scale	Sheet	Revision
160401500	1:300	GP-1	3 of 6

ROADWORKS

- ALL TOPSOIL AND ORGANIC MATERIAL TO BE STRIPPED FROM WITHIN THE FULL RIGHT OF WAY PRIOR TO CONSTRUCTION.
- SUB-EXCAVATE SOFT AREAS & FILL WITH GRANULAR 'B' COMPACTED IN 0.30m LAYERS.
- ALL GRANULAR FOR ROADS SHALL BE COMPACTED TO A MINIMUM OF 98% STANDARD PROCTOR MAXIMUM DRY DENSITY (SPMDD).
- ROAD SUBDRAINS SHALL BE CONSTRUCTED AS PER CITY OF OTTAWA STANDARD R1.
- ASPHALT WEAR COURSE SHALL NOT BE PLACED UNTIL THE VIDEO INSPECTION OF SEWERS & NECESSARY REPAIRS HAVE BEEN CARRIED OUT TO THE SATISFACTION OF THE CONSULTANT.
- CONTRACTOR TO OBTAIN A ROAD OCCUPANCY PERMIT 48 HOURS PRIOR TO COMMENCING ANY WORK WITHIN THE MUNICIPAL ROAD ALLOWANCE IF REQUIRED BY THE MUNICIPALITY. ALL WORK ON THE MUNICIPAL RIGHT OF WAY AND EASEMENTS TO BE INSPECTED BY THE MUNICIPALITY PRIOR TO BACKFILLING.
- PAVEMENT REINSTATEMENT FOR SERVICE AND UTILITY CUTS SHALL BE IN ACCORDANCE WITH CITY OF OTTAWA STANDARD R10, AND OPSD 509.010, AND OPSD 310.
- CONCRETE CURBS SHALL BE CONSTRUCTED AS PER CITY STANDARD SC1.1 AND SC1.3 (BARRIER OR MOUNTABLE CURB AS SHOWN ON DRAWINGS).
- CONCRETE SIDEWALKS SHALL BE CONSTRUCTED AS PER CITY STANDARDS SC3 AND SC1.4.
- PAVEMENT CONSTRUCTION AS PER GEOTECHNICAL INVESTIGATION PROPOSED RESIDENTIAL DEVELOPMENT, LONGFIELDS DRIVE, OTTAWA, ONTARIO., PREPARED BY PATERSON GROUP INC. DATED JUNE 10, 2010. REPORT NO P62119-1.

HEAVY DUTY ASPHALT
40mm HL3 OR SUPERPAVE 12.5 ASPHALTIC CONCRETE
50mm HL8 OR SUPERPAVE 19.0 ASPHALTIC CONCRETE
150mm OPSS GRANULAR A BASE
450mm OPSS GRANULAR B TYPE II

LIGHT DUTY AREAS
50mm HL3 OR SUPERPAVE 12.5 ASPHALTIC CONCRETE
150 OPSS GRANULAR A BASE
300 OPSS GRANULAR B TYPE II

GRADING

- ALL GRANULAR BASE & SUB BASE COURSE MATERIALS SHALL BE COMPACTED TO 98% STANDARD PROCTOR MAX. DRY DENSITY.
- SUB-EXCAVATE SOFT AREAS & FILL WITH GRANULAR 'B' COMPACTED IN 0.15m LAYERS.
- ALL DISTURBED GRASSED AREAS SHALL BE RESTORED TO ORIGINAL CONDITION OR BETTER, WITH SOD ON MIN. 100mm TOPSOIL. THE RELOCATION OF TREES AND SHRUBS SHALL BE SUBJECT TO APPROVAL BY THE PROJECT LANDSCAPE ARCHITECT OR ENGINEER.
- 100 YEAR PONDING DEPTH TO BE 0.30m (MAXIMUM).
- EMBANKMENTS TO BE SLOPED AT MIN. 3:1, UNLESS OTHERWISE SPECIFIED.
- ALL SWALES TO BE MIN. 0.15m DEEP WITH MIN. 3:1 SLOPES UNLESS OTHERWISE NOTED. THE MINIMUM LONGITUDINAL SLOPE TO BE 1.5% OR 1.0% WHEN PERFORATED SUBDRAIN IS INSTALLED.
- TOP OF GRATE (T/G) ELEVATIONS FOR ALL STREET CATCHBASINS SHOWN ON PLANS REFER TO THE ELEVATION AT EDGE OF PAVEMENT, OR GUTTERLINE WHERE APPLICABLE.
- ALL RETAINING WALLS GREATER THAN 1.0m IN HEIGHT ARE TO BE DESIGNED, APPROVED, AND STAMPED BY STRUCTURAL ENGINEER.
- FENCES OR RAILINGS ARE REQUIRED FOR RETAINING WALLS GREATER THAN 0.60m IN HEIGHT.
- EXCESS EXCAVATED MATERIAL SHALL BE REMOVED FROM THE SITE.
- ALL NECESSARY CLEARING AND GRUBBING SHALL BE COMPLETED BY THE CONTRACTOR. REVIEW WITH CONTRACT ADMINISTRATOR AND THE CITY OF OTTAWA PRIOR TO TREE CUTTING.
- REFER TO DRAWING EC-1 FOR EROSION AND SEDIMENT CONTROL DETAILS.

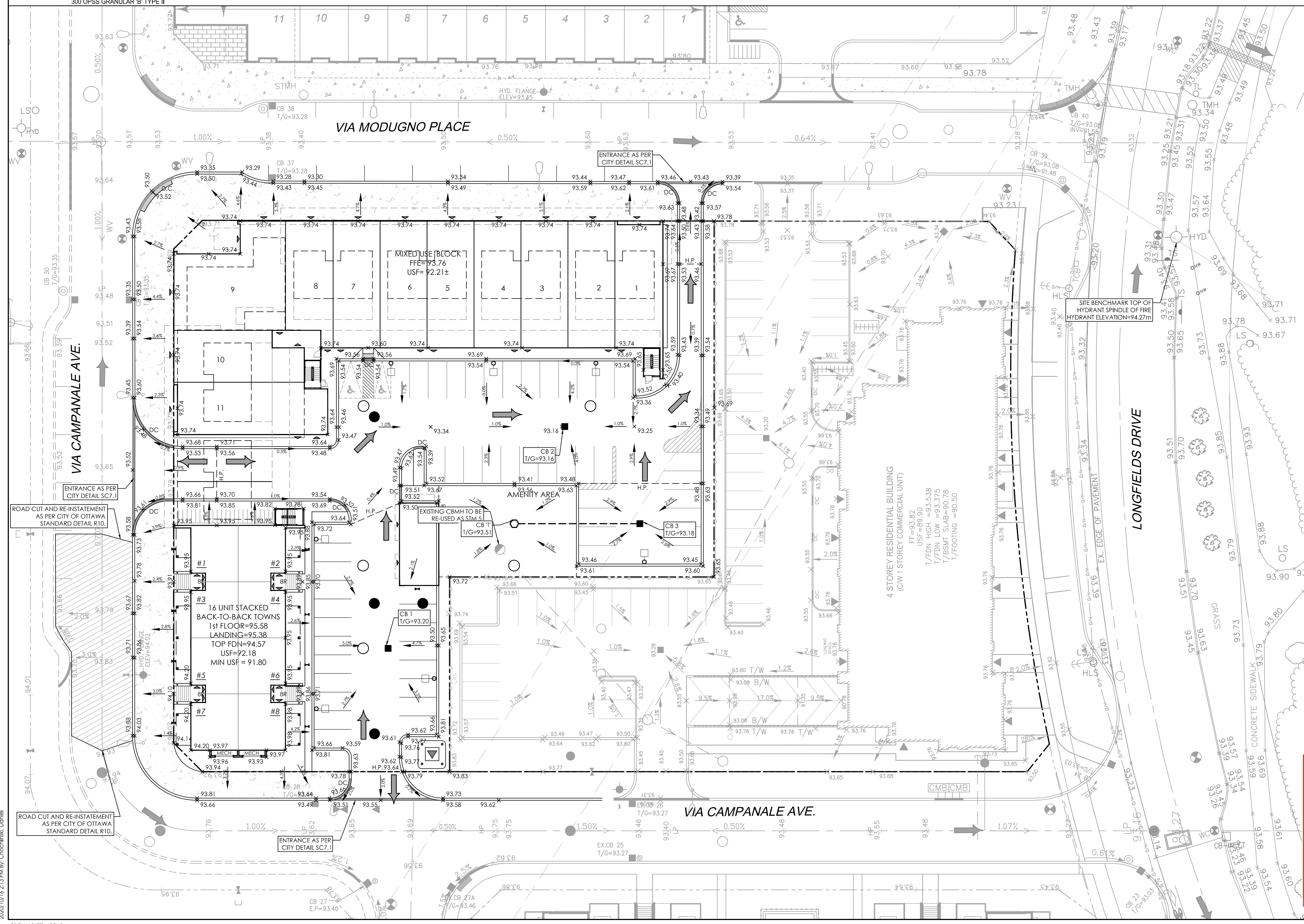

APPROVED

By Lily Xu at 2:31 pm, Nov 26, 2020

LILY XU, MCIP, RPP
MANAGER, DEVELOPMENT REVIEW SOUTH
PLANNING, INFRASTRUCTURE & ECONOMIC
DEVELOPMENT DEPARTMENT, CITY OF OTTAWA

V:\016401500\160401500.dwg 2020/11/26 2:31 PM by: Chaojie.Daniel ORIGINAL SHEET ARCH-D