

GENERAL CONSTRUCTION NOTES :

EROSION AND SEDIMENTATION CONTROL SYSTEM (ESCS) REQUIREMENTS

PRIOR TO COMMENCING ANY WORK, THE CONTRACTOR IS REQUIRED TO CONSTRUCT AN EROSION AND SEDIMENTATION CONTROL SYSTEM (ESCS) ON-SITE (IN ADDITION TO THE PROPOSED MEASURES DEPICTED ON THIS DRAWING) TO CONVEY RAINWATER AND/OR PUMPED WATER PRIOR TO ITS DISCHARGE TO THE SURFACE AND/OR TO ANY NATURAL WATER COURSE AND/OR TO ANY EXISTING SEWER SYSTEM. THE CONTRACTOR SHALL CONSTRUCT THE ESCS IN SUCH A WAY AS TO ENSURE THAT THE QUALITY OF THE DISCHARGED WATER DOES NOT EXCEED THE MORE STRINGENT CRITERIA OF EITHER THE ALLOWABLE TSS CONCENTRATION LIMITS SPECIFIED IN THE PTTW OR 25 MG/L AT ANY TIME.

THE CONTRACTOR SHALL CONSTRUCT AN ESCS TO ACHIEVE THE TURBIDITY AND TSS REMOVAL CRITERIA, REGULARLY MONITOR AND MAINTAIN IT TO ENSURE ONGOING COMPLIANCE. THE CONTRACTOR SHALL TAKE WATER SAMPLES AT THE OUTLET OF THE ESCS TO ENSURE THAT THE TURBIDITY AND TSS REMOVAL CRITERIA ARE MET IN ACCORDANCE WITH CITY OF OTTAWA S.P. NO. F. 1004. IF THE ANALYTICAL RESULTS ARE LESS THAN PRESCRIBED CRITERIA, THEN THE CONTRACTOR MAY BEGIN DEWATERING PROVIDED THAT THE QUALITY OF THE WATER REMAINS SUBSTANTIALLY THE SAME AS THE INITIAL MEASURED SAMPLE. SUBSEQUENT WATER SAMPLES SHALL ALSO BE COLLECTED IN ACCORDANCE WITH CITY OF OTTAWA S.P. NO. F. 1004.

NOTES:

1. SEDIMENT AND EROSION CONTROL MEASURES SHALL BE IMPLEMENTED PRIOR TO WORK AND MAINTAINED DURING THE WORK PHASE BY THE GENERAL CONTRACTOR TO PREVENT ENTRY OF SEDIMENT INTO THE RECEIVING STREAM. ALL SEDIMENT AND EROSION CONTROL MEASURES SHALL BE INSPECTED DAILY BY THE GENERAL CONTRACTOR TO ENSURE THAT THEY ARE FUNCTIONING PROPERLY AND ARE BEING MAINTAINED AND/OR UPGRADED AS REQUIRED. IF THE SEDIMENT AND EROSION CONTROL MEASURES ARE NOT FUNCTIONING PROPERLY, NO FURTHER WORK SHALL OCCUR UNTIL THE PROBLEM HAS BEEN ADDRESSED AND RECTIFIED.
2. ALL MATERIALS AND EQUIPMENT USED FOR THE PURPOSE OF SITE PREPARATION AND PROJECT COMPLETION SHALL BE OPERATED AND STORED IN A MANNER THAT PREVENTS ANY DELETERIOUS SUBSTANCES (I.E. PETROLEUM PRODUCTS, SILT, ETC.) FROM ENTERING THE RECEIVING STREAM.
3. SEDIMENT AND EROSION CONTROL MEASURES MAY BE MODIFIED IN THE FIELD AT THE DISCRETION OF THE CITY SITE INSPECTOR, ENGINEER AND/OR THE LOCAL CONSERVATION AUTHORITY.
4. INSPECTIONS AND REPAIR OF SEDIMENT AND EROSION CONTROLS WILL BE CONDUCTED AS SOON AS POSSIBLE FOLLOWING ANY RAIN EVENTS.
5. WORKS WILL NOT BE CONSIDERED COMPLETE UNTIL ALL SEDIMENT CONTROLS ARE REMOVED.
6. ALL SEDIMENTATION CONTROL MEASURES SHALL BE IMPLEMENTED AND CONSTRUCTED PER OPSB AND OPSB SILT FENCE SHALL BE TO OPSB 219.110.
7. CONTRACTOR IS RESPONSIBLE TO KEEP THE ROADS FREE AND CLEAN FROM MUD OR DEBRIS.
8. A MUD MAT IS TO BE BUILT AT THE DRIVE SITE ENTRANCE TO PREVENT THE TRANSPORT OF SEDIMENT ONTO PAVED SURFACES.
9. FILTER FABRIC TO BE PLACED UNDER GRATE OF EXISTING STREET CATCH BASINS. THE FILTER FABRIC SHALL BE INSPECTED DAILY TO ENSURE THAT THEY ARE FUNCTIONING PROPERLY AND ARE MAINTAINED AS REQUIRED.
10. CB SUMP TO BE PERIODICALLY CLEANED TO ENSURE ACCUMULATED SEDIMENTS DO NOT INTERFERE WITH STORMWATER CONVEYANCE OR CONTRIBUTE TO INCREASED BUILD-UP OF CONTAMINANTS (HEAVY METALS, NUTRIENTS, TOTAL SUSPENDED SOLIDS, PCBs, PAHs ETC.) IN THE SUMP, THAT MAY ENTER THE SEWER SYSTEM.
11. THE CONTRACTOR SHALL IMPLEMENT BEST MANAGEMENT PRACTICES TO PROVIDE FOR PROTECTION OF THE AREA DRAINAGE SYSTEMS AND THE RECEIVING WATERCOURSE DURING CONSTRUCTION ACTIVITIES. THE CONTRACTOR ACKNOWLEDGES THAT FAILURE TO IMPLEMENT APPROPRIATE EROSION AND SEDIMENT CONTROL MEASURES MAY BE SUBJECT TO PENALTIES IMPOSED BY ANY APPLICABLE REGULATORY AGENCY.
12. AT ALL CONNECTION POINTS, REINSTATE SURFACES TO EXISTING CONDITION OR BETTER.
 - ASPHALT RESTORATION SHALL BE IN ACCORDANCE WITH CITY OF OTTAWA STANDARD DRAWING NO. R10.
 - THICKNESS OF GRANULARS AND ASPHALT LAYERS SHALL MATCH EXISTING.
 - ASPHALT SHALL BE A MINIMUM OF 150mm (50mm BASE AND 50mm INTERMEDIATE COURSE, 50mm WEAR COURSE).
 - AN ASPHALT OVERLAY CONSISTING OF 50mm ASPHALT FOR 300mm MINIMUM IS REQUIRED OUTSIDE OF TRENCHES PER CITY OF OTTAWA STANDARD DRAWING NO. R10.
 - BOLLARDS / GRASSED AREAS SHALL BE REINSTATED WITH MINIMUM 100mm TOPSOIL AND SOD.

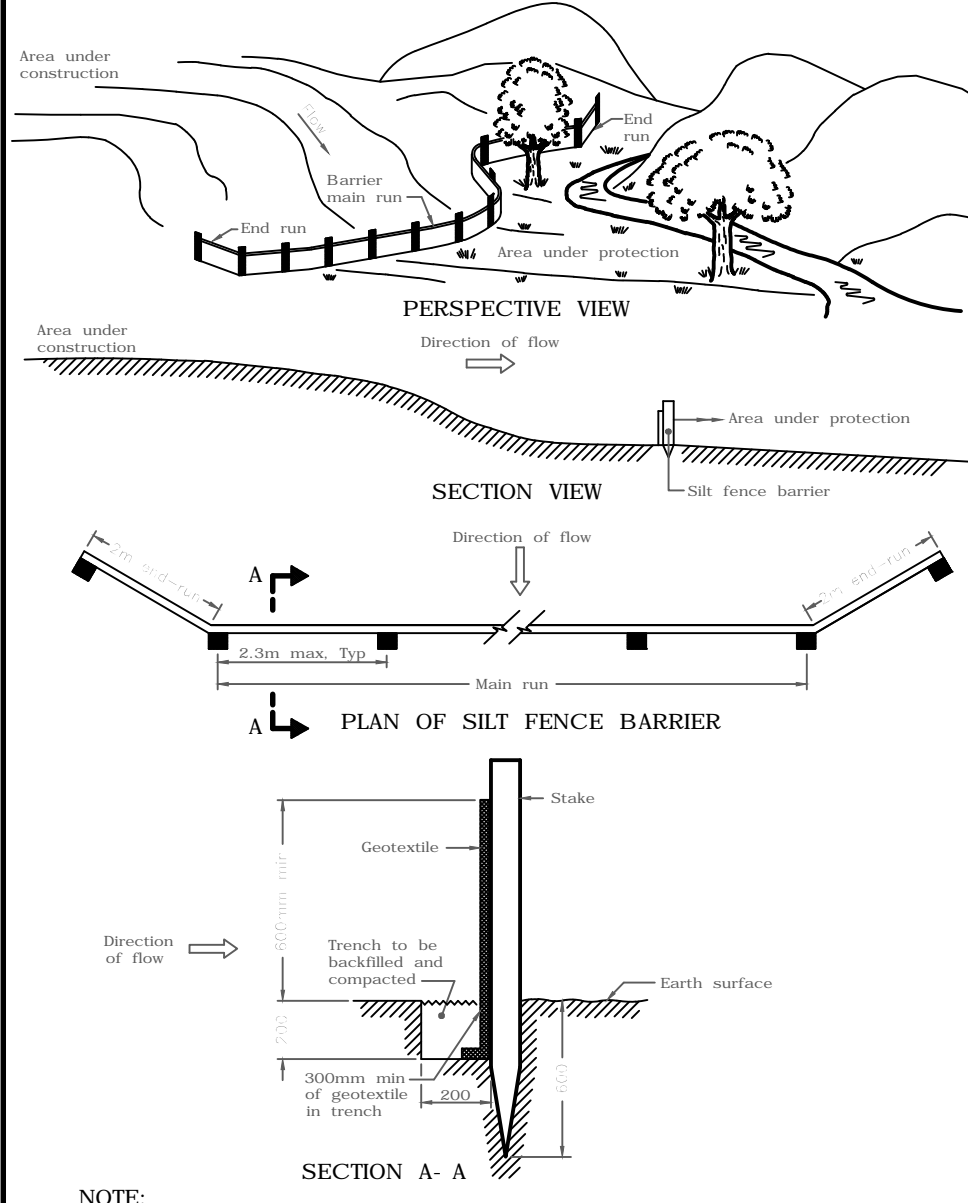

NOTE: A. All dimensions are in millimetres or metres unless otherwise shown.

ONTARIO PROVINCIAL STANDARD DRAWING 1990 02 01
LIGHT DUTY SILT FENCE BARRIER
 OPSD - 219.110

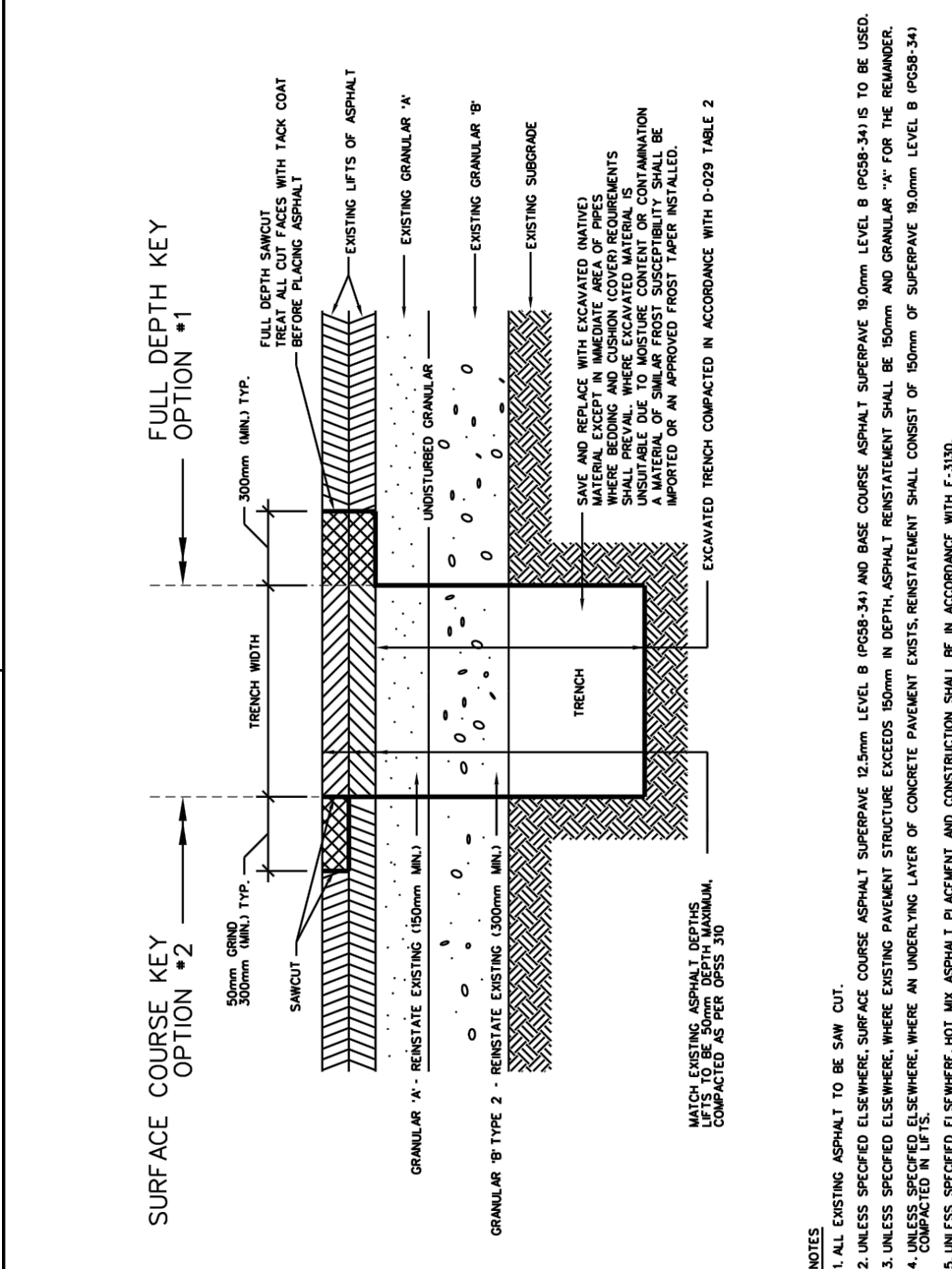

DATE: MAR 2001
 REV: MARCH 2007
 (REVISED) R10

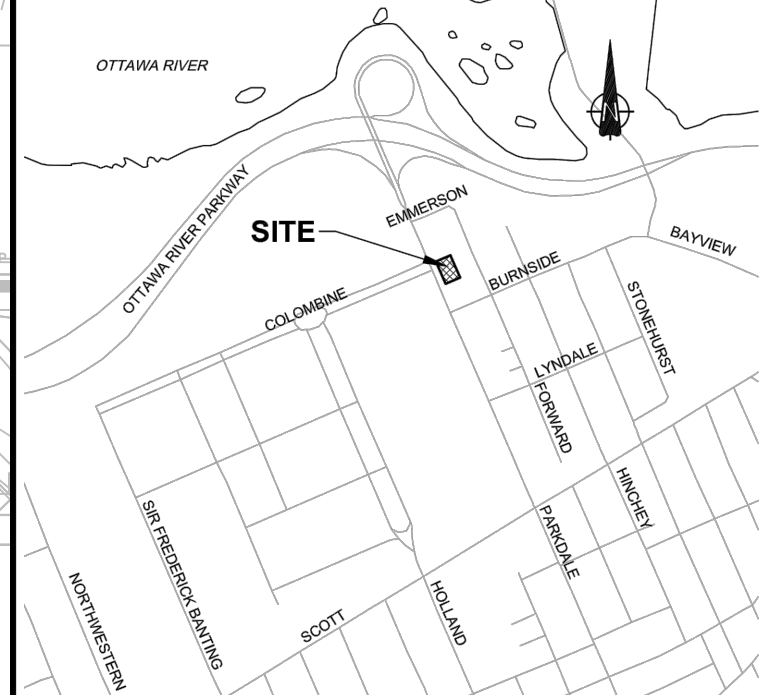
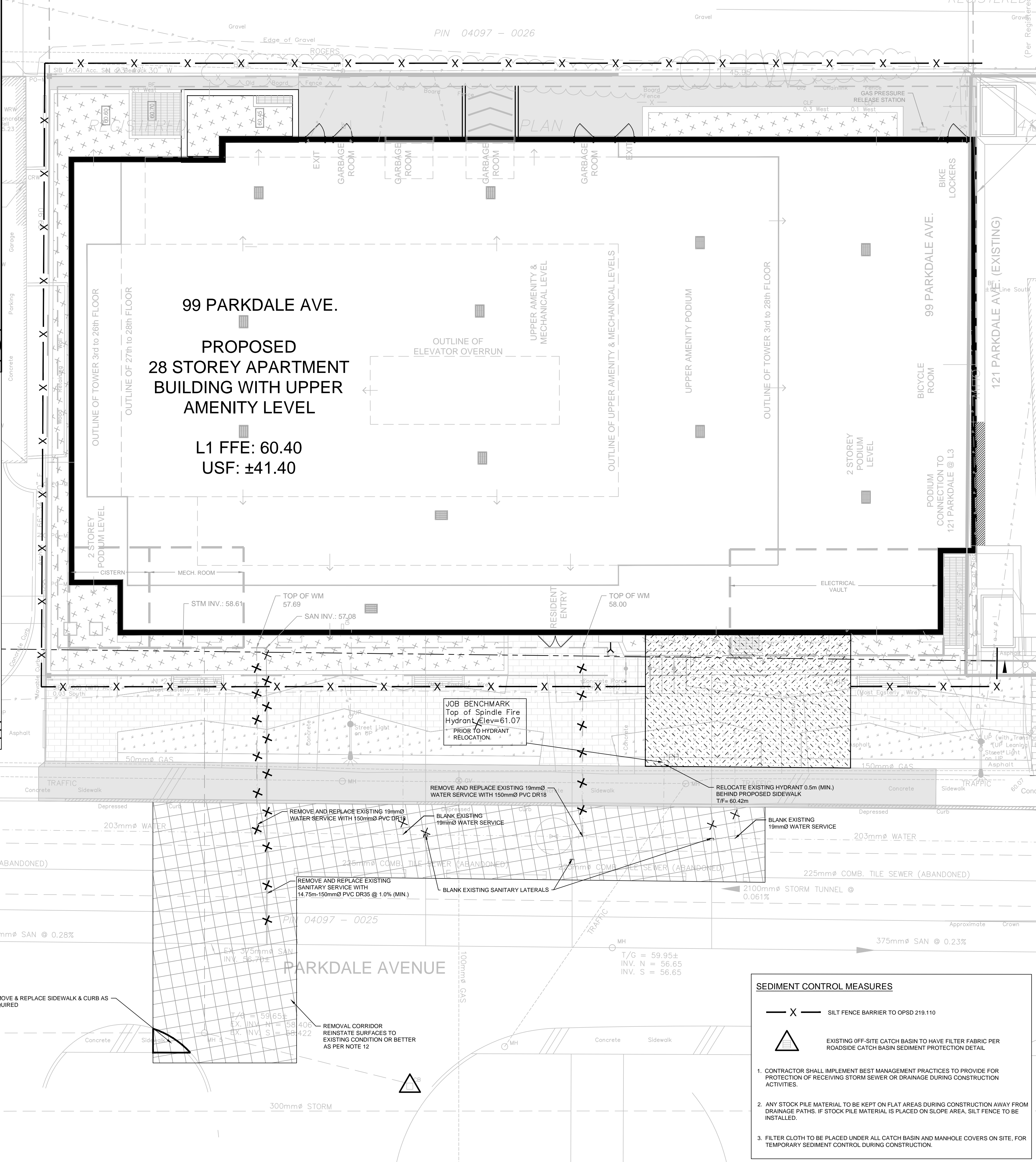

No.	ISSUE / REVISION	DATE
03	ISSUED TO CITY FOR REVIEW - THIRD SUBMISSION	13/03/2020
02	ISSUED TO CITY FOR REVIEW - SECOND SUBMISSION	07/02/2020
01	ISSUED TO CITY FOR REVIEW - FIRST SUBMISSION	22/10/2019
	ISSUE / REVISION	DD/MM/YY

This drawing is copyright protected and may not be reproduced or used for purposes other than execution of the described work without the express written consent of J.L. Richards & Associates Limited.

VERIFY SHEET SIZE AND SCALES. BAR TO THE RIGHT IS 25mm IF THIS IS A FULL SIZE DRAWING.

SCALE: 1:100

CLIENT:
BRIGIL
 CONSULTANT: www.jrichards.ca
J.L. Richards
 ENGINEERS - ARCHITECTS - PLANNERS

CONSULTANT:
 PROFESSIONAL STAMP
 PROJECT NORTH
 LICENSED PROFESSIONAL ENGINEER
 W. N. L. DALRYMPLE
 March 13, 2020
 PROVINCE OF ONTARIO

PROJECT:
99 PARKDALE AVENUE
 OTTAWA ONTARIO

DRAWING:
REMOVALS, REINSTATEMENTS & EROSION PLAN

DESIGN: SP
 DRAWN: SP
 CHECKED: LD
 JLR #: 25205-100

DRAWING #:
RESC

NOTES:

- 1) TO BE USED UNDER APPROPRIATE DRAINAGE CIRCUMSTANCES, DURING THE CONSTRUCTION PERIOD.
- 2) WOVEN GEOTEXTILE TO HAVE A MINIMUM EQUIVALENT OPENING SIZE OF 0.15mm AND A MAXIMUM EQUIVALENT OPENING SIZE OF 0.3mm.
- 3) WOVEN GEOTEXTILE TO BE REPLACED PERIODICALLY WHEN ACCUMULATED SEDIMENTS INTERFERE WITH DRAINAGE.
- 4) ALL DIMENSIONS ARE IN MILLIMETRES UNLESS OTHERWISE SHOWN.

ROADSIDE CATCH BASIN SEDIMENT PROTECTION DETAIL

DATE: MAR 2001
 REV: MARCH 2007
 (REVISED) R10

SAIDE SAYAH
 MANAGER, CENTRAL BRANCH
 PLANNING, INFRASTRUCTURE & ECONOMIC DEVELOPMENT DEPARTMENT, CITY OF OTTAWA

APPROVED
 By Saide Sayah at 12:43 pm, Oct 19, 2020