

Copyright Reserved  
The Contractor shall verify and be responsible for all dimensions. DO NOT scale the drawing - any errors or omissions shall be reported to Stantec without delay.  
The Copyrights to all designs and drawings are the property of Stantec. Reproduction or use for any purpose other than that authorized by Stantec is forbidden.

**Legend**

- ROOF 1: AREA ID
- 1.00 0.90: RUNOFF COEFFICIENT
- : STORM DRAINAGE AREA b.c.
- : STORM DRAINAGE AREA b.c. MAXIMUM PONDING LIMITS
- : DIRECTION OF OVERLAND FLOW
- : PROPOSED STORM SEWER
- : PROPOSED CATCHBASIN MANHOLE
- : PROPOSED CATCHBASIN
- : PROPOSED DITCH INLET CATCHBASIN
- : PROPOSED DOUBLE CATCH BASIN
- : PROPOSED SUB DRAIN CATCH BASIN AS PER CITY OF OTTAWA STANDARD DETAIL DRAWINGS L10 AND L11
- : PROPOSED PERFORATED SUBDRAIN
- : EXISTING STORM SEWER
- : EXISTING CATCHBASIN MANHOLE
- : EXISTING CATCHBASIN
- : EXISTING SUBDRAIN CATCHBASIN
- : EXISTING SWALE
- : THERMAL INSULATION ON STORM SEWER WHERE COVER IS LESS THAN 1.5m. THERMAL INSULATION ON WATERMAIN WHERE COVER IS LESS THAN 2.4m AS PER W22.
- : PROPOSED SCUPPER LOCATIONS

**SCHEDULE OF ROOF RELEASE RATES**

ROOF	DRAIN TYPE	NUMBER OF DRAINS	DEPTH (m)	HEAD (m)	DISCHARGE (L/s)	VOLUME REQUIRED (m <sup>3</sup> )	VOLUME AVAILABLE (m <sup>3</sup> )
1+2	WATTS ACCUFLOW (50% OPEN)	7	136	0.136	8.21	29.1	38.2
3	WATTS ACCUFLOW (100% OPEN)	4	142	0.142	7.14	37.9	43.9
4	WATTS ACCUFLOW (CLOSED)	5	135	0.135	3.15	10.5	14.1
5	WATTS ACCUFLOW (100% OPEN)	4	142	0.142	7.14	37.9	43.9
6+7	WATTS ACCUFLOW (50% OPEN)	7	136	0.136	8.21	29.1	38.2
8	WATTS ACCUFLOW (25% OPEN)	2	117	0.117	1.68	1.9	3.9
9	WATTS ACCUFLOW (25% OPEN)	2	100	0.100	1.58	0.6	2.1
10	WATTS ACCUFLOW (25% OPEN)	21	141	0.141	19.25	94.7	112.4
11	WATTS ACCUFLOW (25% OPEN)	2	120	0.120	1.70	2.2	4.2
12	WATTS ACCUFLOW (25% OPEN)	2	118	0.118	1.69	2.0	4.0

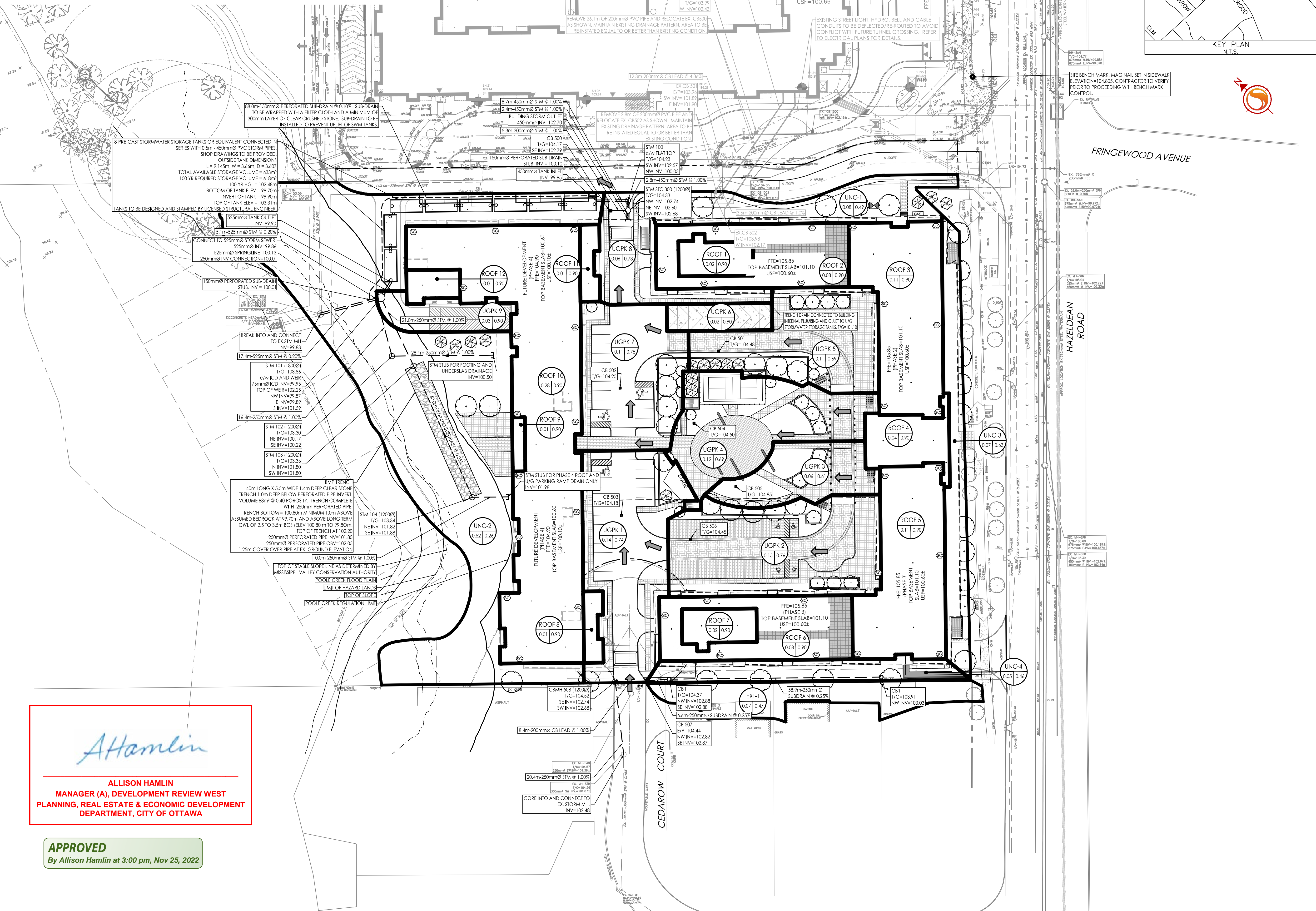

Revision	By	Appd.	YY.MM.DD	
5	REVISÉ AS PER CITY COMMENTS	MJS	DT	22.07.14
4	REVISÉ AS PER CITY COMMENTS	MJS	DT	22.03.29
3	REVISÉ AS PER CITY COMMENTS	MJS	TR	21.09.02
2	ISSUED FOR GEOTECH REVIEW	MJS	DT	21.08.03
1	ISSUED TO CITY FOR SPA	MJS	DT	20.05.22

File Name: 160401511-DB MJS DT MJS 19.09.05  
Dwn. Chkd. Dgn. YY.MM.DD

Permit-Seal

Client/Project  
**NAUTICAL LANDS GROUP**  
2962 Carp Road  
**WELLINGS OF STITTSVILLE PH 2**  
20 CEDAROW COURT  
OTTAWA, ON

Title  
**STORM DRAINAGE PLAN**

Project No. 160401511 Scale 1:500  
Drawing No. Sheet Revision

SD-1 6 of 7 5  
PLAN No. 18190

*Allanlin*  
**ALLISON HAMLIN**  
MANAGER (A), DEVELOPMENT REVIEW WEST  
PLANNING, REAL ESTATE & ECONOMIC DEVELOPMENT  
DEPARTMENT, CITY OF OTTAWA

**APPROVED**  
By Allison Hamlin at 3:00 pm, Nov 25, 2022

W:\active\160401511\design\drawings\160401511-DB.dwg  
22/11/2022 14:15:59 by: mhamlin