

Copyright Reserved

The Contractor shall verify and be responsible for all dimensions. DO NOT scale the drawing - any errors or omissions shall be reported to Stantec without delay. The Copyrights to all designs and drawings are the property of Stantec. Reproduction or use for any purpose other than that authorized by Stantec is forbidden.

Legend

- PROPOSED WATERMAIN
- PROPOSED VALVE AND VALVE BOX
- PROPOSED REDUCER
- PROPOSED FIRE HYDRANT
- PROPOSED SANITARY SEWER
- PROPOSED STORM SEWER
- PROPOSED CATCHBASIN MANHOLE
- PROPOSED CATCH BASIN
- ALL CATCH BASINS TO BE CONNECTED TO INTERNAL PLUMBING AND DRAIN TO EXISTING STORM WATER MANAGEMENT TANKS.
- PROPOSED DITCH INLET CATCHBASIN
- PROPOSED SUBDRAIN CATCHBASIN
- EXISTING WATERMAIN
- EXISTING VALVE AND VALVE BOX
- EXISTING VALVE CHAMBER
- EXISTING REDUCER
- EXISTING FIRE HYDRANT
- EXISTING SANITARY SEWER
- EXISTING STORM SEWER
- EXISTING CATCHBASIN MANHOLE
- EXISTING CATCHBASIN
- EXISTING SUBDRAIN CATCHBASIN
- EXISTING SWALE
- PROPOSED DEPRESSED CURB LOCATIONS
- PROPOSED MOUNTABLE/BARRIER CURB LOCATION
- THERMAL INSULATION ON STORM SEWER WHERE COVER IS LESS THAN 1.5m. THERMAL INSULATION ON WATERMAIN WHERE COVER IS LESS THAN 2.4m AS PER W22.
- WATER METER
- REMOTE WATER METER
- PROPOSED COMMUNITY MAILBOX LOCATIONS

NOTES:

- UNDERGROUND PARKING RAMP TRENCH DRAINS TO BE CONVEYED THROUGH BUILDING AND OUTLET INTO EXTERNAL UNDERGROUND STORM WATER MANAGEMENT STORAGE TANKS.
- ALL SURFACE CATCH BASINS INSTALLED ON TOP OF UNDERGROUND PARKING STRUCTURE TO BE CONVEYED THROUGH BUILDING AND OUTLET INTO EXTERNAL UNDERGROUND STORM WATER MANAGEMENT STORAGE TANKS.
- PROPOSED FIRE HYDRANT TO BE SERVICED THROUGH BUILDINGS INTERNAL PLUMBING.

1	ISSUED TO CITY FOR SPA	MJS	DT	20.05.22
Revision		By	Appd.	YY.MM.DD
File Name:	160401511-08	MJS	DT	MJS
		Dwn.	Chkd.	Dgn.
				YY.MM.DD

Permit-Seal

Client/Project
NAUTICAL LANDS GROUP
2962 Carp Road
WELLINGS OF STITTSVILLE PH 2
20 CEDAROW COURT
OTTAWA, ON

Title
SITE SERVICING PLAN

Project No.	Scale	0 5 15 25m
160401511	1:500	
Drawing No.	Sheet	Revision

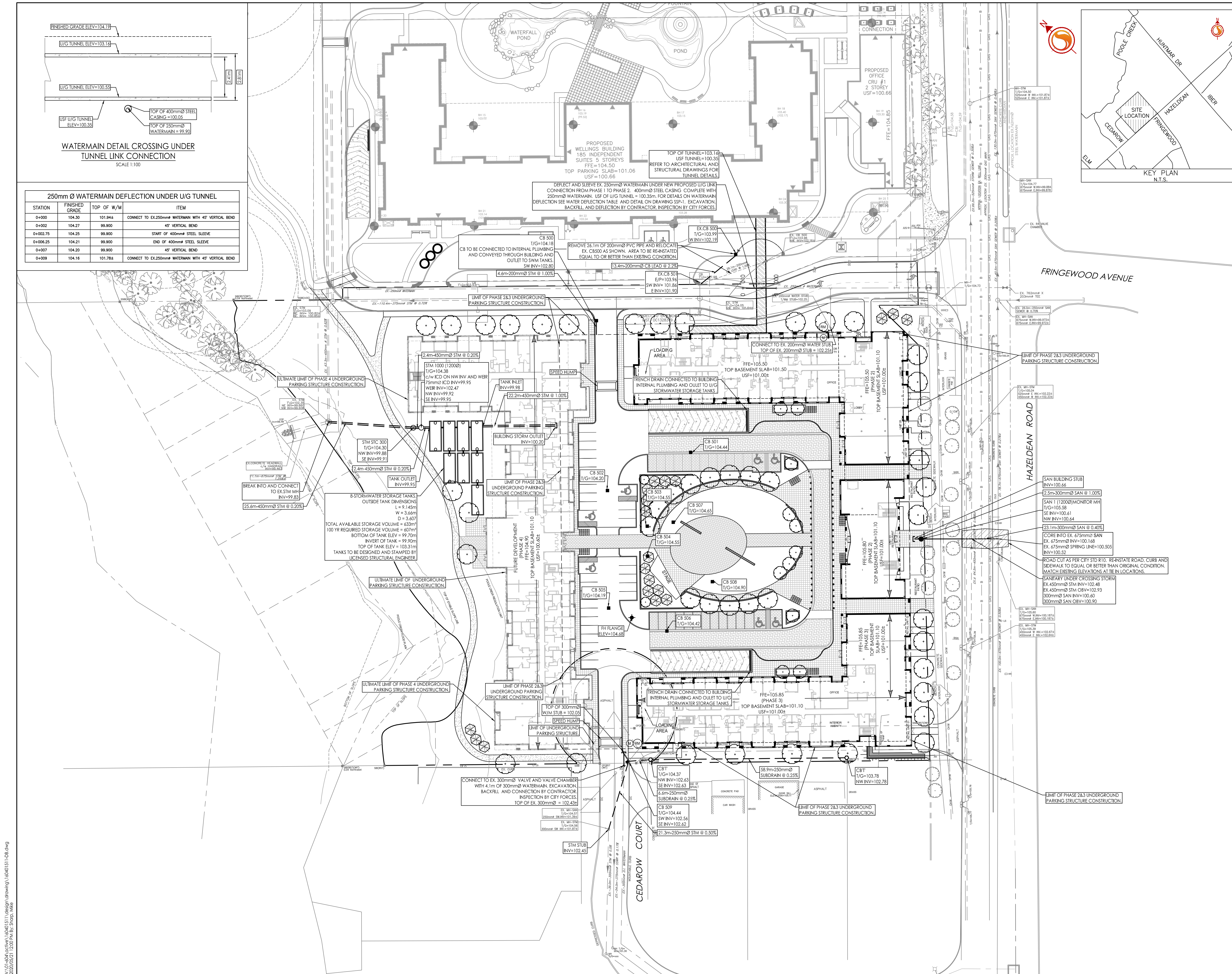

250mm Ø WATERMAIN DEFLECTION UNDER U/G TUNNEL

STATION	FINISHED GRADE	TOP OF W/M	ITEM
0+000	104.30	101.94	CONNECT TO EX 250mm WATERMAIN WITH 45° VERTICAL BEND
0+002	104.27	99.900	45° VERTICAL BEND
0+002.75	104.25	99.900	START OF 400mm STEEL SLEEVE
0+006.25	104.21	99.900	END OF 400mm STEEL SLEEVE
0+007	104.20	99.900	45° VERTICAL BEND
0+009	104.16	101.78	CONNECT TO EX 250mm WATERMAIN WITH 45° VERTICAL BEND

V:\10160401\active\160401511\design\drawing\160401511-08.dwg
 2022/05/21 12:00 PM by: shapc, mbe
 ORIGINAL SHEET - ARCH D