

edsa

PLANNING
LANDSCAPE ARCHITECTURE
URBAN DESIGN

INNER HARBOR CENTER
400 EAST PRATT STREET, SUITE 502
BALTIMORE, MARYLAND 21202 USA
TEL: 443.539.3350

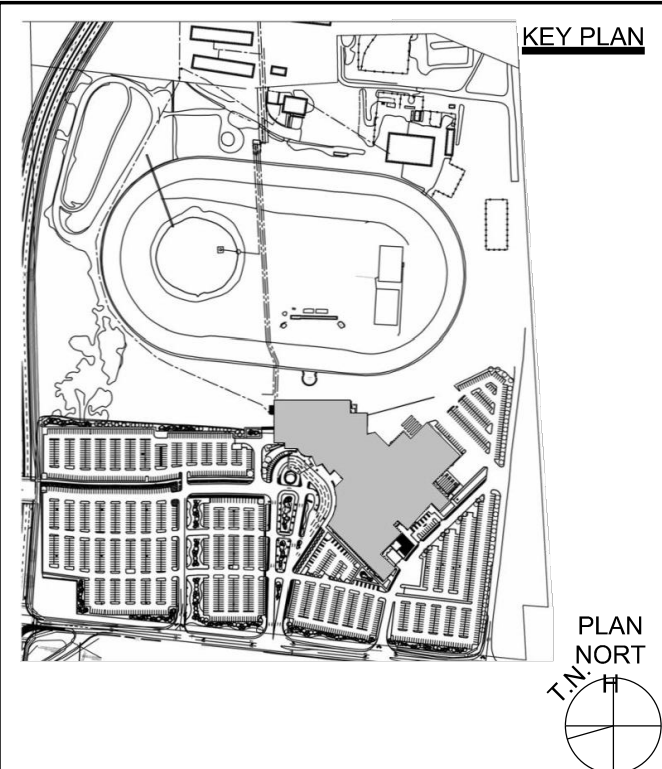

HARD ROCK HOTEL CASINO
4837 ALBION ROAD,
GLOUCESTER, OTTAWA,
ON, CANADA
4837 ALBION RD,
GLOUCESTER, OTTAWA
ONTARIO, CANADA

SITE PLAN AGREEMENT PACKAGE - 2019 11 15

SUBMISSIONS

NO.	DATE	DESCRIPTION
1	11.20.19	REVISION 1

DRAWING TITLE: ILLUSTRATIVE PLAN

DRAWN BY:	DATE:
REVIEWED BY:	11/15/2019
SCALE:	DRAWING NO.
1:750	L0.00
PROJECT NO.	
19072.00	

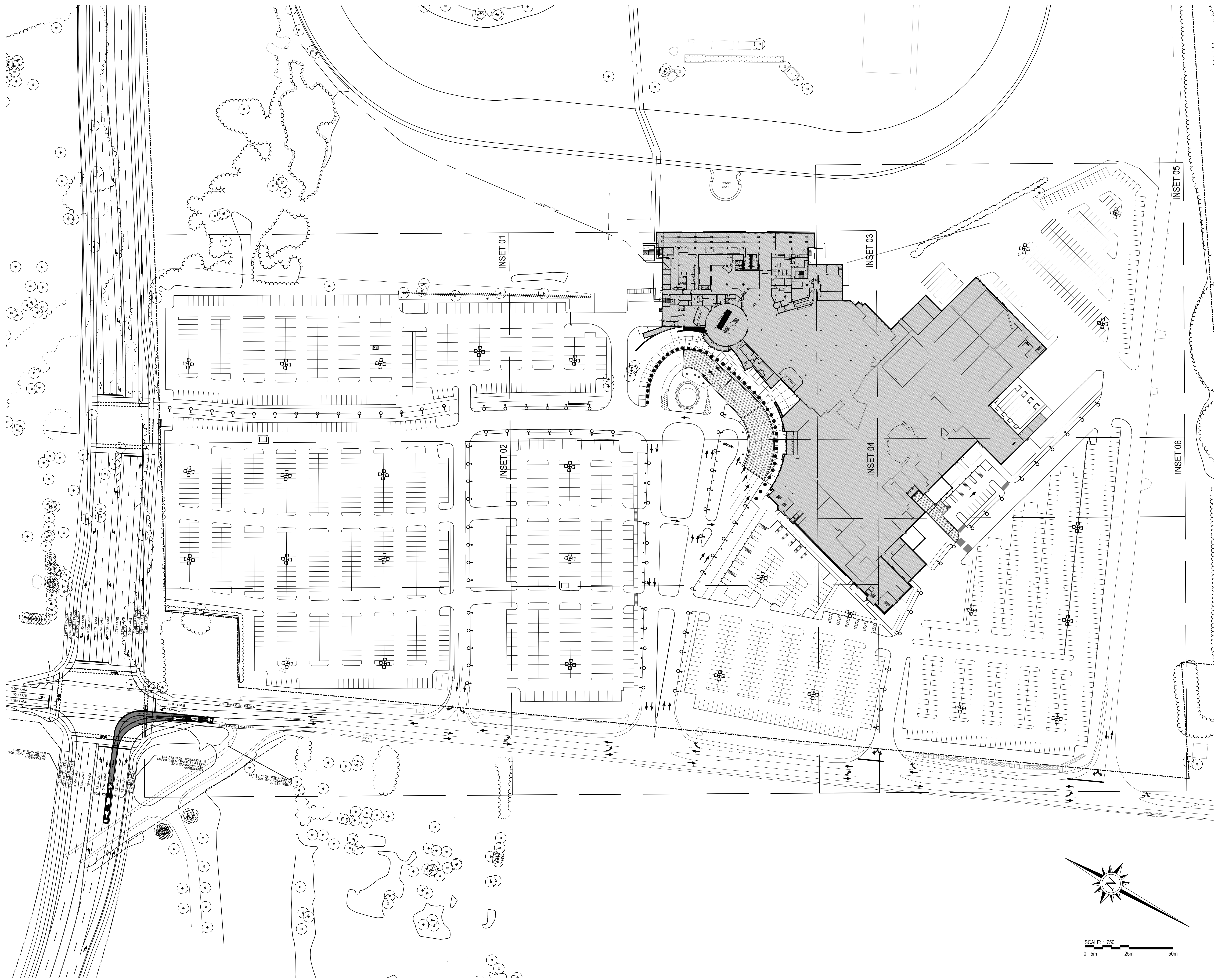

PLANNING
 LANDSCAPE ARCHITECTURE
 URBAN DESIGN
 INNER HARBOR CENTER
 400 EAST PRATT STREET, SUITE 502
 BALTIMORE, MARYLAND 21202 USA
 TEL: 443.539.3350

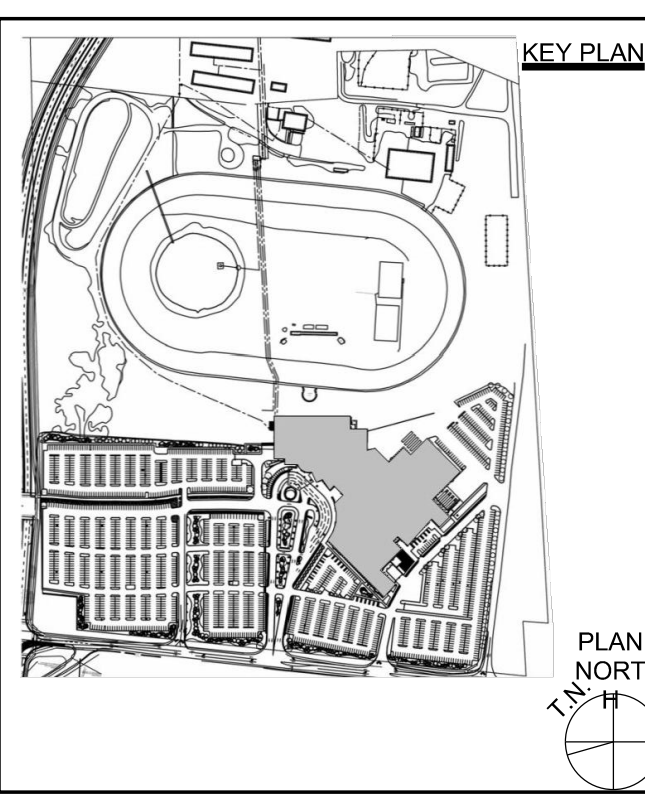

HARD ROCK HOTEL CASINO
 4837 ALBION ROAD,
 GLOUCESTER, OTTAWA,
 ON, CANADA
 4837 ALBION RD.
 GLOUCESTER, OTTAWA
 ONTARIO, CANADA

SITE PLAN AGREEMENT
 PACKAGE - 2019 11 15

SUBMISSIONS		
△	11.20.19 REVISION 1	
NO.	DATE	DESCRIPTION

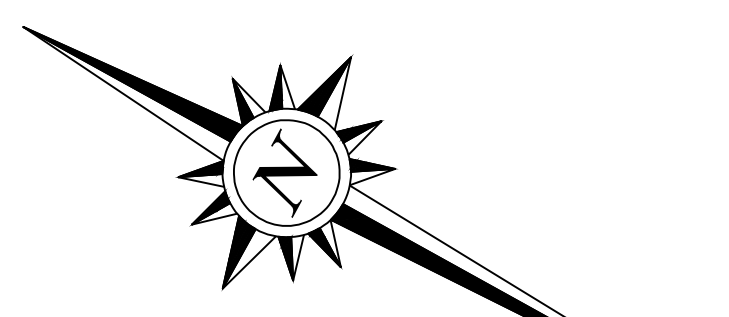

SCALE: 1:750
 0 5m 25m 50m



DRAWING TITLE:
KEY PLAN

DRAWN BY:	DATE:
REVIEWED BY:	11/15/2019
SCALE:	DRAWING NO.:
1:750	L0.01
PROJECT NO.	
19072.00	

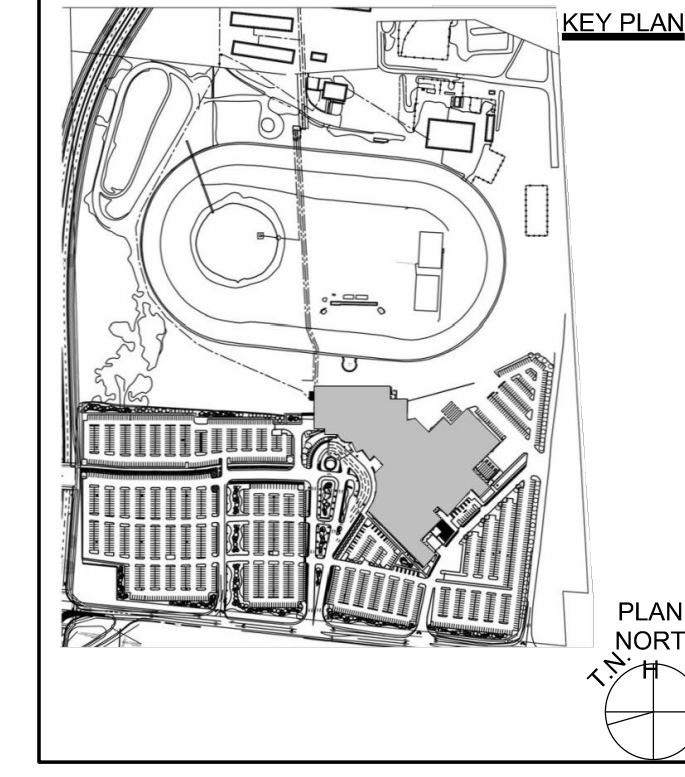

PLANNING
LANDSCAPE ARCHITECTURE
URBAN DESIGN

INNER HARBOR CENTER
400 EAST PRATT STREET, SUITE 502
BALTIMORE, MARYLAND 21202 USA
TEL: 443.539.3350

HARD ROCK HOTEL CASINO
4837 ALBION ROAD,
GLOUCESTER, OTTAWA,
ON, CANADA
4837 ALBION RD,
GLOUCESTER, OTTAWA,
ONTARIO, CANADA

SITE PLAN AGREEMENT
PACKAGE - 2019 11 15

SUBMISSIONS

NO.	DATE	DESCRIPTION
Δ	11.20.19	REVISION 1

DRAWING TITLE:
SITE LANDSCAPE PLAN

DRAWN BY:	DATE:
REVIEWED BY:	11/15/2019
SCALE:	DRAWING NO.
1:300	
PROJECT NO.	L1.02
19072.00	

PLANT SCHEDULE

KEY	QTY	BOTANICAL NAME	COMMON NAME
SHADE TREES			
AR	63	Acer rubrum 'Red Sunset'	Red Sunset Red Maple
AS	24	Acer saccharum 'Green Mountain'	Green Mountain Sugar Maple
GT	13	Gleditsia tricanthos var. inermis Shademaster	Shademaster Honeylocust
PG	5	Populus grandidentata	Large-tooth Aspen
	105	Totals	
EVERGREEN TREES			
PA	50	Picea abies	Norway Spruce
PC	239	Picea abies 'Cupressina'	Columnar Norway Spruce
PN	36	Picea nigra	Austrian Pine
PP	88	Picea pungens 'Glaucal'	Colorado Blue Spruce
PS	54	Pinus strobus	White Pine
TS	42	Tsuga canadensis	Eastern Hemlock
	509	Totals	
EVERGREEN SHRUBS			
CPF	152	Chamaecyparis pisifera filifera	Threadleaf False Cypress
EFC	411	Euonymus fortunei 'Canadale Gold'	Canadale Gold Euonymus
EFM	101	Euonymus fortunei 'Moonshadow'	Moonshadow Euonymus
JCG	150	Juniperus communis 'Green Carpet'	Green Carpet Juniper
JCP	88	Juniperus chinensis 'Pfitzeriana Compacta'	Compact Pfitzer Juniper
JHW	283	Juniperus horizontalis 'Wiltoni'	Blue Rug Juniper
JSW	39	Juniperus scopulorum 'Wichita Blue'	Wichita Blue Juniper
	1072	Totals	
DECIDUOUS SHRUBS			
FOG	28	Forsythia ovata 'Ottawa'	Ottawa Forsythia
HPL	71	Hydrangea paniculata 'Limelight.'	Limelight Hydrangea
IWJ	12	Ilex verticillata 'Jim Dandy'	Dwarf Winterberry Holly (male)
IVR	72	Ilex verticillata 'Red Sprite'	Dwarf Winterberry Holly (female)
VIB	47	Viburnum x burkwoodii	Burkwoodii Viburnum
VDB	25	Viburnum dentatum 'Blue Muffin'	Blue Muffin Viburnum
	2528	Totals	
PERENNIALS / GROUNDCOVERS / GRASSES			
AAB	140	Astilbe arendsi 'Bridal Veil'	Bridal Veil Garden Astilbe
HYK	25	Hypericum kalmianum	St.Johns Wort
MSG	535	Miscanthus sinensis 'Gracillimus'	Silver Maiden Grass
PAH	565	Pennisetum alopecuroides 'Harneli'	Dwarf Harneli Fountain Grass
PVH	90	Panicum virgatum 'Shenandoah'	Shenandoah Switch Grass
	4108	Totals	
LAWN			
		Seeded / Sodded Lawn	

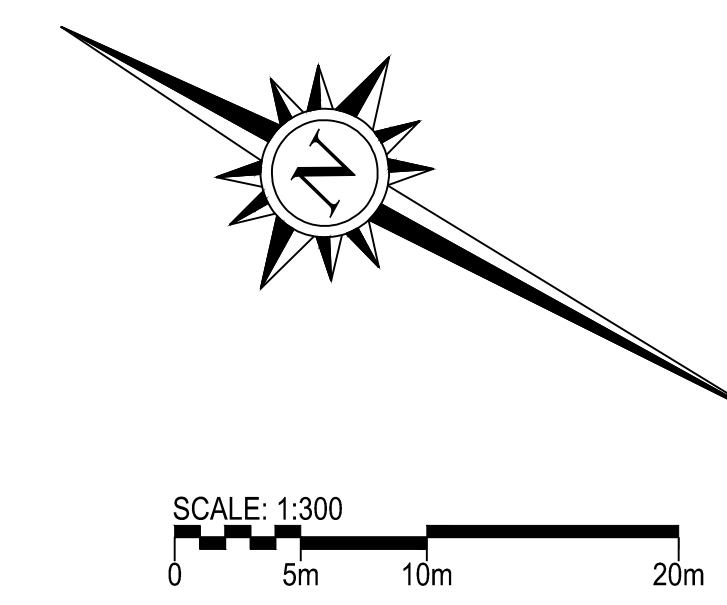
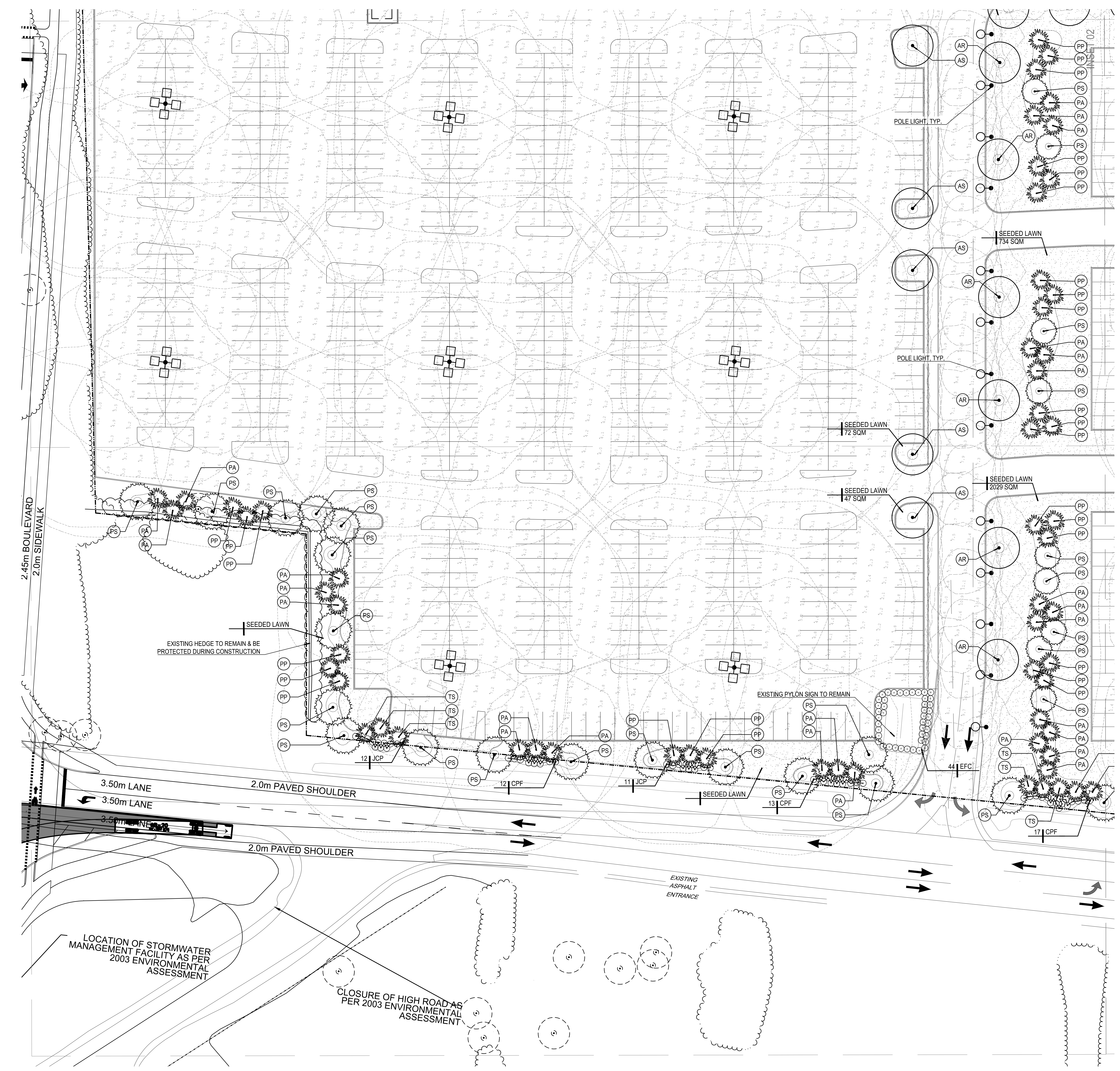

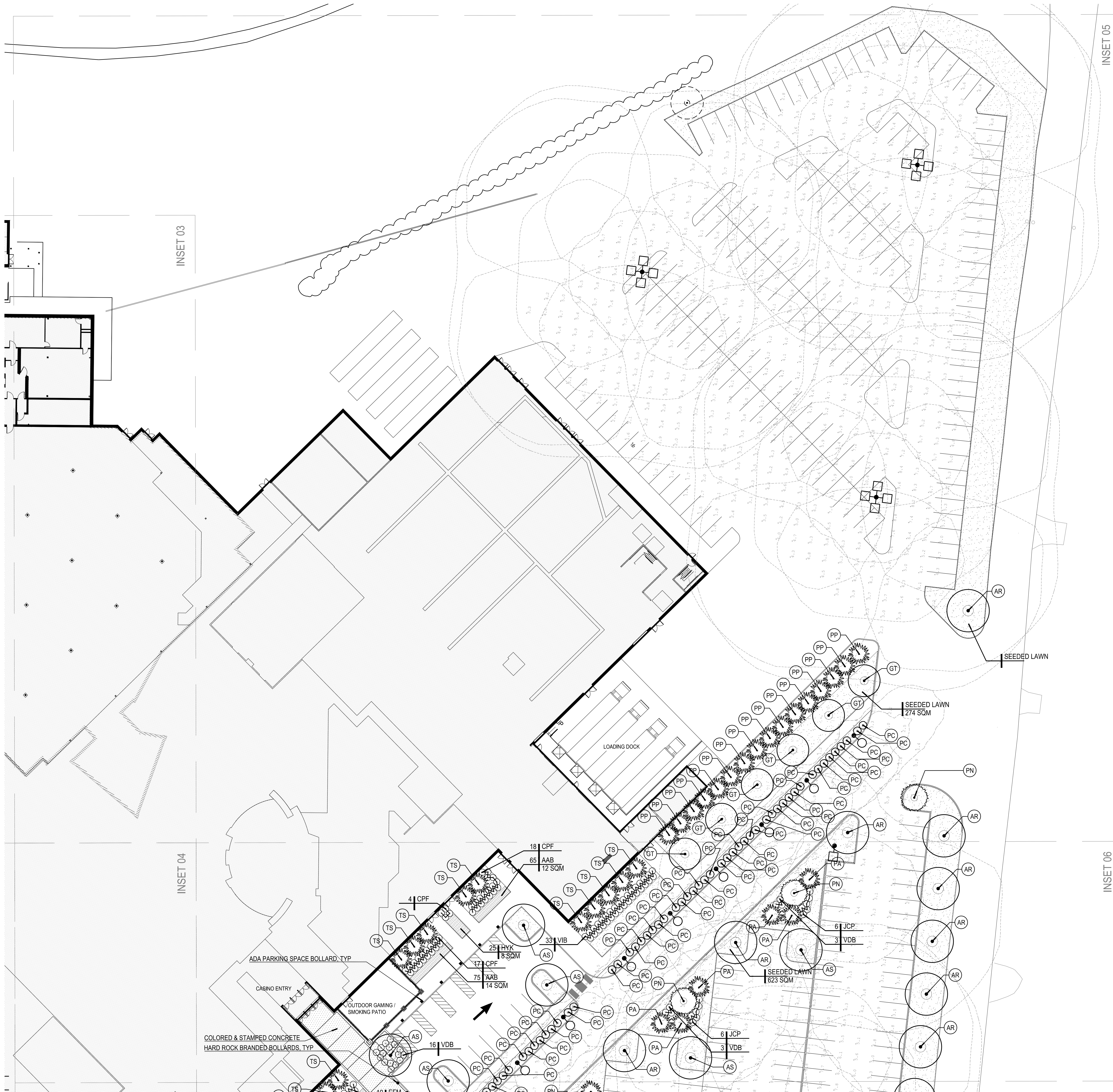

PLANT SCHEDULE			
KEY	QTY	BOTANICAL NAME	COMMON NAME
SHADE TREES			
AR	43	Acer rubrum 'Red Sunset'	Red Sunset Red Maple
AS	24	Acer saccharum 'Green Mountain'	Green Mountain Sugar Maple
GT	13	Gleditsia tricanthos var. inermis 'Shademaster'	Shademaster Honeylocust
PG	5	Populus grandidentata	Largeleaf Aspen
	105	Totals	
EVERGREEN TREES			
PA	50	Picea abies	Norway Spruce
PC	239	Picea abies 'Cupressina'	Columnar Norway Spruce
PN	36	Picea nigra	Austrian Pine
PT	88	Picea pungens 'Glauca'	Colorado Blue Spruce
PS	54	Pinus strobus	White Pine
TS	42	Tsuga canadensis	Eastern Hemlock
	509	Totals	
EVERGREEN SHRUBS			
CPF	152	Chamaecyparis pisifera filifera	Threadleaf False Cypress
EFC	411	Euonymus fortunei 'Canadale Gold'	Canadale Gold Euonymus
EFM	101	Euonymus fortunei 'Moonshadow'	Moonshadow Euonymus
JCG	150	Juniperus communis 'Green Carpet'	Green Carpet Juniper
JCP	88	Juniperus chinensis 'Pfitzeriana Compacta'	Compact Pfitzer Juniper
JHW	283	Juniperus horizontalis 'Wiltoni'	Blue Rug Juniper
JSW	39	Juniperus scopulorum 'Wichita Blue'	Wichita Blue Juniper
	1072	Totals	
DECIDUOUS SHRUBS			
FOJ	28	Forsythia ovalis 'Ottawa'	Ottawa Forsythia
HPL	71	Hydrangea paniculata 'Limelight'	Limelight Hydrangea
IWJ	12	Ilex verticillata 'Jim Dandy'	Dwarf Winterberry Holly (male)
IWR	72	Ilex verticillata 'Red Sprite'	Dwarf Winterberry Holly (female)
VIB	47	Viburnum x burkwoodii	Burkwoodii Viburnum
VDB	25	Viburnum dentatum 'Blue Muffin'	Blue Muffin Viburnum
	2528	Totals	
PERENNIALS / GROUNDCOVERS / GRASSES			
AAB	140	Astilbe arendsii 'Bridal Veil'	Bridal Veil Garden Astilbe
HYK	25	Hypericum kalimianum	St. Johns Wort
MSG	535	Miscanthus sinensis 'Gracillimus'	Silver Maiden Grass
PAH	565	Pennisetum alopecuroides 'Harmeln'	Dwarf Harmeln Fountain Grass
PVH	30	Panicum virgatum 'Shenandoah'	Shenandoah Switch Grass
	4108	Totals	
LAWN			
		Seeded / Sodded Lawn	



PLANNING
LANDSCAPE ARCHITECTURE
URBAN DESIGN
INNER HARBOR CENTER
400 EAST PRATT STREET, SUITE 502
BALTIMORE, MARYLAND 21202 USA
TEL: 443.539.3350

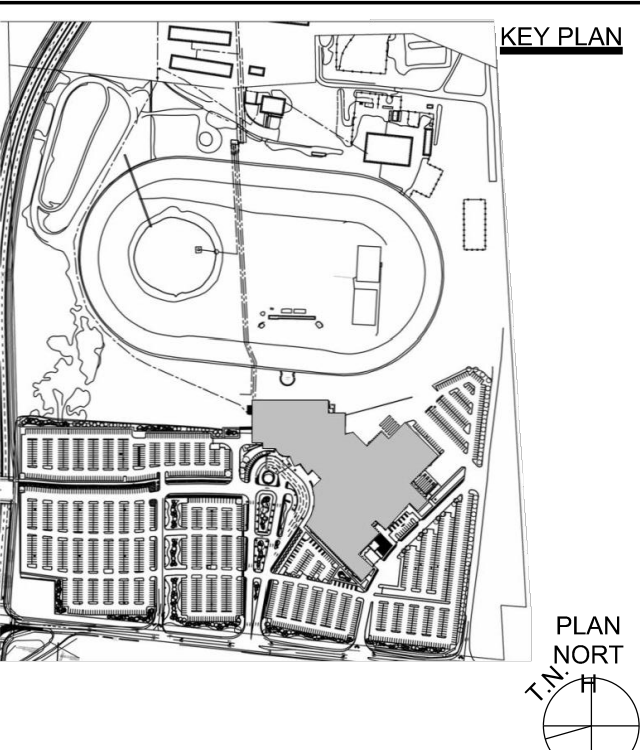

HARD ROCK HOTEL CASINO
4837 ALBION ROAD,
GLOUCESTER, OTTAWA,
ON, CANADA
4837 ALBION RD,
GLOUCESTER, OTTAWA
ONTARIO, CANADA

SITE PLAN AGREEMENT
PACKAGE - 2019 11 15

SUBMISSIONS

NO.	DATE	DESCRIPTION
Δ	11.20.19	REVISION 1

DRAWING TITLE:
SITE LANDSCAPE PLAN

DRAWN BY: DATE:
REVIEWED BY: 11/15/2019
SCALE: DRAWING NO.
1:300
PROJECT NO. 19072.00 L1.05

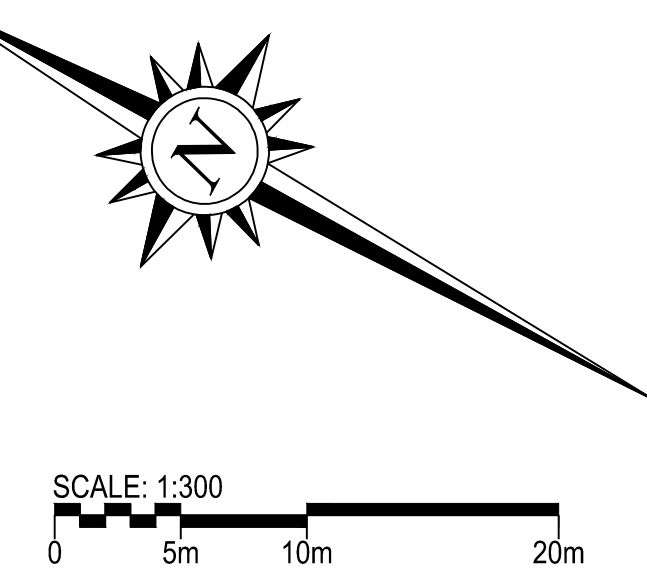

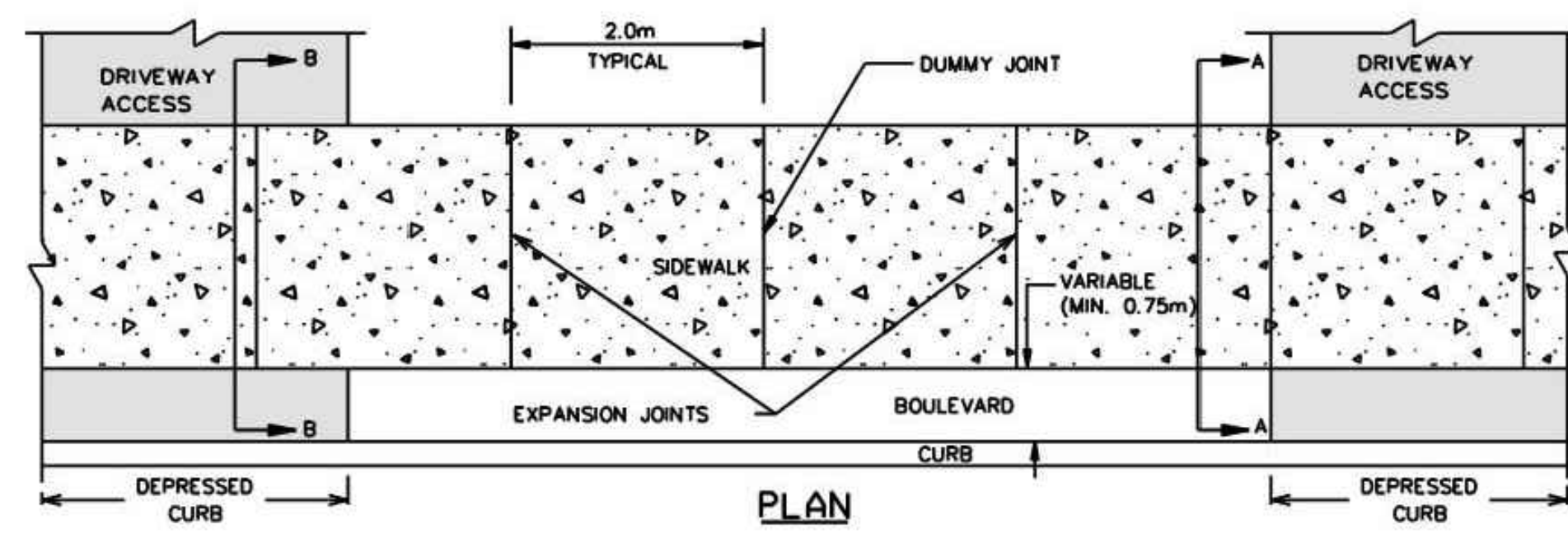
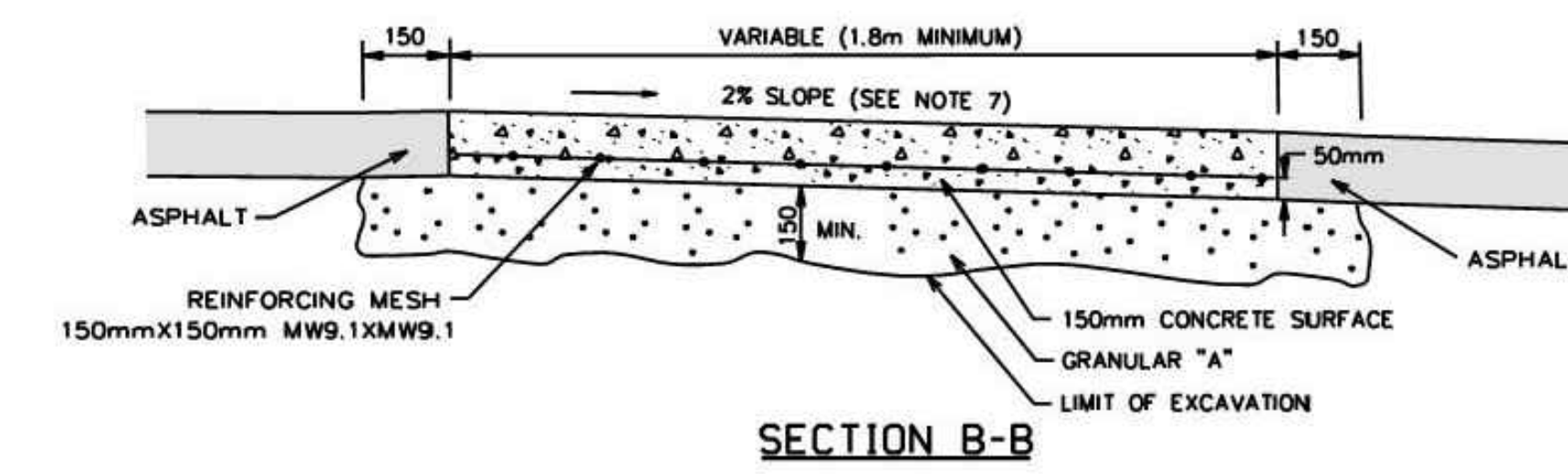
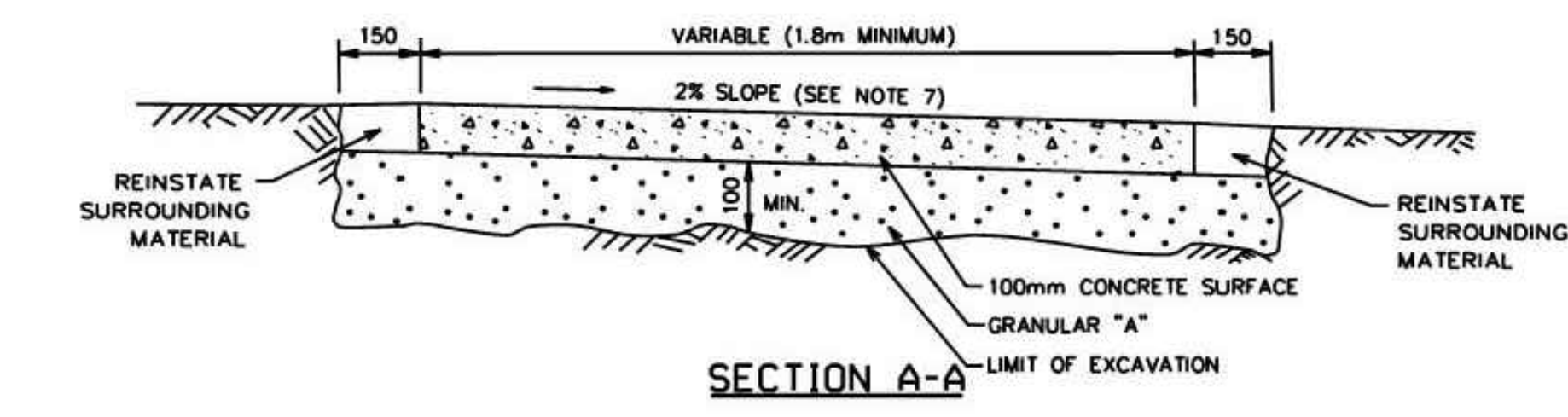

- NOTES:
1. CONCRETE AND GRANULAR "A" IS TO BE INCREASED TO 150mm AT THE ENTRANCE AND 150x150mm MW9.1 x MW9.1 REINFORCING MESH IS TO BE PLACED MID DEPTH WITHIN DRIVEWAY ACCESS.
 2. TRANSVERSE EXPANSION JOINTS ARE REQUIRED AT THE ENDS, THE MIDPOINT, AT INTERVALS OF 4m MAXIMUM, AND ALSO TO ISOLATE OBSTRUCTIONS FROM SIDEWALK, HYDRANTS, POLES, BUILDINGS, ETC.
 3. WHEN THE OVERALL SIDEWALK WIDTH EXCEEDS 2.5m, A LONGITUDINAL CONSTRUCTION JOINT SHALL BE CREATED AT ITS MIDPOINT.
 4. EDGES AND JOINTS ARE TO BE FINISHED WITH A 75mm EDGING TOOL.
 5. ALL CONCRETE SIDEWALKS ARE TO HAVE A BROOM FINISH UNLESS OTHERWISE SPECIFIED.
 6. ALL DIMENSIONS ARE IN MILLIMETRES UNLESS SHOWN OTHERWISE.
 7. THE MAXIMUM SLOPE IS NOT TO EXCEED 2%.
 8. INSTALL DUMMY TRANSVERSE JOINTS AS REQUIRED SO THERE IS A MAXIMUM SPACING OF 2m BETWEEN ALL JOINTS.
 9. SIDEWALK NOT TO BE DEPRESSED ACROSS DRIVEWAY ACCESSES.
 10. EXPANSION AND DUMMY JOINTS AS PER SCS

1 CONCRETE SIDEWALK TYPICAL
 DETAIL SCALE: NOT TO SCALE

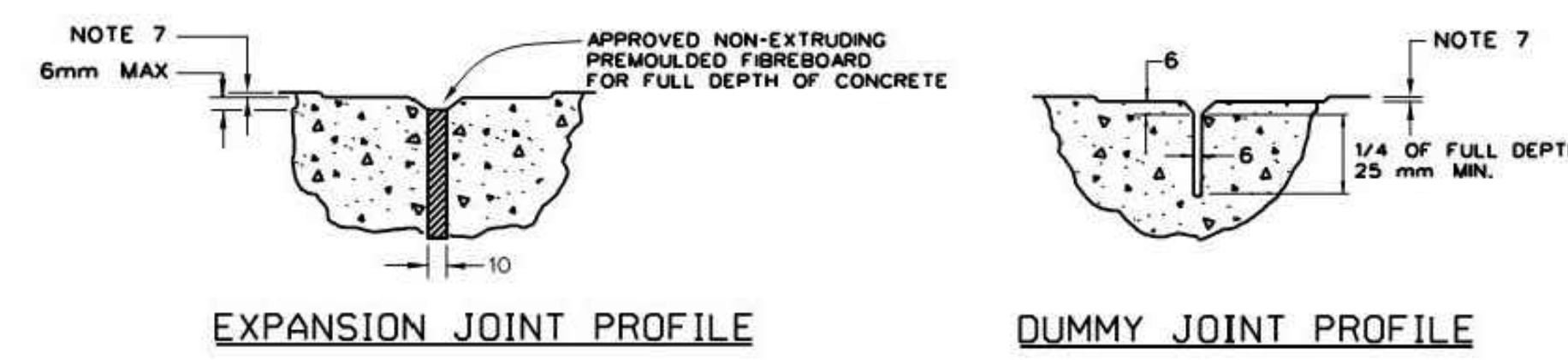
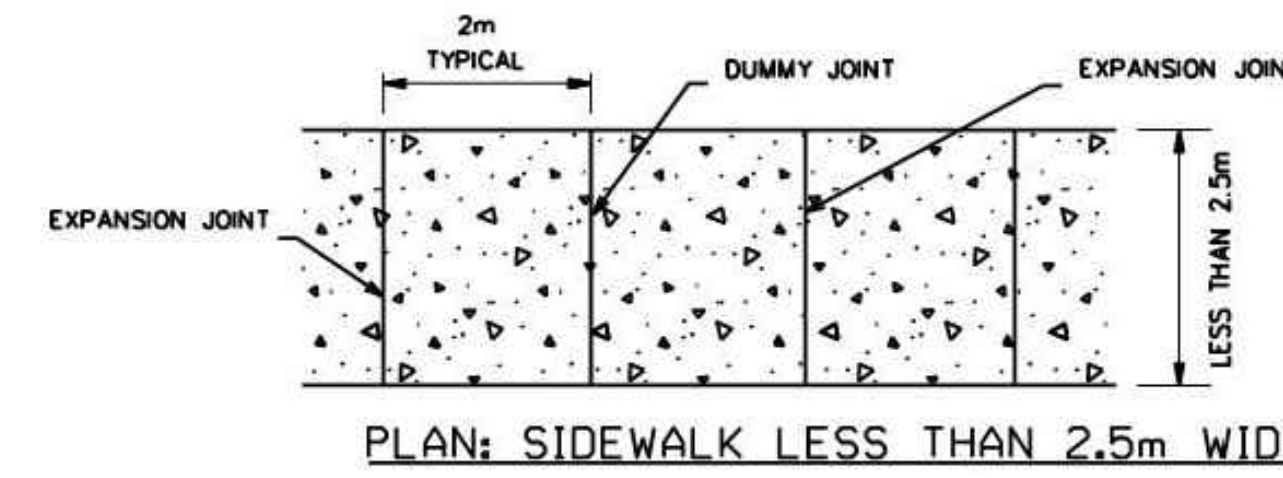
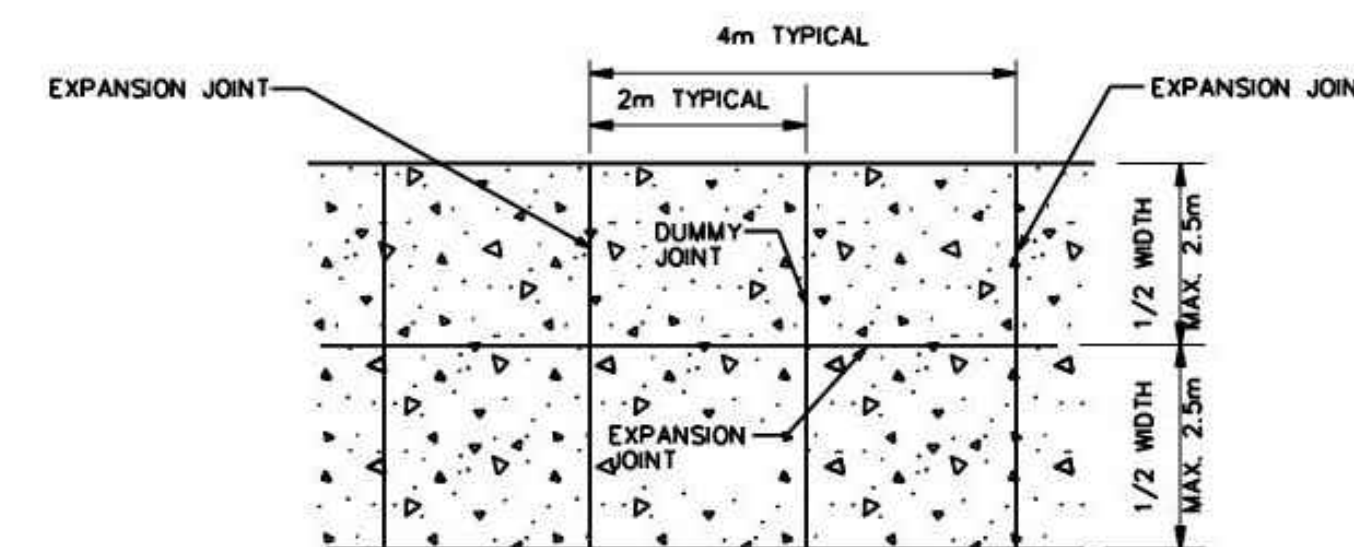

- NOTES:
1. EXPANSION JOINTS IN SIDEWALK SHALL BE IN LINE WITH EXPANSION JOINTS IN CURB.
 2. TRANSVERSE EXPANSION JOINTS ARE REQUIRED AT THE ENDS, THE MIDPOINT, AT INTERVALS OF 4m MAXIMUM, AND ALSO TO ISOLATE OBSTRUCTIONS FROM SIDEWALK, HYDRANTS, POLES, BUILDINGS, ETC.
 3. EDGES AND JOINTS ARE TO BE FINISHED WITH A 75mm EDGING TOOL.
 4. ALL CONCRETE SIDEWALKS ARE TO HAVE A BROOM FINISH UNLESS OTHERWISE SPECIFIED.
 5. ALL DIMENSIONS ARE IN MILLIMETRES UNLESS SHOWN OTHERWISE.
 6. INSTALL DUMMY TRANSVERSE JOINTS AS REQUIRED SO THERE IS A MAXIMUM SPACING OF 2m BETWEEN ALL JOINTS.
 7. SMOOTH ALL TOOLED EDGES TO A MAXIMUM DEPTH OF 1mm.

2 SIDEWALK CONSTRUCTION JOINTS
 DETAIL SCALE: NOT TO SCALE

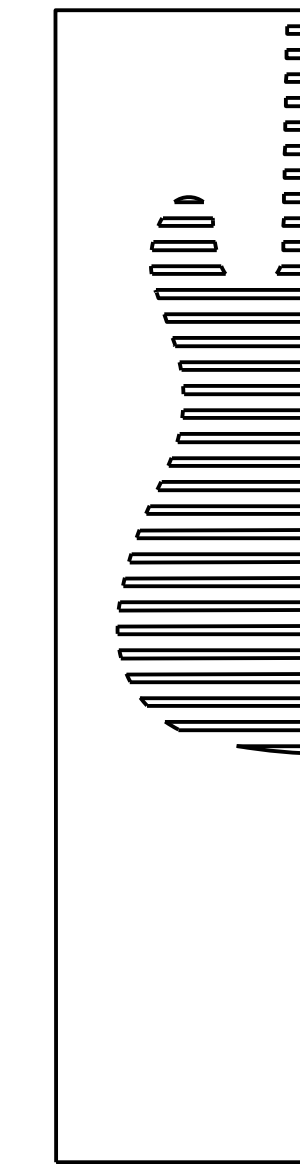

3 BRANDED HARD ROCK BOLLARD
 DETAIL SCALE: NOT TO SCALE

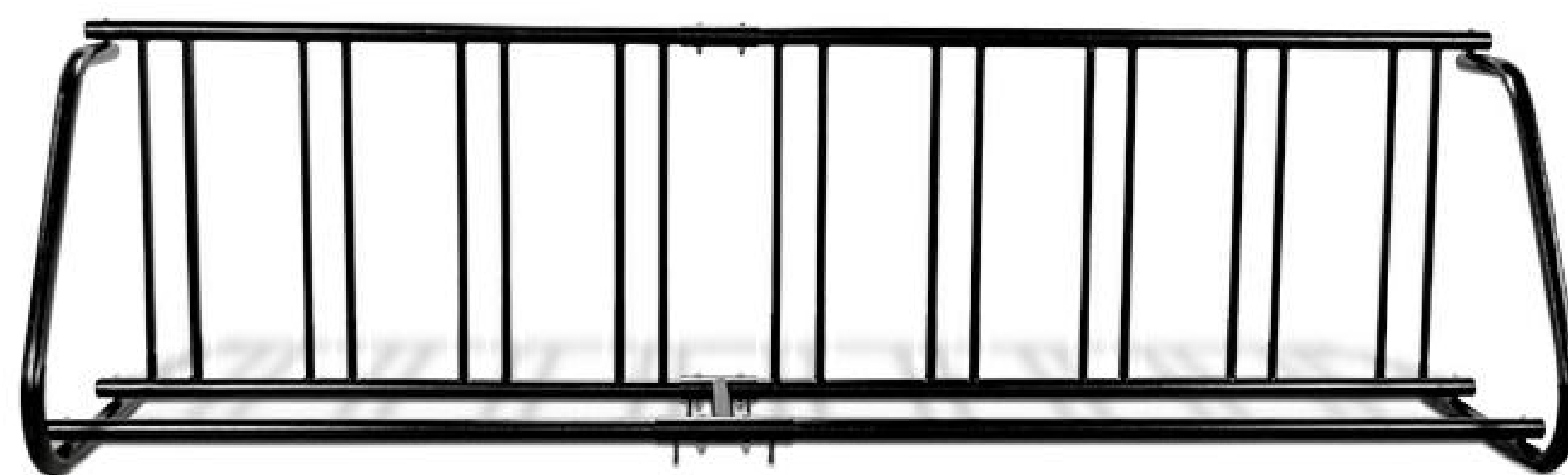

18 BIKE - SINGLE SIDED BIKE RACK
 MODEL: CBBR-18SG-BK
 AS MFG BY: BELSON OUTDOORS

4 18 BIKE - SINGLE SIDED BIKE RACK
 DETAIL SCALE: NOT TO SCALE

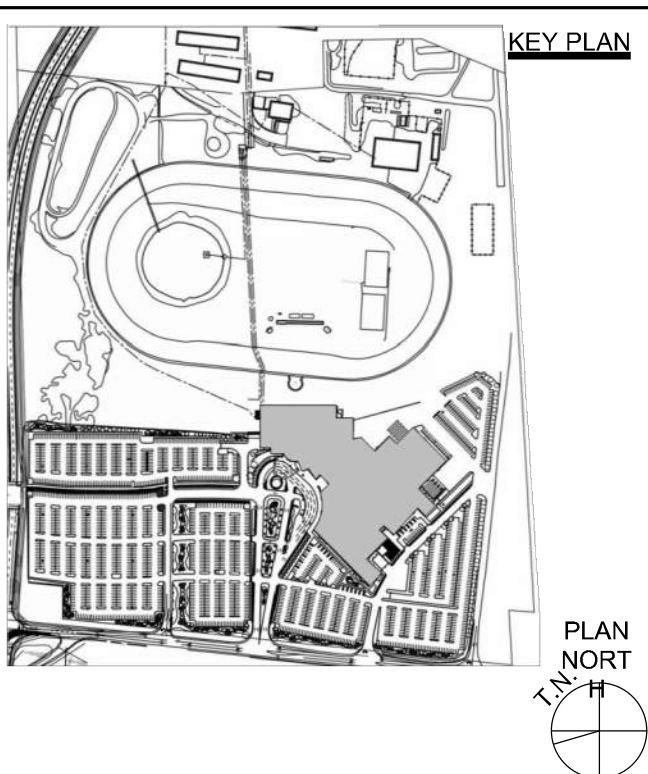

HARD ROCK HOTEL CASINO
 4837 ALBION ROAD,
 GLOUCESTER, OTTAWA,
 ON, CANADA
 4837 ALBION RD,
 GLOUCESTER, OTTAWA
 ONTARIO, CANADA

SITE PLAN AGREEMENT
 PACKAGE - 2019 11 15

SUBMISSIONS		
NO.	DATE	DESCRIPTION
△	11.20.19	REVISION 1

DRAWING TITLE:
 SITE DETAILS

DRAWN BY:	DATE:
REVIEWED BY:	11/15/2019
SCALE:	DRAWING NO.:
PROJECT NO.:	L5.01
19072.00	

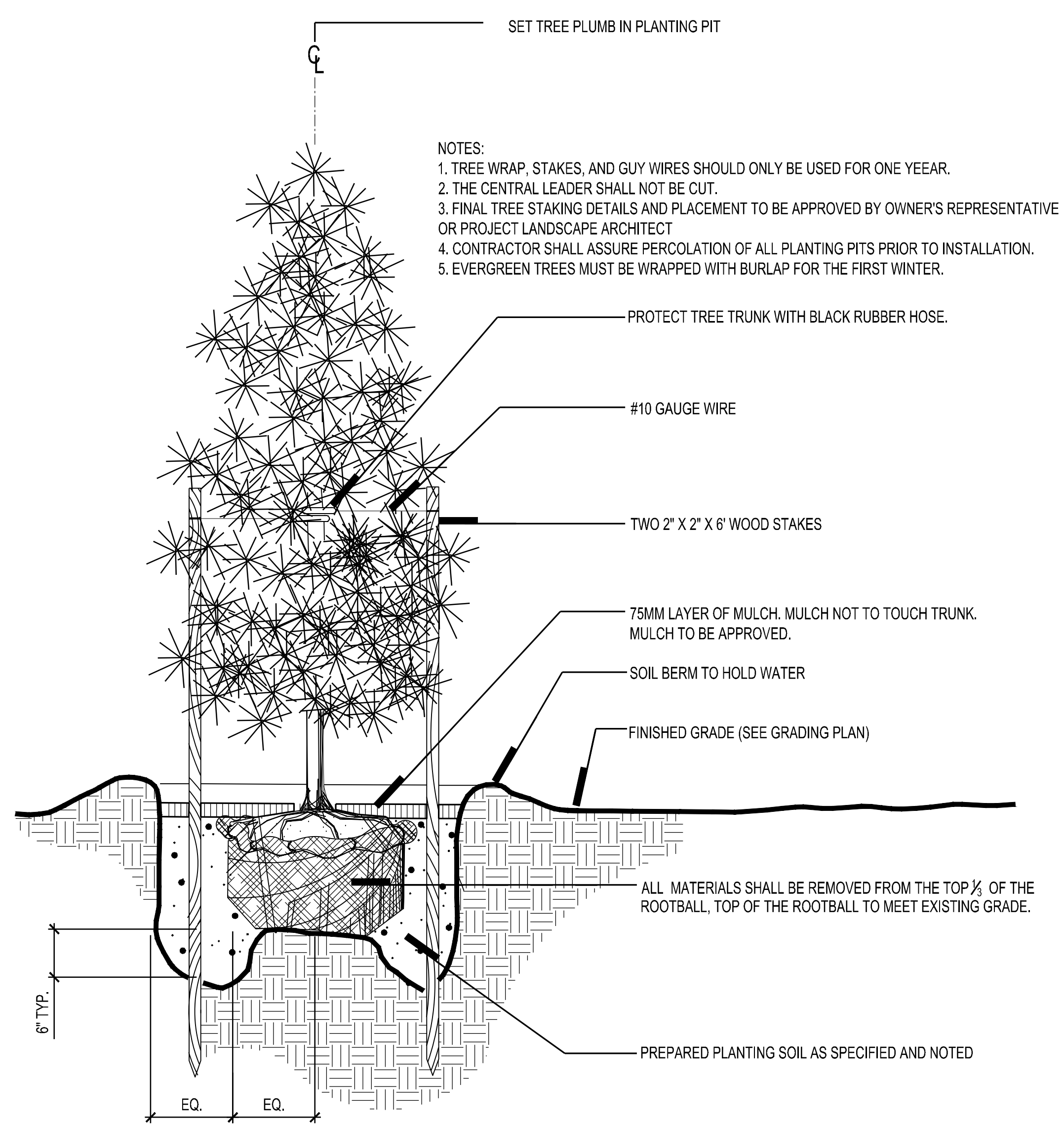

1 EVERGREEN TREE PLANTING
DETAIL

D-1058-PL-PINE.DWG
SCALE: NOT TO SCALE

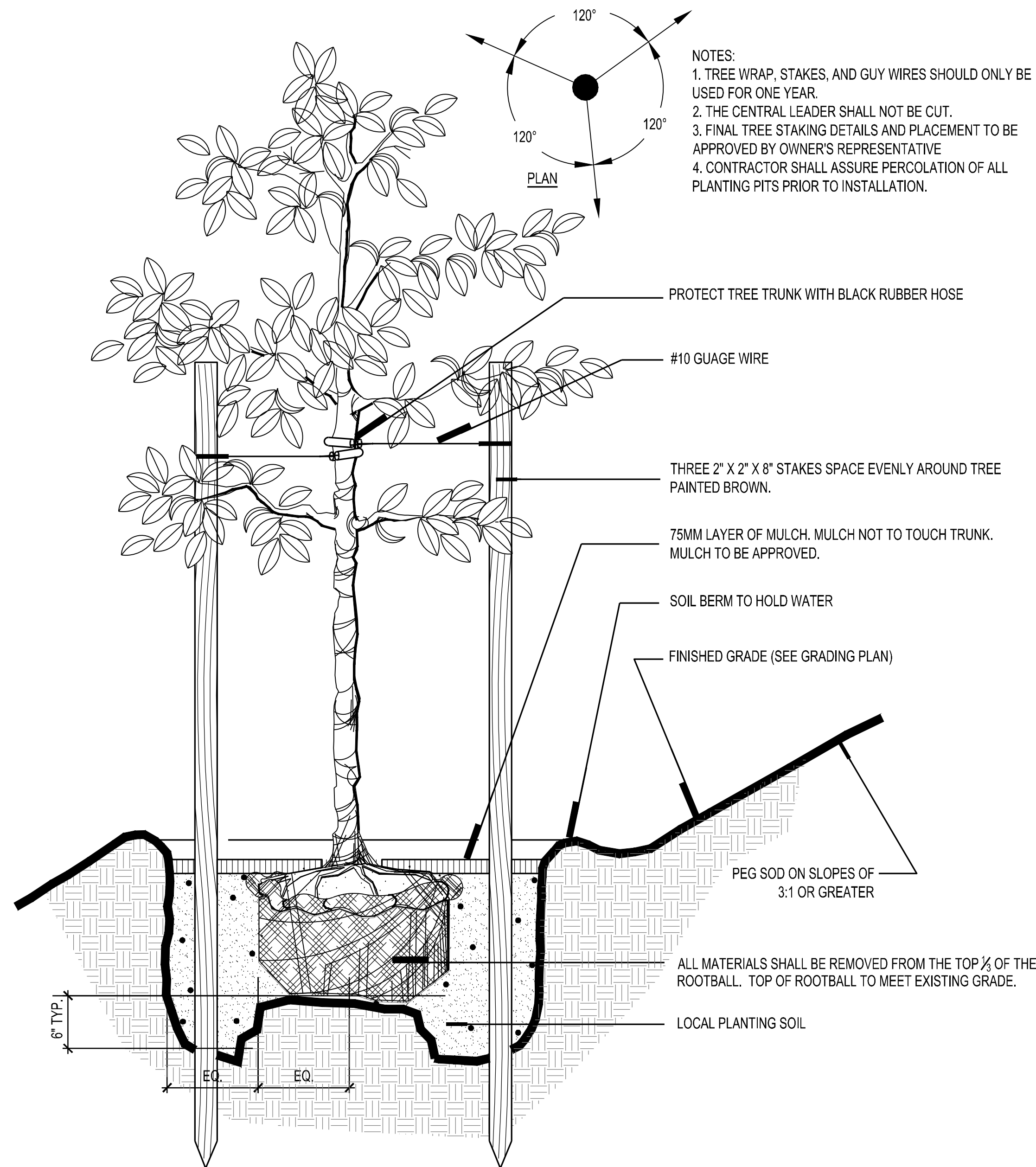

2 TREE PLANTING
DETAIL

NOT TO SCALE

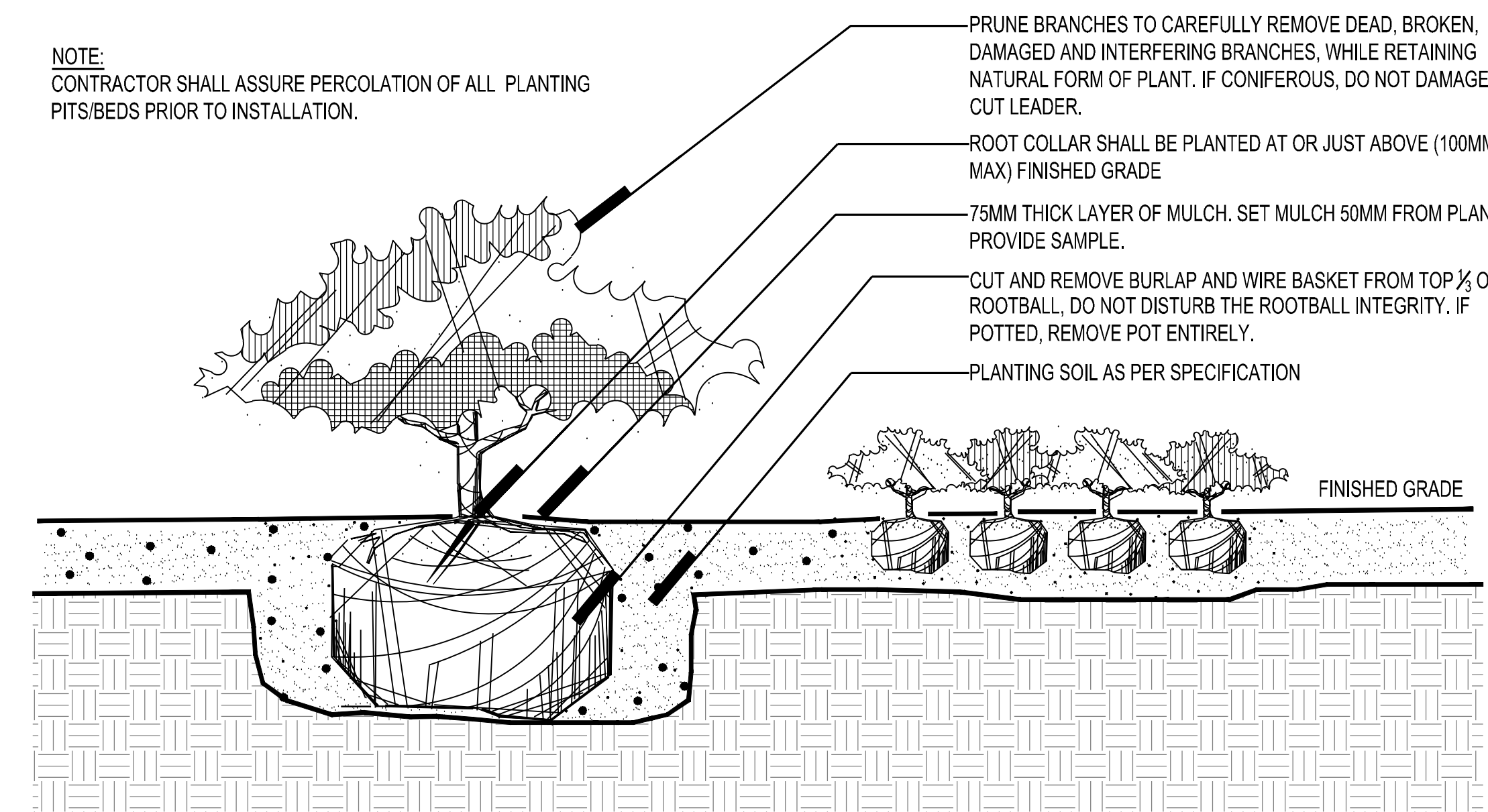

3 SHRUB PLANTING
DETAIL

SCALE: NOT TO SCALE

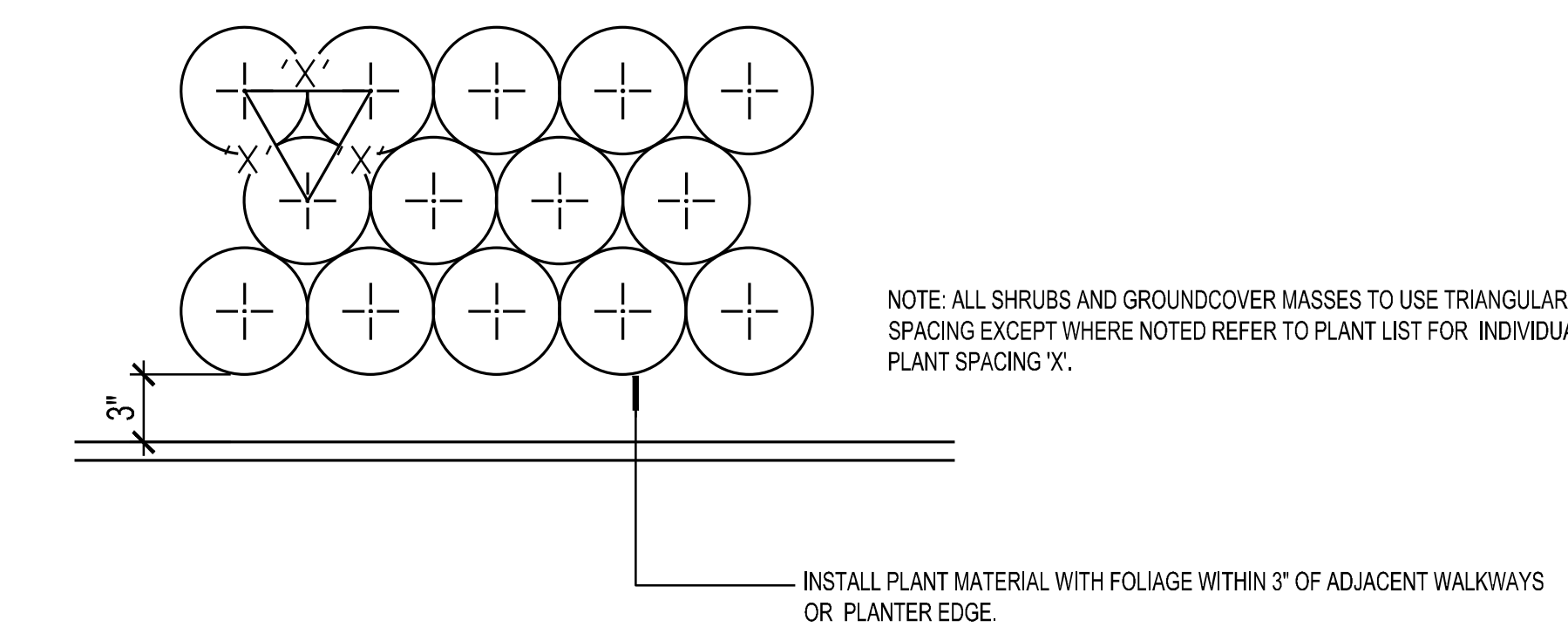

4 SHRUB & GROUNDCOVER SPACING
PLAN

NOT TO SCALE



PLANNING
LANDSCAPE ARCHITECTURE
URBAN DESIGN
INNER HARBOR CENTER
400 EAST PRATT STREET, SUITE 502
BALTIMORE, MARYLAND 21202 USA
TEL: 443.539.3350

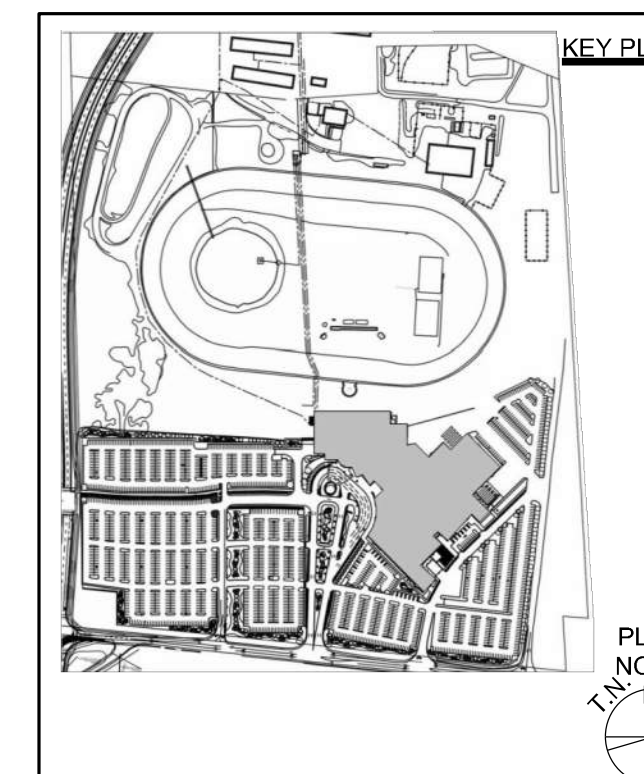

HARD ROCK HOTEL
CASINO
4837 ALBION ROAD,
GLOUCESTER, OTTAWA,
ON, CANADA
4837 ALBION RD,
GLOUCESTER, OTTAWA
ONTARIO, CANADA

SITE PLAN AGREEMENT
PACKAGE - 2019 11 15

SUBMISSIONS

NO.	DATE	REVISION	DESCRIPTION
Δ	11.20.19	REVISION 1	

DRAWING TITLE:
LANDSCAPE DETAILS

DRAWN BY: DATE:
REVIEWED BY: 11/15/2019
SCALE: DRAWING NO.
PROJECT NO. 19072.00 L5.02