

LEGEND	
	PROPERTY LINE
	PROPOSED CURB
	PROPOSED DEPRESSED CURB
	PROPOSED RETAINING WALL
	PROPOSED PRECAST CONCRETE CURB (C.P. S.D. 803.020)
	TACTILE WALKING SURFACE INDICATOR (TWSI) PER CITY DETAIL SCT. 3
	PROPOSED CAP
	PROPOSED CROSSWALK PAINTING
	PROPOSED PARKING PAINTING
	PROPOSED SANITARY SERVICE C/W MANHOLE
	PROPOSED STORM SEWER AND MANHOLE
	PROPOSED BUILDING ENTRANCE
	DIRECTION OF FLOW
	PROPOSED CATCHBASIN MANHOLE
	PROPOSED INLET CONTROL DEVICE
	PROPOSED CATCHBASIN
	PROPOSED UNDERGROUND STORAGE WITH GEOTEXTILE (REFER TO 116111-ND FOR DETAILS)
	PROPOSED UNDERGROUND STORAGE WITHOUT GEOTEXTILE (REFER TO 116111-ND FOR DETAILS)
	PROPOSED LIGHT POST FIXTURE (REFER TO ELECTRICAL/PHOTOMETRIC PLAN)
	DECORATIVE LAMP POST (REFER TO ELECTRICAL/PHOTOMETRIC PLAN)
	LIGHTING BOLLARD (REFER TO ELECTRICAL/PHOTOMETRIC PLAN)
	CONCRETE BOLLARDS
	HYDRO TRANSFORMER (REFER TO ELECTRICAL PLAN)
	GENERATOR (REFER TO ELECTRICAL PLAN)
	ELECTRICAL MANHOLE (REFER TO ELECTRICAL PLAN)
	EXISTING UTILITY POLE C/W DWT WIRES
	EXISTING WATERMAIN C/W VALVE & VALVE CHAMBER
	EXISTING HYDRANT C/W VALVE & LEAD
	EXISTING SANITARY MANHOLE & SEWER
	EXISTING SANITARY FORCEMAIN
	EXISTING STORM MANHOLE & SEWER
	EXISTING CATCHBASIN
	EXISTING INFILTRATION CHAMBERS
	EXISTING GAS MAIN
	EXISTING OVERHEAD WIRES
	EXISTING BELL LINE
	EXISTING HYDRO
	EXISTING STREETLIGHT POWER SUPPLY
	EXISTING STREETLIGHT
	EXISTING PARKING LOT SIGNAGE

FUTURE EARL ARMSTRONG EXTENSION

ALBION RD.

Allamlin

ALLISON HAMLIN
MANAGER (A), DEVELOPMENT REVIEW WEST
PLANNING, REAL ESTATE & ECONOMIC DEVELOPMENT
DEPARTMENT, CITY OF OTTAWA

APPROVED
By Allison Hamlin at 1:11 pm, Aug 03, 2023

NOT FOR
CONSTRUCTION

NO.	REVISION	DATE	BY
7	REVISED PER CITY COMMENTS	JUN 2023	MJH
6	ISSUED FOR GMP	JUN 14 2023	MJH
5	REVISED PER CITY COMMENTS	MAR 03 23	MJH
4	DESIGN DOCUMENTS PACKAGE	NOV 15 22	MJH
3	REVISED PER CITY COMMENTS	NOV 08 22	MJH
2	REVISED PER CITY COMMENTS	APRIL 24 20	CJR
1	ISSUED FOR SITE PLAN APPROVAL	NOV 20 19	CJR

SCALE	
1:400	1:400
0 4 8 12 16	

FOR REVIEW ONLY	
CHECKED	MJH
DRAWN	CJR
CHECKED	MJH
APPROVED	CJR
BY	JLS

NOVATECH

Engineers, Planners & Landscape Architects
Suite 200, 240 Michael Copland Drive
Ottawa, Ontario, Canada K2M 1P6
Telephone: (613) 254-9643
Facsimile: (613) 254-5867
Website: www.novatech-eng.com

LOCATION	
4837 ALBION ROAD, CITY OF OTTAWA HARD ROCK OTTAWA	
DRAWING NAME	
GENERAL PLAN OF SERVICES SOUTH-WEST DEVELOPMENT	
PROJECT NO.	116111
REV	REV #7
DRAWING NO.	116111-GP1

TO BE READ IN CONJUNCTION WITH ALL OTHER DRAWINGS

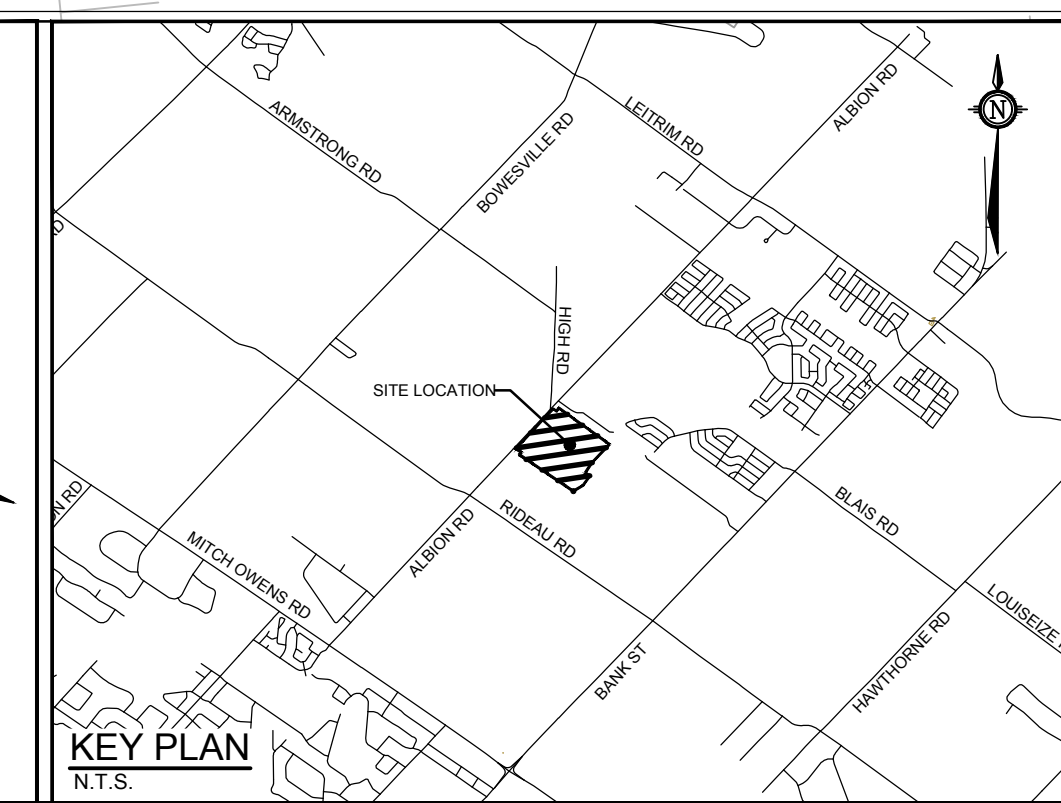

C:\001\116111\116111-GP1.dwg (GP1) - 1:400 - 2:25pm - dmmama

D07-12-19-0191 Plan No. 18864