

Item	Code	Description	Quantity	Unit	Value
1	0000	GRASS	11830	SQ	0.2500
2	0000	ASPH	11830	SQ	0.2500
3	0000	CONC	11830	SQ	0.2500
4	0000	PAV	11830	SQ	0.2500
5	0000	LAND	11830	SQ	0.2500
6	0000	WATER	11830	SQ	0.2500
7	0000	SEWER	11830	SQ	0.2500
8	0000	ELECT	11830	SQ	0.2500
9	0000	TELE	11830	SQ	0.2500
10	0000	MECH	11830	SQ	0.2500
11	0000	PLUMB	11830	SQ	0.2500
12	0000	PAINT	11830	SQ	0.2500
13	0000	FINISH	11830	SQ	0.2500
14	0000	LANDSCAPE	11830	SQ	0.2500
15	0000	CONSTRUCTION	11830	SQ	0.2500
16	0000	UTILITIES	11830	SQ	0.2500
17	0000	DEMOLITION	11830	SQ	0.2500
18	0000	ASBESTOS	11830	SQ	0.2500
19	0000	ENVIRONMENTAL	11830	SQ	0.2500
20	0000	ARCHITECTURAL	11830	SQ	0.2500
21	0000	ENGINEERING	11830	SQ	0.2500
22	0000	PERMITS	11830	SQ	0.2500
23	0000	INSURANCE	11830	SQ	0.2500
24	0000	LEGAL	11830	SQ	0.2500
25	0000	MARKETING	11830	SQ	0.2500
26	0000	OPERATIONS	11830	SQ	0.2500
27	0000	MAINTENANCE	11830	SQ	0.2500
28	0000	REPAIRS	11830	SQ	0.2500
29	0000	RENOVATIONS	11830	SQ	0.2500
30	0000	EXPANSIONS	11830	SQ	0.2500

Item	Code	Description	Quantity	Unit	Value
1	0000	GRASS	11830	SQ	0.2500
2	0000	ASPH	11830	SQ	0.2500
3	0000	CONC	11830	SQ	0.2500
4	0000	PAV	11830	SQ	0.2500
5	0000	LAND	11830	SQ	0.2500
6	0000	WATER	11830	SQ	0.2500
7	0000	SEWER	11830	SQ	0.2500
8	0000	ELECT	11830	SQ	0.2500
9	0000	TELE	11830	SQ	0.2500
10	0000	MECH	11830	SQ	0.2500
11	0000	PLUMB	11830	SQ	0.2500
12	0000	PAINT	11830	SQ	0.2500
13	0000	FINISH	11830	SQ	0.2500
14	0000	LANDSCAPE	11830	SQ	0.2500
15	0000	CONSTRUCTION	11830	SQ	0.2500
16	0000	UTILITIES	11830	SQ	0.2500
17	0000	DEMOLITION	11830	SQ	0.2500
18	0000	ASBESTOS	11830	SQ	0.2500
19	0000	ENVIRONMENTAL	11830	SQ	0.2500
20	0000	ARCHITECTURAL	11830	SQ	0.2500
21	0000	ENGINEERING	11830	SQ	0.2500
22	0000	PERMITS	11830	SQ	0.2500
23	0000	INSURANCE	11830	SQ	0.2500
24	0000	LEGAL	11830	SQ	0.2500
25	0000	MARKETING	11830	SQ	0.2500
26	0000	OPERATIONS	11830	SQ	0.2500
27	0000	MAINTENANCE	11830	SQ	0.2500
28	0000	REPAIRS	11830	SQ	0.2500
29	0000	RENOVATIONS	11830	SQ	0.2500
30	0000	EXPANSIONS	11830	SQ	0.2500

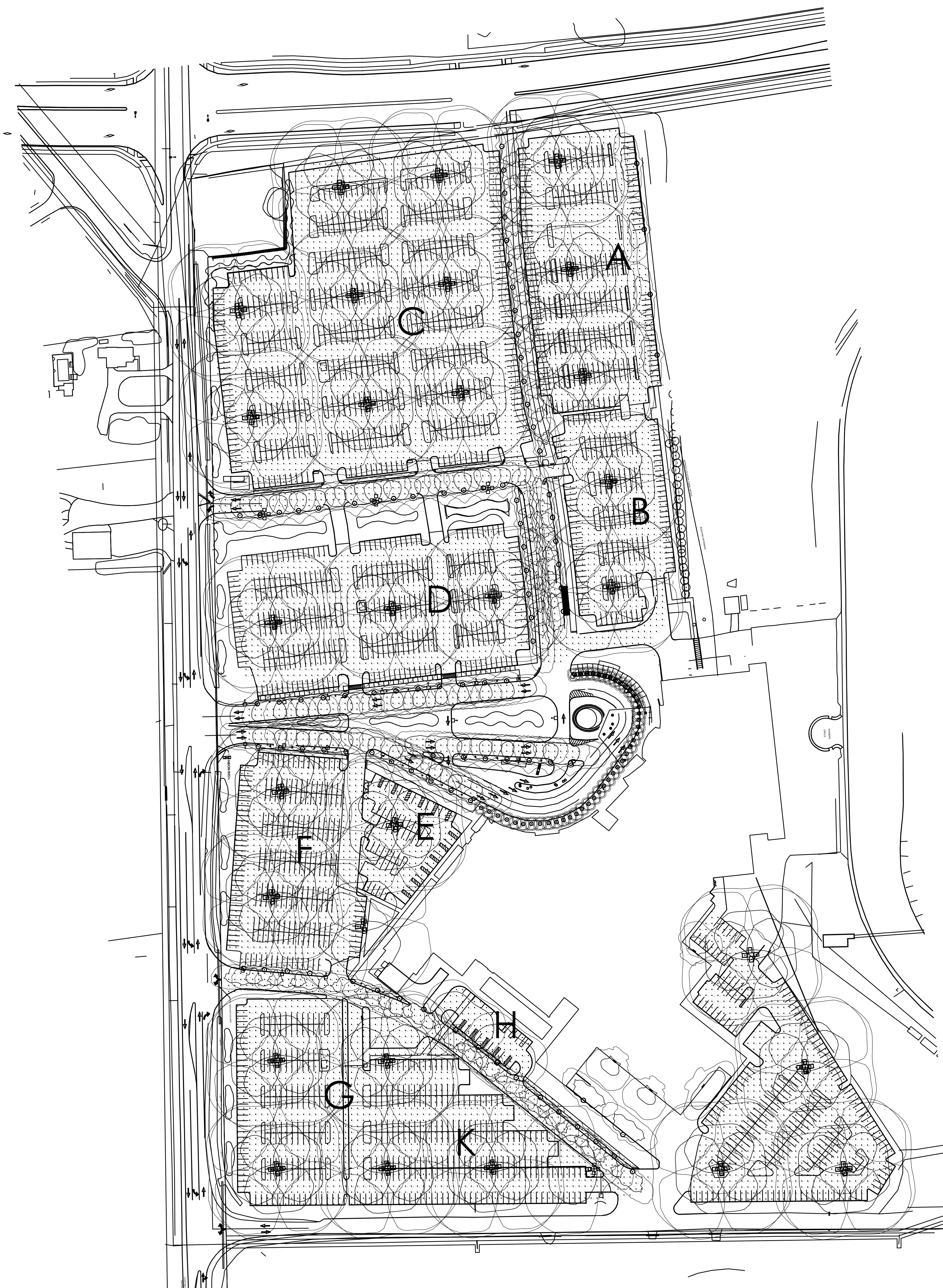

Allison Hamlin

ALLISON HAMLIN
MANAGER (A), DEVELOPMENT REVIEW WEST
PLANNING, REAL ESTATE & ECONOMIC DEVELOPMENT
DEPARTMENT, CITY OF OTTAWA

APPROVED
 By Allison Hamlin at 1:23 pm, Aug 03, 2023

SNC-LAVALIN
 Buildings Ontario, Central Canada
 Engineering, Design and Project Management
 2140 Regent St. South Unit 12A
 Sudbury, Ontario Tel: 705-675-6881
 Canada P3E 5S8

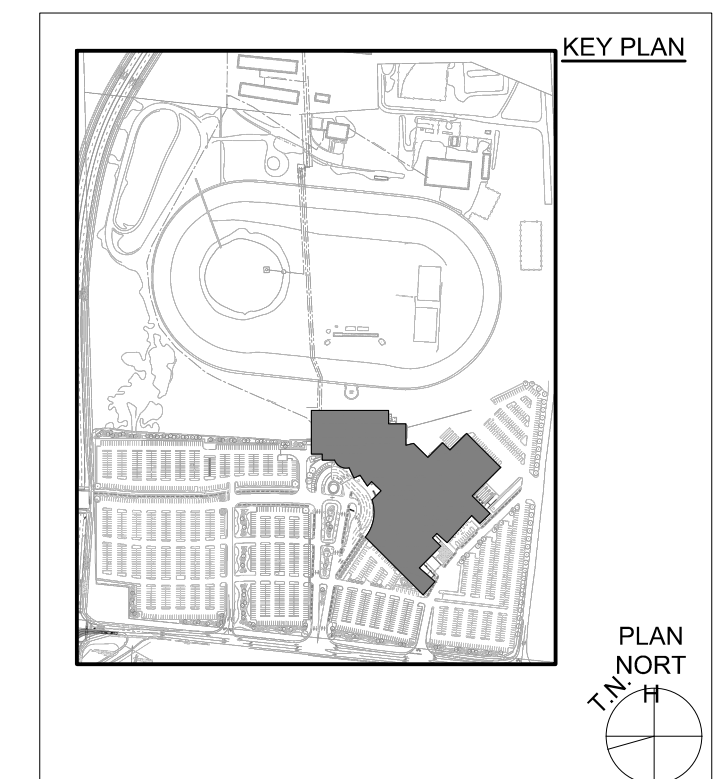

Hard Rock
CASINO

HARD ROCK HOTEL
CASINO
 4837 ALBION ROAD,
 GLOUCESTER, OTTAWA,
 ON, CANADA
 4837 ALBION RD,
 GLOUCESTER, OTTAWA
 ONTARIO, CANADA

REVISED PER CITY COMMENTS

SUBMISSIONS		
NO.	DATE	DESCRIPTION
9	July 29th 2023	REVISED PER CITY COMMENTS
8	July 14th 2023	ISSUED FOR PERMIT
7	June 20th 2023	REVISED PER CITY COMMENTS
6	June 14th 2023	ISSUED FOR GMP
5	March 3rd 2023	REVISED PER CITY COMMENTS
4	November 15th 2022	DESIGN DOCUMENTS PACKAGE 2022
3	November 8th 2022	REVISED PER CITY COMMENTS
2	April 24th 2020	REVISED PER CITY COMMENTS
1	November 26th 2019	ISSUED FOR SITE PLAN APPROVAL 2019

DRAWING TITLE:
SITE PLAN
LIGHTING PHOTOMETRIC

DRAWN BY: NJ **DATE:** 2022-11-04
REVIEWED BY: GP

SCALE: 1"=80' **DRAWING NO.:** SKE01

PROJECT NO.: 667797

FILE # : 007-12-19(0)191 PLAN # : 18654