

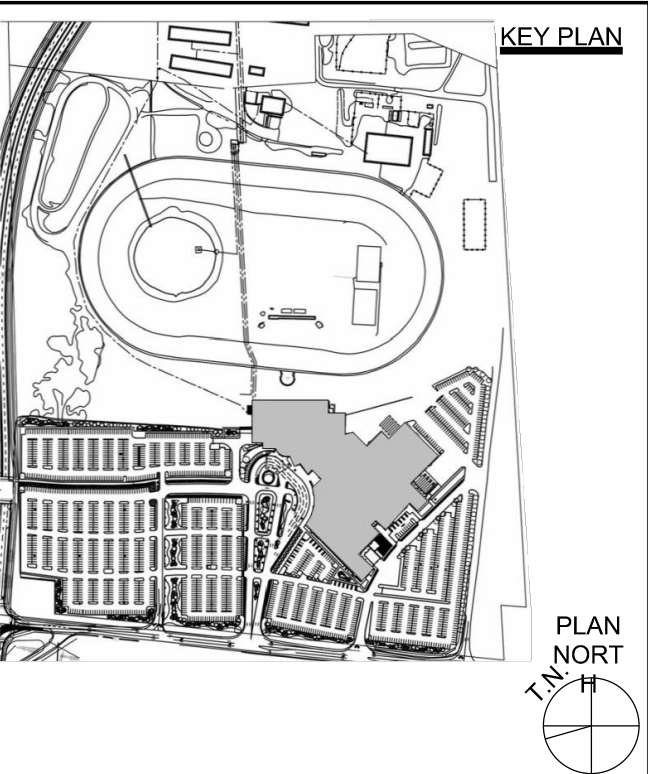

PLANNING  
 LANDSCAPE ARCHITECTURE  
 URBAN DESIGN  
 INNER HARBOR CENTER  
 400 EAST PRATT STREET, SUITE 502  
 BALTIMORE, MARYLAND 21202 USA  
 TEL: 443.539.3350



**HARD ROCK HOTEL  
 CASINO**  
 4837 ALBION ROAD,  
 GLOUCESTER, OTTAWA,  
 ON, CANADA  
4837 ALBION RD,  
 GLOUCESTER, OTTAWA,  
 ONTARIO, CANADA

SECOND SUBMISSION FOR  
 SITE PLAN AGREEMENT  
 APRIL 24, 2020

SUBMISSIONS

NO.	DATE	DESCRIPTION

DRAWING TITLE:  
**ILLUSTRATIVE PLAN**

DRAWN BY: VH	DATE:
REVIEWED BY: CAS	04/17/2020
SCALE: 1:750	DRAWING NO.:
PROJECT NO. 19072.00	<b>L0.00</b>

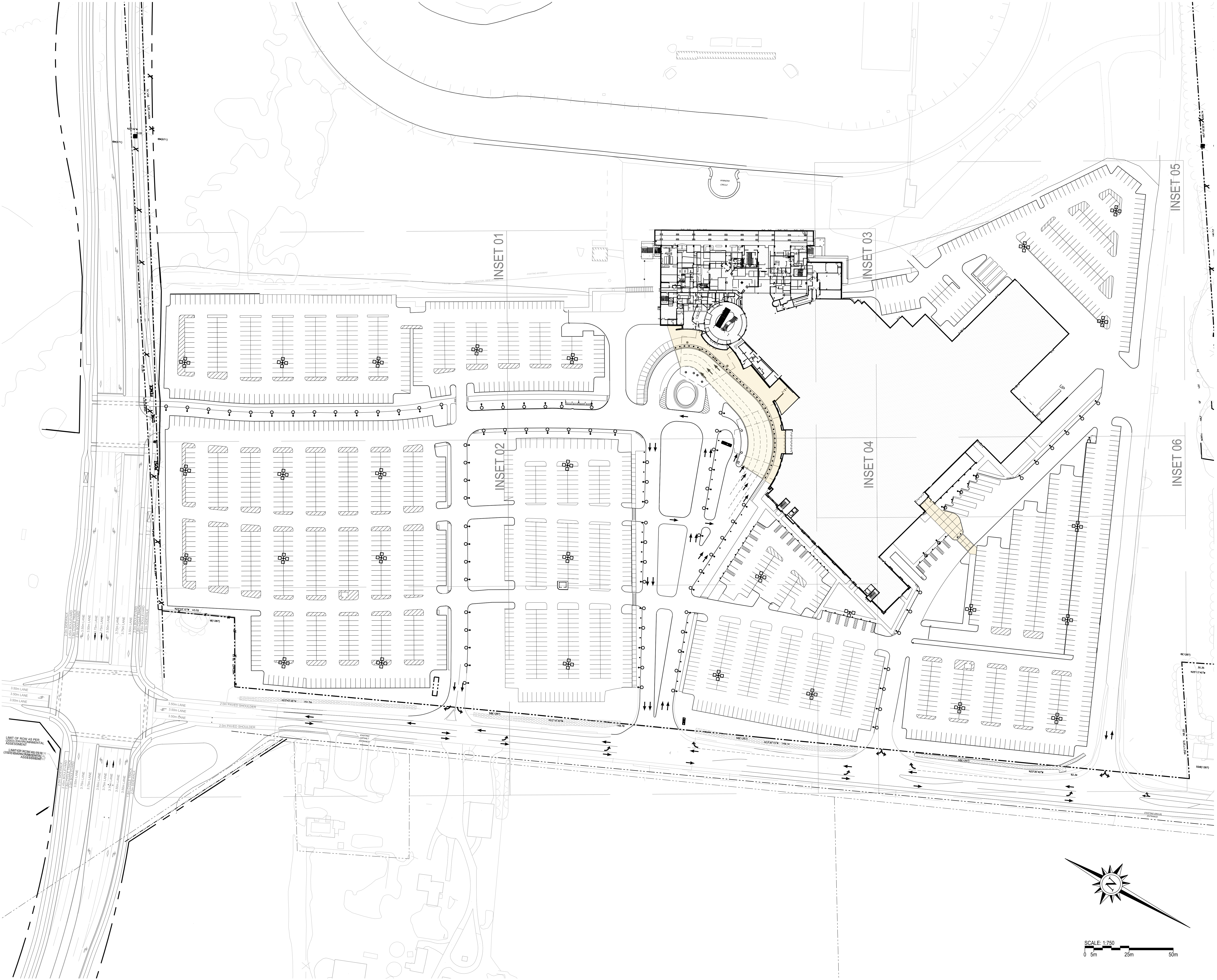

PLANNING  
LANDSCAPE ARCHITECTURE  
URBAN DESIGN  
  
INNER HARBOR CENTER  
400 EAST PRATT STREET, SUITE 502  
BALTIMORE, MARYLAND 21202 USA  
TEL: 443.539.3350

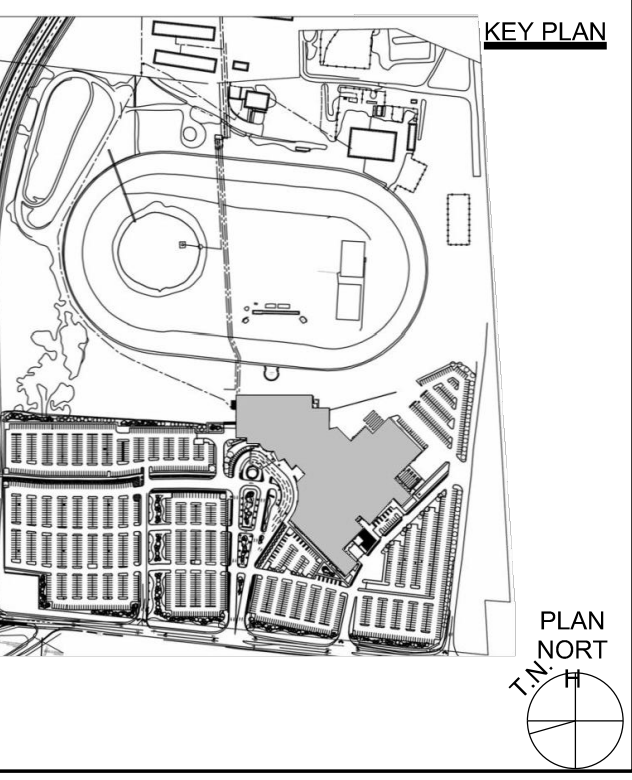

HARD ROCK HOTEL  
CASINO  
4837 ALBION ROAD,  
GLOUCESTER, OTTAWA,  
ON, CANADA  
4837 ALBION RD.  
GLOUCESTER, OTTAWA  
ONTARIO, CANADA

SECOND SUBMISSION FOR  
SITE PLAN AGREEMENT  
APRIL 24, 2020

SUBMISSIONS

NO.	DATE	DESCRIPTION

DRAWING TITLE:  
KEY PLAN

DRAWN BY: VH	DATE:
REVIEWED BY: CAS	04/17/2020
SCALE: 1:750	DRAWING NO.
PROJECT NO. 19072.00	L0.01

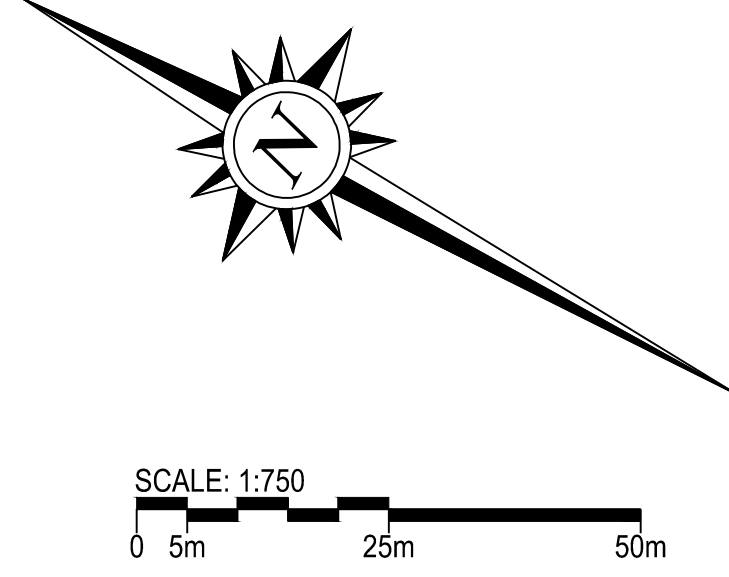





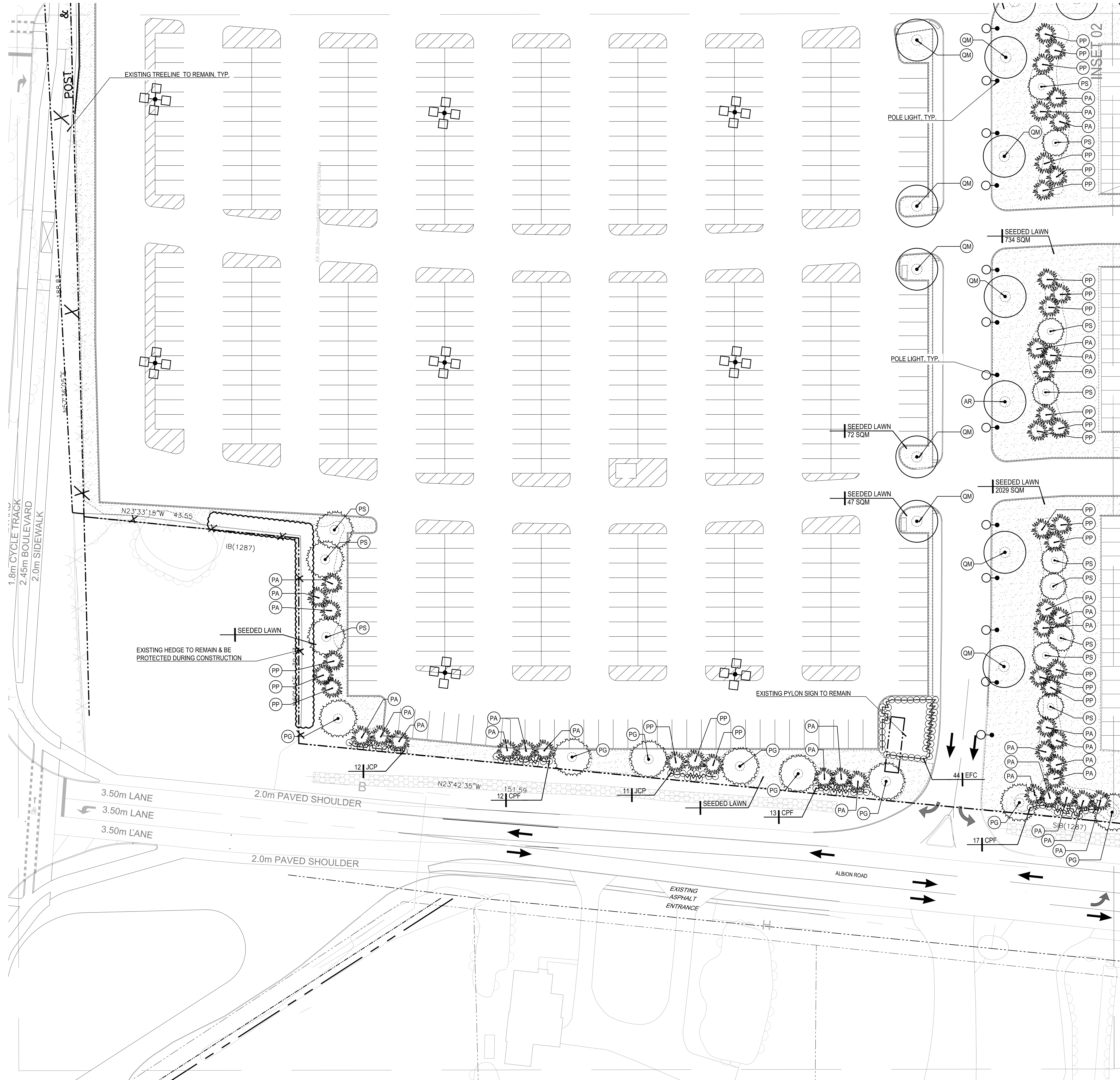

KEY	QTY	BOTANICAL NAME	COMMON NAME
<b>SHADE TREES</b>			
AR	33	Acer rubrum 'Red Sunset'	Red Sunset Red Maple
AS	24	Acer saccharum 'Green Mountain'	Green Mountain Sugar Maple
GT	15	Gleditsia tricanthos var. inermis	Shademoor Honeylocust
PS	27	Populus grandidentata	Largeleaf Aspen
QM	10	Quercus macrocarpa	Bar Oak
QR	23	Quercus rubrum	Red Oak
TA	15	Tilia americana	Basswood
	147	Totals	
<b>EVERGREEN TREES</b>			
PA	61	Picea abies	Norway Spruce
PC	220	Picea abies 'Supressina'	Columnar Norway Spruce
PG	27	Picea glauca	White Spruce
PN	17	Picea nigra	Austrian Pine
PP	96	Picea pungens 'Glauc'	Colorado Blue Spruce
PS	21	Pinus strobus	White Pine
TS	16	Tsuga canadensis	Eastern Hemlock
	458	Totals	
<b>EVERGREEN SHRUBS</b>			
CPF	111	Chamaecyparis pisifera filifera	Threadleaf False Cypress
EFC	411	Euonymus fortunei 'Canadale Gold'	Canadale Gold Euonymus
EFM	78	Euonymus fortunei 'Moonshadow'	Moonshadow Euonymus
JCG	336	Juniperus communis 'Green Carpet'	Green Carpet Juniper
JCP	88	Juniperus chinensis 'Pfitzeriana Compacta'	Compact Pfitzer Juniper
JHW	305	Juniperus horizontalis 'Wilton'	Blue Rug Juniper
JBW	39	Juniperus scopulorum 'Wichita Blue'	Wichita Blue Juniper
	1257	Totals	
<b>DECIDUOUS SHRUBS</b>			
FOO	28	Forsythia ovata 'Ottawa'	Ottawa Forsythia
HPL	104	Hydrangea paniculata 'Limelight'	Limelight Hydrangea
IWJ	12	Ilex verticillata 'Jim Dandy'	Dwarf Winterberry Holly (male)
IVR	69	Ilex verticillata 'Red Sprite'	Dwarf Winterberry Holly (female)
VIB	67	Viburnum x burkwoodii	Burkwoodii Viburnum
VDB	9	Viburnum dentatum 'Blue Muffin'	Blue Muffin Viburnum
	2905	Totals	
<b>PERENNIALS / GROUNDCOVERS / GRASSES</b>			
MSG	569	Miscanthus sinensis 'Gracillimus'	Silver Maiden Grass
PAH	404	Pennisetum alopecuroides 'Hameln'	Dwarf Hameln Fountain Grass
PWH	451	Panicum virgatum 'Shenandoah'	Shenandoah Switch Grass
	4880	Totals	
<b>LAWN</b>			
		Seeded / Sodded Lawn	



PLANNING  
LANDSCAPE ARCHITECTURE  
URBAN DESIGN  
INNER HARBOR CENTER  
400 EAST PRATT STREET, SUITE 502  
BALTIMORE, MARYLAND 21202 USA  
TEL: 443.539.3350

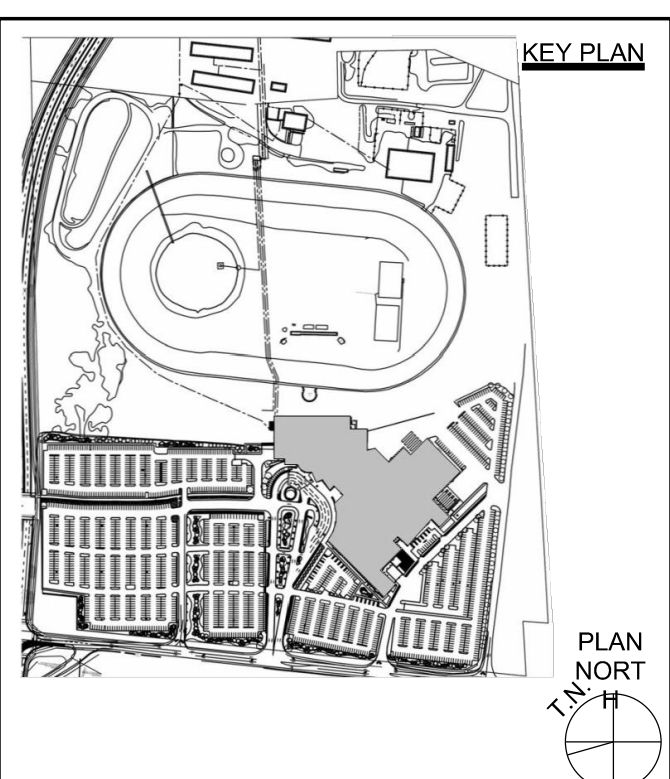

**HARD ROCK HOTEL CASINO**  
4837 ALBION ROAD,  
GLOUCESTER, OTTAWA,  
ON, CANADA  
4837 ALBION RD.  
GLOUCESTER, OTTAWA  
ONTARIO, CANADA

SECOND SUBMISSION FOR  
SITE PLAN AGREEMENT  
APRIL 24, 2020

SUBMISSIONS		
NO.	DATE	DESCRIPTION

DRAWING TITLE:  
**SITE LANDSCAPE PLAN**

DRAWN BY: VH      DATE: 04/17/2020  
REVIEWED BY: CAS

SCALE: 1:300      DRAWING NO. L1.02  
PROJECT NO. 19072.00

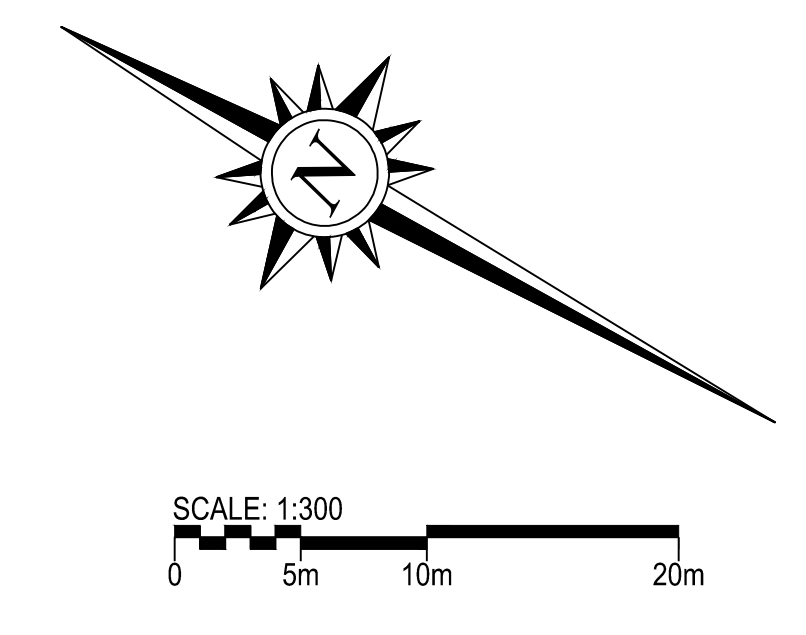





KEY	QTY	BOTANICAL NAME	COMMON NAME
<b>SHADE TREES</b>			
ZR	33	Acer rubrum 'Red Sunset'	Red Sunset Red Maple
AS	24	Acer saccharum 'Green Mountain'	Green Mountain Sugar Maple
GT	15	Gleditsia triacanthos var. inermis 'Shademaster'	Shademaster Honeylocust
PG	27	Populus grandidentata	Largeleaf Aspen
OM	10	Quercus macrocarpa	Bur Oak
GR	23	Quercus rubrum	Red Oak
TA	15	Tilia americana	Basswood
	147	Totals	
<b>EVERGREEN TREES</b>			
PA	61	Picea abies	Norway Spruce
PC	220	Picea abies 'Supressina'	Columnar Norway Spruce
PG	27	Picea glauca	White Spruce
PN	17	Picea nigra	Austrian Pine
PP	96	Picea pungens 'Glauca'	Colorado Blue Spruce
PS	21	Pinus strobus	White Pine
TS	16	Tsuga canadensis	Eastern Hemlock
	458	Totals	
<b>EVERGREEN SHRUBS</b>			
CPF	111	Chamaecyparis pisifera filifera	Threadleaf False Cypress
EFC	411	Euonymus fortunei 'Canadale Gold'	Canadale Gold Euonymus
EFM	78	Euonymus fortunei 'Moonshadow'	Moonshadow Euonymus
JCG	336	Juniperus communis 'Green Carpet'	Green Carpet Juniper
JCP	88	Juniperus chinensis 'Pfitzeriana Compacta'	Compact Pfitzer Juniper
JHW	305	Juniperus horizontalis 'Wilsoni'	Blue Rug Juniper
JSW	39	Juniperus scopulorum 'Wichita Blue'	Wichita Blue Juniper
	1257	Totals	
<b>DECIDUOUS SHRUBS</b>			
FOO	28	Forsythia ovata 'Ottawa'	Ottawa Forsythia
HPL	104	Hydrangea paniculata 'Limelight'	Limelight Hydrangea
IVJ	12	Ilex verticillata 'Jim Dandy'	Dwarf Winterberry Holly (male)
IVR	69	Ilex verticillata 'Red Sprite'	Dwarf Winterberry Holly (female)
VIB	67	Viburnum x burkwoodii	Burkwoodi Viburnum
VDB	9	Viburnum dentatum 'Blue Muffin'	Blue Muffin Viburnum
	2905	Totals	
<b>PERENNIALS / GROUNDCOVERS / GRASSES</b>			
MSG	569	Miscanthus sinensis 'Gracillimus'	Silver Maiden Grass
PAH	404	Pennisetum ssp. 'Hammer'	Dwarf Hameln Fountain Grass
PVH	451	Panicum virgatum 'Shenandoah'	Shenandoah Switch Grass
	4680	Totals	
<b>LAWN</b>			
	2905	Seeded / Sodded Lawn	



PLANNING  
LANDSCAPE ARCHITECTURE  
URBAN DESIGN  
  
INNER HARBOR CENTER  
400 EAST PRATT STREET, SUITE 502  
BALTIMORE, MARYLAND 21202 USA  
TEL: 443.539.3350

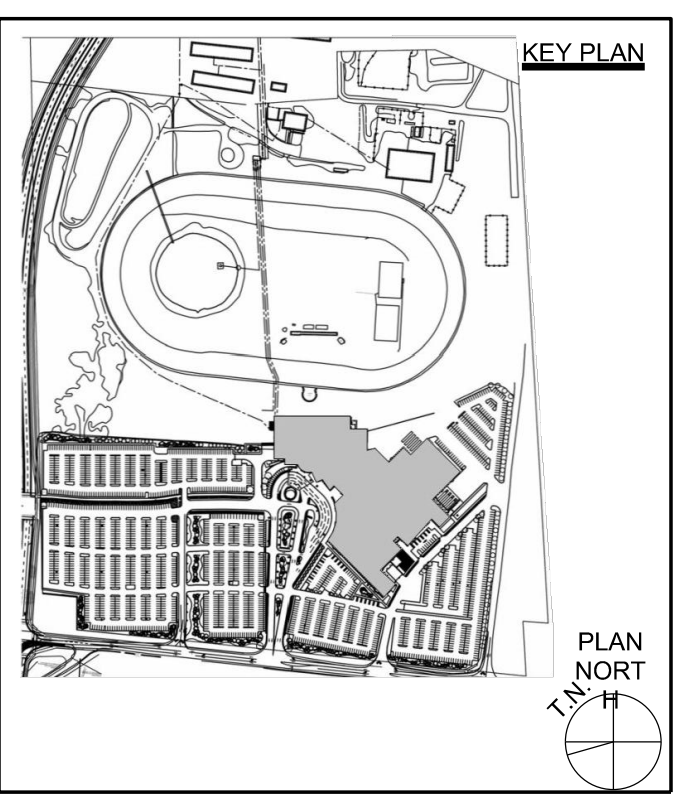

**Hard Rock CASINO**

**HARD ROCK HOTEL CASINO**  
4837 ALBION ROAD,  
GLOUCESTER, OTTAWA,  
ON, CANADA

4837 ALBION RD,  
GLOUCESTER, OTTAWA  
ONTARIO, CANADA

SECOND SUBMISSION FOR  
SITE PLAN AGREEMENT  
APRIL 24, 2020

SUBMISSIONS		
NO.	DATE	DESCRIPTION

DRAWING TITLE:  
**SITE LANDSCAPE PLAN**

DRAWN BY: VH	DATE: 04/17/2020
REVIEWED BY: CAS	DRAWING NO. 1:300
SCALE: 1:300	PROJECT NO. 19072.00
<b>L1.04</b>	

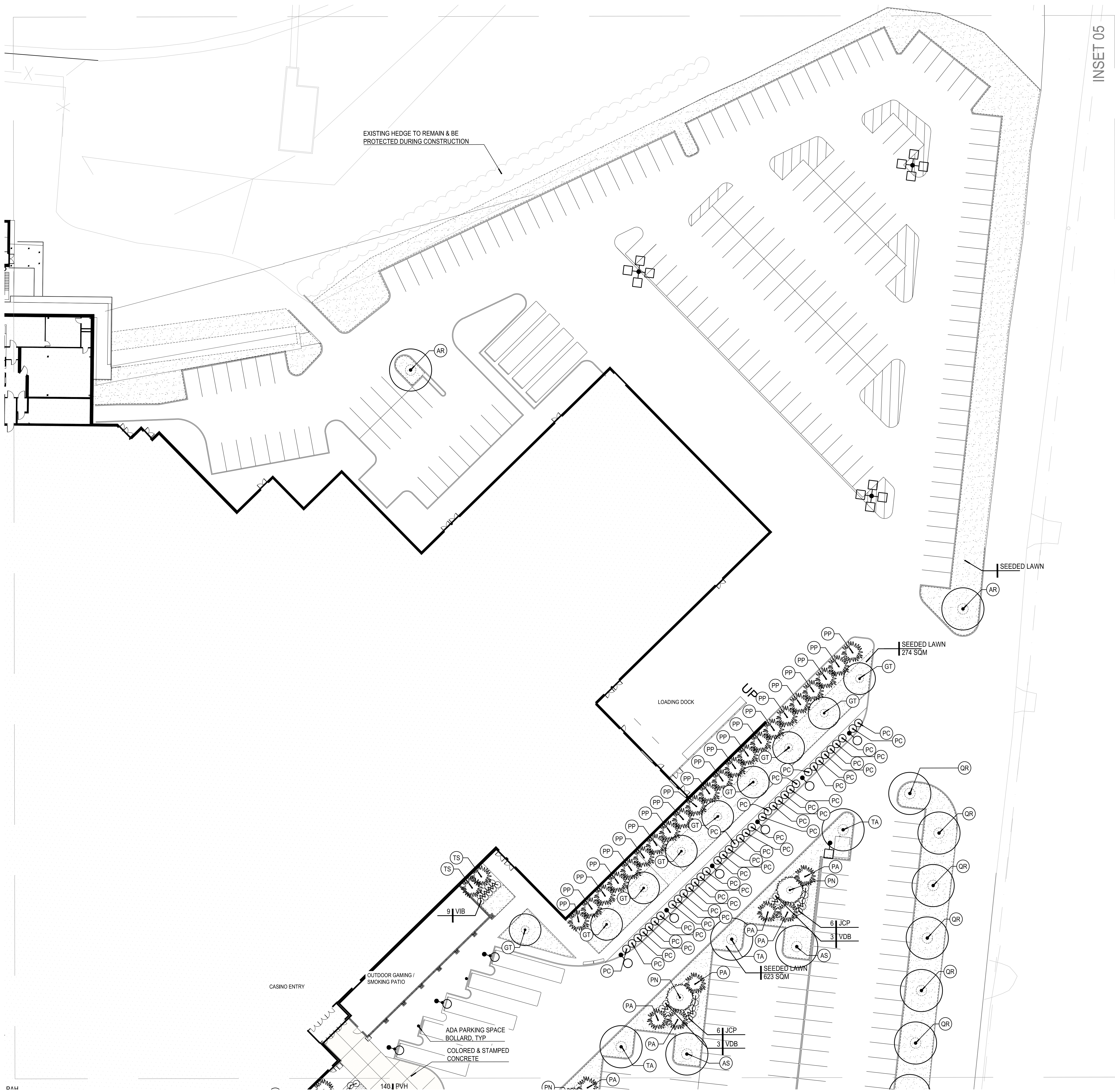

INSET 05

KEY	QTY	BOTANICAL NAME	COMMON NAME
<b>SHADE TREES</b>			
AR	33	Acer rubrum 'Red Sunset'	Red Sunset Red Maple
AS	24	Acer saccharum 'Green Mountain'	Green Mountain Sugar Maple
GT	15	Gleditsia tricanthos var. Inermis 'Shademaster'	Shademaster Honeylocust
FG	27	Populus grandidentata	Largeleaf Aspen
QM	10	Quercus macrocarpa	Bur Oak
GR	23	Quercus rubrum	Red Oak
TA	15	Tilia americana	Basswood
147		Totals	
<b>EVERGREEN TREES</b>			
PA	61	Picea abies	Norway Spruce
PC	220	Picea abies 'Supressina'	Columnar Norway Spruce
PG	27	Picea glauca	White Spruce
PN	17	Picea nigra	Austrian Pine
PP	96	Picea pungens 'Glauca'	Colorado Blue Spruce
PS	21	Pinus strobus	White Pine
TS	16	Tsuga canadensis	Eastern Hemlock
458		Totals	
<b>EVERGREEN SHRUBS</b>			
CPE	111	Chamaecyparis pisifera filifera	Threadleaf False Cypress
EFC	411	Euonymus fortunei 'Canadale Gold'	Canadale Gold Euonymus
EFM	78	Euonymus fortunei 'Moonshadow'	Moonshadow Euonymus
JCG	336	Juniperus communis 'Green Carpet'	Green Carpet Juniper
JCP	88	Juniperus chinensis 'Pfitzeriana Compacta'	Compact Pfitzer Juniper
JHW	305	Juniperus horizontalis 'Wiltoni'	Blue Rug Juniper
JSW	39	Juniperus scopulorum 'Wichita Blue'	Wichita Blue Juniper
1257		Totals	
<b>DECIDUOUS SHRUBS</b>			
FOO	28	Forsythia ovata 'Ottawa'	Ottawa Forsythia
HPL	104	Hydrangea paniculata 'Limelight'	Limelight Hydrangea
IWJ	12	Ilex verticillata 'Jim Dandy'	Dwarf Winterberry Holly (male)
IWR	89	Ilex verticillata 'Red Sprite'	Dwarf Winterberry Holly (female)
VIB	67	Viburnum x burkwoodii	Burkwoodii Viburnum
VDB	9	Viburnum dentatum 'Blue Muffin'	Blue Muffin Viburnum
2905		Totals	
<b>PERENNIALS / GROUNDCOVERS / GRASSES</b>			
MSG	569	Miscanthus sinensis 'Gracillimus'	Silver Maiden Grass
PAW	404	Pennisetum alopecuroides 'Harrisii'	Dwarf Haircell Fountain Grass
PVH	451	Panicum virgatum 'Shenandoah'	Shenandoah Switch Grass
4880		Totals	
<b>LAWN</b>			
		Seeded / Sodded Lawn	



PLANNING  
LANDSCAPE ARCHITECTURE  
URBAN DESIGN  
INNER HARBOR CENTER  
400 EAST PRATT STREET, SUITE 502  
BALTIMORE, MARYLAND 21202 USA  
TEL: 443.539.3350

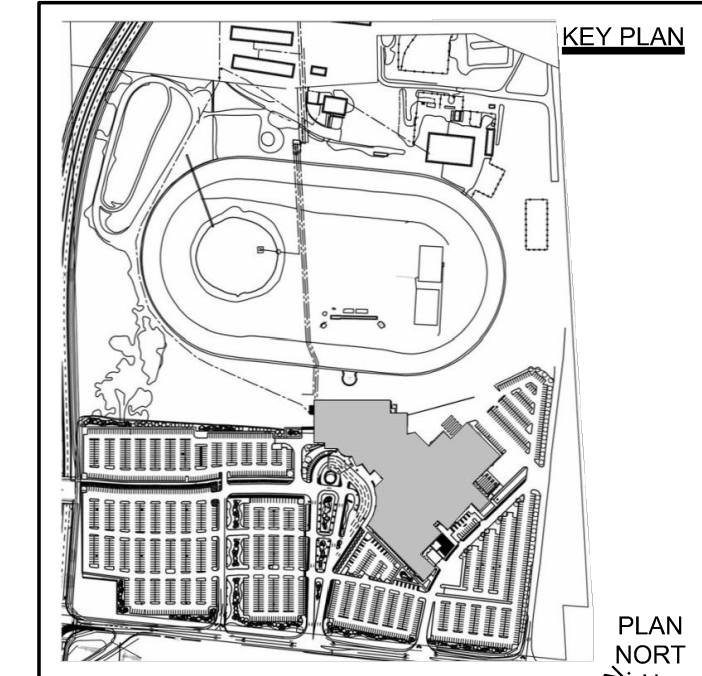

**HARD ROCK HOTEL CASINO**  
4837 ALBION ROAD,  
GLOUCESTER, OTTAWA,  
ON, CANADA  
4837 ALBION RD,  
GLOUCESTER, OTTAWA  
ONTARIO, CANADA

SECOND SUBMISSION FOR  
SITE PLAN AGREEMENT  
APRIL 24, 2020

SUBMISSIONS

NO.	DATE	DESCRIPTION

DRAWING TITLE:  
SITE LANDSCAPE PLAN

DRAWN BY: VH	DATE:
REVIEWED BY: CAS	04/17/2020
SCALE: 1:300	DRAWING NO. L1.05
PROJECT NO. 19072.00	

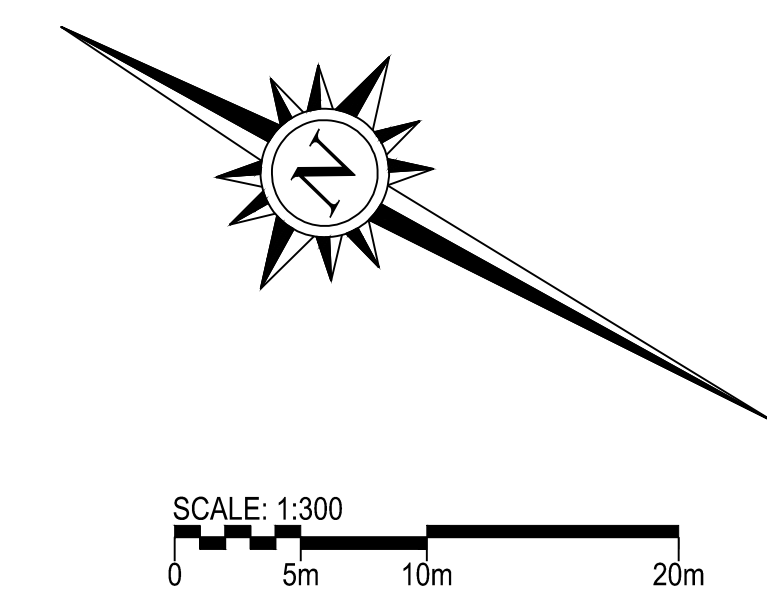





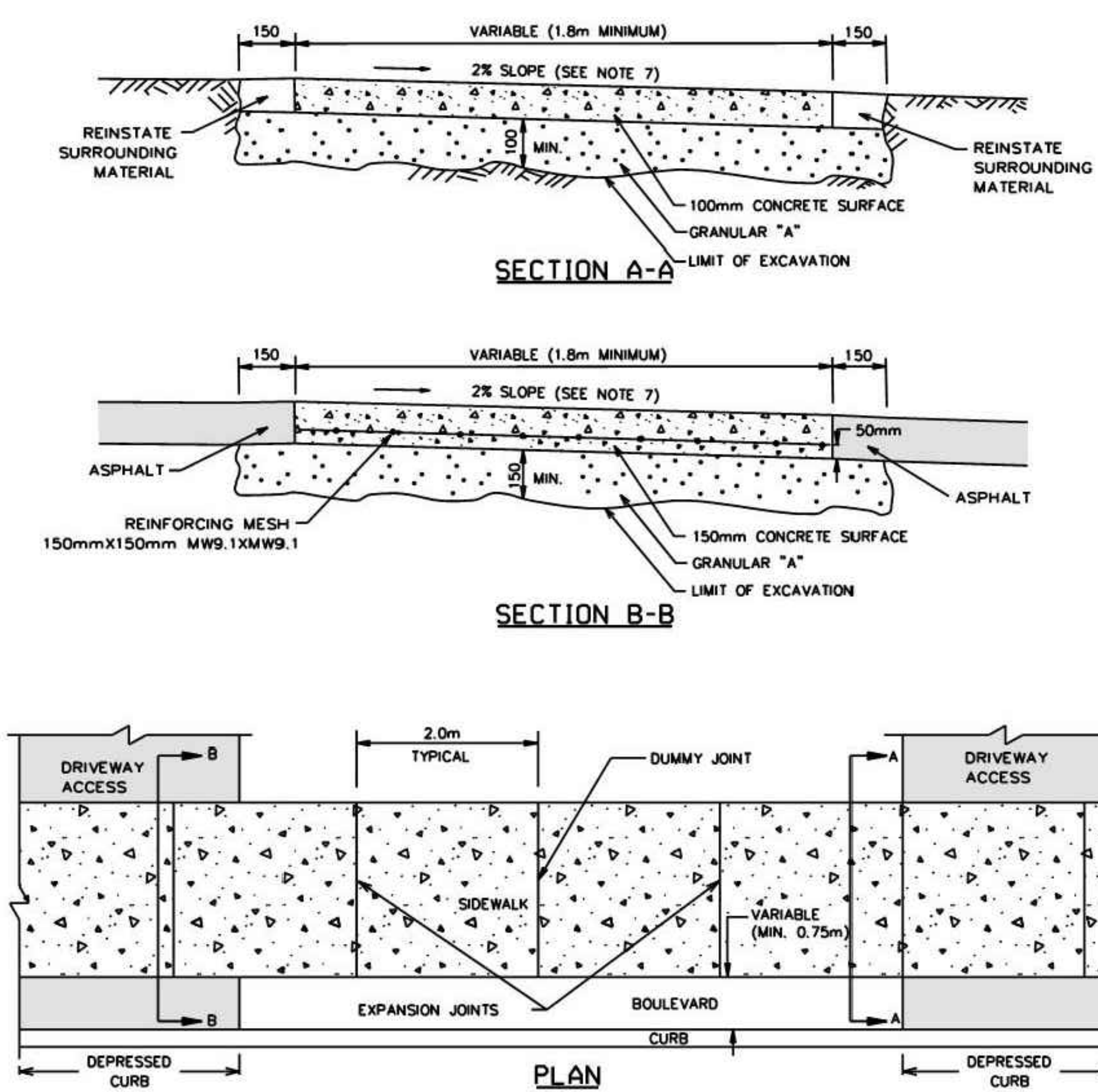

NOTES:

1. CONCRETE AND GRANULAR "A" IS TO BE INCREASED TO 150mm AT THE ENTRANCE AND 150x150mm MW9.1 REINFORCING MESH IS TO BE PLACED MID DEPTH WITHIN DRIVEWAY ACCESS.
2. TRANSVERSE EXPANSION JOINTS ARE REQUIRED AT THE ENDS, THE MIDPOINT, AT INTERVALS OF 4m MAXIMUM, AND ALSO TO ISOLATE OBSTRUCTIONS FROM SIDEWALK, HYDRANTS, POLES, BUILDINGS, ETC.
3. WHEN THE OVERALL SIDEWALK WIDTH EXCEEDS 2.5m, A LONGITUDINAL CONSTRUCTION JOINT SHALL BE CREATED AT ITS MIDPOINT.
4. EDGES AND JOINTS ARE TO BE FINISHED WITH A 75mm EDGING TOOL.
5. ALL CONCRETE SIDEWALKS ARE TO HAVE A BROOM FINISH UNLESS OTHERWISE SPECIFIED.
6. ALL DIMENSIONS ARE IN MILLIMETRES UNLESS SHOWN OTHERWISE.
7. THE MAXIMUM SLOPE IS NOT TO EXCEED 2%.
8. INSTALL DUMMY TRANSVERSE JOINTS AS REQUIRED SO THERE IS A MAXIMUM SPACING OF 2m BETWEEN ALL JOINTS.
9. SIDEWALK NOT TO BE DEPRESSED ACROSS DRIVEWAY ACCESSES.
10. EXPANSION AND DUMMY JOINTS AS PER SCS

① CONCRETE SIDEWALK TYPICAL  
SCALE: NOT TO SCALE

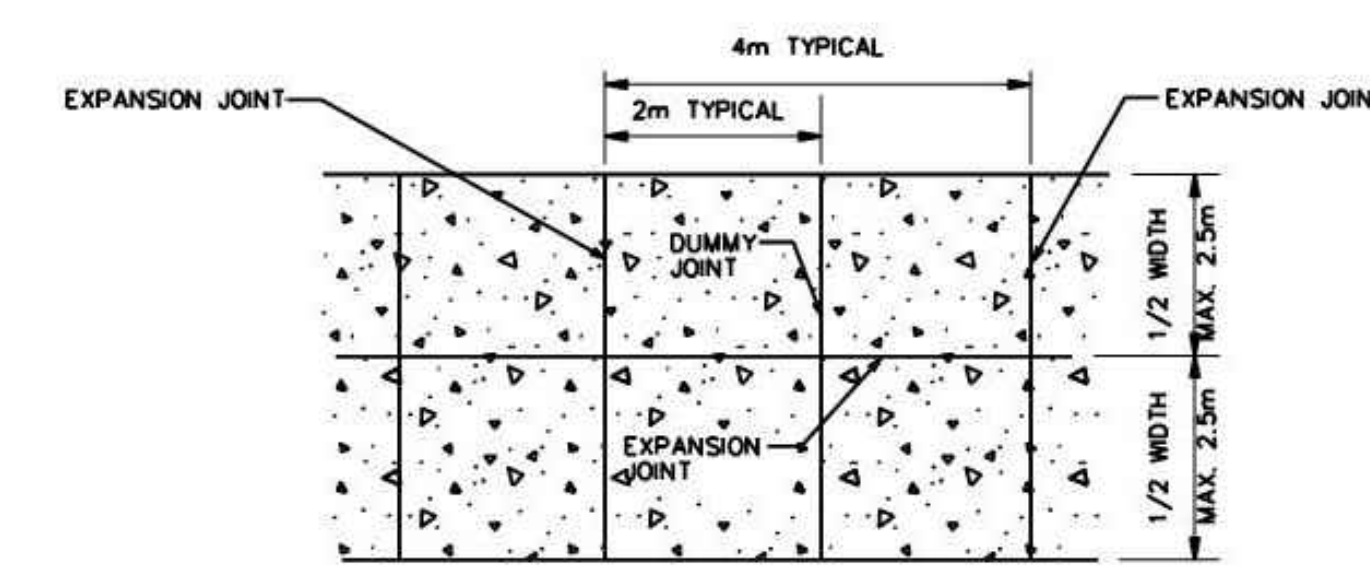

PLAN: SIDEWALK 2.5m WIDE AND OVER

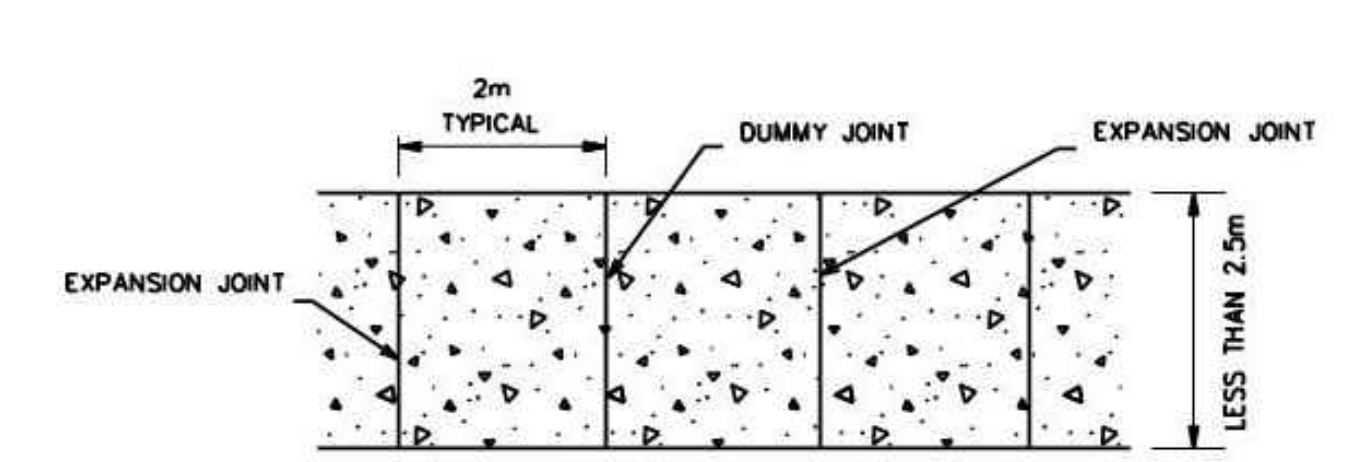

PLAN: SIDEWALK LESS THAN 2.5m WIDE

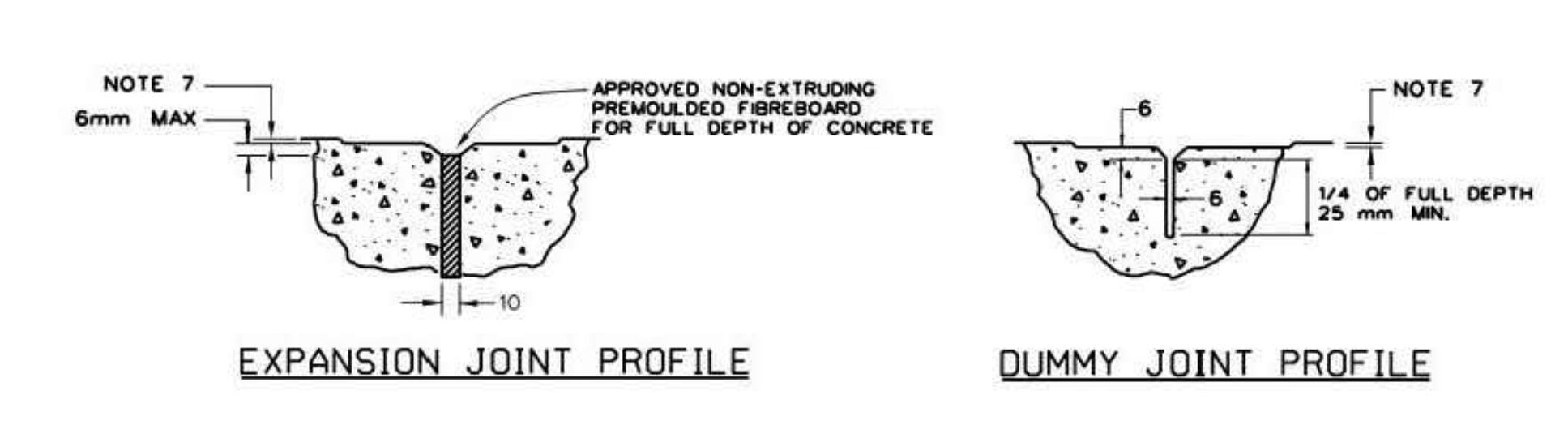

NOTES:

1. EXPANSION JOINTS IN SIDEWALK SHALL BE IN LINE WITH EXPANSION JOINTS IN CURB.
2. TRANSVERSE EXPANSION JOINTS ARE REQUIRED AT THE ENDS, THE MIDPOINT, AT INTERVALS OF 4m MAXIMUM, AND ALSO TO ISOLATE OBSTRUCTIONS FROM SIDEWALK, HYDRANTS, POLES, BUILDINGS, ETC.
3. EDGES AND JOINTS ARE TO BE FINISHED WITH A 75mm EDGING TOOL.
4. ALL CONCRETE SIDEWALKS ARE TO HAVE A BROOM FINISH UNLESS OTHERWISE SPECIFIED.
5. ALL DIMENSIONS ARE IN MILLIMETRES UNLESS SHOWN OTHERWISE.
6. INSTALL DUMMY TRANSVERSE JOINTS AS REQUIRED SO THERE IS A MAXIMUM SPACING OF 2m BETWEEN ALL JOINTS.
7. SMOOTH ALL TOOLED EDGES TO A MAXIMUM DEPTH OF 1mm.

② SIDEWALK CONSTRUCTION JOINTS  
SCALE: NOT TO SCALE

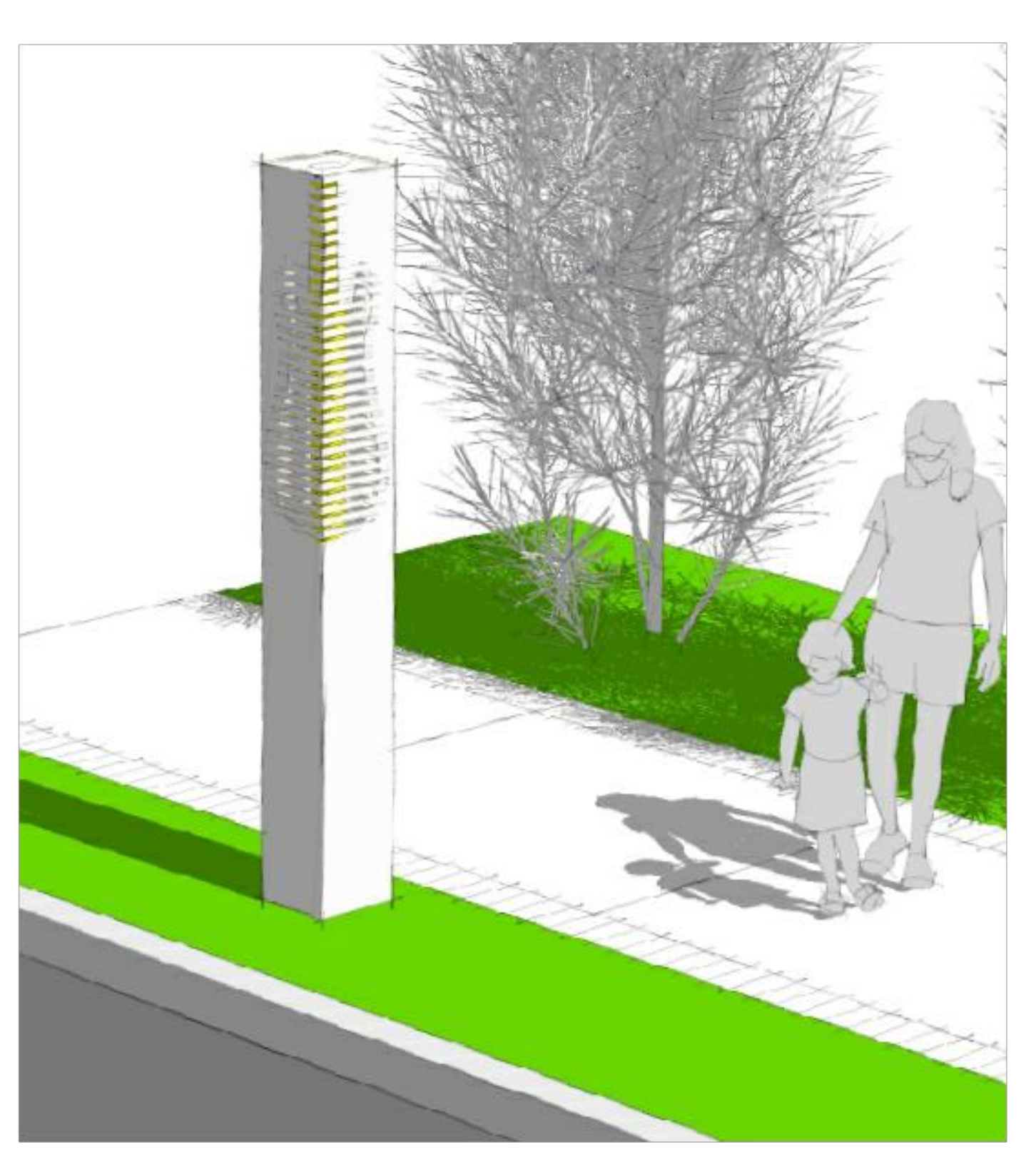
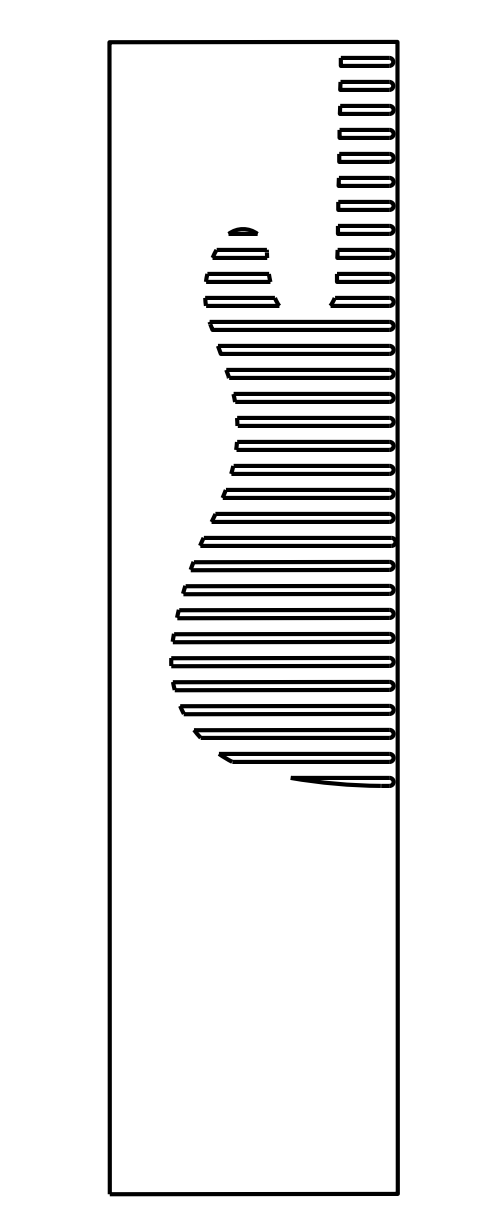

③ BRANDED HARD ROCK BOLLARD  
SCALE: NOT TO SCALE

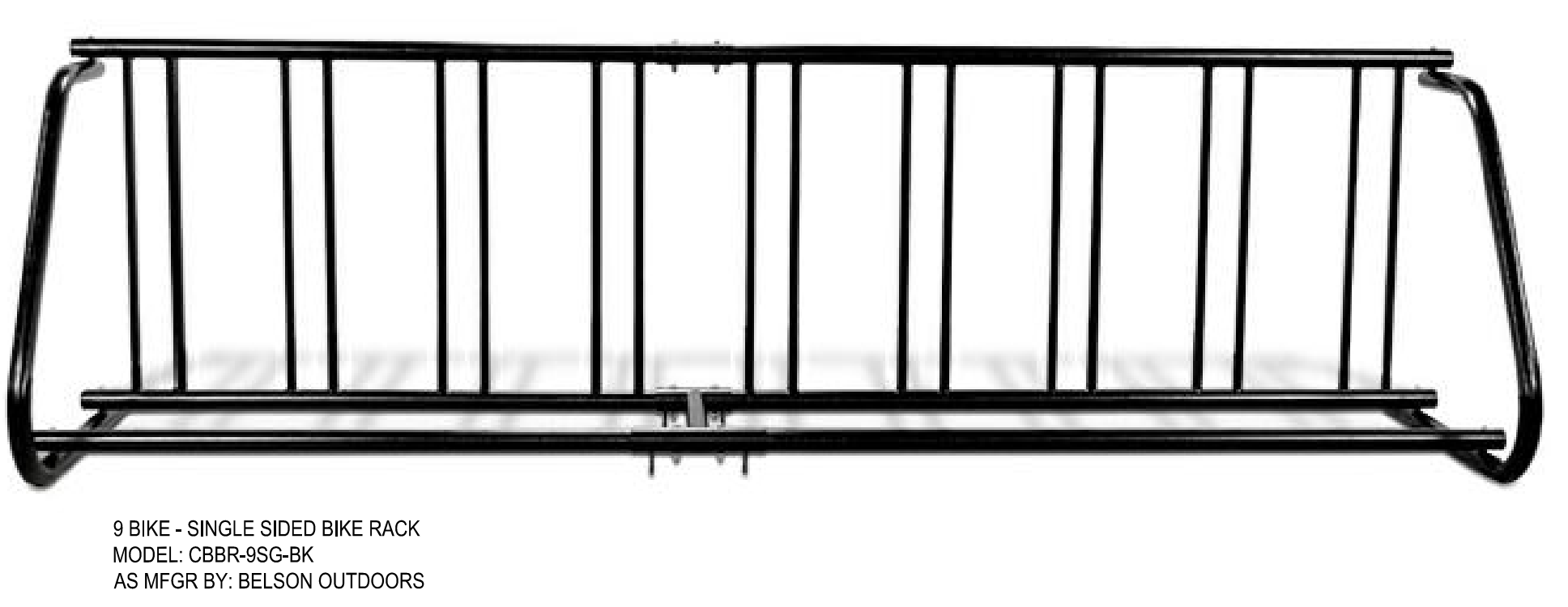

9 BIKE - SINGLE SIDED BIKE RACK  
MODEL: CBBR-9SG-BK  
AS MFG BY: BELSON OUTDOORS

④ 9 BIKE - SINGLE SIDED BIKE RACK  
SCALE: NOT TO SCALE

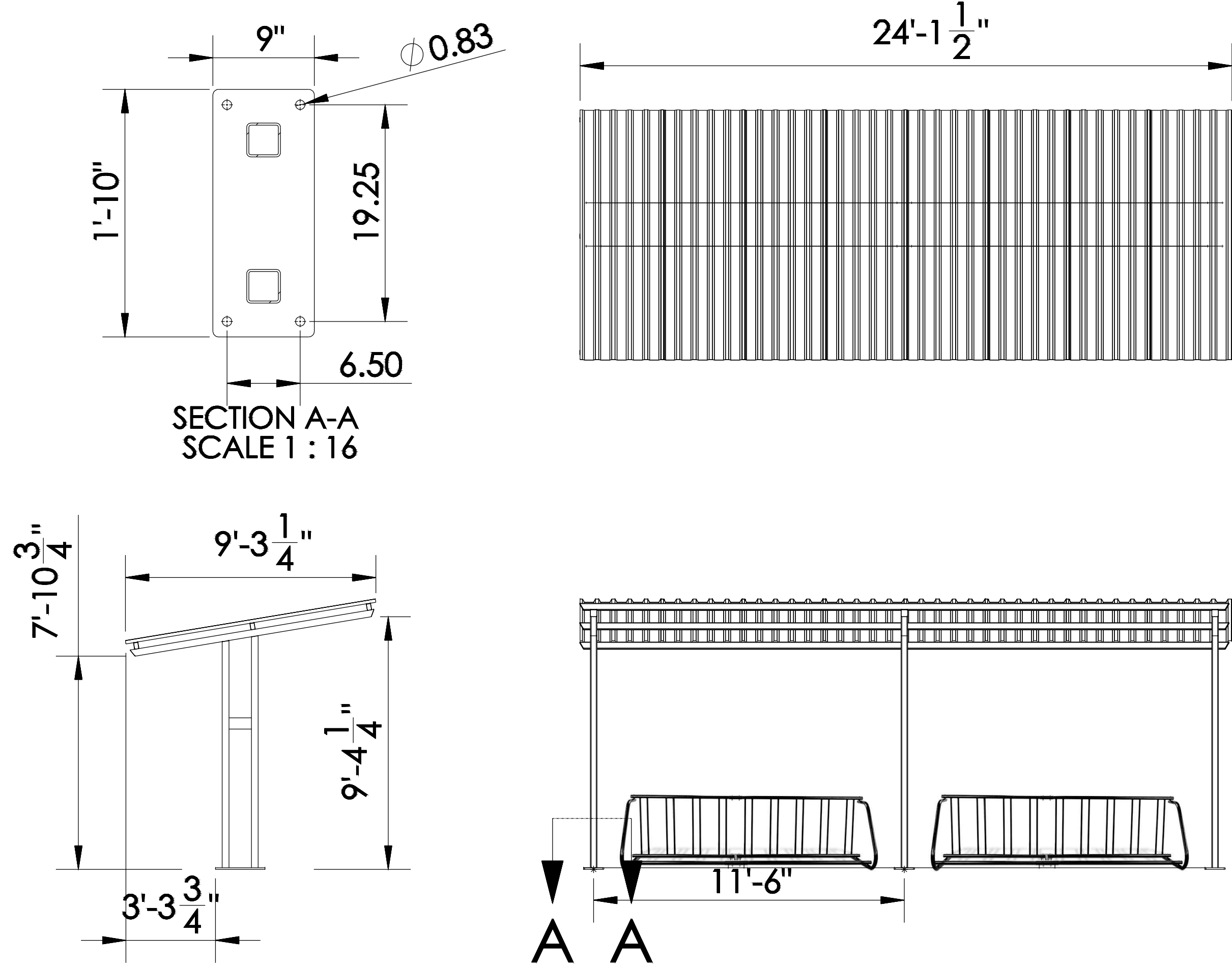

⑤ BIKE PARKING SHELTER  
SCALE: NOT TO SCALE

edsa  
PLANNING  
LANDSCAPE ARCHITECTURE  
URBAN DESIGN  
INNER HARBOR CENTER  
400 EAST PRATT STREET, SUITE 502  
BALTIMORE, MARYLAND 21202 USA  
TEL: 443.539.3350

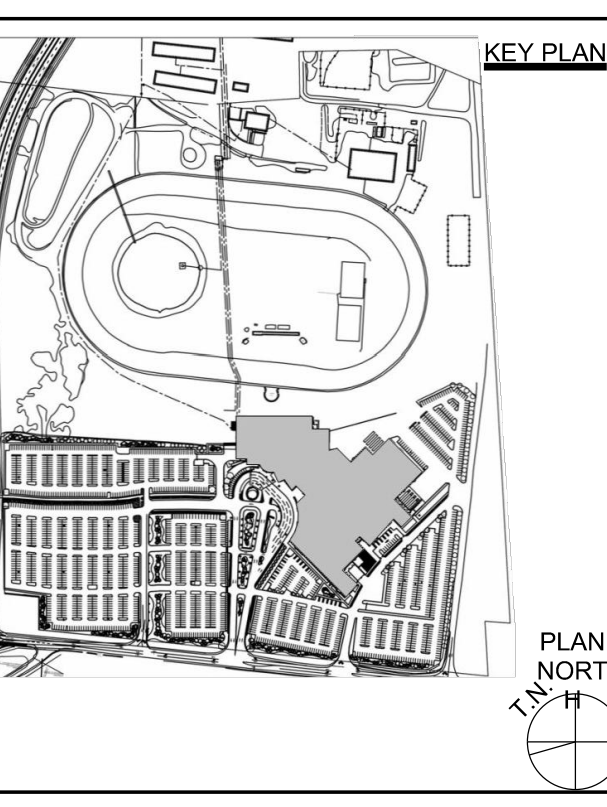

**Hard Rock** CASINO  
HARD ROCK HOTEL  
CASINO  
4837 ALBION ROAD,  
GLOUCESTER, OTTAWA,  
ON, CANADA  
4837 ALBION RD,  
GLOUCESTER, OTTAWA  
ONTARIO, CANADA

SECOND SUBMISSION FOR  
SITE PLAN AGREEMENT  
APRIL 24, 2020

SUBMISSIONS		
NO.	DATE	DESCRIPTION

DRAWING TITLE:  
SITE DETAILS  
DRAWN BY: VH DATE:  
REVIEWED BY: CAS 04/17/2020  
SCALE: DRAWINGS NO.  
PROJECT NO. 19072.00 L5.01

GROUND CONTROL  
SYSTEMS®  
Intelligent Bike & Board Parking

DESCRIPTION:	SLOPE SHELTER 9 X 24	
PART NUMBER:	S0924	USED IN ASSEMBLY NUMBER:
		REV. A

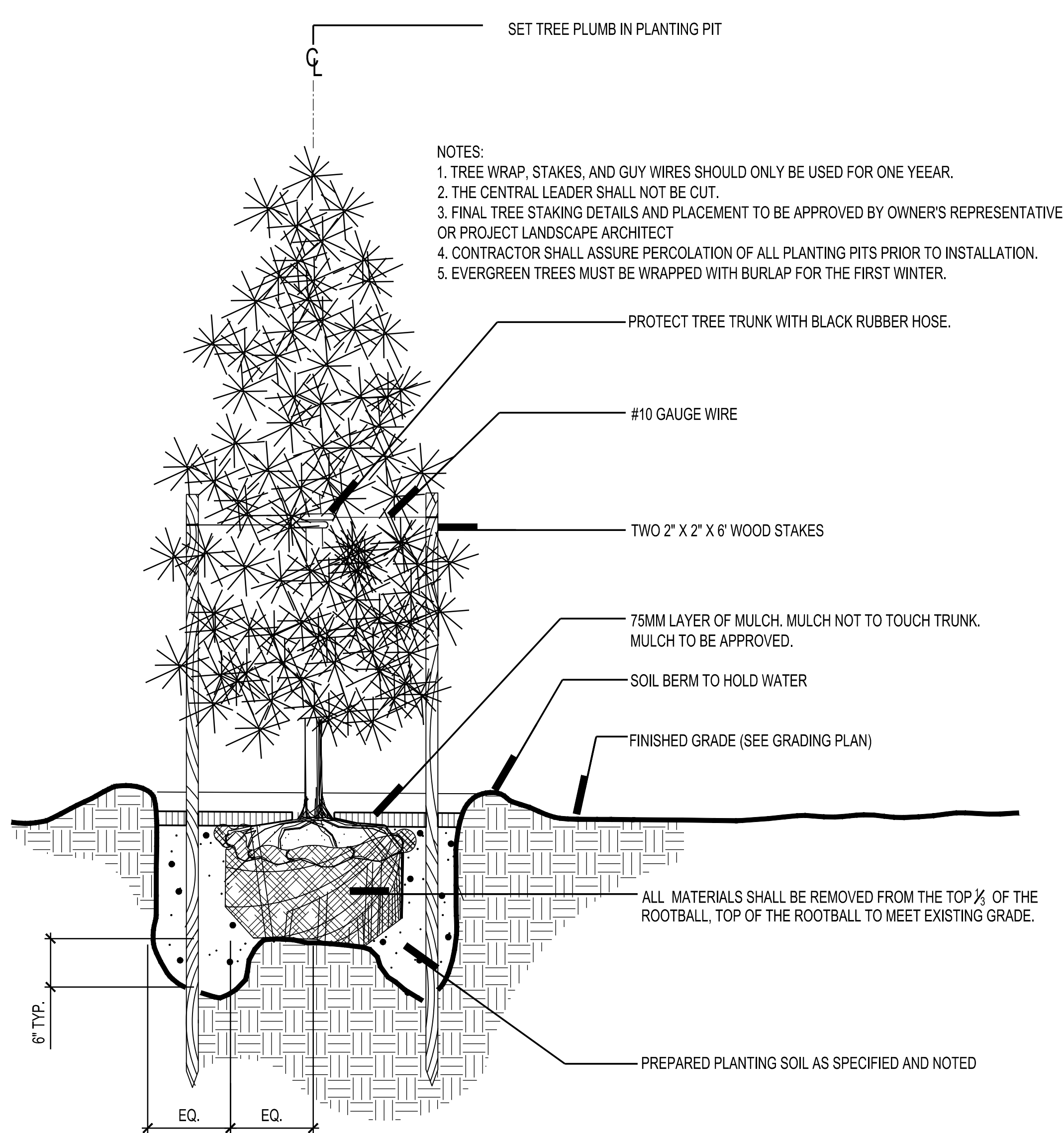

1 EVERGREEN TREE PLANTING  
 D-1058-PL-PINE.DWG  
 SCALE: NOT TO SCALE  
 DETAIL

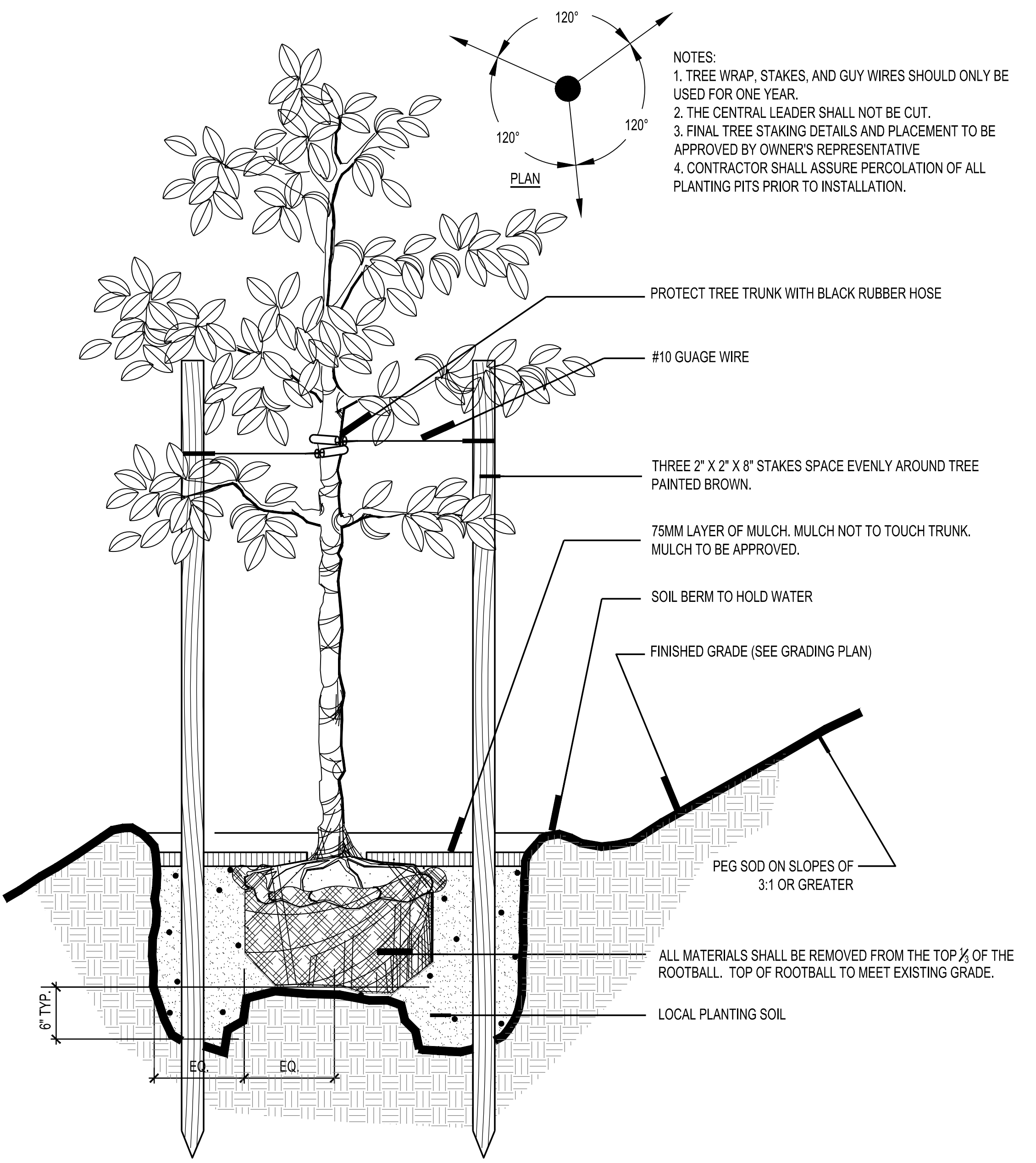

2 TREE PLANTING  
 SCALE: NOT TO SCALE  
 DETAIL

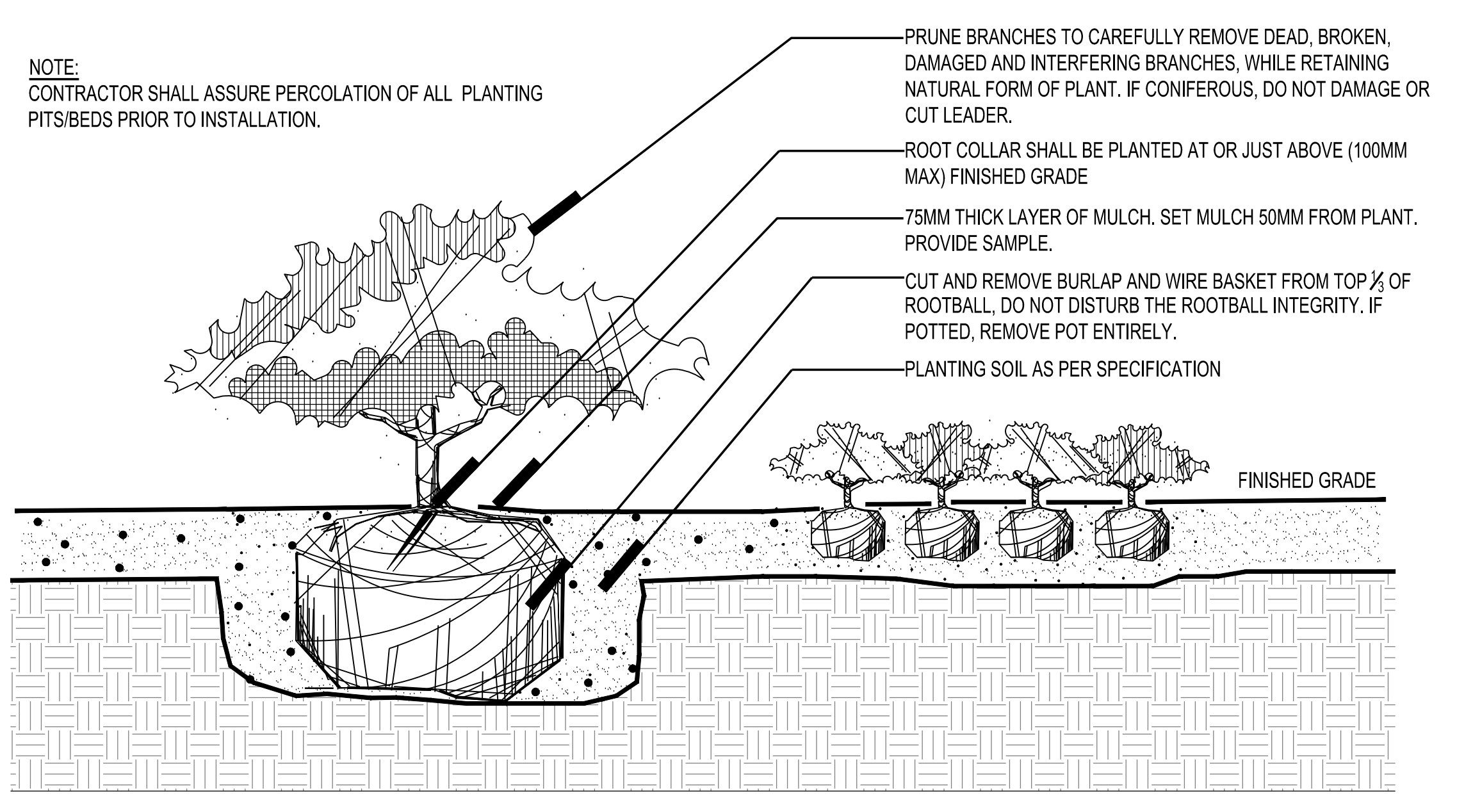

3 SHRUB PLANTING  
 SCALE: NOT TO SCALE  
 DETAIL

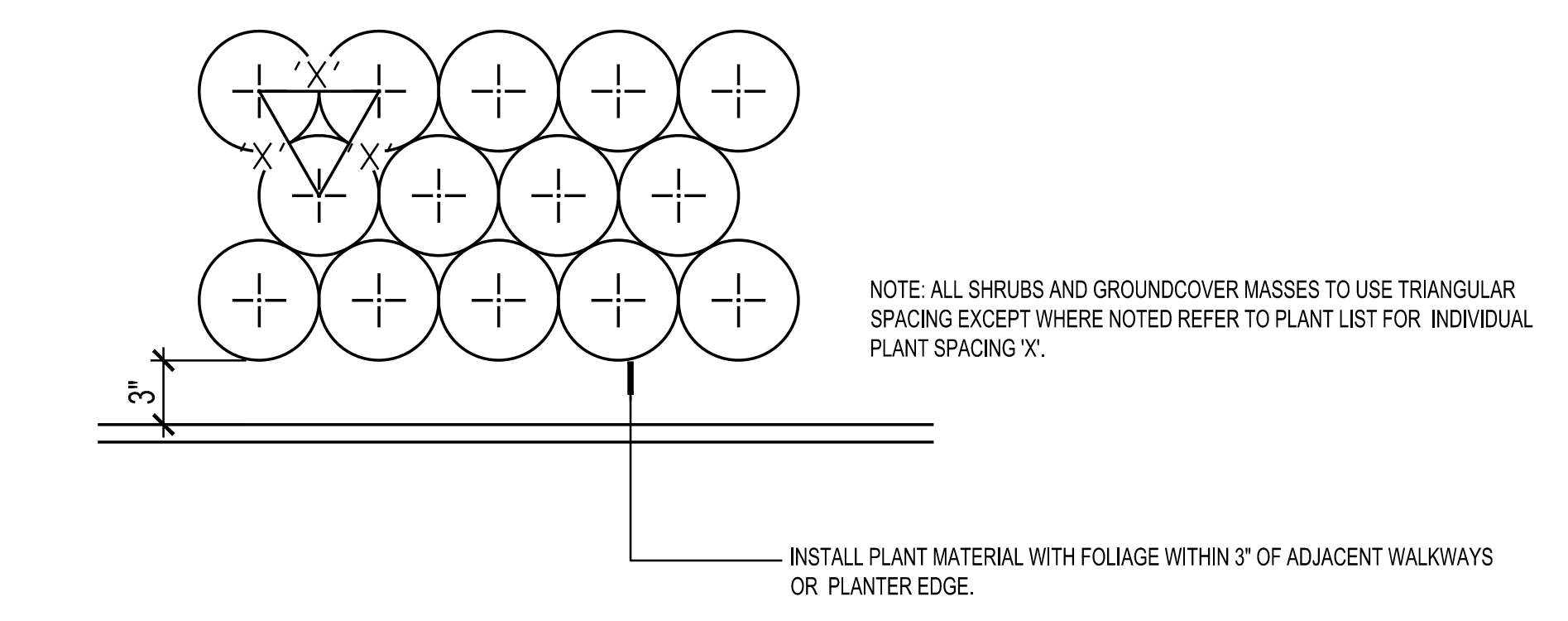

4 SHRUB & GROUNDCOVER SPACING  
 SCALE: NOT TO SCALE  
 PLAN

ed  
sa

PLANNING  
 LANDSCAPE ARCHITECTURE  
 URBAN DESIGN

INNER HARBOR CENTER  
 400 EAST PRATT STREET, SUITE 502  
 BALTIMORE, MARYLAND 21202 USA  
 TEL: 443.539.3350

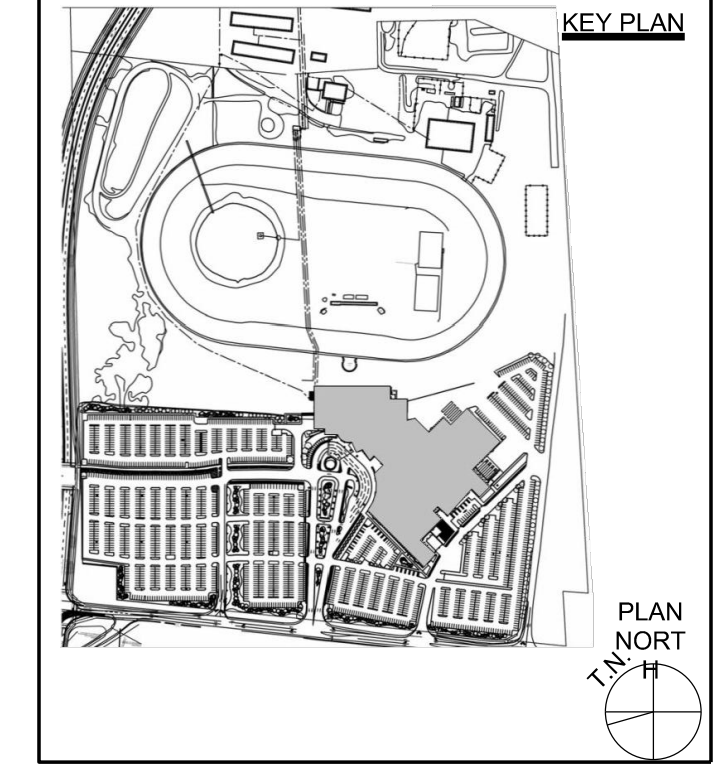

**Hard Rock**  
 CASINO

HARD ROCK HOTEL CASINO  
 4837 ALBION ROAD,  
 GLOUCESTER, OTTAWA,  
 ON, CANADA  
 4837 ALBION RD,  
 GLOUCESTER, OTTAWA  
 ONTARIO, CANADA

SECOND SUBMISSION FOR  
 SITE PLAN AGREEMENT  
 APRIL 24, 2020

SUBMISSIONS		
NO.	DATE	DESCRIPTION

DRAWING TITLE:  
**LANDSCAPE DETAILS**

DRAWN BY: VH	DATE: 04/17/2020
REVIEWED BY: CAS	DRAWINGS NO. L5.02
PROJECT NO. 19072.00	