

Allison Hamlin

ALLISON HAMLIN
MANAGER (A), DEVELOPMENT REVIEW WEST
PLANNING, REAL ESTATE & ECONOMIC DEVELOPMENT
DEPARTMENT, CITY OF OTTAWA

APPROVED
By Allison Hamlin at 1:11 pm, Aug 03, 2023

TO BE READ IN CONJUNCTION WITH ALL OTHER PLANS

LEGEND	
	PROPERTY LINE
	PROPOSED ELEVATION
	EXISTING ELEVATION
	PROPOSED SWALE ELEVATION
	PROPOSED BUILDING ENTRANCE
	DIRECTION OF MAJOR OVERLAND FLOW
	PROPOSED SAN MANHOLE
	PROPOSED STORM MANHOLE
	PROPOSED CATCHBASIN MANHOLE
	PROPOSED CATCHBASIN
	PROPOSED LIGHT POST/FIXTURE (REFER TO ELECTRICAL/PHOTOMETRIC PLAN)
	DECORATIVE LAMP POST (REFER TO ELECTRICAL/PHOTOMETRIC PLAN)
	LIGHTING BOLLARD (REFER TO ELECTRICAL/PHOTOMETRIC PLAN)
	CONCRETE BOLLARD
	PROPOSED CROSSWALK PAINTING
	PROPOSED PARKING PAINTING
	PROPOSED HIGH POINT
	PROPOSED CURB
	PROPOSED DEPRESSED CURB
	PROPOSED ASPHALT TIE INTO EXISTING ASPHALT
	PROPOSED PRECAST CONCRETE CURB (O.P.S.D. 603.020)
	TACTILE WALKING SURFACE INDICATOR (TWSI) PER CITY DETAIL SCT.3
	SWALE c/w SUBDRAIN AND DIRECTION OF FLOW
	TERRACING 3:1 SLOPE MAX (UNLESS OTHERWISE INDICATED)
	PROPOSED RETAINING WALL
	SLOPE AND DIRECTION
	100YR. PONDING LIMITS
	CROSS-SECTION DETAIL (REFER TO NOTES AND DETAILS SHEET)
	EXISTING UTILITY POLE c/w GUY WIRES
	EXISTING VALVE & VALVE CHAMBER
	EXISTING VALVE & VALVE BOX
	EXISTING HYDRANT
	EXISTING SANITARY MANHOLE
	EXISTING STORM MANHOLE
	EXISTING CATCHBASIN
	EXISTING LIGHT STANDARD
	EXISTING FENCE

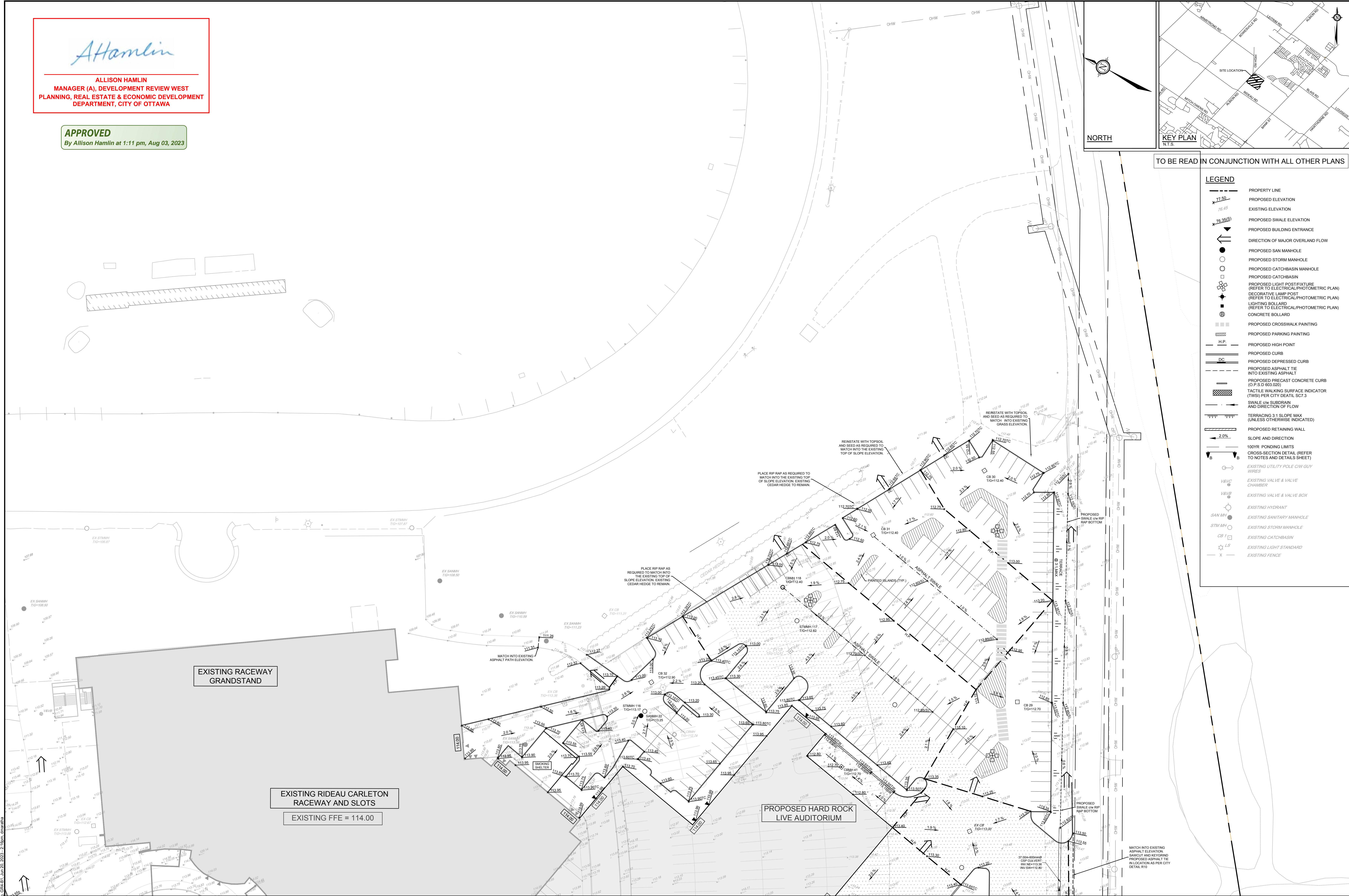

NOTE:
THE POSITION OF ALL POLE LINES, CONDUITS,
WATERMANS, SEWERS AND OTHER
UNDERGROUND AND OVERGROUND UTILITIES AND
STRUCTURES IS NOT NECESSARILY SHOWN ON
THE CONTRACT DRAWINGS, AND WHERE SHOWN,
THE ACCURACY OF THE POSITION OF SUCH
UTILITIES AND STRUCTURES IS NOT GUARANTEED.
BEFORE STARTING WORK, DETERMINE THE EXACT
LOCATION OF ALL SUCH UTILITIES AND
STRUCTURES AND ASSUME ALL LIABILITY FOR
DAMAGE TO THEM.

**NOT FOR
CONSTRUCTION**

No.	REVISION	DATE	BY
7	REVISED PER CITY COMMENTS	JUN 2023	MJH
6	ISSUED FOR GMP	JUN 14/23	MJH
5	REVISED PER CITY COMMENTS	MAR 03/23	MJH
4	DESIGN DOCUMENTS PACKAGE	NOV 15/22	MJH
3	REVISED PER CITY COMMENTS	NOV 08/22	MJH
2	REVISED PER CITY COMMENTS	APRIL 24/20	CJR
1	ISSUED FOR SITE PLAN APPROVAL	NOV 20/19	CJR

SCALE	FOR REVIEW ONLY
1:400	DESIGNER: MJH
1:400	CHECKED: CJR
1:400	DRAWN: MJH
1:400	CHECKED: CJR
1:400	APPROVED: JLS

SCALE	FOR REVIEW ONLY
1:400	DESIGNER: MJH
1:400	CHECKED: CJR
1:400	DRAWN: MJH
1:400	CHECKED: CJR
1:400	APPROVED: JLS

NOVATECH
Engineers, Planners & Landscape Architects
Suite 200, 240 Michael Cowpland Drive
Ottawa, Ontario, Canada K2M 1P6
Telephone: (613) 254-9643
Facsimile: (613) 254-5867
Website: www.novatech-eng.com

LOCATION	DRAWING NAME	PROJECT No.
4837 ALBION ROAD, CITY OF OTTAWA HARD ROCK OTTAWA	GRADING PLAN NORTH-EAST DEVELOPMENT	116111
		REV #7
		116111-GR4

D07-12-19-0191 Plan No. 18864