

*All Hamlin*

ALLISON HAMLIN  
MANAGER (A), DEVELOPMENT REVIEW WEST  
PLANNING, REAL ESTATE & ECONOMIC DEVELOPMENT  
DEPARTMENT, CITY OF OTTAWA

**APPROVED**

By Allison Hamlin at 1:11 pm, Aug 03, 2023

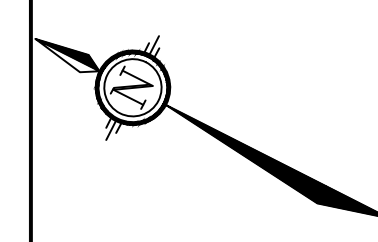

NORTH

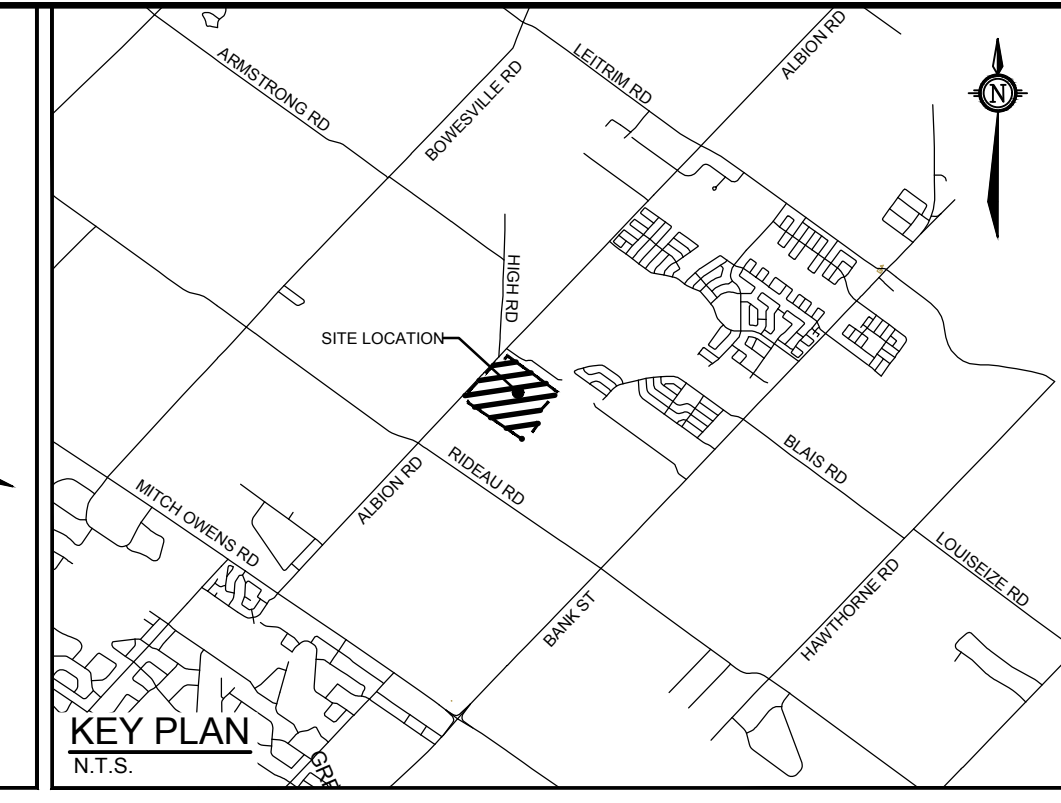

APPROXIMATE LIMITS OF DRAWING. REFER TO INDIVIDUAL DRAWINGS FOR DETAILED DESIGN INFORMATION

116111-GP2 - GENERAL PLAN OF SERVICES NORTH-WEST DEVELOPMENT

116111-GP1 - GENERAL PLAN OF SERVICES SOUTH-WEST DEVELOPMENT

116111-GP4 - GENERAL PLAN OF SERVICES NORTH-EAST DEVELOPMENT

116111-GP3 - GENERAL PLAN OF SERVICES SOUTH-EAST DEVELOPMENT

**LEGEND**

- PROPERTY LINE
- PROPOSED CURB
- DC — PROPOSED DEPRESSED CURB
- PROPOSED RETAINING WALL
- PROPOSED PRECAST CONCRETE CURB (0.75' S.D. 803.320)
- TACTILE WALKING SURFACE INDICATOR (TWSI) PER CITY DETAIL SCT. 3
- PROPOSED CAP
- PROPOSED CROSSWALK PAINTING
- PROPOSED PARKING PAINTING
- PROPOSED SANITARY SERVICE c/w MANHOLE
- PROPOSED STORM SEWER AND MANHOLE
- PROPOSED BUILDING ENTRANCE
- DIRECTION OF FLOW
- PROPOSED CATCHBASIN MANHOLE
- PROPOSED INLET CONTROL DEVICE
- PROPOSED CATCHBASIN
- PROPOSED UNDERGROUND STORAGE WITH GEOTEXTILE (REFER TO 116111-ND FOR DETAILS)
- PROPOSED UNDERGROUND STORAGE WITHOUT GEOTEXTILE (REFER TO 116111-ND FOR DETAILS)
- PROPOSED LIGHT POST FIXTURE (REFER TO ELECTRICAL/PHOTOMETRIC PLAN)
- DECORATIVE LAMP POST (REFER TO ELECTRICAL/PHOTOMETRIC PLAN)
- LIGHTING BOLLARD (REFER TO ELECTRICAL/PHOTOMETRIC PLAN)
- CONCRETE BOLLARDS
- HYDRO TRANSFORMER (REFER TO ELECTRICAL PLAN)
- GENERATOR (REFER TO ELECTRICAL PLAN)
- ELECTRICAL MANHOLE (REFER TO ELECTRICAL PLAN)
- EXISTING UTILITY POLE c/w GUY WIRES
- EXISTING WATERMAIN c/w VALVE & VALVE CHAMBER
- EXISTING HYDRANT c/w VALVE & LEAD
- EXISTING SANITARY MANHOLE & SEWER
- EXISTING SANITARY FORCEMAIN
- EXISTING STORM MANHOLE & SEWER
- EXISTING CATCHBASIN
- EXISTING INFILTRATION CHAMBERS
- EXISTING GAS MAIN
- EXISTING OVERHEAD WIRES
- EXISTING BELL LINE
- EXISTING HYDRO
- EXISTING STREETLIGHT POWER SUPPLY
- EXISTING STREETLIGHT
- EXISTING PARKING LOT SIGNAGE

TO BE READ IN CONJUNCTION WITH ALL OTHER DRAWINGS

**NOT FOR CONSTRUCTION**

NOTE:  
THE POSITION OF ALL POLE LINES, CONDUITS, WATERMANS, SEWERS AND OTHER UNDERGROUND AND OVERGROUND UTILITIES AND STRUCTURES IS NOT NECESSARILY SHOWN ON THE CONTRACT DRAWINGS, AND WHERE SHOWN, THE ACCURACY OF THE POSITION OF SUCH UTILITIES AND STRUCTURES IS NOT GUARANTEED. BEFORE STARTING WORK, DETERMINE THE EXACT LOCATION OF ALL SUCH UTILITIES AND STRUCTURES AND ASSUME ALL LIABILITY FOR DAMAGE TO THEM.

NO.	REVISION	DATE	BY
7	REVISED PER CITY COMMENTS	JUN 2023	MJH
6	ISSUED FOR GMP	JUN 14/23	MJH
5	REVISED PER CITY COMMENTS	MAR 03/23	MJH
4	DESIGN DOCUMENTS PACKAGE	NOV 15/22	MJH
3	REVISED PER CITY COMMENTS	NOV 08/22	MJH
2	REVISED PER CITY COMMENTS	APRIL 24/20	CJR
1	ISSUED FOR SITE PLAN APPROVAL	NOV 20/19	CJR

SCALE	
1:1250	0 10 20 30 40 50

FOR REVIEW ONLY	
DESIGN	MJH
CHECKED	CJR
DRAWN	MJH
CHECKED	CJR
APPROVED	JLS

**NOVATECH**  
Engineers, Planners & Landscape Architects  
Suite 200, 240 Michael Cowpland Drive  
Ottawa, Ontario, Canada K2M 1P6  
Telephone: (613) 254-9643  
Facsimile: (613) 254-5867  
Website: www.novatech-eng.com

LOCATION  
4837 ALBION ROAD, CITY OF OTTAWA  
HARD ROCK OTTAWA  
DRAWING NAME  
**GENERAL PLAN OF SERVICES  
OVERALL DEVELOPMENT**

PROJECT NO.	116111
REV	REV #7
DRAWING NO.	116111-GP

C:\000\116111\GP\116111-GP-01.dwg - Jun 20, 2023 - 2:25pm - dhaman

DOT-12-19-0131 Plan No. 18864