

February 13th, 2020

BY E-MAIL: mike.giampa@ottawa.ca

City of Ottawa
Planning and Growth Management Department
110 Laurier Ave. W, 4th Floor
Ottawa ON, K1P 1J1

Attention: Mike Giampa
Project Manager, Transportation Approvals

Dear Mr. Giampa:

Reference: 480 Cope Drive
RMA Application
Our File No.: 119153

A Transportation Impact Assessment, dated November 2019, was prepared in support of Site Plan Control application for 480 Cope Drive. The TIA was revised in February 2020 to address City comments. The proposed development consists of an elementary school with a capacity of 650 students.

The proposed Continental Avenue roadway modifications will narrow the width of the road to 7.0m at Cope Drive, Britannic Road/proposed access, and north of Haliburton Heights. A 2.5m wide lay-by will be developed between the proposed bulb-outs. This design will encourage a lower speed limit of 30km/hr along Continental Avenue, while maintaining a lay-by for parent pick-up/drop-off activity.

The proposed Rouncey Road modifications will extend the multi-use pathway to south of the bus loop egress where it will transition to an on-road cycling facility/concrete sidewalk. This modification is not anticipated to impact the pedestrian or cycling level of service along Rouncey Road. Back-to-back 'bicycle trail crossing' (Wc-44L/R) signs are proposed at the ingress and 'pedestrian and bicycle crossing ahead' (Wc-15) signs are proposed at the egress to the bus layby to provide pedestrians and cyclists with the right-of-way.

A 1:500 scale functional design is included in Appendix G of the TIA report dated February 2020.

Please find attached the required documentation to initiate the Roadway Modification Approval process for the roadway modifications associated with the above-noted development:

- Key Plan (PDF)
- Proposed Roadway Modifications (PDF)
- Preliminary Cost Estimate (PDF)

Digital copies of the drawings will be provided when City comments are provided and addressed.

Contact information for the proponent is as follows:

Ottawa Carleton District School Board
133 Greenbank Road
Ottawa, Ontario K2H 6L3

Email: david.lacelle@ocdsb.ca
Tel: (613)596-8748 Ext. 8748

Should you require anything further please feel free to call.

Yours truly,

NOVATECH



Brad Byvelds, P. Eng.
Project Coordinator | Transportation/Traffic

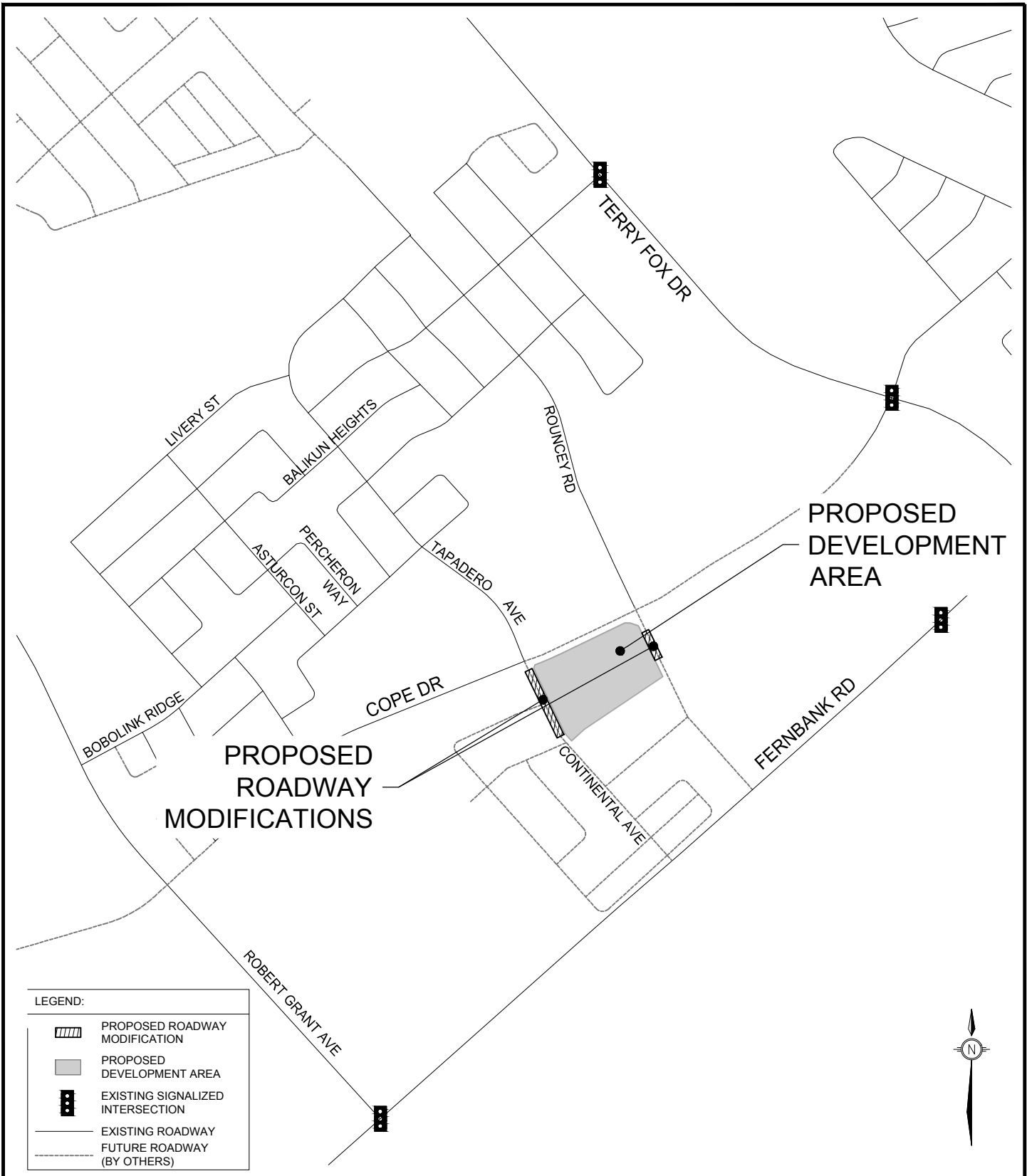

TRANSPORTATION SERVICES DEPARTMENT

KEYPLAN
480 COPE DRIVE

Transportation Engineering Services

Approved By:
Completed By: NOVATECH
Scale: N.T.S.
Date: FEBRUARY 2020

Drawing No.:
RMA-2020
-TPD-002A

M:\2019\119153\CAD\Design\Figures\Traffic\119153-FD.dwg, RMA-detail B1, Feb 13, 2020 - 11:37am, millier

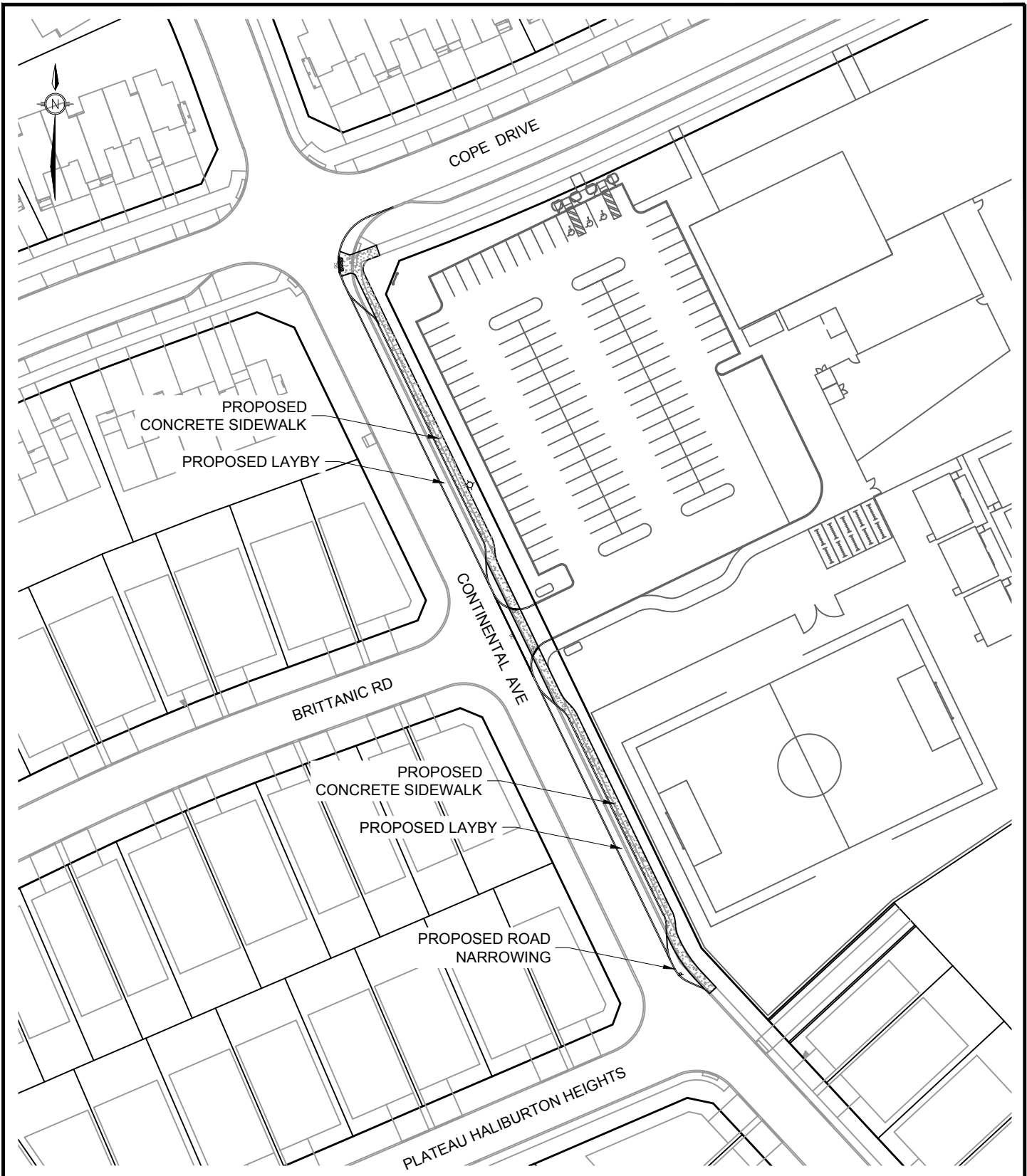

TRANSPORTATION SERVICES
DEPARTMENT

**PROPOSED ROADWAY
MODIFICATION**
480 COPE DRIVE

Transportation Engineering Services

Approved By:	???
Completed By:	NOVATECH
Scale:	Date: FEBRUARY 2020
N.T.S.	

Drawing No.:

**RMA-2020
-TPD-002B1**

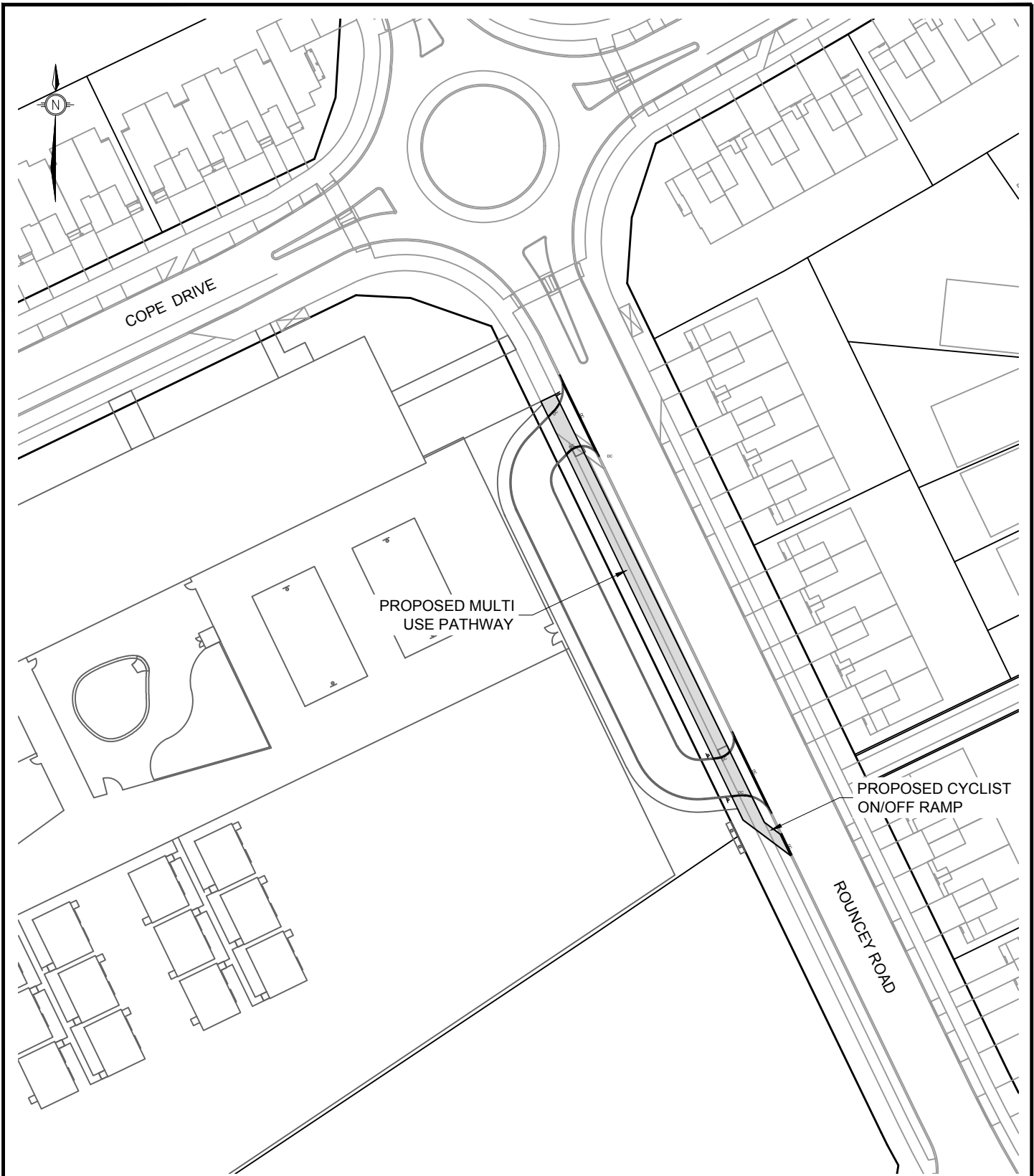

M:\2019\119153\CAD\Design\Figures\Traffic\119153-FD.dwg, RMA-detail B2, Feb 13, 2020 - 11:37am, millier



TRANSPORTATION SERVICES
DEPARTMENT

**PROPOSED ROADWAY
MODIFICATION**
480 COPE DRIVE

Transportation Engineering Services

Approved By:		???
Completed By:		NOVATECH
Scale:	Date:	
N.T.S.	FEBRUARY 2020	

Drawing No.:

**RMA-2020
-TPD-002B2**

PRELIMINARY COST ESTIMATE

Project No. 119153

480 Cope Drive -
Continental Avenue
and Rouncey Road Modifications

Date: February 13, 2020

Item	Description	Quantity	Unit	Unit Price	Total Amount
<u>SECTION A - EARTHWORKS</u>					
1	Traffic Management Requirements	1	LS	\$5,000.00	\$5,000.00
2	Excavation	1,184	m ³	\$25.00	\$29,600.00
Subtotal					\$34,600.00
<u>SECTION B - ROADWAYS</u>					
1	Granular "B" - Type II a) 450 mm thickness	244	m ²	\$18.00	\$4,392.00
2	Granular "A" a) 150 mm thickness	769	m ²	\$10.00	\$7,690.00
3	Asphalt a) 40mm, Top Lift 12.5m Level B b) 50mm, Base Course Superpave 19.0 Level B (PG 58-28) c) Multi-use Pathway	244 244 287	m ² m ² m ²	\$15.00 \$15.00 \$50.00	\$3,660.00 \$3,660.00 \$14,350.00
4	Curb a) Concrete Barrier Curb b) Concrete Mountable Curb c) Concrete Sidewalk	271 116 276	m m m ²	\$80.00 \$80.00 \$80.00	\$21,680.00 \$9,280.00 \$22,080.00
5	Removals a) Saw-Cut of Asphalt b) Removal of Concrete Curb c) Removal of Concrete Sidewalk	211 207 444	m m m ²	\$8.00 \$10.00 \$30.00	\$1,688.00 \$2,070.00 \$13,320.00
6	Tactile Walking Surface Indicators (TWSI)	1	ea	\$3,500.00	\$3,500.00
7	Line Painting (MUP)	70	m	\$5.50	\$385.00
8	Proposed Signage	3	ea	\$500.00	\$1,500.00
9	Relocation of Fire Hydrant	1	LS	\$7,500.00	\$7,500.00
Subtotal					\$116,755.00
<u>SECTION C - LANDSCAPING</u>					
1	Topsoil & Sod	172	m ²	\$12.00	\$2,064.00
Subtotal					\$2,064.00
Subtotal					\$153,419.00
	Soft Costs (20%)				\$30,683.80
	Contingency (10%)				\$15,341.90
Subtotal					\$199,444.70