

- NOTES**
- THE FOLLOWING PROTECTION MEASURES MUST BE IMPLEMENTED FOR RETAINED TREES BOTH WITHIN THE WORK AREA AND ON ADJACENT PARCELS.
 - UNDER THE GUIDANCE OF AN ARBORIST, ERECT A MODULAR FENCE AT THE CRITICAL ROOT ZONE (CRZ) OF TREES WHERE THE CRZ IS ESTABLISHED AS BEING TO EXTEND FROM THE TRUNK FOR EVERY CENTIMETER OF TRUNK DIAMETER AT BRANCH HEAD.
 - TREE PROTECTION SHALL BE ERECTED TO PROVIDE A CONTINUOUS BARRICADE BETWEEN EXISTING TREES AND THE WORK AREA PRIOR TO CONSTRUCTION. TUNNEL OR BORE WHEN DIGGING WITHIN THE CRZ OF A TREE.
 - DO NOT PLACE ALL EQUIPMENT AND CONSTRUCTION RELATED MATERIAL ARE NOT PLACED OR TEMPORARILY STORED WITHIN THE CRZ.
 - DO NOT EXHAUST FUMES FROM ALL EQUIPMENT ARE NOT DIRECTED TOWARDS ANY TREE'S CANOPY.
 - FLOODING OR DEPOSITION OF SEDIMENT SHALL BE PREVENTED WHERE TREES ARE LOCATED.
 - ALL EXPOSED ROOT SYSTEMS SHALL BE EXPOSED AND BACKFILLED IN ONE CONTINUOUS OPERATION TO MINIMIZE DISEASE.
 - EXPOSED ROOTS SHALL BE KEPT CONTINUOUSLY MOIST DURING EXCAVATION. REMOVE BRANCHES AND DAMAGED ROOTS WITH SHARP PRUNING SHEARS.
 - THE TREE PROTECTION MODULAR FENCE IS TEMPORARY, SHALL BE MAINTAINED AT ALL TIMES DURING CONSTRUCTION OPERATIONS, AND SHALL BE REMOVED UPON COMPLETION OF WORK WHEN AGREED TO BY THE CONTRACT ADMINISTRATOR AND LANDSCAPE ARCHITECT.

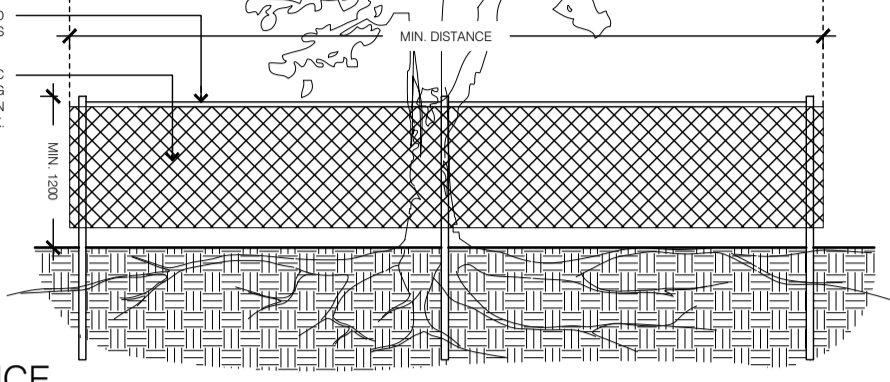

1 TREE PRESERVATION FENCE

L001

TREES TO BE REMOVED			
NO.	TREE SPECIES	DBH	CONDITION
1	Acer Saccharum	25 cm	Good
2	Acer Saccharum	20 cm	Good
3	Acer Rubrum	10 cm	Good
4	Acer Rubrum	15cm	Good
5	Acer Saccharum	20 cm	Good
6	Acer Saccharum	30 cm	Good
7	Picea spp.	15 cm	Good
8	Picea spp.	20 cm	Good
9	Picea spp.	20 cm	Good
10	Picea spp.	15 cm	Good
11	Picea spp.	20 cm	Good
12	Picea spp.	17 cm	Good
13	Picea spp.	20 cm	Good
14	Picea spp.	15 cm	Good
15	Pinus spp.	35 cm	Good
16	Pinus spp.	30 cm	Good
17	Pinus spp.	30 cm	Good
18	Pinus spp.	35 cm	Good
19	Pinus spp.	25 cm	Good
20	Pinus spp.	20 cm	Good
21	Acer Saccharum	22 cm	Good
22	Acer Saccharum	22 cm	Good
23	Acer Saccharum	22 cm	Good
24	Picea spp.	30 cm	Good
25	Picea spp.	30 cm	Good
26	Picea spp.	25 cm	Good
27	Picea spp.	25 cm	Good
28	Picea spp.	20 cm	Good
29	Picea spp.	25 cm	Good
30	Picea spp.	30 cm	Good
31	Picea spp.	25 cm	Good
32	Pinus spp.	25 cm	Good
33	Picea spp.	25 cm	Good
34	Picea spp.	25 cm	Good

TREES TO BE REMOVED			
NO.	TREE SPECIES	DBH	CONDITION
35	Pinus spp.	35 cm	Good
36	Pinus spp.	40 cm	Good
37	Tilia Cordata	25 cm	Good
38	Tilia Cordata	10 cm	Good
39	Tilia Cordata	20 cm	Good
40	Tilia Cordata	20 cm	Good
41	Quercus Rubra	30 cm	Good
42	Tilia Cordata	25 cm	Good
43	Tilia Cordata	20 cm	Moderate- Poor
44	Tilia Cordata	25 cm	Moderate- Poor
45	Acer Saccharum	25 cm	Good
46	Pinus spp.	20 cm	Moderate
47	Pinus spp.	20 cm	Moderate
48	Pinus spp.	20 cm	Good
49	Pinus spp.	18 cm	Poor
50	Pinus spp.	15 cm	Good

2 TREE PRESERVATION PLAN

L001

CONTRACTOR MUST CHECK & VERIFY ALL DIMENSIONS ON THE JOB.
DO NOT SCALE DRAWINGS.
ALL DRAWINGS, SPECIFICATIONS AND RELATED DOCUMENTS ARE THE COPYRIGHT PROPERTY OF THE ARCHITECT AND MUST BE RETURNED UPON REQUEST. REPRODUCTION OF DRAWINGS, SPECIFICATIONS AND RELATED DOCUMENTS IN PART OR IN WHOLE IS FORBIDDEN WITHOUT THE WRITTEN PERMISSION OF THE ARCHITECT.
THIS DRAWING IS NOT TO BE USED FOR CONSTRUCTION UNTIL SIGNED BY THE ARCHITECT.

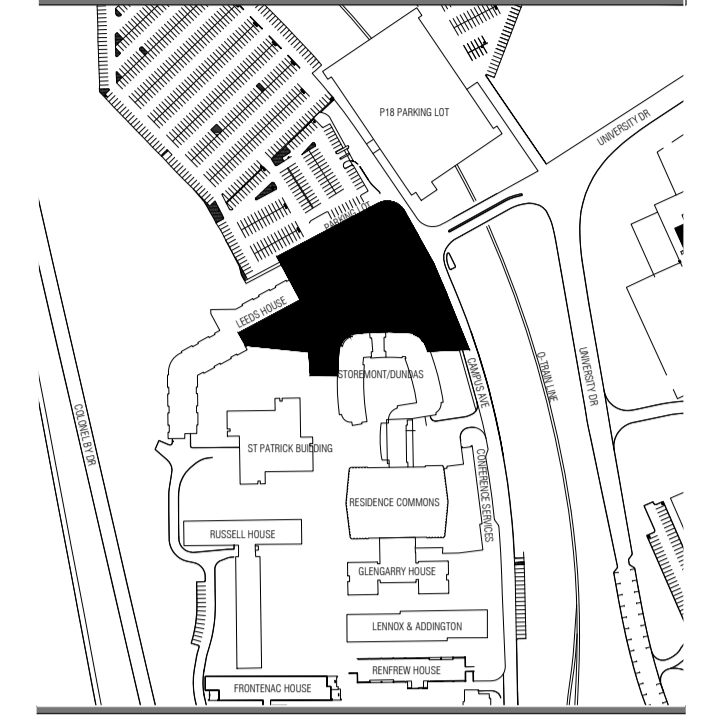

- LEGEND:**
- LIMIT OF WORK
 - TREE PROTECTION ZONE
 - TREE PROTECTION ZONE WHERE REMOVALS ARE WITHIN TPZ, REMOVALS ARE TO BE DONE BY HAND DIGGING UNDER SUPERVISION OF AN ARBORIST
 - EXISTING CONIFEROUS TREE TO REMAIN
 - EXISTING DECIDUOUS TREE TO REMAIN
 - EXISTING CONIFEROUS TREE TO BE REMOVED
 - EXISTING DECIDUOUS TREE TO BE REMOVED

ISSUED

No.	Date	Description
1	2019-12-13	ISSUED FOR SITE PLAN CONTROL



Architects in Joint Venture for the Carleton University Engineering Design Centre
Diamond Schmitt Architects 384 Adelaide Street West, Toronto, Ontario M5T 1S7 Canada
KWC Architects Inc. 383 Dundas Avenue East, Suite 201, Ottawa, Ontario K1R 4K4 Canada

LASHLEY + ASSOCIATES
 LANDSCAPE ARCHITECTURE AND SITE ENGINEERING
 202-950 GLADSTONE AVENUE OTTAWA, ON K1Y 3E6
 T 613 233 8579 F 613 233 4051 W LashleyLA.com E Mail@LashleyLA.com

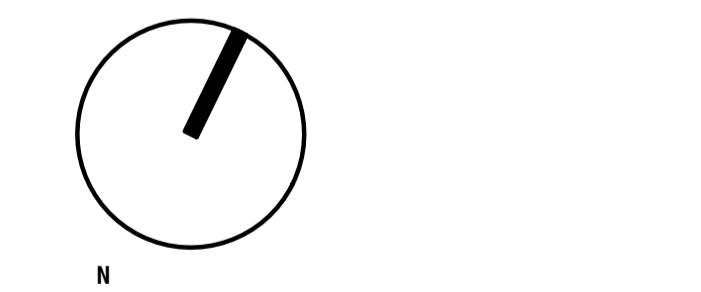

CARLETON UNIVERSITY NEW STUDENT RESIDENCE

CARLETON UNIVERSITY
 1125 COLONEL BY DRIVE
 OTTAWA ON K1S 5B6

Drawing Name
TREE CONSERVATION PLAN

Scale: 1:200
 Project No: 19758-1
 Date: 2019-12-13

L001

PLANT LIST

Key	QTY	BOTANICAL NAME	COMMON NAME	SIZE	COMMENTS
Ar	4	Acer rubrum	Red Maple	15m	45 mm W.B.
Bp	3	Betula papyrifera	Paper Birch	12m	50 mm W.B.
Cc	4	Carya cordiformis	Bitternut Hickory	15m	45 mm W.B.
Fg	2	Fagus grandifolia	American Beech	15m	45 mm W.B.
Ma	2	Magnolia acuminata	Cucumber Magnolia	20m	10 GAL
Ov	3	Ostrya vigiana	Eastern Hop-Hornbeam	10m	45 mm W.B.
Ta	2	Tilia americana	Basswood	20m	50 mm W.B.

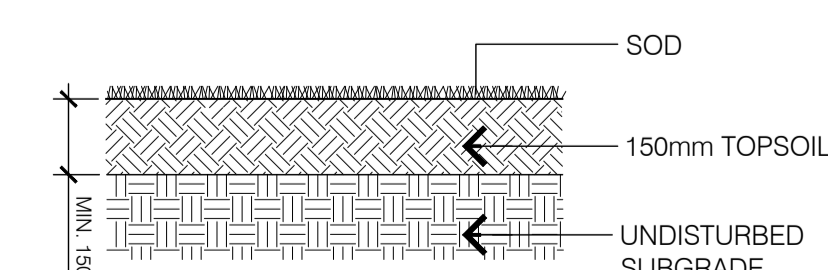
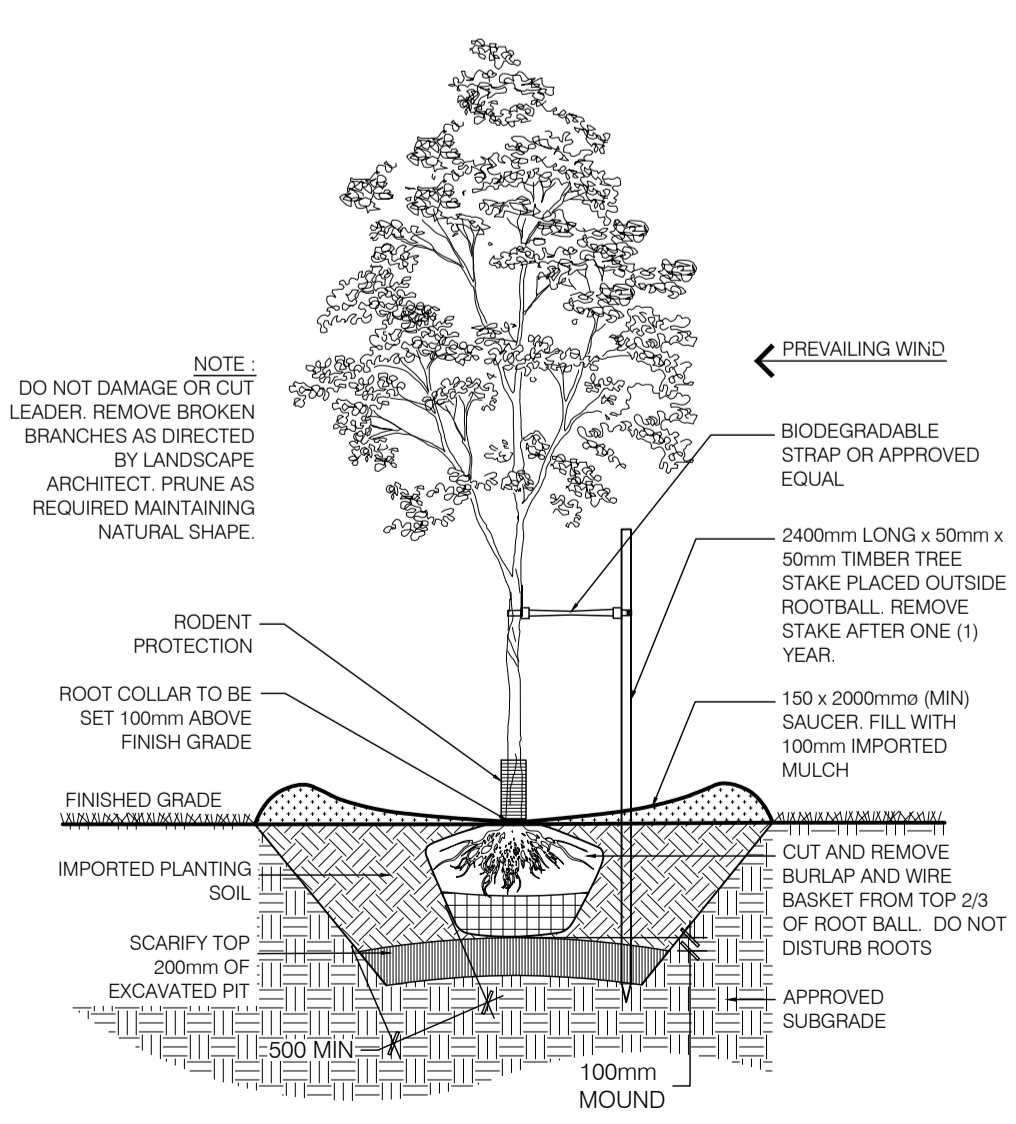
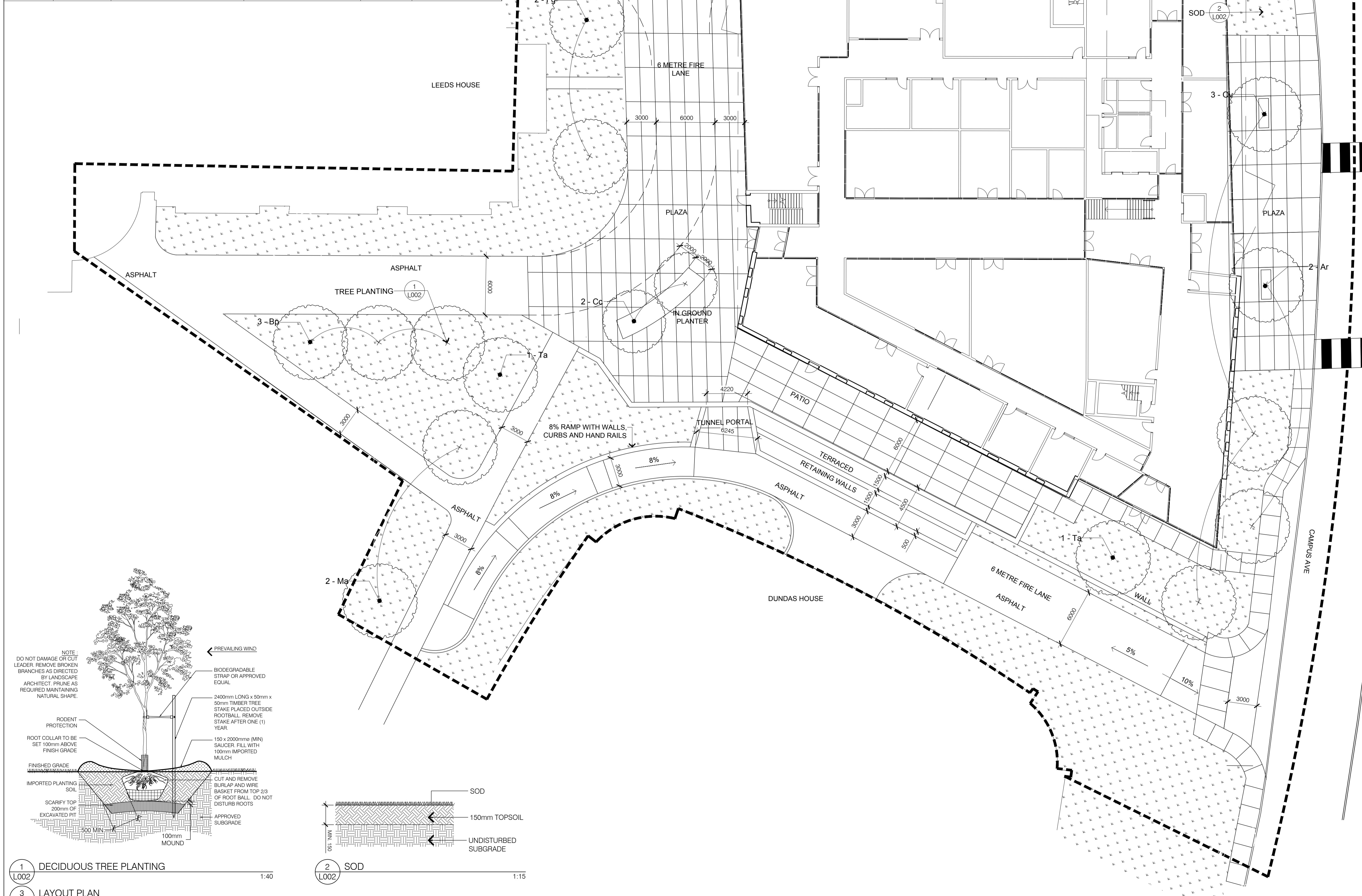

1 L002 DECIDUOUS TREE PLANTING 1:40

3 L002 LAYOUT PLAN

2 L002 SOD 1:15

CONTRACTOR MUST CHECK & VERIFY ALL DIMENSIONS ON THE JOB.
DO NOT SCALE DRAWINGS.
ALL DRAWINGS, SPECIFICATIONS AND RELATED DOCUMENTS ARE THE COPYRIGHT PROPERTY OF THE ARCHITECT AND MUST BE RETURNED UPON REQUEST. REPRODUCTION OF DRAWINGS, SPECIFICATIONS AND RELATED DOCUMENTS IN PART OR IN WHOLE IS FORBIDDEN WITHOUT THE WRITTEN PERMISSION OF THE ARCHITECT.
THIS DRAWING IS NOT TO BE USED FOR CONSTRUCTION UNTIL SIGNED BY THE ARCHITECT.

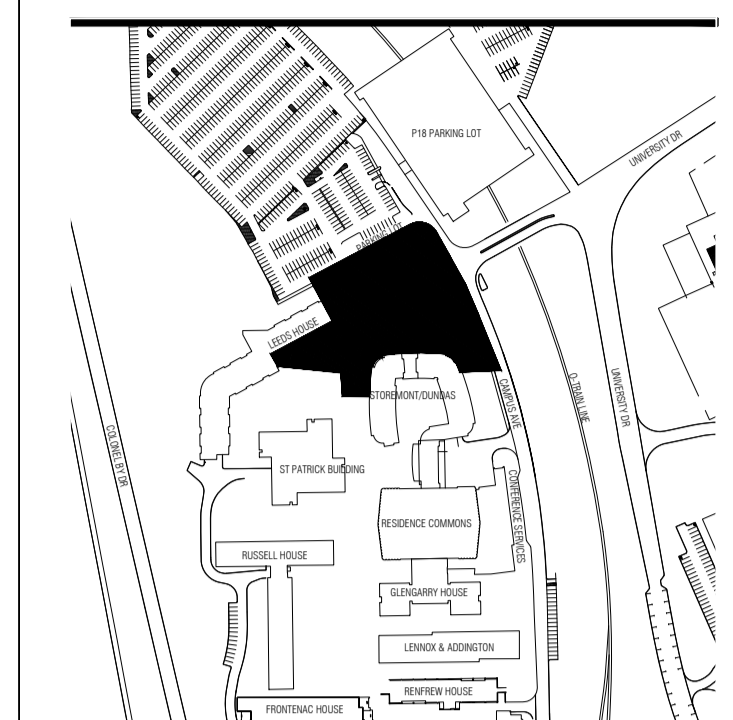

LEGEND:

- LIMIT OF WORK
- SOD
- ==== PAVING
- ★ EXISTING CONIFEROUS TREE TO REMAIN
- EXISTING DECIDUOUS TREE TO REMAIN

ISSUED

No.	Date	Description
1	2019-12-13	ISSUED FOR SITE PLAN CONTROL



Architects in Joint Venture for the Carleton University Engineering Design Centre

Diamond Schmitt Architects
384 Adelaide Street West
Toronto, Ontario
M5T 1A7 Canada
Tel: 416 862 8800
Fax: 416 862 1008
info@dsac.ca
www.dsac.ca

KWC Architects Inc.
383 Paradise Avenue
Suite 201
Ottawa, Ontario
K1P 4K4 Canada
Tel: 613 238 2117
Fax: 613 238 4595
kw@kwarcch.com
www.kwarcch.com

LASHLEY + ASSOCIATES
LANDSCAPE ARCHITECTURE AND SITE ENGINEERING

202-950 GLADSTONE AVENUE
OTTAWA, ON K1Y 3E8
T 613 233 8579
F 613 233 4051
W LashleyLA.com
E Mail@LashleyLA.com

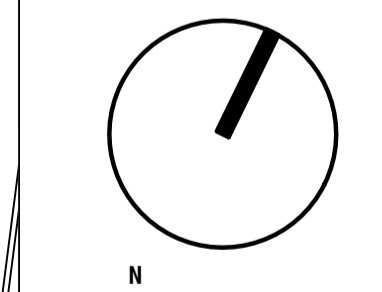

CARLETON UNIVERSITY NEW STUDENT RESIDENCE

CARLETON UNIVERSITY
1125 COLONEL BY DRIVE
OTTAWA ON
K1S 5B6

Drawing Name
LANDSCAPE LAYOUT PLAN

Scale: 1:200
Project No: 19758-1
Date: 2019-12-13

L002

C:\Users\asuraga\OneDrive\Files\1934-Building_asuraga.rvt

7/28/2019 11:41:51 PM