DOUGLAS JAMES, MCIP, RPP
 MANAGER, DEVELOPMENT REVIEW - CENTRAL
 PLANNING, INFRASTRUCTURE & ECONOMIC
 DEVELOPMENT DEPARTMENT, CITY OF OTTAWA



- LEGEND**
- PROPOSED SANITARY MANHOLE AND SEWER
 - PROPOSED STORM MANHOLE AND SEWER
 - EXISTING COMBINED MH & SEWER
 - EXISTING OVERHEAD WIRES
 - EXISTING CONCRETE CURB
 - EXISTING SANITARY MANHOLE & SEWER
 - EXISTING HYDRANT & VALVE
 - EXISTING TREES / VEGETATION
 - EXISTING UTILITY POLE
 - EXISTING FENCE
 - EXISTING WATERMAIN
 - EXISTING HYDRANT

- GENERAL NOTES:**
- COORDINATE AND SCHEDULE ALL WORK WITH OTHER TRADES AND CONTRACTORS.
 - DETERMINE THE EXACT LOCATION, SIZE, MATERIAL AND ELEVATION OF ALL EXISTING UTILITIES PRIOR TO COMMENCING CONSTRUCTION. PROTECT AND ASSUME RESPONSIBILITY FOR ALL EXISTING UTILITIES WHETHER OR NOT SHOWN ON THIS DRAWING.
 - OBTAIN ALL NECESSARY PERMITS AND APPROVALS FROM THE CITY OF OTTAWA BEFORE COMMENCING CONSTRUCTION.
 - BEFORE COMMENCING CONSTRUCTION OBTAIN AND PROVIDE PROOF OF COMPREHENSIVE, ALL RISK AND OPERATIONAL LIABILITY INSURANCE FOR \$5,000,000.00. INSURANCE POLICY TO NAME OWNERS, ENGINEERS AND ARCHITECTS AS CO-INSURED.
 - RESTORE ALL DISTURBED AREAS ON-SITE AND OFF-SITE, INCLUDING TRENCHES AND SURFACES ON PUBLIC ROAD ALLOWANCES TO EXISTING CONDITIONS OR BETTER TO THE SATISFACTION OF THE CITY OF OTTAWA AND ENGINEER.
 - REMOVE FROM SITE ALL EXCESS EXCAVATED MATERIAL, ORGANIC MATERIAL AND DEBRIS UNLESS OTHERWISE INSTRUCTED BY ENGINEER. EXCAVATE AND REMOVE FROM SITE ANY CONTAMINATED MATERIAL. ALL CONTAMINATED MATERIAL SHALL BE DISPOSED OF AT A LICENSED LANDFILL FACILITY.
 - ALL ELEVATIONS ARE GEODETIC.
 - REFER TO GEOTECHNICAL REPORT (No. 190227, DATED JUNE, 2019), PREPARED BY LRL ENGINEERING FOR SUBSURFACE CONDITIONS, CONSTRUCTION RECOMMENDATIONS, AND GEOTECHNICAL INSPECTION REQUIREMENTS. THE GEOTECHNICAL CONSULTANT IS TO REVIEW ON-SITE CONDITIONS AFTER EXCAVATION PRIOR TO PLACEMENT OF THE GRANULAR MATERIAL.
 - REFER TO ARCHITECT'S AND LANDSCAPE ARCHITECT'S DRAWINGS FOR BUILDING AND HARD SURFACE AREAS AND DIMENSIONS.
 - REFER TO DEVELOPMENT SERVICING & STORMWATER MANAGEMENT REPORT (R-2019-193) PREPARED BY NOVATECH.
 - SAW CUT AND KEY GRIND ASPHALT AT ALL ROAD CUTS AND ASPHALT TIE IN POINTS AS PER CITY OF OTTAWA STANDARDS (R10).

- SEWER NOTES:**
- SUPPLY AND CONSTRUCT ALL SEWERS AND APPURTENANCES IN ACCORDANCE WITH THE MOST CURRENT CITY OF OTTAWA STANDARDS AND SPECIFICATIONS.
 - SPECIFICATIONS:

ITEM	SPEC. No.	REFERENCE
STORM / SANITARY MANHOLE (1200mmØ)	701.010	OPSD
STORM / SANITARY MH FRAME & COVER	401.010	OPSD
WATER TIGHT MH FRAME AND COVER	401.030	OPSD
SEWER TRENCH	S6	CITY OF OTTAWA
SANITARY / STORM SEWER	PVC DR 35	
 - ALL STORM AND SANITARY SERVICE LATERALS SHALL BE EQUIPPED WITH BACKFLOW PREVENTION DEVICES AS PER THE CITY OF OTTAWA STANDARD DETAILS S14 AND S14.2.
 - INSULATE ALL PIPES (SANITARY) THAT HAVE LESS THAN 1.5m COVER WITH HI-40 INSULATION PER INSULATION DETAIL FOR SHALLOW SEWERS. PROVIDE 150mm CLEARANCE BETWEEN PIPE AND INSULATION.
 - SERVICES ARE TO BE CONSTRUCTED TO 1.0m FROM FACE OF BUILDING AT A MINIMUM SLOPE OF 1.0%.
 - PIPE BEDDING, COVER AND BACKFILL ARE TO BE COMPACTED TO AT LEAST 95% OF THE STANDARD PROCTOR MAXIMUM DRY DENSITY. THE USE OF CLEAR CRUSHED STONE AS A BEDDING LAYER SHALL NOT BE PERMITTED.
 - FLEXIBLE CONNECTIONS ARE REQUIRED FOR CONNECTING PIPES TO MANHOLES (FOR EXAMPLE KOR-N-SEAL, PSX, POSITIVE SEAL AND DURASEAL). THE CONCRETE CRADLE FOR THE PIPE CAN BE ELIMINATED.
 - THE OWNER SHALL REQUIRE THAT THE SITE SERVICING CONTRACTOR PERFORM FIELD TESTS FOR QUALITY CONTROL OF ALL SANITARY SEWERS. LEAKAGE TESTING SHALL BE COMPLETED IN ACCORDANCE WITH OPS5 410.07.18, 410.07.16, 410.07.16.04 AND 407.07.24. DYE TESTING IS TO BE COMPLETED ON ALL SANITARY SERVICES TO CONFIRM PROPER CONNECTION TO THE SANITARY SEWER MAIN. THE FIELD TESTS SHALL BE PERFORMED IN THE PRESENCE OF A CERTIFIED PROFESSIONAL ENGINEER WHO SHALL SUBMIT A CERTIFIED COPY OF THE TEST RESULTS.
 - ALL STORM MANHOLES AND CATCHBASIN MANHOLES ARE TO HAVE 300mm SUMPS UNLESS OTHERWISE INDICATED. ALL CATCHBASINS ARE TO HAVE 600mm SUMPS UNLESS OTHERWISE INDICATED.
 - ALL CATCHBASINS, MANHOLES AND/OR CATCHBASIN MANHOLES THAT ARE TO HAVE ICD'S INSTALLED WITHIN THEM ARE TO HAVE 600mm SUMPS.
 - ALL WEAVING TILE CONNECTIONS TO BE MADE TO THE PROPOSED STORM SEWER SYSTEM DOWNSTREAM OF ANY INLET CONTROL DEVICES.
 - THE CONTRACTOR IS TO TELEPHONE (CCTV) ALL PROPOSED SEWERS, 200mmØ OR GREATER PRIOR TO BASE COURSE ASPHALT. UPON COMPLETION OF CONTRACT, THE CONTRACTOR IS RESPONSIBLE TO FLUSH AND CLEAN ALL SEWERS & APPURTENANCES.
 - CONTRACTOR TO PROVIDE THE CONSULTANT WITH A PLAN AND PROFILE DRAWING INDICATING ALL APPLICABLE SERVICING AS-BUILT INFORMATION SHOWN ON THIS PLAN. AS-BUILT INFORMATION MUST INCLUDE: PIPE MATERIAL, SIZES, LENGTHS, SLOPES, INVERT AND TIG ELEVATIONS, STRUCTURE LOCATIONS AND ANY ALIGNMENT CHANGES, ETC.

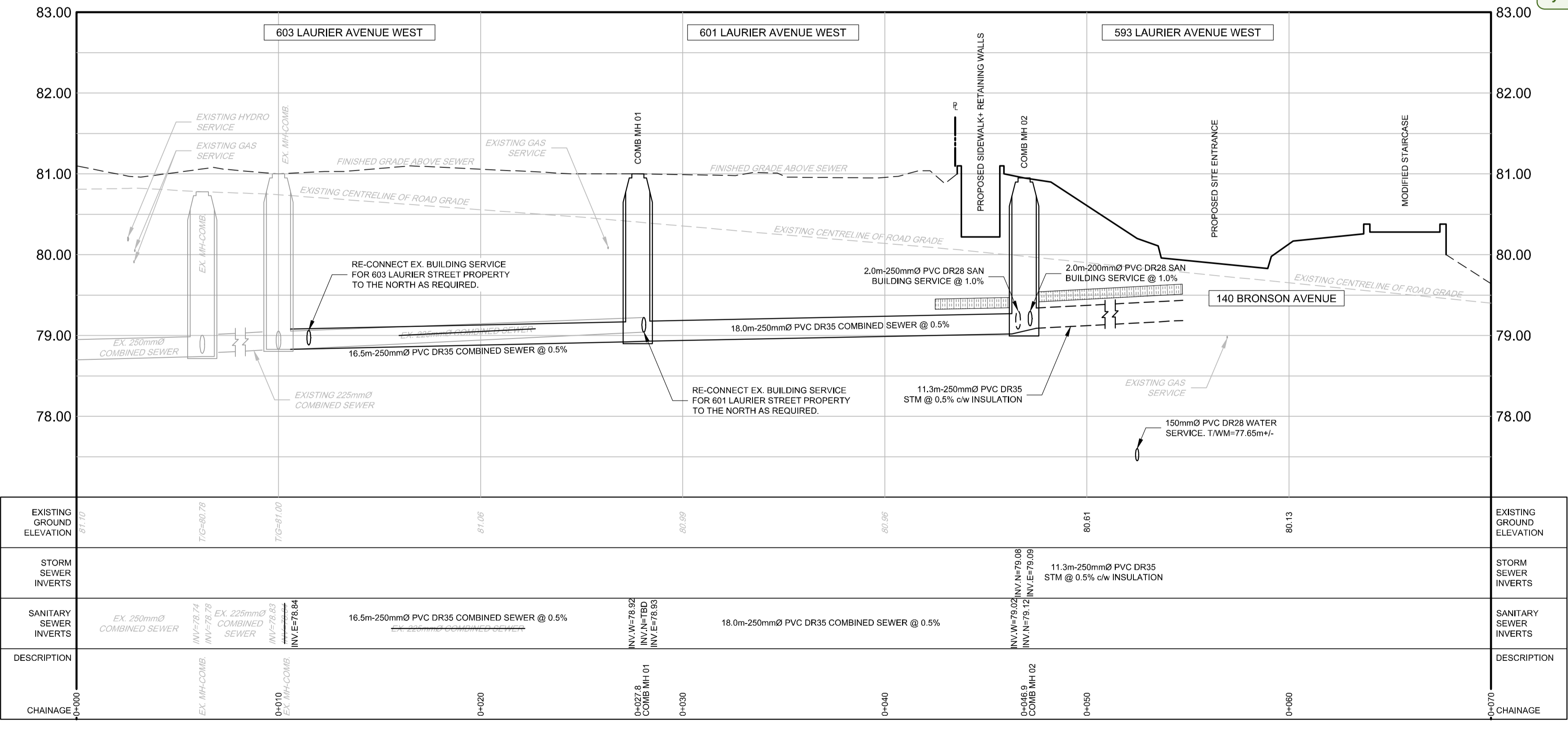

CHAINAGE	EXISTING GROUND ELEVATION	STORM SEWER INVERTS	SANITARY SEWER INVERTS	DESCRIPTION	EXISTING GROUND ELEVATION	STORM SEWER INVERTS	SANITARY SEWER INVERTS	DESCRIPTION
0+000	81.00			EXISTING 250mmØ COMBINED SEWER	81.00			
0+010	81.00			RE-CONNECT EX. BUILDING SERVICE FOR 603 LAURIER STREET PROPERTY TO THE NORTH AS REQUIRED.	81.00			
0+020	81.00			16.5m-250mmØ PVC DR35 COMBINED SEWER @ 0.5%	81.00			
0+030	81.00			COMB MH 01	81.00			
0+040	81.00			18.0m-250mmØ PVC DR35 COMBINED SEWER @ 0.5%	81.00			
0+050	81.00			COMB MH 02	81.00			
0+060	81.00			11.3m-250mmØ PVC DR35 STM @ 0.5% c/w INSULATION	81.00			
0+070	81.00			150mmØ PVC DR28 WATER SERVICE, TWM=77.65m+/-	81.00			

APPROVED
 By Douglas James at 2:36 pm, Aug 12, 2021

NOTE: THE POSITION OF ALL POLE LINES, CONDUITS, WATERMANS, SEWERS AND OTHER UNDERGROUND AND OVERGROUND UTILITIES AND STRUCTURES IS NOT NECESSARILY SHOWN ON THE CONTRACT DRAWINGS, AND WHERE SHOWN, THE ACCURACY OF THE POSITION OF SUCH UTILITIES AND STRUCTURES IS NOT GUARANTEED. BEFORE STARTING WORK, DETERMINE THE EXACT LOCATION OF ALL SUCH UTILITIES AND STRUCTURES AND ASSUME ALL LIABILITY FOR DAMAGE TO THEM.

OWNER INFORMATION
 ALEXANDER FLECK HOUSE INC.
 250 STE ANNE AVENUE,
 OTTAWA, ONTARIO, K1L 7C4
 DENIS MICHAUD
 PHONE: (613) 402-2855
 denis@henryinvestments.ca

No.	REVISION	DATE	BY
1	REVISED SITE PLAN / ISSUED FOR SITE PLAN APPROVAL	JUL 31/20	MS

SCALE

1:150

0 2 4 6

1:75

0 1 2 3

DESIGN: SM / MS
 CHECKED: MS
 DRAWN: SM
 CHECKED: JLS
 APPROVED: MS

FOR REVIEW ONLY

DESIGNER: M. SAVIC
 LICENSED PROFESSIONAL ENGINEER
 100102651
 July 31, 2020
 PROVINCE OF ONTARIO

NOVATECH
 Engineers, Planners & Landscape Architects
 Suite 200, 240 Michael Cowpland Drive
 Ottawa, Ontario, Canada K2M 1P6
 Telephone: (613) 254-9643
 Facsimile: (613) 254-9667
 Website: www.novatech-eng.com

LOCATION
 CITY OF OTTAWA
 593 LAURIER AVENUE

DRAWING NAME
**OUTLET SEWER
 PLAN AND PROFILE**

PROJECT No.: 119019
 REV: REV #1
 DRAWING No.: 119019-PR
 PLAN #18087

D07-12-19-0207