

C:\Fichiers Revit\Locaux\P2BL8_10498.02_ARC_INT_R20_pmqaqueen.rvt

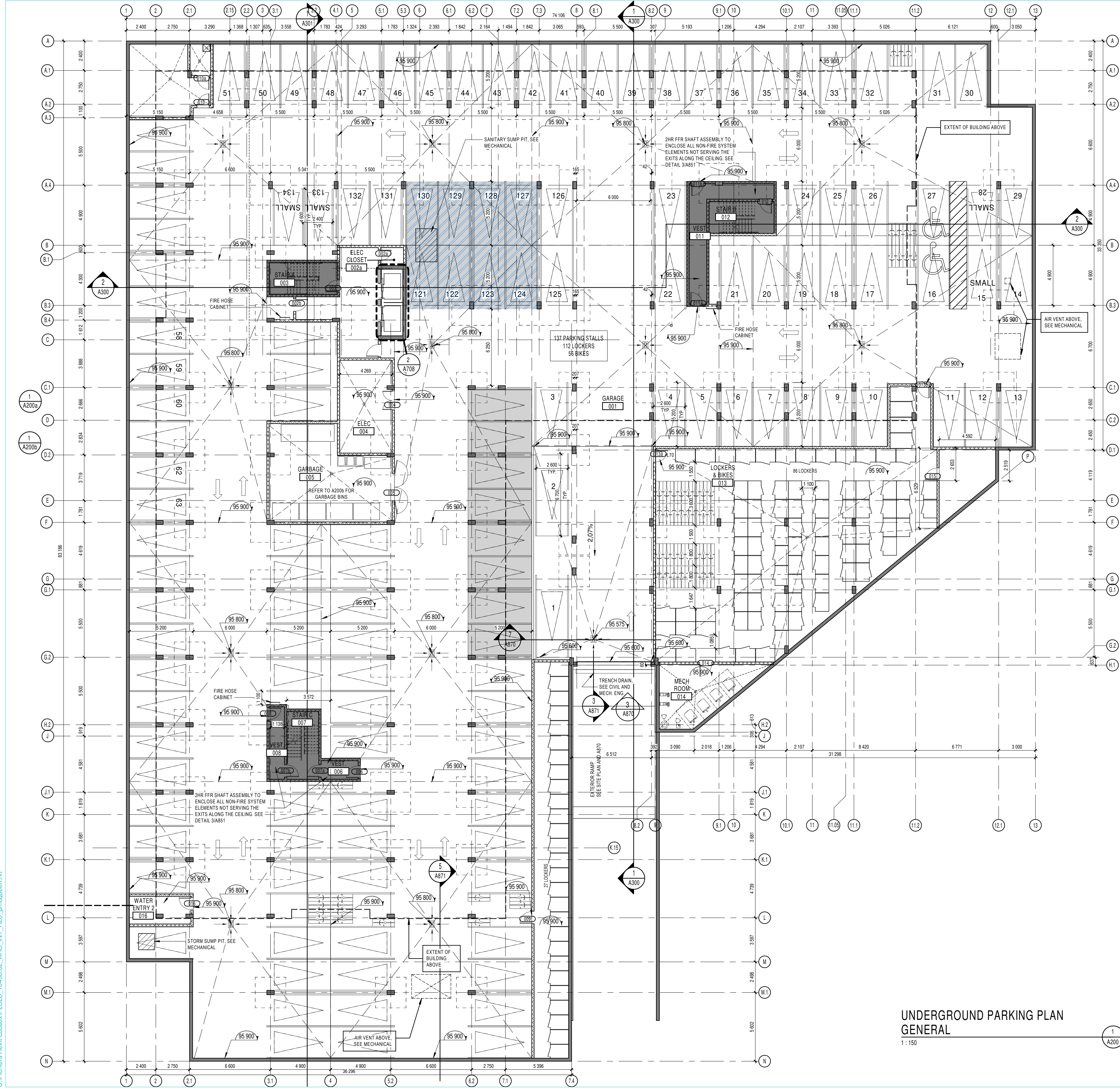

NOTES:

- CREATE SLOPE OF ASPHALT LOCALLY AT THE BASE OF COLUMNS TO REDIRECT WATER AWAY FROM COLUMNS AND TOWARDS DRAINS.
- 2HR FFR SHAFT ASSEMBLY TO ENCLOSE ALL NON-FIRE SYSTEM ELEMENTS NOT SERVING THE EXITS ALONG THE CEILING. SEE DETAIL 3/A851
- A HEADROOM OF 2100mm MUST BE MAINTAINED THROUGHOUT THE ENTIRE BASEMENT.

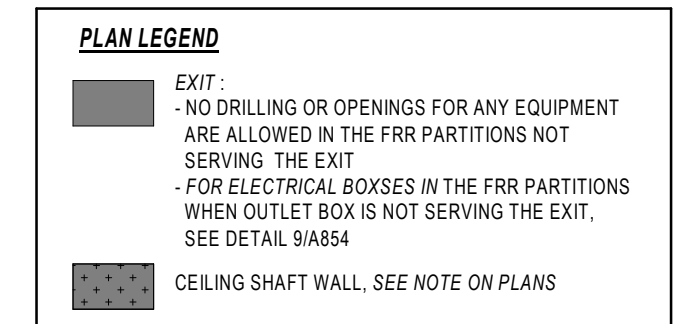
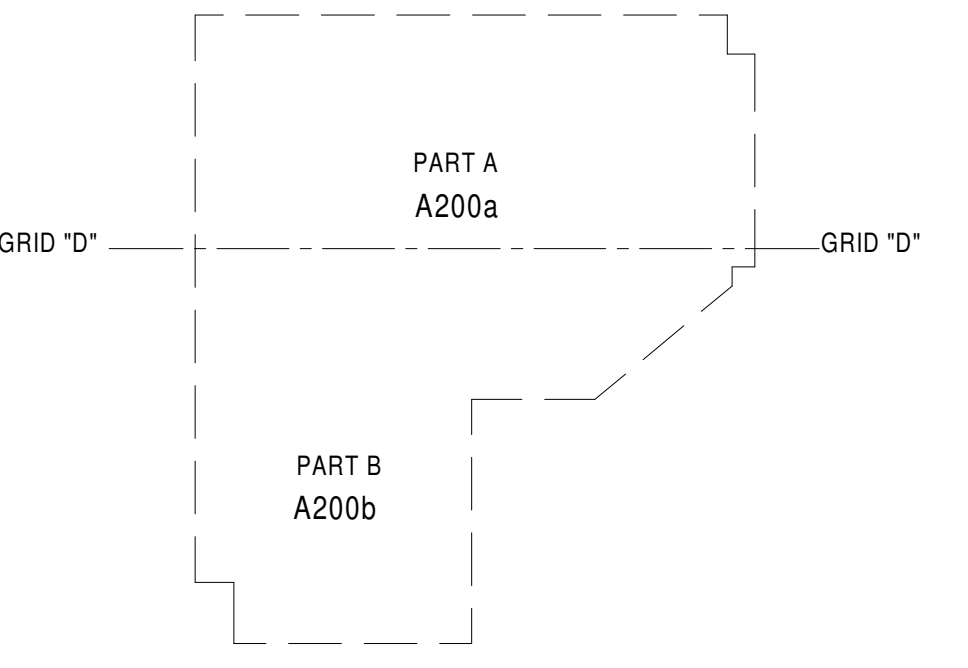
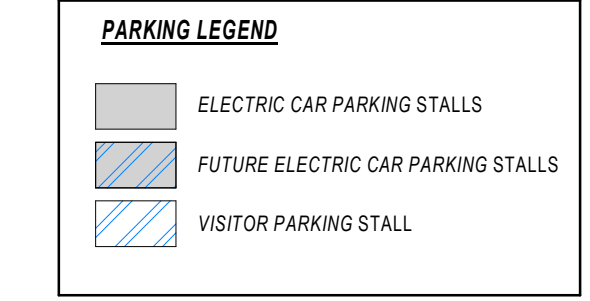

G. Wildman

GERALDINE WILDMAN
ACTING MANAGER, DEVELOPMENT REVIEW EAST
PLANNING, REAL ESTATE & ECONOMIC DEVELOPMENT
DEPARTMENT, CITY OF OTTAWA

APPROVED
By wildmange at 7:12 pm, Jun 01, 2022

UNDERGROUND PARKING PLAN GENERAL
1:150

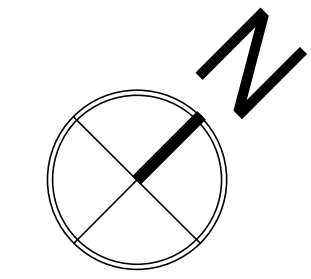

NOTES GÉNÉRALES / General Notes

- Ces documents d'architecture sont la propriété exclusive de NEUF architecte et ne peuvent être utilisés, reproduits ou copiés sans autorisation écrite préalable. / These architectural documents are the exclusive property of NEUF architecte and cannot be used, copied or reproduced without written pre-authorization.
- Les dimensions apparaissant sur ces documents doivent être vérifiées par l'entrepreneur avant le début des travaux. / All dimensions which appear on the documents must be verified by the contractor before to start the work.
- Veuillez aviser l'architecte de toute dimension erreur et/ou divergence entre ces documents et ceux des autres professionnels. / The architect must be notified of all errors, omissions and discrepancies between these documents and those of the other professionals.
- Les dimensions sur ces documents doivent être lues et non mesurées. / The dimensions on these documents must be read and not measured.

GEOTECHNIQUE / Geotechnical
Paterson Group Inc.
154 Colborne Road South Ottawa (Nepean), Ontario Canada K2E 7J5
T 613 226-7381 www.patersongroup.ca

MÉCANIQUE ÉLECTRIQUE / Mechanical Electrical
LCA
15, rue Du Valcourt, unité 6, Gatineau, Québec J8T 8H1
T 819 24-8383 www.larouchecostel.com

STRUCTURE / structure
gdi
635, boulevard de la Gappe, gatineau (QC) J8T 8G1
T 819 243-4424 lgdi.ca

ARCHITECTURE DE PAYSAGE / Landscape Architect
Lovestek Consultants
5977 Hugh Crofton, Ottawa ON K0K 0V0
T 613 825 0518 larocquelovestek.com

CIVIL / Civil
Stantec
400 - 1331 Crysler Avenue, Ottawa ON K2C 3G4
T 613 724 6337 krc.albor@stantec.com

ARCHITECTES / Architect
NEUF architecte(s) SENCL
630, St-J. René-Lévesque O. 52e étage, Montréal QC H3B 1S6
T 514 847 1117 NEUFArchitectes.com

SCEAU / Seal

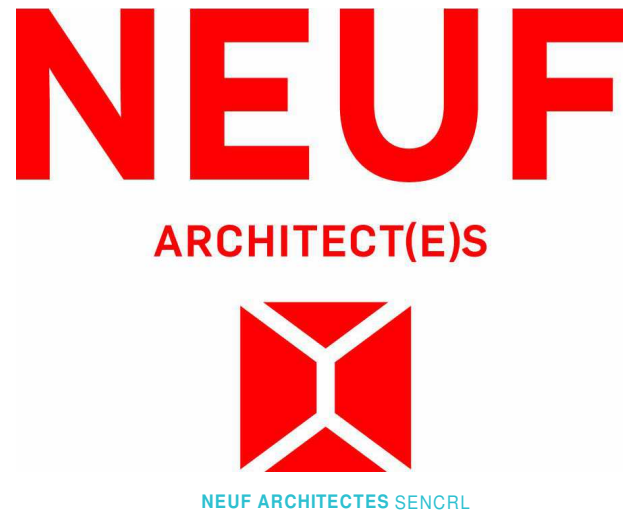
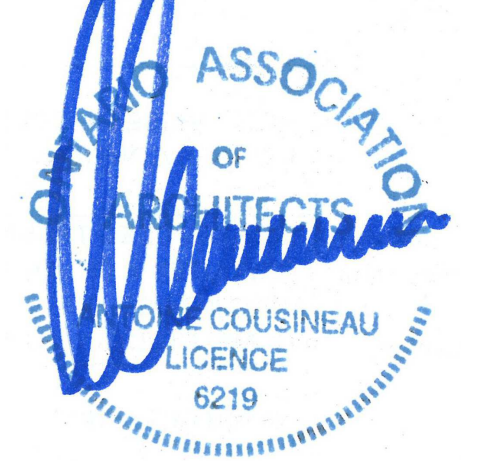

CLIENT Client
brigi

OUVRAGE / Project
PETRIES II BLOCK 8
112 units

EMPLACEMENT / Location NO PROJET No.
ORLEANS, ON 10498.02

NO	RÉVISION	DATE (aa-mm-ii)
A	Issue to the city	2021-06-10
B	Issue for Coordination	2021-07-16
C	Issued for Coordination	2021-08-13
D	Issued for Permit (Cancelled)	2021-08-30
E	Issued for Coordination	2021-09-08
F	Issued for SPA	2021-09-23
G	Issued for Coordination	2021-09-24
H	Issued for Full Building Permit	2021-10-01
I	Issued for Coordination	2021-10-06
J	Issued for Tender	2021-10-15
K	Permit 1st Review	2021-12-03
L	Issued for Coordination	2022-02-11
M	Issued for SPA	2022-02-25

DESSIN PAR Drawn by
PM

VERIFIÉ PAR Checked by
Paul McQ.

DATE (aa.mm.ii)
07/29/10

ECHELLE Scale
As indicated

UNDERGROUND PARKING PLAN GENERAL

RÉVISION Revision NO. DESSIN Dwg Number
M A200

DATE 07/29/10

PLAN LEGEND

- EXIT
- NO DRILLING OR OPENINGS FOR ANY EQUIPMENT ARE ALLOWED IN THE FRP PARTITIONS NOT SERVING THE EXIT
- FOR ELECTRICAL BOXES IN THE FRP PARTITIONS WHEN OUTLET BOX IS NOT SERVING THE EXIT. SEE DETAIL 3/AS4
- CEILING SHAFT WALL. SEE NOTE ON PLANS

PARKING LEGEND

- ELECTRIC CAR PARKING STALLS
- FUTURE ELECTRIC CAR PARKING STALLS
- VISITOR PARKING STALL

APPROVED
By wildmange at 7:13 pm, Jun 01, 2022

G. Wildman

GERALDINE WILDMAN
ACTING MANAGER, DEVELOPMENT REVIEW EAST
PLANNING, REAL ESTATE & ECONOMIC DEVELOPMENT
DEPARTMENT, CITY OF OTTAWA

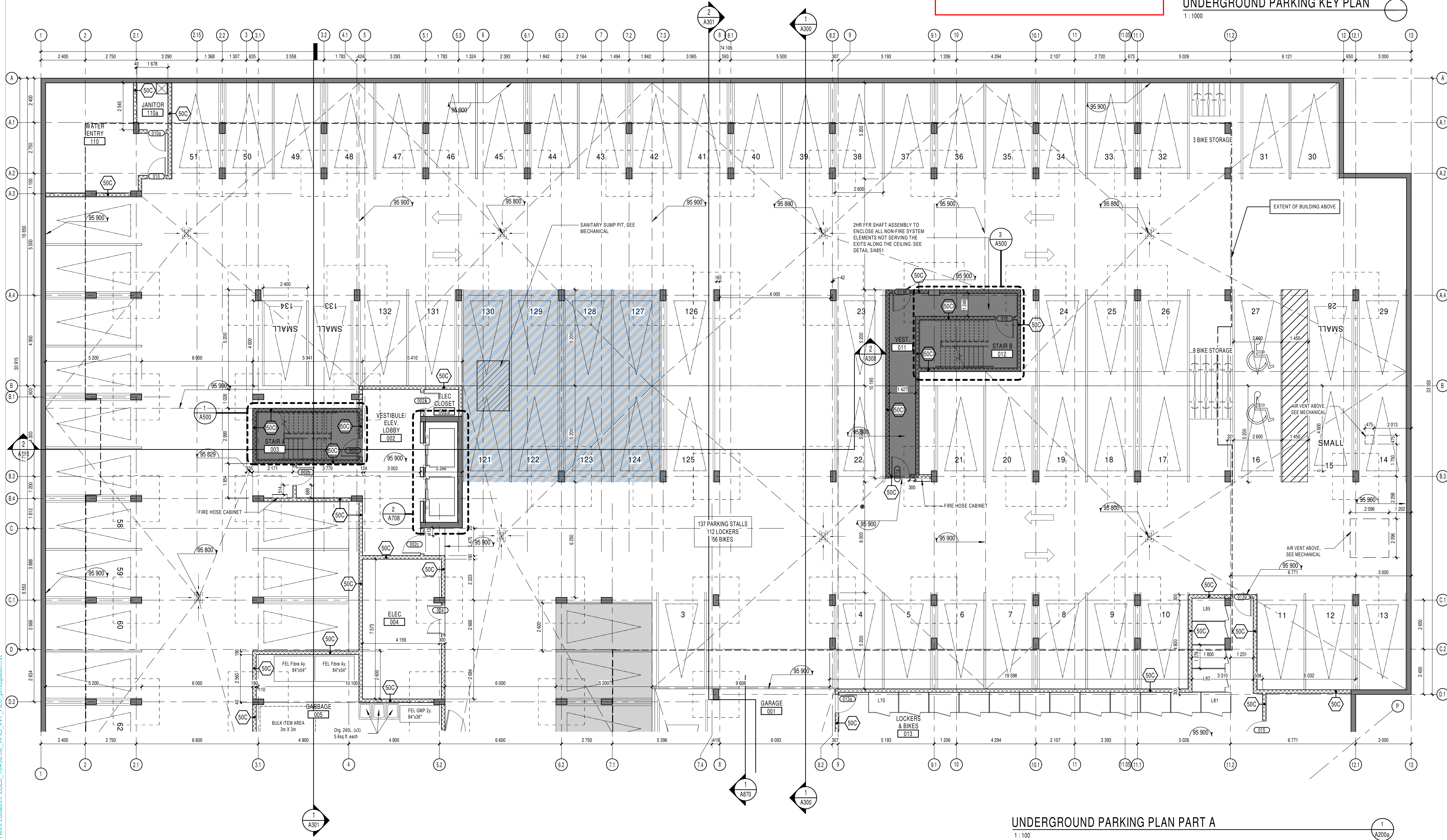
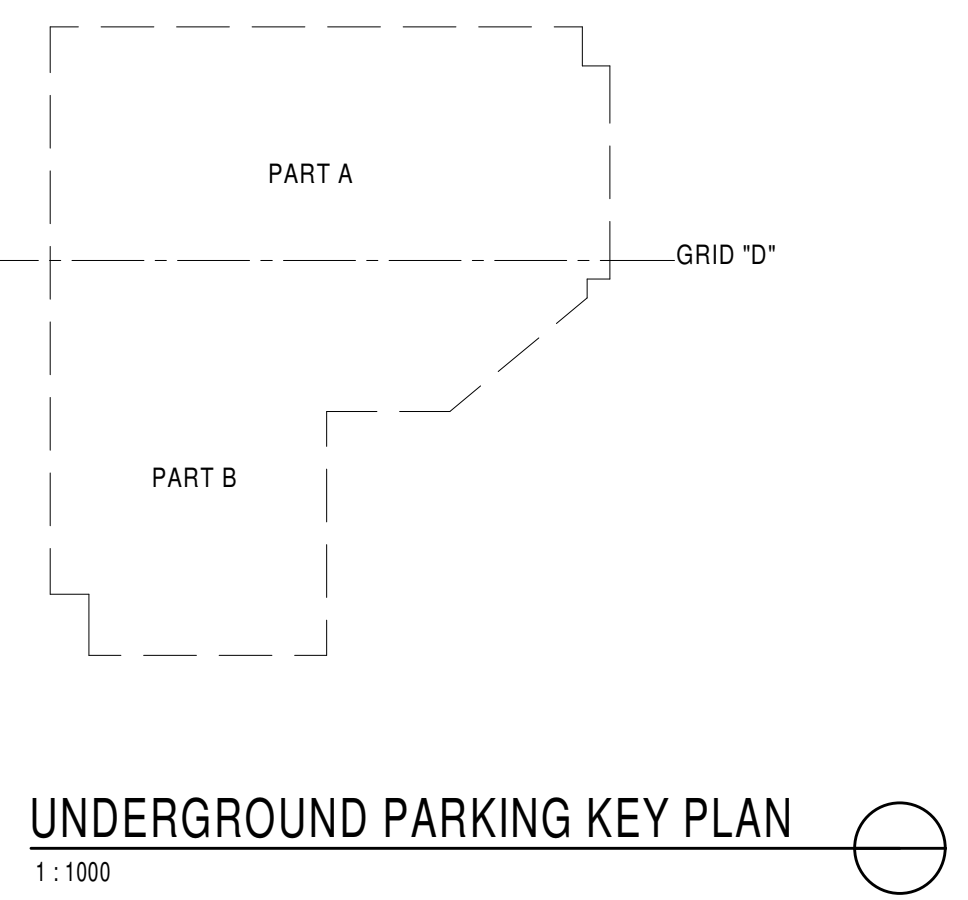

NOTES GÉNÉRALES / General Notes

- Ces documents d'architecture sont la propriété exclusive de NEUF architecte et ne peuvent être utilisés, reproduits ou copiés sans autorisation écrite préalable. / These architectural documents are the exclusive property of NEUF architecte and cannot be used, copied or reproduced without written pre-authorization.
- Les dimensions apparaissant sur ces documents doivent être vérifiées par l'entrepreneur avant le début des travaux. / All dimensions which appear on the documents must be verified by the contractor before to start the work.
- Veuillez aviser l'architecte de toute dimension erreur et/ou divergence entre ces documents et ceux des autres professionnels. / The architect must be notified of all errors, omissions and discrepancies between these documents and those of the others professionals.
- Les dimensions sur ces documents doivent être lues et non mesurées. / The dimensions on these documents must be read and not measured.

GEOTECHNIQUE / Geotechnical
Paterson Group Inc.
154 Colomède Road South Ottawa (Nepere), Ontario Canada K2E 7J5
T 613 226-7381 www.patersongroup.ca

MÉCANIQUE ÉLECTRIQUE / Mechanical Electrical
LCA
15, rue De Valcourt, unité 6, Gatineau Québec J8T 8H1
T 819 24-8383 www.larouchecanada.ca

STRUCTURE / structure
qdi
635, boulevard de la Gaspé, gatineau (QC) J8T 8G1
T 819 243-4424 qdi.ca

ARCHITECTURE DE PAYSAGE / Landscape Architect
Levstek Consultants
5871 High Street, Ottawa ON K0K 0V0
T 613 825 0518 levstekconsultants.com

CIVIL / Civil
Stantec
400 - 1331 Clys Avenue, Ottawa ON K2C 3G4
T 613 724-6337 krc.albor@stantec.com

ARCHITECTES / Architect
NEUF architecte(s) SENCL
630, St-J. René-Lévesque O. 52e étage, Montréal QC H3B 1S6
T 514 847 1117 NEUFarchitectes.com

SCEAU / Seal

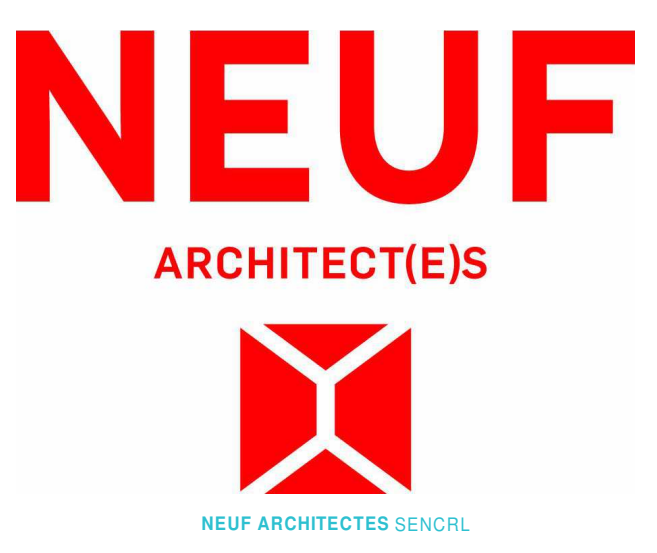

CLIENT / Client
brigi

OUVRAGE / Project
PETRIES II BLOCK 8
112 units
ORLEANS, ON

NO	RÉVISION	DATE (aa-mm-ii)
A	Issue for Coordination	2021-07-16
B	Issued for Coordination	2021-08-13
C	Issued for Permit (Cancelled)	2021-08-30
D	Issued for Coordination	2021-09-08
E	Issued for SPA	2021-09-23
F	Issued for Coordination	2021-09-24
G	Issued for Full Building Permit	2021-10-01
H	Issued for Coordination	2021-10-06
J	Issued for Tender	2021-10-15
K	Permit 2nd Review	2022-01-14
L	Issued for Coordination	2022-02-11
L	Issued for SPA	2022-02-25

DESSIN PAR / Drawn by
PM

VÉRIFIÉ PAR / Checked by
Paul McQ.

DATE (aa.mm.ii)
07/11/18

ÉCHELLE / Scale
As indicated

UNDERGROUND PARKING PLAN PART A

REVISION / Revision

NO. DESSIN / Dwg Number
A200a

#18062

C:\Fichiers Revit\Locaux\P2BL8_10498.02_ARC_INT_R20_pmqueen.rvt

PLOT DATE:2022-02-28 12:37:39 PM

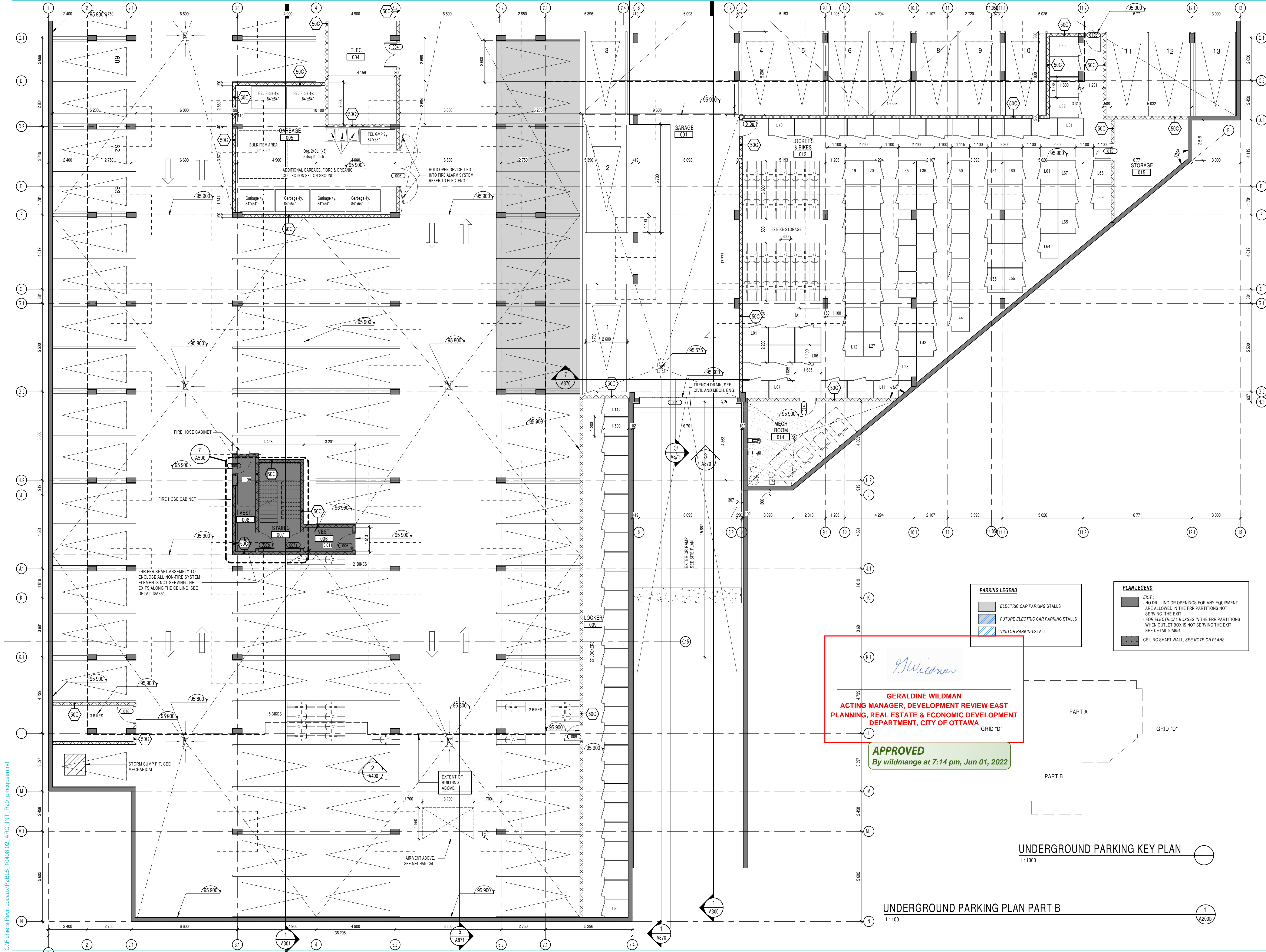

NOTES GÉNÉRALES / General Notes

- Ces documents d'architecture sont la propriété exclusive de NEUF architecte et ne peuvent être utilisés, reproduits ou copiés sans autorisation écrite préalable. / These architectural documents are the exclusive property of NEUF architecte and cannot be used, copied or reproduced without written pre-authorization.
- Les dimensions apparaissant sur les documents doivent être vérifiées par l'entrepreneur avant le début des travaux. / All dimensions which appear on the documents must be verified by the contractor before to start the work.
- Vous devez aviser l'architecte de toute dimension erronée et/ou divergences entre ces documents et ceux des autres professionnels. / The architect must be notified of all errors, omissions and discrepancies between these documents and those of the other professionals.
- Les dimensions sur ces documents doivent être lues et non mesurées. / The dimensions on these documents must be read and not measured.

GÉOTECHNIQUE / Geotechnical
Paterson Group Inc.
 154 Colomède Road South Ottawa (Nearpark), Ontario Canada K2E 7J5
 T 819 226-7381 www.patersongroup.ca

MÉCANIQUE ÉLECTRIQUE / Mechanical Electrical
LCA
 15, rue De Valcourt, unité 6, Gatineau, Québec J8T 8H1
 T 819 243-8383 www.larouchecostel.ca

STRUCTURE / structure
qdi
 635, boulevard de la Gappe, gatineau (QC) J8T 8G1
 T 819 243-4474 qdi.ca

ARCHITECTURE DE PAYSAGE / Landscape Architect
Levstek Consultants
 5971, Crémont, Ottawa ON K6A 0V6
 T 613 825 0518 larocquelevstek.com

CIVIL / Civil
Stantec
 400 - 1331 Clys Avenue, Ottawa ON K2C 3G4
 T 613 724-6337 krc.albor@stantec.com

ARCHITECTES / Architect
NEUF architect(e)s SENCRAL
 630, St-Jas, Rémix-Lévesque O. 52e étage, Montréal QC H3B 1S6
 T 514 847 1117 NEUFarchitectes.com

SCEAU / Seal

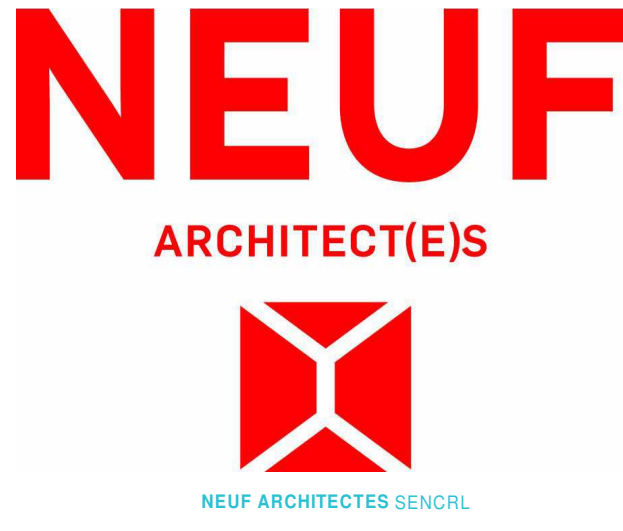

CLIENT / Client
brigi

OUVRAGE / Project
PETRIES II BLOCK 8
 112 units
 ORLEANS, ON

NO	RÉVISION	DATE (aa-mm-jj)
A	Issue for Coordination	2021-07-16
B	Issued for Coordination	2021-08-13
C	Issued for Permit (Cancelled)	2021-08-30
D	Issued for Coordination	2021-09-08
E	Issued for SPA	2021-09-23
F	Issued for Coordination	2021-09-24
G	Issued for Full Building Permit	2021-10-01
H	Issued for Coordination	2021-10-06
J	Issued for Tender	2021-10-15
J	Permit 2nd Review	2022-01-14
K	Issued for Coordination	2022-02-11
L	Issued for SPA	2022-02-25

DESSINÉ PAR / Drawn by
 PM

VÉRIFIÉ PAR / Checked by
 Paul McQ.

DATE (aa.mm.jj)
 07/11/18

ÉCHELLE / Scale
 As indicated

TITRE DU DESSIN / Drawing Title
UNDERGROUND PARKING PLAN PART B

RÉVISION / Revision
L

NO. DESSIN / Dwg Number
A200b

G. Wildman
GERALDINE WILDMAN
 ACTING MANAGER, DEVELOPMENT REVIEW EAST
 PLANNING, REAL ESTATE & ECONOMIC DEVELOPMENT
 DEPARTMENT, CITY OF OTTAWA

APPROVED
 By wildmange at 7:14 pm, Jun 01, 2022

UNDERGROUND PARKING KEY PLAN
 1:1000

UNDERGROUND PARKING PLAN PART B
 1:100

C:\Fichiers Revit\Locaux\P2BL8_10498.02_ARC_INT_R20_pmaqueen.rvt