

C:\Fichiers Revit\Locaux\P2BL8\_10498.02\_ARC\_INT\_R20\_pmqaqueen.rvt

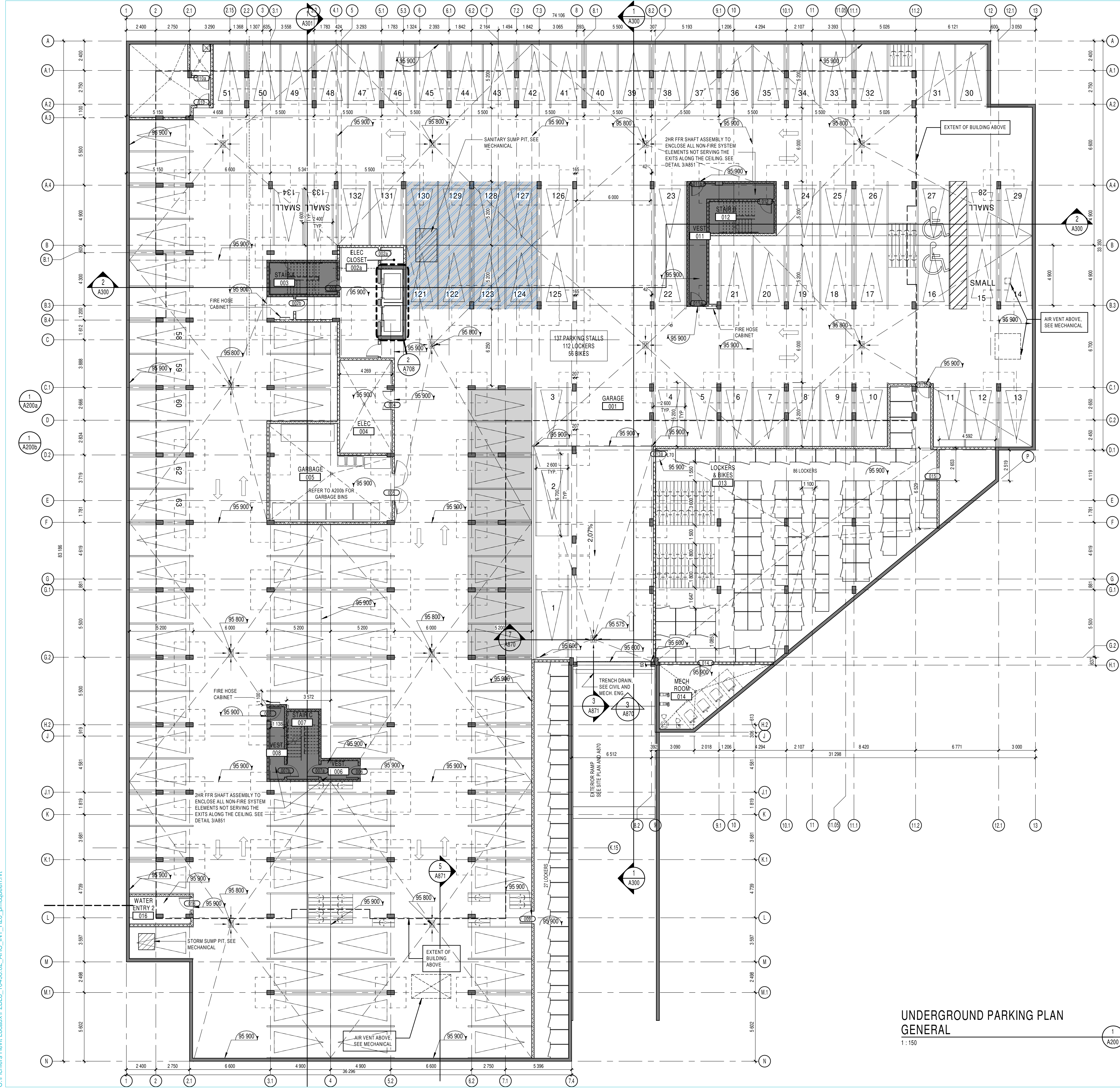

**NOTES:**

- CREATE SLOPE OF ASPHALT LOCALLY AT THE BASE OF COLUMNS TO REDIRECT WATER AWAY FROM COLUMNS AND TOWARDS DRAINS.
- 2HR FFR SHAFT ASSEMBLY TO ENCLOSE ALL NON-FIRE SYSTEM ELEMENTS NOT SERVING THE EXITS ALONG THE CEILING. SEE DETAIL 3/A851
- A HEADROOM OF 2100mm MUST BE MAINTAINED THROUGHOUT THE ENTIRE BASEMENT.

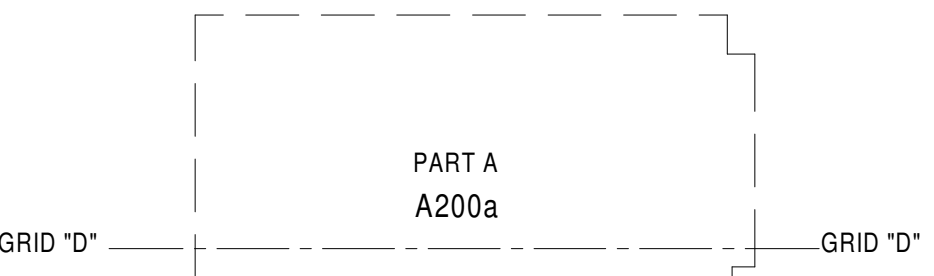
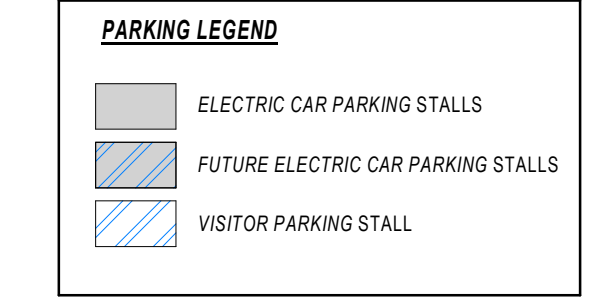

**UNDERGROUND PARKING KEY PLAN**  
1:1000

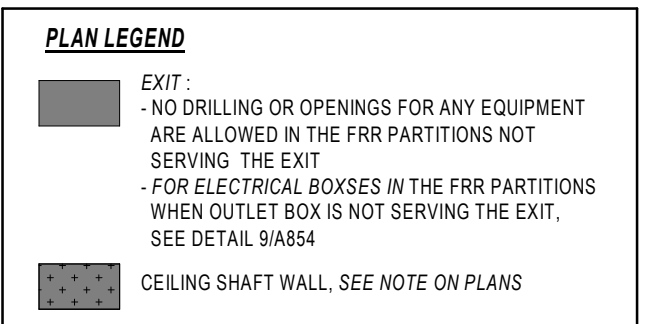

**UNDERGROUND PARKING PLAN GENERAL**  
1:150

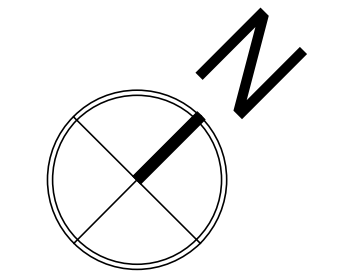

**NOTES GÉNÉRALES / General Notes**

- Ces documents d'architecture sont la propriété exclusive de NEUF architecte et ne peuvent être utilisés, reproduits ou copiés sans autorisation écrite préalable. / These architectural documents are the exclusive property of NEUF architecte and cannot be used, copied or reproduced without written pre-authorization.
- Les dimensions apparaissant sur ces documents doivent être vérifiées par l'entrepreneur avant le début des travaux. / All dimensions which appear on the documents must be verified by the contractor before to start the work.
- Veuillez aviser l'architecte de toute dimension erreur et/ou divergence entre ces documents et ceux des autres professionnels. / The architect must be notified of all errors, omissions and discrepancies between these documents and those of the other professionals.
- Les dimensions sur ces documents doivent être lues et non mesurées. / The dimensions on these documents must be read and not measured.

**GEOTECHNIQUE / Geotechnical**  
**Paterson Group Inc.**  
154 Colomdale Road South Ottawa (Nepean), Ontario Canada K2E 7J5  
T 613 226-7381 www.patersongroup.ca

**MÉCANIQUE ÉLECTRIQUE / Mechanical Electrical**  
**LCA**  
15, rue Du Valcourt, unité 6, Gatineau, Québec J8T 8H1  
T 819 24-8383 www.larouchecollec.com

**STRUCTURE / structure**  
**gdi**  
635, boulevard de la Gaspie, gatineau (QC) J8T 8G1  
T 819 243-4424 lgdi.ca

**ARCHITECTURE DE PAYSAGE / Landscape Architect**  
**Lestek Consultants**  
5971 Hugh Crockett, Ottawa ON K0A 0V0  
T 613 825 0518 larc@lestek.com

**CIVIL / Civil**  
**Stantec**  
400 - 1331 Clys Avenue, Ottawa ON K2C 3G4  
T 613 724-6337 krc.albor@stantec.com

**ARCHITECTES / Architect**  
**NEUF architect(e)s** SENCRL  
630, St-J. René-Lévesque O. 52e étage, Montréal QC H3B 1S6  
T 514 847 1117 NEUFarchitectes.com

**SCEAU / Seal**

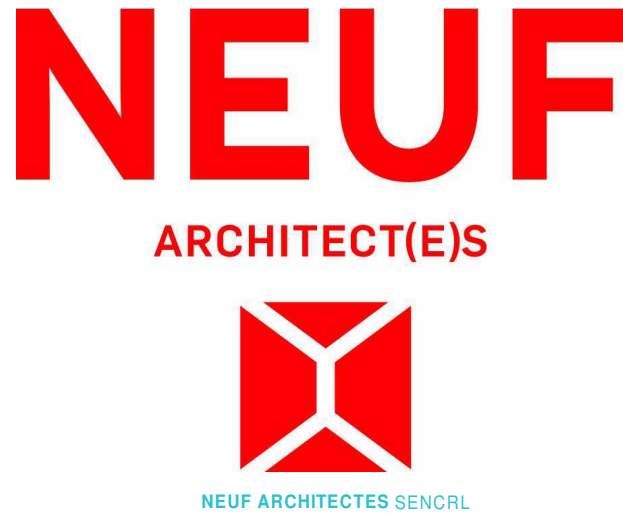

**CLIENT / Client**  
**brigi**

**OUVRAGE / Project**  
**PETRIES II BLOCK 8**  
**112 units**  
EMPLACEMENT / Location NO PROJET No.  
ORLEANS, ON 10498.02

NO	RÉVISION	DATE (aa-mm-jj)
A	Issue to the city	2021-06-10
B	Issue for Coordination	2021-07-16
C	Issued for Coordination	2021-08-13
D	Issued for Permit (Cancelled)	2021-08-30
E	Issued for Coordination	2021-09-08
F	Issued for SPA	2021-09-23
G	Issued for Coordination	2021-09-24
H	Issued for Full Building Permit	2021-10-01
I	Issued for Coordination	2021-10-06
J	Issued for Tender	2021-10-15
K	Permit 1st Review	2021-12-03
L	Issued for Coordination	2022-02-11
M	Issued for SPA	2022-02-25

DESSIN PAR / Drawn by **PM** VÉRIFIÉ PAR / Checked by **Paul McQ.**  
DATE (aa.mm.jj) **07/29/10** ÉCHELLE / Scale **As indicated**

TITRE DU DESSIN / Drawing Title  
**UNDERGROUND PARKING PLAN GENERAL**

RÉVISION / Revision **M** NO. DESSIN / Dwg Number **A200**  
#18062



**PLAN LEGEND**

- EXIT - NO DRILLING OR OPENINGS FOR ANY EQUIPMENT ARE ALLOWED IN THE FRP PARTITIONS NOT SERVING THE EXIT
- FOR ELECTRICAL BOXES IN THE FRP PARTITIONS WHEN OUTLET BOX IS NOT SERVING THE EXIT. SEE DETAIL 3/AS4
- CEILING SHAFT WALL. SEE NOTE ON PLANS

**PARKING LEGEND**

- ELECTRIC CAR PARKING STALLS
- FUTURE ELECTRIC CAR PARKING STALLS
- VISITOR PARKING STALL

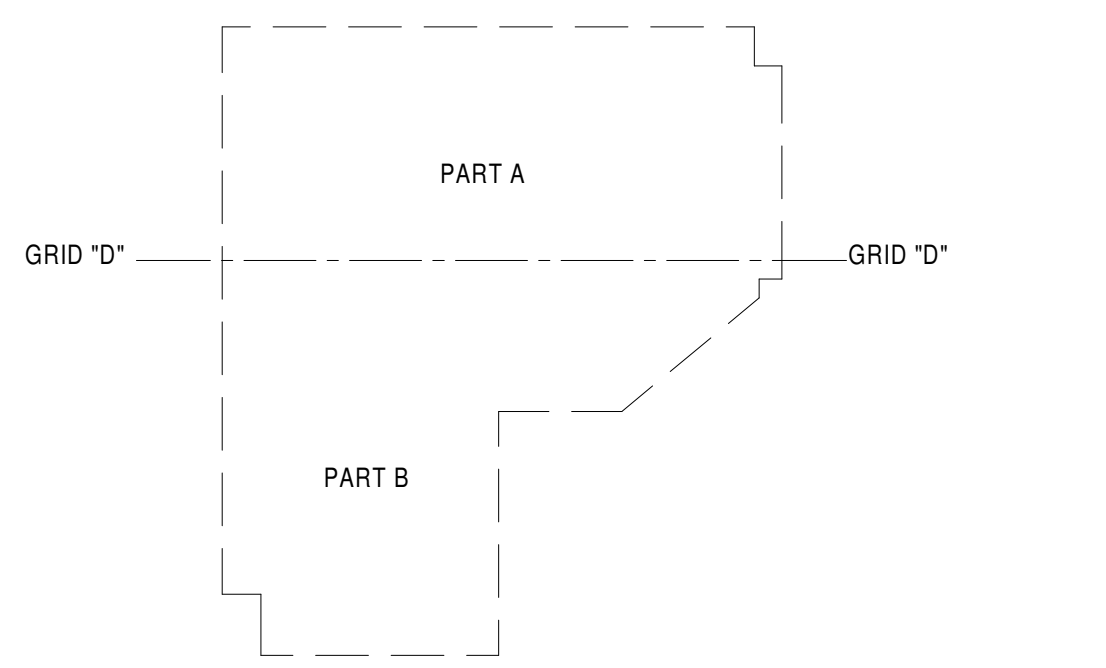

**UNDERGROUND PARKING KEY PLAN**  
1:1000

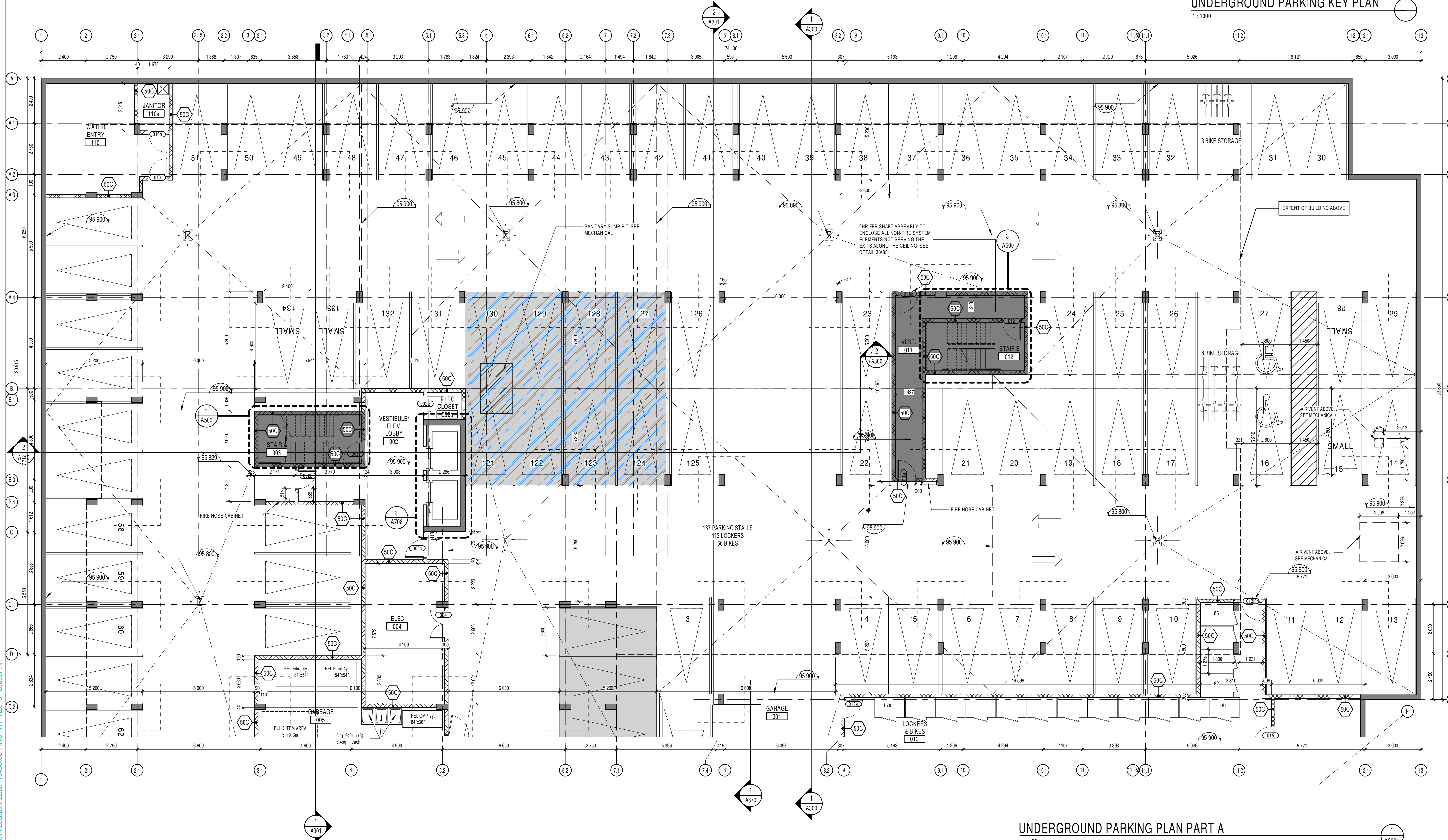

**UNDERGROUND PARKING PLAN PART A**  
1:100

**NOTES GÉNÉRALES / General Notes**

- Ces documents d'architecture sont la propriété exclusive de NEUF architecte et ne peuvent être utilisés, reproduits ou copiés sans autorisation écrite préalable. / These architectural documents are the exclusive property of NEUF architecte and cannot be used, copied or reproduced without written pre-authorization.
- Les dimensions apparaissant sur ces documents doivent être vérifiées par l'entrepreneur avant le début des travaux. / All dimensions which appear on the documents must be verified by the contractor before to start the work.
- Veuillez aviser l'architecte de toute dimension erreur et/ou divergence entre ces documents et ceux des autres professionnels. / The architect must be notified of all errors, omissions and discrepancies between these documents and those of the others professionals.
- Les dimensions sur ces documents doivent être lues et non mesurées. / The dimensions on these documents must be read and not measured.

**GEOTECHNIQUE / Geotechnical**  
**Paterson Group Inc.**  
154 Colomade Road South Ottawa (Nepere), Ontario Canada K2E 7J5  
T 613 226-7381 www.patersongroup.ca

**MÉCANIQUE ÉLECTRIQUE / Mechanical Electrical**  
**LCA**  
15, rue De Valcourt, unité 6, Gatineau Québec J8T 8H1  
T 819 24-8383 www.larouchecanestel.ca

**STRUCTURE / structure**  
**qdi**  
635, boulevard de la Gaspé, gatineau (QC) J8T 8G1  
T 819 243-4424 qdi.ca

**ARCHITECTURE DE PAYSAGE / Landscape Architect**  
**Levstek Consultants**  
5871 High Street, Ottawa ON K2K 0V4  
T 613 825 0518 larouchelevstek.com

**CIVIL / Civil**  
**Stantec**  
400 - 1331 Clys Avenue, Ottawa ON K2C 3G4  
T 613 724-6337 krs.albor@stantec.com

**ARCHITECTES / Architect**  
**NEUF architecte(s) SENCL**  
630, St-J. René-Lévesque O. 52e étage, Montréal QC H3B 1S6  
T 514 847 1117 NEUFarchitectes.com

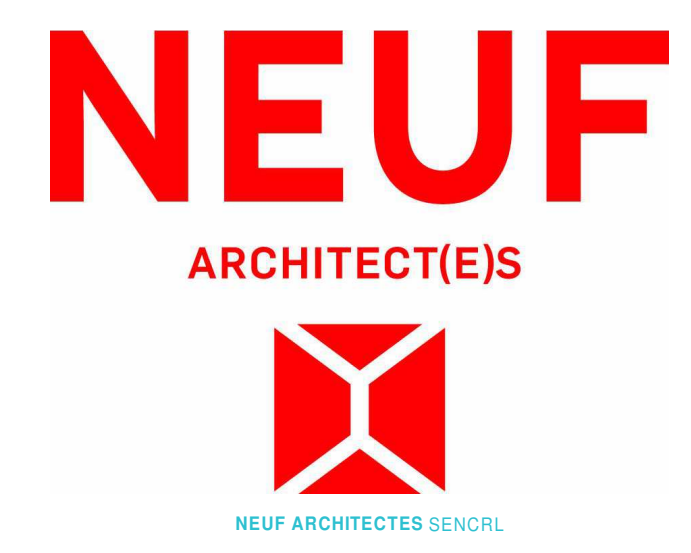

**CLIENT / Client**  
**brigi**

**OUVRAGE / Project**  
**PETRIES II BLOCK 8**  
112 units  
ORLEANS, ON

NO	RÉVISION	DATE (aa-mm-ii)
A	Issue for Coordination	2021-07-16
B	Issued for Coordination	2021-08-13
C	Issued for Permit (Cancelled)	2021-08-30
D	Issued for Coordination	2021-09-08
E	Issued for SPA	2021-09-23
F	Issued for Coordination	2021-09-24
G	Issued for Full Building Permit	2021-10-01
H	Issued for Coordination	2021-10-06
J	Issued for Tender	2021-10-15
K	Permit 2nd Review	2022-01-14
L	Issued for Coordination	2022-02-11
M	Issued for SPA	2022-02-25

DESSIN PAR Drawn by: **PM**  
DATE (aa.mm.ii): **07/11/18**  
TITRE DU DESSIN Drawing Title:

VERIFIÉ PAR Checked by: **Paul McQ.**  
ÉCHELLE Scale: **As indicated**

**UNDERGROUND PARKING PLAN PART A**  
NO. DESSIN Dwg Number: **A200a**  
#18062

C:\Fichiers Revit\Locaux\P2BL8\_10498.02\_ARC\_INT\_R20\_pmqueen.rvt



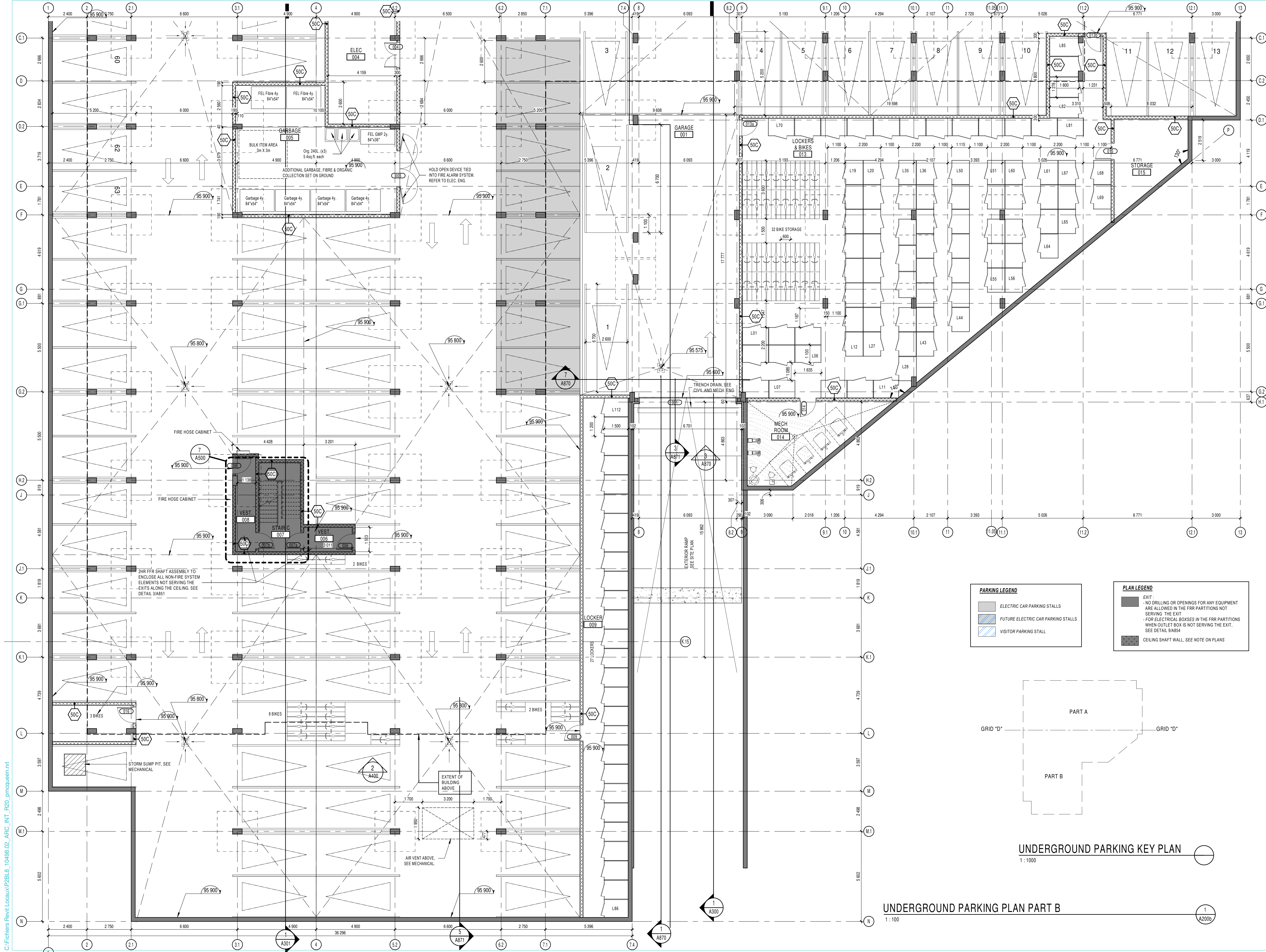

**PARKING LEGEND**

- ELECTRIC CAR PARKING STALLS
- FUTURE ELECTRIC CAR PARKING STALLS
- VISITOR PARKING STALL

**PLAN LEGEND**

- EXIT: NO DRILLING OR OPENINGS FOR ANY EQUIPMENT ARE ALLOWED IN THE FRR PARTITIONS NOT SERVING THE EXIT
- FOR ELECTRICAL BOXES IN THE FRR PARTITIONS WHEN OUTLET BOX IS NOT SERVING THE EXIT, SEE DETAIL 9/A854
- CEILING SHAFT WALL, SEE NOTE ON PLANS

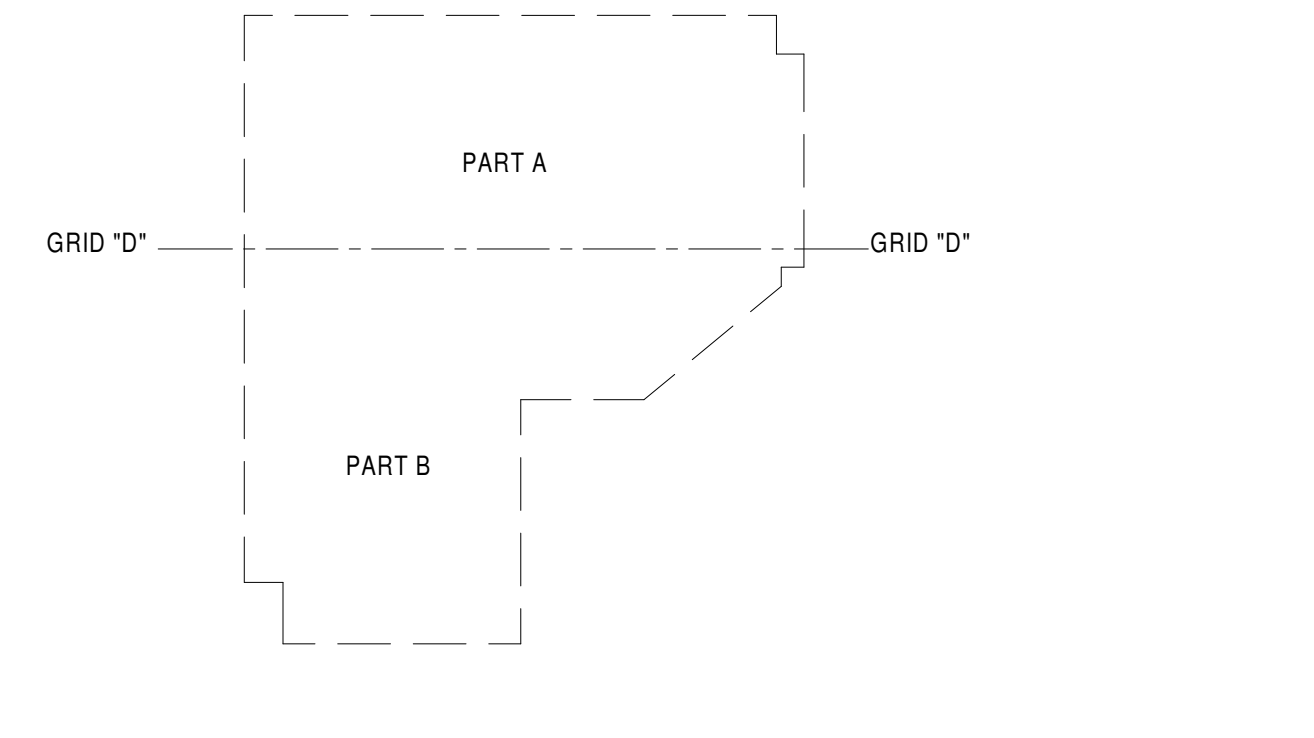

UNDERGROUND PARKING KEY PLAN  
1:1000

UNDERGROUND PARKING PLAN PART B  
1:100

**NOTES GÉNÉRALES / General Notes**

- Ces documents d'architecture sont la propriété exclusive de NEUF architecte et ne peuvent être utilisés, reproduits ou copiés sans autorisation écrite préalable. / These architectural documents are the exclusive property of NEUF architecte and cannot be used, copied or reproduced without written pre-authorization.
- Les dimensions apparaissant sur les documents doivent être vérifiées par l'entrepreneur avant le début des travaux. / All dimensions which appear on the documents must be verified by the contractor before to start the work.
- Veillez aviser l'architecte de toute dimension erreur et/ou divergence entre ces documents et ceux des autres professionnels. / The architect must be notified of all errors, omissions and discrepancies between these documents and those of the other professionals.
- Les dimensions sur ces documents doivent être lues et non mesurées. / The dimensions on these documents must be read and not measured.

**GÉOTECHNIQUE / Geotechnical**  
**Paterson Group Inc.**  
154 Colomade Road South Ottawa (Nearpark), Ontario Canada K2E 7J5  
T 819 226-7381 www.patersongroup.ca

**MÉCANIQUE ÉLECTRIQUE / Mechanical Electrical**  
**LCA**  
15, rue De Valcourt, unité 6, Gatineau, Québec J8T 8H1  
T 819 24-8383 www.larouchecostel.ca

**STRUCTURE / structure**  
**qdi**  
635, boulevard de la Gappe, gatineau (QC) J8T 8G1  
T 819 243-4474 qdi.ca

**ARCHITECTURE DE PAYSAGE / Landscape Architect**  
**Lestek Consultants**  
5971, Crémont, Ottawa ON K0A 0V0  
T 613 825 0518 lestekconsultants.com

**CIVIL / Civil**  
**Stantec**  
400 - 1331 Clys Avenue, Ottawa ON K2C 3G4  
T 613 724-6337 krc.albor@stantec.com

**ARCHITECTES / Architect**  
**NEUF architect(e)s SENCRAL**  
630, St-J. René-Lévesque O. 52e étage, Montréal QC H3B 1S6  
T 514 847 1117 NEUFarchitectes.com

**SCEAU / Seal**



**CLIENT / Client**  
**brigi**

**OUVRAGE / Project**  
**PETRIES II BLOCK 8**  
112 units  
ORLEANS, ON

NO	RÉVISION	DATE (aa-mm-ii)
A	Issue for Coordination	2021-07-16
B	Issued for Coordination	2021-08-13
C	Issued for Permit (Cancelled)	2021-08-30
D	Issued for Coordination	2021-09-08
E	Issued for SPA	2021-09-23
F	Issued for Coordination	2021-09-24
G	Issued for Full Building Permit	2021-10-01
H	Issued for Coordination	2021-10-06
J	Issued for Tender	2021-10-15
K	Permit 2nd Review	2022-01-14
L	Issued for Coordination	2022-02-11
	Issued for SPA	2022-02-25

DESSINÉ PAR Drawn by: **PM**  
DATE (aa.mm.ii): **07/11/18**  
TITRE DU DESSIN Drawing Title: **UNDERGROUND PARKING PLAN PART B**

VERIFIÉ PAR Checked by: **Paul McQ.**  
ÉCHELLE Scale: **As indicated**

NO. DESSIN Dwg Number: **A200b**  
RÉVISION Revision: **L**

C:\Fichiers Revit\Locaux\P2BL8\_10498.02\_ARC\_INT\_R20\_pmaqueen.rvt