

Copyright Reserved

The Contractor shall verify and be responsible for all dimensions. DO NOT scale the drawing - any errors or omissions shall be reported to Stantec without delay. The Copyrights to all designs and drawings are the property of Stantec. Reproduction or use for any purpose other than that authorized by Stantec is forbidden.

Legend

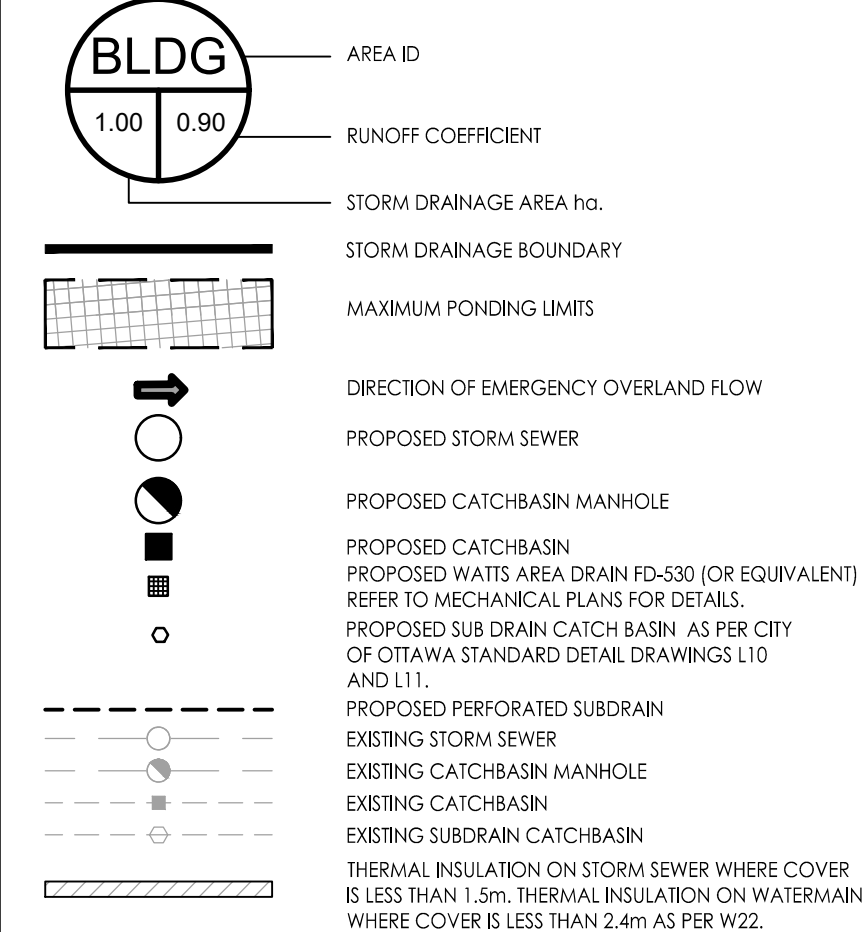

Notes

SCHEDULE OF ROOF RELEASE RATES				
BUILDING	DRAIN TYPE	# DRAINS	100YR Head (m)	100YR RELEASE RATE (L/s)
R1001A	WATTS ACCUFLOW (50% OPEN)	11	0.15	13.80

SCHEDULE OF INLET CONTROL DEVICES					
AREA ID	CATCHBASIN ID	TYPE	100YR HEAD (m)	100YR RELEASE RATE (L/s)	DEPTH OF PONDING (m)
F1001A	CB1001A	LMF ES	3.48	6.78	0.23

SCHEDULE FOR DECK AND RAMP AREAS			
BLOCK ID	DRAINAGE AREA ID	100YR RELEASE RATE (L/s)	
RAMP	F1001B	13.40	
DECK CB	F1001C	16.07	

NOTES:

- PROPOSED BUILDINGS TO BE EQUIPPED WITH BACKWATER VALVES
- PROPOSED TRENCH DRAINS TO BE DESIGNED TO CAPTURE 100 YEAR PEAK FLOWS.
- STORAGE PIPE VOLUME = 12.72m³
- UNCONTROLLED RUNOFF UP TO THE 100 YEAR STORM FROM AREAS R1001B, R1001C, F1001B AND F1001C WILL BE CAPTURED INTO THE BUILDINGS INTERNAL PLUMBING SYSTEM AND DIRECTED TO THE STORM SERVICE LATERAL.

4	REVISED AS PER CITY COMMENTS	MJS	AMP	22.02.16
3	ISSUED FOR TENDER	MJS	KH	21.10.01
2	REVISED AS PER CITY COMMENTS	MJS	TR	21.09.20
1	REVISED AS PER NEW SITE PLAN AND CITY COMMENTS	MJS	AMP	21.03.24
0	ISSUED FOR SPA	MJS	AMP	19.12.13

Revision				
By	Appd.	YY.MM.DD		
MJS	AMP	MJS	19.06.20	

File Name: 160401331_D82.dwg

Permit-Seal

Client/Project
**BRIGIL
PETRIE'S LANDING II**

**BLOCK 8
180 Prestige Circle
OTTAWA, ON, CANADA**

Title
STORM DRAINAGE PLAN

Project No. 160401331	Scale 1:250	0 2.5 7.5 12.5m
Drawing No. SD-1	Sheet 5 of 6	Revision 4

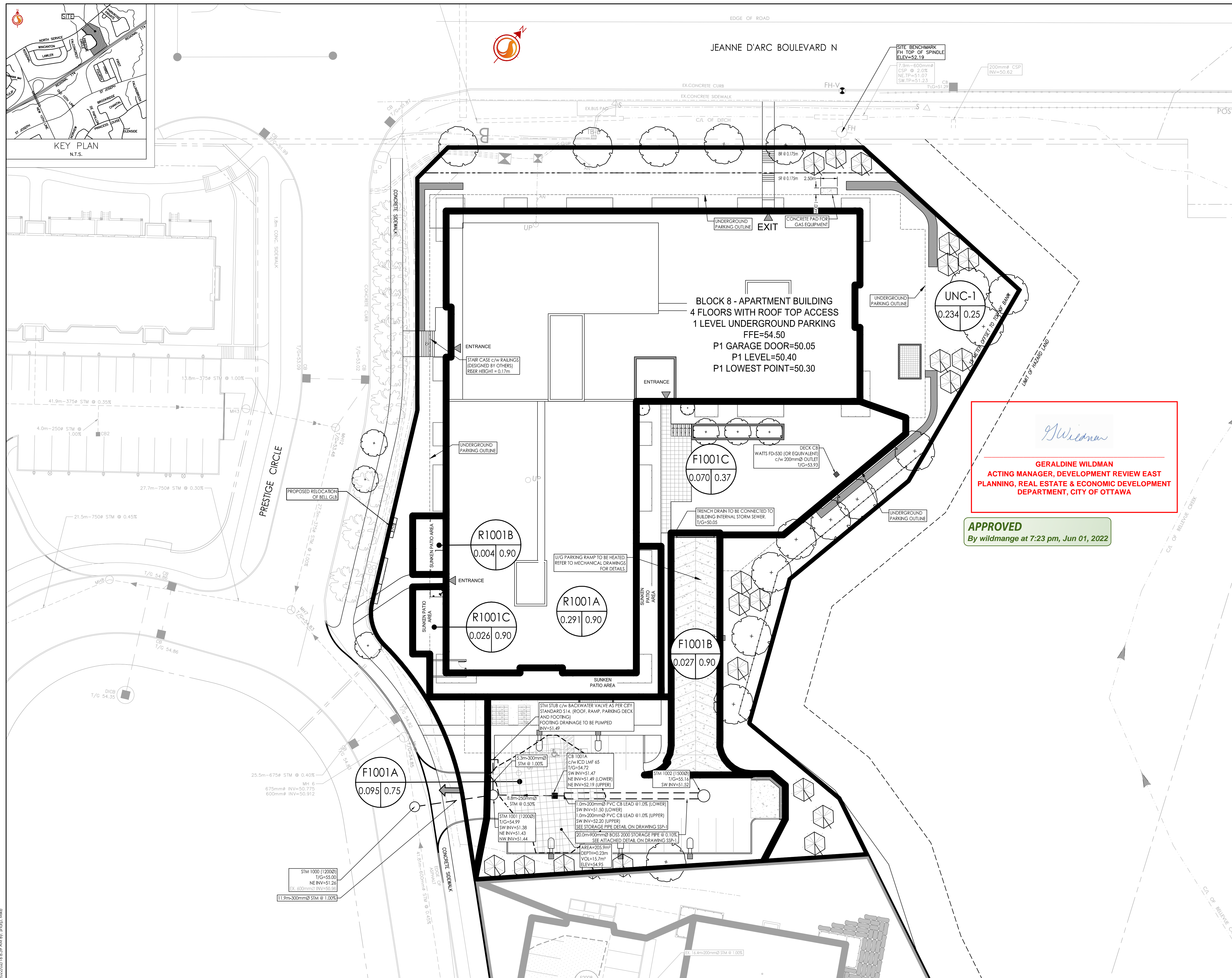

G. Wildman
**GERALDINE WILDMAN
ACTING MANAGER, DEVELOPMENT REVIEW EAST
PLANNING, REAL ESTATE & ECONOMIC DEVELOPMENT
DEPARTMENT, CITY OF OTTAWA**

APPROVED
By wildmange at 7:23 pm, Jun 01, 2022