

Notes

SANITARY STATS	
POPULATION COUNT - PHASE 1, 2 AND 3	
63 STUDIO APTS @ 1.4PPU = 89 PEOPLE	
190 - 1 BEDROOM APTS @ 1.4PPU = 266 PEOPLE	
113 - 2 BEDROOM APTS @ 2.1PPU = 238 PEOPLE	
8 - 3 BEDROOM APTS @ 3.1PPU = 25 PEOPLE	
30 CARE UNITS @ 1.0 PPU = 30 PEOPLE	
TOTAL POPULATION = 646	
COMMERCIAL AREA	
TOTAL COMMERCIAL SPACE = 548m ² (0.0548ha) @ 28,000 L/ha/day	
INFILTRATION AREA	
TOTAL SITE AREA = 0.912 Ha.	

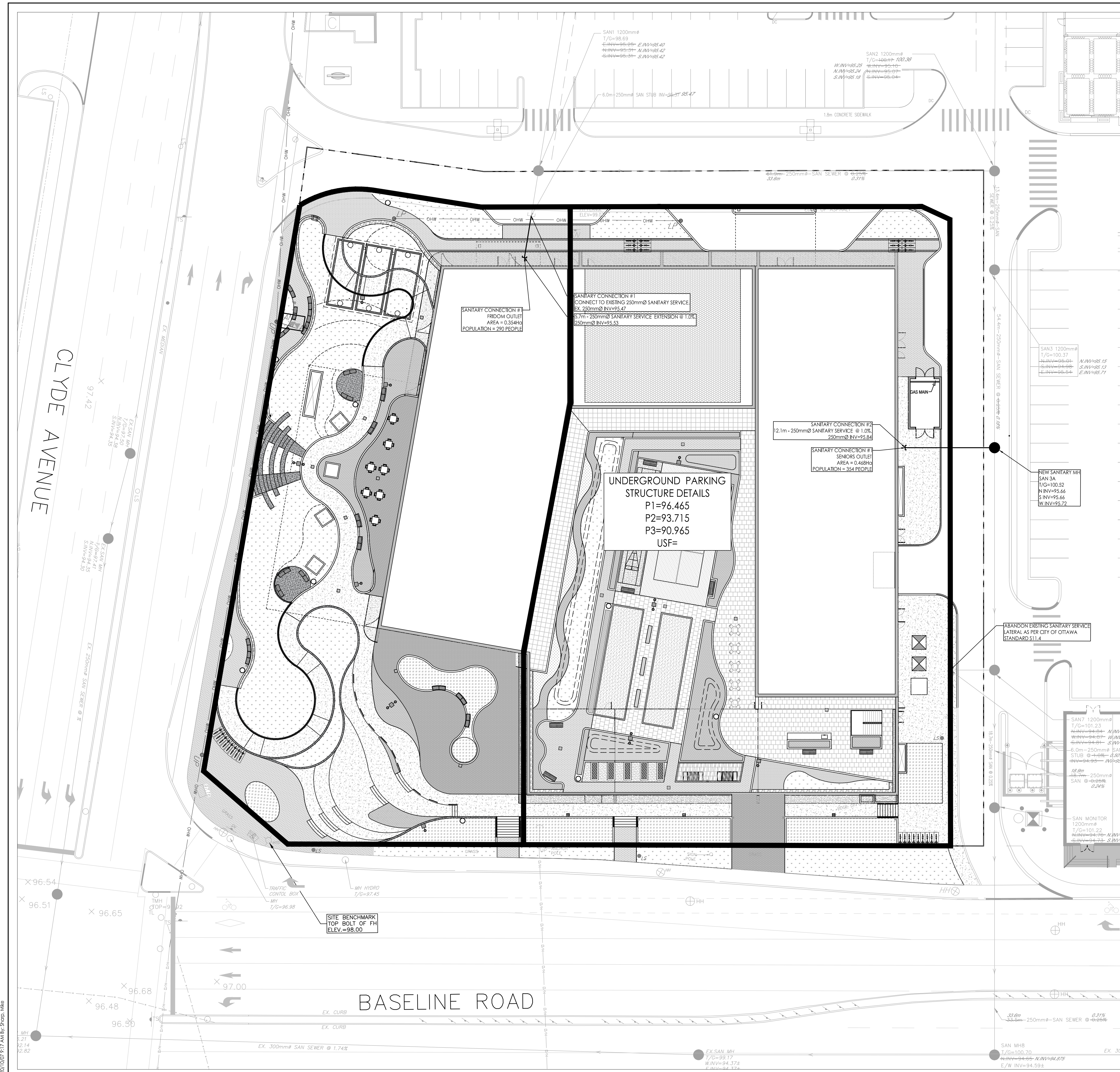

APPROVED
By Lily Xu at 11:51 am, Apr 13, 2021

LILY XU, MCIP, RPP
MANAGER, DEVELOPMENT REVIEW SOUTH
PLANNING, INFRASTRUCTURE & ECONOMIC
DEVELOPMENT DEPARTMENT, CITY OF OTTAWA

Revision	By	Appd.	YY.MM.DD	
2	REVISED AS PER CITY COMMENTS	MJS	DT	20.10.07
1	REVISED AS PER CITY COMMENTS	MJS	DT	20.05.15
0	ISSUED TO CITY FOR SPA	MJS	DT	20.01.09

File Name: 160401510-D8
 MJS KS MJS 19.09.23
 Dwn. Chkd. Dgn. YY.MM.DD

Client/Project
 SELECTION GROUP INTERNATIONAL INC.
 2400 BOUL. DANIEL JOHNSON
 LAVAL, QUEBEC
 H7T 3A4
 1357 BASELINE ROAD
 OTTAWA, ON, CANADA

Title
 SANITARY DRAINAGE PLAN

Project No. 160401510
 Drawing No. Sheet Revision
 Scale 0 2.5 7.5 12.5m
 1:250

\\s1\apps\cadd\160401510\design\drawing\160401510\sd.dwg
 2021/04/13 09:57:11 AM 160401510.dwg
 ORIGINAL SHEET - ARCH D