

Copyright Reserved
The Contractor shall verify and be responsible for all dimensions. DO NOT scale the drawing - any errors or omissions shall be reported to Stantec without delay.
The Copyrights to all designs and drawings are the property of Stantec. Reproduction or use for any purpose other than that authorized by Stantec is forbidden.

Legend

- EXISTING WATERMAIN
- EXISTING VALVE AND VALVE BOX
- EXISTING VALVE CHAMBER
- EXISTING REDUCER
- EXISTING FIRE HYDRANT
- EXISTING SANITARY SEWER
- EXISTING STORM SEWER
- EXISTING CATCH-BASIN MANHOLE
- EXISTING CATCH-BASIN
- EXISTING SUBDRAIN CATCH-BASIN

Notes

Revision	By	Appd.	YY.MM.DD
2	MJS	DT	20.10.07
1	MJS	DT	20.05.15
0	MJS	DT	20.01.09

File Name:	MJS	KS	MJS	19.09.23
160401510-D8	Dwn.	Chkd.	Dgn.	YY.MM.DD

Permit-Seal

Client/Project

SELECTION GROUP INTERNATIONAL INC.
2400 BOUL. DANIEL JOHNSON
LAVAL, QUEBEC
H7T 3A4

1357 BASELINE ROAD
OTTAWA, ON, CANADA

Title

EXISTING CONDITIONS PLAN

Project No.	Scale	0	2.5	7.5	12.5m
160401510	1:250				
Drawing No.	Sheet	Revision			

EX-1 2 of 8 2
PLAN No. 18117

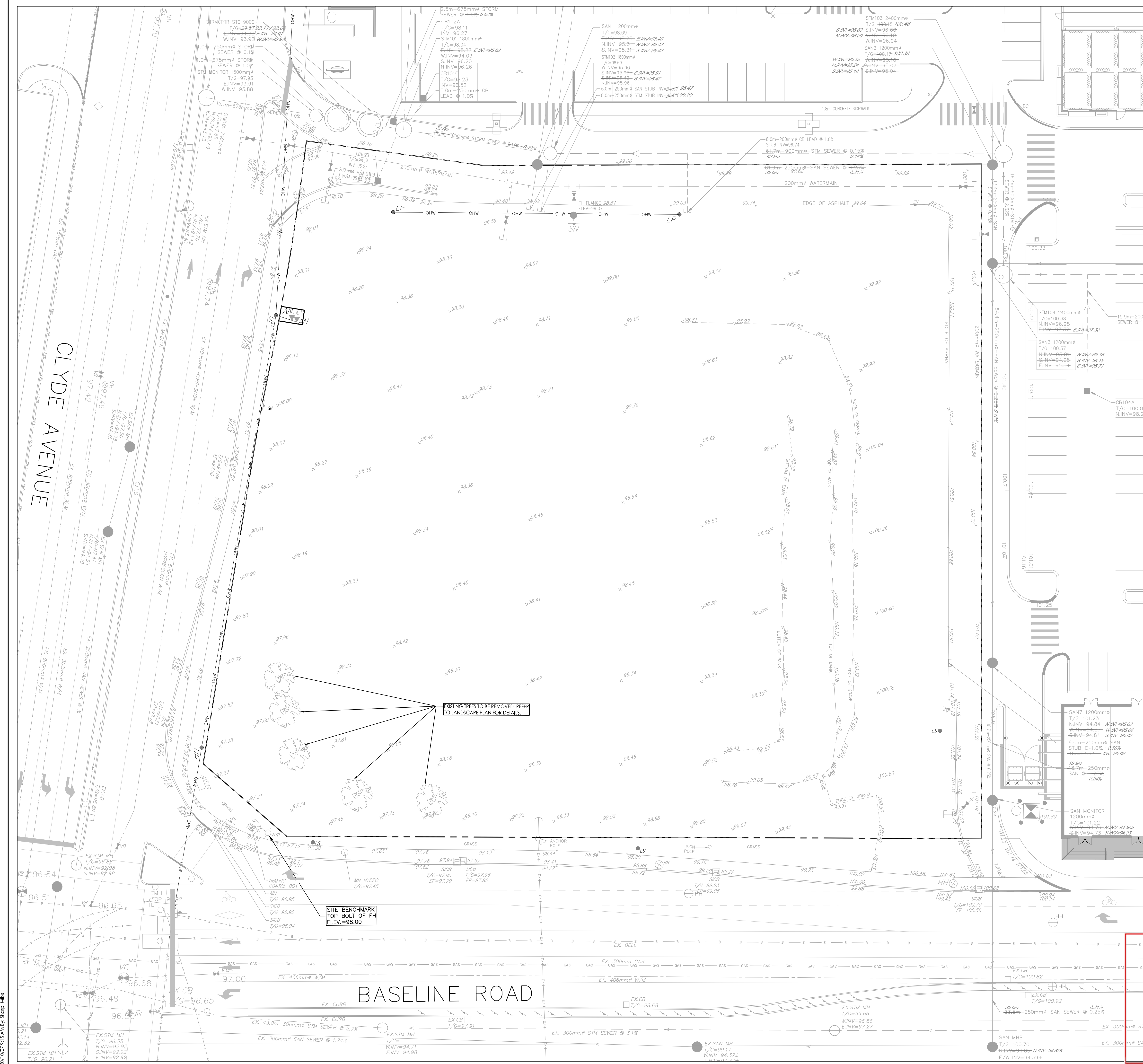

APPROVED
By Lily Xu at 11:50 am, Apr 13, 2021

LILY XU, MCIP, RPP
MANAGER, DEVELOPMENT REVIEW SOUTH
PLANNING, INFRASTRUCTURE & ECONOMIC
DEVELOPMENT DEPARTMENT, CITY OF OTTAWA

2021/04/13 11:50 AM Design Drawing 160401510-D8.dwg
 ORIGINAL SHEET ARCH-D