

EXTERIOR LIGHTING - LUMINAIRE SCHEDULE

TYPE	DESCRIPTION	MOUNTING	LAMPS	OPTIC DISTRIBUTION	CONTROL
W1	LED WALL LUMINAIRE EQUAL TO LITHONIA LIGHTING D-SERIES SIZE 2, STANDARD BRONZE, FULL CUT-OFF (ULOR-0) DIE-CAST ALUMINUM HOUSING, ACRYLIC LENSES, EQUIPPED WITH PIR-H MOTION/AMBIENT SENSOR THAT SWITCH TO 33% DIMMED OUTPUT STATE, RATED OPERATING TEMPERATURE -40 TO 40 DEGREE CELSIUS, IP65 RATED, DLC QUALIFIED, 5-YEAR WARRANTY, 120V OR 34.7V HIGH EFFICIENCY DRIVER, PF>90%, THD<20%	WALL-MOUNT 8.0 M AFG	105W LED, 10,955 LUMENS, 4000K, 70CRI, 100,000 HOURS RATED LIFE AT L87	T2M	BUILDING LIGHTING CONTROLLER AND INTEGRAL MOTION SENSOR
W2	LED WALL LUMINAIRE EQUAL TO LITHONIA LIGHTING D-SERIES SIZE 2, STANDARD BRONZE, FULL CUT-OFF (ULOR-0) DIE-CAST ALUMINUM HOUSING, ACRYLIC LENSES, EQUIPPED WITH PIR-H MOTION/AMBIENT SENSOR THAT SWITCH TO 33% DIMMED OUTPUT STATE, RATED OPERATING TEMPERATURE -40 TO 40 DEGREE CELSIUS, IP65 RATED, DLC QUALIFIED, 5-YEAR WARRANTY, 120V OR 34.7V HIGH EFFICIENCY DRIVER, PF>90%, THD<20%	WALL-MOUNT 8.0 M AFG	105W LED, 11,129 LUMENS, 4000K, 70CRI, 100,000 HOURS RATED LIFE AT L87	T4M	BUILDING LIGHTING CONTROLLER AND INTEGRAL MOTION SENSOR
W3	LED WALL LUMINAIRE EQUAL TO LITHONIA LIGHTING D-SERIES SIZE 2, STANDARD BRONZE, FULL CUT-OFF (ULOR-0) DIE-CAST ALUMINUM HOUSING, ACRYLIC LENSES, EQUIPPED WITH PIR-H MOTION/AMBIENT SENSOR THAT SWITCH TO 33% DIMMED OUTPUT STATE, RATED OPERATING TEMPERATURE -40 TO 40 DEGREE CELSIUS, IP65 RATED, DLC QUALIFIED, 5-YEAR WARRANTY, 120V OR 34.7V HIGH EFFICIENCY DRIVER, PF>90%, THD<20%	WALL-MOUNT 8.0 M AFG	105W LED, 11,240 LUMENS, 4000K, 70CRI, 100,000 HOURS RATED LIFE AT L87	T2S	BUILDING LIGHTING CONTROLLER AND INTEGRAL MOTION SENSOR

ELECTRICAL LEGEND

- PHOTOCELL
- BUILDING WALL-MOUNT LIGHT FIXTURE
- COMPLETE WITH
- ABOVE FINISH GRADE

GENERAL NOTES:

- THESE DRAWINGS ARE NOT TO BE USED FOR CONSTRUCTION.
- ALL WORK SHALL BE CARRIED OUT IN ACCORDANCE WITH:
  - A) ELECTRICAL DRAWING E1 NOTES, AND
  - B) ALL APPLICABLE CODES, BYLAWS AND BEST-RECOMMENDED PRACTICES.
- DURING TENDER PHASE, CONTRACTORS SHALL FAMILIARIZE THEMSELVES WITH THE TENDER DRAWINGS AND THE PROJECT SITE, AND REPORT TO THE ENGINEER ANY CONFLICTS OR SITE CONDITIONS WHICH MAY AFFECT WORK. IF THIS PROCEDURE IS NOT FOLLOWED, THE CONTRACTORS WILL BE RESPONSIBLE TO COMPLETE WORK REQUIRED AT NO EXTRA COSTS.
- FOR THE PURPOSES OF THIS PROJECT, 'PROVIDE' SHALL MEAN TO SUPPLY, INSTALL, CONNECT AND TEST.
- THESE DRAWINGS WERE PREPARED BASED ON THE AVAILABLE BUILDING DRAWINGS PROVIDED BY THE ARCHITECT. EXISTING SITE CONDITIONS ARE SHOWN AS ACCURATELY AS POSSIBLE. THERE IS THE POSSIBILITY THAT CONDITIONS SHOWN ARE NOT EXACTLY AS EXISTING. CONTRACTOR SHALL VERIFY ALL DIMENSIONS, ELEVATIONS, LOCATIONS, SIZES, AND CONDITIONS AT THE SITE PRIOR TO COMMENCING ANY LAYOUT OR INSTALLATION WORK.
- PROPOSED CONDUITS/CABLES AND EQUIPMENT LAYOUTS SHOWN ON DRAWINGS ARE INTENDED TO CONVEY THE GENERAL SCOPE OF WORK. LOCATION OF EQUIPMENT/DEVICES SHOWN ON ELECTRICAL DRAWINGS IS TO BE CONSIDERED AS APPROXIMATE. IT IS CONTRACTOR RESPONSIBILITY TO COORDINATE FINAL LAYOUTS WITH ALL COMPONENTS OF THE BUILDING SYSTEMS AND TO PROVIDE ALL PULL AND JUNCTION BOXES, SUPPORTS, FITTINGS, ETC. REQUIRED TO FULLY COMPLETE WORK.
- PROVIDE WALL PENETRATIONS REQUIRED TO RUN NEW CONDUITS AND CABLES. PERFORM SCANNING PRIOR TO CORE DRILLING ANY NEW OPENINGS THROUGH A STRUCTURAL ELEMENT AND ENSURE THAT NO REINFORCING BARS ARE CUT WITHOUT THE APPROVAL OF A LICENSED STRUCTURAL ENGINEER AND THE BUILDING OWNER.
- PROVIDE ALL REQUIRED LADDERS, RIGGING, HOISTING, AND ALL OTHER EQUIPMENT TO FULLY COMPLETE THE WORK REQUIRED UNDER THIS PROJECT.
- UPON FINAL COMPLETION, PROVIDE AS-BUILT DRAWINGS THAT SHALL INCLUDE MARK-UPS OF THE FINAL LOCATIONS AND DEPTHS OF ALL THE UNDERGROUND CONDUITS OR CABLES.
- PRIOR TO EMERGING ANY NEW WIRING, PERFORM INSULATION RESISTANCE TESTS ON ALL NEW AND EXISTING WIRING AND EQUIPMENT PART OF THIS PROJECT. TEST AND CHECK THE ELECTRICAL SYSTEMS PERTAINING TO THIS PROJECT FOR THEIR CORRECT OPERATION.
- ENGAGE AND PAY FOR A THIRD-PARTY FIRM OR INDIVIDUAL SPECIALIZED IN TESTING LIGHTING CONTROLS TO TEST ALL NEW LIGHTING CONTROL DEVICES AND/OR CONTROL SYSTEMS PERTAINING TO THIS PROJECT. LIGHTING CONTROL DEVICES AND CONTROL SYSTEMS SHALL BE TESTED TO ENSURE, AS APPLICABLE, THAT CONTROL HARDWARE AND SOFTWARE ARE CALIBRATED, ADJUSTED, PROGRAMMED, AND IN PROPER WORKING CONDITION IN ACCORDANCE WITH THE CONSTRUCTION DOCUMENTS AND MANUFACTURER'S INSTALLATION INSTRUCTIONS. THE THIRD-PARTY LIGHTING SPECIALIST RESPONSIBLE FOR THIS FUNCTIONAL TESTING SHALL NOT BE DIRECTLY INVOLVED IN CONSTRUCTION OF THE PROJECT AND SHALL PROVIDE DOCUMENTATION CERTIFYING THAT THE INSTALLED LIGHTING CONTROLS MEET OR EXCEED ALL DOCUMENTED PERFORMANCE CRITERIA. ENSURE THAT THE CITY BUILDING OFFICIAL IS SATISFIED WITH THE CERTIFYING DOCUMENTATION'S FORMAT AND CONTENT PRIOR TO SUBMITTING IT.

LUMINAIRE SCHEDULE NOTES:

- EACH LUMINAIRE SHALL BE AUTOMATICALLY CONTROLLED BY ITS INTEGRAL OCCUPANCY SENSOR SUCH THAT THE CONNECTED LIGHTING POWER IS REDUCED BY AT LEAST 30% DURING ANY PERIOD WHEN NO ACTIVITY/MOTION IS DETECTED FOR A TIME OF NO LONGER THAN 15 MINUTES.
- IF ALTERNATE LIGHTING FIXTURES ARE PROVIDED, CONTRACTOR SHALL ENSURE THAT ILLUMINATION LEVELS DO NOT EXCEED 5 LUX AT PROPERTY LINES, AND ALL NEW EXTERIOR LIGHTING FIXTURES ARE FULL CUT-OFF (ULOR-0) RATED.

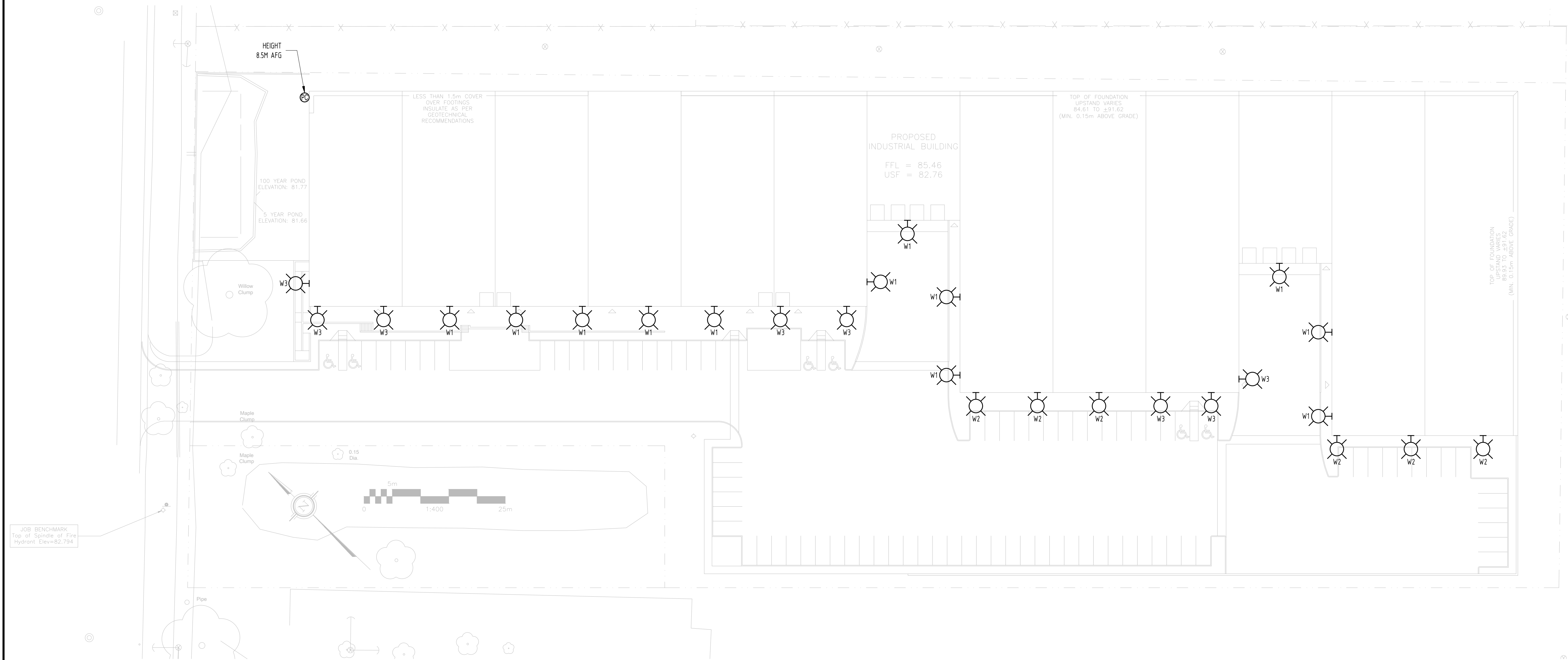

DRAWING NOTES: THE NUMBERS INSIDE HEXAGONS SHOWN ON THE PLAN REFER TO THE NUMBERED POINTS BELOW. NOT ALL POINTS ARE SHOWN ON THE PLAN.

- PROVIDE NEW WALL-MOUNT EXTERIOR LIGHTING FIXTURES AS INDICATED IN SITE PLAN AND IN LUMINAIRE SCHEDULE.
- PROVIDE ONE NEW LIGHTING CONTROLLER AND ONE NEW PHOTOCELL TO CONTROL ALL EXTERIOR LIGHTING FIXTURES TO MEET CLAUSE 94.14 OF ASHRAE 90.1-2013.

ISSUE	DESCRIPTION	CHECKED	DATE
1	ISSUED FOR SITE PLAN	AB	2019-11-27

KEY PLAN

DRAWINGS ARE TO BE READ AS A PACKAGE AND ARE NOT INTENDED TO BE SEPARATED AND VIEWED INDIVIDUALLY BY DISCIPLINE.

DESIGNED BY:	AB
DRAWN BY:	JD
CHECKED BY:	AB
CLIENT:	MEGHA HOLDING

PROJECT:  
PROPOSED WAREHOUSE  
  
1243 TERON ROAD, OTTAWA, ON

DRAWING TITLE:  
ELECTRICAL SITE PLAN  
LIGHTING LAYOUT, LEGEND  
SCHEDULES, AND NOTES

SEAL:	SCALE: AS NOTED
	SHEET NO: 1 OF 1
	PROJECT NO: 19080
	E1