

PROPOSED PLANT LIST

KEY	QTY	BOTANICAL NAME	COMMON NAME	SIZE	CONDITION	REMARKS
TREES						
JL	3	Syringa reticulata	Japanese Tree Lilac	60mm Cal.	B&B	Single Leader
SHRUBS						
RR	34	Rosa rugosa	Rugosa Rose	800mm Ht.	Potted	Space 1200mm O.C.
SE	34	Sorbaria sorbifolia 'Sem'	Sem False Spirea	600mm Ht.	Potted	Space 1000mm O.C.
SS	37	Sorbaria sorbifolia	Ural False Spirea	600mm Ht.	Potted	Space 1000mm O.C.
WC	131	Thuja occidentalis 'Clumps'	Eastern White Cedar Clumps	1200mm Ht.	Bare Root	Space 500mm O.C. Three trunks or more
ORNAMENTAL GRASSES						
KF	135	Calamagrostis x acutiflora 'Karl Foerster'	Feather Reed Grass	250mm pot.	Potted	Space 1000mm O.C.

EXISTING TREE LIST

KEY	QTY	BOTANICAL NAME	COMMON NAME	SIZE	CONDITION	REMARKS
TREES						
AF	3	Acer x freemanii	Freeman's Maple	50mm DBH	GOOD	See Plan
CO	3	Celtis occidentalis	Hackberry	50mm DBH	GOOD	See Plan
GT	1	Gleditsia triacanthos	Honey Locust	50mm DBH	GOOD	See Plan
TC	1	Tilia cordata	Littleleaf Linden	50mm DBH	GOOD	See Plan

- #### GENERAL NOTES:
- It is the responsibility of the appropriate contractor or official to report any errors, omissions or discrepancies on this plan with actual site conditions to the Landscape Architect before proceeding with construction.
 - The contractor is to notify all utility companies and authorities prior to any excavation and ascertain locations of underground services.
 - The contractor is to reinstatement all areas and items damaged as a result of construction activity.
 - The contractor is to comply with all pertinent codes and by-laws.
 - The contractor is to maintain a positive surface run-off throughout the entire construction period.
 - The Landscape Architect is not responsible for subsurface conditions.
 - The contractor is to identify all existing trees to remain on site with the Landscape Architect prior to construction.
 - The contractor is to stake the proposed location of all plant material in conjunction with the Landscape Architect prior to excavation.
 - Minimum distances for selected deciduous trees are as follows:
 - Building Foundations 7.5m
 - Sidewalks 1.5m
 - Public Streets 2.5m
 - Underground Infrastructure 2.0m
 - All trees within 1m of underground utility trenches are to be excavated by hand.
 - Remove all protective wrapping from tree trunks after installation.
 - Staking of trees shall only be performed if necessary.
 - Ensure that mulch is pulled back a min. distance of 75mm from base of tree trunk.

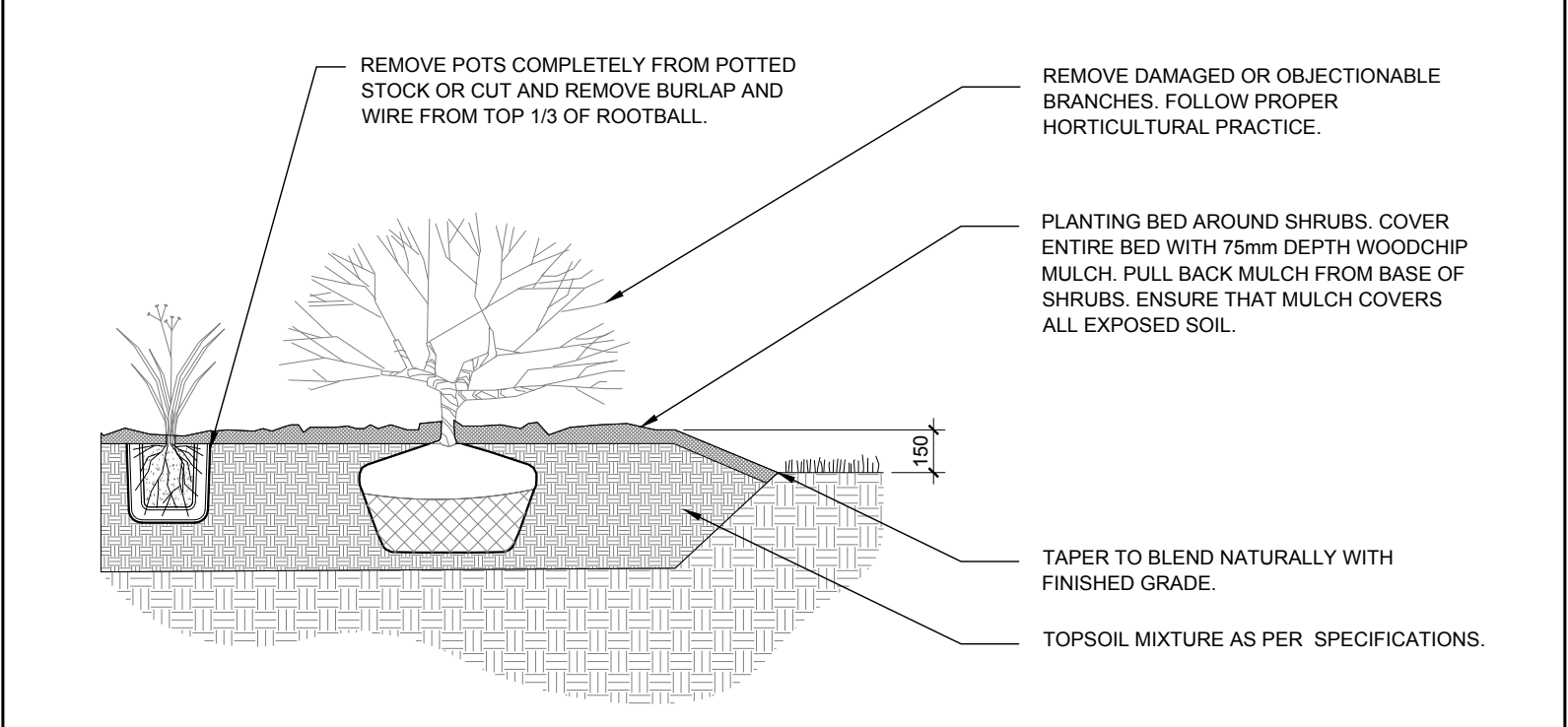

2 SHRUB PLANTING / ORNAMENTAL GRASS PLANTING
SCALE: NTS

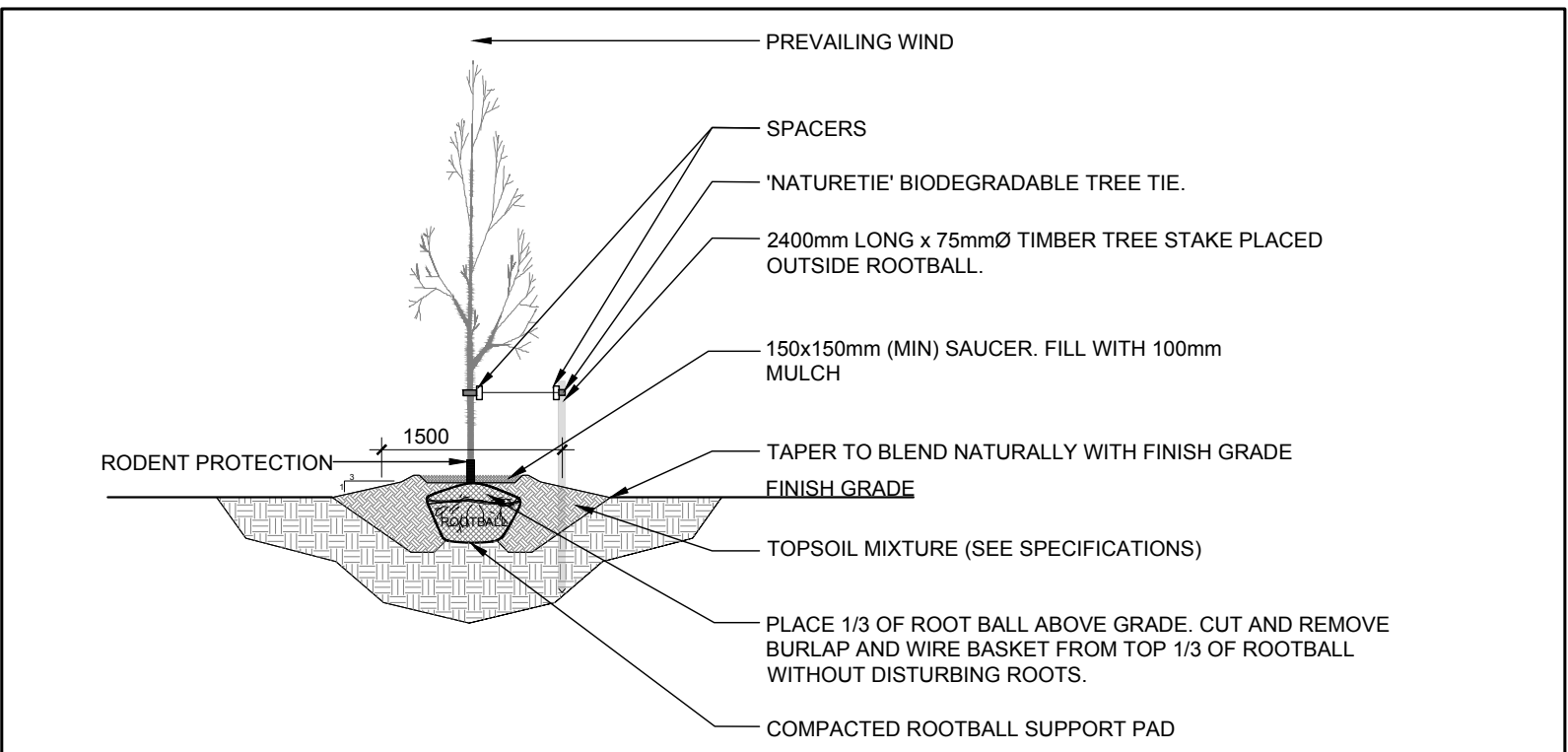

3 DECIDUOUS TREE PLANTING
SCALE: NTS

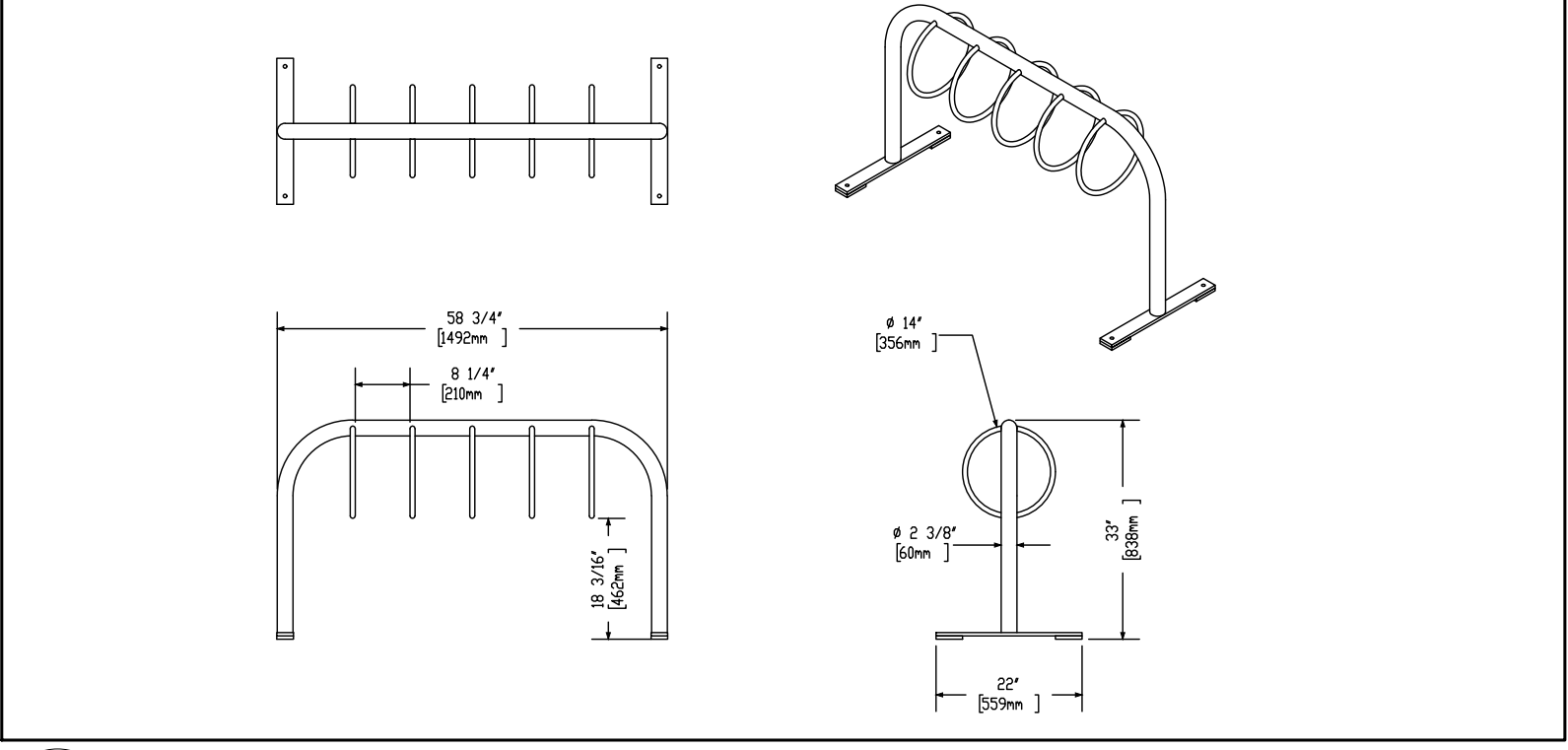

4 PROPOSED FIVE (5) RING BIKE RACK
SCALE: NTS

CLIENT: **GOVAN BROWN**
31-2000 THURSTON DRIVE,
OTTAWA, ON K1G 4K7
Tel: (613) 231-7878

ARCHITECTS: **OPEN PLAN ARCHITECTS INC.**
3205 HILLARY AVE.
OTTAWA, ON K1H 7J2
Tel: (613) 883-5090

CIVIL ENGINEERS: **H.S.P. CONSULTANTS INC.**
5715 WARNER DRIVE,
LONG SAULT, ON
Tel: (613) 937-3289

- #### LEGEND
- EXISTING TREE TO REMAIN
 - PROPOSED DECIDUOUS TREE
 - PROPOSED TREE 'BY OTHERS'
 - PROPOSED SHRUBS / ORNAMENTAL GRASSES
 - PROPOSED CEDAR HEDGE
 - PROPOSED CONCRETE
 - PROPOSED SOD
 - PROPOSED PAVERS
 - PROPOSED FIVE (5) RING BIKE RACK
 - PROPOSED PICNIC TABLE
 - PROPOSED BENCH

No.	Issue	Date	By	Checked
3	REVISED PER NEW SITE PLAN	08/07/2020	ML	JL
2	REVISED PER NEW SITE PLAN	05/14/2020	ML	JL
1	ISSUED FOR SITE PLAN CONTROL	12/03/2020	ML	JL

JAMES B. LENNOX & ASSOCIATES INC.
LANDSCAPE ARCHITECTS
3332 CARLING AVE. OTTAWA, ONTARIO K2H 5A8
Tel: (613) 722-5168 Fax: (866) 343-3942

PROJECT
PANORAMA WELLNESS CENTRE
1380 UPPER CANADA STREET, OTTAWA ON

DRAWING
LANDSCAPE PLAN

SCALE
AS SHOWN

START DATE
FEBRUARY 2020

PROJECT NO.
20MIS2023

PROJECT NORTH

DRAWING NO.
L.1

APPROVED REFUSED
THIS 29 DAY OF September, 2020

Erin O'Connell
ERIN O'CONNELL, MCIP, RPP, MANAGER (A)
DEVELOPMENT REVIEW, WEST
PLANNING, INFRASTRUCTURE AND ECONOMIC
DEVELOPMENT DEPARTMENT, CITY OF OTTAWA

1 LANDSCAPE PLAN
SCALE 1:200