



- GENERAL NOTES**
- IT IS THE RESPONSIBILITY OF THE APPROPRIATE CONTRACTOR OR OFFICIAL TO REPORT ANY ERRORS, OMISSIONS OR DISCREPANCIES ON THIS PLAN WITH ACTUAL SITE CONDITIONS TO THE LANDSCAPE ARCHITECT BEFORE PROCEEDING WITH CONSTRUCTION.
  - THE CONTRACTOR IS TO NOTIFY ALL UTILITY COMPANIES AND AUTHORITIES PRIOR TO ANY EXCAVATION AND ASCERTAIN LOCATIONS OF UNDERGROUND SERVICES.
  - THE CONTRACTOR IS TO REINSTATE ALL AREAS AND ITEMS DAMAGED AS A RESULT OF CONSTRUCTION ACTIVITY.
  - THE CONTRACTOR IS TO COMPLY WITH ALL PERTINENT CODES AND BY-LAWS.
  - THE CONTRACTOR IS TO MAINTAIN A POSITIVE SURFACE RUN-OFF THROUGHOUT THE ENTIRE CONSTRUCTION PERIOD.
  - THE LANDSCAPE ARCHITECT IS NOT RESPONSIBLE FOR SUBSURFACE CONDITIONS.
  - THE CONTRACTOR IS TO IDENTIFY ALL EXISTING TREES TO REMAIN ON SITE WITH THE LANDSCAPE ARCHITECT PRIOR TO CONSTRUCTION.
  - THE CONTRACTOR IS TO STAKE THE PROPOSED LOCATION OF ALL PLANT MATERIAL IN CONJUNCTION WITH THE LANDSCAPE ARCHITECT PRIOR TO EXCAVATION.
  - MINIMUM DISTANCES FOR SELECTED DECIDUOUS TREES ARE AS FOLLOWS:
    - BUILDING FOUNDATIONS 7.5M
    - SIDEWALKS 1.5M
    - PUBLIC STREETS 2.5M
    - UNDERGROUND INFRASTRUCTURE 2.0M
  - ALL TREES WITHIN 1M OF UNDERGROUND UTILITY TRENCHES ARE TO BE EXCAVATED BY HAND.
  - REMOVE ALL PROTECTIVE WRAPPING FROM TREE TRUNKS AFTER INSTALLATION.
  - STAKING OF TREES SHALL ONLY BE PERFORMED IF NECESSARY.
  - ENSURE THAT MULCH IS PULLED BACK A MIN. DISTANCE OF 75MM FROM BASE OF TREE TRUNK.

No.	Issue	Date	DR	CK
1	ISSUED FOR SITE PLAN CONTROL	03/20/2020	ML	JL

**PROJECT**  
MIXED USE APARTMENT BUILDING  
320 McRAE AVENUE, OTTAWA, ON

**DRAWING**  
LANDSCAPE PLAN

	<b>SCALE</b>	AS SHOWN
	<b>START DATE</b>	JUNE, 2019
	<b>PROJECT NO.</b>	19MIS1965
	<b>DRAWING NO.</b>	L.1

**PROJECT NORTH**

**PLOT SIZE ARCH-D**

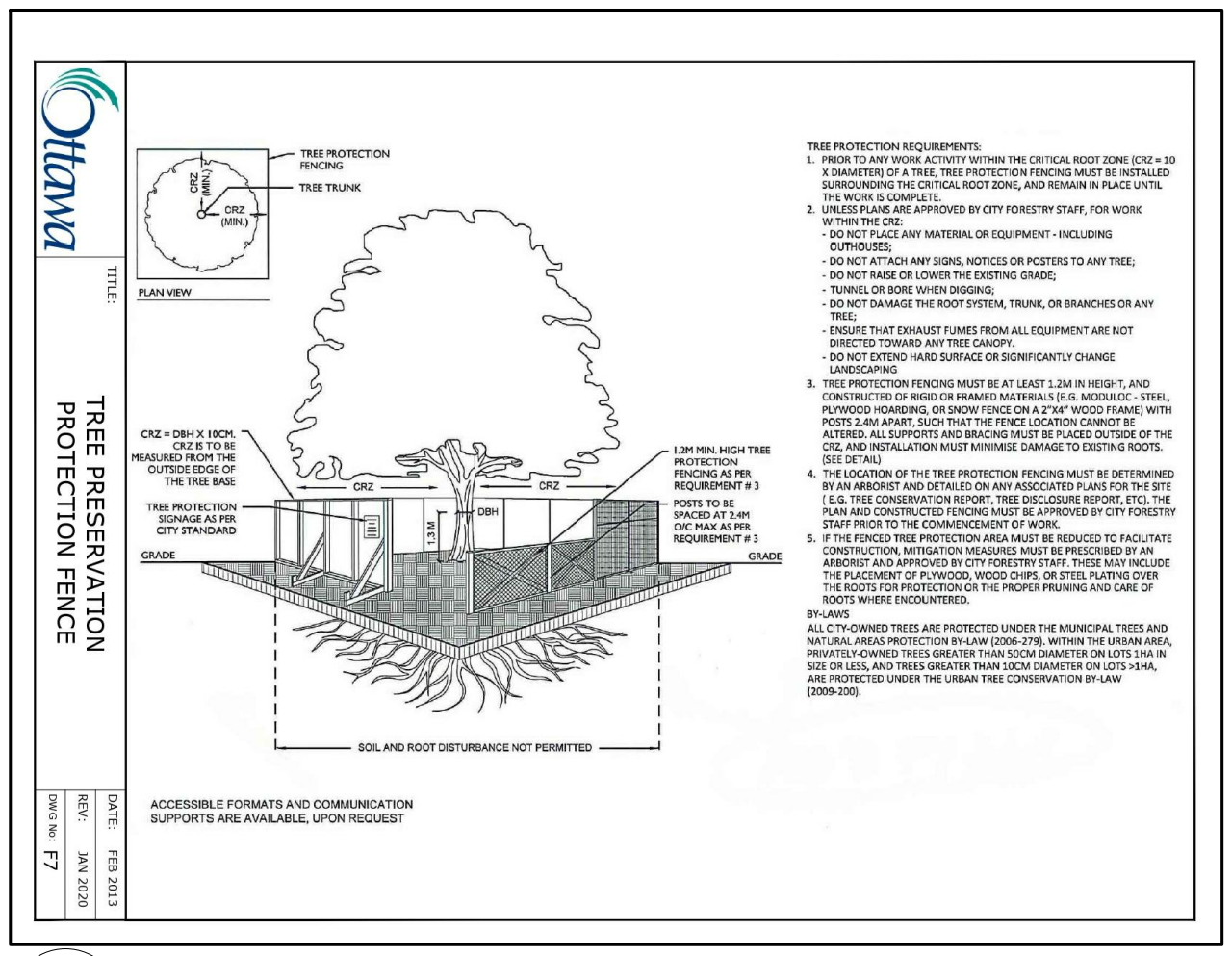
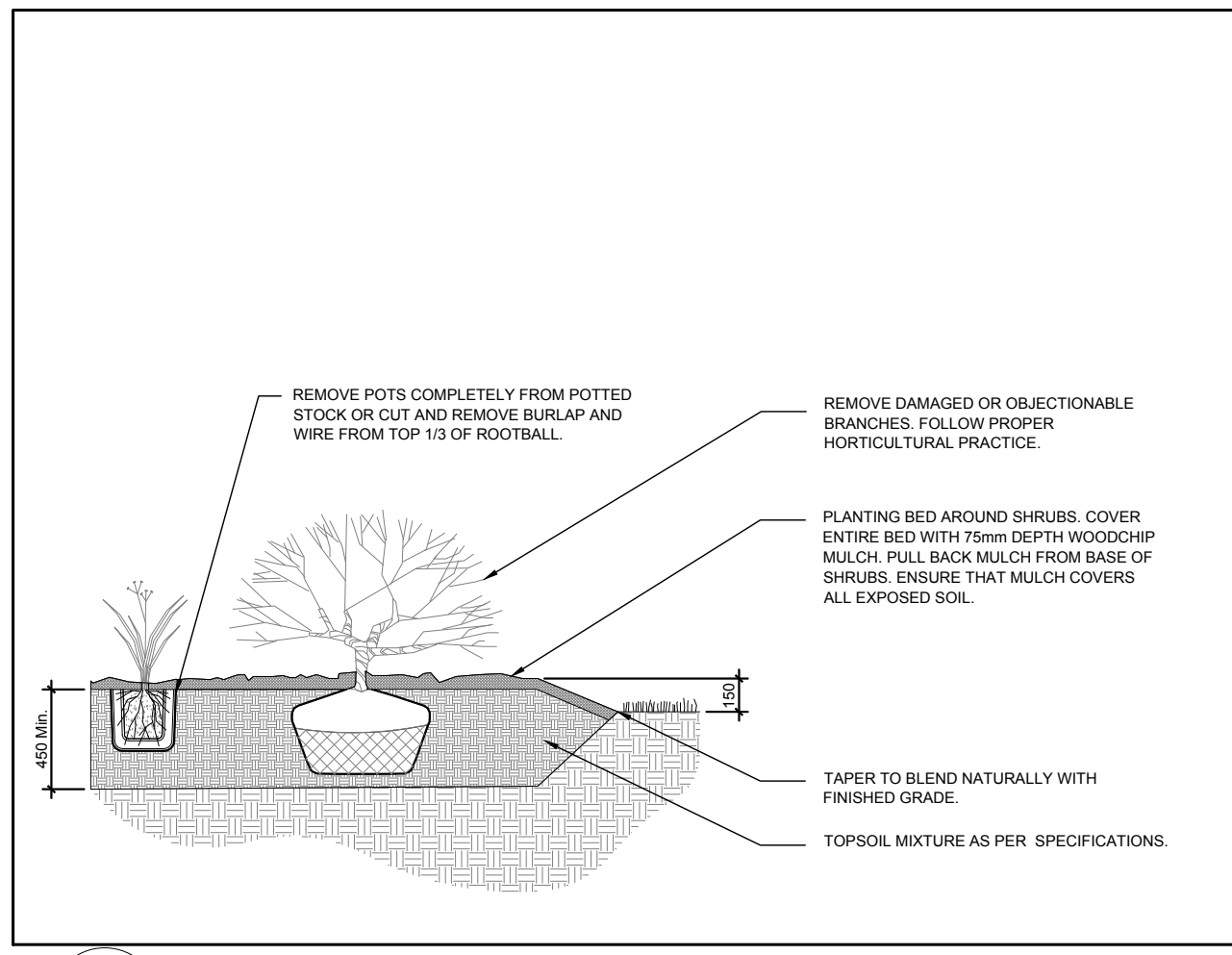
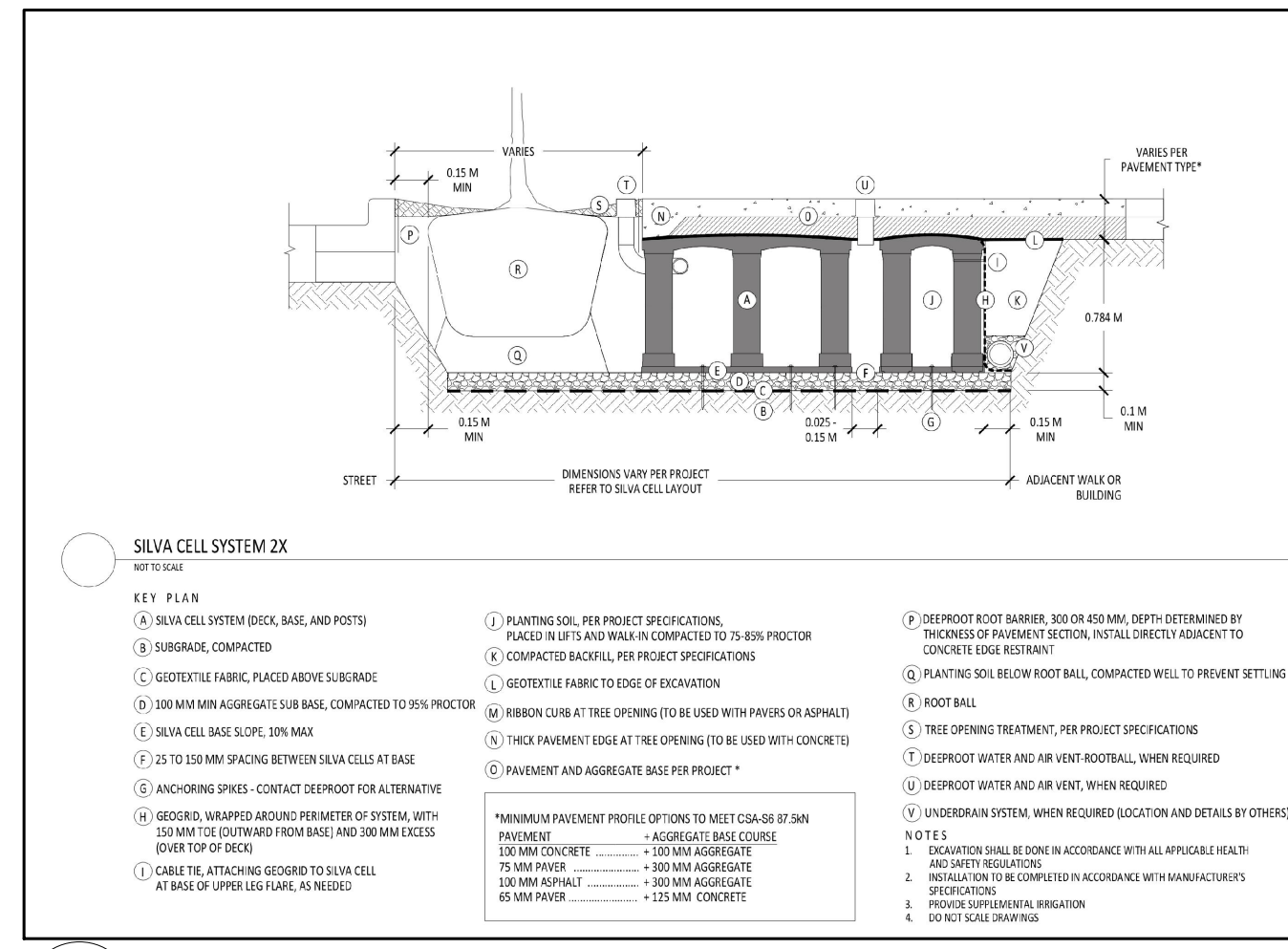

**PROPOSED PLANT LIST**

KEY	QTY	BOTANICAL NAME	COMMON NAME	SIZE	CONDITION	REMARKS
<b>TREES</b>						
HL	6	Gleditsia triacanthos 'Draves'	Street Keeper Honey Locust	60mm ø	B&B	
<b>SHRUBS</b>						
SS	37	Sorbaria sorbifolia 'Sem'	Sem False Spirea	600mm HL	Potted	Space 1000mm O.C.
<b>ORNAMENTAL GRASSES</b>						
KF	6	Calamagrostis x acutiflora 'Karl Foerster'	Feather Reed Grass	250mm pot	Potted	Space 800mm O.C.
SG	52	Panicum virgatum 'Shenandoah'	Shenandoah Switch Grass	250mm pot	Potted	Space 800mm O.C.

- LEGEND**
- EXISTING TREE TO REMAIN
  - PROPOSED DECIDUOUS TREE IN LANDSCAPE AREA REFER TO DETAIL 2/L.1
  - PROPOSED SHRUBS AND PERENNIALS
  - PROPOSED TABLE AND CHAIRS
  - PROPOSED 1.5m H. SCREEN FENCE
  - PROPOSED 1.8m H. PRIVACY FENCE
  - PROPOSED TREE PROTECTION FENCE SEE DETAIL 4/L.1 THIS SHEET
  - PROPOSED CONCRETE PAVERS TYPE I
  - PROPOSED CONCRETE PAVERS TYPE II
  - PROPOSED SOIL
  - PROPOSED PEASTONE MULCH
  - PROPOSED SILVA CELL AREA
  - PROPOSED 75mm OF COMPOSTED PINE MULCH
  - EXISTING UTILITY POLE
  - EXISTING CATCH BASIN
  - EXISTING FIRE HYDRANT

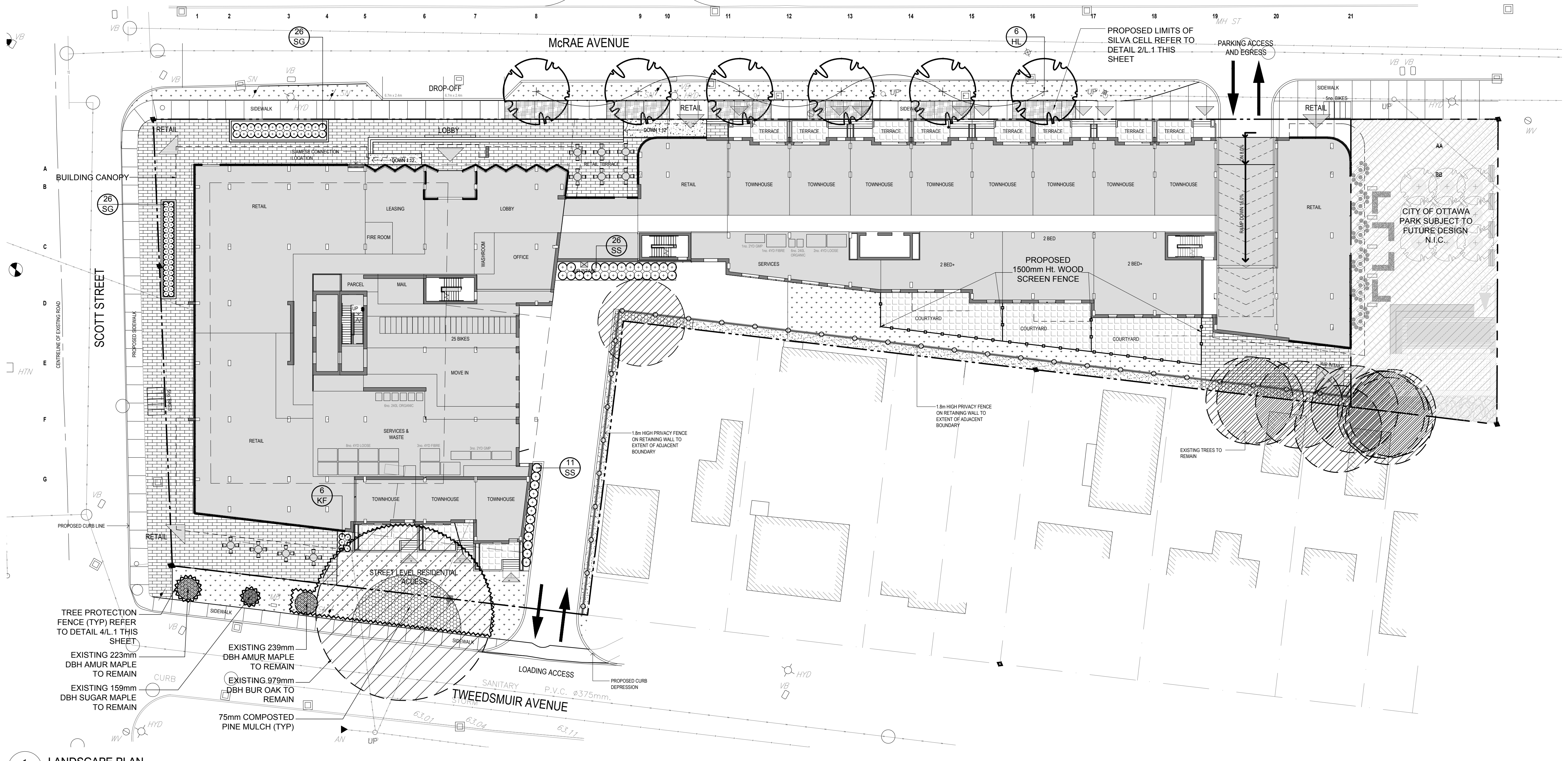

**1 LANDSCAPE PLAN**  
SCALE 1:250